

T H A M E S V A L L E Y

ARCHAEOLOGICAL

S E R V I C E S

**Southampton Park Hotel, Cumberland Place,
Southampton, Hampshire**

Archaeological Watching Brief

by Ellen McManus-Fry

**Site Code: CPS15/276
(SOU1723)**

(SU 4182 1245)

**Southampton Park Hotel, Cumberland Place,
Southampton, Hampshire**

An Archaeological Watching Brief

For Whitbread Premier Inn

by Genni Elliott

Thames Valley Archaeological Services Ltd

Site Code SOU 1723

March 2017

Summary

Site name: Southampton Park Hotel, Cumberland Place, Southampton, Hampshire

Grid reference: SU 4182 1245

Site activity: Watching Brief

Date and duration of project: 16th August -1st September 2016

Project manager: Steve Ford

Site supervisor: Ellen McManus-Fry

Site code: CPS 15/276 (SOU 1723)

Area of site: 495 sq m

Summary of results: A single well of likely Victorian age was found presumably tapping into the former Goswell Stream that ran across the site. Across much of the rest of the site the natural brickearth had been truncated by various cellars and the previous building. No deposits nor artefacts of archaeological interest were recorded.

Location and reference of archive: The archive is presently held at Thames Valley Archaeological Services, Reading and will be deposited Southampton City Council Museum in due course.

*This report may be copied for bona fide research or planning purposes without the explicit permission of the copyright holder. All TVAS unpublished fieldwork reports are available on our website:
www.tvas.co.uk/reports/reports.asp.*

Report edited/checked by: Steve Ford✓ 25.03.17 Steve Preston✓ 23.03.17

Southampton Park Hotel, Cumberland Place, Southampton, Hampshire An Archaeological Watching Brief

by Genni Elliott

Report 15/276

Introduction

This report documents the results of an archaeological watching brief carried out at Southampton Park Hotel, Cumberland Place, Southampton, Hampshire (SU 4182 1245) (Fig. 1). The work was commissioned by Mr Richard Ashton of Artelia Group, High Holborn House, 52-54 High Holborn, Holborn, WC1V 6RL on behalf of Whitbread Premier Inn, Whitbread Court, Houghton Hall Business Park, Porz Avenue, Dunstable, LU 5 5XE.

Planning permission (15/01423/FUL) has been granted from Southampton City Council for the demolition of the existing hotel and the erection of a new 4, 5 and 6 storey hotel building with new access. The consent is subject to two conditions (6 and 7) which require an archaeological watching brief to be carried out during groundworks. The building will be constructed using piles and groundbeam foundations.

This is in accordance with the Department for Communities and Local Government's *National Planning Policy Framework* (NPPF 2012) and the City's policies on archaeology. The field investigation was carried out to a specification approved by Mr Kevin White, Historic Environment Group Leader for Southampton City Council.

The fieldwork was undertaken by Aidan Colyer, Luis Esteves, Ellen McManus-Fry and Dave Platt between 16th-26th August 2016 and the site code is SOU 1723.

The archive is presently held at Thames Valley Archaeological Services, Reading and will be deposited at Southampton City Council Museum in due course.

Location, topography and geology

The site is located immediately to the north of the city centre, on the north side of Cumberland Place (A3024). It is opposite Watts Park, which is itself located immediately to the north of the Guildhall and Civic Centre (Fig. 2). The underlying geology is described as Plateau Gravel (BGS 1973) and as River Terrace Deposits 3 (mainly gravel in the more recent edition (BGS 1987). The actual geology observed was brickearth above gravel.

Archaeological background

The archaeological potential of the site stems from its location within Local Area of Archaeological Potential 7 – Bannister’s Park, in an area where prehistoric, Saxon, medieval and post-medieval archaeology has been recorded in the Historic Environment Record and identified during watching briefs carried out on nearby groundworks.

The site lies in the rural suburbs of the medieval borough of Southampton, in former meadow land called Lubery Mead, the source of the Goswell stream. It was developed in the late 18th and early 19th century as Grosvenor Square. The site itself is on the south-east side of the Goswell stream valley. The stream flowed NE-SW across the area, and fed a conduit pipe terminating at Conduit House (to the southwest on Commercial Road), as part of the early water supply of Southampton. It is possible that evidence relating to the town’s water supply may be present in the vicinity of the site.

Objectives and methodology

The purpose of the watching brief was to determine the presence or absence of human use of the area, and the date, type, state of preservation, and extent of that use; to recover associated objects; and to record such evidence as does survive. For the purposes of this project, archaeologically significant remains and contexts are defined as remains and contexts relating to pre-20th-century human use of the area, including any remains of early 19th century buildings. An additional aim was to identify and record the nature, dimensions, and relationship of natural deposits on the site and assess the potential of the natural deposits to contain or conceal archaeological remains, particularly from the prehistoric periods.

All intrusive groundworks were observed including the removal of the footings of the previous building. All excavation was to be carried out using a machine fitted with a toothless bucket, apart from the removal of the earlier footings. Where features were observed these were to be recorded and excavated only if threatened by the groundworks.

Results

All groundworks were observed. These included the removal of the existing footings, new foundation trenches, services and the removal of three cellars.

The stratigraphy consisted of significant deposits of made ground including ceramic building material and services at least 0.60m thick above the natural brickearth (Pl. 1). Across much of the site the truncation of the

brickearth was far more significant with depths of made ground up to 3m thick. Along the western boundary of the site was a brick built cellar with the walls laid in English bond on a concrete footing, totalling 3.5m deep. The base of the cellar had exposed the natural gravel beneath the brickearth (Pl. 2) at a depth of 2.40m below the street level. The brickearth in the vicinity of the cellar was 1.70m thick beneath 0.70m of made ground (Pl. 3). Two other cellars were present on the site; one in the southwest corner of the former building and the other within the southeastern part of the former building. Along the eastern boundary of the site was the location of a former swimming pool.

A single feature was found on the site; a brick built circular well (52), some 1.10m in diameter and more than 3m deep (Pl. 4). The bricks measured 200mm x 70 mm; there was no apparent bonding material and no cut was observed; the well had been backfilled.

Finds

There were no finds recovered from the site.

Conclusion

A single well of likely Victorian age was found presumably tapping into the former Goswell Stream that ran across the site. Across much of the rest of the site the the natural brickearth geology had been truncated by three cellars and the previous building with other truncation indicated by a thick deposit of made ground directly overlying brickearth. No deposits nor artefacts of archaeological interest were recorded and the site is considered to have no archaeological potential.

References

BGS, 1973, *British Geological Survey*, 1:50 000, Sheet 315, Drift Edition, Keyworth
BGS, 1987, *British Geological Survey*, 1:50 000, Sheet 315, Solid and Drift Edition, Keyworth
NPPF 2012, *National Planning Policy Framework*, Dept Communities and Local Govt, London

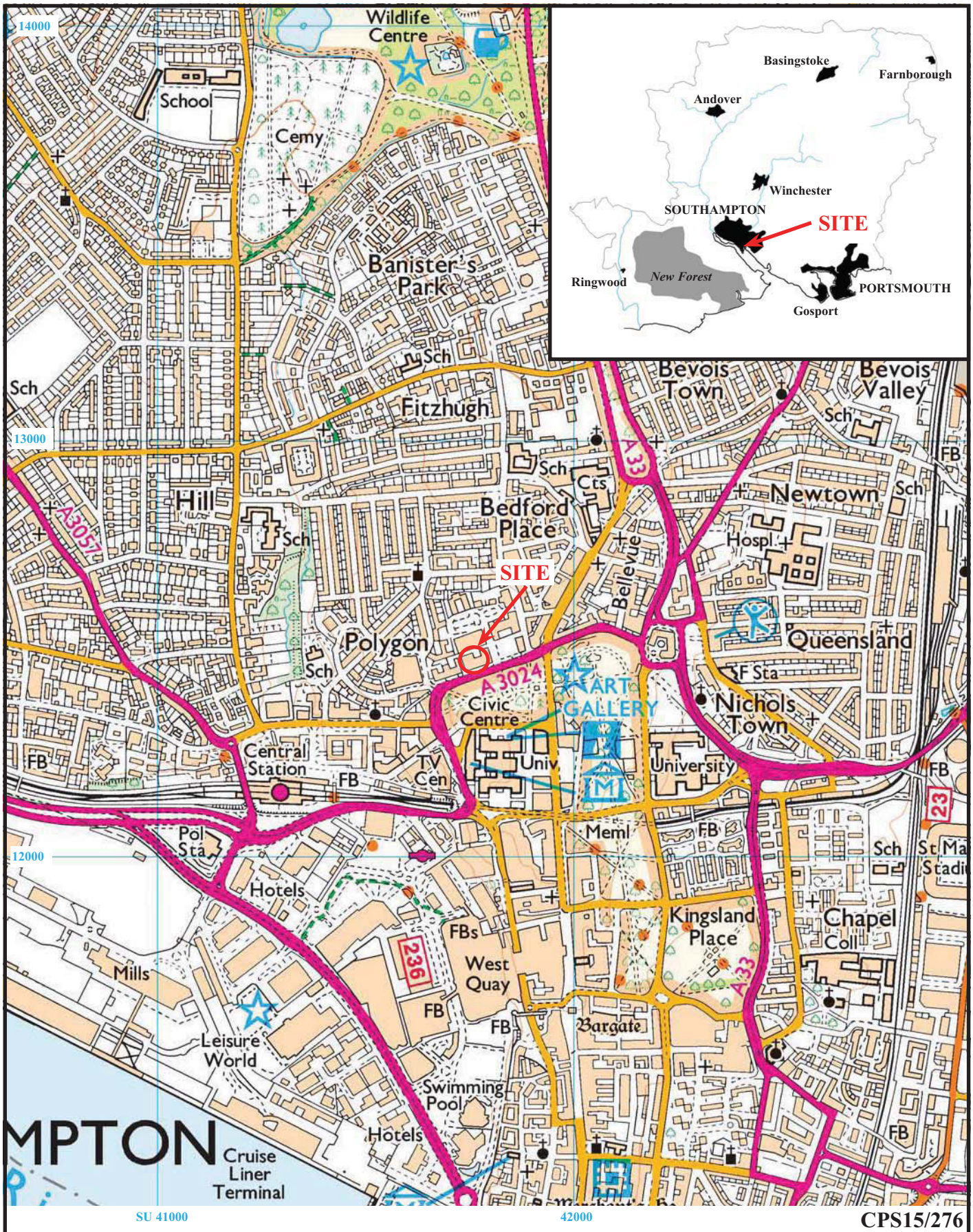

**Southampton Park Hotel, Cumberland Place,
Southampton, Hampshire
Archaeological Watching Brief**

Figure 1. Location of site within Southampton and Hampshire.

Reproduced from Ordnance Survey Explorer digital mapping at 1:12500
Ordnance Survey Licence 100025880

THAMES VALLEY
ARCHAEOLOGICAL
SERVICES

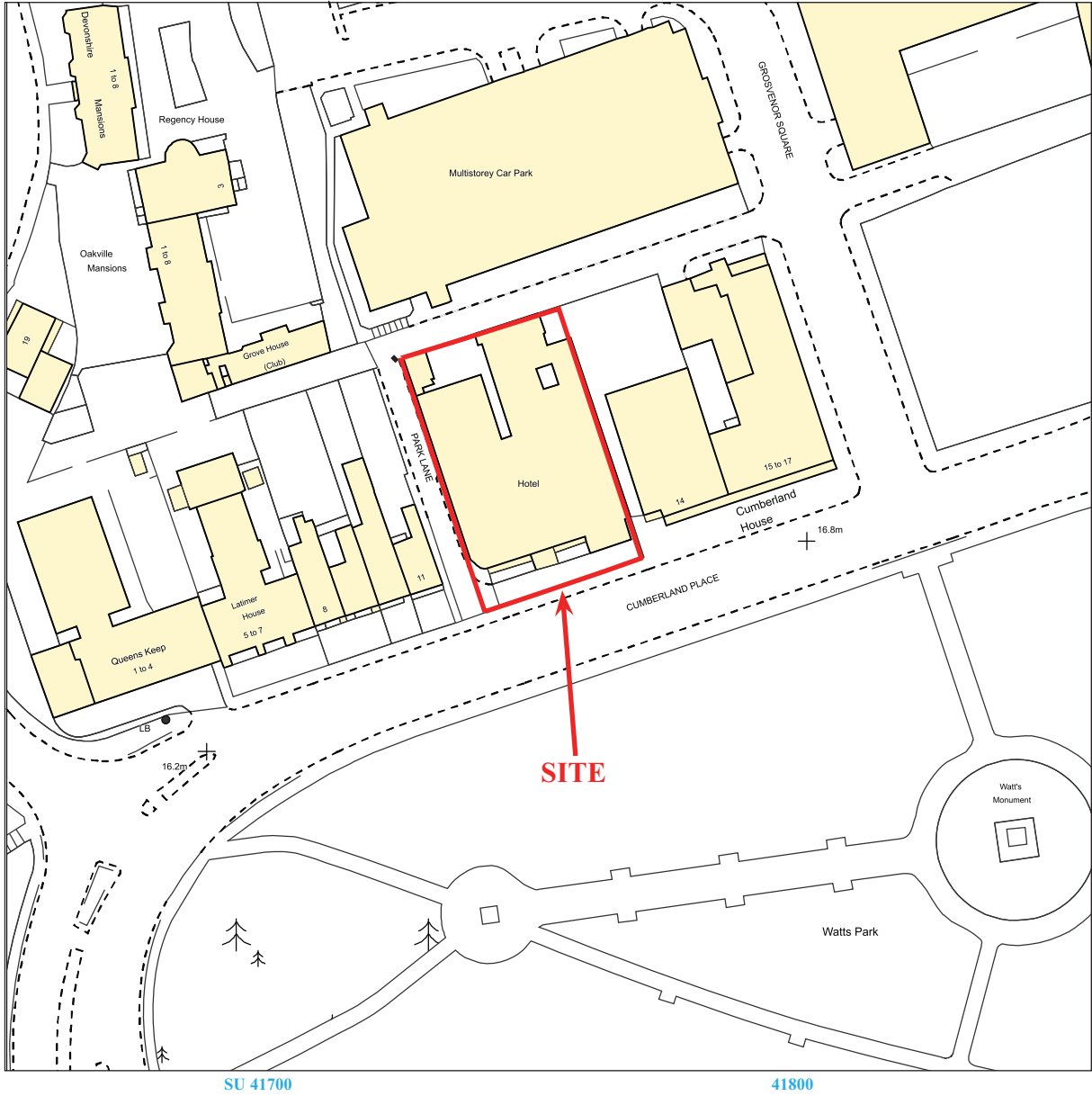

CPS15/276



**Southampton Park Hotel, Cumberland Place,
Southampton, Hampshire**
Archaeological Watching Brief
 Figure 2. Detailed location of site off Cumberland Place.

Reproduced from Ordnance Survey Digital Mapping under licence.
 Crown copyright reserved. Scale 1:1250

THAMES VALLEY
 ARCHAEOLOGICAL
 SERVICES

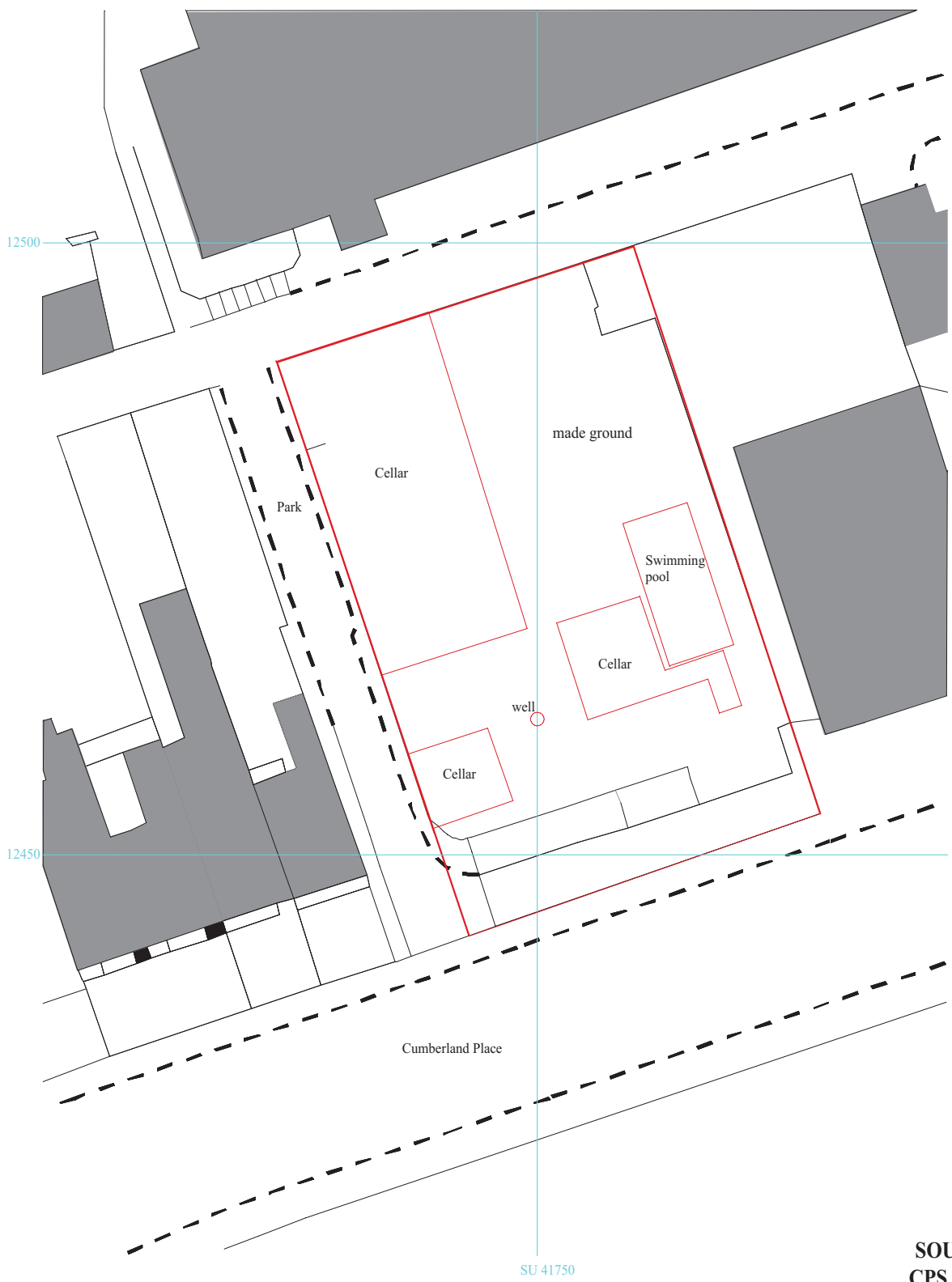

SOU 1723
CPS 15/276



**Southampton Park Hotel, Cumberland Place,
Southampton, Hampshire
Archaeological Watching Brief**

Figure 3. Location of observed area.





Plate 1. Site excavations, looking north east.



Plate 2. The cellar, looking west, Scales: 2m and 1m.



Plate 3. Stratigraphy adjacent to the cellar, looking north,
Scale: 2m.



Plate 4. Well 52, looking north west, Scale: 1m.

CPS15/276

**Southampton Park Hotel, Cumberland Place, Southampton
Hampshire
Archaeological Watching Brief
Plates 1 - 4.**

THAMES VALLEY
ARCHAEOLOGICAL
SERVICES

TIME CHART

	Calendar Years
Modern _____	AD 1901
Victorian _____	AD 1837
Post Medieval _____	AD 1500
Medieval _____	AD 1066
Saxon _____	AD 410
Roman _____	AD 43
Iron Age _____	BC/AD 750 BC
Bronze Age: Late -----	1300 BC
Bronze Age: Middle -----	1700 BC
Bronze Age: Early -----	2100 BC
Neolithic: Late	3300 BC
Neolithic: Early	4300 BC
Mesolithic: Late	6000 BC
Mesolithic: Early	10000 BC
Palaeolithic: Upper	30000 BC
Palaeolithic: Middle	70000 BC
Palaeolithic: Lower	2,000,000 BC



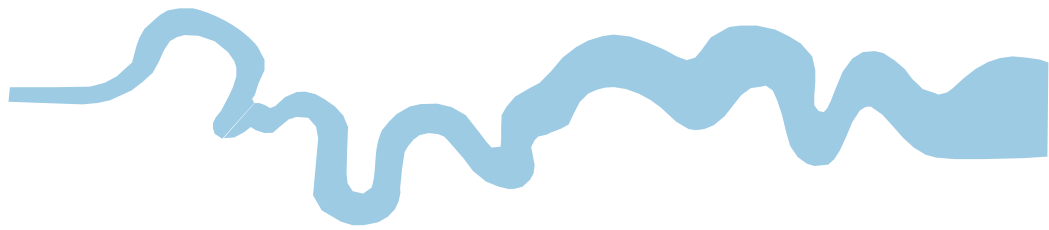

**Thames Valley Archaeological Services Ltd,
47-49 De Beauvoir Road, Reading,
Berkshire, RG1 5NR**

**Tel: 0118 9260552
Fax: 0118 9260553
Email: tvas@tvas.co.uk
Web: www.tvas.co.uk**