

OBSERVATIONS BY P BELLAMY	DATE 29/6/21	TIME ON SITE 9.00	TIME OFF SITE 14.30	TRAVELLING TIME
------------------------------	-----------------	----------------------	------------------------	-----------------

NOTES

SPOKE TO GRAHAM JACK (HAMMOUS) ABOUT NOT ALLOWING TRAFFIC IN & OUT OF SITE DURING RECORDING OF CELLARS. SET UP SAFETY TRIPOD & TESTED AIR QUALITY.

EXPLORED TWO ACCESSIBLE ROOMS OF CELLARS THEN PHOTOGRAPHED THE ROOMS & DETAIL

DRAW PLAN & ELEVATIONS OF CELLARS & MADE SOME NOTES ON DRAWINGS.

THE CELLARS CONSISTED OF A ROW OF BRICK-VAULTED ROOMS OF WHICH ONLY TWO NORTHERN CELLS ARE ACCESSIBLE. THE CELLS ARE NUMBERED 1-3 FROM N. CELL 3 IS BLOCKED BY CONCRETE INFILL. CELL 1 HAS A WINDOW OR WATCH IN W END BLOCKED BY CONCRETE BLOCKWORK. IN NW CORNER IS A BLOCKED OPENING IN TOP OF VAULT. ALONG N WALL IS A ROW OF 7 VATS BUILT OF BRICK WITH CEMENT RENDER. ANOTHER LARGE VAT ALONG S WALL. ALONG E WALL IS LOW TIMBER SHELF. A MODERN BRICK & CONCRETE PIER SUPPORTING VAULT IN NW PART. ROOM FULL OF RUBBLE & RUBBISH. OPENING IN E END OF S WALL LEADS TO CELL 2. MUCH OF CELL 2 IS FILLED WITH CONCRETE SPILLING OUT OF CELL 3 & A PILE OF ~~ASPHALT~~ ASPHALT & CONCRETE BENEATH MANHOLE ENTRY INTO CELLAR. ALSO PILES OF RUBBLE THROUGHOUT ROOM. THE W END OF CELL 2 HAS BEEN REBUILT IN CONCRETE BLOCKWORK. VAT ACROSS W END OF CELL 2

PLANNED LOCATION OF MANHOLE ENTRY TO CELLAR IN RELATION TO GATE PIERS.

SKETCH

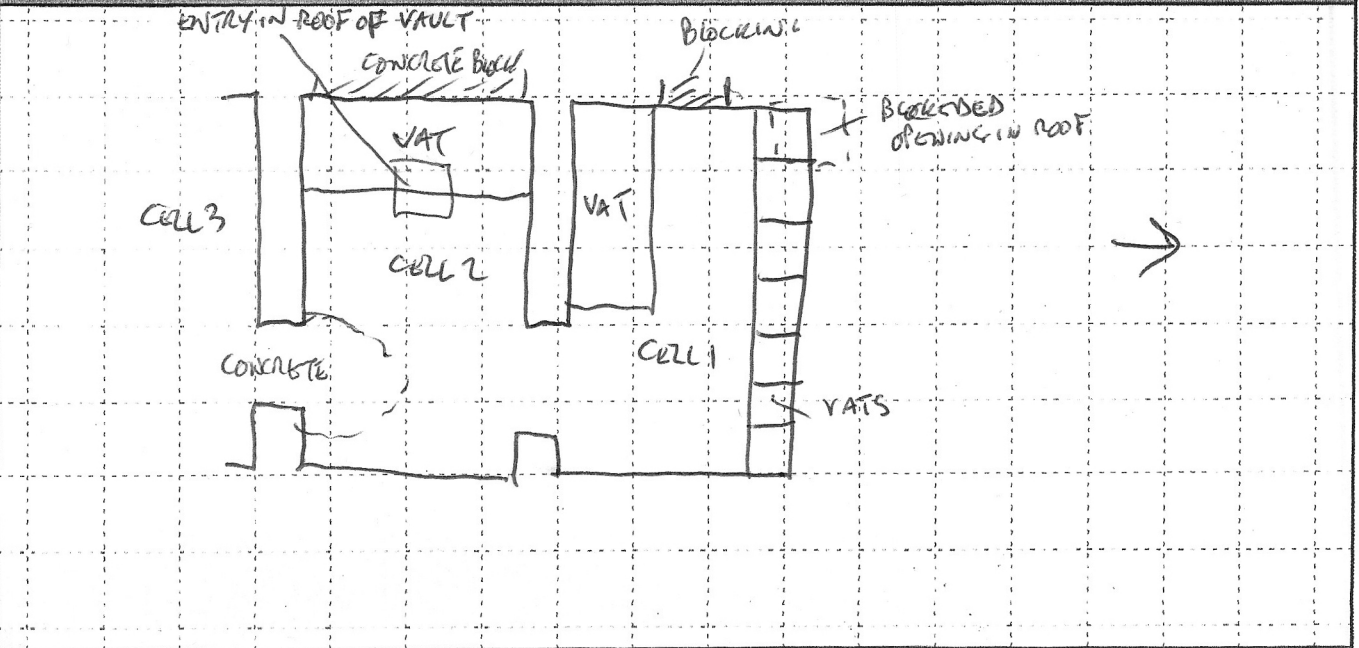



SITE NAME
CORN EXCHANGE EXTENSION,
NORTH SQUARE DORCHESTER

SITE CODE
53552

FIELD
NOTES

OBSERVATIONS BY
P BELLAMY

DATE
15/8/22

TIME ON SITE
14.15

TIME OFF SITE
15.30

TRAVELLING TIME

NOTES

CALLED TO SITE BY GRAHAM KICK (HAMMOUS) AS CONTRACTORS HAD DISCOVERED A LARGE HOLE WHEN LOCATING A DRAIN TRENCH. CAME DOWN TO SITE. A SMALL HOLE NEXT TO A MODERN DRAIN PIPE REVEALED A SLOPING CHUTE INTO A WELL. THE TOP OF THE WELL WAS TO BE EXPOSED TOMORROW MORNING IN ORDER TO FILL WELL ON ADVICE OF STRUCTURAL ENGINEER. AGREED TO COME BACK 2 RECORD TOMORROW

SKETCH

SITE NAME
CORN EXCHANGE EXTENSION,
NORTH SQUARE DOORCHESTER

SITE CODE
53522

FIELD
NOTES

OBSERVATIONS BY A BELLAMY	DATE 16/8/22	TIME ON SITE 8.00	TIME OFF SITE 10.00	TRAVELLING TIME
------------------------------	-----------------	----------------------	------------------------	-----------------

NOTES

PRESENT ON SITE WHILE THE CAR PARK SURFACE IS REMOVED TO EXPOSE THE WELL. THERE APPEARS TO BE A LIMESTONE FLAG SURFACE BELOW CAR PARK SURFACE WITH A LIMESTONE CAPPING BELOW THE WELL SHAFT IS OVOID & IRREGULAR & ABOUT 13m DEEP, CUT THROUGH THE CHALK BEDROCK. THERE IS A DRY STONE LINING ABOVE THE CHALK. THE UPPER PART APPEARS REBUILT WITH A SLOPING CHUTE ON W. SIDE WITH A MORTARED LIMESTONE LINING. THE WELL MAY BE MEDIEVAL IN ORIGIN OR POST-MEDIEVAL. IT APPEARS TO HAVE BEEN HEIGHTENED AND A CHUTE ADDED. ~~THE~~ PERHAPS IN RELATIONSHIP WITH THE CONSTRUCTION OF 19 CENT. MARKET HOUSE

SKETCH

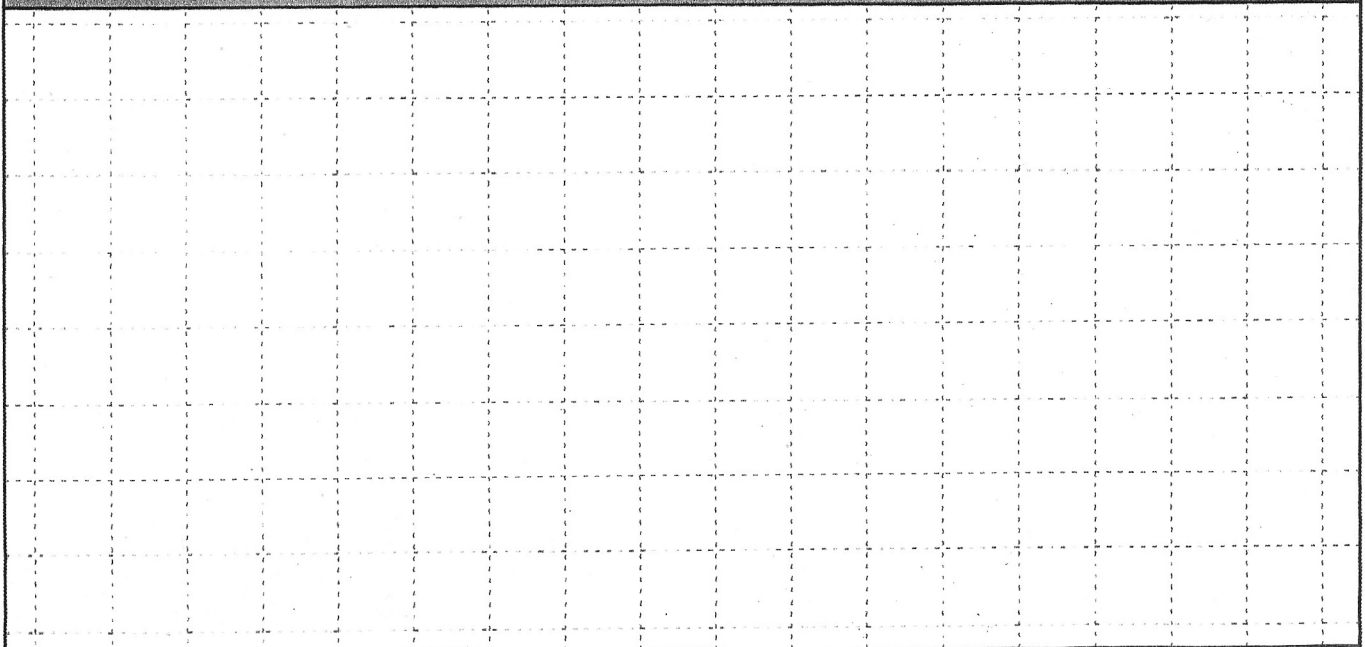



SITE NAME
 8 CORN EXCHANGE EXTENSION,
 NORTH SQUARE, DORCHESTER

SITE CODE
 53552

**CONTEXT
 RECORD**

SITE SUB-DIV 1 LAYER CUT GROUP CONTEXT NUMBER 101

CO-ORDINATES LENGTH WIDTH/DIAMETER THICKNESS/DEPTH 0.0-15m

DRAWINGS	PLANS 4	PHOTOS	BW
	SECTIONS		COLOUR
			DIGITAL 0080-0081

LAYER

CONSISTENCY	BELOW
COLOUR	CUT BY
TEXTURE	ABOVE 102
COARSE COMPONENTS	FILL OF

CUT

SHAPE IN PLAN	CUTS
SHAPE OF SIDES	
SHAPE OF BASE	
	FILLED WITH

OTHER

SUBDIVISION OF/SUBDIVIDED INTO	SAME AS 201
COMPONENT OF	COMPOSED OF

FINDS	
OBJECTS	
SAMPLES	

DESCRIPTION

GENERAL NUMBER GIVEN FOR ALL PILE LOCATIONS. THE TOP OF EACH PILE LOCATION WAS REMOVED. THIS ~~NUMBER~~ CONSISTED OF A TARMAK SURFACE OVER ORANGE HOGGING

INTERPRETATION

MODERN CAR PARK SURFACE



SITE NAME
CORN EXCHANGE EXTENSION,
NORTH SQUARE WORCHESTER

SITE CODE
53552

**CONTEXT
RECORD**

SITE SUB-DIV	1	LAYER	<input checked="" type="checkbox"/>	CUT	<input type="checkbox"/>	GROUP	<input type="checkbox"/>	CONTEXT NUMBER	102
--------------	---	-------	-------------------------------------	-----	--------------------------	-------	--------------------------	----------------	-----

CO-ORDINATES	LENGTH	WIDTH/DIAMETER	THICKNESS/DEPTH	C. 2.3-2.5m
--------------	--------	----------------	-----------------	-------------

DRAWINGS	PLANS	PHOTOS	B/W
	SECTIONS		COLOUR
			DIGITAL

LAYER

CONSISTENCY	Firm	BELOW	101
COLOUR	greyish-brown	CUT BY	
TEXTURE	CLAY LOAM	ABOVE	103, 104, 105
COARSE COMPONENTS	ABUNDANT SMALL CHALK, VERY ABUNDANT FLINT, LIMESTONE & CHALK RUBBLE	FILL OF	

CUT

SHAPE IN PLAN	CUTS
SHAPE OF SIDES	
SHAPE OF BASE	
FILLED WITH	

OTHER

SUBDIVISION OF/SUBDIVIDED INTO	SAME AS
COMPONENT OF	COMPOSED OF

FINDS	
OBJECTS	
SAMPLES	

DESCRIPTION

GENERAL NUMBER GIVEN FOR ALL RECORDED PILES. A THICK LAYER OF RUBBLE IN CHALKY SOIL

INTERPRETATION

NINETEENTH CENTURY TERRACING DEPOSITS FOR MARKET HOUSE



SITE NAME
CORN EXCHANGE EXTENSION,
NORTH SQUARE, DORCHESTER

SITE CODE
53552

CONTEXT RECORD

SITE SUB-DIV 1 LAYER CUT GROUP CONTEXT NUMBER 103

CO-ORDINATES LENGTH WIDTH/DIAMETER THICKNESS/DEPTH 0.3m

DRAWINGS
PLANS
SECTIONS

PHOTOS
BW
COLOUR
DIGITAL

LAYER

CONSISTENCY FRIABLE BELOW 102
COLOUR DARK GAYISH BROWN CUT BY
TEXTURE SILTY CLAY LOAM ABOVE 105, 106
COARSE COMPONENTS FILL OF

CUT

SHAPE IN PLAN CUTS
SHAPE OF SIDES FILLED WITH
SHAPE OF BASE

OTHER

SUBDIVISION OF/SUBDIVIDED INTO SAME AS
COMPONENT OF COMPOSED OF

FINDS

OBJECTS

SAMPLES

DESCRIPTION

GENERAL NUMBER GIVEN FOR ALL PILES A LAYER OF DARK HUMIC SOIL PRESENT ACROSS ALMOST ALL PILES. BELOW TERRACE DEPOSITS 102.

INTERPRETATION

POST-MEDIEVAL GARDEN SOIL.



SITE NAME
 CORN EXCHANGE EXTENSION
 NORTH SQUARE, DORCHESTER

SITE CODE
 53552

CONTEXT RECORD

SITE SUB-DIV	1	LAYER	<input checked="" type="checkbox"/>	CUT	<input type="checkbox"/>	GROUP	<input type="checkbox"/>	CONTEXT NUMBER	104
--------------	---	-------	-------------------------------------	-----	--------------------------	-------	--------------------------	----------------	-----

CO-ORDINATES	LENGTH	WIDTH/DIAMETER	THICKNESS/DEPTH	0.3m
--------------	--------	----------------	-----------------	------

DRAWINGS	PLANS	PHOTOS	BW
	SECTIONS		COLOUR
			DIGITAL

LAYER

CONSISTENCY	FIRM	BELOW	103, 102
COLOUR	MID REDDISH-BROWN	CUT BY	
TEXTURE	SILTY CLAY	ABOVE	105
COARSE COMPONENTS	FLINT NODULES	FILL OF	

CUT

SHAPE IN PLAN	CUTS
SHAPE OF SIDES	
SHAPE OF BASE	
	FILLED WITH

OTHER

SUBDIVISION OF/SUBDIVIDED INTO	SAME AS
COMPONENT OF	COMPOSED OF

FINDS	
OBJECTS	
SAMPLES	

DESCRIPTION

LAYER OBSERVED IN PILES 13 & 14

INTERPRETATION

POSSIBLY SURVIVING REMNANT OF PRE-URBAN SOIL?



SITE NAME
CORN EXCHANGE EXTENSION,
NORTON SQUARE, DORCHESTER

SITE CODE
53552

**CONTEXT
RECORD**

SITE SUB-DIV 1 LAYER CUT GROUP CONTEXT NUMBER 105

CO-ORDINATES LENGTH WIDTH/DIAMETER THICKNESS/DEPTH

DRAWINGS	PLANS	PHOTOS	B/W
	SECTIONS		COLOUR
			DIGITAL

LAYER

CONSISTENCY	HARD	BELOW	104, 103
COLOUR	WHITE	CUT BY	
TEXTURE	CHALK BEDROCK	ABOVE	
COARSE COMPONENTS		FILL OF	

CUT

SHAPE IN PLAN	CUTS
SHAPE OF SIDES	
SHAPE OF BASE	
	FILLED WITH

OTHER

SUBDIVISION OF/ SUBDIVIDED INTO	SAME AS
COMPONENT OF	COMPOSED OF

FINDS	
OBJECTS	
SAMPLES	

DESCRIPTION

NUMBER GIVEN TO CHALK REVEALED IN ALL OBSERVED PILES

INTERPRETATION

NATURAL CHALK BEDROCK



SITE NAME
 CORN EXCHANGE EXTENSION
 NORTH SQUARE, DORCHESTER

SITE CODE
 53552

CONTEXT RECORD

SITE SUB-DIV 1	LAYER <input checked="" type="checkbox"/>	CUT <input type="checkbox"/>	GROUP <input type="checkbox"/>	CONTEXT NUMBER 106
----------------	---	------------------------------	--------------------------------	--------------------

CO-ORDINATES	LENGTH	WIDTH/DIAMETER	THICKNESS/DEPTH
--------------	--------	----------------	-----------------

DRAWINGS	PLANS	PHOTOS	B/W
	SECTIONS		COLOUR
			DIGITAL

LAYER

CONSISTENCY	FIRM	BELOW	103
COLOUR	PALE YELLOW / CREAM TO PALE BROWN	CUT BY	
TEXTURE	CHALK	ABOVE	105
COARSE COMPONENTS		FILL OF	

CUT

SHAPE IN PLAN	CUTS
SHAPE OF SIDES	
SHAPE OF BASE	
	FILLED WITH

OTHER

SUBDIVISION OF/ SUBDIVIDED INTO	SAME AS
COMPONENT OF	COMPOSED OF

FINDS	
OBJECTS	
SAMPLES	

DESCRIPTION

COARSE ROCK DEPOSITS SEEN IN ALES 1 & 9

INTERPRETATION

DEGRADED NATURAL CHALK



SITE NAME
CORNER EXCHANGE EXTENSION
NORTH SQUARE, BORCHOSTER

SITE CODE
53552

CONTEXT RECORD

SITE SUB-DIV 2 LAYER CUT GROUP CONTEXT NUMBER 201

CO-ORDINATES LENGTH WIDTH/DIAMETER THICKNESS/DEPTH 0.12

DRAWINGS	PLANS	PHOTOS	B/W
	SECTIONS 6		COLOUR
			DIGITAL 0671 - 0676

LAYER

CONSISTENCY	BELOW
COLOUR	CUT BY
TEXTURE	ABOVE 202
COARSE COMPONENTS	FILL OF

CUT

SHAPE IN PLAN	CUTS
SHAPE OF SIDES	FILLED WITH
SHAPE OF BASE	

OTHER

SUBDIVISION OF/SUBDIVIDED INTO	SAME AS
COMPONENT OF	COMPOSED OF

FINDS	
OBJECTS	
SAMPLES	

DESCRIPTION

TARMAK OVER ORANGE HOBBING

INTERPRETATION

CAR PARK SURFACE



SITE NAME
CORNER EXCHANGE EXTENSION
NORTH SQUARE, DORCHESTER

SITE CODE
53552

**CONTEXT
RECORD**

SITE SUB-DIV 2 LAYER CUT GROUP CONTEXT NUMBER 202

CO-ORDINATES LENGTH WIDTH/DIAMETER THICKNESS/DEPTH 0.07m

DRAWINGS	PLANS	PHOTOS	B/W
	SECTIONS <u>6</u>		COLOUR
			DIGITAL <u>0671-0676</u>

LAYER

CONSISTENCY	BELOW <u>201</u>
COLOUR	CUT BY
TEXTURE	ABOVE <u>203</u>
COARSE COMPONENTS	FILL OF

CUT

SHAPE IN PLAN	CUTS FILLED WITH
SHAPE OF SIDES	
SHAPE OF BASE	

OTHER

SUBDIVISION OF/ SUBDIVIDED INTO	SAME AS
COMPONENT OF	COMPOSED OF

FINDS	
OBJECTS	
SAMPLES	

DESCRIPTION

LAYER OF LIMESTONE FLAGS - ONLY SEEN WHERE BROKEN OUT TO EXPOSE WELL. NOT SEEN IN PLAN.

INTERPRETATION

POSSIBLE FLOOR OF 19TH CENT. MARKET HOUSE



SITE NAME
CORNER EXCHANGE EXTENSION
NORTH SQUARE, DORCHESTER

SITE CODE
53552

CONTEXT RECORD

SITE SUB-DIV 2

LAYER

CUT

GROUP

CONTEXT NUMBER 203

CO-ORDINATES

LENGTH

WIDTH/DIAMETER

THICKNESS/DEPTH 0.12m

DRAWINGS
PLANS
SECTIONS 6

PHOTOS
BW
COLOUR
DIGITAL 0671-0676

LAYER

CONSISTENCY Firm

BELOW 202

COLOUR MID GREYISH - BROWN

CUT BY

TEXTURE CLAY LOAM

ABOVE 204

COARSE COMPONENTS VERY ABUNDANT SMALL CHALK LUMPS

FILL OF

CUT

SHAPE IN PLAN

CUTS

SHAPE OF SIDES

FILLED WITH

SHAPE OF BASE

OTHER

SUBDIVISION OF/ SUBDIVIDED INTO

SAME AS

COMPONENT OF

COMPOSED OF

FINDS

OBJECTS

SAMPLES

DESCRIPTION

INTERPRETATION

LEVELLING LAYER OVER WELLS CAPING 204 OR BEDDING FOR STONE FLAGS 202.

SHEET OF

NAME PB

DATE 16/8/77



SITE NAME
 CORN EXCHANGE EXTENSION
 NORTH SQUARE, DORCHESTER

SITE CODE
 5355Z

CONTEXT RECORD

SITE SUB-DIV **2** LAYER CUT GROUP CONTEXT NUMBER **204**

CO-ORDINATES LENGTH WIDTH/DIAMETER THICKNESS/DEPTH **0.07m**

DRAWINGS PLANS SECTIONS **6**

PHOTOS B/W COLOUR DIGITAL **0671 - 0676**

LAYER

CONSISTENCY BELOW **203**
 COLOUR CUT BY
 TEXTURE ABOVE **207**
 COARSE COMPONENTS FILL OF

CUT

SHAPE IN PLAN CUTS
 SHAPE OF SIDES FILLED WITH
 SHAPE OF BASE

OTHER

SUBDIVISION OF/SUBDIVIDED INTO SAME AS
 COMPONENT OF COMPOSED OF

FINDS
 OBJECTS
 SAMPLES

DESCRIPTION

FLAT LIMESTONE SLABS COVERING WELL 205 & CHUTE 206
 BROKEN OUT TO EXPOSE WELL & NOT SEEN IN SITU.

INTERPRETATION

WELL CAPING



SITE NAME COIN EXCHANGE EXTENSION NORTH SQUARE, DORCHESTER	SITE CODE 53552	CONTEXT RECORD
--	--------------------	---------------------------

SITE SUB-DIV 2	LAYER <input type="checkbox"/>	CUT <input checked="" type="checkbox"/>	GROUP <input type="checkbox"/>	CONTEXT NUMBER 205
-------------------	--------------------------------	---	--------------------------------	-----------------------

CO-ORDINATES	LENGTH	WIDTH/DIAMETER c. 1.0m	THICKNESS/DEPTH 13m
--------------	--------	---------------------------	------------------------

DRAWINGS	PLANS 5	PHOTOS	B/W
	SECTIONS 6		COLOUR
			DIGITAL 0677 - 0697

LAYER	
CONSISTENCY	BELOW
COLOUR	CUT BY
TEXTURE	ABOVE
COARSE COMPONENTS	FILL OF

CUT	
SHAPE IN PLAN CIRCULAR TO OVOID	CUTS 209
SHAPE OF SIDES VERTICAL	FILLED WITH 207, 208
SHAPE OF BASE NOT SEEN	

OTHER	
SUBDIVISION OF/ SUBDIVIDED INTO	SAME AS
COMPONENT OF	COMPOSED OF

FINDS	
OBJECTS	
SAMPLES	

DESCRIPTION
SLIGHTLY IRREGULAR ALMOST CIRCULAR SHAFT CUT INTO NATURAL CHALK.

INTERPRETATION
CUT FOR WELL - POSSIBLY MEDIEVAL IN DATE

SHEET	OF	NAME PB	DATE 16/8/22
-------	----	------------	-----------------



SITE NAME
CORNER EXCHANGE EXTENSION
NORTH SQUARE, DORCHESTER

SITE CODE
53552

CONTEXT RECORD

SITE SUB-DIV 2	LAYER <input type="checkbox"/>	CUT <input checked="" type="checkbox"/>	GROUP <input type="checkbox"/>	CONTEXT NUMBER 206
----------------	--------------------------------	---	--------------------------------	--------------------

CO-ORDINATES	LENGTH	WIDTH/DIAMETER	THICKNESS/DEPTH
--------------	--------	----------------	-----------------

DRAWINGS	PLANS 5	PHOTOS	B/W
	SECTIONS 6		COLOUR
			DIGITAL 0680 - 0697

LAYER

CONSISTENCY	BELOW
COLOUR	CUT BY
TEXTURE	ABOVE
COARSE COMPONENTS	FILL OF

CUT

SHAPE IN PLAN	CUTS 209? 207
SHAPE OF SIDES	
SHAPE OF BASE	FILLED WITH 207

OTHER

SUBDIVISION OF/SUBDIVIDED INTO	SAME AS
COMPONENT OF	COMPOSED OF

FINDS	
OBJECTS	
SAMPLES	

DESCRIPTION

SLOPING CUT ON W SIDE OF WELL 205. APPEARS TO CUT THE TERRACING DEPOSITS FOR MARKET HOUSE (NOT EXPOSED). LINED WITH BORTACED STONE RUBBLE 207.

INTERPRETATION

CUT FOR CHUTE. CHUTE MAY HAVE BEEN ADDED TO CONVERT WELL INTO A SOARAWAI IN THE MARKET HOUSE

SHEET	OF	NAME	PB	DATE	16/9/27
-------	----	------	----	------	---------



SITE NAME
 CORN EXCHANGE EXTENSION
 NORTH SQUARE, DORCHESTER

SITE CODE
 53552

CONTEXT RECORD

SITE SUB-DIV **2** LAYER CUT GROUP CONTEXT NUMBER **207**

CO-ORDINATES LENGTH WIDTH/DIAMETER THICKNESS/DEPTH

DRAWINGS	PLANS	5	PHOTOS	B/W	
	SECTIONS	6		COLOUR	
				DIGITAL	0677 - 0697

LAYER

CONSISTENCY	CEMENTED	BELOW	204
COLOUR	PALE GREY	CUT BY	
TEXTURE	LIME MORTAR	ABOVE	208
COARSE COMPONENTS	LIMESTONE RUBBLE	FILL OF	205 206

CUT

SHAPE IN PLAN	CUTS
SHAPE OF SIDES	
SHAPE OF BASE	
FILLED WITH	

OTHER

SUBDIVISION OF/SUBDIVIDED INTO	SAME AS
COMPONENT OF	COMPOSED OF

FINDS
 OBJECTS
 SAMPLES

DESCRIPTION

MORTARED LIMESTONE RUBBLE LINING OF UPPER 0.9-1.0M OF WELL ²⁰⁵ AND ALSO AROUND SIDES & ONE BASE OF CHUTE 206. RUBBLE INCLUDES SOME SQUARED STONE RUBBLE

INTERPRETATION

LINING AROUND POSSIBLE EXTENSION OF WELL UPWARDS FOLLOWING TERRACING FOR MARKET HOUSE. ALSO LINES CHUTE 206.



SITE NAME
CORN EXCHANGE EXTENSION
NORTH SQUARE, DORCHESTER

SITE CODE
53552

CONTEXT RECORD

SITE SUB-DIV 2 LAYER CUT GROUP CONTEXT NUMBER 208

CO-ORDINATES LENGTH WIDTH/DIAMETER THICKNESS/DEPTH

DRAWINGS PLANS SECTIONS 6 PHOTOS B/W COLOUR DIGITAL 0677-0671, 0682-0684, 0694-0697

LAYER

CONSISTENCY BELOW 207
COLOUR CUT BY
TEXTURE ABOVE 209
COARSE COMPONENTS FILL OF 205

CUT

SHAPE IN PLAN SHAPES OF SIDES SHAPES OF BASE CUTS FILLED WITH

OTHER

SUBDIVISION OF/SUBDIVIDED INTO SAME AS COMPONENT OF COMPOSED OF

FINDS OBJECTS SAMPLES

DESCRIPTION

DRYSTONE LIMESTONE RUBBLE LINING OF WELL SHAFT 205 IT LIES AT A DEPTH OF 0.9 - 1.8m BELOW TOP OF WELL. THE LINING HAS BULGED INWARDS BELOW CHUTE 206.

INTERPRETATION

ORIGINAL STEYNING FOR WELL 205?



SITE NAME
 CORN EXCHANGE EXTENSION
 NORTH SQUARE, DORCHESTER

SITE CODE
 53552

CONTEXT RECORD

SITE SUB-DIV **2** LAYER CUT GROUP CONTEXT NUMBER **209**

CO-ORDINATES LENGTH WIDTH/DIAMETER THICKNESS/DEPTH

DRAWINGS	PLANS	PHOTOS	BW
	SECTIONS 6		COLOUR
			DIGITAL 0677-0679, 0682-0684 0694-0697

LAYER

CONSISTENCY	BELOW 208
COLOUR	CUT BY 205
TEXTURE	ABOVE
COARSE COMPONENTS	FILL OF

CUT

SHAPE IN PLAN	CUTS
SHAPE OF SIDES	
SHAPE OF BASE	
FILLED WITH	

OTHER

SUBDIVISION OF/SUBDIVIDED INTO	SAME AS
COMPONENT OF	COMPOSED OF

FINDS	
OBJECTS	
SAMPLES	

DESCRIPTION

CHALK BEDROCK EXPOSED IN WELL SHAFT 205. WORN SURFACE AT 1.8 m BELOW TOP OF WELL.

INTERPRETATION

CHALK BEDROCK EXPOSED BY WELL 205

CAMERA NIKON D5000

DIGITAL

IMAGE No.	ARCHIVE No.	SITE SUB DIV.	DESCRIPTION	SCALES	VIEW FROM	INIT. DATE
0184		CELLAR	DETAIL OF VAT IN NE CORNER CELL 1	1m	S	PB 29/6/21
0185	010	"	" " " " " "	"	S	" "
0186	011	"	W END OF CELL 1	1m	E	" "
0187		"	" " " "	"	E	" "
0188		"	" " " "	"	E	" "
0189		"	" " " "	"	E	" "
0190	012	"	" " " "	"	E	" "
0191	013	"	BLOCKED OPENING IN W WALL OF CELL 1	-	E	" "
0192		"	" " " " " "	-	E	" "
0193		"	DETAIL OF BLOCKED OPENING IN VAULT, NW CORNER CELL 1		S	" "
0194		"	" " " " " "	-	S	" "
0195	014	"	" " " " " "	-	S	" "
0196		"	" " " " " "	-	S	" "
0197		"	DETAIL OF NW CORNER, CELL 1	-	SE	" "
0198	015	"	" " " " " "	-	SE	" "
0199		"	VAT ON S SIDE OF CELL 1	1m	NE	" "
0200	016	"	" " " " " "	"	NE	" "
0201	018	"	" " " " " "	"	NE	" "
0202	017	"	VIEW FROM CELL 1 INTO CELL 2	1m	N	" "
0203		"	" " " " " "	"	N	" "
0204		"	DETAIL OF FITTINGS ON WALL NE OF CELL 1	-	W	" "
0205	018	"	" " " " " "	-	W	" "
0206	019	"	DETAIL OF HOLE IN E SIDE OF DOORWAY	-	W	" "
0207		"	" " " " " "	-	W	" "
0208		"	DETAIL OF HOLE IN W SIDE OF DOORWAY	-	E	" "
0209	020	"	" " " " " "	-	E	" "
0210		"	E END OF CELL 2	-	W	" "
0211		"	" " " " " "	-	W	" "
0212		"	DETAIL OF BLOCKING OF CELL 3	-	W	" "
0213	021	"	" " " " " "	-	W	" "
0214	022	"	DETAIL OF BRICK FLOOR IN CELL 2	-	N	" "
0215		"	" " " " " "	-	N	" "
0216		"	MODERN BLOCKING IN W END OF CELL 2	-	E	" "
0217	023	"	" " " " " "	-	E	" "
0218	024	"	VAT IN W END OF CELL 2	-	W	" "
0219		"	" " " " " "	-	W	" "
0220		"	" " " " " "	-	W	" "
0221		"	" " " " " "	-	W	" "
0222		"	S END OF CELL 2 W END BLOCKING	-	E	" "

CAMERA	NIKON D5000	DIGITAL
--------	-------------	---------

IMAGE No.	ARCHIVE No.	SITE SUB DIV.	DESCRIPTION	SCALES	VIEW FROM	INIT. DATE
0223	025	CELLAR	DETAIL BLOCKING S SIDE W END CELL 2	—	E	PB 29/6/21
0224	026	"	DETAIL BLOCKING N SIDE W END CELL 2	—	E	" "
0225		"	" — " — " — "	—	E	" "
0226		"	" — " — " — "	—	E	" "
0227	027	"	E END OF CELL 2	—	W	" "
0228		"	" — " — "	—	W	" "
0229		"	DETAIL OF ACCESS HATCH INTO CELL 2	—	E	" "
0230	028	"	" — " — " — "	—	E	" "
0231		"	NW PART OF CELL 1 WITH MOD. BRICK PIERS	—	SE	" "
0232	029	"	" — " — " — "	—	SE	" "
0233		"	" — " — " — "	—	SE	" "
0234		"	" — " — " — "	—	SE	" "
0235		"	VATS ALONG N SIDE CELL 1	—	S	" "
0236		"	" — " — " — "	—	S	" "
0237		"	" — " — " — "	—	S	" "
0238		"	" — " — " — "	—	S	" "
0239		"	" — " — " — "	—	S	" "
0240	030	"	VAT ON S SIDE CELL 1	—	E	" "
0241		"	" — " — " — "	—	E	" "
////	////	////	////	////	////	////
0080		1	GENERAL VIEW OF PILING	—	NW	PB 27/10/21
0081		1	PILE 4 " — " — "	—	E	" "
0082		1	PILE 1	—	E	" "
0083		1	PILE 2	—	E	" "
0084		1	PILE 5	—	E	" "
0085		1	DRILLING PILE 6	—	E	" "
0086		1	PILE 6	—	NE	" "
0087		1	PILE 7	—	NE	" "
0088		1	PILE 9	—	NE	" "
0089		1	PILE 10	—	E	" "
0090		1	PILE 11	—	W	" "
0091		1	PILE 12	—	W	" "
0092		1	PILE 13	—	W	" "
0093		1	PILE 14	—	W	" "
0094		1	DRILLING PILE 15	—	NE	" "
0095		1	PILE 16	—	W	" "
0096		1	DRILLING OF PILE 16	—	W	" "
0097		1	DRILLED PILES FOR NEW EXTENSION	—	NW	" "
0098		1	" — " — " — "	—	N	" "

CAMERA	NIKON D5000	DIGITAL
--------	-------------	---------

IMAGE No.	ARCHIVE No.	SITE SUB DIV.	DESCRIPTION	SCALES	VIEW FROM	INIT. DATE
0661		2	INITIAL DISCOVERY OF WELL	-	E	PB 15/8/22
0662		2	LOCATION VIEW OF WELL	-	S	" "
0663		2	" " " "	-	N	" "
0664		2	VIEWS DOWN CHUTE INTO WELL	-	W	" "
0665		2	" " " "	-	W	" "
0666		2	" " " "	-	W	" "
0667		2	" " " "	-	W	" "
0668		2	" " " "	-	W	" "
0669		2	" " " "	-	W	" "
0670		2	" " " "	-	W	" "
0671		2	BREAKING OUT TOP OF WELL	-	W	PB 16/8/22
0672		2	" " " "	-	W	PB 16/8/22
0673		2	" " " "	-	W	" "
0674		2	VIEW OF WELL & CHUTE	-	W	" "
0675		2	" " " "	-	SW	" "
0676		2	" " " "	-	E	" "
0677		2	VIEW DOWN WELL SHAFT	-	-	" "
0678		2	" " " "	-	-	" "
0679		2	" " " "	-	-	" "
0680		2	CHUTE	-	E	" "
0681		2	WELL & CHUTE	-	SE	" "
0682		2	" "	-	SW	" "
0683		2	" "	-	W	" "
0684		2	" "	-	W	" "
0685		2	" "	-	E	" "
0686		2	DETAIL OF CHUTE	-	E	" "
0687		2	" "	-	E	" "
0688		2	WELL & CHUTE	-	E	" "
0689		2	" "	-	S	" "
0690		2	" "	-	W	" "
0691		2	" "	-	W	" "
0692		2	" "	-	N	" "
0693		2	" "	-	W	" "
0694		2	" "	-	W	" "
0695		2	" "	-	S	" "
0696		2	WELL SHAFT	-	N	" "
0697		2	WELL SHAFT	-	N	" "
0698						

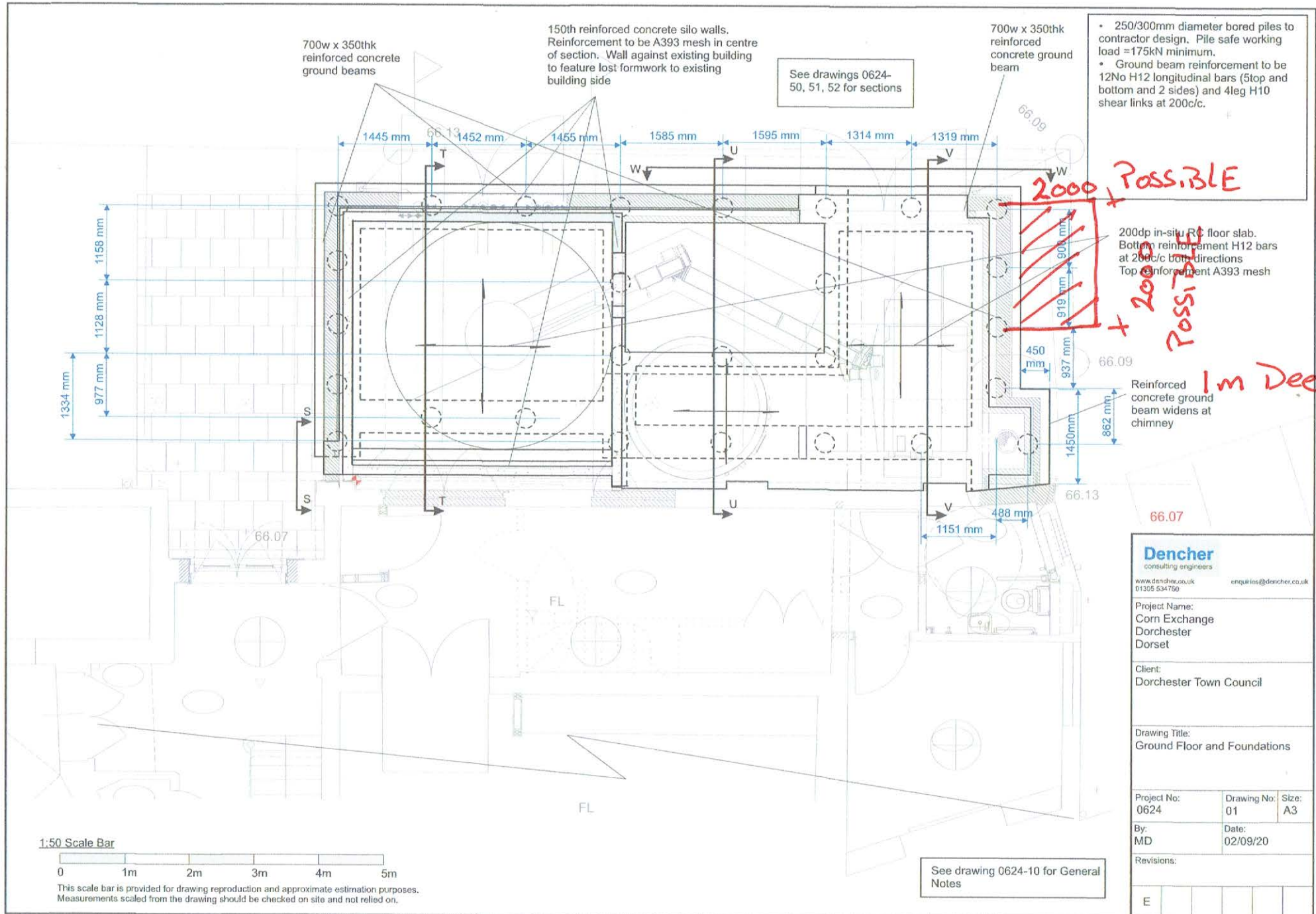

700w x 350thk reinforced concrete ground beams

150th reinforced concrete silo walls. Reinforcement to be A393 mesh in centre of section. Wall against existing building to feature lost formwork to existing building side

See drawings 0624-50, 51, 52 for sections

700w x 350thk reinforced concrete ground beam

- 250/300mm diameter bored piles to contractor design. Pile safe working load = 175kN minimum.
- Ground beam reinforcement to be 12No H12 longitudinal bars (5top and bottom and 2 sides) and 4leg H10 shear links at 200c/c.

2000 POSSIBLE

200dp in-situ RC floor slab. Bottom reinforcement H12 bars at 200c/c both directions. Top reinforcement A393 mesh

+ 2000 POSSIBLE

1m Deep?

Reinforced concrete ground beam widens at chimney

66.07

Dencher
consulting engineers
www.dencher.co.uk enquiries@dencher.co.uk
01305 534760

Project Name:
Corn Exchange
Dorchester
Dorset

Client:
Dorchester Town Council

Drawing Title:
Ground Floor and Foundations

Project No: 0624 Drawing No: 01 Size: A3

By: MD Date: 02/09/20

Revisions:

E			
---	--	--	--

See drawing 0624-10 for General Notes

1:50 Scale Bar



This scale bar is provided for drawing reproduction and approximate estimation purposes. Measurements scaled from the drawing should be checked on site and not relied on.

