

Reproduced from Ordnance Survey's 1:25 000 map of 1998 with the permission of the controller of Her Majesty's Stationery Office. Crown Copyright reserved. Licence No: AL 50125A
 Licensee:
 Stratascan Ltd.
 Vineyard House
 Upper Hook Road
 Upton Upon Severn
 WR8 0SA
 OS 100km square = TL



41
40
39
38
37



Survey Area

04 05 06 07 08

Amendments

Issue No.	Date	Description
-	-	-
-	-	-

© Stratascan Ltd - ----

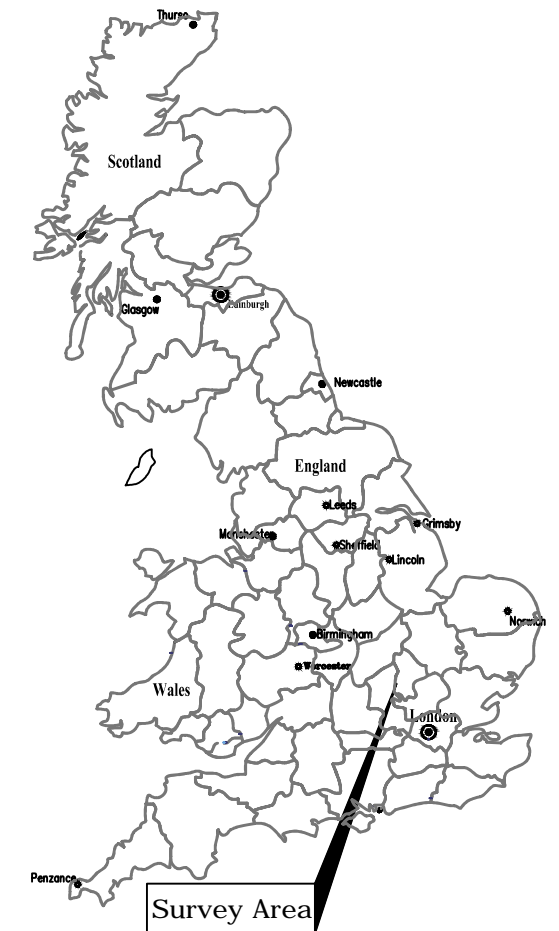

Site centred on NGR TL 061 394

Client
ALBION ARCHAEOLOGY

Project Title Job No. J7431
LAND SOUTH OF NORTH LIMBERSEY FARM, MAULDEN, BEDFORDSHIRE

Subject
LOCATION PLAN OF SURVEY AREA

STRATASCAN™
 GEOPHYSICS FOR ARCHAEOLOGY AND ENGINEERING
 VINEYARD HOUSE T: 01684 592266
 UPTON UPON SEVERN E: info@stratascan.co.uk
 WR8 0SA www.stratascan.co.uk



SUMO GROUP MEMBER



Scale 1:25000 0m 500m 1000m

Plot A3	Checked by DGE	Issue No. 01
Survey date SEPT 14	Drawn by TR	Figure No. 01

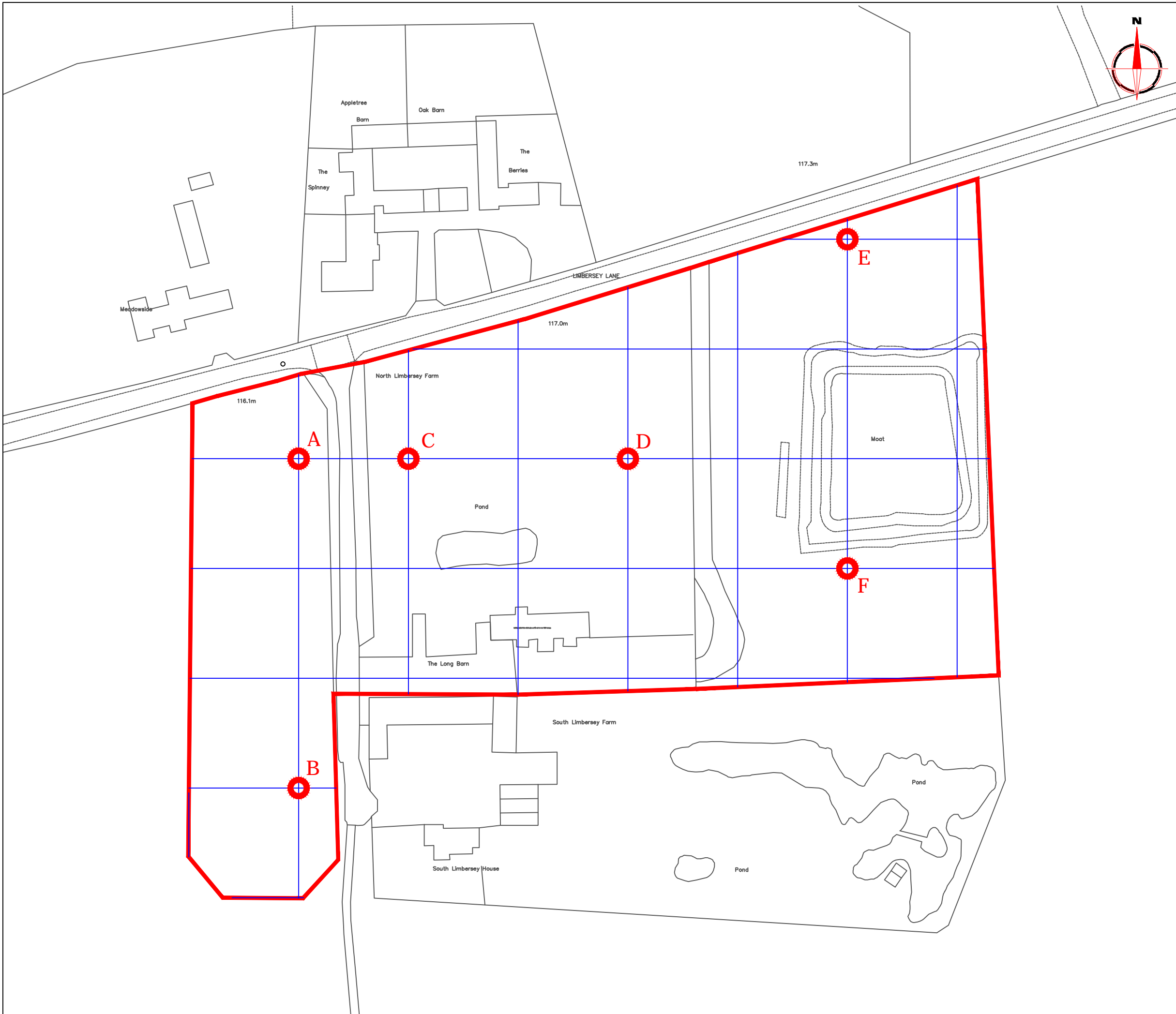

Amendments

Issue No.	Date	Description
-	-	-
-	-	-

© Stratascan Ltd - ----

OS GRID REFERENCES

A	506001.52, 239409.87
B	506001.52, 239319.87
C	506031.52, 239409.87
D	506091.52, 239409.87
E	506151.52, 239469.87
F	506151.52, 239379.87

Client
ALBION ARCHAEOLOGY

Project Title Job No. J7431
LAND SOUTH OF NORTH LIMBERSEY FARM, MAULDEN, BEDFORDSHIRE

Subject
LOCATION OF SURVEY GRIDS AND REFERENCING

STRATASCAN™
GEOPHYSICS FOR ARCHAEOLOGY AND ENGINEERING
VINEYARD HOUSE T: 01684 592266
UPTON UPON SEVERN E: info@stratascan.co.uk
WR8 0SA www.stratascan.co.uk

EUROPEAN GPR ASSOCIATION
SUMO GROUP MEMBER
ims ISO 9001 certified
ims ISO 14001 certified

Scale 1: 1000
0m 10 20 30 40 50

Plot A3	Checked by DGE	Issue No. 01
Survey date SEPT 14	Drawn by TR	Figure No. 02

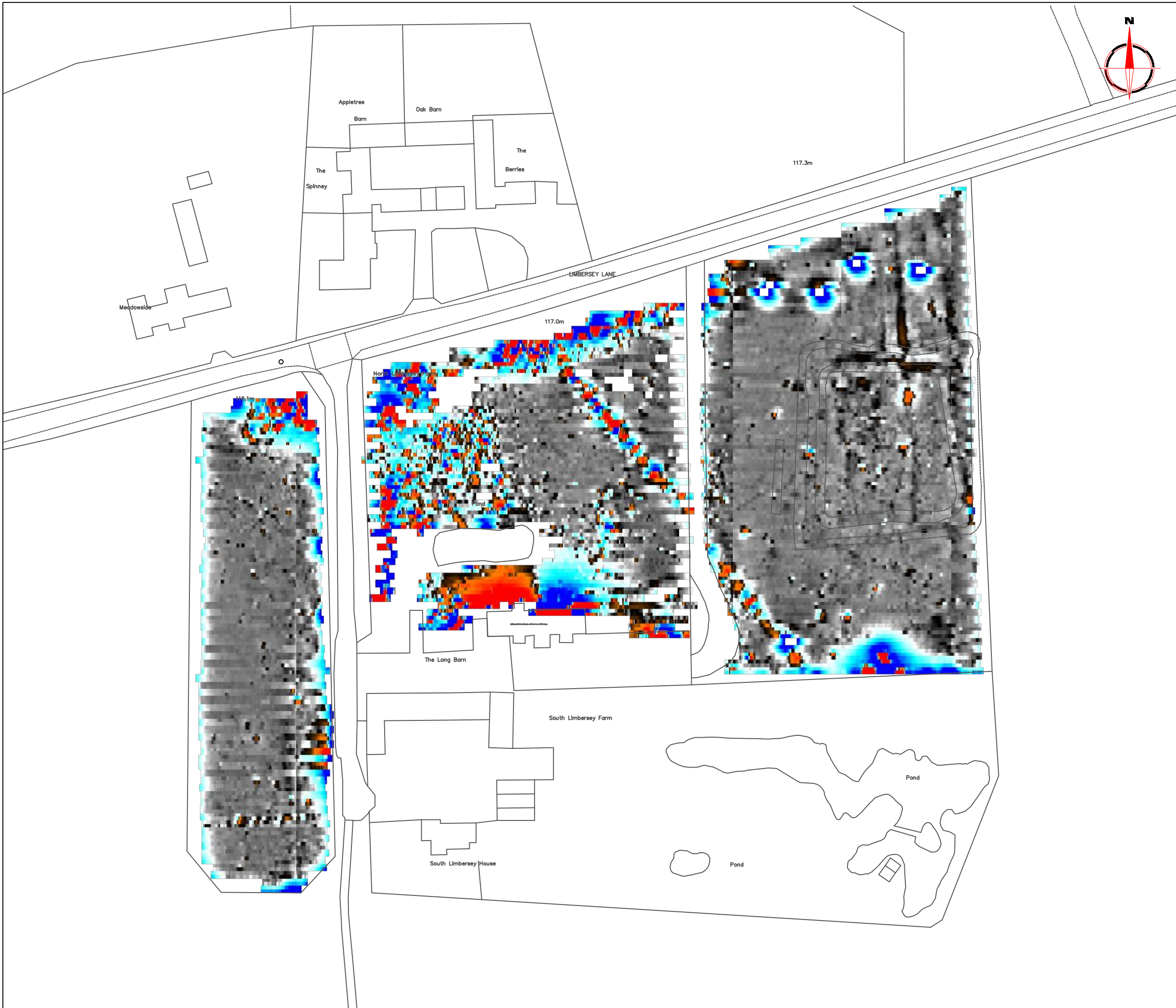

Amendments

Issue No.	Date	Description
-	-	-
-	-	-

© Stratascan Ltd - ----

Plotting parameters

Maximum + 100nT (red)
Minimum - 100nT (blue)

+ 100nT
+ 25nT
+ 3nT
- 3nT
- 25nT
- 100nT

Client
ALBION ARCHAEOLOGY

Project Title **LAND SOUTH OF NORTH LIMBERSEY FARM, MAULDEN, BEDFORDSHIRE** Job No. **J7431**

Subject
COLOUR PLOT OF GRADIOMETER DATA SHOWING EXTREME VALUES

STRATASCAN™
GEOPHYSICS FOR ARCHAEOLOGY AND ENGINEERING

VINEYARD HOUSE T: 01684 592266
UPTON UPON SEVERN E: info@stratascan.co.uk
WR8 0SA www.stratascan.co.uk

EUROPEAN GPR ASSOCIATION

SUMO GROUP MEMBER

ims ISO 9001 certified **UKAS** **ims ISO 14001 certified** **UKAS**

Scale **1: 1000** 0m 10 20 30 40 50

Plot A3	Checked by DGE	Issue No. 01
Survey date SEPT 14	Drawn by TR	Figure No. 03



Amendments

Issue No.	Date	Description
-	-	-
-	-	-

© Stratascan Ltd - ----

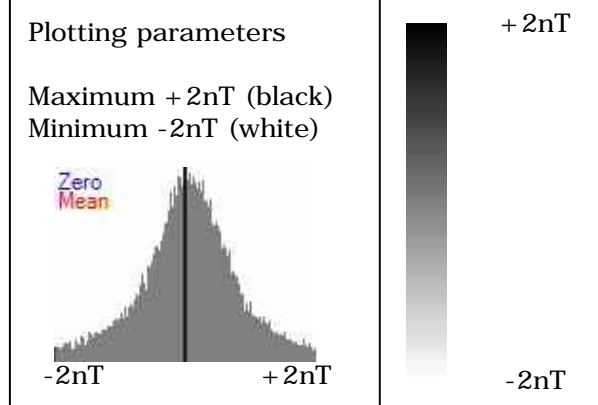

Client
ALBION ARCHAEOLOGY

Project Title **LAND SOUTH OF NORTH LIMBERSEY FARM, MAULDEN, BEDFORDSHIRE** Job No. **J7431**

Subject
PLOT OF MINIMALLY PROCESSED GRADIOMETER DATA

STRATASCAN™
GEOPHYSICS FOR ARCHAEOLOGY AND ENGINEERING
VINEYARD HOUSE T: 01684 592266
UPTON UPON SEVERN E: info@stratascan.co.uk
WR8 0SA www.stratascan.co.uk

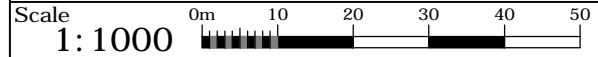

Plot A3	Checked by DGE	Issue No. 01
Survey date SEPT 14	Drawn by TR	Figure No. 04



Amendments		
Issue No.	Date	Description
-	-	-
-	-	-
© Stratascan Ltd - ----		
KEY		
PROBABLE ARCHAEOLOGY		
	Positive anomaly / weak positive anomaly - probable cut feature of archaeological origin	
	Negative anomaly / weak negative anomaly - probable bank or earthwork of archaeological origin	
	Moderate strength discrete anomaly - probable thermoremanent feature	
	Widely spaced curving parallel linear anomalies - probably related to ridge-and-furrow	
POSSIBLE ARCHAEOLOGY		
	Positive anomaly / weak positive anomaly - possible cut feature of archaeological origin	
	Negative anomaly / weak negative anomaly - possible bank or earthwork of archaeological origin	
	Moderate strength discrete anomaly - possible thermoremanent feature	
OTHER ANOMALIES		
	Closely spaced parallel linear anomalies - probably related to agricultural activity such as ploughing	
	Linear anomaly - probably related to pipe, cable or other modern service	
	Linear anomaly - possibly related to land drain	
	Magnetic disturbance associated with nearby metal object such as service or field boundary	
	Strong magnetic debris - possible disturbed or made ground	
	Scattered magnetic debris	
	Area of amorphous magnetic variation - probable natural (e.g. geological or pedological) origin	
	Magnetic spike - probable ferrous object	
Client		
ALBION ARCHAEOLOGY		
Project Title		Job No. J7431
LAND SOUTH OF NORTH LIMBERSEY FARM, MAULDEN, BEDFORDSHIRE		
Subject		
ABSTRACTION AND INTERPRETATION OF GRADIOMETER ANOMALIES		
STRATASCAN™		
GEOPHYSICS FOR ARCHAEOLOGY AND ENGINEERING		
VINEYARD HOUSE		T: 01684 592266
UPTON UPON SEVERN		E: info@stratascan.co.uk
WR8 0SA		www.stratascan.co.uk
Scale		
1: 1000		
Plot	Checked by	Issue No.
A3	DGE	01
Survey date	Drawn by	Figure No.
SEPT 14	TR	05