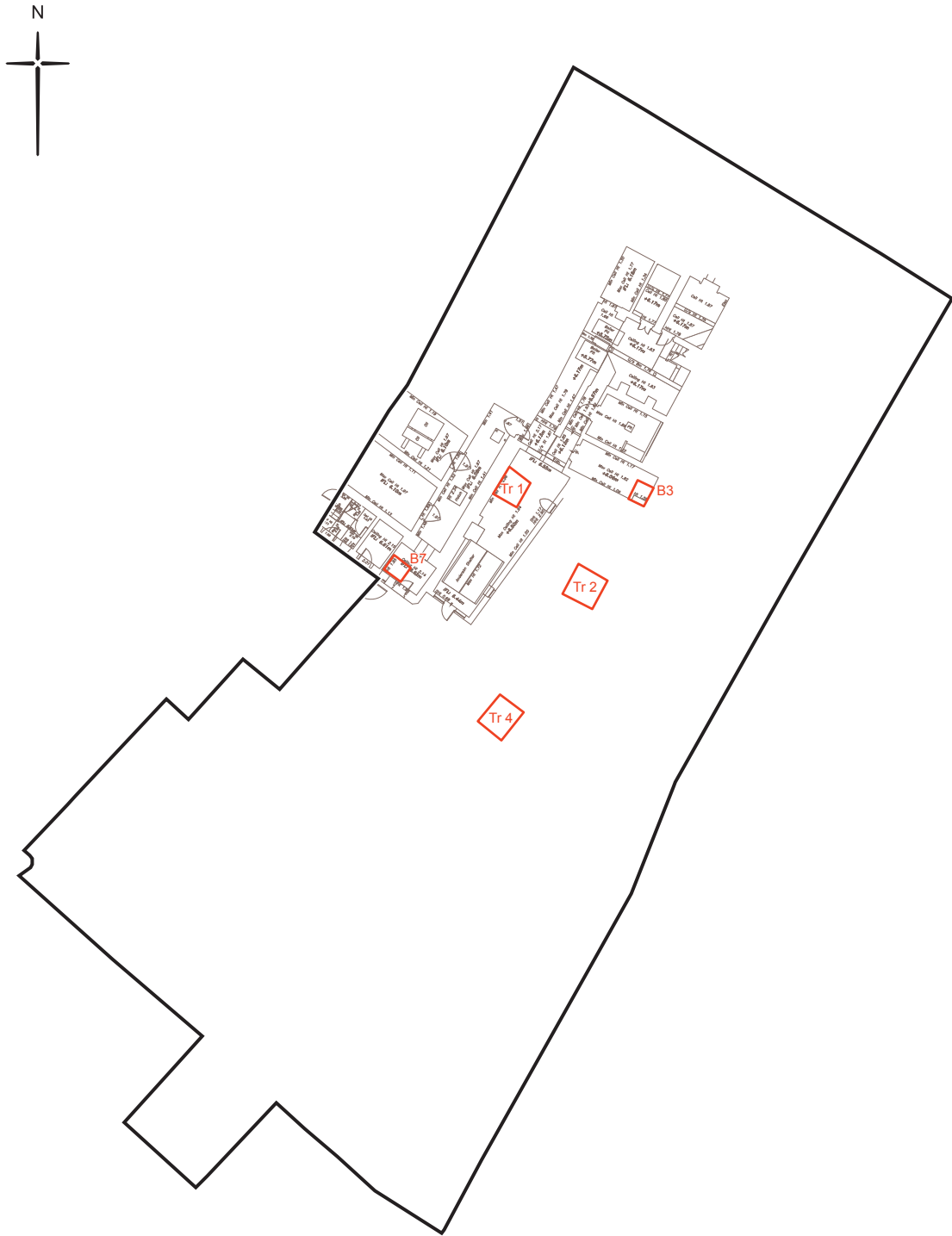



Fig 1 Site location





KEY	
	trial pit
	site outline

Based upon the Ordnance Survey mapping with the permission of the Controller of Her Majesty's Stationery Office © Crown Copyright. Unauthorised reproduction infringes Crown copyright and may lead to prosecution or civil proceedings. City of London 100023243 2013.

Scale 1:400 @ A4



Fig 3 Trial pit locations in relation to existing basement (after Greenhatch Group, dwg no. 17980_03_P, Rev 0, February 2013)

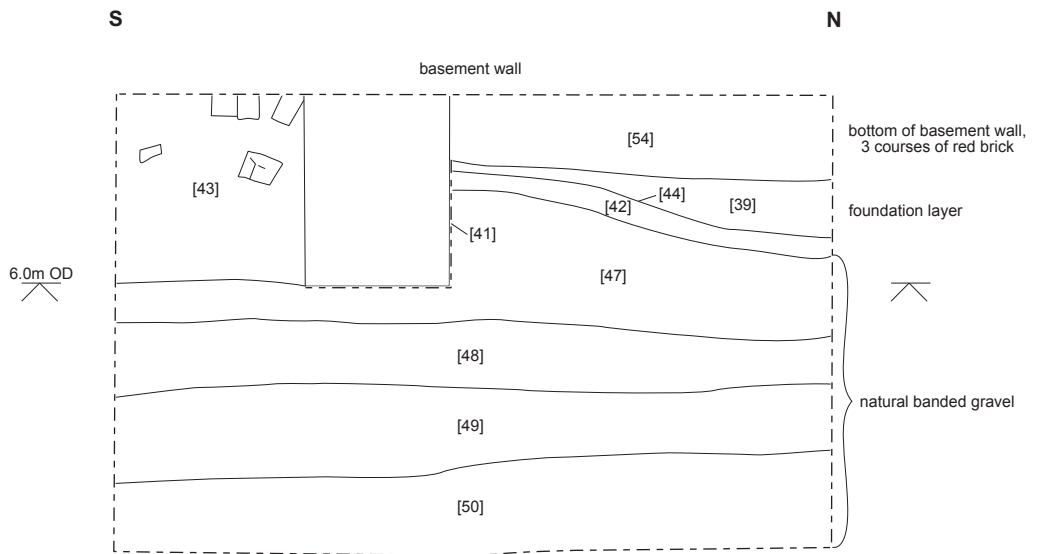

Fig 4 Section 4, Trench 1

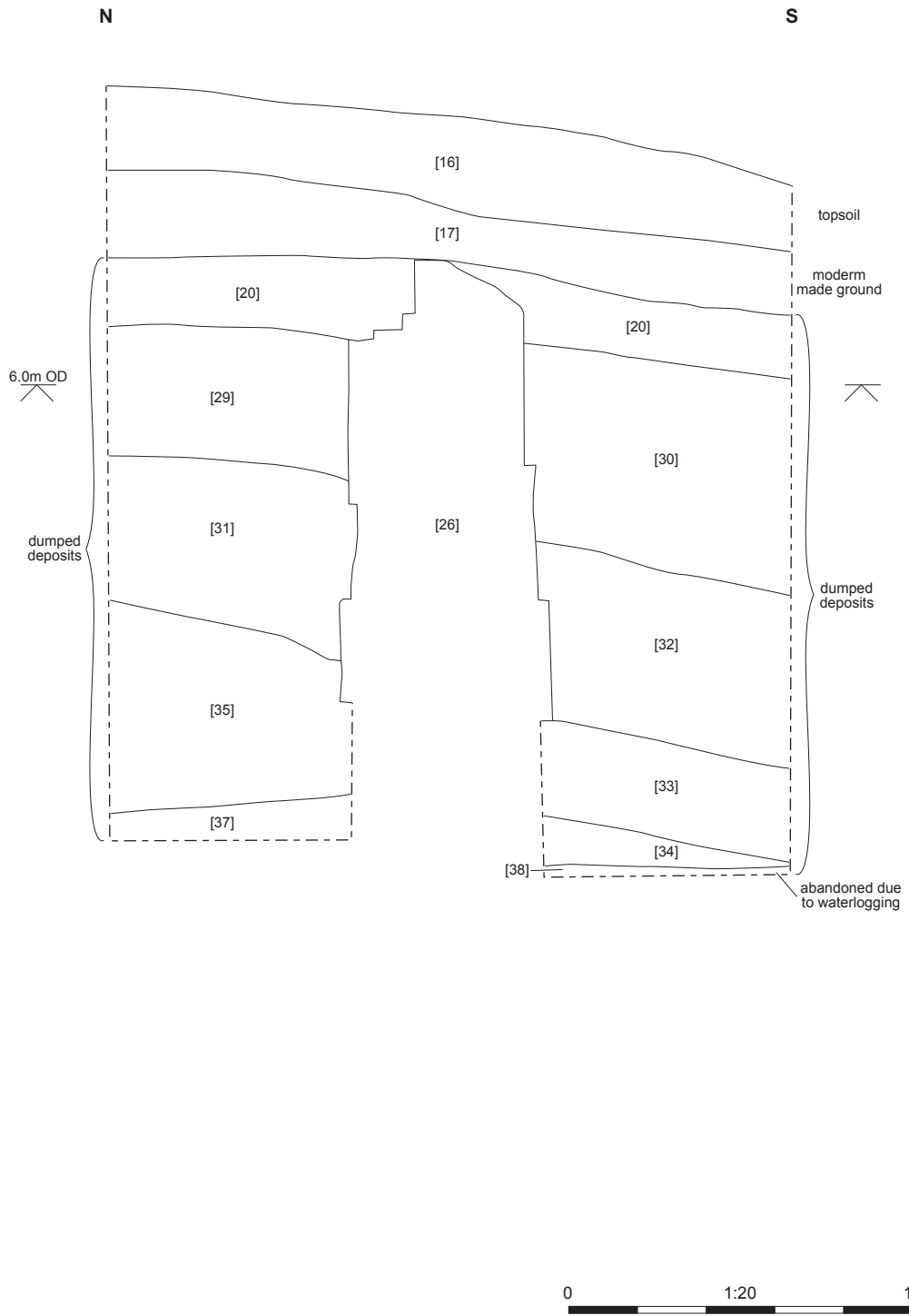

Fig 5 Section 2, Trench 4



Fig 6 View of Trench 1, looking west, showing wall [40]



Fig 7 View of Trench 1, looking south, showing wall [40] and dumped deposit [43]



Fig 8 View of Trench 2, looking west, with modern services in the north and western part of the trench, and possible trampled deposit [13] in sondage



Fig 9 View of Trench 2, looking west, with natural gravel shown in the base of the trench



Fig 10 Trench 4, looking east, showing wall [26] and waterlogging in the base of the trench



Fig 11 Trench 4, looking north-east, showing southern face of wall [26] including bevelled plinth



Fig 12 Trench 4, looking south, showing northern face of wall [26]



Fig 13 Trench B3, looking east, showing natural gravel beneath basement wall [56]



Fig 14 Trench B3, looking south, showing basement wall [58] and fill/made ground deposit [59]



Fig 15 Trench B7, looking north, showing brick vault beneath existing floorboards



Fig 16 Trench B7, looking west, with detail on brick vault