



LOUISBURG BARRACK

County of Hampshire

Watching brief report

March 2015



**Louisburg Barracks
Bordon
Hampshire
GU35 0BN**

Site Code HA-LBB15
NGR 479595 136575
OASIS reference molas1-206861

Planning reference 55369/001
Condition Number 10 and 11

Report on an archaeological watching brief

Sign-off History:

Issue No.	Date:	Prepared by:	Checked/ Approved by:	Reason for Issue:
1	30.03.15	Helen Vernon	Stewart Hoad	First issue

Graphics: Judit Peresztegi

Summary

This report presents the results of an archaeological watching brief carried out by MOLA at Louisburg Barracks. The report was commissioned from MOLA by AECOM on behalf of the client the Homes and Communities Agency.

In accordance with the Written Scheme of Investigation (MOLA 2015) a watching brief was carried out on the site between 18/02/15-19/03/15.

The entire area covered by the relief road can largely be split into three sections with different methodologies of investigation. Areas with buildings and known obstructions were excavated to an average depth of approximately 1m. Areas covered by road or parade ground had the tarmac or concrete slab lifted, exposing the natural below. Areas of grassland or forest were not excavated or exposed in any way.

In those areas explored mid orange yellow sandy natural was revealed which was truncated by the various phases of foundations of the barrack buildings and associated services and amenities. No archaeological deposits or features were uncovered.

Contents

Summary	2
Contents	3
1 Introduction	4
2 Topographical and historical background	5
3 The watching brief	6
4 Results of the watching brief	7
5 Archaeological potential	9
6 Publication and archiving	10
7 Acknowledgements	111
8 Bibliography	12
9 OASIS archaeological report form	17

List Of Illustrations

Front cover: Broxhead House	
Fig 1 Site Location	13
Fig 2 Areas outlines	14
Fig 3 Photograph of Area 1 complete; Facing west	15
Fig 4 Photograph of Area 2 complete; Facing north-east	15
Fig 5 Photograph of Area 3; Facing east	16
Fig 6 Photograph of Area 4; Facing east	16

1 Introduction

1.1 Site background

- 1.1.1 An archaeological watching brief was carried out by MOLA at Louisburg Barracks ('the site') between 18/02/15 and 19/03/15 (see *Fig 1*). This document is the Report on that work.
- 1.1.2 Further to the condition on Planning Consent a Written Scheme of Investigation was prepared by MOLA (2015). All archaeological work has been carried out in accordance with that WSI.

1.2 Planning background

- 1.2.1 The legislative and planning framework in which the watching brief took place was fully set out in the *Written Scheme of Investigation* which formed the project design for the evaluation (see Section 1.2, MOLA 2015).
- 1.2.2 The watching brief was carried out to fulfil a condition attached to the Planning Consent given by the Local Authority (Consent reference 55369/001; Condition number 10 and 11).

1.3 Scope of the watching brief

- 1.3.1 An archaeological watching brief is normally a limited fieldwork exercise. It is not the same as full excavation, though individual features may be fully excavated.
- 1.3.2 There were selected areas within the area of the proposed relief road that were not excavated or exposed at all, and therefore are not covered by this report. These areas are marked on Fig 2.
- 1.3.3 The watching brief was carried out within the terms of the relevant Standard for watching brief specified by the Institute for Archaeologists (CIFA, 2014).
- 1.3.4 All work was undertaken within research aims and objectives established in the Written Scheme of Investigation for the watching brief (Section 2.2)

2 Topographical and historical background

- 2.1.1 A description of the geology, archaeology and history of the site was provided in the Environmental Statement, produced in support of the planning application. Full details of the archaeology and cultural heritage of the study area are contained within the Environmental Statement (AECOM 2014). A brief resume is provided here:

2.2 Topography

- 2.2.1 The site is located to the east of Oxney Moss, a tributary of Oxney Stream. The underlying solid geology of the site is Folkestone Formation of sandstone.

2.3 Archaeology

- 2.3.1 Within the vicinity of the site are three prehistoric Scheduled Monuments in the form of Bronze Age barrows.
- 2.3.2 Evidence of Roman activity is limited to three find spots of coin, pottery and Alice Holt vessels.
- 2.3.3 Until the late 19th century the landscape was a largely undeveloped area of woodland and common heath, part of Woolmer Forest, a former royal forest.
- 2.3.4 The previous Environmental Statement lists 17 archaeological assets that will potentially be physically affected by the construction and operation of the proposed scheme. All of these assets are 19th/20th century structures and buildings which formed parts of the Louisburg Barracks.

3 The watching brief

3.1 Field methodology

- 3.1.1 The slab/ground was broken out and cleared by contractors under MOLA supervision. Areas were excavated by machine by the contractors, and monitored by a member of staff from MOLA.
- 3.1.2 Area locations were plotted on plans provided by the client using an 'offset methodology' and subsequently tied to the OS grid by MOLA Geomatics.

3.2 Recording methodology

- 3.2.1 A written and drawn record of all archaeological deposits encountered was carried out in accordance with the Written Scheme of Investigation (MOLA 2015).

3.3 Site archive

Number of trench record sheets	0
Number of overall location plans	0
Number of Context (SU) sheets	0
Number of photographs	38
Number of Plan sheets	0
Number of Sections	0

4 Results of the watching brief

For area locations see *Fig 2*

For area photographs see *Fig 3-6*

Area 1

Location	Buildings LB27-31
Dimensions	Approx. 177m by 45m by 1m depth
Modern ground level	Approx. 81mOD
Base of modern fill	Approx. 80.5mOD
Depth of archaeological stratigraphy	None
Level of base of lowest features observed	None
Top of surviving natural observed at	Approx. 80.5mOD
Level of base of trench	Approx. 80mOD

- 4.1.1 This area was excavated by machine in order to remove any obstacles within the ground. To ensure no obstacles remained the ground was 'turned over' and therefore excavated to a depth of approximately 1m.
- 4.1.2 Natural consisted of mid yellow orange sand which extended over the entirety of the observed site. Truncating this were concrete and brick wall foundations of the barracks, and services related to these buildings.

4.2 Area 2

Location	Buildings LB72, LB80-81
Dimensions	Approx. 68m by 48m by 1m depth
Modern ground level	Approx. 83mOD
Base of modern fill	Approx. 82.5mOD
Depth of archaeological stratigraphy	None
Level of base of lowest features observed	None
Top of surviving natural observed at	Approx. 82.5mOD
Level of base of trench	Approx. 82m OD

- 4.2.1 The same methodology as applied in Area 1 was repeated in this area to remove the foundations of the buildings.
- 4.2.2 Again, truncating the sandy natural was the foundations of the barrack buildings and associated services. The slightly different make-up of the foundations of building LB72 suggests it was built at a different time to the other buildings.

4.3 Area 3

Location	Area of road and parade ground
Dimensions	Approx. 276m by 22m
Modern ground level	Approx. 83mOD
Base of modern fill	Approx. 82.8mOD
Depth of archaeological stratigraphy	None
Level of base of lowest features observed	None
Top of surviving natural observed at	Approx. 82.8mOD

4.4 Area 4

Location	Area of road to west of site
Dimensions	Approx. 82m by 6m
Modern ground level	Sloping from approx. 80mOD to 78mOD
Base of modern fill	0.2m below ground level
Depth of archaeological stratigraphy	None
Level of base of lowest features observed	None
Top of surviving natural observed at	Approx. 79.8mOD

- 4.4.1 The methodology employed in areas 3 and 4 consisted of the lifting of tarmac and concrete slabs along the roads and parade ground within the area of the proposed relief road. No excavation or exploration into the ground was undertaken except in the case of the removal of a fuel tank and associated contaminated ground.
- 4.4.2 Once the tarmac and slabs had been lifted the mid orange yellow sand natural was revealed. No archaeological deposits or features were observed.

5 Archaeological potential

5.1 Answering original research aims

- What is the nature and level of natural topography?

The site slopes from east to west from approximately 83mOD to 78mOD with natural only 0.2m below the surface in some areas. The natural consisted of mid orange yellow sand.

- What are the earliest deposits identified?

The earliest deposits consisted of the earliest phases of the barracks foundations.

- What are the latest deposits identified?

The latest deposits consisted of the latest phases of the barracks foundations.

- What is the extent of modern disturbance?

In the areas of the buildings modern disturbance is fairly extensive, with foundations and services truncating most of the area. In the areas of road and parade ground disturbance is far less with the concrete and a thin hardcore layer being laid directly upon the natural. However, as there was no subsoil observed across site, there is no way to tell if any, or how much horizontal truncation occurred to make a reasonably level ground for the building of the barracks.

6 Publication and archiving

- 6.1.1 The results of the watching brief will be made publicly available by means of a database in digital form, to permit inclusion of the site data in any future academic researches into the development of Hampshire.
- 6.1.2 The site archive containing original records and finds will be stored in accordance with the terms of the *Written Scheme of Investigation* (MOLA 2015) with the Hampshire County Council Museums and Archives Service 12 months of the end of the watching brief.
- 6.1.3 In view of the limited potential of the material (Sections 5) it is suggested that a short note on the results of the watching brief should appear in the annual round up of the *Annual Review of Archaeology in Hampshire*.

7 Acknowledgements

- 7.1.1 The author would like to thank the following for their contributions and help in producing this report: Karl Larcombe, Erith Site Manager, for his assistance on site. Fiona Lee and Victoria Griffin of AECOM for commissioning and setting up the archaeological investigation.

8 Bibliography

AECOM 2014 Louisburg Barracks Environmental Statement
Chartered Institute for Archaeologists, (CIFA), 2014 *By-Laws, Standards and Policy Statements of the Chartered Institute for Archaeologists, Standard and guidance: watching brief*

Chartered Institute for Archaeologists, (CIFA), 2014 *By-Laws, Standards and Policy Statements of the Chartered Institute for Archaeologists, Standard and guidance: the creation, compilation deposition and transfer of archaeological archives*

English Heritage, 1991 Management of Archaeological Projects (MAP2)

English Heritage Greater London Archaeology Advisory Service, 2014 Standards for archaeological Work

MOLA, 2015, Written Scheme of Investigation for Louisburg Barracks, MOLA unpub report

WYG 2014 Site Constraints Plan A088473-003

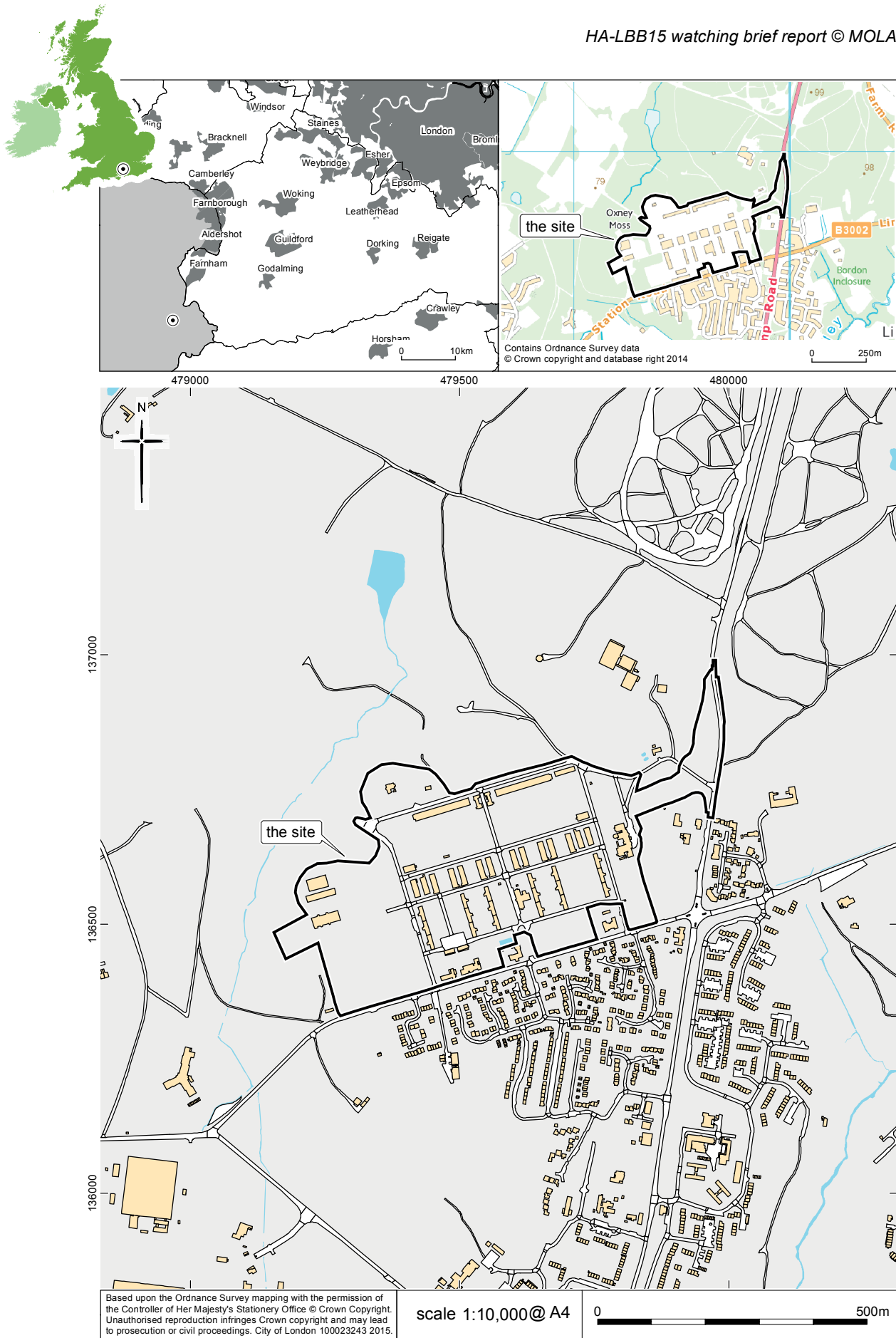

Fig 1 Site location

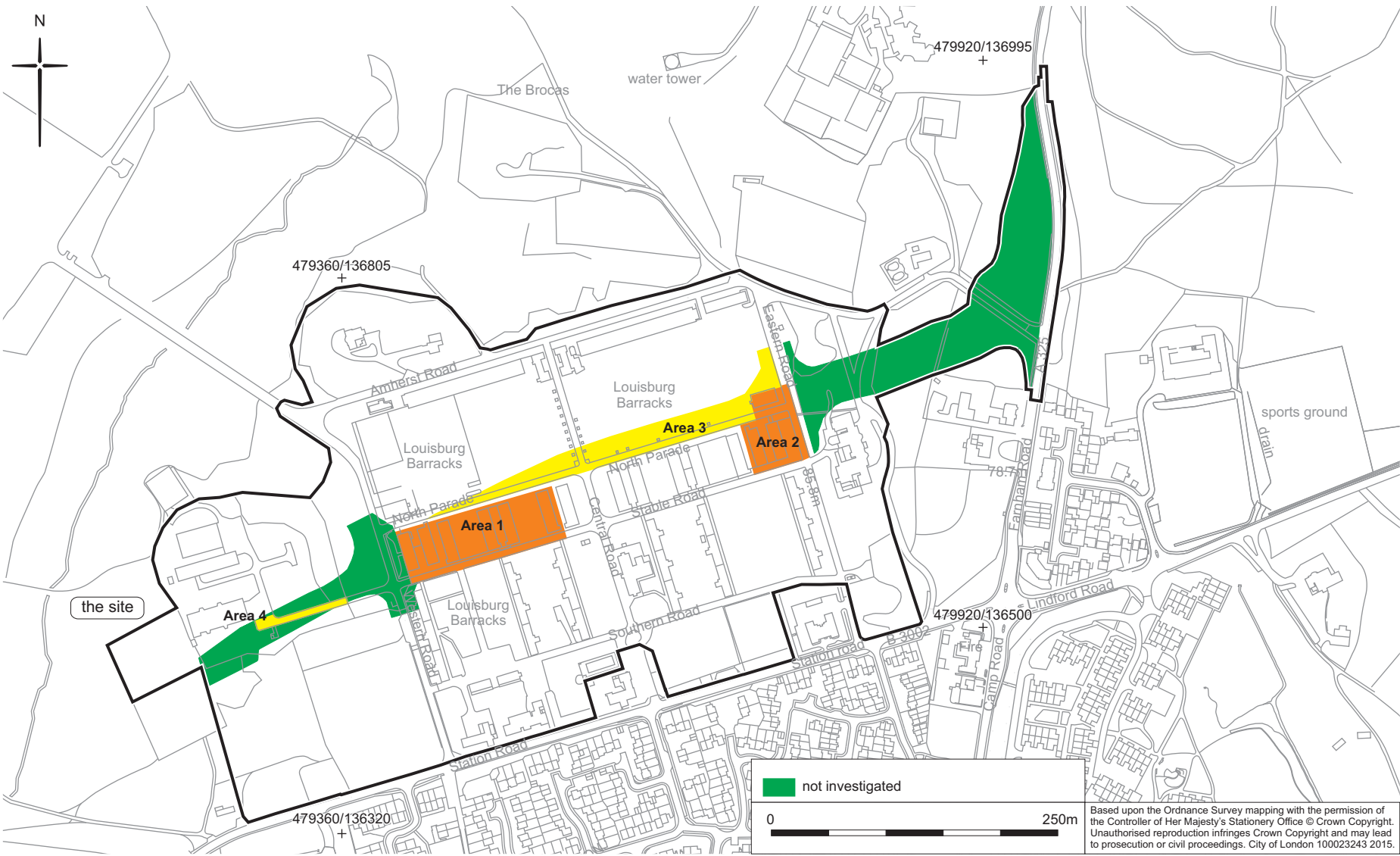

Fig 2 Area outlines



Fig 3 Photograph of Area 1 complete; facing west



Fig 4 Photograph of Area 2 complete; Facing north-east



Fig 5 Photograph of Area 3; Facing east



Fig 6 Photograph of Area 4; Facing east

9 OASIS archaeological report form

9.1 OASIS ID: molas1-206861

Project details

Project name	Louisburg Barracks
Short description of the project	The area is being developed into a relief road and can largely be split into three sections with different methodologies of investigation. Areas with buildings and known obstructions were excavated to an average depth of approximately 1m. Areas covered by road or parade ground had the tarmac or concrete slab lifted, exposing the natural below. Areas of grassland or forest were not excavated or exposed in any way. In those areas explored mid orange yellow sand natural was revealed which was truncated by the various phases of foundations of the barrack buildings and associated services and amenities. No archaeological deposits or features were discovered.
Project dates	Start: 18-02-2015 End: 19-03-2015
Previous/future work	No / Not known
Any associated project reference codes	HA-LBB15 - Sitecode
Type of project	Recording project
Monument type	N/A None
Significant Finds	N/A None
Investigation type	"Watching Brief"
Prompt	Planning condition
Project location	
Country	England
Site location	HAMPSHIRE EAST HAMPSHIRE WHITEHILL Louisburg Barracks
Postcode	GU35 0BN
Study area	13886.00 Square metres
Site coordinates	SU 79595 36575 51.1223940042 -0.862556986067 51 07 20 N 000 51 45 W Point
Height OD / Depth	Min: 79.80m Max: 82.80m
Project creators	
Name of Organisation	MOLA
Project brief originator	AECOM

Project design originator	AECOM
Project director/manager	Stewart Hoad
Project supervisor	Helen Vernon
Type of sponsor/funding body	Client
Project archives	
Physical Archive Exists?	No
Digital Archive recipient	Hampshire County Council Museums Service
Digital Contents	"none"
Digital Media available	"Images raster / digital photography"
Paper Archive recipient	Hampshire County Council Museums Service
Paper Contents	"none"
Paper Media available	"Report"
Project bibliography	
1	
Publication type	Grey literature (unpublished document/manuscript)
Title	Louisburg Barracks, Bordon Report on an Archaeological watching brief
Author(s)/Editor(s)	Vernon, H
Date	2015
Issuer or publisher	MOLA
Place of issue or publication	LONDON
Entered by	Helen Vernon (hvernnon@mola.org.uk)
Entered on	20 March 2015