



# Northamptonshire Archaeology

Archaeological Trial Trench evaluation at  
Birch Coppice Business Park, Phase III,  
Dordon, Warwickshire  
January 2013



## Northamptonshire Archaeology

2 Bolton House  
Wootton Hall Park  
Northampton NN4 8BE  
t. 01604 700493 f. 01604 702822  
e. [sparry@northamptonshire.gov.uk](mailto:sparry@northamptonshire.gov.uk)  
w. [www.northantsarchaeology.co.uk](http://www.northantsarchaeology.co.uk)



Northamptonshire  
County Council

Jason Clarke  
Report 13/17  
January 2013



### STAFF

Project Manager: Ian Meadows BA

Text: Jason Clarke BSc MA AIfA

Fieldwork: Jason Clarke  
Adrian Adams  
David Haynes  
William Illsley BA

Illustrations Amir Bassir BSc PIfA

### QUALITY CONTROL

	Print name	Signed	Date
Checked by	Pat Chapman	<i>PC</i>	
Verified by	Ian Meadows	<i>IM</i>	
Approved by	Andy Chapman	<i>AC</i>	

**OASIS REPORT FORM**

<b>PROJECT DETAILS</b>		<b>Oasis No: 141592</b>	
Project title	Archaeological Trial Trench evaluation at Birch Coppice Business Park, Phase III, Dordon, Warwickshire, January 2013		
Short description	In January 2013, an archaeological trial trench evaluation was carried out by Northamptonshire Archaeology, on behalf of Prospect Archaeology, on land at Birch Coppice Business Park, Dordon, Warwickshire. The works identified an undated area of burning to the west and a possible post-medieval quarry pit to the east of the development area. The site to the west was traversed by remnant furrows of medieval ridge and furrow cultivation.		
Project type	Trial trench evaluation		
Previous work	Geophysical survey		
Current land use	Arable		
Future work	Unknown		
Monument type and period	Post-Medieval		
Significant finds	None		
<b>PROJECT LOCATION</b>			
County	Warwickshire		
Site address	Birch Coppice Business Park, Dordon		
Easting Northing	SP 26003 99845		
Area (sq m/ha)	10.3ha		
Height aOD	100mAOD		
<b>PROJECT CREATORS</b>			
Organisation	Northamptonshire Archaeology (NA)		
Project brief originator	Warwickshire County Council		
Project Design originator	Northamptonshire Archaeology (NA)		
Director/Supervisor	Jason Clarke (NA)		
Project Manager	Ian Meadows (NA)		
Sponsor or funding body	Prospect Archaeology		
<b>PROJECT DATE</b>			
Start date	7/01/2013		
End date	11/01/2013		
<b>ARCHIVES</b>	<b>Location (Accession no.)</b>	<b>Contents</b>	
Physical	T/1195		
Paper		Site records (1 archive box)	
Digital		Client report PDF. Survey Data, Photographs	
<b>BIBLIOGRAPHY</b>			
Title	Archaeological Trial Trench evaluation at Birch Coppice Business Park, Phase III, Dordon, Warwickshire, January 2013		
Serial title & volume	13/17		
Author(s)	Jason Clarke		
Page numbers	8 text, 4 figs		
Date	January 2013		

# Contents

<b>1</b>	<b>INTRODUCTION</b>	<b>1</b>
<b>2</b>	<b>BACKGROUND</b>	<b>1</b>
	2.1 Location and geology	1
	2.2 Historical and archaeological background	3
<b>3</b>	<b>METHODOLOGY</b>	<b>3</b>
<b>4</b>	<b>THE EXCAVATED EVIDENCE</b>	<b>4</b>
	4.1 General stratigraphy	4
	4.2 The trial trenches (Figs 2 -4)	4
<b>5</b>	<b>THE POTTERY</b> by Tora Hylton	<b>4</b>
<b>6</b>	<b>DISCUSSION</b>	<b>8</b>
	<b>BIBLIOGRAPHY</b>	<b>8</b>
	<b>APPENDIX: SUMMARY OF CONTEXTS</b>	

## Figures

Front cover: General view of the excavation area

Fig 1: Site location

Fig 2: The excavated trenches

Fig 3: Plan of Trench 7 showing area of burning

Fig 4: Plans of trenches 7 and 41 and section 1

Back cover: Trenches 34-41 backfilled

**ARCHAEOLOGICAL TRIAL TRENCH EVALUATION AT  
BIRCH COPPICE BUSINESS PARK, PHASE III,  
DORDON, WARWICKSHIRE  
JANUARY 2013**

**Abstract**

*In January 2013, an archaeological trial trench evaluation was carried out by Northamptonshire Archaeology, on behalf of Prospect Archaeology, on land at Birch Coppice Business Park, Dordon, Warwickshire. The works identified an undated area of burning to the west and a possible post-medieval quarry pit to the east of the development area. The site to the west was traversed by remnant furrows of medieval ridge and furrow cultivation.*

**1 INTRODUCTION**

In January 2013, an archaeological trial trench evaluation was carried out by Northamptonshire Archaeology (NA) on land at Birch Coppice Business Park, Dordon, Warwickshire (NGR: SP 26003 99845, Fig 1). The work was commissioned by Prospect Archaeology ahead of the proposed development of the land.

The scope of works was outlined and detailed in the Written Scheme of Investigation prepared by Northamptonshire Archaeology (NA 2012). The objectives of the evaluation were to determine the presence of any archaeological features or deposits within the application area and to date and characterise their extent, depth of burial and state of preservation.

**2 BACKGROUND**

**2.1 Location and geology**

The proposed development area comprises a compact block of land, approximately 10.3ha in extent, between Tamworth and Atherstone. The site is located 1km east of the M42 junction with the A5 in north Warwickshire. The A5 lies immediately north of the site with the village of Dordon. Within the centre of the study area, effectively dividing it in two is a bank of woodland, bounded by Gypsy Lane to the east and a stream to the south, at the northern end of which is Beanstalk Farm. The fields are under arable cultivation.

The site is located on the geological bedrock of the Pennine Middle Coal Measure Formation, with overlying strata of Mudstone, Siltstone and Sandstone (BGS 2013).

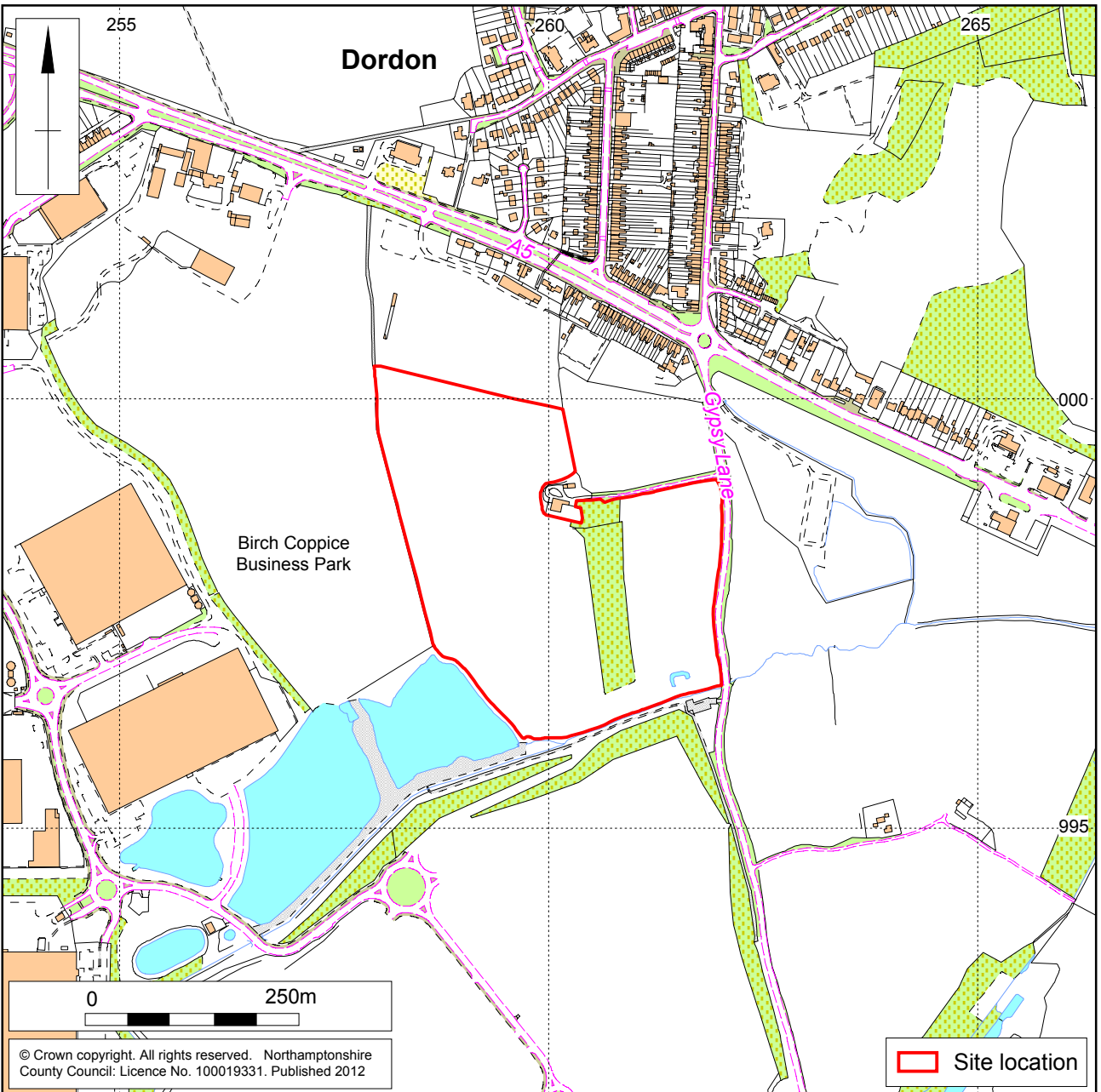

Scale 1:7500

Site location Fig 1

## 2.2 Historical and archaeological background

To the north-west of the development area, the Warwickshire HER records an extensive group of cropmark enclosures of probable late prehistoric or Roman date (MWA 4822). Prehistoric features have been recorded to the south of the proposed development during evaluation and recording of Phase II of Birch Coppice Business Park. This comprised a pit containing Beaker pottery (MWA13081) and a group of five small pits containing charcoal and cremated bone of middle Bronze Age date (MWA13086).

No Roman sites or finds have been identified within the proposed development although the Roman Watling Street passes 100m to the north of the study area. No sites or finds from the early medieval period have been identified within the proposed development.

The Beanstalk farm is of no particular antiquity first appearing on the 1938 Ordnance Survey.

A geophysical survey of the site has previously been undertaken (Evershed 2012).

The survey of the site identified a small group of anomalies of potential archaeological significance comprising weak linear anomalies that might relate to field systems, and several possible pits or infilled ponds. None of the anomalies identified however appear to relate to anything other than agricultural activities on the site. Unfortunately the evidence is quite slight, and cannot support a more detailed or confident interpretation.

## 3 METHODOLOGY

Forty-one trial trenches were excavated in accordance with a trench plan prepared by Northamptonshire Archaeology and approved by Anna Stocks (Senior Planning Archaeologist, Warwickshire County Council) (Fig 2).

The trenches measured 50m long by 1.80m wide. The total length excavated was 2050m. Trenches were positioned using a Leica system 1200 GPS.

A 360° tracked mechanical excavator fitted with a 1.80m-wide ditching bucket was used to remove overburden to archaeological levels or the natural substrate, whichever was encountered first. The trenches were cleaned sufficiently to enable the identification and definition of archaeological features. A hand-drawn plan of all archaeological features was made at scale 1:50 or 1:100 and was related to the Ordnance Survey National Grid. Archaeological deposits were examined by hand excavation to determine their nature. Recording followed standard NA procedures as described in the *Fieldwork Manual* (NA 2011). Deposits were described on *pro-forma* sheets to include measured and descriptive details of the context, its relationships, interpretation and a checklist of associated finds. Context sheets were cross-referenced to scale plans, section drawings and photographs. Photography was with 35mm black and white film and colour slides, supplemented with digital images. Sections were drawn at scale 1:10 or 1:20, as appropriate and related to Ordnance Survey datum. Spoil heaps and features were scanned with a metal detector to maximise the recovery of metal objects.

All works were conducted in accordance with the Institute for Archaeologists' *Code of Conduct* (IfA 2010) and *Standard and Guidance for Archaeological Field Evaluation* (IfA 1994, revised 2008).

## 4 THE EXCAVATED EVIDENCE

### 4.1 General stratigraphy

The underlying geology of mudstones siltstone and sandstone, was encountered between 0.2-0.5m below the modern ground surface. This occurred as light-mid orange or brownish-yellow sandy clay with occasional angular to sub-angular pebbles. The subsoil was light grey-brown sandy clay and the topsoil was mid greyish-brown sandy clay, both soils contained occasional sandstone fragments and pebbles.

Archaeological features cut into the natural geology were found in two of the forty-one trenches (Trenches 7 and 41). Remnant furrows from ridge and furrow cultivation were encountered in Trenches 1, 3, 4, 5, 15, 20, 21 and 22.

### 4.2 The trial trenches (Figs 2 -4)

The trench locations are shown in Figure 2 and an inventory of contexts is provided as an Appendix. The topsoil had an average depth of 0.40m and the subsoil of 0.10m.

#### ***Trench 7***

Trench 7 was 50m long, aligned north-east to south-west (Figs 2 and 3). An area of burning was partially exposed in the section of the trench.

#### ***Area of burning [704]***

An area of burning [704] partially exposed at the south of the trench, was 0.90m long, 0.20m wide and 0.04m deep, with a shallow U-shaped profile (Figs 2 and 3). The fill of mid brown-red clay with occasional charcoal fragments (703) contained no finds.

#### ***Trench 41***

Trench 41 was 50m long, aligned north to south (Figs 2 and 4 Section 1). A possible quarry pit was exposed in the east of the trench.

#### ***Quarry Pit [4104]***

A large pit [4104] lay at the east of the trench. It was 13m long and 0.70m deep, with a shallow profile (Figs 2 and 4). The primary fill of mid grey-brown sandy clay (4105) was overlaid by dark brown-grey sandy clay (4103). Both fills produced post-medieval pottery.

#### **The Medieval field system**

Remnant furrows from a medieval ridge and furrow cultivation system were present at the west of the site. They were aligned east to west and had an average width of 1.0m. The furrows were highly truncated by subsequent agricultural activity and no finds were recovered from them.

## 5 THE POTTERY by Tora Hylton

Four sherds weighing c.18g were recovered from quarry pit 4106 in Trench 41. The sherds are post-medieval in date and factory produced modern glazed wares dating to the 19th and 20th centuries (Warwickshire Medieval and Post-Medieval Pottery Type Series). Diagnostic sherds include a rim sherd in Underglaze-Transfer Printed ware dating from the late 18th -19th century, a body sherd from a grey salt-glazed stoneware marmalade jar (late 19th century) and two sherds of utilitarian whiteware, one a basesherd from a plain bowl. The sherds will not be retained.



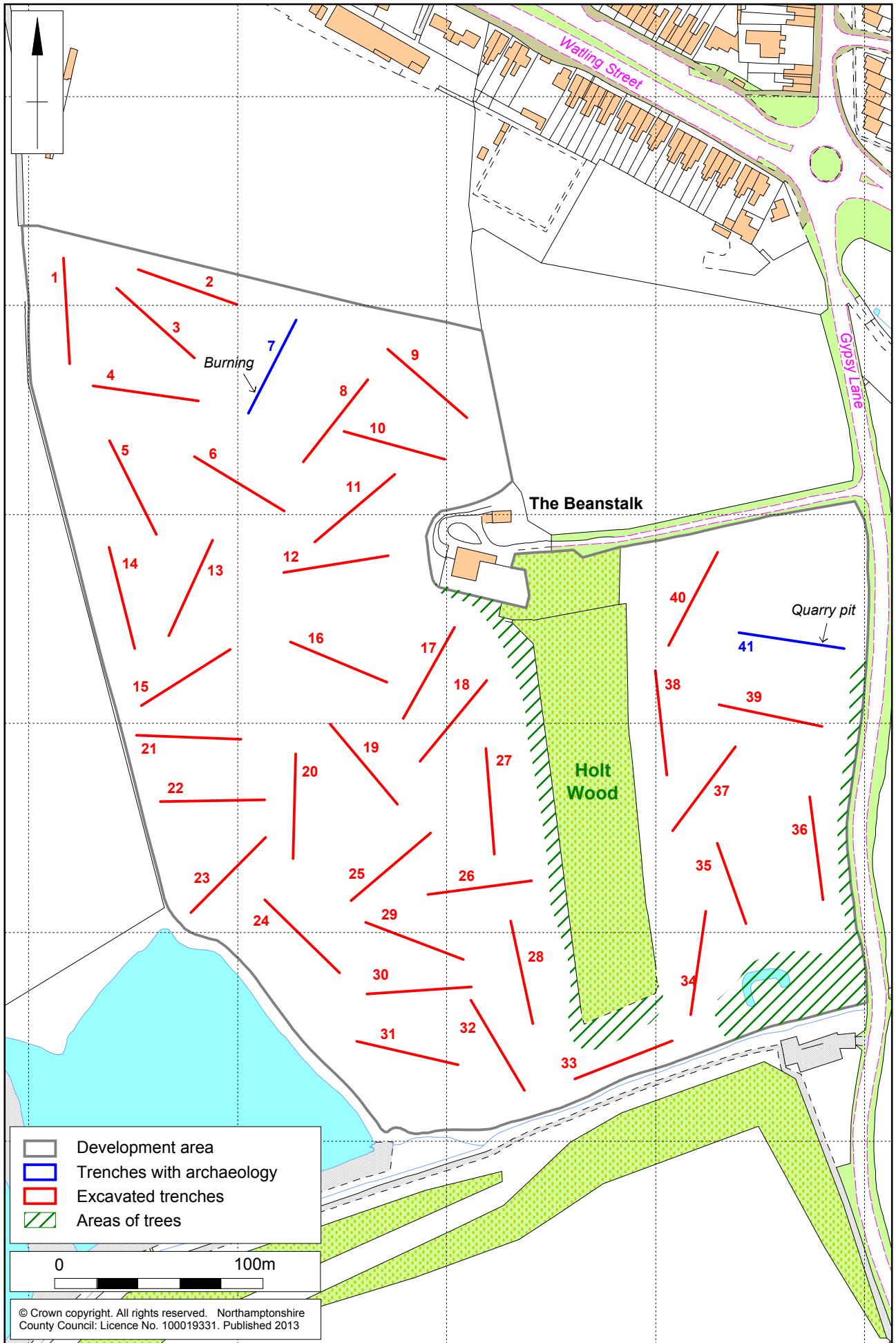

Scale 1:2500 (A4)

The excavated trenches Fig 2

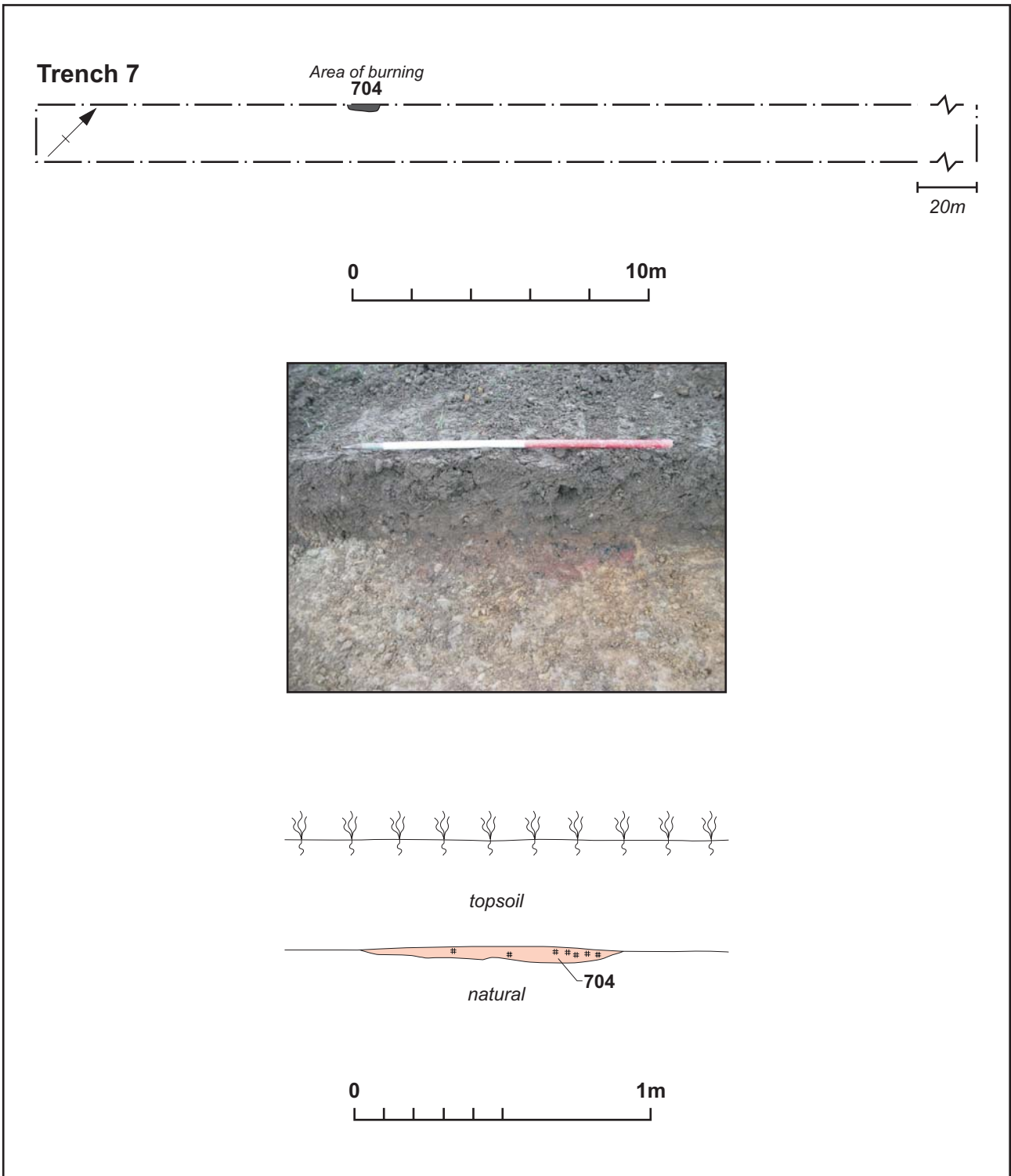

Scales, Plan 1:200, Section 1:20

Plan of Trench 7, showing area of burning Fig 3

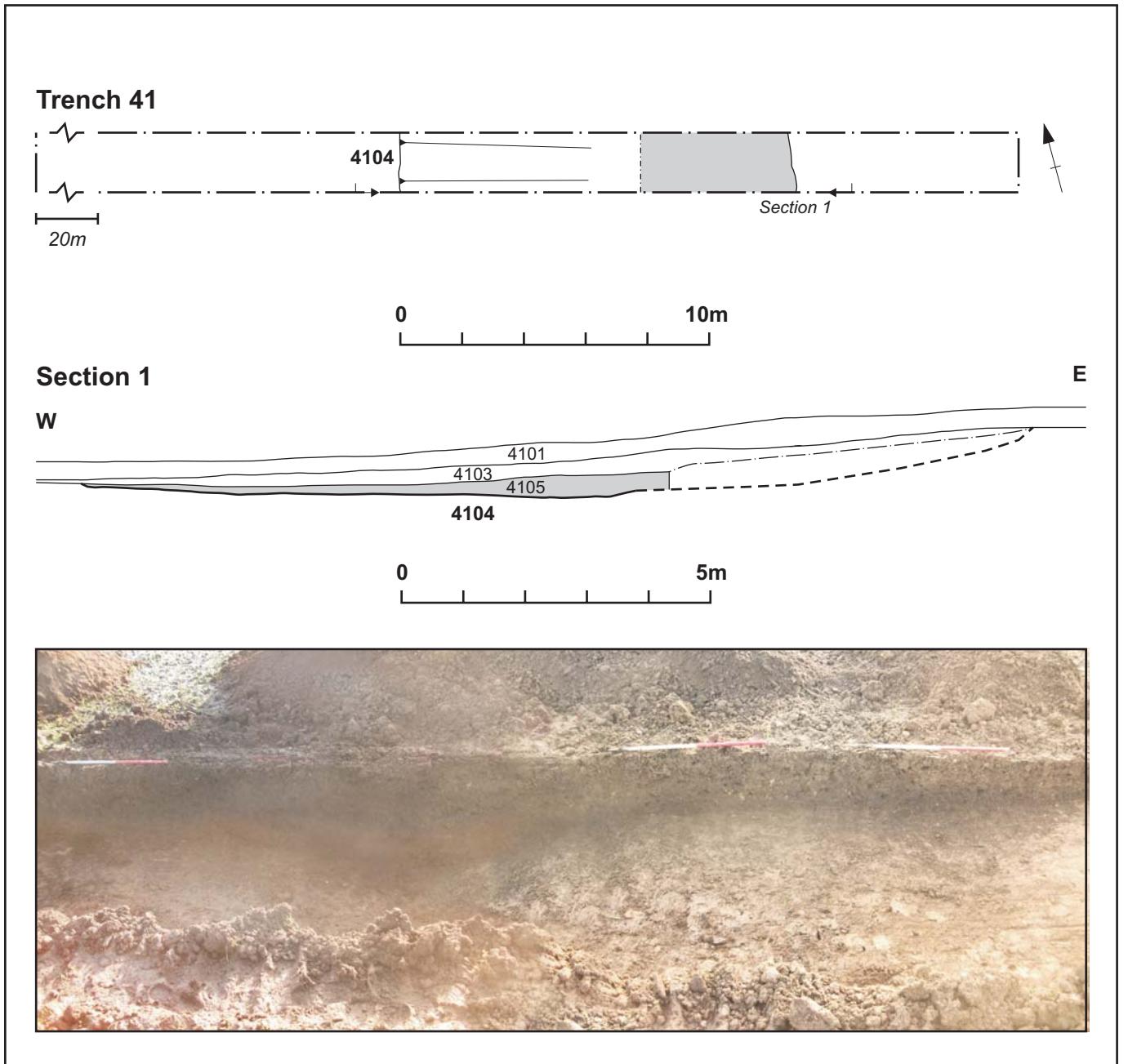

Scales, Plans 1:200, Section 1:100 (A4)

Plan of Trench 41 and section 1 Fig 4

## 6 DISCUSSION

The trial trenching generally confirmed the accuracy of the earlier geophysical survey. The development area to the west was traversed by medieval ridge and furrow cultivation.

A small area of burning was located to the west of the development area. It was situated on the interface between the natural geology and topsoil and consisted of a lens of charcoal within an area of heat affected natural clay. No burnt stone inclusions were present and no artefacts were recovered from the feature. In the absence of any dating evidence or better preservation its interpretation is problematic, however, in the absence of any prehistoric activity it is unlikely to be a burnt mound and may simply be the base of a recent bonfire.

A large pit located to the east of the development area was probably a quarry dating to the post-medieval period.

## BIBLIOGRAPHY

Evershed, R, 2012 *Geophysical Survey by Magnetometry on Land Adjacent to Beanstalk Farm, Dordon, Warwickshire*, Allen Archaeology report **2012087**

IfA 2008 *Standard and guidance for archaeological field evaluation*, Institute for Archaeologists

IfA 2010 *Code of Conduct*, Institute for Archaeologists

NA 2011 *Archaeological Fieldwork Manual*, Northamptonshire Archaeology

NA 2012 *Archaeological Trial Trench Evaluation Birch Coppice Business Park, Phase III, Dordon, Warwickshire, Written Scheme of Investigation*. Northamptonshire Archaeology

Ratkai, S, and Soden, I, 1997 *The Warwickshire medieval and post-medieval ceramic type series*, Unpublished manual

### Maps

British Geological Survey, Solid and Drift Edition enhanced 1:50000 reprint.1997.

### Websites

BGS 2013 <http://www.bgs.ac.uk/geindex/home.html> British Geological Survey website

## APPENDIX: CONTEXT INDEX

Trench No	Length, width & alignment	NGR	Surface height	Depth & height of natural
1	50m x 1.80m N-S	SP 25816 00022	95.84m aOD	95.44m aOD
<i>Context</i>	<i>Context type Feature &amp; type</i>	<i>Description</i>	<i>Dimensions</i>	<i>Artefacts/ Samples</i>
101	Topsoil	Mid brown sandy clay	0.30m thick	
102	Subsoil	Mid yellow-brown sandy clay	0.10m thick	
103	Natural	Light yellow-brown sandy clay with sandstone fragments		

Trench No	Length, width & alignment	NGR	Surface height	Depth & height of natural
2	50m x 1.80m NW-SE	SP 25852 00017	95.45m aOD	94.95maOD
<i>Context</i>	<i>Context type Feature &amp; type</i>	<i>Description</i>	<i>Dimensions</i>	<i>Artefacts/ Samples</i>
201	Topsoil	Mid grey-brown sandy clay	0.45m thick	
202	Natural	Light yellow-brown clay with sandstone inclusions		

Trench No	Length, width & alignment	NGR	Surface height	Depth & height of natural
3	50m x 1.80m NW to SE	SP 25842 00008	94.94m aOD	94.36m aOD
<i>Context</i>	<i>Context type Feature &amp; type</i>	<i>Description</i>	<i>Dimensions</i>	<i>Artefacts/ Samples</i>
301	Topsoil	Mid grey- brown sandy clay	0.48m thick	
302	Natural	Mid reddish-brown sandy clay		

BIRCH COPPICE, DORDON: TRIAL TRENCHING

<b>Trench No</b>	<b>Length, width &amp; alignment</b>	<b>NGR</b>	<b>Surface height</b>	<b>Depth &amp; height of natural</b>
4	50m x 1.80m E-W	SP 25830 99961	92.81aOD	92.33m aOD
<b>Context</b>	<b>Context type Feature &amp; type</b>	<b>Description</b>	<b>Dimensions</b>	<b>Artefacts/ Samples</b>
401	Topsoil	Mid grey-brown sandy clay	0.48m thick	
402	Natural	Mid yellow-brown sandy clay with sandstone inclusions		

<b>Trench No</b>	<b>Length, width &amp; alignment</b>	<b>NGR</b>	<b>Surface height</b>	<b>Depth &amp; height of natural</b>
5	50m x 1.80m NW to SE	SP 25838 99935	92.02m aOD	91.47m aOD
<b>Context</b>	<b>Context type Feature &amp; type</b>	<b>Description</b>	<b>Dimensions</b>	<b>Artefacts/ Samples</b>
501	Topsoil	Mid grey-brown sandy clay	0.55m thick	
502	Natural	Mid yellow-brown sandy clay		

<b>Trench No</b>	<b>Length, width &amp; alignment</b>	<b>NGR</b>	<b>Surface height</b>	<b>Depth &amp; height of natural</b>
6	50m x 1.80m NW to SE	SP 25879 99927	93.28m aOD	92.86m aOD
<b>Context</b>	<b>Context type Feature &amp; type</b>	<b>Description</b>	<b>Dimensions</b>	<b>Artefacts/ Samples</b>
601	Topsoil	Mid grey-brown sandy clay	0.42m thick	
602	Natural	Light yellow-brown sandy clay		

BIRCH COPPICE, DORDON: TRIAL TRENCHING

Trench No	Length, width & alignment	NGR	Surface height	Depth & height of natural
7	50m x 1.80m NE to SW	SP 25928 99993	98.04m aOD	97.64m aOD
<b>Context</b>	<b>Context type Feature &amp; type</b>	<b>Description</b>	<b>Dimensions</b>	<b>Artefacts/ Samples</b>
701	Topsoil	Mid grey-brown sandy clay	0.32m thick	
702	Natural	Mid orange brown clay		
703	Fill of [704]	Dark grey-red sandy clay with occasional charcoal fragments		
704	Cut of burnt area	Area of burning	0.90m long, 0.20m wide (seen) and 0.04m deep	

Trench No	Length, width & alignment	NGR	Surface height	Depth & height of natural
8	50m x 1.80m NE to SW	SP 25962 99964	100.76m aOD	100.40m aOD
<b>Context</b>	<b>Context type Feature &amp; type</b>	<b>Description</b>	<b>Dimensions</b>	<b>Artefacts/ Samples</b>
801	Topsoil	Mid grey-brown sandy clay	0.36m thick	
802	Natural	Light orange-brown sandy clay		

Trench No	Length, width & alignment	NGR	Surface height	Depth & height of natural
9	50m x 1.80m NW to SE	SP 25971 99979	101.38m aOD	100.98m aOD
<b>Context</b>	<b>Context type Feature &amp; type</b>	<b>Description</b>	<b>Dimensions</b>	<b>Artefacts/ Samples</b>
901	Topsoil	Mid grey-brown sandy clay	0.40m thick	
902	Natural	Light orange-red sandy clay		

BIRCH COPPICE, DORDON: TRIAL TRENCHING

<b>Trench No</b>	<b>Length, width &amp; alignment</b>	<b>NGR</b>	<b>Surface height</b>	<b>Depth &amp; height of natural</b>
10	50m x 1.80m E to W	SP 25950 99939	99.94m aOD	99.54m aOD
<b>Context</b>	<b>Context type Feature &amp; type</b>	<b>Description</b>	<b>Dimensions</b>	<b>Artefacts/ Samples</b>
1001	Topsoil	Mid grey-brown sandy clay	0.40m thick	
1002	Natural	Mid orange-brown sandy clay		

<b>Trench No</b>	<b>Length, width &amp; alignment</b>	<b>NGR</b>	<b>Surface height</b>	<b>Depth &amp; height of natural</b>
11	50m x 1.80m NE to SW	SP 25936 99886	96.84m aOD	96.44m aOD
<b>Context</b>	<b>Context type Feature &amp; type</b>	<b>Description</b>	<b>Dimensions</b>	<b>Artefacts/ Samples</b>
1101	Topsoil	Mid grey-brown sandy clay	0.40m thick	
1102	Natural	Mid yellow-brown clay		

<b>Trench No</b>	<b>Length, width &amp; alignment</b>	<b>NGR</b>	<b>Surface height</b>	<b>Depth &amp; height of natural</b>
12	50m x 1.80m NW to SE	SP 25972 99880	100.55m aOD	100.15m aOD
<b>Context</b>	<b>Context type Feature &amp; type</b>	<b>Description</b>	<b>Dimensions</b>	<b>Artefacts/ Samples</b>
1201	Topsoil	Mid grey-brown sandy clay	0.40m thick	
1202	Natural	Mid orange-brown clay		



BIRCH COPPICE, DORDON: TRIAL TRENCHING

<b>Trench No</b>	<b>Length, width &amp; alignment</b>	<b>NGR</b>	<b>Surface height</b>	<b>Depth &amp; height of natural</b>
13	50m x 1.80m NE to SW	SP 25861 99890	91.30m aOD	90.90m aOD
<b>Context</b>	<b>Context type Feature &amp; type</b>	<b>Description</b>	<b>Dimensions</b>	<b>Artefacts/ Samples</b>
1301	Topsoil	Mid grey-brown sandy clay	0.40m thick	
1302	Natural	Mid orange-grey clay with sandstone fragments		

<b>Trench No</b>	<b>Length, width &amp; alignment</b>	<b>NGR</b>	<b>Surface height</b>	<b>Depth &amp; height of natural</b>
14	50m x 1.80m N to S	SP 25867 99842	89.16m aOD	88.78m aOD
<b>Context</b>	<b>Context type Feature &amp; type</b>	<b>Description</b>	<b>Dimensions</b>	<b>Artefacts/ Samples</b>
1401	Topsoil	Mid grey-brown sandy clay	0.38m thick	
1402	Natural	Mid yellow-brown sandy clay		

<b>Trench No</b>	<b>Length, width &amp; alignment</b>	<b>NGR</b>	<b>Surface height</b>	<b>Depth &amp; height of natural</b>
15	50m x 1.80m NE to SW	SP 25853 99808	87.66m aOD	87.26m aOD
<b>Context</b>	<b>Context type Feature &amp; type</b>	<b>Description</b>	<b>Dimensions</b>	<b>Artefacts/ Samples</b>
1501	Topsoil	Mid grey-brown sandy clay	0.40m thick	
1502	Natural	Mid yellow-brown sandy clay		

BIRCH COPPICE, DORDON: TRIAL TRENCHING

<b>Trench No</b>	<b>Length, width &amp; alignment</b>	<b>NGR</b>	<b>Surface height</b>	<b>Depth &amp; height of natural</b>
16	50m x 1.80m NE to SW	SP 25925 99839	92.82m aOD	92.42m aOD
<b>Context</b>	<b>Context type Feature &amp; type</b>	<b>Description</b>	<b>Dimensions</b>	<b>Artefacts/ Samples</b>
1601	Topsoil	Mid grey-brown sandy clay	0.40m thick	
1602	Natural	Mid orange-brown sandy clay		

<b>Trench No</b>	<b>Length, width &amp; alignment</b>	<b>NGR</b>	<b>Surface height</b>	<b>Depth &amp; height of natural</b>
17	50m x 1.80m NW to SE	SP 26003 99845	90.07m aOD	89.59m aOD
<b>Context</b>	<b>Context type Feature &amp; type</b>	<b>Description</b>	<b>Dimensions</b>	<b>Artefacts/ Samples</b>
1701	Topsoil	Mid grey-brown sandy clay	0.40m thick	
1702	Subsoil	Mid orange-brown sandy clay	0.08m thick	
1703	Natural	Dark grey-brown clay		

<b>Trench No</b>	<b>Length, width &amp; alignment</b>	<b>NGR</b>	<b>Surface height</b>	<b>Depth &amp; height of natural</b>
18	50m x 1.80m NE to SW	SP 26019 99820	95.56m aOD	95.16m aOD
<b>Context</b>	<b>Context type Feature &amp; type</b>	<b>Description</b>	<b>Dimensions</b>	<b>Artefacts/ Samples</b>
1801	Topsoil	Mid grey-brown sandy clay	0.40m thick	
1802	Natural	Mid orange-brown clay with sandstone fragments		

BIRCH COPPICE, DORDON: TRIAL TRENCHING

<b>Trench No</b>	<b>Length, width &amp; alignment</b>	<b>NGR</b>	<b>Surface height</b>	<b>Depth &amp; height of natural</b>
19	50m x 1.80m NW to SE	SP 25944 99799	92.84m aOD	92.43m aOD
<b>Context</b>	<b>Context type Feature &amp; type</b>	<b>Description</b>	<b>Dimensions</b>	<b>Artefacts/ Samples</b>
1901	Topsoil	Mid grey-brown sandy clay	0.41m thick	
1902	Natural	Mid yellow-brown sandy clay		

<b>Trench No</b>	<b>Length, width &amp; alignment</b>	<b>NGR</b>	<b>Surface height</b>	<b>Depth &amp; height of natural</b>
20	50m x 1.80m N to S	SP 25927 99785	90.27m aOD	89.91m aOD
<b>Context</b>	<b>Context type Feature &amp; type</b>	<b>Description</b>	<b>Dimensions</b>	<b>Artefacts/ Samples</b>
2001	Topsoil	Dark grey-brown sandy clay	0.36m thick	
2002	Natural	Mid orange-brown clay with sand patches		

<b>Trench No</b>	<b>Length, width &amp; alignment</b>	<b>NGR</b>	<b>Surface height</b>	<b>Depth &amp; height of natural</b>
21	50m x 1.80m E to W	SP 25851 99794	87.25m aOD	86.75m aOD
<b>Context</b>	<b>Context type Feature &amp; type</b>	<b>Description</b>	<b>Dimensions</b>	<b>Artefacts/ Samples</b>
2101	Topsoil	Mid grey-brown sandy clay	0.40m thick	
2102	Natural	Mid yellow-brown clay		
2103	Colluvium	Mid brown-grey sandy clay	0.15m thick	

<b>Trench No</b>	<b>Length, width &amp; alignment</b>	<b>NGR</b>	<b>Surface height</b>	<b>Depth &amp; height of natural</b>
<b>22</b>	<b>50m x 1.80m E to W</b>	<b>SP 25863 99762</b>	<b>85.62m aOD</b>	<b>85.07m aOD</b>
<b>Context</b>	<b>Context type Feature &amp; type</b>	<b>Description</b>	<b>Dimensions</b>	<b>Artefacts/ Samples</b>
2201	Topsoil	Mid grey-brown sandy clay	0.44m thick	
2202	Colluvium	Mid grey-brown sandy clay	0.15m thick	
2203	Natural	Mid brown-yellow sandy clay		

<b>Trench No</b>	<b>Length, width &amp; alignment</b>	<b>NGR</b>	<b>Surface height</b>	<b>Depth &amp; height of natural</b>
<b>23</b>	<b>50m x 1.80m NE to SW</b>	<b>SP 25913 99745</b>	<b>86.66m aOD</b>	<b>86.14m aOD</b>
<b>Context</b>	<b>Context type Feature &amp; type</b>	<b>Description</b>	<b>Dimensions</b>	<b>Artefacts/ Samples</b>
2301	Topsoil	Mid grey-brown sandy clay	0.40m thick	
2302	Colluvium	Mid yellow-brown sandy clay	0.12m thick	
2303	Natural	Mid brown sandy clay		

<b>Trench No</b>	<b>Length, width &amp; alignment</b>	<b>NGR</b>	<b>Surface height</b>	<b>Depth &amp; height of natural</b>
<b>24</b>	<b>50m x 1.80m NW to SE</b>	<b>SP 25912 99715</b>	<b>85.16m aOD</b>	<b>83.76m aOD</b>
<b>Context</b>	<b>Context type Feature &amp; type</b>	<b>Description</b>	<b>Dimensions</b>	<b>Artefacts/ Samples</b>
2401	Topsoil	Mid grey-brown sandy clay	0.40m thick	
2402	Natural	Mid orange-brown sandy clay		

BIRCH COPPICE, DORDON: TRIAL TRENCHING

<b>Trench No</b>	<b>Length, width &amp; alignment</b>	<b>NGR</b>	<b>Surface height</b>	<b>Depth &amp; height of natural</b>
25	50m x 1.80m NE to SW	SP 25992 99747	91.53m aOD	91.13m aOD
<b>Context</b>	<b>Context type Feature &amp; type</b>	<b>Description</b>	<b>Dimensions</b>	<b>Artefacts/ Samples</b>
2501	Topsoil	Mid grey-brown sandy clay	0.40m thick	
2502	Natural	Light orange-grey clay		

<b>Trench No</b>	<b>Length, width &amp; alignment</b>	<b>NGR</b>	<b>Surface height</b>	<b>Depth &amp; height of natural</b>
26	50m x 1.80m E to W	SP 26040 99724	88.27m aOD	87.80m aOD
<b>Context</b>	<b>Context type Feature &amp; type</b>	<b>Description</b>	<b>Dimensions</b>	<b>Artefacts/ Samples</b>
2601	Topsoil	Mid grey-brown sandy clay	0.47m thick	
2602	Natural	Mid orange-brown sandy clay		

<b>Trench No</b>	<b>Length, width &amp; alignment</b>	<b>NGR</b>	<b>Surface height</b>	<b>Depth &amp; height of natural</b>
27	50m x 1.80m N to S	SP 26018 99787	93.65m aOD	93.35m aOD
<b>Context</b>	<b>Context type Feature &amp; type</b>	<b>Description</b>	<b>Dimensions</b>	<b>Artefacts/ Samples</b>
2701	Topsoil	Mid grey-brown sandy clay	0.30m thick	
2702	Natural	Mid orange-yellow sandy clay		

BIRCH COPPICE, DORDON: TRIAL TRENCHING

<b>Trench No</b>	<b>Length, width &amp; alignment</b>	<b>NGR</b>	<b>Surface height</b>	<b>Depth &amp; height of natural</b>
28	50m x 1.80m N to S	SP 26030 99705	87.52m aOD	87.02m aOD
<b>Context</b>	<b>Context type Feature &amp; type</b>	<b>Description</b>	<b>Dimensions</b>	<b>Artefacts/ Samples</b>
2801	Topsoil	Mid grey-brown sandy clay	0.50m thick	
2802	Natural	Mid orange-brown sandy clay		

<b>Trench No</b>	<b>Length, width &amp; alignment</b>	<b>NGR</b>	<b>Surface height</b>	<b>Depth &amp; height of natural</b>
29	50m x 1.80m NW to SE	SP 25961 99704	89.59m aOD	89.19m aOD
<b>Context</b>	<b>Context type Feature &amp; type</b>	<b>Description</b>	<b>Dimensions</b>	<b>Artefacts/ Samples</b>
2901	Topsoil	Mid grey-brown sandy clay	0.40m thick	
2902	Natural	Mid orange-yellow sandy clay		

<b>Trench No</b>	<b>Length, width &amp; alignment</b>	<b>NGR</b>	<b>Surface height</b>	<b>Depth &amp; height of natural</b>
30	50m x 1.80m E to W	SP 25961 99670	87.43m aOD	87.09m aOD
<b>Context</b>	<b>Context type Feature &amp; type</b>	<b>Description</b>	<b>Dimensions</b>	<b>Artefacts/ Samples</b>
3001	Topsoil	Mid grey-brown sandy clay	0.34m thick	
3002	Natural	Mid orange-brown clay with sandstone fragments		

BIRCH COPPICE, DORDON: TRIAL TRENCHING

<b>Trench No</b>	<b>Length, width &amp; alignment</b>	<b>NGR</b>	<b>Surface height</b>	<b>Depth &amp; height of natural</b>
31	50m x 1.80m NW to SE	SP 25957 99647	85.43m aOD	85.07m aOD
<b>Context</b>	<b>Context type Feature &amp; type</b>	<b>Description</b>	<b>Dimensions</b>	<b>Artefacts/ Samples</b>
3101	Topsoil	Mid grey-brown sandy clay	0.36m thick	
3102	Natural	Mid yellow-brown sandy clay		

<b>Trench No</b>	<b>Length, width &amp; alignment</b>	<b>NGR</b>	<b>Surface height</b>	<b>Depth &amp; height of natural</b>
32	50m x 1.80m NW to SE	SP 26012 99665	86.26m aOD	85.81m aOD
<b>Context</b>	<b>Context type Feature &amp; type</b>	<b>Description</b>	<b>Dimensions</b>	<b>Artefacts/ Samples</b>
3201	Topsoil	Mid grey-brown sandy clay	0.35m thick	
3202	Colluvium	Mid brown sandy clay	0.10m	
3203	Natural	Mid orange-brown clay		

<b>Trench No</b>	<b>Length, width &amp; alignment</b>	<b>NGR</b>	<b>Surface height</b>	<b>Depth &amp; height of natural</b>
33	50m x 1.80m NE to SW	SP 26108 99648	82.47m aOD	81.77m aOD
<b>Context</b>	<b>Context type Feature &amp; type</b>	<b>Description</b>	<b>Dimensions</b>	<b>Artefacts/ Samples</b>
3301	Made ground	Mixed clay and vegetation	0.30m thick	
3302	Subsoil	Mid grey-brown sandy clay	0.40m thick	
3303	Natural	Mid grey clay		

<b>Trench No</b>	<b>Length, width &amp; alignment</b>	<b>NGR</b>	<b>Surface height</b>	<b>Depth &amp; height of natural</b>
34	50m x 1.80m N to S	SP 26117 99663	82.37m aOD	81.93m aOD
<b>Context</b>	<b>Context type Feature &amp; type</b>	<b>Description</b>	<b>Dimensions</b>	<b>Artefacts/ Samples</b>
3401	Topsoil	Mid grey-brown sandy clay	0.38m thick	
3402	Natural	Mid orange-brown sandy clay		
3403	Colluvium	Mid brown sandy clay	0.06m thick	

<b>Trench No</b>	<b>Length, width &amp; alignment</b>	<b>NGR</b>	<b>Surface height</b>	<b>Depth &amp; height of natural</b>
35	50m x 1.80m NW to SE	SP 26129 99742	87.75m aOD	87.35m aOD
<b>Context</b>	<b>Context type Feature &amp; type</b>	<b>Description</b>	<b>Dimensions</b>	<b>Artefacts/ Samples</b>
3501	Topsoil	Dark grey-brown sandy clay	0.40m thick	
3502	Natural	Mid orange-yellow clay		

<b>Trench No</b>	<b>Length, width &amp; alignment</b>	<b>NGR</b>	<b>Surface height</b>	<b>Depth &amp; height of natural</b>
36	50m x 1.80m N to S	SP 26173 99764	90.63m aOD	90.28m aOD
<b>Context</b>	<b>Context type Feature &amp; type</b>	<b>Description</b>	<b>Dimensions</b>	<b>Artefacts/ Samples</b>
3601	Topsoil	Mid grey-brown sandy clay	0.35m thick	
3602	Natural	Mid orange-brown sandy clay with sandstone fragments		



BIRCH COPPICE, DORDON: TRIAL TRENCHING

Trench No	Length, width & alignment	NGR	Surface height	Depth & height of natural
37	50m x 1.80m NE to SW	SP 26138 99788	90.50m aOD	90.12m aOD
<b>Context</b>	<b>Context type Feature &amp; type</b>	<b>Description</b>	<b>Dimensions</b>	<b>Artefacts/ Samples</b>
3701	Topsoil	Mid grey-brown sandy clay	0.38m thick	
3702	Natural	Mid yellow-brown clay		

Trench No	Length, width & alignment	NGR	Surface height	Depth & height of natural
38	50m x 1.80m N to S	SP 26099 99825	92.78m aOD	92.18m aOD
<b>Context</b>	<b>Context type Feature &amp; type</b>	<b>Description</b>	<b>Dimensions</b>	<b>Artefacts/ Samples</b>
3801	Topsoil	Mid grey-brown sandy clay	0.50m thick	
3802	Natural	Mid orange-brown sandy clay		

Trench No	Length, width & alignment	NGR	Surface height	Depth & height of natural
39	50m x 1.80m E to W	SP 26130 99808	91.62m aOD	91.22m aOD
<b>Context</b>	<b>Context type Feature &amp; type</b>	<b>Description</b>	<b>Dimensions</b>	<b>Artefacts/ Samples</b>
3901	Topsoil	Mid grey-brown sandy clay	0.40m thick	
3902	Natural	Mid orange-brown sandy clay		

BIRCH COPPICE, DORDON: TRIAL TRENCHING

<b>Trench No</b>	<b>Length, width &amp; alignment</b>	<b>NGR</b>	<b>Surface height</b>	<b>Depth &amp; height of natural</b>
40	50m x 1.80m NE to SW	SP 26129 99881	97.14m aOD	96.74m aOD
<i>Context</i>	<i>Context type Feature &amp; type</i>	<i>Description</i>	<i>Dimensions</i>	<i>Artefacts/ Samples</i>
4001	Topsoil	Mid grey-brown sandy clay	0.40m thick	
4002	Natural	Mid orange-brown sandy clay		

<b>Trench No</b>	<b>Length, width &amp; alignment</b>	<b>NGR</b>	<b>Surface height</b>	<b>Depth &amp; height of natural</b>
41	50m x 1.80m NW to SE	SP 26190 99835	96.21m aOD	95.81m aOD
<i>Context</i>	<i>Context type Feature &amp; type</i>	<i>Description</i>	<i>Dimensions</i>	<i>Artefacts/ Samples</i>
4101	Topsoil	Mid grey-brown sandy clay	0.40m thick	
4102	Natural	Light yellow-brown sandy clay		
4103	Fill of 4104	Dark brown-grey silty clay	13m long and 0.35m thick	Post-Medieval pottery
4104	Cut of quarry pit	Sub-circular pit, filled by (4103) (4105)	13m long and 0.70m deep	
4104	Fill of 4104	Mid grey-brown sandy clay	13m long and 0.35m deep	Post-Medieval pottery



Northamptonshire County Council

# Northamptonshire Archaeology



## Northamptonshire Archaeology

2 Bolton House  
Wootton Hall Park  
Northampton NN4 8BE

t. 01604 700493 f. 01604 702822

e. [sparry@northamptonshire.gov.uk](mailto:sparry@northamptonshire.gov.uk)

w. [www.northantsarchaeology.co.uk](http://www.northantsarchaeology.co.uk)



Northamptonshire  
County Council