



Northamptonshire Archaeology

Archaeological evaluation of land at Watergall
Bretton, Peterborough
August 2013



Northamptonshire Archaeology

Bolton House
Wootton Hall Park
Northampton NN4 8BN
t. 01604 700493 f. 01604 702822
e. sparry@northamptonshire.gov.uk
w. www.northantsarchaeology.co.uk



Northamptonshire
County Council

Jason Clarke

Report 13/165

August 2013



STAFF

Project Manager: Ian Meadows BA

Text: Jason Clarke BSc MA AIfA

Fieldwork: Jason Clarke
Peter Haynes

Illustrations Amir Bassir BSc

QUALITY CONTROL

	Print name	Signed	Date
Checked by	Pat Chapman	<i>PC</i>	
Verified by	Ian Meadows	<i>IM</i>	
Approved by	Andy Chapman	<i>AC</i>	

OASIS REPORT FORM

PROJECT DETAILS		OASIS No: 158153	
Project title	Archaeological evaluation of land at Watergall, Bretton, Peterborough 2013		
Short description	In August 2013, an archaeological trial trench evaluation was carried out by Northamptonshire Archaeology, on behalf of David Turnock Architects, at Watergall, Bretton, Peterborough. The works confirmed the area had been disturbed by construction activity during the building of the housing estate in the 1970s. No archaeology was present and no artefacts were recovered.		
Project type	Trial trench evaluation		
Previous work	None		
Current land use	Green space		
Future work	Unknown		
Monument type and period	None		
Significant finds	None		
PROJECT LOCATION			
County	Peterborough		
Site address	Watergall		
Easting Northing	TF 1643 0182		
Area (sq m/ha)	0.0054 ha		
Height aOD	16.2m aOD		
PROJECT CREATORS			
Organisation	Northamptonshire Archaeology (NA)		
Project brief originator	Peterborough City Council		
Project Design originator	Northamptonshire Archaeology (NA)		
Director/Supervisor	Jason Clarke (NA)		
Project Manager	Ian Meadows (NA)		
Sponsor or funding body	David Turnock Architects		
PROJECT DATE			
Start date	29/08//2013		
End date	29/08/2013		
ARCHIVES	Location (Accession no.)	Contents	
Physical			
Paper		Site records (1 archive box)	
Digital		Client report PDF. Survey Data, Photographs	
BIBLIOGRAPHY			
Title	Archaeological evaluation of Land at Watergall, Bretton, Peterborough August 2013		
Serial title & volume	13/165		
Author(s)	Jason Clarke		
Page numbers	7 text, 3 figs		
Date	30th August 2013		

Contents

1	INTRODUCTION	1
2	BACKGROUND	1
2.1	Location and geology	1
2.2	Historical and archaeological background	3
3	METHODOLOGY	3
4	THE EXCAVATED EVIDENCE	3
5	DISCUSSION	6
	BIBLIOGRAPHY	6
	APPENDIX: CONTEXT INDEX	

Figures

Front cover: General view of the excavation area

Fig 1: Site location

Fig 2: The excavated trenches

Fig 3: Photographs of trenches 1-3

**ARCHAEOLOGICAL EVALUATION OF LAND AT
WATERGALL, BRETTON
PETERBOROUGH
AUGUST 2013**

Abstract

In August 2013, an archaeological trial trench evaluation was carried out by Northamptonshire Archaeology, on behalf of David Turnock Architects, at Watergall, Bretton, Peterborough. The works confirmed the area had been disturbed by construction activity during the building of the housing estate in the 1970s. No archaeology was present and no artefacts were recovered.

1 INTRODUCTION

In August 2013, an archaeological trial trench evaluation was carried out by Northamptonshire Archaeology (NA) on land at Watergall, Bretton, Peterborough (NGR TF 1643 03182, Fig 1). The work was commissioned by David Turnock Architects to inform a planning application for residential development.

The scope of works was outlined and detailed in the Written Scheme of Investigation prepared by Northamptonshire Archaeology (NA 2013). The objectives of the evaluation were to determine the presence of any archaeological features or deposits within the application area and to date and characterise their extent, depth of burial and state of preservation.

2 BACKGROUND

2.1 Location and geology

The site is located within an area of 1970s Development Corporation housing in Bretton north of Peterborough. The site is bounded by Watergall to the east and domestic housing to the north, Watergall primary school and the Pyramid centre lies to the south.

The solid geology of the area has been mapped as Blisworth Clay mudstone and Cornbrash, with the study area lying on the former.

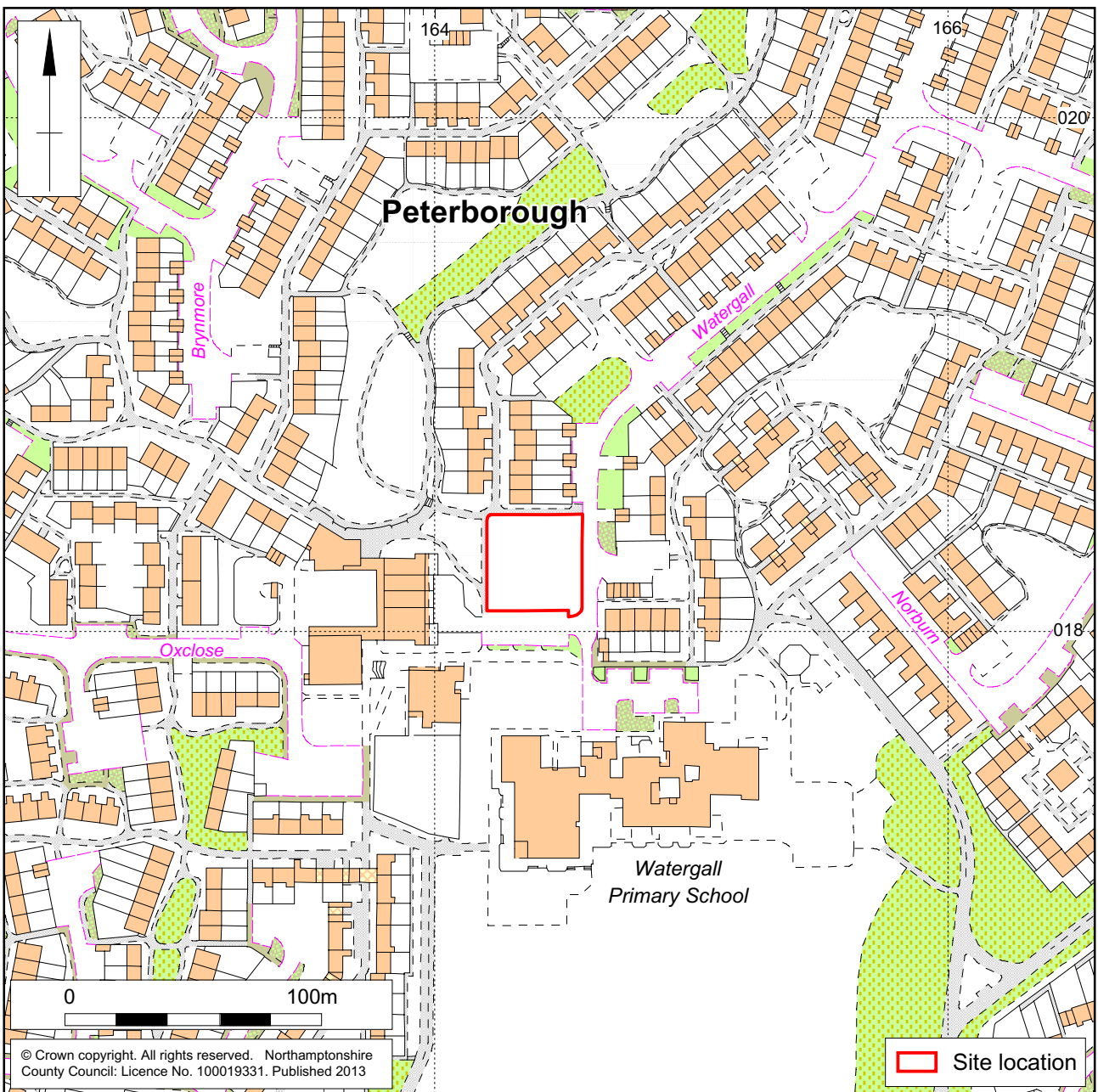

Scale 1:2500

Site Location Fig 1

2.2 Historical and archaeological background

No previous archaeological work has been carried out in the proposed development area. No Scheduled Ancient Monuments or any other designated assets are recorded within or near to the site and it is not within an area of archaeological importance.

The area evaluated lies with an extensive area of housing erected in the 1970's by the Peterborough Development Corporation. No archaeological remains were recorded during the construction works in the immediate vicinity of the current proposed development and there are no records in the Peterborough HER of earlier activity within 300m of the study area.

3 METHODOLOGY

Three trial trenches were excavated in accordance with a trench plan prepared by Northamptonshire Archaeology and approved by Rebecca Casa-Hatton (Peterborough Archaeological Advisor) (Fig 2).

The trenches measured 10m long by 1.80m-wide. The total area excavated was 54m². Trench location were recorded using a Leica system 1200 GPS.

A JCB mechanical excavator fitted with a 1.80m wide ditching bucket was used to remove overburden to archaeological levels or the natural substrate, whichever was encountered first. The trenches were cleaned sufficiently to enable the identification and definition of archaeological features. Recording followed standard NA procedures as described in the *Fieldwork Manual* (NA 2011). Deposits were described on *pro-forma* sheets to include measured and descriptive details of the context, its relationships and interpretation. Context sheets were cross-referenced to scale plans, section drawings and photographs. Photography was with 35mm black and white film, supplemented with digital images. Sections were drawn at scale 1:10 or 1:20, as appropriate and related to Ordnance Survey datum. Spoil heaps and features were scanned with a metal detector to maximise the recovery of metal objects.

All works were conducted in accordance with the Institute for Archaeologists' *Code of Conduct* (IfA 2010) and *Standard and Guidance for Archaeological Field Evaluation* (IfA 1994, revised 2008).

4 THE EXCAVATED EVIDENCE

The underlying geology of Blisworth Clay mudstone and Cornbrash was encountered between 0.20-0.45m below the modern ground surface. This occurred as mid-dark yellow-brown clay with frequent sub-angular limestone fragments. The subsoil was mid grey-brown sandy clay 0.20m thick and the topsoil was dark greyish-brown sandy clay 0.10-0.20m thick, both soils contained limestone fragments, brick and tarmac fragments (Fig 3).

An inventory of contexts is provided in the Appendix. No archaeological features were present within the trenches and no artefacts were recovered.

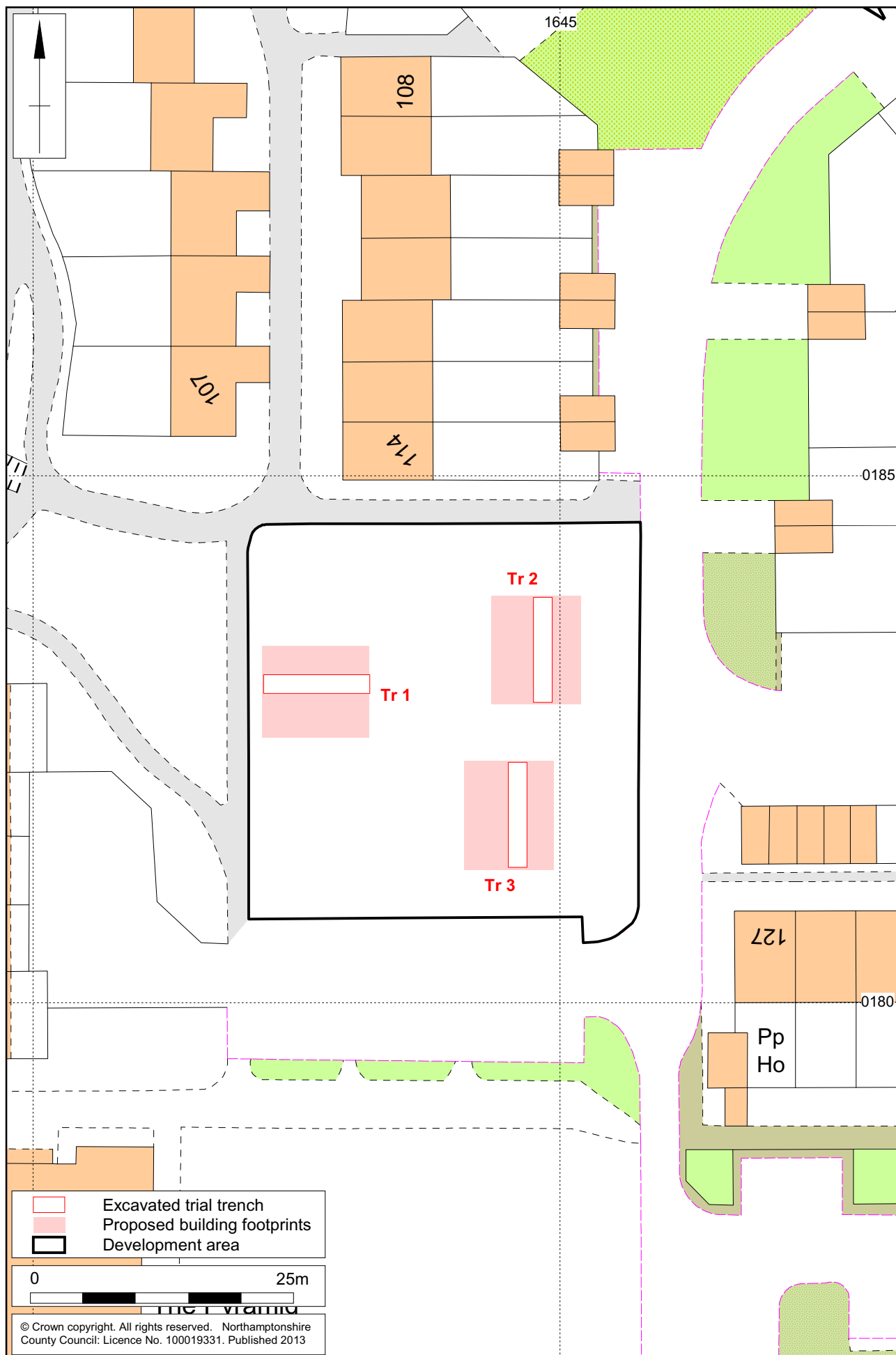

Scale 1:500 (A4)

The excavated trenches Fig 2



Trench 1, looking west

Trench 2, looking south



Trench 3, looking north



5 DISCUSSION

No archaeological features were present within the excavated trenches and no artefacts were recovered. The area had been disturbed during the construction of the housing estate during the 1970s. The topsoil had been stripped and the subsoil and natural, in places, was highly disturbed and truncated by subsequent construction and landscaping activity.

BIBLIOGRAPHY

IfA 2008 *Standard and guidance for archaeological field evaluation*, Institute for Archaeologists

IfA 2010 *Code of Conduct*, Institute for Archaeologists

NA 2011 *Archaeological Fieldwork Manual*, Northamptonshire Archaeology

NA 2013 *Written scheme of investigation for archaeological trial trenching at Watergall, Bretton, Peterborough*, Northamptonshire Archaeology

Websites

BGS <http://www.bgs.ac.uk/GeoIndex/>

APPENDIX: CONTEXT INDEX

Trench No	Length, width & alignment	NGR		
1	10m x 1.80m E to W	TL 15426 01830		
Context	Context type Feature & type	Description	Dimensions	Artefacts/ Samples
101	Topsoil	Dark brown sandy clay	0.18m thick	-
102	Subsoil	Mid brown sandy clay with frequent limestone fragment inclusion	0.20m thick	-
103	Natural	Mid orange-brown clay with limestone inclusions		-

Trench No	Length, width & alignment	NGR		
2	10m x 1.80m N to S	TL 16448 01833		
Context	Context type Feature & type	Description	Dimensions	Artefacts/ Samples
201	Topsoil	Dark brown sandy clay	0.20m thick	-
202	Subsoil	Mid brown sandy clay with frequent limestone fragment inclusion	0.20m thick	-
203	Natural	Mid orange-brown clay with limestone inclusions		-

Trench No	Length, width & alignment	NGR		
3	10m x 1.80m N to S	TL 16446 01817		
Context	Context type Feature & type	Description	Dimensions	Artefacts/ Samples
301	Topsoil	Dark brown sandy clay	0.14m thick	-
302	Subsoil	Mid brown sandy clay with frequent limestone fragment inclusion	0.21m thick	-
303	Natural	Mid orange-brown clay with limestone inclusions		-



Northamptonshire County Council

Northamptonshire Archaeology



Northamptonshire Archaeology

Bolton House
Wootton Hall Park
Northampton NN4 8BN

t. 01604 700493 f. 01604 702822

e. sparry@northamptonshire.gov.uk

w. www.northantsarchaeology.co.uk



Northamptonshire
County Council