



Northamptonshire Archaeology

Archaeological Trial Trench Evaluation at Harbury Gardens, Leamington Spa, Warwickshire



Northamptonshire Archaeology

1 Bolton House
Wootton Hall Park
Northampton NN4 8BE
t. 01604 700493 f. 01604 702822
e. sparry@northamptonshire.gov.uk
w. www.northantsarchaeology.co.uk



Northamptonshire
County Council

Chris Chinnock

Report 13/185

October 2013



STAFF

Project Manager: Adam Yates BA MIfA
Text: Chris Chinnock BA, MSc, PIfA
Fieldwork: Chris Chinnock
Peter Haynes
David Haynes
Adam Meadows BSc
Tom Garside BA
Illustrations: Amir Bassir BSc

QUALITY CONTROL

	Print name	Signed	Date
Checked by	Pat Chapman	<i>PC</i>	02/10/13
Verified by	Antony Maull	<i>AM</i>	02/10/13
Approved by	Andy Chapman	<i>AC</i>	02/10/13

OASIS REPORT FORM

PROJECT DETAILS		OASIS No: 160205	
Project name	Archaeological trial trench evaluation at Harbury Gardens, Leamington Spa, Warwickshire		
Short description (250 words maximum)	Northamptonshire Archaeology was commissioned by Prospect Archaeology on behalf of AC Lloyd Ltd to conduct an archaeological evaluation at Harbury Gardens, Leamington Spa, Warwickshire prior to a proposed residential development on the site. Forty three trenches were excavated. Most trenches were excavated as planned though a few were shortened or re-positioned to accommodate buried services or overhead cables running across the site. No features of archaeological significance were observed in any of the trenches. An old field boundary was identified and remnant furrows of medieval ridge and furrow cultivation could be seen across much of the site.		
Project type (eg DBA, evaluation etc)	Evaluation		
Site status (none, NT, SAM etc)	None		
Previous work (SMR numbers etc)	None		
Current Land use	Agriculture		
Future work (yes, no, unknown)	Unknown		
Monument type/ period	None		
Significant finds (artefact type and period)	None		
PROJECT LOCATION			
County	Warwickshire		
Site address (including postcode)	Grove Farm, Harbury Lane, Leamington Spa CV33 9QF		
Study area (sq.m or ha)	10.5 ha		
OS Easting & Northing (use grid sq. letter code)	431435 262625		
Height OD	65 – 70m aOD		
PROJECT CREATORS			
Organisation	Northamptonshire Archaeology (NA)		
Project brief originator	Warwickshire Museum Field Services		
Project Design originator	Northamptonshire Archaeology		
Director/Supervisor	Chris Chinnock		
Project Manager	Adam Yates		
Sponsor or funding body	Prospect Archaeology on behalf of AC Lloyd Ltd		
PROJECT DATE			
Start date	04/09/13		
End date	12/09/13		
ARCHIVES	Location (Accession no.)	Content (eg pottery, animal bone etc)	
Physical	N/A		
Paper	Warwickshire Museum (HGLS13)	Site file	
Digital	Warwickshire Museum (HGLS13)	Mapinfo plans, Word report	
BIBLIOGRAPHY			
Journal/monograph, published or forthcoming, or unpublished client report (NA report)			
Title	Archaeological trial trench evaluation at Harbury Gardens, Leamington Spa, Warwickshire		
Serial title & volume	13/185		
Author(s)	Chris Chinnock		
Page numbers			
Date			

Contents

- 1 INTRODUCTION**
- 2 AIMS AND OBJECTIVES**
- 3 BACKGROUND**
 - 3.1 Topography and geology**
 - 3.2 Historical and archaeological background**
- 4 EXCAVATION METHODOLOGY**
- 5 EVALUATION RESULTS**
 - 5.1 Field 1**
 - 5.2 Field 2**

- 6 DISCUSSION**

BIBLIOGRAPHY

Figures

Front cover: Trench 29 looking north-east

Fig 1: Site Location

Fig 2: Excavated Trench Locations

Fig 3: Map of 1969 showing marl pits and previous field boundary

APPENDIX: CONTEXT INVENTORY

**ARCHAEOLOGICAL TRIAL TRENCH EVALUATION AT
HARBURY GARDENS, ROYAL LEAMINGTON SPA, WARWICKSHIRE
SEPTEMBER 2013**

Abstract

Northamptonshire Archaeology was commissioned by Prospect Archaeology on behalf of AC Lloyd Ltd to conduct an archaeological evaluation at Harbury Gardens, Leamington Spa, Warwickshire prior to a proposed residential development on the site. Forty-three trenches were excavated. Most trenches were excavated as planned though a few were shortened or re-positioned to accommodate buried services or overhead cables running across the site. No features of archaeological significance were observed in any of the trenches. An old field boundary was identified and remnant furrows of medieval ridge and furrow cultivation could be seen across much of the site.

1 INTRODUCTION

In September 2013, Northamptonshire Archaeology (NA) was commissioned by Prospect Archaeology on behalf of AC Lloyd Ltd to conduct an archaeological evaluation at Harbury Gardens, Leamington Spa, Warwickshire (NGR 431435 262625).

The site lies within an area of potential archaeological interest and sensitivity due to the close proximity of known prehistoric find spots and Iron Age sites. Consequently a programme of archaeological evaluation within the area of the proposed development was required. The requirements were outlined in a Written Scheme of Investigation prepared by Northamptonshire Archaeology (2013).

2 AIMS AND OBJECTIVES

The evaluation of the site was designed to provide information that will allow for the effective targeting of further investigation of the site, if required, prior to or during the early phases of its development.

The following information was required to allow the development of a strategy for further investigation of the site:

- *The location, extent, nature, and date of any archaeological features or deposits that may be present;*
- *The integrity and state of preservation of any archaeological features or deposits that may be present.*

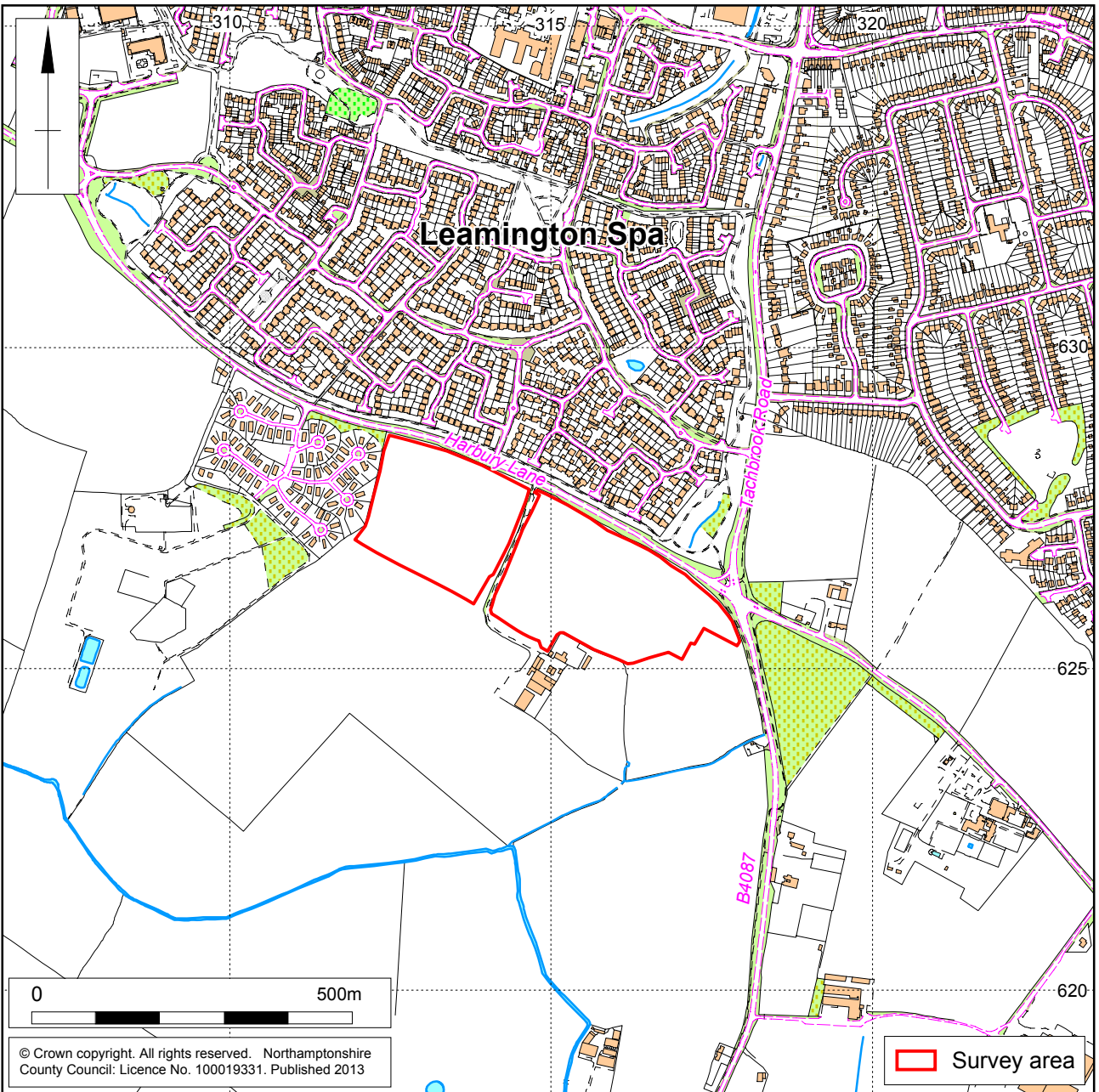
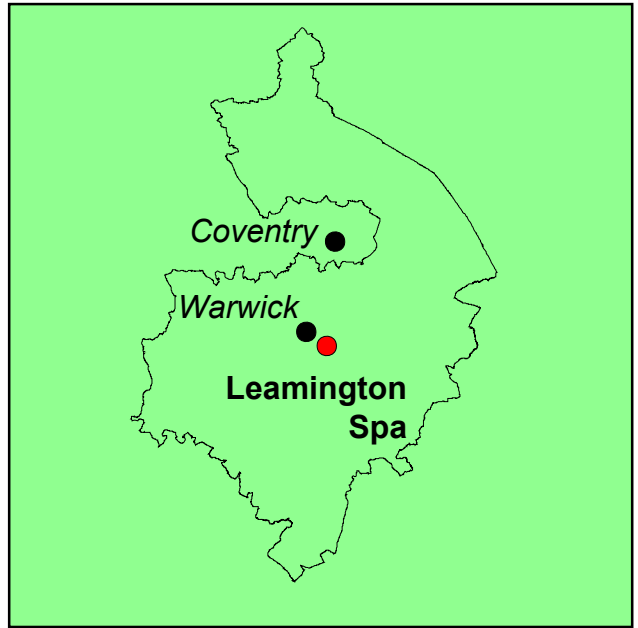
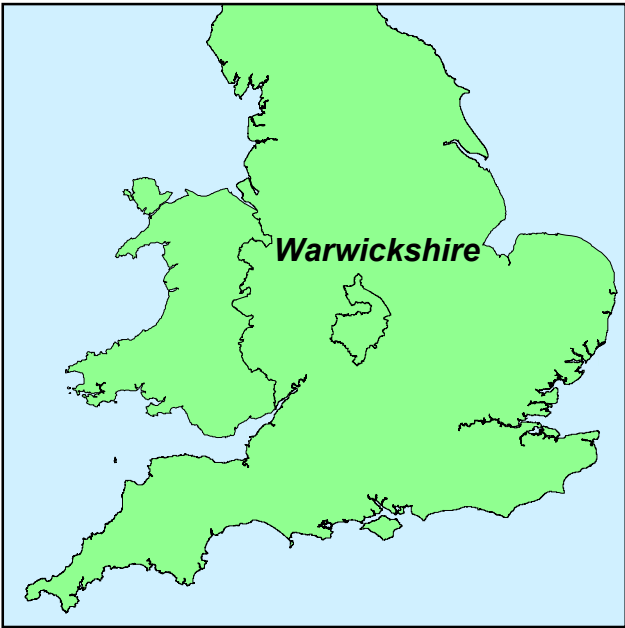

Scale 1:10,000

Site Location Fig 1

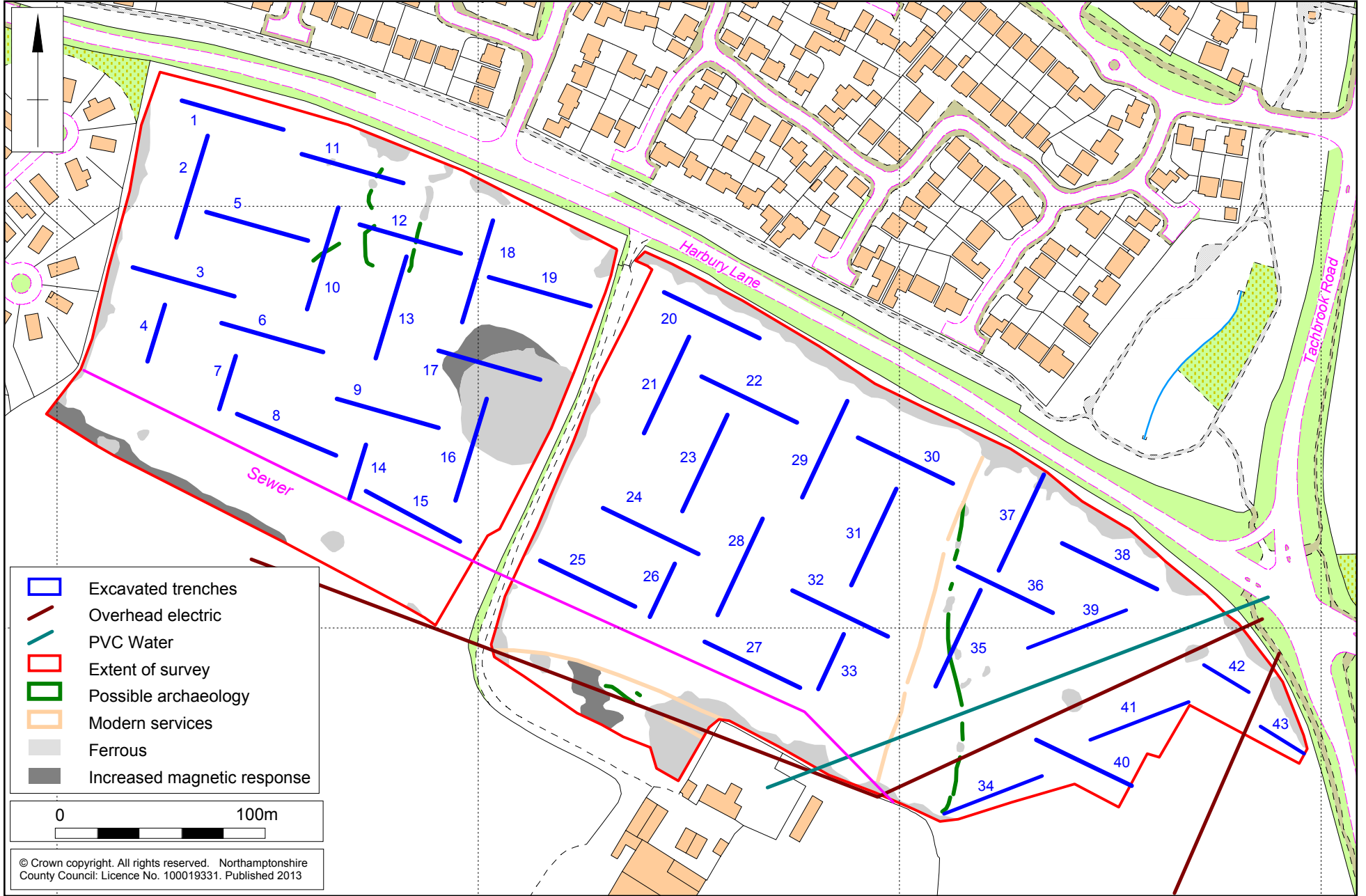

Excavated trench locations

Fig 2

© Crown copyright. All rights reserved. Northamptonshire County Council: Licence No. 100019331. Published 2013

The evaluation was carried following the guidelines suggested by the *IfA*'s standards and guidance for archaeological field evaluation (IfA 2008), and the Northamptonshire Archaeology Fieldwork Manual (NA 2011).

3 BACKGROUND

3.1 Topography and geology

Royal Leamington Spa lies about three miles to the east of Warwick in central Warwickshire. The proposed development occupies approximately 10.5ha of land, located on the south side of Royal Leamington Spa and bounded to the north by Harbury Lane, modern housing to the west, with agricultural land to the south and east (Fig 1). The site is gently undulating between 65m-70m aOD, the solid geology comprises Mercia Mudstones overlain by localised deposits of river terrace gravels (BGS1984).

3.2 Historical and archaeological background

The proposed development area lies within an area of archaeological potential. Prehistoric worked flints were recovered from Tachbrook Mallory to the south and Heathcote Home Farm to the north. A banjo enclosure and a trackway of Iron Age date are present at Heathcote Home Farm 500m to the west (HER MWA4561). An Iron Age gold coin is also recorded 150m east of the site (HER MWA1480). To the south of the site is the shrunken medieval village of Bishops Tachbrook. Post-medieval quarrying is present at grove Farm immediately to the south of the site.

A geophysical survey of the site identified a number of possible anomalies thought to represent previous agricultural activity as well as modern services (Wessex Archaeology 2013). Two anomalies cross the site north to south. The western anomaly is very straight and incorporates the classic dipolar signature of a buried metallic pipe. The eastern curvilinear anomaly corresponds with a boundary shown on the mid 19th Century tithe map of Bishops Tachbrook, this can also be seen as a cropmark in recent aerial photographs.

4 EXCAVATION METHODOLOGY

Forty-three trenches were excavated using a tracked mechanical excavator fitted with a 1.8m-wide toothless ditching bucket. All trenches, where possible, were excavated to their full extent which was 50m. A number of trenches (4, 7, 14, 26 and 33) were shortened to 25m to accommodate a pressurised asbestos sewer pipe stretching across the southern edge of the development area (Fig 2). A 3m section of Trench 36 was left unexcavated as a result of overhead cables impeding the safe working area of the excavator.

The topsoil and subsoil were removed under archaeological direction to reveal natural substrate. The topsoil and subsoil were stacked separately at the side of the excavated area. All procedures complied with Northamptonshire County Council

Health and Safety provisions and Northamptonshire Archaeology Health and Safety at Work Guidelines.

The excavated area was cleaned sufficiently to define any features. The excavated area and spoil heaps were scanned with a metal detector to ensure maximum finds retrieval.

All archaeological deposits encountered during the course of the excavation were fully recorded, following standard NA procedures (NA 2011). All deposits were given a separate context number in a sequence continuing from those allocated during the evaluation. They were described on *pro-forma* context sheets to include details of the context, its relationships and interpretation. Unstratified animal bones and modern material were not retained.

The location of the trenches were surveyed and related to the Ordnance Survey National Grid. A full photographic record comprising both 35mm black and white negatives and digital images was maintained. The field data from the evaluation has been compiled into a site archive with appropriate cross-referencing.

The evaluation conformed to the Institute for Archaeologists *Standard and guidance for archaeological field evaluation* (revised Oct 2008). All stages of the project were undertaken in accordance with English Heritage, *Management of Research Projects in the Historic Environment* (MoRPHE) (EH 2006). The evaluation was carried out in accordance with Written Scheme of Investigation (WSI) prepared by Northamptonshire Archaeology (NA 2013).

All trenches were backfilled with their up-cast, lightly compacted by the mechanical excavator.

5 EVALUATION RESULTS

The proposed area for development was split into two fields by the farm access road. Field 1 lies to the west of the road and Field 2 to the east (Fig 2).

5.1 Field 1

There is a sharp change in geology from the red clay observed in Field 2 to the soft light sand extending to the west and south. The boundary between the two runs roughly from the middle of the northern edge of Field 1 to its south-east corner.

Possible archaeological features identified as a result of the geophysical survey (Fig 2), upon excavation, related to dense pockets of gravel in the natural substrate. Occasional patches of root action and possible tree boles were identified in Trench 10 which may also relate to geophysical anomalies in this area.

Evidence for medieval ridge and furrow cultivation can be seen against the red clay in the eastern part of the field. The furrows are aligned roughly north-east to south-west though the full extent cannot be determined as the furrows are not visible where the natural comprised loose light sand.

A large area of magnetic noise seen in the geophysical data was identified as a large pit visible in Trenches 16 and 17. In Trench 17, 20m of the pit [1704] is visible cutting through homogeneous red clay natural (1705). The backfill of the pit comprises dark grey silty clay with modern tile, brick and other domestic/farmyard debris throughout. This is overlain by a 0.35-0.45m thick deposit of mid brown silty clay-loam topsoil (1702), presumably an original effort to return the area to an agricultural use. The present landowner has subsequently spread another deposit of externally sourced mid brown silty clay-loam topsoil across the whole north-east corner of Field 1 to further level this area of the field (1701, 1901). This level varies between 0.30m and 0.45m and can be seen in Trench 17 and Trench 19.

5.2 Field 2

A field boundary identified in the geophysical survey, cartographic record and aerial photographs crosses the field roughly north to south as a sinuous linear (Figs 2 and 3). A 2.5m wide ditch, relating to this boundary was observed running obliquely across Trench 35 [3504] and again at the north-west end of Trench 36. Root action and disturbed natural parallel to the northern edge of the ditch may represent a hedgeline following the line of the ditch.

Remnant furrows of medieval ridge and furrow cultivation can be seen on both sides of the old field boundary. To the west of the boundary the furrows are aligned roughly north-west to south-east. To the east they are closer to an east to west alignment, shown as extant earthworks in a 1945 aerial photograph for the area, at which time the field boundary was still in place.

6 DISCUSSION

The trial trench evaluation confirms the presence of medieval ridge and furrow cultivation across the area of proposed development. A field boundary removed sometime after 1945 was observed in two trenches (35 and 36) in Field 2. No further archaeology was observed in any of the excavated trenches.

The presence of a large pit was confirmed on the eastern edge of Field 1. This was backfilled with assorted farm related debris and the area levelled with two deposits of topsoil. The pit probably started life as an extraction pit, taking advantage of the glacial drift clays present across much of the site. The clay removed from the pit would have been used to 'marl' the light sandy soils present to the west and south of the development area. The practice of 'marling' helped bulk out lighter soils and neutralise more acidic soils. The process had largely disappeared by the end of the 19th century due to more readily available and less labour intensive methods of managing soil productivity (Mathew 1993). The pit therefore probably existed as a pond for some time before being backfilled in the second half of the 20th century. This and other similar pits can be seen in adjacent fields, as marked on a 1969 map provided by the landowner (Fig 3).

The trenching did not identify any features correlating to the 'trends' highlighted in the geophysical survey report (Wessex 2013). This suggests that the trends are not of archaeological significance. They are more probably spurious features arising from, anomalies present within the ploughsoil or changes in the natural geology and an over-interpretation of the geophysical data (cf EH 2008, 49).



Map of 1969 showing marl pits and previous field boundary Fig 3

BIBLIOGRAPHY

- BGS 1984 *Map sheet 184 (Warwick)*, 1:50,000 series, British Geological Survey
- DCLG 2012 *National Planning Policy Framework*, Department of Communities and Local Government
- EH 2006 *Management of Research Projects in the Historic Environment: The MoRPHE Project Managers Guide*, English Heritage
- EH 2008 *Geophysical Survey in Archaeological Field Evaluation*, English Heritage
- IfA 2008 *Standard and guidance for archaeological field evaluation*, Institute for Archaeologists
- Mathew, W M, 1993 Marling in British Agriculture: A Case of Partial Identity, *Agricultural History Review*, **41**, 97-110
- NA 2011 *Archaeological Fieldwork Manual*, Northamptonshire Archaeology
- NA 2013 *Written Scheme of Investigation for Archaeological Field Evaluation Harbury Gardens, Royal Leamington Spa, Warwickshire*, Northamptonshire Archaeology
- SSEW 1983 *Soils of England and Wales*, Sheet 3, Soil Survey of England and Wales 1:250,000
- Watt, S, 2011 *The Archaeology of the West Midlands: A Framework for Research*, Oxbow Books
- Wessex Archaeology 2013 *Harbury Gardens, Leamington Spa, Warwickshire, Detailed Gradiometer Survey Report*, Wessex Archaeology, **87950.01**.

WEBSITES

www.bgs.ac.uk/geoindex/home.html

APPENDIX: CONTEXT INVENTORY

Trench 1	Length, Width & Alignment 50mx1.8m E-W		Surface Height (SE End) 70.71m aOD	Depth & Height of Natural 0.40m 70.31m aOD
Context	Context Type	Description	Dimensions	Artefacts/Samples
101	Topsoil	Loose, dark grey-brown silty clay-loam. Occasional small stones throughout	0.25m thick	None
102	Subsoil	Loose mid-dark brown-orange sand with occasional small stones throughout.	0.15m thick	None
103	Natural	Loose, soft light-mid brown-yellow sand with moderate gravel throughout.	0.10-0.20m visible	None

Trench 2	Length, Width & Alignment 50mx1.8m N-S		Surface Height (NE End) 70.20m aOD	Depth & Height of Natural 0.40m 69.80m aOD
Context	Context Type	Description	Dimensions	Artefacts/Samples
201	Topsoil	Loose, dark grey-brown silty clay-loam. Occasional small stones throughout	0.30m thick	None
202	Subsoil	Loose mid-dark brown-orange sand with occasional small stones throughout.	0.10m thick	None
203	Natural	Loose, soft light-mid brown-yellow sand with occasional small stones throughout.	0.05-0.15m visible	None

Trench 3	Length, Width & Alignment 50mx1.8m E-W		Surface Height (NW End) 69.63m aOD	Depth & Height of Natural 0.40m 69.23m aOD
Context	Context Type	Description	Dimensions	Artefacts/Samples
301	Topsoil	Loose, dark grey-brown silty clay-loam. Occasional small stones throughout	0.25m thick	None
302	Subsoil	Loose mid-dark brown-orange sand with occasional small stones throughout.	0.15m thick	None
303	Natural	Loose, soft light-mid brown-yellow sand with occasional small stones	0.15-0.20m visible	None

		throughout.		
Trench 4	Length, Width & Alignment 25mx1.8m N-S		Surface Height (NE End) 69.87m aOD	Depth & Height of Natural 0.40m 69.47m aOD
Context	Context Type	Description	Dimensions	Artefacts/Samples
401	Topsoil	Loose, dark grey-brown silty clay-loam. Occasional small stones throughout	0.30m thick	None
402	Subsoil	Loose mid-dark brown-orange sand with occasional small stones throughout.	0.10m thick	None
403	Natural	Loose, soft light-mid brown-yellow sand with occasional small stones throughout.	0.10-0.15m visible	None

Trench 5	Length, Width & Alignment 50mx1.8m E-W		Surface Height (SE End) 70.97m aOD	Depth & Height of Natural 0.45m 70.52m aOD
Context	Context Type	Description	Dimensions	Artefacts/Samples
501	Topsoil	Loose, dark grey-brown silty clay-loam. Moderate small stones throughout	0.30m thick	None
502	Subsoil	Loose mid-dark brown-orange sand with occasional small stones throughout.	0.15m thick	None
503	Natural	Loose, soft light-mid brown-yellow sand with occasional-moderate small stones throughout.	0.05-0.15m visible	None

Trench 6	Length, Width & Alignment 50mx1.8m E-W		Surface Height (SE End) 71.10m aOD	Depth & Height of Natural 0.40m 70.70m aOD
Context	Context Type	Description	Dimensions	Artefacts/Samples
601	Topsoil	Loose, dark grey-brown silty clay-loam. Moderate small stones throughout	0.30m thick	None
602	Subsoil	Loose mid-dark brown-orange sand with occasional small stones throughout.	0.10m thick	None
603	Natural	Loose, soft light-mid brown-yellow sand with occasional small stones throughout.	0.10-0.15m visible	None

Trench 7	Length, Width & Alignment 25mx1.8m N-S		Surface Height (NE End) 70.42m aOD	Depth & Height of Natural 0.40m 70.02m aOD
Context	Context Type	Description	Dimensions	Artefacts/Samples
701	Topsoil	Loose, dark grey-brown silty clay-loam. Moderate small stones throughout.	0.30m thick	None
702	Subsoil	Loose mid-dark brown-orange sand with occasional small stones throughout.	0.10m thick	None
703	Natural	Loose, soft light-mid brown-yellow sand with occasional-moderate small stones throughout.	0.10-0.15m visible	None

Trench 8	Length, Width & Alignment 50mx1.8m E-W		Surface Height (NW End) 70.34m aOD	Depth & Height of Natural 0.35m 69.99m aOD
Context	Context Type	Description	Dimensions	Artefacts/Samples
801	Topsoil	Loose, dark grey-brown silty clay-loam. Moderate small stones throughout.	0.25m thick	None
802	Subsoil	Loose mid-dark brown-orange sand with occasional small stones throughout.	0.10m thick	None
803	Natural	Loose, soft light-mid brown-yellow sand with occasional-moderate small stones throughout.	0.10-0.15m visible	None

Trench 9	Length, Width & Alignment 50mx1.8m E-W		Surface Height (SE End) 72.16m aOD	Depth & Height of Natural 0.35m 71.81m aOD
Context	Context Type	Description	Dimensions	Artefacts/Samples
901	Topsoil	Loose, dark grey-brown silty clay-loam. Moderate small stones throughout.	0.25m thick	None
902	Subsoil	Loose mid-dark brown-orange sand with occasional small stones throughout.	0.10m thick	None
903	Natural	Loose, soft light-mid brown-yellow sand with occasional-moderate small stones throughout.	0.10m visible	None

Trench 10	Length, Width & Alignment 50mx1.8m N-S		Surface Height (SW End) 70.95m aOD	Depth & Height of Natural 0.42m 70.53m aOD
Context	Context Type	Description	Dimensions	Artefacts/Samples
1001	Topsoil	Loose, dark grey-brown silty clay-loam. Moderate small stones throughout.	0.32m thick	None
1002	Subsoil	Loose mid-dark brown-orange sand with occasional small stones throughout.	0.10m thick	None
1003	Natural	Medium-firm, mid brown-orange sand with occasional small stones throughout. Patches of rooting and bands of gravel.	0.10m visible	None

Trench 11	Length, Width & Alignment 50mx1.8m N-S		Surface Height (NW End) 70.86m aOD	Depth & Height of Natural 0.40m 70.46m aOD
Context	Context Type	Description	Dimensions	Artefacts/Samples
1101	Topsoil	Loose, dark grey-brown silty clay-loam. Moderate small stones throughout.	0.30m thick	None
1102	Subsoil	Loose, mid brown-orange sand with occasional small stones throughout. Only visible in the western half of the trench overlying the sand natural.	0.10m thick	None
1103	Natural	Firm/plastic mid red-brown clay in the eastern end of the trench. Friable mid brown-yellow sand in the rest of the trench.	0.05-0.15m visible	None

Trench 12	Length, Width & Alignment 50mx1.8m E-W		Surface Height (SE End) 70.62m aOD	Depth & Height of Natural 0.30m 70.32m aOD
Context	Context Type	Description	Dimensions	Artefacts/Samples
1201	Topsoil	Loose, dark grey-brown silty clay-loam. Moderate small stones throughout.	0.30m thick	None
1202	Natural	Firm/plastic mixed mid red-brown-grey sandy clay and gravel. Moderate small stones throughout. Furrows and land drains evenly spaced aligned north-south throughout the trench.	0.05-0.15m visible	None

Trench 13	Length, Width & Alignment 50mx1.8m N-S		Surface Height (NW End) 71.40m aOD	Depth & Height of Natural 0.35m 71.05m aOD
Context	Context Type	Description	Dimensions	Artefacts/Samples
1301	Topsoil	Loose, dark grey-brown silty clay-loam. Moderate small stones throughout.	0.25m thick	None
1302	Subsoil	Firm/friable mid red-brown-orange sandy clay with occasional small stones throughout.	0.10m thick	None
1303	Natural	Firm/compact mid red-brown clay with occasional small stones throughout. One furrow observed running the length of the trench aligned north-south.	0.05m thick	None

Trench 14	Length, Width & Alignment 25mx1.8m N-S		Surface Height (NE End) 71.71m aOD	Depth & Height of Natural 0.32m 71.39m aOD
Context	Context Type	Description	Dimensions	Artefacts/Samples
1401	Topsoil	Loose, dark grey-brown silty clay-loam. Moderate small stones throughout.	0.25m thick	None
1402	Subsoil	Loose mid dark brown-orange sand with occasional small stones throughout	0.10m thick	None
1403	Natural	Loose, soft light-mid brown-yellow sand with occasional small stones.	0.05-0.10m visible	None

Trench 15	Length, Width & Alignment 50mx1.8m E-W		Surface Height (SE End) 71.80m aOD	Depth & Height of Natural 0.38m 71.42m aOD
Context	Context Type	Description	Dimensions	Artefacts/Samples
1501	Topsoil	Loose, dark grey-brown silty clay-loam. Moderate small stones throughout.	0.28m thick	None
1502	Subsoil	Loose soft mid brown-orange sand with occasional small stones throughout.	0.10m thick	None
1503	Natural	Loose, soft, light-mid brown-yellow sand with occasional small stones. Changes to firm red-brown clay in the eastern half of the trench.	0.05-0.15m visible	None

Trench 16	Length, Width & Alignment 50mx1.8m N-S		Surface Height (NW End) 72.23m aOD	Depth & Height of Natural 0.30m 71.93m aOD
Context	Context Type	Description	Dimensions	Artefacts/Samples
1601	Topsoil	Loose, dark grey-brown silty clay-loam. Moderate small stones throughout.	0.30m thick	None
1602	Natural	Firm mid brown-red sandy clay with moderate small stones throughout.	0.05-0.10m visible	None
1603	Fill	Homogeneous loose mid brown sandy silt-clay with occasional small stones throughout.	0.25m visible in trench section	None
1604	Cut	Edge of post-medieval extraction pit. Visible at the northern end of the trench.	2-3m visible in plan	None

Trench 17	Length, Width & Alignment 50mx1.8m E-W		Surface Height (NW End) 71.53m aOD	Depth & Height of Natural 0.25m 71.28m aOD
Context	Context Type	Description	Dimensions	Artefacts/Samples
1701	Topsoil	Loose, dark grey-brown silty clay-loam. Moderate small stones throughout.	0.25-0.45m thick	None
1702	Buried Topsoil	Firm/friable mid brown silty clay with moderate small stones throughout.	0.42m thick	None
1703	Pit backfill	Firm dark grey mixed material. Silty clay with varied construction debris and other modern detritus (brick, tile, glass, pottery) throughout.	0.10m exposed	None
1704	Pit cut	Cut of large post medieval/modern extraction pit.	22m visible in plan	None
1705	Natural	Firm-compact mid red-brown sandy clay with moderate stone inclusions throughout.	0.06-0.15m visible	None

Trench 18	Length, Width & Alignment 50mx1.8m N-S		Surface Height (NE End) 70.40m aOD	Depth & Height of Natural 0.30m 70.10m aOD
Context	Context Type	Description	Dimensions	Artefacts/Samples
1801	Topsoil	Loose, dark grey-brown silty clay-loam. Moderate small stones throughout.	0.30m thick	None
1802	Natural	Firm/compact mid red-brown clay with occasional small stones. Some patches of gravel and sand.	0.05m visible	None

Trench 19	Length, Width & Alignment 50mx1.8m E-W		Surface Height (SE End) 70.53m aOD	Depth & Height of Natural 0.50m 70.03m aOD
Context	Context Type	Description	Dimensions	Artefacts/Samples
1901	Topsoil	Loose, dark grey-brown silty clay-loam. Moderate small stones throughout.	0.30m thick	None
1902	Buried Topsoil	Mid-dark grey-brown silty clay loam with occasional small stones throughout.	0.08-0.20m thick	None
1903	Natural	Compact mid red-brown clay with occasional small stones throughout.	0.05-0.10m visible	None

Trench 20	Length, Width & Alignment 50mx1.8m SE-NW		Surface Height (NW End) 69.23m aOD	Depth & Height of Natural 0.35m 68.88m aOD
Context	Context Type	Description	Dimensions	Artefacts/Samples
2001	Topsoil	Loose, dark grey-brown silty clay-loam. Moderate small stones throughout.	0.25m thick	None
2002	Subsoil	Friable mid orange-brown sandy clay.	0.10m thick	None
2003	Natural	Compact mid red-brown clay with occasional small stones.	0.05m thick	None

Trench 21	Length, Width & Alignment 50mx1.8m NE-SW		Surface Height (NE End) 69.15m aOD	Depth & Height of Natural 0.30m 68.85m aOD
Context	Context Type	Description	Dimensions	Artefacts/Samples
2101	Topsoil	Loose, dark grey-brown silty clay-loam. Moderate small stones throughout.	0.30m thick	None
2102	Natural	Compact mid red-brown clay with occasional small stones. Furrows visible aligned east-west.	0.05-0.10m visible	None

Trench 22	Length, Width & Alignment 50mx1.8m SE-NW		Surface Height (NW End) 68.87m aOD	Depth & Height of Natural 0.40m 68.47m aOD
Context	Context Type	Description	Dimensions	Artefacts/Samples
2201	Topsoil	Loose, dark grey-brown silty clay-loam. Moderate small stones throughout.	0.25m thick	None
2202	Subsoil	Friable mid orange-brown sandy clay.	0.15m thick	None
2203	Natural	Compact mid red-brown clay with occasional small stones.	0.02-0.10m visible	None

Trench 23	Length, Width & Alignment 50mx1.8m NE-SW		Surface Height (NE End) 69.15m aOD	Depth & Height of Natural 0.35m 68.70m aOD
Context	Context Type	Description	Dimensions	Artefacts/ Samples
2301	Topsoil	Loose, dark grey-brown silty clay-loam. Moderate small stones throughout.	0.25m thick	None
2302	Subsoil	Friable mid orange-brown sandy clay.	0.10m thick	None
2303	Natural	Compact mid red-brown clay with occasional small stones. Furrows visible aligned east-west throughout the trench.	0.05m thick	None

Trench 24	Length, Width & Alignment 50mx1.8m SE-NW		Surface Height (NW End) 69.98m aOD	Depth & Height of Natural 0.35m 69.63m aOD
Context	Context Type	Description	Dimensions	Artefacts/ Samples
2401	Topsoil	Loose, dark grey-brown silty clay-loam. Moderate small stones throughout.	0.25m thick	None
2402	Subsoil	Friable mid orange-brown sandy clay.	0.10m thick	None
2403	Natural	Compact mid red-brown clay with occasional small stones.	0.05-0.20m visible	None

Trench 25	Length, Width & Alignment 50mx1.8m SE-NW		Surface Height (NW End) 70.64m aOD	Depth & Height of Natural 0.35m 70.29m aOD
Context	Context Type	Description	Dimensions	Artefacts/ Samples
2501	Topsoil	Loose, dark grey-brown silty clay-loam. Moderate small stones throughout.	0.25m thick	None
2502	Subsoil	Friable mid orange-brown sandy clay.	0.10m thick	None
2503	Natural	Compact mid red-brown clay with occasional small stones.	0.10m visible	None

Trench 26	Length, Width & Alignment 25mx1.8m NE-SW		Surface Height (NE End) 68.49m aOD	Depth & Height of Natural 0.35m 68.14m aOD
Context	Context Type	Description	Dimensions	Artefacts/Samples
2601	Topsoil	Loose, dark grey-brown silty clay-loam. Moderate small stones throughout.	0.30m thick	None
2602	Subsoil	Friable mid orange-brown sandy clay.	0.05m thick	None
2603	Natural	Compact mid red-brown clay with occasional small stones. Furrows visible aligned east-west throughout the trench.	0.03-0.10m visible	None

Trench 27	Length, Width & Alignment 50mx1.8m SE-NW		Surface Height (NW End) 68.08m aOD	Depth & Height of Natural 0.40m 67.68m aOD
Context	Context Type	Description	Dimensions	Artefacts/Samples
2701	Topsoil	Loose, dark grey-brown silty clay-loam. Moderate small stones throughout.	0.30m thick	None
2702	Subsoil	Friable mid orange-brown sandy clay.	0.10m thick	None
2703	Natural	Firm mid-light brown-orange sand with moderate gravely inclusions and patches of red clay and degraded sandstone.	0.05-0.20m visible	None

Trench 28	Length, Width & Alignment 50mx1.8m NE-SW		Surface Height (SW End) 67.97m aOD	Depth & Height of Natural 0.45m 67.52m aOD
Context	Context Type	Description	Dimensions	Artefacts/Samples
2801	Topsoil	Loose, dark grey-brown silty clay-loam. Moderate small stones throughout.	0.30m thick	None
2802	Subsoil	Friable mid orange-brown sandy clay.	0.15m thick	None
2803	Natural	Firm mid-light red-orange sand with patches of degraded sandstone and red clay.	0.05-0.20m visible	None

Trench 29	Length, Width & Alignment 50mx1.8m NE-SW		Surface Height (SW End) 67.74m aOD	Depth & Height of Natural 0.45m 67.29m aOD
Context	Context Type	Description	Dimensions	Artefacts/ Samples
2901	Topsoil	Loose, dark grey-brown silty clay-loam. Moderate small stones throughout.	0.30m thick	None
2902	Subsoil	Friable mid orange-brown sandy clay.	0.15m thick	None
2903	Natural	Firm mid-light white-brown sand with patches of red clay.	0.20-0.30m visible	None

Trench 30	Length, Width & Alignment 50mx1.8m NW-SE		Surface Height (NW End) 67.93m aOD	Depth & Height of Natural 0.40m 67.53m aOD
Context	Context Type	Description	Dimensions	Artefacts/ Samples
3001	Topsoil	Loose, dark grey-brown silty clay-loam. Moderate small stones throughout.	0.30m thick	None
3002	Subsoil	Friable mid orange-brown sandy clay.	0.10m thick	None
3003	Natural	Firm mid mottled grey-brown-orange sand with frequent degraded sandstone throughout.	0.20-0.40m visible	None

Trench 31	Length, Width & Alignment 50mx1.8m NE-SW		Surface Height (NE End) 67.21m aOD	Depth & Height of Natural 0.45m 66.76m aOD
Context	Context Type	Description	Dimensions	Artefacts/ Samples
3101	Topsoil	Loose, dark grey-brown silty clay-loam. Moderate small stones throughout.	0.30m thick	None
3102	Subsoil	Friable mid orange-brown sandy clay.	0.15m thick	None
3103	Natural	Firm mid light grey-orange clay sand with moderate degraded sandstone throughout. Stone less prevalent toward the north end of trench.	0.10-0.40m visible	None

Trench 32	Length, Width & Alignment 50mx1.8m N-S		Surface Height (SE End) 63.43m aOD	Depth & Height of Natural 0.45m 62.98m aOD
Context	Context Type	Description	Dimensions	Artefacts/Samples
3201	Topsoil	Loose, dark grey-brown silty clay-loam. Moderate small stones throughout.	0.30m thick	None
3202	Subsoil	Friable mid orange-brown sandy clay.	0.15m thick	None
3203	Natural	Firm orange-red sand with areas of degraded sandstone.	0.05-0.25m visible	None

Trench 33	Length, Width & Alignment 30mx1.8m NE-SW		Surface Height (NE End) 67.08m aOD	Depth & Height of Natural 0.40m 66.68m aOD
Context	Context Type	Description	Dimensions	Artefacts/Samples
3301	Topsoil	Loose, dark grey-brown silty clay-loam. Moderate small stones throughout.	0.25m thick	None
3302	Subsoil	Firm light red-brown sand with rare small stones throughout.	0.15m thick	None
3303	Natural	Firm light red-orange sand with moderate gravelly inclusions.	0.05-0.25m visible	None

Trench 34	Length, Width & Alignment 50mx1.8m ENE-WSW		Surface Height (SW End) 63.59m aOD	Depth & Height of Natural 0.62m 62.97m aOD
Context	Context Type	Description	Dimensions	Artefacts/Samples
3401	Topsoil	Loose, dark grey-brown silty clay-loam. Moderate small stones throughout.	0.23-0.35m thick	None
3402	Subsoil	Firm light red-brown sand with rare small stones throughout.	0.11-0.27m thick	None
3403	Natural	Firm mid light red-brown sandy clay. Changes to red clay with sandstone in the north east half of the trench.	0.06-0.19m visible	None

Trench 35	Length, Width & Alignment 50mx1.8m NE-SW		Surface Height (NE End) 66.41m aOD	Depth & Height of Natural 0.30m 66.11m aOD
Context	Context Type	Description	Dimensions	Artefacts/Samples
3501	Topsoil	Loose, dark grey-brown silty clay-loam. Moderate small stones throughout.	0.30m thick	None
3502	Subsoil	Firm light red-brown sand with rare small stones throughout.	0.10m thick	None
3503	Natural	Firm mid red clay-sand with rare stones throughout.	0.05-0.10m visible	None
3504	Cut of ditch	Cut of field boundary identified on maps and geophysical survey results.	2.5-3m visible in plan	None
3505	Fill	Compact mixed mid-dark brown silty clay with root disturbance, occasional charcoal and stones observed throughout.	2.5-3m visible in plan	None

Trench 36	Length, Width & Alignment 47mx1.8m NW-SE		Surface Height (SE End) 66.88m aOD	Depth & Height of Natural 0.45m 66.43m aOD
Context	Context Type	Description	Dimensions	Artefacts/Samples
3601	Topsoil	Friable dark grey-brown sandy soil with occasional small stones throughout.	0.25m thick	None
3602	Subsoil	Firm mid light brown-grey silty sandy clay with rare small stones and charcoal flecks throughout.	0.20m thick	None
3603	Natural	Firm mid red-orange clay-sand with occasional to moderate small gravelly stones, becomes stonier towards the east. Changes to degraded sandstone at the eastern end.	0.01-0.30m visible	None

Trench 37	Length, Width & Alignment 50mx1.8m NE-SW		Surface Height (SW End) 66.79m aOD	Depth & Height of Natural 0.45m 66.34m aOD
Context	Context Type	Description	Dimensions	Artefacts/Samples
3701	Topsoil	Friable dark grey-brown sandy soil with occasional small stones throughout.	0.35m thick	None
3702	Subsoil	Friable mid brown-red silty sand with rare small stone inclusions.	0.10m thick	None
3703	Natural	Firm mid light red-brown sand with areas of degraded sandstone. Furrows observed aligned east-west.	0.10-0.20m visible	None

Trench 38	Length, Width & Alignment 50mx1.8m NW-SE		Surface Height (NW End) 67.60m aOD	Depth & Height of Natural 0.42m 67.18m aOD
Context	Context Type	Description	Dimensions	Artefacts/Samples
3801	Topsoil	Friable dark grey-brown sandy soil with occasional small stones throughout.	0.30m thick	None
3802	Subsoil	Friable mid brown-red silty sand with rare small stone inclusions.	0.12m thick	None
3803	Natural	Firm light brown-white sand with moderate small gravelly inclusions and patches of degraded sandstone. Furrow aligned roughly north east to south west.	0.06-0.15m visible	None

Trench 39	Length, Width & Alignment 50mx1.8m ENE-WSW		Surface Height (SW End) 66.07m aOD	Depth & Height of Natural 0.32m 65.75m aOD
Context	Context Type	Description	Dimensions	Artefacts/Samples
3901	Topsoil	Friable dark grey-brown sandy soil with occasional small stones throughout.	0.35m thick	None
3902	Subsoil	Friable mid brown-red silty sand with rare small stone inclusions.	0.10m thick	None
3903	Natural	Firm light brown clay-sand with sandstone and red clay at the south-west end. One furrow observed aligned roughly east-west	0.10-0.20m visible	None

Trench 40	Length, Width & Alignment 50mx1.8m NW-SE		Surface Height (NW End) 65.80m aOD	Depth & Height of Natural 0.46m 65.34m aOD
Context	Context Type	Description	Dimensions	Artefacts/Samples
4001	Topsoil	Friable dark grey-brown sandy soil with occasional small stones.	0.34m thick	None
4002	Subsoil	Firm mid-light orange – brown clay-sand with rare small stones throughout.	0.12m thick	None
4003	Natural	Firm md red clay and mid-light orange-brown clay-sand.	0.18-0.22m visible	None

Trench 41	Length, Width & Alignment 50mx1.8m ENE-WSW		Surface Height (SW End) 66.81m aOD	Depth & Height of Natural 0.40m 66.41m aOD
Context	Context Type	Description	Dimensions	Artefacts/Samples
4101	Topsoil	Friable dark grey-brown sandy soil with occasional small stones.	0.30m thick	None
4102	Subsoil	Friable-firm mid brown silty sand.	0.10m thick	None
4103	Natural	Firm light grey-white sand with occasional small stones.	0.10-0.30m visible	None

Trench 42	Length, Width & Alignment 25mx1.8m NW-SE		Surface Height (NW End) 67.51m aOD	Depth & Height of Natural 0.40m 67.11m aOD
Context	Context Type	Description	Dimensions	Artefacts/Samples
4201	Topsoil	Friable dark grey-brown sandy soil with occasional small stones throughout.	0.30m thick	None
4202	Subsoil	Firm mid brown silty sand with rare small stones throughout.	0.10m thick	None
4203	Natural	Firm light brown-grey sand with moderate gravelly inclusions. One furrow observed aligned roughly east-west.	0.08-0.30m visible	None

Trench 43	Length, Width & Alignment 25mx1.8m NW-SE		Surface Height (NW End) 67.27m aOD	Depth & Height of Natural 0.40m 66.87m + aOD
<i>Context</i>	<i>Context Type</i>	<i>Description</i>	<i>Dimensions</i>	<i>Artefacts/Samples</i>
4301	Topsoil	Friable dark grey-brown sandy soil with occasional small stones throughout.	0.30m thick	None
4302	Subsoil	Friable-firm mid brown silty sand.	0.10m thick	None
4303	Natural	Firm mid-light brown-grey sand with gravel and clay patches at the eastern end.	0.10-0.30m visible	None



Northamptonshire County Council

Northamptonshire Archaeology

Northamptonshire Archaeology

2 Bolton House
Wootton Hall Park
Northampton NN4 8BE

t. 01604 700493 **f.** 01604 702822

e. sparry@northamptonshire.gov.uk

w. www.northantsarchaeology.co.uk



CONTRACTORS HEALTH & SAFETY ASSESSMENT SCHEME
Accredited Contractor
www.chas.gov.uk



**Northamptonshire
County Council**