Northamptonshire Archaeology

An archaeological evaluation
of land at
Jubilee Street, Rothwell
Northamptonshire



Anne Foard-Colby

February 2006

Report 06/06

Northamptonshire Archaeology

2 Bolton House
Wootton Hall Park
Northampton NN4 8BE

w. www.northantsarchaeology.co.uk

t. 01604 700493/4

f. 01604 702822

e. sparry@northamptonshire.gov.uk



**NORTHAMPTONSHIRE ARCHAEOLOGY
NORTHAMPTONSHIRE COUNTY COUNCIL
FEBRUARY 2006**

NGR SP 817808

**ARCHAEOLOGICAL EVALUATION
JUBILEE STREET, ROTHWELL,
NORTHAMPTONSHIRE
DECEMBER 2005
06/06**

STAFF

Project Manager	Adam Yates BA
Fieldwork	Anne Foard-Colby Cert Ed
	Robin Foard
	Keiran Armitage
	David Haynes
	Peter Haynes
	Rachel Kershaw MA
	Yvonne Wolfram BSc
Text	Anne Foard-Colby
Animal Bone	Wendy Parry BA
Illustrations	Jacqueline Harding BA HND

QUALITY CONTROL

	Print name	Signed	Date
Checked by	P Chapman		
Verified by	A. Yates		
Approved by	S Parry		

OASIS REPORT FORM

PROJECT DETAILS		
Project title	Jubilee Street, Rothwell	
Short description (250 words maximum)	Northamptonshire Archaeology carried out an archaeological evaluation on 8.2ha. of land proposed for housing in Rothwell, Northamptonshire. Three intercutting ditches were revealed in two trenches and a gully in one other trench. No dateable evidence was recovered from any of the features.	
Project type (e.g. desk-based, field evaluation etc)	Field Evaluation (Site Code: RJS05)	
Previous work (reference to organisation or SMR numbers etc)		
Future work (yes, no, unknown)	Unknown	
Monument type And period		
Significant finds (artefact type and period)		
PROJECT LOCATION		
County	Northamptonshire	
Site address (including postcode)	Jubilee Street, Rothwell	
Easting (use numerical 100km grid square no.)	4817	
Northing	2808	
Height OD	Between 103.5m at the north and 95.54m at the south	
PROJECT CREATORS		
Organisation	Northamptonshire Archaeology	
Project brief originator	Entec	
Project Design originator	Northamptonshire Archaeology	
Director/Supervisor	Anne Foard-Colby	
Project Manager	Adam Yates	
Sponsor or funding body	Bovis Homes Ltd	
PROJECT DATE		
Start date	December 2005	
End date	December 2005	
ARCHIVES	Location (Accession no.)	Content (e.g. pottery, animal bone etc)
Physical		
Paper		
Digital		
BIBLIOGRAPHY		
Title		
Serial title & volume		
Author(s)		
Page numbers		
Date		

Contents

1 INTRODUCTION	1
2 TOPOGRAPHY AND GEOLOGY	1
3 ARCHAEOLOGICAL BACKGROUND	2
4 METHODOLOGY	2
5 RESULTS OF FIELDWORK	3
6 THE ANIMAL BONE	4
7 CONCLUSIONS	5
BIBLIOGRAPHY	6

APPENDIX 1: Site Data

TABLES

Table 1: Distribution of bones by context

FIGURES

Fig 1: Site location & trench layout 1:5000

Fig 2: Trench plans 1:500

Fig 3: Sections

PLATES

Title page: Machining looking south

Plate 1: Trench 11, ditches

Plate 2: Trench 29, ditches

AN ARCHAEOLOGICAL EVALUATION
OF LAND AT
JUBILEE STREET, ROTHWELL, NORTHAMPTONSHIRE
DECEMBER 2005

ABSTRACT

Northamptonshire Archaeology carried out an archaeological evaluation on 8.2ha. of land proposed for housing at Rothwell, Northamptonshire. Three intercutting ditches were revealed in two trenches and a gully in another trench. No diagnostic material was recovered from any of the features. No archaeology was present in the remaining trenches. The presence of an old watercourse was noted.

1 INTRODUCTION

Northamptonshire Archaeology carried out an archaeological evaluation during December 2005 on land proposed for housing (planning application: KE/04/0491), east of Jubilee Street, Rothwell, Northamptonshire, NGR SP 817 808 (Fig 1).

The work was undertaken in order to inform a planning application for the construction of dwellings. The evaluation met the requirements of a specification issued by Entec, acting on behalf of their clients Bovis Homes Ltd, on 3/11/05.

The purpose of the evaluation was to determine the potential extent, nature, function, character and date of any archaeological evidence at the site in its cultural setting.

2 TOPOGRAPHY AND GEOLOGY

The site occupies an area of approximately 8.2ha. to the east of Jubilee Street and to the south of the town centre. The ground slopes down from the north, to a central plateau, sloping again to the south and south-west. It lies at an elevation of between 103.5mOD at the north and 95.54mOD at the south.

The land is currently under long grass with many patches of low lying brambles. Young saplings and occasional mature trees are also present.

The geology of the site comprises Upper Lias clays with alluvial deposits overlain by

Northampton sands to the south. Estuarine clays are also present towards the centre of the site (BGS Sheet 170, ENTEC 2005).

3 ARCHAEOLOGICAL BACKGROUND

There are no known archaeological remains from within the application site itself.

The site lies to the south of the medieval town of Rothwell. To the north-west is Holy Trinity Church and lying in grounds to the east of the church is the former Jesus Hospital. Two surviving medieval fishponds are situated to the north of the site within the grounds of the 18th century manor house.

A recent archaeological evaluation at the rear of Gordon Street revealed late Saxon and early medieval features, these may relate to the earlier manor (ENTEC 2005).

4 METHODOLOGY

In total, twenty eight trial trenches were proposed, however, due to underground and overhead services and the position of mature trees, six were not excavated (Trenches 1, 2, 9, 17, 19 & 22) in accordance with the specification (ENTEC 2005). One more (Trench 29) was added to the west of Trench 11 to further investigate a series of ditches (Fig 1). Of those trenches opened, all were between 8m - 60m in length and were excavated using a mechanical digger fitted with a 2m wide toothless ditching bucket under continuous archaeological supervision. Mechanical excavation proceeded as far as the first significant archaeological layer or in its absence as far as the surface of the natural clays and gravels or alluvium.

All potential archaeological features were examined by hand excavation, by cutting a section through them. Standard Northamptonshire Archaeology recording procedures were employed.

All works were carried out according to the policy & guidance for archaeological fieldwork projects in Northamptonshire (NCCNH 1995). All procedures complied with the Northamptonshire County Council Health and Safety provisions and Northamptonshire Archaeology Health and Safety at Work Guidelines (NA 2003).

5 RESULTS OF FIELDWORK

General

The following is a summary of the archaeological findings. An inventory of archaeological contexts is presented in Appendix 1.

No archaeological features were present in Trenches 3 - 8, 10 - 16, 18, 20, 21, 23 - 26 and 28. Those trenches with archaeological remains (11, 27 & 29) are described below.

Generally the same sequence of deposits were encountered across the whole area. An old watercourse was noted in Trench 11 and evidence for ridge and furrow aligned northwest - southeast was seen in Trench 6. Land drains were observed in Trenches 5, 10, 11, 15, 16, 18, 23 and 26 together with an old cast-iron service pipe in Trench 11.

Trench 11

Measuring approximately 60m long by 2m wide, Trench 11 (Fig 2) was aligned north-south. Natural yellow/brown silty clay (1103) was encountered at a depth of 0.4m. Overlying this was yellow/brown sandy clay subsoil (1102), 0.05 – 0.33m thick and overlain by topsoil (1101), up to 0.31m deep. Three parallel inter-cutting ditches were present, none of which are dated.

Ditch [1111] (Fig 3, Section 1, Plate 1), was aligned east-west, was cut into natural clay (1103) and measured 0.75m wide 0.35m deep with a 'V' shaped profile and flat base. Primary fill (1110) was mid grey/brown clay loam with occasional snail shells, overlain by light yellow/green clay loam with some chalk and gravel (1109). Ditch [1111] was cut by ditch [1108] (Fig 3, Section 1, Plate 1), aligned east-west and measured 0.4m wide 0.18m deep with a 'U' shaped profile. The single fill (1107) was light yellow/brown clay loam with occasional chalk, charcoal and snail shells, and contained fragments of bone from sheep or goat. Ditch [1108] was in turn cut by ditch [1106] (Fig 3, Section 1, Plate 1), aligned east-west and measured 1.3m wide 0.17m deep with a shallow 'U' shaped profile and a 'V' shaped base. Primary fill (1105) was light yellow/brown clay loam with occasional chalk and gravel and contained fragments of bone from cattle and pig. Overlying this was fill (1104), a narrow lens of mid yellow brown loam with frequent gravel.

Trench 27

Aligned east-west, Trench 27 (Fig 2), measured approximately 30m long and 2m wide. Natural grey/orange sandy clay with snail shells (2703) was encountered at a depth of

between 0.28 m – 0.54m. Overlying this was grey/brown silty clay subsoil (2702), 0.1m – 0.16m thick and overlain by topsoil (2701), 0.29 – 0.35m thick.

A linear gully (2705), was aligned northwest – southeast (Fig 3, Section 2) cutting natural clay (2703). Measuring approximately 1.1m wide and 0.14m deep with a shallow ‘U’ shaped profile and flat base, it was filled with firm grey/brown loamy clay with snail shell inclusions (2704).

Trench 29

Measuring approximately 8m long by 2m wide, Trench 29 was aligned north-south (Fig 2). Natural light grey/brown sandy clay with frequent flint and chalk pebbles (2903) was encountered at a depth of 0.37m. Overlying this was yellow/brown silty clay subsoil with frequent flint and chalk pebbles (2902), 0.09 – 0.14m thick and overlain by topsoil (2901) 0.33m thick. This was excavated at the request of the curator to further investigate the ditches seen in Trench 11. The same sequence of ditches was identified.

Ditch [2910] (Fig 3, Section 3, Plate 2), was perhaps a continuation of [1111], sharing a common east-west alignment and cut into the natural (2903). It measured 0.8m wide 0.43m deep and had a ‘V’ shaped profile with a flat base. The primary fill (2909) was mid grey/brown silty clay; overlain by grey and orange silty clay with some chalk and gravel (2908). Ditch [2910] was cut by ditch [2907] (Fig 3, Section 3, Plate 2) which was equal to [1108]. It was aligned east-west and measured 0.9m wide 0.26m deep with a shallow ‘V’ shaped profile. The single fill (2906) was of brown loamy clay and contained fragments of cattle bone. Ditch [2907] was cut by ditch [2905] (Fig 3, Section 3, Plate 2) equal to [1106] and aligned east-west. It measured 1.6m wide 0.23m deep with a shallow ‘U’ shaped profile and flat base. Its fill (2904) was mottled brown silty clay and contain fragments of bone from sheep or goat.

6 THE ANIMAL BONE

by Wendy Parry

A total of 17 hand collected bone elements from four contexts were submitted for assessment. Three species including cattle *Bos* (domestic); sheep/goat *Ovis/Capra* (domestic) and pig *Sus* (domestic) were identified, whilst nine fragments were unidentifiable. The table below show shows the distribution of bones by context.

Table 1: Distribution of bones by context

Context	Feature type	Cattle	Sheep/goat	Pig	Unidentified fragments	Total
1105	Ditch	1		1	9	11
1107	Ditch		2			2
2904	Ditch		2			2
2906	Ditch	2				2

Overall the preservation of the bone was fair to good showing sharp un-abraded breaks.

The absence of dating and the small number of bones available to study makes any further interpretation impossible. In the context of well dated features then the bone assemblage would contribute to an understanding of the economy of the area.

7 CONCLUSIONS

Three parallel inter-cutting ditches were revealed in two trenches and a shallow gully in a third trench. None of these features produced diagnostic material. The parallel ditches are likely to represent a field boundary, maintained over a period of time since it required re-cutting on at least two occasions.

BIBLIOGRAPHY

BGS British Geological Survey, Sheet 170, 1:50,000

ENTEC 2005 *Land at Jubilee Street, Rothwell, Northamptonshire, Specification for Archaeological Trial Trench Evaluation*

IFA 1995 *Code of Conduct and Standards and Guidelines for Archaeological Evaluation*
Institute of Field Archaeologist

NA, 2003 *Policy and Guidance for Archaeological Fieldwork Projects in Northamptonshire*, Northamptonshire County Council

Northamptonshire Archaeology Advisory document on Health and Safety at Work

Northamptonshire Archaeology
Northamptonshire County Council

13th February 2006

A1: SITE DATA

Trench No	Context	Deposit Type	Description	Artefact types
3	301	Layer	Topsoil 0 – 0.19m deep	
	302	Layer	Redeposited blue and brown natural clay 0.11m - 0.22m deep	
	303	Layer	Buried topsoil soft grey/brown loamy clay with many inclusions of roots & vegetation 0.15m – 0.17m deep	
	304	Layer	Subsoil mid orange brown sandy clay 0.18m deep	
	305	Layer	Natural light yellow/brown clay with patches of gravel	
	306	Layer	Natural dark orange/brown clay	
	307	Layer	Natural grey/brown clay	
4	401	Layer	Topsoil 0 – 0.24m deep	
	402	Layer	Subsoil mid yellow/brown sandy clay with occasional small flints 0.19m – 0.33m deep	
	403	Layer	Natural blue & yellow clay with frequent small - large flint and dark orange/brown sandy clay with frequent small – mid flint	
5	501	Layer	Topsoil 0 – 0.39m deep	
	502	Layer	Subsoil light orange brown clay with occasional small flint 0.23m – 0.5m deep	
	503	Layer	Natural green/yellow clay	
	504	Layer	Natural light yellow brown clay with some flint	
6	601	Layer	Topsoil 0 – 0.31m deep	
	602	Layer	Subsoil mid yellow/brown clay with occasional small pebbles & charcoal 0.1m – 0.2m deep	
	603	Layer	Natural mid yellow/brown clay with frequent small – mid flints & occasional large flints on N side of trench	
	604	Layer	Natural mid yellow/brown alluvial clay with moderate small – mid flint on S side of trench	
	605	Fill	Fill of [606] mid yellow/brown clay	
	606	Cut	Cut of furrow aligned NW-SE, only partially revealed at W end of trench	
7	701	Layer	Topsoil 0 - 0.3m deep	
	702	Layer	Subsoil mid orange brown silty clay with frequent flints 0.09m – 0.28m deep	

JUBILEE STREET, ROTHWELL, NORTHAMPTONSHIRE

Trench No	Context	Deposit Type	Description	Artefact types
	703	Layer	Natural yellow/blue clay with flint & ironstone fragments with patches of sandy chalk	
8	801	Layer	Topsoil 0 – 0.27m deep	
	802	Layer	Subsoil mid orange/brown sandy clay with patches of natural mixed in 0.1m – 0.2m deep	
	803	Layer	Natural light yellow/brown clay with some patches of gravel	
10	1001	Layer	Topsoil 0 – 0.4m deep	
	1002	Layer	Subsoil mid orange/brown sandy clay with occasional small flakes of flint & chalk 0.2m – 0.5m deep	
	1003	Layer	Natural light grey/brown chalky clay with patches of chalk & flint	
11	1101	Layer	Topsoil 0 – 0.31m deep	
	1102	Layer	Subsoil mid yellow/brown sandy clay with infrequent small flint 0.05m – 0.33m deep	
	1103	Layer	Natural light yellow/brown silty clay with occasional fragments of charcoal and frequent chalk	
	1104	Layer	Upper fill of [1106] mid yellow/brown loam with some gravel, 1.33m wide 0.02m deep	
	1105	Fill	Lower fill of [1106] light yellow/brown clay loam with infrequent small gravel and chalk fragments, 1.33m wide 0.27m deep	Bone
	1106	Cut	Cut of ditch, aligned E – W with shallow ‘u’ shaped sides and flattish base	
	1107	Fill	Fill of [1108] light yellow/brown clay loam with occasional chalk and charcoal fragments and snail shells, 0.44m wide 0.21m deep	Bone
	1108	Cut	Cut of ditch, aligned E – W, steep sloping ‘u’ shaped sides concave base	
	1109	Cut	Upper fill of [1111] light yellow/green clay loam with some chalk and gravel, 0.42m wide 0.38m deep	
	1110	Fill	Lower fill of [1111] mid grey brown clay loam with occasional snail shell fragments, 0.45m wide 0.25m deep	
	1111	Cut	Cut of ditch aligned E – W steep sided ‘u’ shaped with flat base	
	1112	Fill	Fill of old watercourse, running E – W, mid blue grey silty clay with some remnants of vegetation and occasional gravel, 6m wide	
12	1201	Layer	Topsoil 0. 29m deep	

JUBILEE STREET, ROTHWELL, NORTHAMPTONSHIRE

Trench No	Context	Deposit Type	Description	Artefact types
	1202	Layer	Subsoil dark orange/brown sandy clay with frequent flint flecks 0.21m – 0.23m deep	
	1203	Layer	Natural mid orange/brown clay with moderate flint inclusions with patches chalk pebbles	
13	1301	Layer	Topsoil 0 - 0.22m deep	
	1302	Layer	Subsoil mid orange/brown silty clay with occasional small gravel 0.05m – 0.4m deep	
	1303	Layer	Subsoil mid orange/brown silty clay with frequent angular flint fragments 0.05m – 0.55m deep	
	1304	Layer	Natural mid orange/brown clay with very frequent chalk & flint fragments	
14	1401	Layer	Topsoil 0 - 0.34m deep	
	1402	Layer	Subsoil light yellow/brown clay contains modern brick tile and slate and sand at north end 0.3m – 0.4m	
	1403	Layer	Buried topsoil mid grey/brown clay loam with occasional charcoal flecks and gravel 0 – 0.11m deep	
	1404	Layer	Subsoil mid orange/brown silty clay with occasional small gravel 0.19m – 0.3m deep	
	1405	Layer	Natural blue brown clay with frequent flint, chalk & ironstone fragments	
15	1501	Layer	Topsoil 0 – 0.31m deep	
	1502	Layer	Subsoil mid yellow/brown clay with frequent small flints & patches of grit 0.1m – 0.42m deep	
	1503	Layer	Natural light blue & brown alluvial clay with patches of light orange/brown gritty clay	
16	1601	Layer	Topsoil 0 – 0.25m deep	
	1602	Layer	Subsoil mid orange/brown silty clay with occasional gravel 0.26m – 0.28m deep	
	1603	Layer	Natural yellow/brown clay with chalk & flint fragments	
	1604	Layer	Fill of [1605] light clean grey/brown clay, 1.69m long 0.62m wide (half section) 0.14m deep	
	1605	Layer	Cut of probable natural feature	
18	1801	Layer	Topsoil 0 – 0.24m deep	
	1802	Layer	Modern deposition of light grey & orange/brown gravely clay with flint & chalk fragments	
	1803	Layer	Buried topsoil	

JUBILEE STREET, ROTHWELL, NORTHAMPTONSHIRE

Trench No	Context	Deposit Type	Description	Artefact types
	1804	Layer	Subsoil mid yellow/brown silty clay with occasional flint & chalk fragments	
	1805	Layer	Natural yellow/grey clay with frequent flint & chalk fragments	
20	2001	Layer	Topsoil 0 – 0.27m deep	
	2002	Layer	Modern deposition of light grey/brown clay with brick rubble & charcoal lumps 0 – 0.15m deep	
	2003	Layer	Buried topsoil 0 – 0.2m deep	
	2004	Layer	Subsoil orange/brown sandy clay with occasional flint 0.16m – 0.3m deep	
	2005	Layer	Natural orange/blue clay with occasional chalk & flint fragments	
21	2101	Layer	Topsoil 0 – 0.29m deep	
	2102	Layer	Subsoil light brown alluvial clay 0.27m deep	
	2103	Layer	Natural light grey brown clay	
23	2301	Layer	Topsoil 0 – 0.33m deep	
	2302	Layer	Subsoil yellow/brown sandy clay with some gravel 0 – 0.22m deep	
	2303	Layer	Natural yellow clay with patches of sand & gravel	
	2304	Fill	Fill of [2305] yellow/brown sandy clay 0.63m wide 0.3m deep	
	2305	Cut	Cut of probable land drain (base of)	
24	2401	Layer	Topsoil 0 – 0.29m deep	
	2402	Layer	Subsoil yellow orange sandy clay with gravel 0 – 0.38m deep	
	2403	Layer	Natural firm orange brown sandy clay with gravel	
25	2501	Layer	Topsoil 0 – 0.37m deep	
	2502	Layer	Subsoil loose yellow/orange sandy clay with gravel 0 – 0.38m deep	
	2503	Layer	Natural firm orange/brown sandy clay with gravel & patches of chalky gravel	
26	2601	Layer	Topsoil 0 – 0.39m deep	
	2602	Layer	Subsoil firm yellow/brown clay with some gravel 0 – 0.14m deep	
	2603	Layer	Natural firm yellow orange clay	

JUBILEE STREET, ROTHWELL, NORTHAMPTONSHIRE

Trench No	Context	Deposit Type	Description	Artefact types
27	2701	Layer	Topsoil 0 – 0.35m deep	
	2702	Layer	Subsoil firm grey/brown silty clay with snail shells 0 – 0.16m deep	
	2703	Layer	Natural firm mottled grey & orange sandy clay with snail shells	
	2704	Fill	Fill of [2705] firm grey/brown loamy clay with shell inclusions, 1.1m wide 0.14m deep	
	2705	Cut	Cut of gully, aligned NW – SE ‘u’ shaped profile & flat base	
28	2801	Layer	Topsoil 0 – 0.39m deep	
	2802	Layer	Subsoil dark orange/blue brown silty clay with some shell & chalk flecks 0 – 0.3m deep	
	2803	Layer	Modern deposition layer of light orange/brown gravel & chalk mixed with in topsoil and subsoil	
	2804	Layer	Natural light orange/blue brown clay with frequent flint	
29	2901	Layer	Topsoil 0 – 0.3m deep	
	2902	Layer	Subsoil yellow/brown silty clay with frequent flint & chalk 0 – 0.14m deep	
	2903	Layer	Natural light grey brown sandy clay with frequent flint & chalk	
	2904	Fill	Fill of [2905] firm mottled brown silty clay, 1.6m wide 0.22m deep	Bone
	2905	Cut	Cut of ditch aligned E – W shallow ‘u’ shaped profile	
	2907	Fill	Fill of [2907] firm brown loamy clay, 0.8m wide 0.26m deep	Bone
	2907	Cut	Cut of ditch aligned E – W, ‘u’ shaped profile	
	2908	Fill	Upper fill of [2910] firm mottled grey & orange silty clay, 0.75m wide 0.33m deep	
	2909	Fill	Lower fill of [2910] firm mottled grey & brown silty clay, 0.45m wide 0.25m deep	
	2910	Cut	Cut of ditch aligned E – W, ‘u’ shaped profile, flat base	

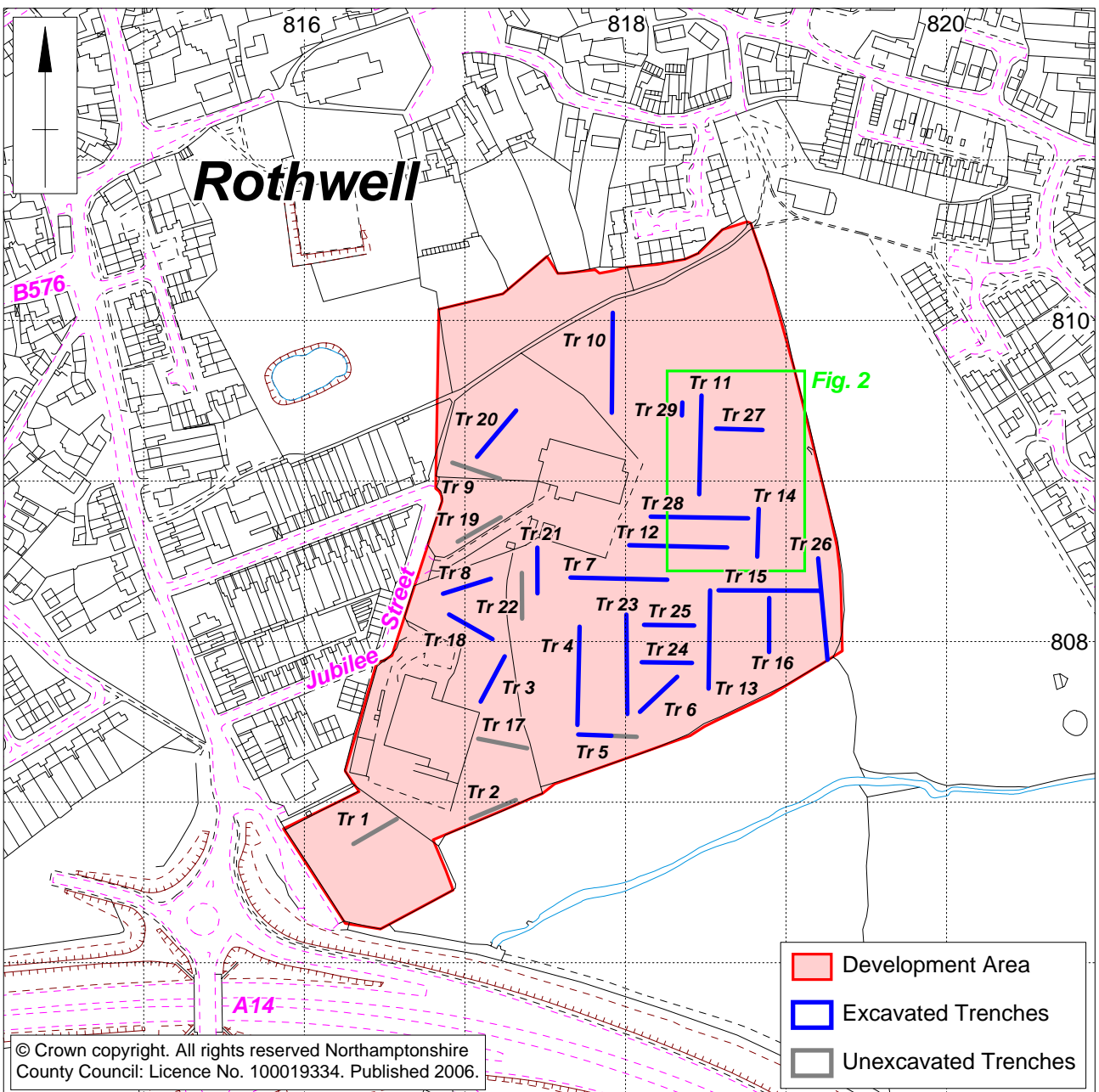
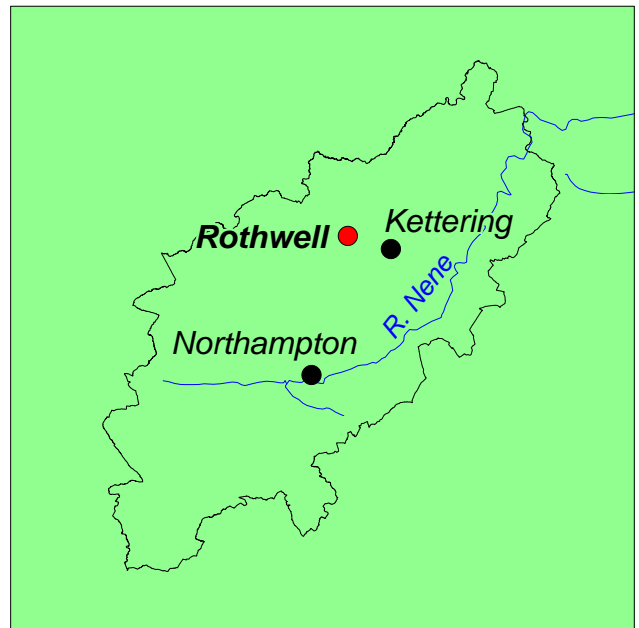

Fig. 1

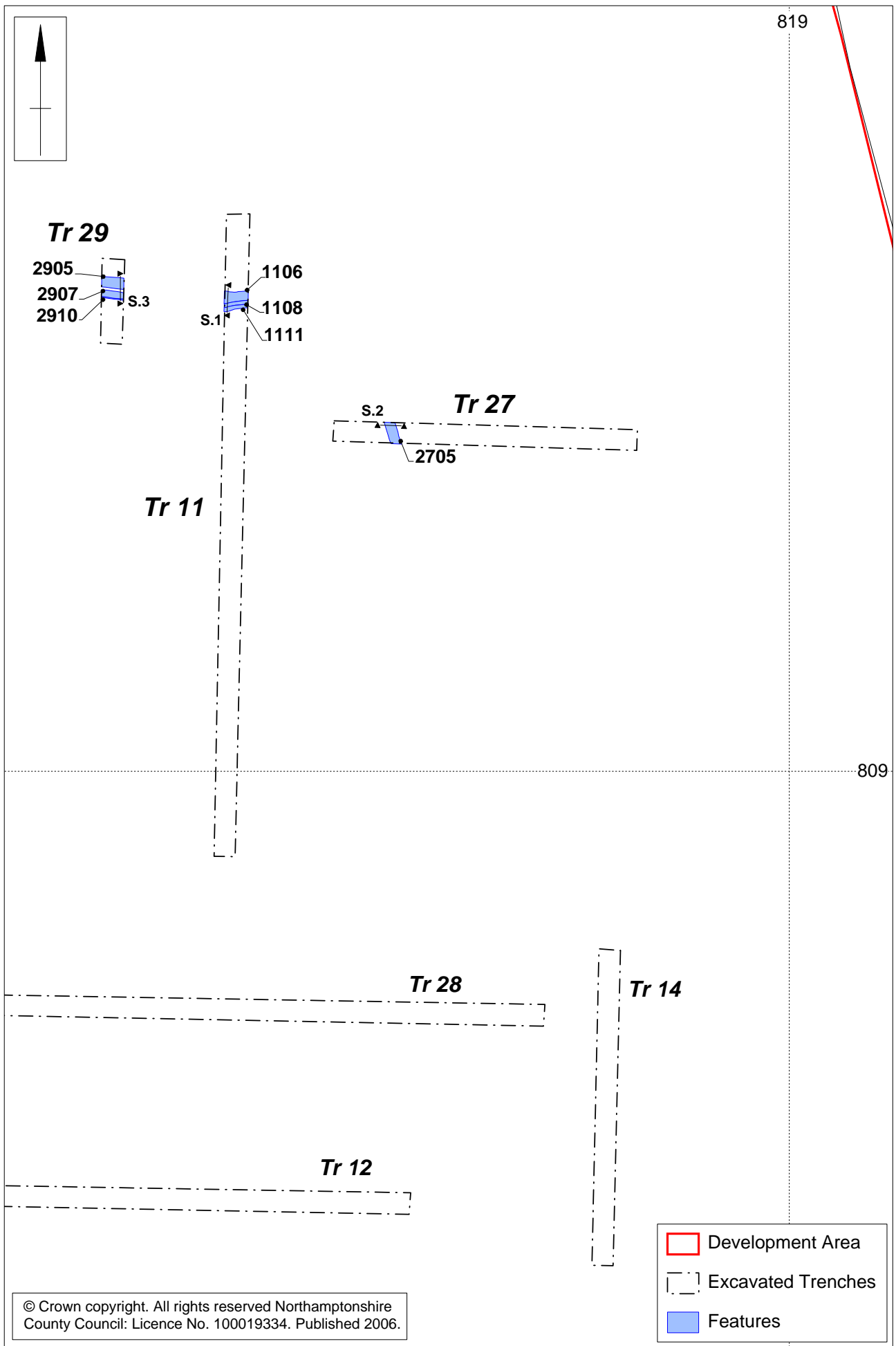
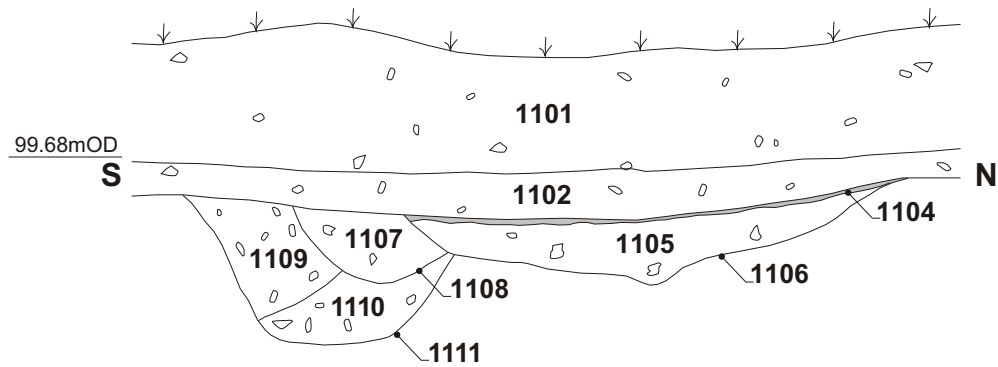
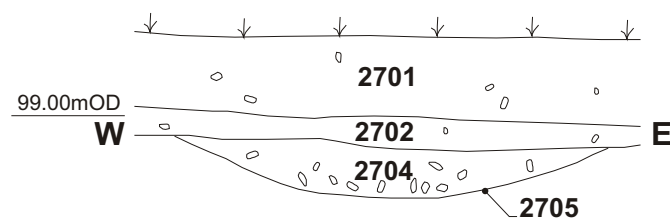

Fig. 2

Section 1 - Trench 11



Section 2 - Trench 27



Section 3 - Trench 29

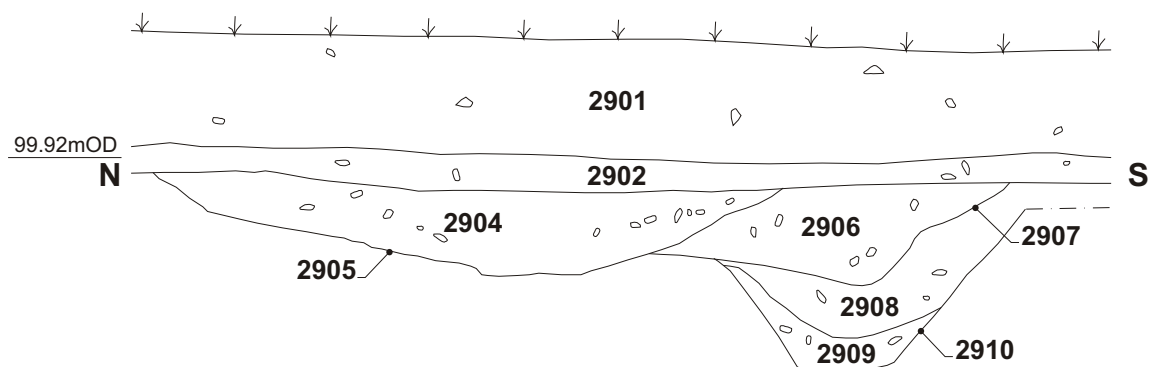

Gravel lens



Fig. 3



Plate 1



Plate 2