



Northamptonshire
County Council

Northamptonshire Archaeology

An archaeological watching brief

at Longbrook Farm

Thurning

NORTHAMPTONSHIRE



Paul Kajewski

October 2007

Report 07/145

Northamptonshire Archaeology

2 Bolton House
Wootton Hall Park

Northampton NN4 8BE

t. 01604 700493 f. 01604 702822

e. sparry@northamptonshire.gov.uk

w. www.northantsarchaeology.co.uk



STAFF

Project Manager Joe Prentice
Text Paul Kajewski BA PGDip
Fieldwork Paul Kajewski BA PGDip
Illustrations Jacqueline Harding BA HND

QUALITY CONTROL

	Print name	Signed	Date
Checked by	Pat Chapman		
Checked by	Carol Simmons		
Verified by	Joe Prentice		
Approved by	Bill Boismier		

OASIS REPORT FORM

PROJECT DETAILS		
Project title	An Archaeological Watching Brief at Longbrook Farm, Winwick Road, Thurning, Northamptonshire	
Short description	An archaeological watching brief was undertaken by Northamptonshire Archaeology during groundwork associated with the creation of a lake at Longbrook Farm, Winwick Road, Thurning. Examination revealed a number of modern land drains, and one undated gully.	
Project type	Watching brief	
Previous work	Unknown	
Current Land Use	Pasture	
Future work	Unknown	
Monument type and period		
Significant finds	One gully, no dating evidence.	
PROJECT LOCATION		
County	Northamptonshire	
Site address	Longbrook Farm, Winwick Road, Thurning.	
Easting Northing	SP 967 826	
Area	c1.934 ha	
Height OD	50m	
PROJECT CREATORS		
Organisation	Northamptonshire Archaeology	
Project brief originator	Mike Dawson, CgMs	
Project Design originator	East Northants District Council	
Director/Supervisor	Paul Kajewski	
Project Manager	Joe Prentice	
Sponsor or funding body	Mr. Norman Paske	
PROJECT DATE		
Start date	July 2007	
End date	July 2007	
ARCHIVES	Location (Accession no.)	Content (eg pottery, animal bone etc)
Physical		nil
Paper		Project Monitoring Forms (1), Colour slides (15), black and white contact prints (15), Digital (18)
Digital		PDF of report and illustrations.
Serial	07/145	

Contents

- 1 INTRODUCTION
- 2 TOPOGRAPHY AND GEOLOGY
- 3 ARCHAEOLOGICAL BACKGROUND
- 4 OBJECTIVES AND METHODOLOGY
- 5 THE RECORDED EVIDENCE
- 6 THE ARCHIVE
- 7 CONCLUSIONS

BIBLIOGRAPHY

APPENDIX 1: Site Data

PLATES

Figures

- Fig 1: Site location, 1:20,000
Fig 2: Plan of Features, 1:1000
Fig 3: Section 1, 2, 3, 4 1:10

Plates

- Plate 1: Borrow Pit Trench
Plate 2: Small gully [1003] found in Borrow Pit Trench
Plate 3: East Lake Wall Trench
Plate 4: West Lake Wall Trench

**AN ARCHAEOLOGICAL WATCHING BRIEF
AT Longbrook Farm, Thurning
Northamptonshire**

Abstract

An archaeological watching brief was undertaken by Northamptonshire Archaeology during groundwork associated with the creation of a lake at Longbrook Farm, Winwick Road, Thurning, Northamptonshire. Examination revealed a number of modern land drains, and one undated gully.

1 INTRODUCTION

An archaeological watching brief was undertaken by Northamptonshire Archaeology in July 2007 during ground works for the construction of a lake in the northernmost field at Longbrook Farm, NGR SP 967826 (planning application: EN/03/01341/FUL), (Fig 1). The work was carried out following a brief issued by East Northamptonshire District Council (Dawson 2004). The purpose of the evaluation was to determine whether there was any occupation on this site and to characterise any material uncovered.

2 TOPOGRAPHY AND GEOLOGY

The development site is located on Longbrook Farm, Winwick Road, Thurning, Northamptonshire. The site covers c1.934 ha and consists of bounded grazing paddocks and crops. The development site is situated in a grazing paddock which gently slopes down to a brook at a height of around 50mOD. The geology is predominately oxford clay characteristic of eastern Northamptonshire.

3 ARCHAEOLOGICAL BACKGROUND

Longbrook Farm has no known archaeological remains within its boundaries, and no previous archaeological works have been undertaken on the proposed development area. Cropmarks (SMR 1306 and 2173) located in the vicinity of the farm indicate potential for archaeological remains in the area.

4 OBJECTIVES AND METHODOLOGY

The aims of the watching brief were to:

- ◆ Observe all groundworks occurring within the development area connected with the construction of the lake.
- ◆ To determine the date, character, state of preservation and depth of any archaeological deposits observed and to retrieve all datable artefacts.

The fieldwork comprised observation by an archaeologist during ground works connected with the excavation of the borrow pit and foundations of the clay wall which will contain the water. A photographic record comprising black and white prints and negatives, colour slide, and digital images was maintained and any recording was carried out using Northamptonshire Archaeology pro-forma sheets.

Groundworks were undertaken with a 360° tracked excavator with a toothless bucket. The watching brief was carried out in accordance with the *Standards and Guidance for an archaeological watching brief* (IFA 1994 revised 2001).

5 THE RECORDED EVIDENCE

The following is a summary of the archaeological findings. A detailed inventory of archaeological contexts is presented in Appendix 1. The investigation has been divided into three sections: (Fig2)

1. Trench 1 - Borrow Pit (where clay is to be taken from, to build a clay wall).
2. Trench 2 - East Lake wall (excavations east of the brook) and
3. Trench 3 - West Lake Wall (excavation west of the brook).

Trench 1 - Borrow Pit

The Borrow Pit was excavated to the required level of 0.95m (Plate 1). The natural comprised substrata of orange/brown clay, which was sealed by a layer of mid light brown silt/clay subsoil, 0.50m – 0.65m thick. Above the subsoil was a layer of topsoil, 0.25-0.30m thick (Fig 3, section 1). A linear gully [1003] was identified aligned east – west. This gully was cut into the natural and overlain by the subsoil (Fig 2). It measured 0.67m by 0.11m deep and had a shallow ‘U’-shaped profile (Fig 3, section 4, Plate 2). The gully fill (1004) was light brown silt/clay with small flint nodules and small rounded pebbles.

Trench 2 - East Lake Wall

The foundation trench of the clay wall east of the brook was excavated to the required level of 1.05m (Plate 3). The natural comprised substrata of orange/brown clay with patches of brown/grey clay, which was sealed by a layer of mid light brown silt/clay subsoil, 0.60m – 0.75m thick. The topsoil measured approx. 0.25-0.30m thick (soil profile shown in Fig 3, section 2). There was no archaeology revealed in this area.

Trench 3 - West Lake Wall

The foundation trench of the clay wall east of the brook was excavated to the required level of 0.70m-1.20m (Plate 4). The natural comprised substrata of orange/brown clay with patches of brown/grey clay, which was sealed by a layer of mid light brown silt/clay subsoil, 0.30m – 0.95m thick. The topsoil measured 0.25-0.30m thick (soil profile shown in Fig 3, section 3). There was no archaeology revealed in this area.

6 THE ARCHIVE

The site archive comprises:

RECORD	NUMBER
Project Monitoring Forms	1
Colour slides	15
Black and white contacts and negatives	15
Digital photographs	18

7 CONCLUSIONS

The only feature found within the scope of this watching brief was one small gully containing no dating evidence. This gully was aligned parallel with modern land drains in the area and it is likely that it once served a similar purpose.

BIBLIOGRAPHY

Dawson, M, 2004 *Project Design For An Archaeological Watching Brief, Land at Longbrook Farm, Winwick Road, Thurning, Northants.* East Northants District Council.

IFA 1994 (revised 2001) *Code of Conduct and Standards and Guidance for an Archaeological Watching Brief,* Institute of Field Archaeologist

Northamptonshire Archaeology *Advisory document on Health and Safety at Work*

A1: SITE DATA

Trench Name	Context	Deposit Type	Description	Artefact types
The Borrow Pit	1000	Layer	Topsoil 0.30m thick	nil
	1001	Layer	Subsoil light brown silt/clay – 0.65m thick	nil
	1002	Layer	Natural orange/brown clay 0.10m to base of trench	nil
	1003	Cut	Cut of linear feature aligned E-W shallow ‘U’-shaped profile, concave base	
	1004	Fill	Fill of [1003] light brown clay with small flint pieces, rounded pebbles 0.67m wide by 0.11m deep	nil
The East Lake Wall trench	2000	Layer	Topsoil 0.30m thick	nil
	2001	Layer	Subsoil light brown silt/clay 0.60m – 0.75m thick	nil
	2002	Layer	Natural orange/brown clay with patches of brown/blue clay 0.10m to base of trench	nil
The West Lake Wall trench	3000	Layer	Topsoil 0.30m thick	nil
	3001	Layer	Subsoil light brown silt/clay –0.30m – 0.95m thick	nil
	3002	Layer	Natural orange/brown clay with patches of brown/blue clay 0.10m to base of trench	nil

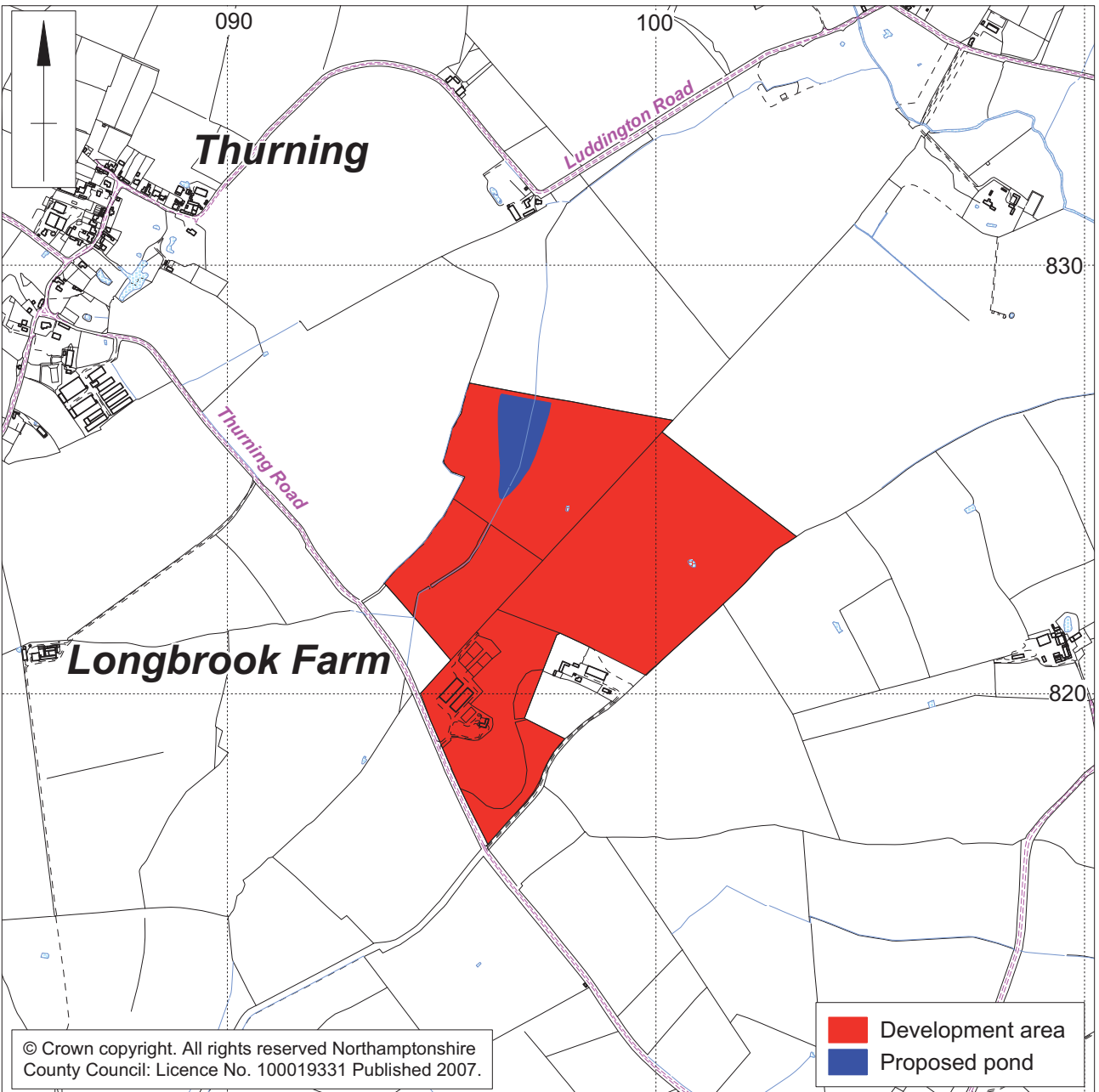

Scale 1:15,000

Site location Fig 1

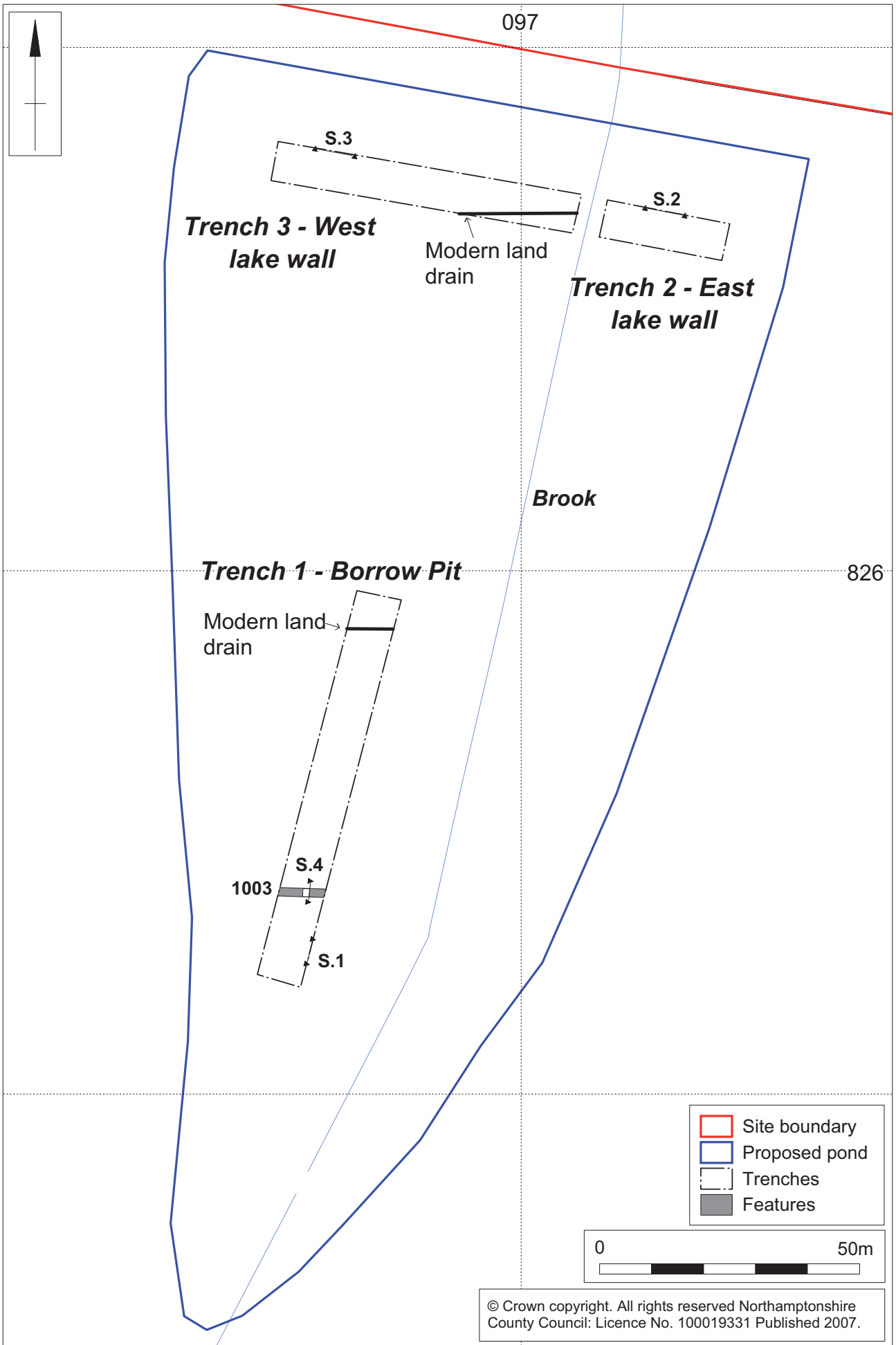

Scale 1:1000

Trench location Fig 2

© Crown copyright. All rights reserved Northamptonshire County Council: Licence No. 100019331 Published 2007.

Section 1 - Borrow Pit trench

51.00mOD

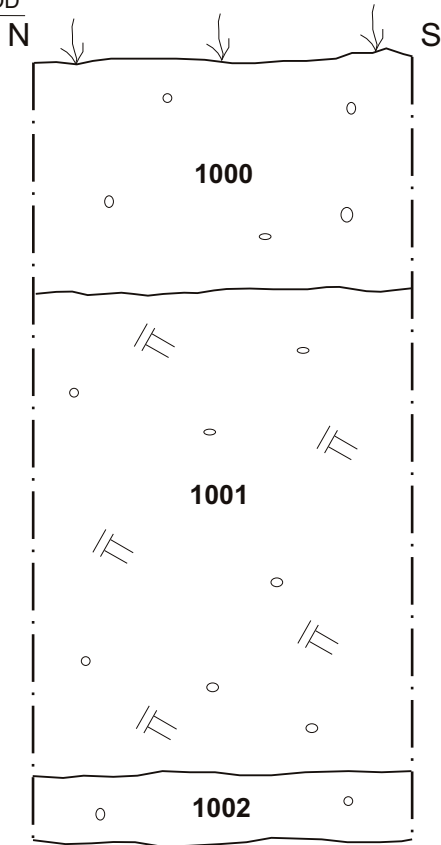

Section 2 - East Wall trench

50.30mOD

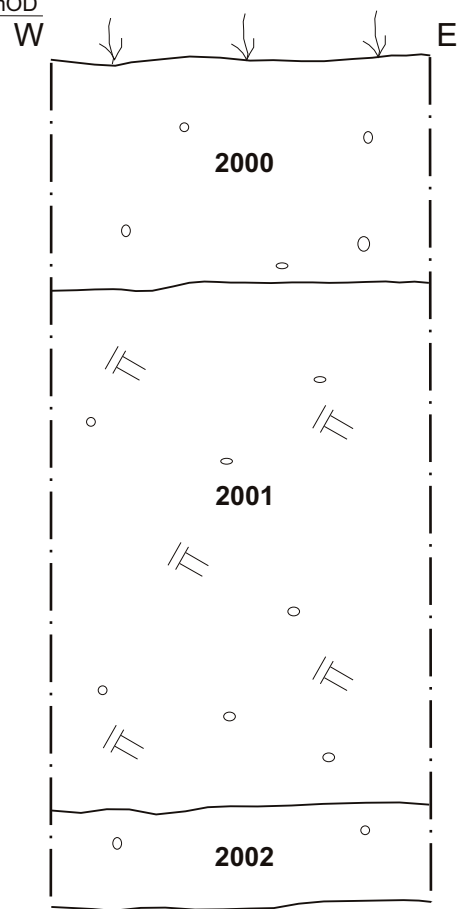

Section 3 - West Wall trench

50.12mOD

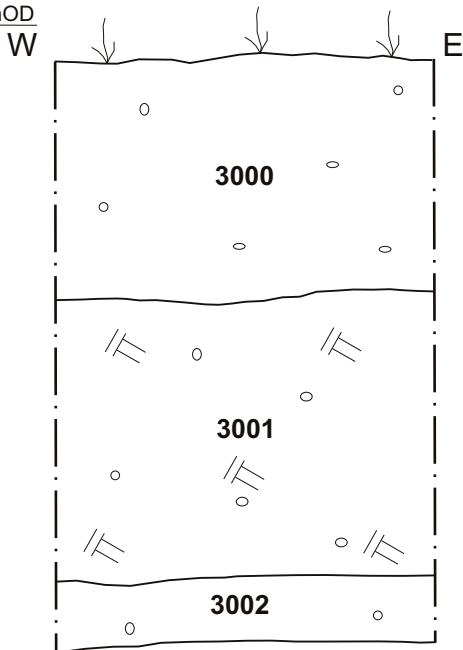

Section 4 - Small gully in Borrow Pit trench

49.80mOD

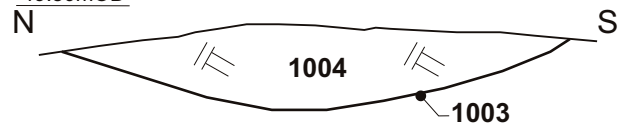

 Silty Clay



Trench soil profiles and gully section Fig 3

PLATES



Plate 1: Trench 1 - Borrow Pit looking north



Plate 2: Small gully [1003] found in Borrow Pit



Plate 3: East Lake Wall Trench looking east



Plate 4: West Lake Wall Trench looking east