

North Pennines Archaeology Ltd
2006
Metric Building Survey
of Blencow Hall,
Penrith, Cumbria



REPORT No:
CP 307/06

Scale 1:200 for A3 plot

DRAWN BY: MDR
DATE: 15/08/06

— datum 195m OD

KEY:

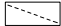
-  floor level
-  blocked opening
-  break in masonry

TITLE:
Elevations of the West Range
and South Tower

COMMISSIONED BY:
Graham K Norman (Architect) Ltd

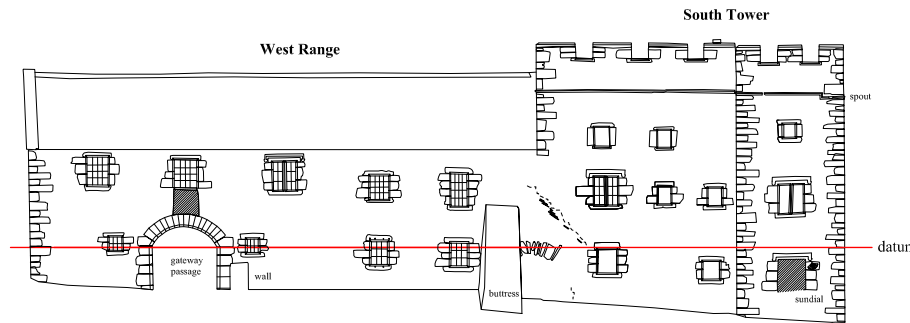

West Range and North Tower,
southwest-facing elevation

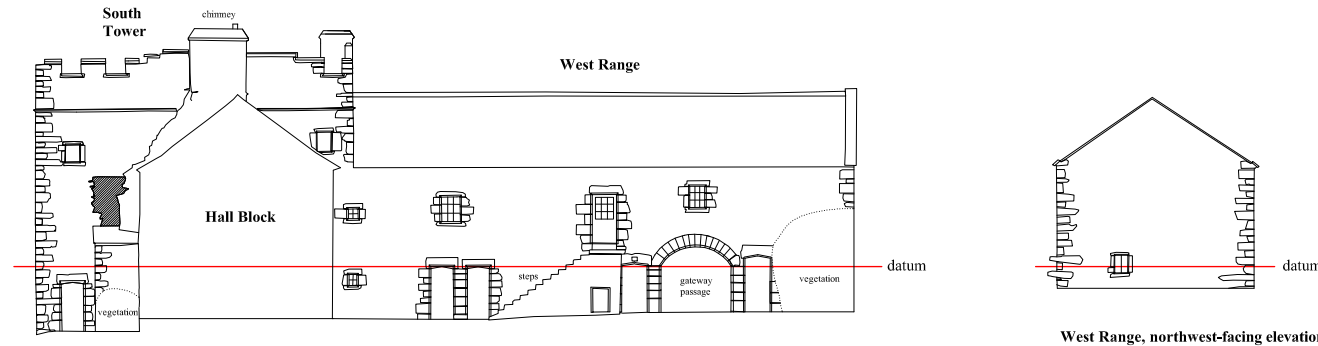

West Range and North Tower,
northeast-facing elevation

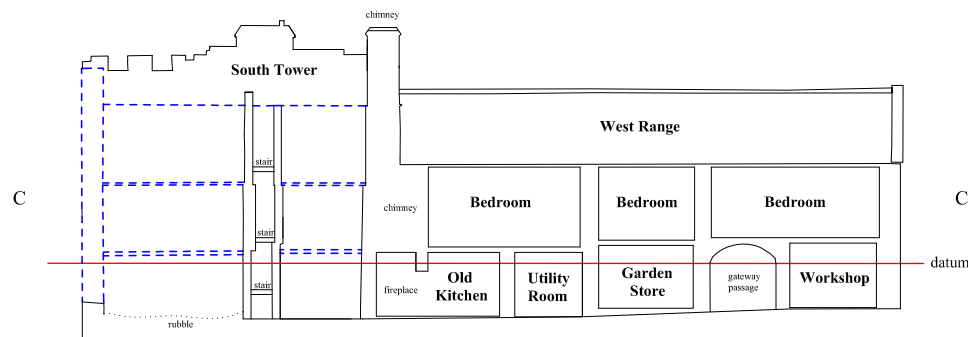

West Range and South Tower,
northeast-facing section (C-C1)

Figure 6: Elevations of the West Range and South Tower