



North Pennines Archaeology Ltd
2009
Archaeological Evaluation
at Tendley Quarry, Brigham,
Cockermouth, Cumbria

CLIENT:

Tarmac Ltd/Tendley Quarries Ltd

SCALE: 1:150 at A4

DRAWN BY: DJ

DATE: March 2009

KEY:

 Limit of
Excavated Trench

(401) Context Number

REPORT No:

CP/877/09

FIGURE:

4

West-southwest facing section of Trench 1 (Area A)

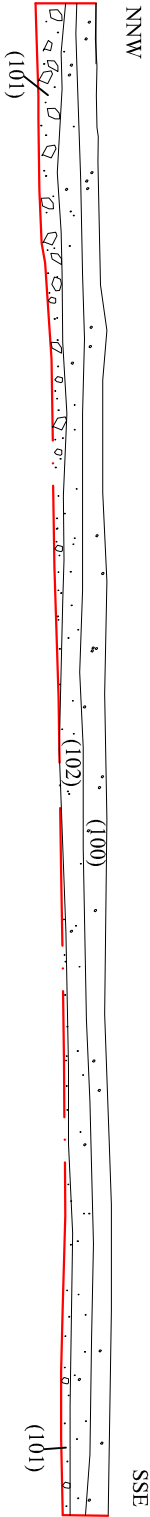

East-northeast facing section of Trench 4 (Area B)

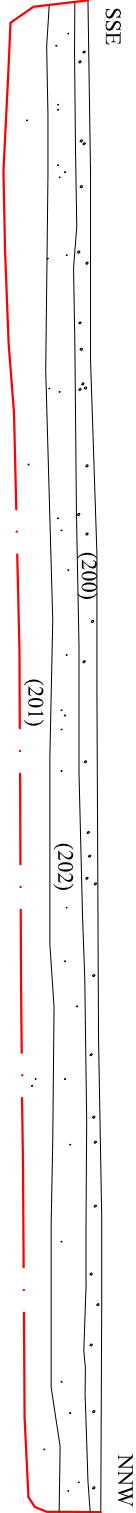

South facing section of Trench 17 (Area D)

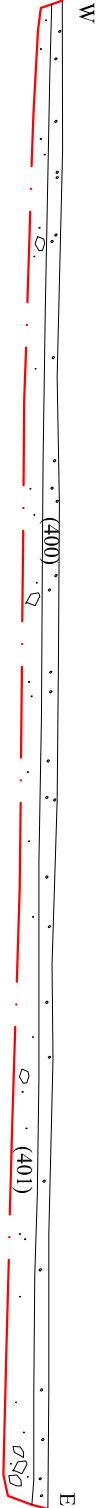

Figure 4: Representative Sections from Areas A, B and D