





North Pennines Archaeology Ltd  
2009  
Castle Carrook to Geltsdale  
Cumbria

CLIENT:  
United Utilities

SCALE:  
1:2500 at A3

DRAWN BY:  
TL  
DATE:  
May 2009

- KEY:
-  Walkover Survey area
  -  Features identified during walkover survey
  -  Features identified from aerial photographs
  -  Plot Boundary



Reproduced by permission of Ordnance Survey on behalf of The Controller of Her Majesty's Stationery Office.  
© Crown copyright. All rights reserved.  
Licence number 100014732.

REPORT No:  
CP 906

FIGURE:  
17

Figure 17: Results of the walkover survey between Plot 15 at Jockey Shield to Plot 20 (NGR NY 5562 5567 and NY 5650 5495)

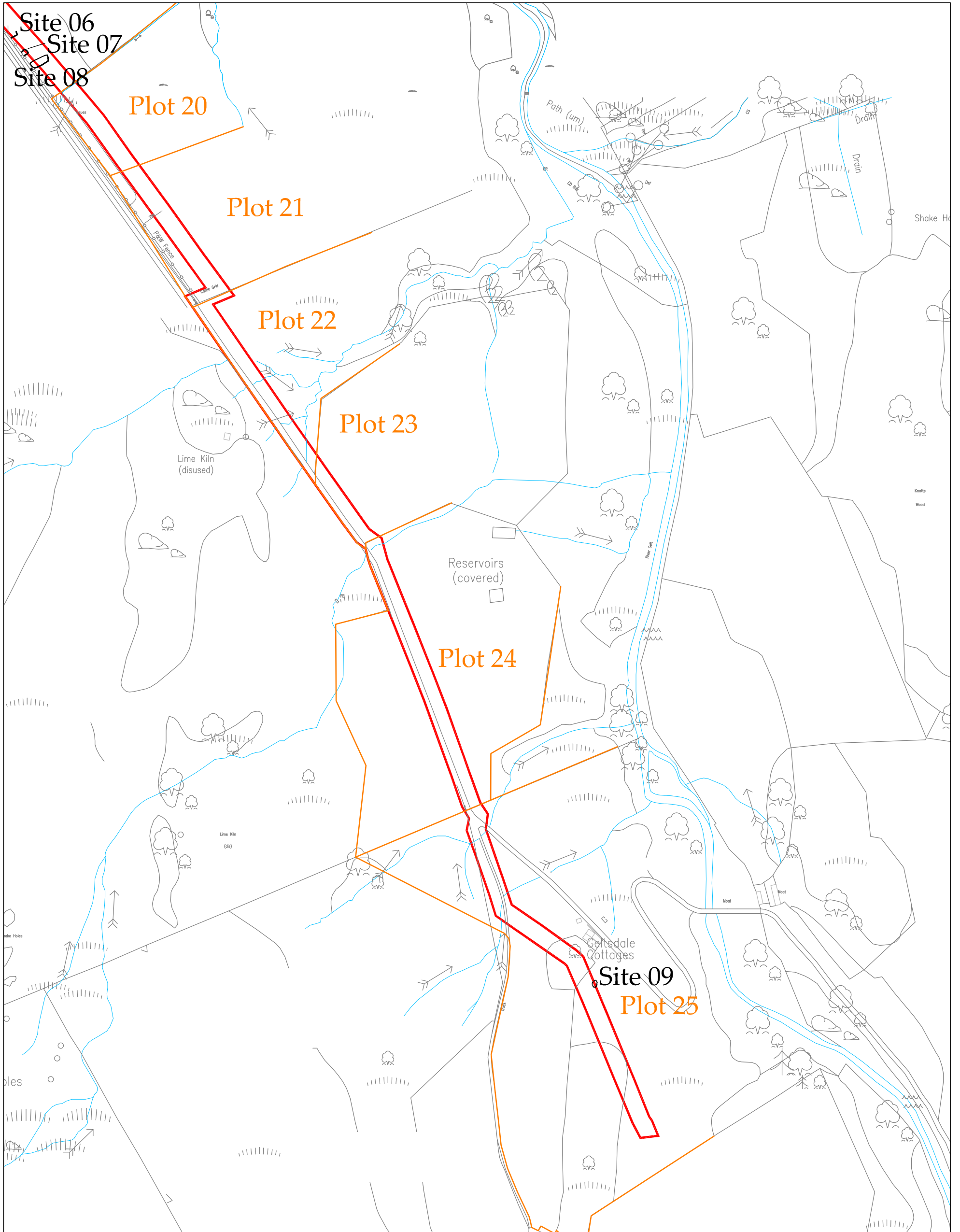









 North Pennines Archaeology Ltd 2009	PROJECT:	Castle Carrock to Geltsdale, Cumbria	KEY:	 Walkover Survey area  AP 01  Plot Boundary	 <small>Reproduced by permission of Ordnance Survey on behalf of The Controller of Her Majesty's Stationary Office. © Crown copyright. All rights reserved. Licence number 100014732.</small>
	SCALE:	1:4000 at A3	 Site 02  Features identified from aerial photographs		
	REPORT No:	CP 906	 Features identified during walkover survey		
	CLIENT:	United Utilities			
	DRAWN BY:	TL			
	DATE:	May 2009			
FIGURE:	18				

Figure 18: Results of the walkover survey between Plot 20 and Plot 25 at Geltsdale Cottage (NGR NY 5650 5567 and NY 5706 5385)



North Pennines Archaeology Ltd

2009

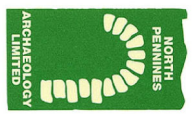
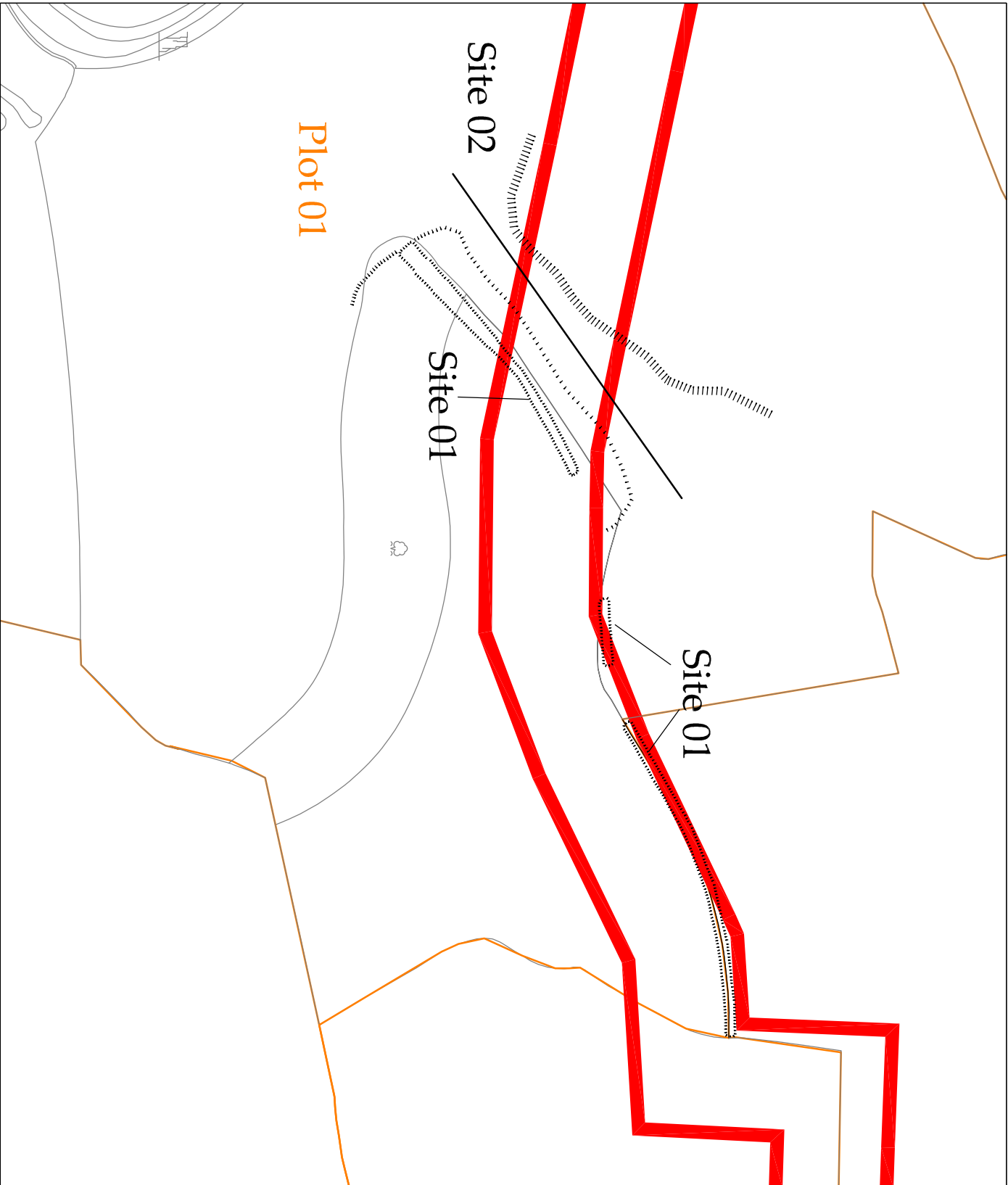
Castle Carrock to Geltsdale,  
Cumbria

CLIENT:

United Utilities

SCALE:

1:1000 at A4

DRAWN BY: Initials

DATE: Date

KEY:

 Walkover Survey area

 Features identified during walkover survey

 Plot Boundary



Reproduced by permission of Ordnance Survey on behalf of The Controller of Her Majesty's Stationery Office. © Crown copyright. All rights reserved. Licence number 10004732

REPORT No:

CP906/09

FIGURE:

19

Figure 19: Plan showing Sites 01-02