

# **The Grange, St. Andrews: Archaeological Evaluation**

Data Structure Report

by Katie Sludden

issued 15<sup>th</sup> November 2007



**Rathmell**

---

Archaeology Ltd

## Quality Assurance

This report covers works which have been undertaken in keeping with the issued brief as modified by the agreed programme of works. The report has been prepared in keeping with the guidance of Rathmell Archaeology Limited on the preparation of reports. All works reported on within this document have been undertaken in keeping with the Institute of Field Archaeology's Standards and Policy Statements and Code of Conduct.

Signed ..... Date .....

In keeping with the procedure of Rathmell Archaeology Limited this document and its findings have been reviewed and agreed by an appropriate colleague:

Checked ..... Date .....

Copyright Rathmell Archaeology Limited. All rights reserved.

No part of this report may be copied or reproduced by any means without prior written permission from Rathmell Archaeology Limited. If you have received this report in error, please destroy all copies in your possession or control and notify Rathmell Archaeology Limited.

This report has been prepared for the exclusive use of the commissioning party and unless otherwise agreed in writing by Rathmell Archaeology Limited, no other party may use, make use of or rely on the contents of the report. No liability is accepted by Rathmell Archaeology Limited for any use of this report, other than the purposes for which it was originally prepared and provided.

Opinions and information provided in the report are on the basis of Rathmell Archaeology Limited using due skill, care and diligence in preparation of the same and no explicit warranty is provided as to their accuracy. It should be noted and it is expressly stated that no independent verification of any of the documents or information supplied to Rathmell Archaeology Limited has been made.

## Contents

1 Overview	4
2 Project Works	4
3 Findings: Desktop Study	5
4 Findings: Evaluation trenches	9
5 Discussion	7
6 Recommendations	12
7 Conclusion	12
8 References	13
Appendix 1 - Trench Details	14
Appendix 2 - Record Summaries	21
Appendix 3 - Discovery & Excavation in Scotland	27
Contact Details	28

### *Figures*

Figs. 1a-f	Historical maps	6
Figs. 2a-b	Location of Evaluation Trenches within the development area.	7
Figs. 3a-g	Images taken during Evaluation	10

## 1 Overview

- 1.1 This Data Structure Report has been prepared for James Paul Architects on behalf of C&L Properties in respect of: the enlargement of an existing house to form a hotel; construction of 10 timeshare units; and formation of a new service road (App. Ref: 06/03453/EFULL) to be erected at The Grange, Grange Road, St. Andrews centred NGR: NO 516 152.
- 1.2 The archaeological investigative works, carried out from the 31st October to the 1<sup>st</sup> November 2007, were designed to inform any necessary mitigation of impact on the archaeological remains within the development area. The investigative works covered two distinct areas. The first was a southern block of land for housing development that is currently open grassed field extending to roughly 1.2ha where a sequence of evaluation trenches were opened. During the period of investigative works Rathmell Archaeology Ltd were asked to assess a second area to the area north of the field, where the existing Grange House stands. There, a car park and access road have been proposed and therefore required some evaluation work. The area covered by the road and car park is roughly 0.184ha.
- 1.3 The findings presented below inform on the character of any archaeologically significant features within the proposed development areas. These investigative works were sufficient to inform on archaeological hazard and allow the development of any necessary subsequent mitigation. The character of such further stages of work will need to be agreed with Fife Council and the Fife Archaeology Service through an addendum to the agreed Written Scheme of Investigation should the development proceed.
- 1.4 Rathmell Archaeology Ltd was appointed by James Paul Architects on behalf of C&L Properties to act with regard to the archaeological issues. The Fife Archaeology Service who advises Fife Council on archaeological matters, provided guidance on the character of archaeological investigations required on this site.

## 2 Project Works

- 2.1 The programme of works agreed with the Fife Archaeology Service, commenced with an archaeological evaluation through machine cut trenches extending to 8% of the available portions of the development area. These works were undertaken in keeping with the agreed Written Scheme of Investigation with the on-site works taking place from the 31st October to the 1<sup>st</sup> November 2007.
- 2.2 The site is comprised of the northern area: The Grange House and garden; and the southern area of disused agricultural land (Figure 2). The southern area was evaluated with 768m<sup>2</sup> of linear trenching, representing an 8% sample of the full area of the southern portion of the site. The northern area had to be assessed while on-site due to the unknown coverage of trees and vegetation across the garden. The area impacted by the development here was estimated to be 1840m<sup>2</sup>, which when sampled, resulted in a minimum requirement of 147.2m<sup>2</sup> of trenching. This area was restricted to the proposed road, car park and roundabout running north from the south fields. The total requirement then, comprised of 915.2m<sup>2</sup> of linear trenches. The actual trenching completed amounted to 978.2m<sup>2</sup> representing 8.5% of the entire area.
- 2.3 Some alterations to the trench layout in the southern area were necessary as the clearance of the site resulted in two spoil-heaps being placed at either end of the southern field (see Figure 2). These impinged on only two trenches and realignment still enabled the entire development area to be examined.
- 2.4 The majority of exposed features within the trenches were investigated and evaluated to determine their archaeological significance, as stated in the agreed Written Scheme of Investigation. All works were conducted in accordance with the Institute of Field Archaeology's Standards and Policy Statements and Code of Conduct and Historic Scotland

## Policy Statements.

### 3 Findings: Desktop study

- 3.1 The modern ascription of “The Grange” is in reference to an area comprising the farmsteads belonging to The East Grange, The West Grange and to the south, The Grange Inn (NMRS No.: NO51 SW58) as well as The Grange House itself. This raises the potential that the term ‘Grange’ may indicate the presence of a medieval grange – a farm complex created by ecclesiastical institutions (eg abbeys) in the management of their extensive estates. However, the extensive use of the name ‘Grange’ in society to name portions of the landscape does not allow a confident association between the post-reformation use of this word with the presence of a medieval farm complex.
- 3.2 The first reference to the Grange occurs on Gordon’s map (1615?-1686, Figure 1a) although no structures are depicted. The medieval Grange (NMRS No.: NO51SW 48) seems to be in reference to a general area of small farmsteads depicted on Roy’s military map (1747-1755, Figure 1b). This map also depicts satellite farmsteads in the mid-eighteenth century when the “East Grange” is shown. This cluster northwest of the East Grange is roughly in common location with the much later existing 19<sup>th</sup> century Grange House. Roy’s map shows a group of farmsteads to the north-west of the East Grange which may represent the original location of the Grange, where the present house sits. The original Grange may not actually be in reference to a singular farm then. The existing Grange may sit upon the central hub of these or within a locality where these farms coalesced.
- 3.3 Somewhat confusingly the term ‘New Grange’ is ascribed to the location of the present West Grange in 1888 and by 1896 (Figure 1e) to the present Grange House. This may be an indication that the West Grange had developed apart from the site of the original Grange and the “West” thereby highlights the significance of the new farmstead to the West of the East Grange and in essence the growth of the farmsteads in the area is highlighted by the spreading use of the Grange name over time, and hence the need to differentiate between the differing elements. The site under development remains the most likely location for the earliest Grange farmsteads in the mid seventeenth century, despite the continuous renaming of the surrounding farmsteads.
- 3.4 Examining cartographic sources we can see that the development area and the surrounding fields have remained virtually undeveloped since the 1850s. The present Grange House first appears on the 1<sup>st</sup> edition Ordnance Survey map of 1855 showing the house and field. The house, by 1921, has become fairly extensive retaining the northern half of the field as a garden. The first edition Ordnance Survey (1855) shows the existing house and garden with what appears to be the same land boundaries as the present day. The only addition to the house is the extension of it’s’ gardens from 1855 onwards (Figure 1f). The development area does not appear to lie on the immediate fabric of the farmstead, but lies south of the present grounds of the residence there, bordered on all sides by trees. It is likely that the present house sits upon a previous medieval incarnation of The Grange and the archaeological framework may relate to the presence of outworks, middens, ancillary structures and other comparable material related to the farmstead.
- 3.5 Roy (1755) (Figure 1b) illustrates an unenclosed rig and furrow field system in the vicinity of development area and any surviving remains of this may suggest medieval activity in the area. The 1926 Ordnance Survey (Figure 1d) shows a stream running from the southwest of the site, heading northwest across the field. This appears to be of relatively modern date occurring on maps from the 19<sup>th</sup> century.
- 3.6 Archaeological works were undertaken nearby on a suspected enclosure (NMRS No.: NO 51 SW 37) in November 1999 (NMRS No.: NO15SW 37 515 147) but no previously unknown structures were discovered.



Figure 1a: Gordon, 1615?-1686 Map

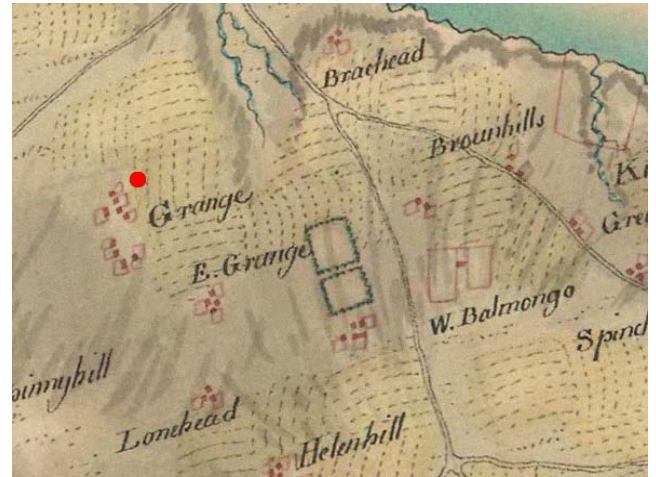

Figure 1b: Roy's Map, 1747-1755



Figure 1c: John Ainslie's Map, 1745-1828

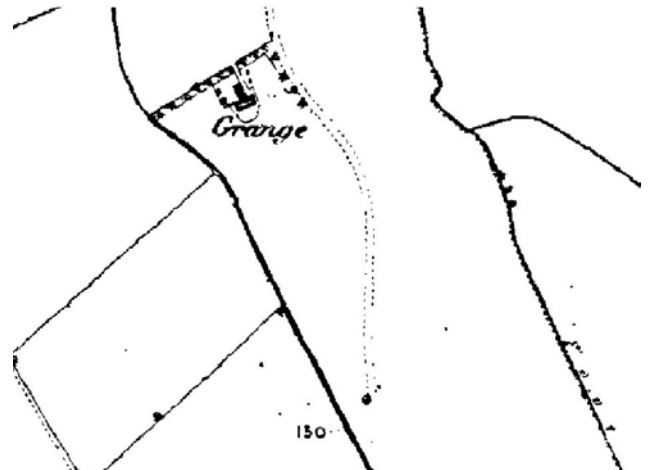

Figure 1d: Ordnance Survey, 1855

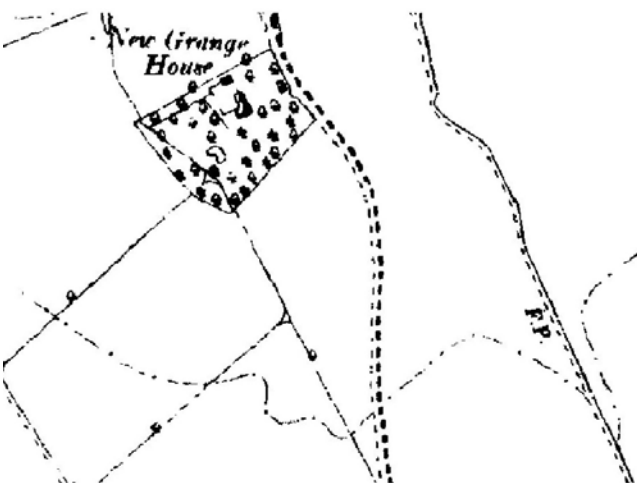

Figure 1e: Ordnance Survey, 1896

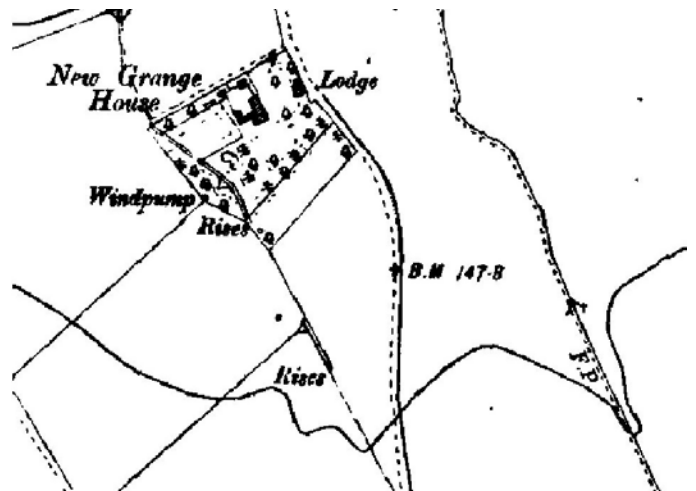

Figure 1f: Ordnance Survey, 1921



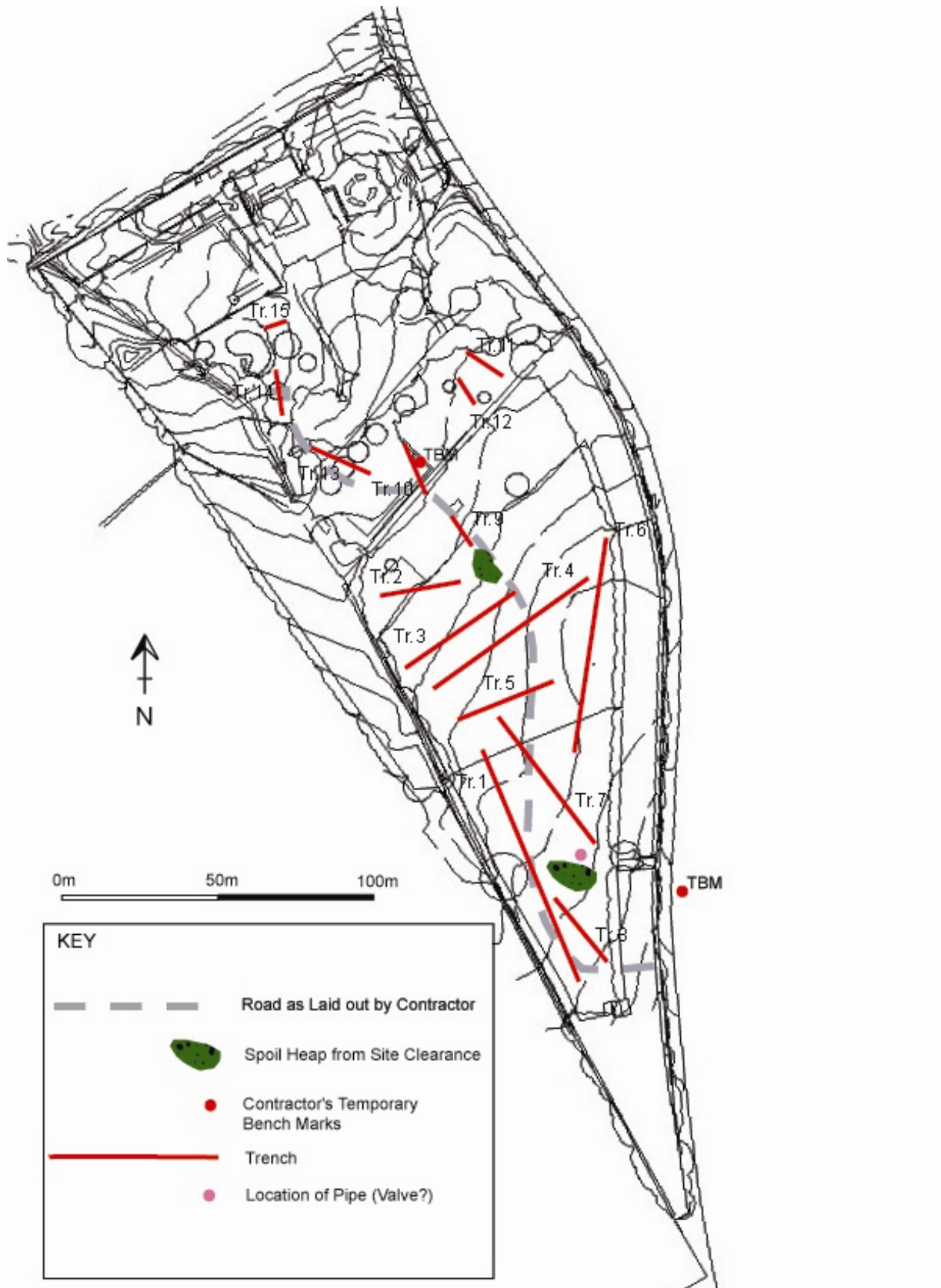

Figure 2a: Location of Evaluation Trenches within the existing development area.

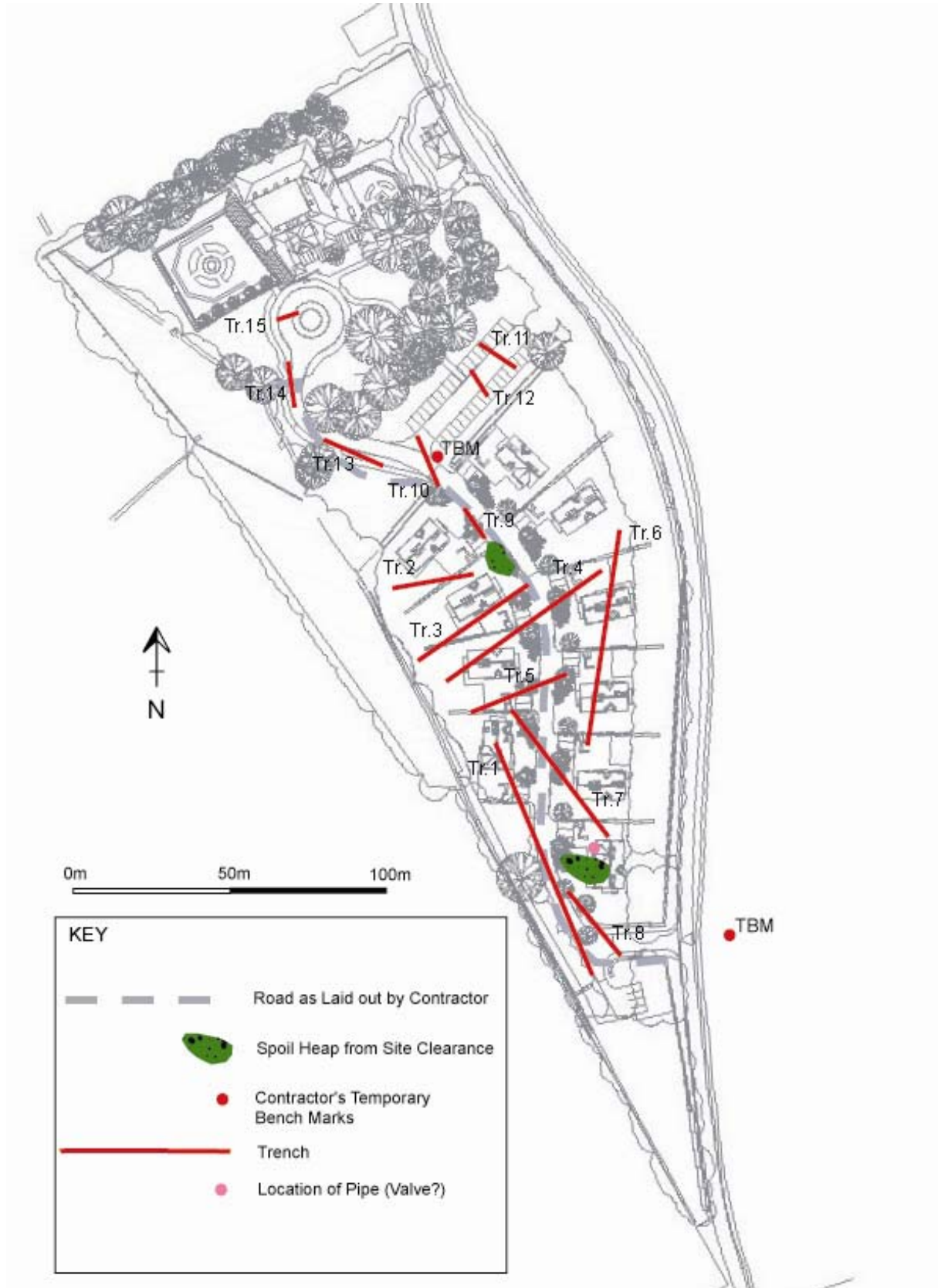

Figure 2b: Location of Evaluation Trenches with proposed housing development shown.



## 4 Findings: Evaluation trenches

- 4.1 Fifteen trenches were cut over the north and south areas totalling a basal area of 978.2m<sup>2</sup>, representing at least 8.5% of the area affected by proposed development works (Figure 2a and 2b). The trenches exhibited a fairly common stratigraphic sequence with moderately compact humic dark brown clay and sandy silt up to 550mm deep, overlying either moderately compact mottled mid-dark brown sandy clay or orange and yellow sands with large degraded sandstone and small clay lenses ((006) for example). There were however, some variations within the trenches: a number of the trenches contained an interface layer between the topsoil and subsoil, this was usually either moderately compact mottled mid-dark brown sandy clay, deposit (004), or loosely compacted mid brown silty sand, deposit (002). These deposits are most likely remnants of plough-soils or are areas of leeching between the topsoil and natural interface.
- 4.2 All the trenches, with the exception of two trenches (11 and 12) contained at least one (but usually several) field drains. The drains varied only slightly in both width and depth (though the stone lined drains tended to be wider) and the drains were either red ceramic or rubble-filled. These would seem to be representative of generations of agricultural usage of the land in question.
- 4.3 Trench 8 and 10 contained manganese deposits (038) suggesting some significant water action in the past although this is restricted to a small area at the south of the site.
- 4.4 Trench 1 contained a modern plastic pipe (023), 200mm in diameter. It was glued at a join between pipe sections. This was most likely to be a modern drain or water pipe although it was roughly aligned to a possible stop-cock or valve to the east. It was left undisturbed and the trench was left open at this point for further investigations by the developer.
- 4.5 Trench 13 contained an organic deposit ([52]) 12m from its' southern end (Figure3e). This deposit extended towards the north end of the trench for 8 metres. This deposit occurred at a change in ground height between the hedged area to the south and the garden lawn of The Grange House. The deposit was therefore a likely result of the removal of a previous plant-border or hedgerow from this area. Since the lawn was lower than the southern area, water had built up over time, creating this very soft stagnant natural deposit.
- 4.6 No significant archaeological features were identified during the course of the archaeological evaluation.



Fig. 3b: North Area: Shot of Walled Garden



Fig.3d: North Area: Post Ex of Trench 13



Fig.3a: North Area: Shot of The Grange House



Fig.3c: North Area: Post-Ex of Trench





Fig.3f: South Area: Pre-Excavation



Fig.3e: North Area: W Facing Section of Tr.13, (Deposit <045>)

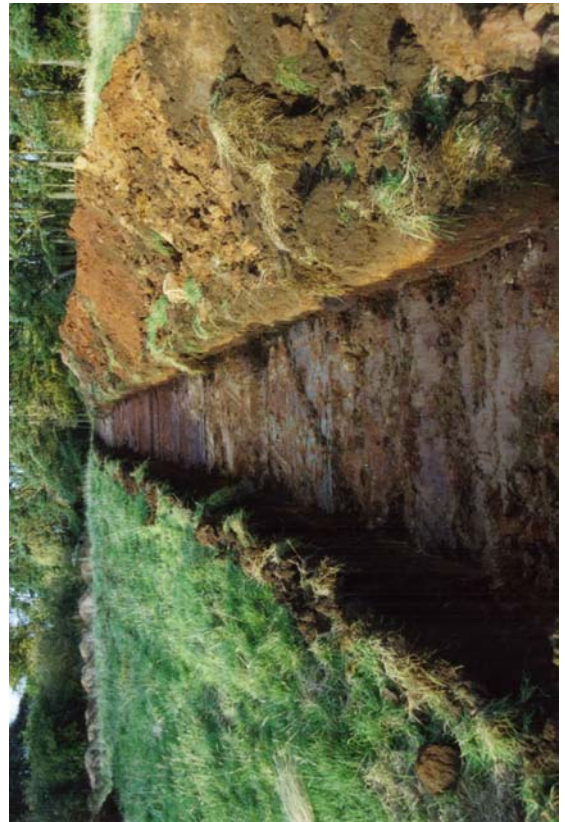

Fig. 3g: South Area: Post Excavation of Trench 6

## 5 Discussion

- 5.1 No archaeological features were identified during the course of the archaeological evaluation at The Grange, St. Andrews. In addition the trenching failed to locate or recover any artefacts that suggested the presence of any pre-19<sup>th</sup> century activity within the proposed development area.
- 5.2 The evaluation trenching in the northern portion was of limited physical extent, but did focus on the planned development elements within this area. Hence in the northern portion the comment on the absence of archaeologically significant material bears solely on the new build elements. However, since the new build elements in this area are limited in scale and the balance of the ground will be retained as gardens, then any archaeology that is present in this area would be preserved *in-situ* within ground whose use will remain unaltered.
- 5.3 The relatively high number of field drains indicates a clear attempt to improve drainage especially in the southern portion of the development area. The majority of the drains were aligned on a more or less north/south axis. This would support the assertion that the ground has been mainly used as agricultural land.

## 6 Recommendations

- 6.1 Presented below are our provisional recommendations for archaeological mitigation in the event of the development proceeding. These recommendations are framed with reference to the issued planning guidance. The appropriateness and acceptability of our recommendations rest with Fife Council and the Fife Archaeology Service, their advisors. Confirmation that the below recommendations are acceptable should be confirmed with these bodies prior to the implementation of any development works whose appropriateness may rely on these recommendations.
- 6.2 The investigative works have failed to identify any significant archaeology and the character of the ground was such as to suggest that these findings are a reasonable representation of the ground to be impacted upon by the development. Consequently we recommend that the development will not have an identifiable adverse impact on archaeology and hence no further archaeological works are appropriate in the course of the agreed development.

## 7 Conclusion

- 7.1 A programme of archaeological investigative works was undertaken in respect of: the enlargement of an existing house to form a hotel; construction of 10 timeshare units; and formation of a new service road (App. Ref: 06/03453/EFULL) to be erected at The Grange, Grange Road, St. Andrews, Fife centred NGR: NO 516. An evaluation was carried out from the 30<sup>th</sup> October-1<sup>st</sup> November 2007. The evaluation comprised fifteen trenches covering approximately 8.5% of the total area of ground to be impacted upon by the development.
- 7.2 A representative sample, as agreed with the Fife Archaeology Service, of all of the uncovered features with archaeological potential was investigated. The trenches exhibited a common stratigraphic sequence with topsoil up to 550mm in depth overlying either grey/orange mottled boulder clay or an orangey brown mixed sandy subsoil. Numerous field drains/ditches indicating an attempt at drainage were apparent throughout the field.
- 7.3 No significant archaeological features were identified during the course of the archaeological evaluation. In addition no artefacts were recovered that suggested site activity prior to the 19<sup>th</sup> century.

## 8 References

### *Documentary* SODev

1994      *National Planning Policy Guideline 5, Archaeology and planning*, Scottish Office Development Department.

### SOEnv

1994      *Planning Advice Note 42, Archaeology*, Scottish Office Environmental Department.

### *Cartographic*

#### Ainslie, John

1745-1828      County of Fife.

#### Gordon, James

1615?-1686      Fyfe, Counties of Scotland, 1580-1928

#### Ordnance Survey

1855      Fifehire, 1:10,560

#### Ordnance Survey

1896      Fifehire, 1:10,560

#### Ordnance Survey

1921      Fifehire, 1:10,560

#### Ordnance Survey

1938      Fifehire, 1:10,560

#### Roy, William

1747-1755      Roy's Military Survey of Scotland.

## Appendix 1: Trench Details

Within this appendix a standardised set of data pertaining to the evaluation trenches is presented.

All measurement distances quoted along the trench measure based on the quoted orientation of the trench. See Figure 8 for trench locations.

### *Trench 1*

Orientation:	South-east to North-west
Size:	2m by 79.1m (158.2m <sup>2</sup> )
Topsoil depth:	200mm to 350mm
Subsoil character	Directly below the topsoil across the whole of the trench lies subsoil (002), a loosely compacted mid brown silty sand, for a depth of 450-550mm. Below this lies subsoil (003), a loosely compacted mottled pale yellow/orange/brown silty sand, which is present for the first 10.5m of the trench, before being replaced by subsoil (004), a moderately compact mottled mid-dark brown sandy clay. This is present for the rest of the trench for a depth of 340-350mm, overlying subsoil (006), a moderately compact dark grey silty clay with medium stone inclusions.
Modern features:	Red tile drain (005) runs ESE-WNW across the trench at 10.9m until 35.5m. Measures 100mm wide. Modern pipe (023) runs SW-NE across the trench at 31.5m. Large black plastic tube. Possibly for water. Measures 200mm wide. Red tile drain (027) runs SW-NE across the trench at 66m. Measures 100mm wide. Stone rubble drain (007) runs SW-NE across the trench at 69.4m. Composed of sandstone $\leq$ 300mm. Measures 400mm wide and a depth of 250mm.
Significant features:	None
Artefacts:	None

### *Trench 2*

Orientation:	East to West
Size:	2m by 26m (52m <sup>2</sup> ).
Topsoil depth:	200mm to 300mm
Subsoil character:	Directly below the topsoil across the whole of the trench lies subsoil (004), a moderately compact mottled mid-dark brown sandy clay, for a depth of 270mm. Below this lies subsoil (009), a loosely compacted mottled pale yellow/orange/brown silty sand with large stone inclusions, for the first 8.2m of the trench.
Modern features:	Red tile drain (024) runs NE-SW across the trench at 0m. Measures 100mm wide. Linear field drain (008) runs NE-SW across the trench at 2.3m. Measures 250mm wide and 2m long. Stone rubble drain (025) runs N-S across the trench at 6.5m. Measures 400mm wide. Stone rubble drain (026) runs NE-SW across the trench at 11.5m until 21m. Measures 400mm wide. Stone rubble drain (016) runs N-S across the trench at 12.4m. Measures 500mm by 300mm by 2m.



Significant features: None

Artefacts: None

### *Trench 3*

Orientation: North-east to South-west

Size: 2m by 41m (82m<sup>2</sup>).

Topsoil depth 300mm to 330mm

Subsoil character: Subsoil (010), a loosely compacted mottled pale yellow/orange/brown/grey silty sand with frequent small stone inclusions, is present for the first 7.6m before being replaced by subsoil (011), a loosely compacted very pale grey/orange sandy silt with frequent small sandstone inclusions. This is present until 10m before changing to subsoil (012), a light brown sandy clay with sandy stony flecks. After 16m subsoil (004), a moderately compact mottled mid-dark brown sandy clay, lies directly underneath the topsoil for a depth of 800mm and overlies subsoil (013), a loosely compacted mottled pale yellow/orange/brown silty sand with large stone inclusions.

Modern features: Field drain (014) runs E-W across the trench at 15.5m. Measures 300mm wide and 3.2m long. Stone rubble drain (025) runs NW-SE across the trench at 20.6m. Measures 400mm wide. Red tile drain (015) runs N-S across the trench at 21.2m. Measures 150mm by 100mm. Stone rubble drain (016) runs NW-SE cross trench at 26m. Measures 500mm by 300mm by 2m.

Significant features: None

Artefacts: None

### *Trench 4*

Orientation: North-east to South-west

Size: 2m by 60m (120m<sup>2</sup>).

Topsoil depth: 300mm to 400mm.

Subsoil character: Directly underneath the topsoil lies subsoil (002), a loosely compacted mid brown silty sand, present after 25m for a depth of 600mm. Underlying the topsoil and subsoil (002) for the first 36m of the trench is subsoil (017), a moderately compact mixed white/red/pink/orange/yellow sand and pale sandstone with some waterbourn material (iron pan). This is then replaced by subsoil (018), a quite compact mixed red sands and frequent small stone inclusions, which then changes to subsoil (013), a loosely compacted mottled pale yellow/orange/brown silty sand with large stone inclusions, at 47m.

Modern features: Red tile drain (019) runs NW-SE across the trench at 51m. Measures 250mm by 150mm by 2m.

Significant features: None

Artefacts: None

### *Trench 5*

Orientation:	East to West
Size:	2m by 33m (66m <sup>2</sup> ).
Topsoil depth:	300mm to 320mm
Subsoil character:	Directly underneath the topsoil lies subsoil (004), a moderately compact mottled mid-dark brown sandy clay, across the whole of the trench for a depth of 300-320mm. Below this lies subsoil (020), a moderately compact mixed white/red/pink/orange/yellow sand and pale sandstone with some waterbourn material (iron pan), for the first 12m of the trench before being replaced by subsoil (021), a variant of (020) with white purer sand. At 16.6m this then changes to subsoil (013), a loosely compacted mottled pale yellow/orange/brown silty sand with large stone inclusions.
Modern features:	Red tile drain (021) runs SE-NW across the trench at 15.2m. Measures 250mm by 150mm by 3m.
Significant features:	None
Artefacts:	None

### *Trench 6*

Orientation:	South to North
Size:	2m by 75m (150m <sup>2</sup> ).
Topsoil depth:	250mm to 400mm.
Subsoil character:	Directly underneath the topsoil lies (004), a moderately compact mottled mid-dark brown sandy clay, for the whole of the trench for a depth of 380-600mm. Below this lies subsoil (029), an orange and yellow sands with large degraded sandstone and small clay lenses, for the first 10m of the trench before being replaced by subsoil (030), a compact dark red-brown sand and gravel with streaks of (017). This is present until 22.7m where it changes to subsoil (017), a moderately compact mixed white/red/pink/orange/yellow sand and pale sandstone with some waterbourn material (iron pan). This then changes to subsoil (031), a variant of (017) but lighter sands and looser compaction, at 36.5m.
Modern features:	Stone rubble drain (028) runs SW-NE across the trench at 4.4m. Measures 250mm by 250mm by 3.5m.
Significant features:	None
Artefacts:	None

### *Trench 7*

Orientation:	South-east to North-west
Size:	2m by 49.5m (99m <sup>2</sup> ).
Topsoil depth:	250mm to 450mm.
Subsoil character:	Directly below the topsoil lies subsoil (004), a moderately compact mottled mid-dark brown sandy clay, across the whole of the trench

for a depth of 320-800mm. Below this lies subsoil (030), a compact dark red-brown sand and gravel with streaks of (017), for the first 12m of the trench before being replaced by subsoil (017), a moderately compact mixed white/red/pink/orange/yellow sand and pale sandstone with some waterbourn material (iron pan). At 22.3m this then changes to subsoil (021), a variant of (020) with white purer sand.

Modern features: Red tile drain (033) runs SW-NE across the trench at 6.5m. Measures 250mm by 250mm by 2m. Stone rubble drain (034) runs SW-NE across the trench at 21.2m. Measures 250mm by 200mm by 2m. Stone rubble drain (060) runs S-N across the trench at 29.3m. Measures 400mm by 150mm by 8m. Red tile drain (035) runs E-W across the trench at 47m. measures 250mm by 150mm by 2.2m.

Significant features: None

Artefacts: None

### *Trench 8*

Orientation: North-west to South-east

Size: 2m by 26m (52m<sup>2</sup>).

Topsoil depth: 300mm to 350mm.

Subsoil character: Directly below the topsoil lies subsoil (002), a loosely compacted mid brown silty sand, across the whole trench for a depth of 500-680mm. Below this lies subsoil (004), a moderately compact mottled mid-dark brown sandy clay, across the whole of the trench for a depth of 800-950mm. Underlying this is subsoil (017), a moderately compact mixed white/red/pink/orange/yellow sand and pale sandstone with some waterbourn material (iron pan), for the first 7m of the trench before being replaced by subsoil (037), a pale yellow clay with flecks of manganese. A deposit of manganese (038) is also present within the subsoil at 24.7m.

Modern features: Red tile drain (036) runs NW-SE across the trench at 0.4m until 7.3m. Measures 150mm by 150mm by 8m.

Significant features: None

Artefacts: None

### *Trench 9*

Orientation: South-east to North-west

Size: 2m by 13m (26m<sup>2</sup>).

Topsoil depth: 100mm to 270mm.

Subsoil character: Directly below the topsoil lies subsoil (004), a moderately compact mottled mid-dark brown sandy clay, across the whole of the trench for a depth of 200mm. Below this lies subsoil (032), a compact light pinkish-yellow clay with few inclusions, for the first 4m of the trench before being replaced by subsoil (039), a mixed dark pink/red with pale yellow/orange silty sandy clay with few inclusions.

Modern features: Linear field drain (040) runs SW-NE across the trench at 7.6m. V-shaped in section. Fill of mid-brown clayey sand with flecks of manganese. Measures 200mm by 170mm by 2m.

Significant features: None

Artefacts: None

#### *Trench 10*

Orientation: South-east to North-west

Size: 2m by 18m (36m<sup>2</sup>).

Topsoil depth: 200mm to 250mm.

Subsoil character: Directly below the topsoil lies subsoil (004), a moderately compact mottled mid-dark brown sandy clay, across the whole of the trench for a depth of 250-300mm. Below this lies subsoil (017), a moderately compact mixed white/red/pink/orange/yellow sand and pale sandstone with some waterbourn material (iron pan), for the first 8m of the trench, before being replaced by subsoil (045), a very mixed light-dark brown/grey/pinky red sandy clay with frequent small stone inclusions. A deposit of manganese (038) is also present within the subsoil at 15.7m.

Modern features: Stone rubble drain (041) runs WNW-ESE across the trench at 0m until 1.8m. Measures 400mm by 1.7m long. Red tile drain (042) runs SW-NE across the trench at 2m. Measures 600mm in diameter and 1.9m long. Red tile drain (043) runs SW-NE across the trench at 9m. Measures 700mm in diameter and 2m long. Red tile drain (044) runs SE-NW across the trench at 10m until 14m. Measures 100mm in diameter and 2m long.

Significant features: None

Artefacts: None

#### *Trench 11*

Orientation: South-east to North-west

Size: 2m by 15m (30m<sup>2</sup>).

Topsoil depth: 290mm to 300mm.

Subsoil character: Subsoil (039), a mixed dark pink/red with pale yellow/orange silty sandy clay with few inclusions, is present across the whole of the trench.

Modern features: None

Significant features: None

Artefacts: None

#### *Trench 12*

Orientation: South-east to North-west

Size: 2m by 10.5m (73.5m<sup>2</sup>).

Topsoil depth: 370mm to 470mm.

Subsoil character: Subsoil (046), a loosely compacted mixed pale yellow/brown silty sand with frequent small stone inclusions, is present across the whole trench.

Modern features: None

Significant features: None

Artefacts: None

### *Trench 13*

Orientation: South-east to North-west

Size: 2m by 21m (42m<sup>2</sup>).

Topsoil depth: 300mm to 335mm.

Subsoil character: Directly below the topsoil lies subsoil (002), a loosely compacted mid brown silty sand, across the whole of the trench for a depth of 470-550mm. Below this lies subsoil (004), a moderately compact mottled mid-dark brown sandy clay, across the whole of the trench for a depth of 600-900mm. Underlying this is subsoil (045), a very mixed light-dark brown/grey/pinky red sandy clay with frequent small stone inclusions, present across the whole of the trench.

Modern features: Red tile drain (047) runs S-N across the trench at 0m until 2m. Measures 250mm by 250mm by 1.3m. Red tile drain (048) runs S-N across the trench at 2.6m. Measures 250mm by 250mm by 1.8m. Stone rubble drain (049) runs SW-NE across the trench at 4m. Measures 300mm by 200mm by 2.2m. Red tile drain (050) runs NE-SW across the trench at 10m. Measures 200mm by 20mm by 2.1m. Organic material (052) is present in the trench starting at 11.7m until the end. Probably built up against an old hedge or fenceline, it consists of humic brown silt/roots organic matter mixed with subsoil (045) and measures a depth of 900mm. Stone rubble drain (051) runs S-N across the trench at 14.7m. Measures 250mm by 250mm by 1.3m.

Significant features: None

Artefacts: None

### *Trench 14*

Orientation: South to North

Size: 2m by 16m (32m<sup>2</sup>).

Topsoil depth: 200mm to 430mm.

Subsoil character: Directly below the topsoil is subsoil (002), a loosely compacted mid brown silty sand, which is present for the first 4m of the trench for a depth of 400mm. Underlying this is subsoil (045), a very mixed light-dark brown/grey/pinky red sandy clay with frequent small stone inclusions. After 4m the subsoil becomes (021), a variant of (020) with white purer sand.

Modern features: Red tile drain (053) runs SSE-NNW across the trench at 0m until 4m. Measures 150mm by 150mm by 4m. Red tile drain (054) runs SE-NW across the trench at 0m until 9m. Measures 100mm by 100mm by 10m. Red tile drain (055) runs SE-NW across the

trench at 5.5m. Measures 100mm by 100mm by 3m. Red tile drain (056) runs SE-NW across the trench at 6.5m. Measures 100mm by 100mm by 3.5m.

Significant features: None

Artefacts: None

#### *Trench 15*

Orientation: West-north-west to East-south-east

Size: 2m by 9.8m (19.6m<sup>2</sup>).

Topsoil depth: 270mm to 350mm.

Subsoil character: Directly below the topsoil lies subsoil (004), a moderately compact mottled mid-dark brown sandy clay, across the whole of the trench for a depth of 250-300mm. Below this lies subsoil (039), a mixed dark pink/red with pale yellow/orange silty sandy clay with few inclusions, which is present across the whole of the trench. Measures 100mm by 100mm by 2.6m.

Modern features: Red tile drain (057) runs SW-NE across the trench at 1.8m. Measures 100mm by 100mm by 2.6m. Red tile drain (058) runs SW-NE across the trench at 3m. Measures 100mm by 100mm by 3m. Red tile drain (059) runs SW-NE across the trench 6.7m. Measures 150mm by 150mm by 2.2m.

Significant features: None

Artefacts: None



## Appendix 2: Registers

### Context Register

No.	Trench	Interpretation	Description
001	-	Topsoil	Moderately compact humic dark brown clayey sandy silt.
002	1,4,8,13,14	Subsoil	Loosely compacted mid brown silty sand.
003	1	Subsoil	Loosely compacted mottled pale yellow/orange/brown silty sand.
004	1-3,5-10,13,15	Subsoil	Moderately compact mottled mid-dark brown sandy clay.
005	1	Field drain	Red tile drain. 100mm wide.
006	1	Subsoil	Moderately compact dark grey silty clay with medium stone inclusions.
007	1	Field drain	Stone rubble drain runs NE-SW along the side of central fence. Composed of sandstone $\leq 300\text{mm}$ . Measures 400mm wide and a depth of 250mm.
008	2	Field drain	Linear shaped cut measuring 250mm wide and 2m long.
009	2	Subsoil	Loosely compacted mottled pale yellow/orange/brown silty sand with large stone inclusions.
010	3	Subsoil	Loosely compacted mottled pale yellow/orange/brown/grey silty sand with frequent small stone inclusions.
011	3	Subsoil	Loosely compacted very pale grey/orange sandy silt with frequent small sandstone inclusions.
012	3	Subsoil	Light brown sandy clay with sandy stony flecks.
013	3,4,5	Subsoil	Loosely compacted mottled pale yellow/orange/brown silty sand with large stone inclusions. Similar to (009).
014	3	Field drain	Linear shaped cut orientated E-W. Measures 300mm wide and 3.2m long.
015	3	Field drain	Red tile drain. Measures 150mm by 100mm by 2m.
016	3	Field drain	Stone lined drain roughly measuring 500mm by 300mm by 2m.
017	4,6-8,10	Subsoil	Moderately compact mixed white/red/pink/orange/yellow sand and pale sandstone with some

			waterbourn material (iron pan).
018	4	Subsoil	Quite compact mixed red sands and frequent small stone inclusions. Similar to (017).
019	4	Field drain	Red tile drain measuring 250mm by 150mm by 2m.
020	5	Subsoil	Moderately compact mixed white/red/pink/orange/yellow sand and pale sandstone with some waterbourn material (iron pan).
021	5,7,14	Subsoil	Variant of (020) with white purer sand.
022	5	Field drain	Red tile drain measuring 250mm by 150mm by 3m.
023	1	Modern pipe	Large black plastic tube. Possibly for water. Measures 200mm wide.
024	2	Field drain	Red tile drain measuring 100mm wide.
025	2	Field drain	Stone rubble drain measuring 400mm wide.
026	2	Field drain	Stone rubble drain measuring 400mm wide.
027	1	Field drain	Red tile drain measuring 100mm wide.
028	6	Field drain	Narrow stone rubble drain containing ceramic pipe. Measures 250mm by 250mm by 3.5m.
029	6	Subsoil	Orange and yellow sands with large degraded sandstone and small clay lenses.
030	6,7	Subsoil	Compact dark red-brown sand and gravel with streaks of (017).
031	6	Subsoil	Variant of (017) but lighter sands and looser compaction.
032	7,9	Subsoil	Compact light pinkish-yellow clay with few inclusions.
033	7	Field drain	Red tile drain measuring 250mm by 250mm by 2m.
034	7	Field drain	Stone rubble drain measuring 250mm by 200mm by 2m.
035	7	Field drain	Red tile drain measuring 250mm by 150mm by 2.2m.
036	8	Field drain	Red tile drain measuring 150mm by

			150mm by 8m.
037	8	Subsoil	Pale yellow clay with flecks of manganese.
038	8,10	Deposit within subsoil	Very compact black stony manganese.
039	9,11,15	Subsoil	Mixed dark pink/red with pale yellow/orange silty sandy clay with few inclusions.
040	9	Field drain	Linear cut. V-shaped in section. Fill of mid-brown clayey sand with flecks of manganese. Measures 200mm by 170mm by 2m.
041	10	Field drain	Stone rubble drain runs WNW-ESE measuring 400mm by 1.7m long.
042	10	Field drain	Red tile drain orientated SW-NE. Measures 600mm in diameter and 1.9m long.
043	10	Field drain	Red tile drain orientated SW-NE. Measures 700mm in diameter and 2m long.
044	10	Field drain	Red tile drain orientated SE-NW. Measures 100mm in diameter and 2m long.
045	10,13,14	Subsoil	Very mixed light-dark brown/grey/pinky red sandy clay with frequent small stone inclusions.
046	11	Subsoil	Loosely compacted mixed pale yellow/brown silty sand with frequent small stone inclusions.
047	13	Field drain	Red tile drain measuring 250mm by 250mm by 1.3m.
048	13	Field drain	Red tile drain measuring 250mm by 250mm by 1.8m.
049	13	Field drain	Stone rubble field drain measuring 300mm by 200mm by 2.2m.
050	13	Field drain	Red tile drain measuring 200mm by 20mm by 2.1m.
051	13	Field drain	Stone rubble drain measuring 250mm by 250mm by 1.3m.
052	13	Organic material, probably built up against an old hedge or fenceline	Humic brown silt/roots organic matter mixed with subsoil (045). Measures a depth of 900mm.
053	14	Field drain	Red tile drain measuring 150mm by 150mm by 4m.

054	14	Field drain	Red tile drain measuring 100mm by 100mm by 10m.
055	14	Field drain	Red tile drain measuring 100mm by 100mm by 3m.
056	14	Field drain	Red tile drain measuring 100mm by 100mm by 3.5m.
057	15	Field drain	Red tile drain measuring 100mm by 100mm by 2.6m.
058	15	Field drain	Red tile drain measuring 100mm by 100mm by 3m.
059	15	Field drain	Red tile drain measuring 150mm by 150mm by 2.2m.
060	7	Field drain	Stone rubble drain measuring 400mm by 150mm by 8m.

*Photographic Register*

Image	Description	From	Date
1	General pre ex site shot (south field)	S	30/10/07
2	Shot of trench 1	NW	30/10/07
3	Pre ex shot of drain (007)	NE	30/10/07
4	NE facing section of slot through (007)	NE	30/10/07
5	Shot of trench 2	E	30/10/07
6	Shot of trench 3	NE	30/10/07
7	Shot of trench 4	NE	30/10/07
8	Working shot		30/10/07
9	Shot of trench 5	E	30/10/07
10	Working shot		30/10/07
11	Shot of trench 6	SW	30/10/07
12	Shot of modern plastic pipe (023) in trench 1	N	31/10/07
13	Working shot of trench 7	NW	31/10/07
14	Working shot of trenches 1 and 7	NW	31/10/07
15	Shot of trench 7	S	31/10/07
16	Working shot of trenches 6 and 7	S	31/10/07
17	Shot of trench 8	NW	31/10/07
18	General pre ex site shot of the garden	NNE	31/10/07
19	General shot of house	SE	31/10/07
20	General shot of opening and road	NW	31/10/07

21	General shot of fountain and walled garden	SE	31/10/07
22	General pre ex site shot of area of north end of proposed road	N	31/10/07
23	General pre ex site shot along area of proposed road	WNW	31/10/07
24	General pre ex site shot of raspberry bush area (area of proposed car park)	SSW	31/10/07
25	General pre ex shot along area of proposed road	NW	31/10/07
26	General pre ex site shot of area of proposed car park	S	31/10/07
27	General pre ex site shot of area of proposed car park	SE	31/10/07
28	Shot of trench 9	NW	31/10/07
29	Shot of trench 10	NW	31/10/07
30	Shot of trench 11	SE	31/10/07
31	Shot of trench 12	SE	31/10/07
32	Working shot	N	31/10/07
33	Shot of trench 13	SE	31/10/07
34	W facing section of trench 13 showing (052)	W	31/10/07
35	Shot of trench 14	S	31/10/07
36	Shot of trench 15	WNW	31/10/07
37	Working shot of trenches 14 and 15	NE	31/10/07
38	Shot of trenches 1 and 8 after backfilling	NW	01/11/07
39	Shot of trenches 1 and 8 after backfilling	SE	01/11/07
40	Shot of trenches 11 and 12 after backfilling	S	01/11/07
41	Shot of trenches 11 and 12 after backfilling	E	01/11/07
42	General shot of the house and front lawn	SE	01/11/07
43	Shot of trench 15 after backfilling	E	01/11/07
44	General shot of house and walled garden	SW	01/11/07
45	General shot of house towards trench 15	W	01/11/07
46	General shot of derelict pond and fountain	SE	01/11/07
47	Shot of trench 14 after backfilling	SSE	01/11/07
48	Shot of trench 3 after backfilling	NE	01/11/07
49	Shot of trench 4 after backfilling	NE	01/11/07
50	Shot of trench 5 after backfilling	N	01/11/07
51	Shot of trench 13 after backfilling	NW	01/11/07
52	Shot of trenches 9 and 10 after backfilling	N	01/11/07
53	General post-ex site shot (south field)	S	01/11/07

*Drawing Register*

<b>Sheet</b>	<b>No.</b>	<b>Trench</b>	<b>Title</b>	<b>Scale</b>	<b>Date</b>	<b>Author</b>
1	1	1	Plan of trench 1	1:100	30/10/07	CW
1	2	1	Sample of NE facing section of trench 1 at 25m	1:20	30/10/07	CW
1	3	2	Plan of trench 2	1:100	30/10/07	CW
1	4	3	Plan of trench 3	1:100	30/10/07	KS + CW
1	5	4	Plan of trench 4	1:100	30/10/07	KS
1	6	5	Plan of trench 5	1:100	30/10/07	KS
1	7	6	Plan of trench 6	1:100	31/10/07	KS
2	8	7	Plan of trench 7	1:100	31/10/07	KS
2	9	8	Plan of trench 8	1:100	31/10/07	KS
2	10	9	Plan of trench 9	1:100	31/10/07	CW
2	11	10	Plan of trench 10	1:100	31/10/07	CW
2	12	11	Plan of trench 11	1:100	31/10/07	CW
2	13	12	Plan of trench 12	1:100	31/10/07	CW
2	14	13	Plan of trench 13	1:100	31/10/07	KS
2	15	13	Section of trench 13 showing (052)	1:50	31/10/07	KS
2	16	14	Plan of trench 14	1:100	31/10/07	CW
2	17	15	Plan of trench 15	1:100	31/10/07	CW



## Appendix 3: Discovery &amp; Excavation in Scotland

<b>LOCAL AUTHORITY:</b>	Fife
<b>PROJECT TITLE/SITE NAME:</b>	The Grange, St. Andrews
<b>PARISH:</b>	St. Andrews and St. Leonards
<b>NAME OF CONTRIBUTOR:</b>	Katie Sludden
<b>NAME OF ORGANISATION:</b>	Rathmell Archaeology Limited
<b>TYPE(S) OF PROJECT:</b>	Evaluation
<b>NMRS NO(S):</b>	None
<b>SITE/MONUMENT TYPE(S):</b>	None
<b>SIGNIFICANT FINDS:</b>	None
<b>NGR (2 letters, 6 figures)</b>	NO 516 152
<b>START DATE (this season)</b>	31 <sup>st</sup> October 2007
<b>END DATE (this season)</b>	1st November 2007
<b>PREVIOUS WORK (incl. DES ref.)</b>	None
<b>PROPOSED FUTURE WORK:</b>	None
<b>MAIN (NARRATIVE) DESCRIPTION:</b> (may include information from other fields)	<p>A programme of archaeological investigative works was undertaken in respect of a proposed housing development within land south of The Grange, Grange Road, St. Andrews, Fife. The evaluation comprised fifteen trenches covering approximately 8.5% of the total area to be impacted upon by the development.</p> <p>The trenches exhibited a common stratigraphic sequence with topsoil up to 400mm in depth overlying mixed clays or orange and yellow sandy gravel subsoil.</p> <p>No significant archaeological features were identified during the course of the archaeological evaluation.</p>
<b>PROJECT CODE:</b>	RA07056
<b>SPONSOR OR FUNDING BODY:</b>	C&L Properties
<b>ADDRESS OF MAIN CONTRIBUTOR:</b>	10 Ashgrove Workshops, Kilwinning, Ayrshire KA13 6PU
<b>E MAIL:</b>	contact@rathmell-arch.co.uk
<b>ARCHIVE LOCATION (intended/deposited)</b>	Report to Fife Archaeology Service and archive to National Monuments Record of Scotland.

## Contact Details

Rathmell Archaeology can be contacted at its Registered Office or through the web:

**Rathmell Archaeology Ltd**

10 Ashgrove Workshops  
Kilwinning  
Ayrshire  
KA13 6PU

[www.rathmell-arch.co.uk](http://www.rathmell-arch.co.uk)

t.: 01294 542848  
m.: 07817 334907

f.: 01294 542849  
e.: [contact@rathmell-arch.co.uk](mailto:contact@rathmell-arch.co.uk)

The Fife Archaeology Service can be contacted at their office or through the web:

**Fife Archaeology Unit**

Development Services  
Forth House  
Abbotshall Road  
North Street  
Kirkcaldy  
KY1 1RU

t.: 01593 417912

f.: 01593 417641  
e.: [douglas.speirs@fife.gov.uk](mailto:douglas.speirs@fife.gov.uk)

End of Document