

**Land to the North of 116 Main Street
Newton upon Ayr:
Archaeological Evaluation**

Data Structure Report

by Katie Sludden

issued 28th September 2007



Rathmell

Archaeology Ltd

Quality Assurance

This report covers works which have been undertaken in keeping with the issued brief as modified by the agreed programme of works. The report has been prepared in keeping with the guidance of Rathmell Archaeology Limited on the preparation of reports. All works reported on within this document have been undertaken in keeping with the Institute of Field Archaeology's Standards and Policy Statements and Code of Conduct.

Signed Date

In keeping with the procedure of Rathmell Archaeology Limited this document and its findings have been reviewed and agreed by an appropriate colleague:

Checked Date

Copyright Rathmell Archaeology Limited. All rights reserved.

No part of this report may be copied or reproduced by any means without prior written permission from Rathmell Archaeology Limited. If you have received this report in error, please destroy all copies in your possession or control and notify Rathmell Archaeology Limited.

This report has been prepared for the exclusive use of the commissioning party and unless otherwise agreed in writing by Rathmell Archaeology Limited, no other party may use, make use of or rely on the contents of the report. No liability is accepted by Rathmell Archaeology Limited for any use of this report, other than the purposes for which it was originally prepared and provided.

Opinions and information provided in the report are on the basis of Rathmell Archaeology Limited using due skill, care and diligence in preparation of the same and no explicit warranty is provided as to their accuracy. It should be noted and it is expressly stated that no independent verification of any of the documents or information supplied to Rathmell Archaeology Limited has been made.

Contents

1 Overview	4
2 Historical Background	4
3 Project Works	8
4 Findings	8
5 Recommendations	10
6 Conclusion	11
7 References	12
Appendix 1: Record Summaries	13
Appendix 2: Trench Descriptions	14
Appendix 3: Discovery and Excavation Scotland	15
Contact Details	16

Figures

Fig. 1	Site Location and Amended Trench Layout	5
Fig. 2a	116 Main Street in 1818	6
Fig. 2b	116 Main Street in 1855	6
Fig. 2c	116 Main Street in 1860	7
Fig. 2d	116 Main Street in 1897	7
Fig. 3a:	General Shot of Trench 2	9
Fig. 3b:	Sample Section Shot of Trench 2	9
Fig. 3c:	General Shot of Trench 2: Shallow Floor Surfaces	10
Fig. 3d:	Sample Section Shot of Trench 4	10

1 Overview

- 1.1 This Data Structure Report presents the findings of an archaeological evaluation undertaken, on behalf of Damside Contruction Ltd in respect of the construction of a dwelling house and associated works on a site directly north of 116 Main Street, Newton upon Ayr. The archaeological works were designed to mitigate the impact on the archaeological remains within the development area.
- 1.2 The area concerned measures roughly 0.025ha in extent and is currently waste ground. It is bounded by a supermarket car park to the east, 116 Main Street to the south, the A79 (Main Street) to the west and Damside to the north (Fig. 1).
- 1.3 South Ayrshire Council required archaeological monitoring to be undertaken as a requirement of the issued planning consent. The archaeological works were designed to address the general ground reduction and foundations relating to the new building. This condition was in keeping with the issued planning guidance (SODev 1994; SOEnd 1994) and was based on the guidance provided by the West of Scotland Archaeology Service.
- 1.4 Rathmell Archaeology Ltd was appointed to act with regard to the archaeological condition for Damside Contruction Ltd. The terms of the monitoring were agreed through a Written Scheme of Investigation (Rees 2007) agreed in advance with the West of Scotland Archaeology Service on behalf of South Ayrshire Council.

2 Historical Background

- 2.1 The development area is within the defined area of the burgh of Newton upon Ayr. The burgh was probably erected as a burgh of barony in the mid fourteenth century, although she never rivalled Ayr in economic influence. Armstrong's depiction of the burgh in 1775 shows the burgh to be extensive, and the development area can be seen lying at the northern end of the eastern terrace of New (latterly Main) Street (Strawhorn, 1989). At this location there is a free standing structure mid-road and a pond (either natural or more likely a mill pond to manage the stream that flows down the centre of the Main Street to the Mill, on the bank of the River Ayr).
- 2.2 Damside was name after the water course that ran down to Newton Mill from Newton Loch (Close, 2001) and can be seen on the 1818 Map of Ayrshire in Figure 2a. A *Gas Works* is also found on the 1855 map (NMRS No. NS32SW 106), just beyond the development area to the east. In particular, a circular feature is illustrated, marked *Gasometer* on the 1855 map. This structure still exists in 1860 (Fig. 2c) but it is not marked on the later 1897 map (Fig. 2d), although there is a building marked on the later map here. The 1938 map (Fig 2e) shows the development area void of any structure. It seems then that the only structural evidence that would be expected on the site would be buildings relating to the nearby Gasworks (NMRS No. NS32SW 106).
- 2.3 There are no known archaeological sites of significance in the development area. There is a nominal hazard to significant archaeological features being present.

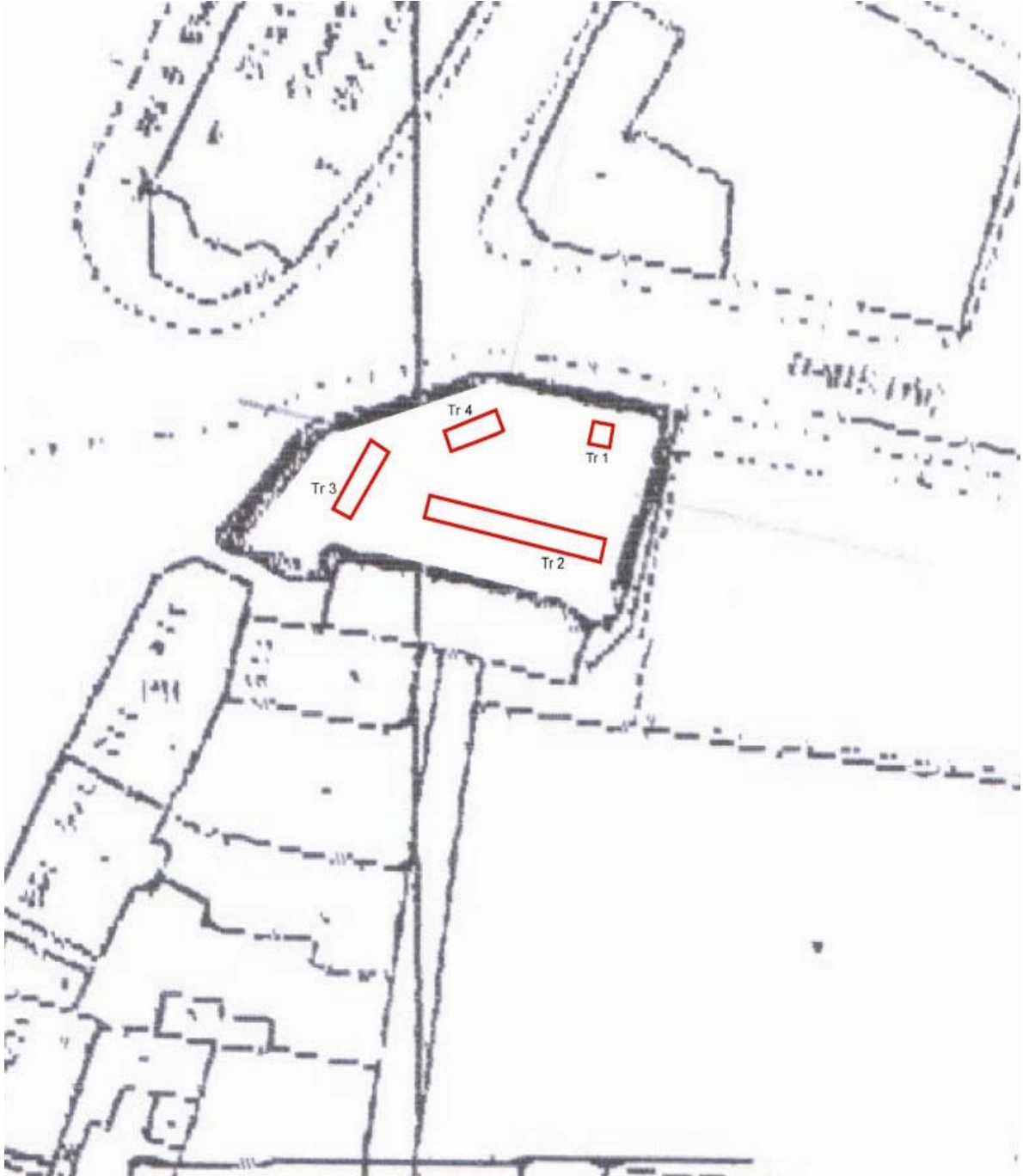

Figure 1: Site Location and Amended Trench Layout

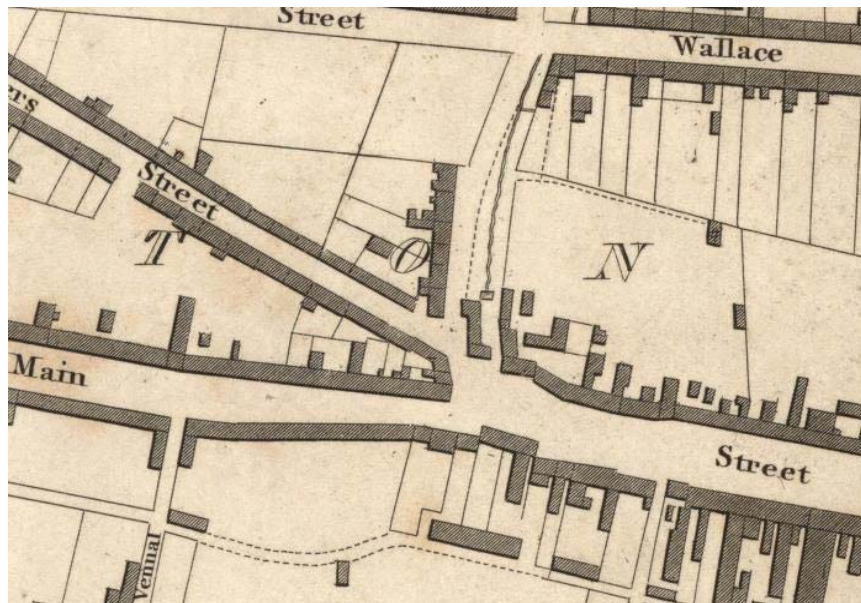

Figure 2a: Main Street in 1818, Wood

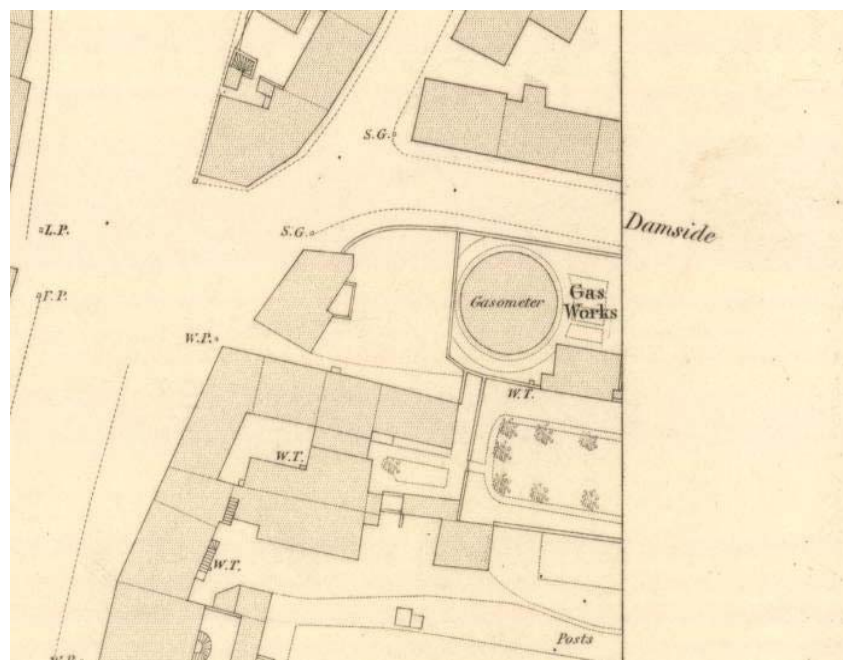

Figure 2b: Main Street in 1855, Ordnance Survey



Figure 2c: Main Street in 1860, Ordnance Survey

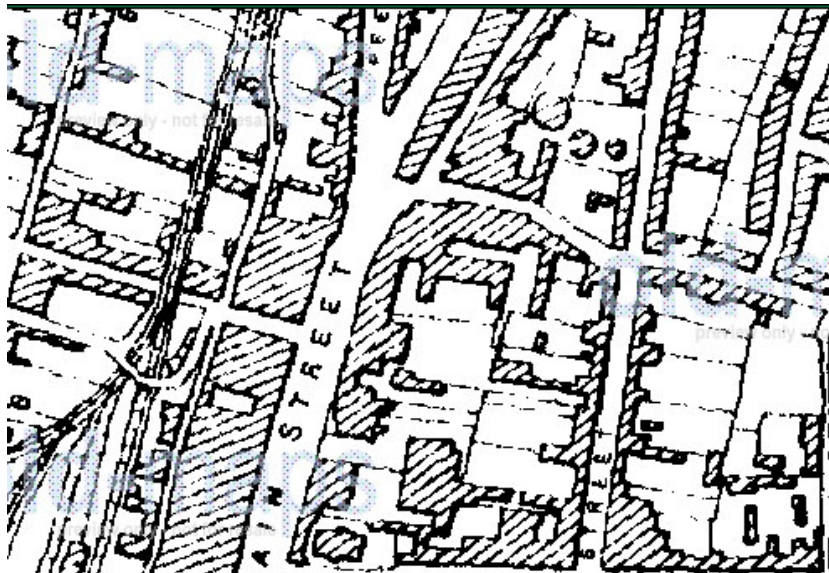

Figure 2d: Main Street in 1897, Ordnance Survey



Figure 2e: Main Street in 1938, Ordnance Survey

3 Project Works

- 3.1 The evaluation commenced on the 20th September 2007; the works included four separate trenches placed within the development area, comprising a total of 21m of linear trenching. The first trench hit a previously unknown active iron water pipe, which was broken and flooded the surrounding area. Archaeological works were halted until further services were investigated. The trench scheme was suitably amended and works recommenced on the 25th September.
- 3.2 The trenches did not uncover any structures relating to the nearby 19th century Gasworks (NMRS no. NS32SW 106).
- 3.3 In compliance with the Written Scheme of Investigation any potential archaeological features were investigated. All features impacted by the ground reduction appeared to be of relatively modern or natural origin, and throughout the course of the investigation no artefacts were recovered.
- 3.4 All works complied with WoSAS Standard Conditions, the Institute of Field Archaeology's Standards and Policy Statements and Code of Conduct and Historic Scotland Policy Statements.

4 Findings

- 4.1 The development area is centred NGR: NS 3391 2254. The land was covered in industrial waste and dumps: all modern; glass, ceramic, metal, plastics and concrete. On the first visit to site a fire hydrant and street lighting was noted on the pavement to the west of the site. The electric cable to this lighting was discovered at the south end of Trench 3, and was left undamaged.
- 4.2 The stripping was undertaken using a 1.6m wide toothless ditching bucket. Here, mixed waste materials were removed to reveal mixed demolition debris that comprised of a white lime mortar and brick waste. The underlying sediments were fairly uniform in depth and texture sitting on natural subsoil at a maximum depth of 1.45m. These consisted of brown sand and dark yellow clay, possibly levelling material for the site, and probably a modern deposit. Sample sections (Fig. 3b and Fig. 3d) show the depth and nature of the sediments. The natural subsoil onsite consisted of dark blue-grey stony sand: no charcoal or any other cultural material was recovered from these lower deposits. It is likely that these deposits are an indication of modern (early to mid-twentieth century) landscaping which may have removed any underlying archaeological structures.
- 4.3 The top deposit revealed only modern materials: plastic, degraded metal, modern ceramics and window glass. None of these were retained. Trench 1 uncovered one of many iron water pipes within the development area (Fig. 3a). None of these were known to exist and Scottish Water has no record of them. They may have been constructed privately whilst the ground was disused. These pipes are found at a relatively shallow depth of 200-300mm. Three of them run N-S while three run E-W meeting at (at least) one junction found in Trench 2.
- 4.4 Several modern surfaces were encountered at fairly shallow depths in Trench 1; two cobbled surfaces in particular (Fig. 3c). These probably relate to a nearby twentieth century Lemonade factory or are earlier versions of Damside to the north. Indeed the site is known to have been fully occupied by buildings in the late nineteenth century (see Fig. 2d) but was open ground by the early twentieth century (see Fig. 2e). It is probable that the cobble surfaces and levelling deposits relate to forming this open ground after the demolition of the structures.
- 4.5 There was no evidence from the evaluation trenches of the character or extent of the nineteenth century structures shown to cover either part (Fig. 2b in 1855) or the whole site (Fig. 2d in 1897). Equally there were no identifiable anthropic sediments that could be taken to confidently predate this now sequence of construction.



Fig. 3a: General Shot of Trench 2



Fig. 3b: Sample Section Shot of Trench 2



Fig. 3c: General Shot of Trench 2: Shallow Cobbled Surfaces



Fig. 3d: Sample Section Shot of Trench 4

5 Recommendations

- 5.1 The archaeological monitoring failed to identify any significant archaeological features or artefacts within the development area. The absence of any evidence on-site for the known nineteenth century structures suggests large scale clearance of the site followed by re-levelling and surfacing in the early to mid twentieth century. Consequently, we recommend that no further archaeological works are appropriate.
- 5.2 The appropriateness and acceptability of our recommendations rest with South Ayrshire Council and the West of Scotland Archaeology Service, their advisors. Confirmation that the above recommendations are acceptable should be confirmed with these bodies prior to the implementation of any development works whose appropriateness may rely on these recommendations.

6 Conclusion

- 6.1 An archaeological evaluation exercise was carried on the 20th and 25th September 2007 for Damside Construction Ltd in respect of the construction of new structures and associated works directly north of 116 Main Street, Newton upon Ayr. The evaluation revealed no archaeological features or artefacts that warrant further investigation.
- 6.2 On balance we have illustrated that this development has not adversely impacted on any archaeological remains and we recommend that no further archaeological works are appropriate.

7 References

7.1 Bibliographic References

Close, Rob	2001	<i>The Street Names of Ayr</i> , Ayrshire monographs No. 25, Ayrshire Archaeological and Natural History Society.
Rees, T	2007	<i>Land to the North of 116 Main Street, Newton upon Ayr: Archaeological Mitigation, Written Scheme of Investigation</i>
SODev	1994	<i>National Planning Policy Guideline 5, Archaeology and planning</i> , Scottish Office Development Department.
SOEnd	1994	<i>Planning Advice Note 42, Archaeology</i> , Scottish Office Environmental Department.
Strawhorn, John	1989	<i>The History of Ayr: Royal Burgh and County Town</i> , John Donald Publishers Ltd.

7.2 Cartographic References

Ordnance Survey	1855	<i>Town Plan of Ayr</i> , 1:10,560
Ordnance Survey	1897	<i>Ayrshire</i> , 1:10,560
Ordnance Survey	1858	<i>Ayrshire</i> , 1:2,500
Ordnance Survey	1860	<i>Ayrshire</i> , 1:10,560
Ordnance Survey	1938	<i>Ayrshire</i> 1:10,560
Wood, John	1818	<i>Plan of the Town and Parishes of Ayr, Newton upon Ayr & St. Quivox.</i>

Appendix 1: Record summaries

Context Summaries

No.	Interpretation	Description
101	Industrial wasteland/ Debris	Top deposit. Mixed modern dump materials; window glass, bottle glass, concrete, brick, sand, plastic, ceramics and metal. Depth of 200mm-300mm across site.
102	Demolition debris	Mixed white lime mortar, yellow brick, red brick, concrete and clay debris. Depth of 300mm and is 300mm thick, exists only in south eastern part of site.
103	Levelling material	Mixed mid-brown sand with clay and dark silty deposits. Varies across site but is generally found at 500mm depth and is 400mm thick. Dump material or possible levelling material.
104	Levelling material	Mixed dark yellow clay, is at 900mm depth and is up to 300mm thick. Sits on natural subsoil 105.
105	Natural subsoil	Dark blue-grey stony sand, moist. Found at 1.25m in western half of site and 1.45m in eastern half of site..

Drawing Register

Sheet	No.	Title	Scale	Date	Author
1	001	Measured Sketch Plan of Trenched Area	1:100	25/09/07	KS

Photographic record

Image no.	Description	From	Date
1	Trench 2 South Facing Section	S	25/09/07
2	Trench 3 NW Facing Section	NW	25/09/07
3	Trench 4 General Shot	W	25/09/07
4	Trench 2 General Shot	W	25/09/07
5	Trench 1 General Shot	S	25/09/07
6	General Shot of site	NE	25/09/07
7	Trench 2: Cobbles	N	25/09/07
8	Trench 2 General shot	W	25/09/07

Appendix 2: Trench Descriptions

Trench Number	Location	Description
01	North-east corner of site	Orientated E-W, is 1.5m long by 1.6m wide by 300mm deep. Contains an iron water pipe; running N-S through site.
02	Along southern boundary of site, from southeast corner.	Orientated E-W, is 12m long by 1.6m wide by 1.45 m deep. Contains three iron pipes two running N-S, one at intersection running E-W in extended section of trench. Trench was extended at its' east end to follow pipe running north but left at shallow depth to allow Scottish Water access.
03	Runs along northwest boundary of site.	Orientated SSW-NNE, is 5m long by 1.6m wide by 1.25m deep. Electric cable runs along the southern edge of the trench and remains intact. An iron pipe running E-W remains along the trenches' northern edge.
04	Runs E-W along the northern edge of the site.	Orientated SW-NE, is 2.5m long by 1.6m wide by 1.25m deep.

Appendix 3: Discovery & Excavation in Scotland

LOCAL AUTHORITY:	South Ayrshire
PROJECT TITLE/SITE NAME:	Land to the North of 116 Main Street, Newton upon Ayr
PARISH:	Newton upon Ayr
NAME OF CONTRIBUTOR:	Katie Sludden
NAME OF ORGANISATION:	Rathmell Archaeology Limited
TYPE(S) OF PROJECT:	Evaluation
NMRS NO(S):	None
SITE/MONUMENT TYPE(S):	None
SIGNIFICANT FINDS:	None
NGR (2 letters, 6 figures)	NS 044257
START DATE (this season)	20 th September 2007
END DATE (this season)	25 th September 2007
PREVIOUS WORK (incl. DES ref.)	None
PROPOSED FUTURE WORK:	None
MAIN (NARRATIVE) DESCRIPTION: (may include information from other fields)	Archaeological evaluation was carried on the 20 th and the 25 th September 2007 for Damside Construction Ltd in respect of the construction of a dwelling house and associated works in an area North of 116 Main Street, Newton upon Ayr. The archaeological evaluation failed to identify any significant archaeological features within the development area.
PROJECT CODE:	07058
SPONSOR OR FUNDING BODY:	Damside Construction Ltd
ADDRESS OF MAIN CONTRIBUTOR:	10 Ashgrove Workshops, Kilwinning, Ayrshire KA13 6PU
E MAIL:	contact@rathmell-arch.co.uk
ARCHIVE LOCATION (intended/deposited)	Report to West of Scotland Archaeology Service and archive to National Monuments Record of Scotland.

Contact Details

Rathmell Archaeology can be contacted at its Office or through the web:

Rathmell Archaeology Ltd

10 Ashgrove Workshops
Kilwinning
Ayrshire
KA13 6PU

www.rathmell-arch.co.uk

t.: 01294 542848
m.: 07817 334907

f.: 01294 542849
e.: contact@rathmell-arch.co.uk

The West of Scotland Archaeology Service can be contacted at their office or through the web:

West of Scotland Archaeology Service

Charing Cross Complex
20 India Street
Glasgow
G2 4PF

www.wosas.org.uk

t.: 0141 287 8332-3

f.: 0141 287 9259
e.: enquiries@wosas.glasgow.gov.uk

End of Document