

**Whinhill Farm, Greenock:  
Archaeological Mitigation**

Data Structure Report (Revised)

by Alan Matthews

issued 4<sup>th</sup> February 2009



**Rathmell**  
Archaeology Ltd

---

## Quality Assurance

This report covers works which have been undertaken in keeping with the issued brief as modified by the agreed programme of works. The report has been prepared in keeping with the guidance of Rathmell Archaeology Limited on the preparation of reports. All works reported on within this document have been undertaken in keeping with the Institute of Field Archaeology's Standards and Policy Statements and Code of Conduct.

Signed ..... Date .....

In keeping with the procedure of Rathmell Archaeology Limited this document and its findings have been reviewed and agreed by an appropriate colleague:

Checked ..... Date .....

Copyright Rathmell Archaeology Limited. All rights reserved.

No part of this report may be copied or reproduced by any means without prior written permission from Rathmell Archaeology Limited. If you have received this report in error, please destroy all copies in your possession or control and notify Rathmell Archaeology Limited.

This report has been prepared for the exclusive use of the commissioning party and unless otherwise agreed in writing by Rathmell Archaeology Limited, no other party may use, make use of or rely on the contents of the report. No liability is accepted by Rathmell Archaeology Limited for any use of this report, other than the purposes for which it was originally prepared and provided.

Opinions and information provided in the report are on the basis of Rathmell Archaeology Limited using due skill, care and diligence in preparation of the same and no explicit warranty is provided as to their accuracy. It should be noted and it is expressly stated that no independent verification of any of the documents or information supplied to Rathmell Archaeology Limited has been made.

## Contents

|   |    |
|---|----|
| 1 Overview                                      | 3  |
| 2 Project Works                                 | 3  |
| 3 Archaeological and Historical Background      | 6  |
| 4 Findings: Evaluation Trenches                 | 6  |
| 5 Discussion                                    | 8  |
| 6 Recommendations                               | 10 |
| 7 Conclusion                                    | 10 |
| 8 References                                    | 11 |
| Appendix 1 - Trench Details                     | 12 |
| Appendix 2 - Registers                          | 15 |
| Appendix 3 - Discovery & Excavation in Scotland | 20 |
| Contact Details                                 | 21 |

### *Figures*

|                |                      |   |
|----------------|----------------------|---|
| Figure 1 and 2 | Site Photographs     | 4 |
| Figure 3       | Trench location plan | 5 |
| Figure 4 and 5 | Site Photographs     | 7 |
| Figure 6 and 7 | Site Photographs     | 8 |

## 1 Overview

- 1.1 This Data Structure Report presents the findings for archaeological investigative works required by Zoom Developments in respect of a residential development (Planning application no. 08/0125/IC) to be undertaken at Whinhill Farm, Greenock, Inverclyde. The archaeological works were designed to mitigate the impact on the archaeological remains within the development area.
- 1.2 The findings presented below inform on the character of any archaeologically significant features occurring within the proposed development area and the appropriateness or requirement for further archaeological works. The character of any such further stages of work will need to be agreed with West of Scotland Archaeology Service and Inverclyde Council.
- 1.3 While the SMR has no recorded sites from within the development area, a number of sites of archaeological significance have been identified in the surrounding landscape. These include: a cup-marked rock on Whinhill Golf Course; cultivation terraces on Whin Hill; and cultivation remains at Auchmountain Glen. These sites illustrate activity in the general area and suggest a potential for additional sites that may survive only as buried sub-surface deposits.
- 1.4 Rathmell Archaeology Limited has been appointed by Zoom Developments Ltd to undertake the programme of investigative works which will establish the baseline of archaeological information within the proposed development area.

## 2 Project Works

- 2.1 The programme of works commenced with an archaeological evaluation through machine cut trenches which were initially to include 8% of the proposed development area, which measures some 3.8ha in extent. An initial target of 3040m<sup>2</sup> of trenching (approximately 1520 linear meters using a 2m bucket) was specified in the Written Scheme of Investigation. In total 1186m of linear trenching was excavated, slightly exceeding 6.2% of the study area. This reduction in the scale of the investigation was agreed, in consultation with West of Scotland Archaeology Service, to be appropriate to the Health and Safety constraints of the development area.
- 2.2 Placement of the evaluation trenches was rarely in keeping with the trench plan submitted within the Written Scheme of Investigation (Rees 2008). Alterations were made to the trench layout due to the presence of large trees on site but more particularly as a result of Health and Safety issues resulting from the instability of sediments on a steep slope (Figure 1). Further alterations to the initial layout resulted from the presence of a large water main running through the north-western half of the site.
- 2.3 Any exposed features were investigated and evaluated to determine their archaeological significance; the on-site works took place from the 12<sup>th</sup> to the 16<sup>th</sup> January 2009. All works were conducted in accordance with the West of Scotland Archaeology Service Standard Conditions, the Institute of Field Archaeology's Standards and Policy Statements and Code of Conduct and Historic Scotland Policy Statements.



Figure 1: Digger slide due to saturated topsoil



Figure 2: Trench 27

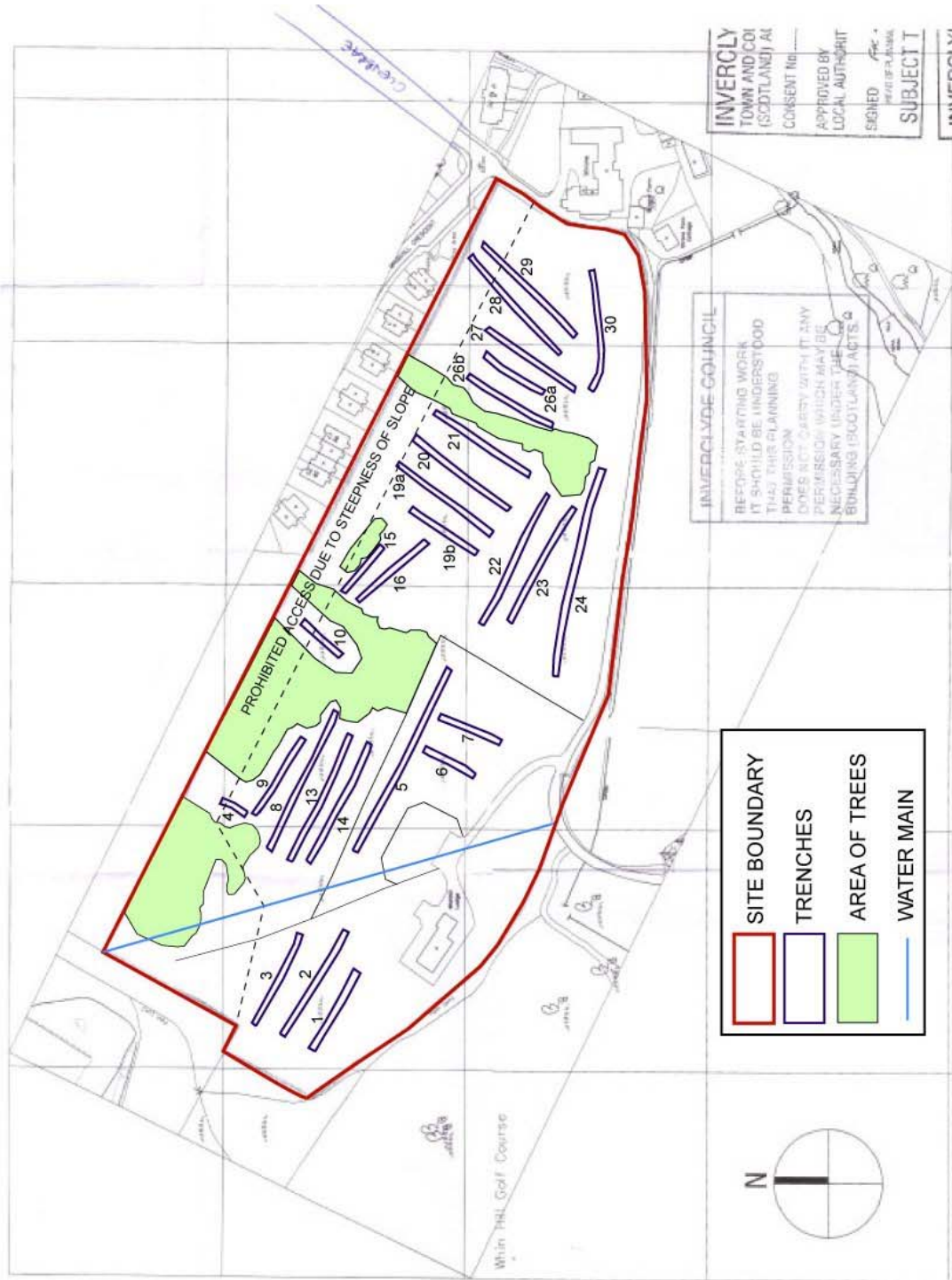

Figure 3: Trench Layout



### 3 Archaeological and Historical Background

- 3.1 Although no archaeological sites have been recorded within the development area, a number of sites of archaeological significance have been identified in the surrounding landscape. The closest site is listed as a farmstead at Strone (NMRS No. NS27SE 96) and consisted of two roofed buildings and three enclosures. Initially this site was thought to be located to the south of the development area. However when considering the route of Glenbrae Road, which follows the south-eastern limits of the development area, it was found that the farmstead was likely to exist to the east of Glenbrae Road. This farmstead (NMRS No.: NS27SE 96) can be therefore be positioned to where a modern farmstead currently resides to the east-southeast. This would suggest then that the original farmstead may be incorporated within the present farmstead or has been wholly or partially removed for its' construction.
- 3.2 Other sites of note in the surrounding landscape include cultivation terraces on Whin Hill; and cultivation remains at Auchmountain Glen (WoSAS Site ID: 14969). These sites were located during a field survey undertaken by the Centre of Field Archaeology and are located to the west of the development area (Alexander 1997). These sites illustrate evidence for activity in the general area and also demonstrate the potential for other signs of agricultural activity and land improvement within the development area.
- 3.3 There is a potential in the surrounding landscape for additional sites that may survive only as buried sub-surface deposits. This is illustrated by the finding of a cup-marked rock on Whinhill Golf Course. There is clearly some potential for prehistoric activity in the surrounding landscape and therefore within the development area.

### 4 Findings: Evaluation trenches

- 4.1 Twenty-seven evaluation trenches were opened across the development area. Full descriptions of each are contained in the appendices at the end of this report. Included below is a synthesis of the findings and interpretation from these trenches. The numbering of trenches was originally intended to reflect their location as shown in the trench layout included in the Written Scheme of Investigation. However, in the course of the investigative works, these numbers had to be altered and adapted to suit the needs of the project. As a result there are no Trenches 11, 12, 17, 18 and 25 (Figure 3).
- 4.2 The topsoil across the site (001) ranged between 100mm to 400mm in depth, though typically it was no deeper than 300mm. The natural subsoil was predominantly pink-orange compact clay (Figure 2) with occasional areas of grey clay at the north-western end of the site. There was very little evidence of bioturbation or disturbance of the subsoil. Where such evidence did occur it was mainly as a result of modern activity or tree roots. In several places large trees made access for the evaluation work impossible (Figure 4).
- 4.3 *Significant Archaeological features*
  - 4.3.1 No significant archaeological features were observed during the course of the evaluation works. All potential archaeological features were investigated but for the most part the subsoil was disturbed only by occasional tree roots.
- 4.4 *Artefacts*
  - 4.4.1 No artefacts were recovered during the evaluation though modern detritus (late nineteenth and twentieth century material) was observed within the topsoil in most trenches.
- 4.5 *Modern Disturbance*
  - 4.5.1 Several features were recorded in the evaluation trenches which showed evidence of modern disturbance on the site. Trenches 26a, 26b, 27, 28 and 29 all contained modern field drains which contained red tile drains (003). These features were clearly modern and frequently contained modern glass and ceramic material. Similarly, stone and rubble field drains were observed in Trenches 28 and 30 (004). These contained occasional fragments of modern glass and white glazed ceramic.



Figure 4: Digger among trees



Figure 5: Trench 14



- 4.5.2 Trench 16 contained a linear cut (006) with vertical sides which contained fragments of modern brick and modern glass. Although no drain pipe was observed in the fill this feature is still likely to be part of a modern drain. Feature (008) was another linear feature which had been cut into the subsoil (002) of Trench 14 (Figure 5). The most likely interpretation of this feature is a field drain; however, the only finds recovered from the feature were fragments of tarmac, ash and modern glass.
- 4.5.3 In two locations within the development area, Trenches 22 and 28, deposits, (005) and (009), of dark brown to black gravel were spread beneath the topsoil (001). These spreads contained fragments of modern glass and modern, white glazed ceramic. Although the origin of these deposits remains unclear they contained only modern building waste and modern rubbish.
- 4.5.4 Trench 7 contained a linear feature (010) and a large rectangular cut (011). No artefactual material was recovered from the linear feature but its size and orientation suggested that it was another field drain, possibly truncated. The rectangular cut which formed (011) was obviously machine cut and had been backfilled with type 1 gravel. It is unclear to what this feature related but it was clearly modern.
- 4.5.5 The location of those trenches which were placed at the north western end of the site was intentionally altered to avoid crossing the line of the water main which bisected the site in this area. Only the general location of the water main was known and the cut for its placement was not located in the evaluation trenches.

## 5 Discussion

### 5.1 *Significant Archaeological Features*

- 5.1.1 No significant archaeological features were uncovered in the course of the evaluation works. It would seem extremely unlikely that significant archaeological features survive anywhere on the site due to the adverse conditions created by the slope. The extremely compact and poorly draining clay subsoil with its shallow covering of loose topsoil means that without the bonding action of vegetation, footing across most of the development area becomes dangerously treacherous.
- 5.1.2 The difficulty experienced in putting a 13t 360 excavator safely on site may indicate that occupation of the site was never a feasible option, even in the prehistoric period. The only parts of the site where the slope was not a serious safety consideration were the near level portions along the south-western boundary of the development area.

### 5.2 *Modern Disturbance*

- 5.2.1 The only features which were cut into the subsoil were all apparently modern. In most cases these were field drains, the fills of which contained fragments of modern glass or pottery. It is entirely consistent with the formation and location of the site, being at the boundaries of agricultural areas, that some attempt should have been made in modern times to improve the condition of the ground. It was certainly evident during the course of the evaluation works that, despite the slope, the ground became extremely waterlogged in a short space of time due to the poorly draining subsoil.
- 5.2.2 Other modern features on site such as the spreads of gravel, (005) and (009), are most likely to be formed by the dumping of material at the boundaries of modern agricultural activity. Similarly, the large rectangular pit filled with Type 1 (011) could only have been of modern origin. It may also relate to marginal agricultural activity or it may relate to the near by water works.



Figure 6: North end of Trenches 19a, 20 and 21



Figure 7: Trenches 8, 13 and 14

## 6 Recommendations

- 6.1 The archaeological evaluation works failed to identify any significant archaeological features or artefacts within the development area. Consequently, we recommend that no further archaeological works are appropriate. We further recommend that no post-excavation analysis be carried out as no archaeologically significant material was recovered in the course of the archaeological monitoring works.
- 6.2 The appropriateness and acceptability of our recommendations rest with Inverclyde Council and the West of Scotland Archaeology Service, their advisors.

## 7 Conclusion

- 7.1 A programme of archaeological investigative works was undertaken in respect of a residential development (Planning application no. 08/0125/IC) to be undertaken at Whinhill Farm, Greenock, Inverclyde. This Data Structure Report presents the findings for archaeological evaluation works required by Zoom Developments. The archaeological works were designed to mitigate the impact on the archaeological remains within the development area. The evaluation works comprised twenty-seven trenches and took place from the 12<sup>th</sup> to the 16<sup>th</sup> January 2009.
- 7.2 The coverage of the evaluation trenches was limited in some places by the danger posed by the slope of the ground and by the location of several large trees. The trees were avoided where possible and dangerously sloping parts of the site, where the plant could not track safely, were also avoided. Evaluation trenches were placed wherever possible given the conditions and this resulted in 6.2% of the development area being evaluated.
- 7.3 No significant archaeological features were located anywhere within the proposed development area. In all of the evaluation trenches natural drift geology was reached and the only noted disturbance to the natural soil was as a result of tree roots or modern features. Rathmell Archaeology Ltd recommends that no further archaeological work is appropriate within the development area. The appropriateness of these recommendations is subject to the agreement of Inverclyde Council and their advisors West of Scotland Archaeology Service.

## 8 References

### 8.1 *Documentary*

|              |      |  |
|--------------|------|--|
| Alexander, D | 1997 | <i>Devol Moor to Spango Valley, Discovery and Excavation in Scotland</i>                                       |
| Rees         | 2008 | <i>'Whinhill Farm, Greenock: Archaeological Evaluation, Written Scheme of Investigation</i>                    |
| SODev        | 1994 | <i>National Planning Policy Guideline 5, Archaeology and planning, Scottish Office Development Department.</i> |
| SOEnd        | 1994 | <i>Planning Advice Note 42, Archaeology, Scottish Office Environmental Department.</i>                         |

### 8.2 *Cartographic*

|                 |         |                                     |
|-----------------|---------|-------------------------------------|
| Ordnance Survey | 1866    | 1 <sup>st</sup> edition map, 6 inch |
| Ordnance Survey | 1903    | 3 <sup>rd</sup> edition map 1:10560 |
| Roy             | 1747-55 | Military Survey of Scotland         |

## Appendix 1: Trench Details

Within this appendix a standardised set of data pertaining to the evaluation trenches is presented.

All measurement distances quoted along the trench measure based on the quoted orientation of the trench. See Figure 2 for trench locations.

| Trench | Orientation | Size (m <sup>2</sup> ) | Topsoil Depth (mm) | Subsoil Character  | Modern/ Agricultural Features    | Significant Features | Artefacts |
|--------|-------------|------------------------|--------------------|--|----------------------------------|----------------------|-----------|
| 1      | WNW-ESE     | 71                     | 280-300            | 002 Quite compact, dark pink-red silty clay with frequent mid-sized stone inclusions<br>007 compact pale mixed yellow-orange silty clay with frequent small stone inclusions | None                             | None                 | None      |
| 2      | ESE-WNW     | 90                     | 260-360            | 002 Quite compact, dark pink-red silty clay with frequent mid-sized stone inclusions<br>007 compact pale mixed yellow-orange silty clay with frequent small stone inclusions | None                             | None                 | None      |
| 3      | ESE-WNW     | 71.6                   | 200-380            | 002 Quite compact, dark pink-red silty clay with frequent mid-sized stone inclusions<br>007 compact pale mixed yellow-orange silty clay with frequent small stone inclusions | None                             | None                 | None      |
| 4      | SW-NE       | 20.4                   | 270                | 002 Quite compact, dark pink-red silty clay with frequent mid-sized stone inclusions   | None                             | None                 | None      |
| 5      | NW-SE       | 164                    | 200-330            | 002 Quite compact, dark pink-red silty clay with frequent mid-sized stone inclusions   | None                             | None                 | None      |
| 6      | SW-NE       | 42                     | 320-330            | 002 Quite compact, dark pink-red silty clay with frequent mid-sized stone inclusions   | None                             | None                 | None      |
| 7      | NE-SW       | 52                     | 330-420            | 002 Quite compact, dark pink-red silty clay with frequent mid-sized stone  | 010 Linear disturbance, possible | None                 | None      |



| Trench | Orientation | Size (m <sup>2</sup> ) | Topsoil Depth (mm) | Subsoil Character  | Modern/ Agricultural Features                                       | Significant Features | Artefacts |
|--------|-------------|------------------------|--------------------|--|---|----------------------|-----------|
|        |             |                        |                    | inclusions   | field drain<br>011 rectangular<br>machine cut filled<br>with type 1 |                      |           |
| 8      | SE-NW       | 124.8                  | 240-330            | 002 Quite compact, dark pink-red silty clay with frequent mid-sized stone inclusions | None  | None                 | None      |
| 9      | SE-NW       | 70.2                   | 300-350            | 002 Quite compact, dark pink-red silty clay with frequent mid-sized stone inclusions | None  | None                 | None      |
| 10     | SW-NE       | 40                     | 240                | 002 Quite compact, dark pink-red silty clay with frequent mid-sized stone inclusions | None  | None                 | None      |
| 13     | SE-NW       | 113.4                  | 190-330            | 002 Quite compact, dark pink-red silty clay with frequent mid-sized stone inclusions | None  | None                 | None      |
| 14     | ESE-WNW     | 106                    | 290-360            | 002 Quite compact, dark pink-red silty clay with frequent mid-sized stone inclusions | 008 Feature containing modern glass                                 | None                 | None      |
| 15     | ESE-WNW     | 48                     | 220-300            | 002 Quite compact, dark pink-red silty clay with frequent mid-sized stone inclusions | None  | None                 | None      |
| 16     | NW-SE       | 72.6                   | 250-300            | 002 Quite compact, dark pink-red silty clay with frequent mid-sized stone inclusions | 006 Possible field drain  | None                 | None      |
| 19a    | SW-NE       | 96.8                   | 200-280            | 002 Quite compact, dark pink-red silty clay with frequent mid-sized stone inclusions | None  | None                 | None      |
| 19b    | SW-NE       | 62                     | 240-300            | 002 Quite compact, dark pink-red silty clay with frequent mid-sized stone inclusions | None  | None                 | None      |
| 20     | SW-NE       | 98.6                   | 200-280            | 002 Quite compact, dark pink-red silty clay with frequent mid-sized stone inclusions | None  | None                 | None      |
| 21     | SW-NE       | 92                     | 200-300            | 002 Quite compact, dark pink-red silty   | None  | None                 | None      |

| Trench | Orientation | Size (m <sup>2</sup> ) | Topsoil Depth (mm) | Subsoil Character  | Modern/ Agricultural Features  | Significant Features | Artefacts |
|--------|-------------|------------------------|--------------------|--|--|----------------------|-----------|
|        |             |                        |                    | clay with frequent mid-sized stone inclusions  |  |                      |           |
| 22     | NW-SE       | 120                    | 300-400            | 002 Quite compact, dark pink-red silty clay with frequent mid-sized stone inclusions | 009 Loose dark grey shingle – modern material                        | None                 | None      |
| 23     | SE-NW       | 104                    | 280-350            | 002 Quite compact, dark pink-red silty clay with frequent mid-sized stone inclusions | None   | None                 | None      |
| 24     | W-E         | 166                    | 270-320            | 002 Quite compact, dark pink-red silty clay with frequent mid-sized stone inclusions | None   | None                 | None      |
| 26a    | SW-NE       | 55.6                   | 300-400            | 002 Quite compact, dark pink-red silty clay with frequent mid-sized stone inclusions | 003 Field Drain  | None                 | None      |
| 26b    | SW-NE       | 80.4                   | 250-270            | 002 Quite compact, dark pink-red silty clay with frequent mid-sized stone inclusions | 003 Field Drain  | None                 | None      |
| 27     | SW-NE       | 88.8                   | 240-300            | 002 Quite compact, dark pink-red silty clay with frequent mid-sized stone inclusions | 003 Field Drain  | None                 | None      |
| 28     | SW-NE       | 110.8                  | 100-300            | 002 Quite compact, dark pink-red silty clay with frequent mid-sized stone inclusions | 004 Field Drain, 005 Spread of black shingle containing modern glass | None                 | None      |
| 29     | SW-NE       | 105.4                  | 100-300            | 002 Quite compact, dark pink-red silty clay with frequent mid-sized stone inclusions | 003 Field Drain  | None                 | None      |
| 30     | W-E         | 101.2                  | 220-400            | 002 Quite compact, dark pink-red silty clay with frequent mid-sized stone inclusions | 004 Field Drain  | None                 | None      |

## Appendix 2: Registers

Within this appendix are all registers pertaining to works on-site regardless of the process by which that information was gathered (e.g. evaluation or strip, map & sample).

### Context Register

| Context No. | Area/Trench          | Type    | Description  | Interpretation          |
|-------------|----------------------|---------|--|-------------------------|
| 001         | All                  | Deposit | Dark brown moderately compact silty clay with frequent roots, modern rubbish and modern ceramic        | Topsoil                 |
| 002         | All                  | Deposit | Quite compact, dark pink-red silty clay with frequent mid-sized stone inclusions                       | Natural drift geology   |
| 003         | 26a, 26b, 27, 28, 29 | Drain   | Drain, red tile, cut vertical sides and 200mm wide   | Field drain             |
| 004         | 28, 30               | Drain   | Stone and rubble drain, 600mm wide   | Field drain             |
| 005         | 28                   | Deposit | Spread of loose dark brown-black gravel containing modern glass, white glazed ceramic                  | Modern deposit          |
| 006         | 16                   | Drain   | Linear cut, running NE-SW. 350mm wide. Contains some brick and modern glass fragments. Vertical sides. | Field drain             |
| 007         | 1, 2, 3              | Deposit | Compact pale mixed yellow-orange silty clay with frequent small stone inclusions                       | Natural drift geology   |
| 008         | 14                   | Drain   | Linear feature which contains ash, tarmac and modern glass   | Possible field drain    |
| 009         | 22                   | Deposit | Similar to 005 loose dark grey shingle/gravel.   | Modern dump of material |
| 010         | 7                    | Drain   | Linear feature. 400mm wide.  | Possible field drain    |
| 011         | 7                    | Cut     | Large rectangular machine cut, filled with type 1  | Modern feature          |

### Photographic Register

| Image No. | Digital | Print    |          | Slide    |          | Description                        | From | Date    |
|-----------|---------|----------|----------|----------|----------|------------------------------------|------|---------|
|           |         | Film No. | Neg. No. | Film No. | Neg. No. |                                    |      |         |
| 1         | 1       | 1        | 2        | 1        | 1        | General shot – eastern end of site | S    | 12/1/09 |
| 2         | 2       | 1        | 3        | 1        | 2        | General shot – eastern end of site | SW   | 12/1/09 |
| 3         | 3       | 1        | 4        | 1        | 3        | Tr 29                              | SW   | 12/1/09 |
| 4         | 4       | 1        | 5        | 1        | 4        | Tr 28                              | SW   | 12/1/09 |
| 5         | 5       | -        | -        | -        | -        | General shot showing bracken       | NW   | 12/1/09 |

| Image No. | Digital | Print    |          | Slide    |          | Description                        | From | Date    |
|-----------|---------|----------|----------|----------|----------|------------------------------------|------|---------|
|           |         | Film No. | Neg. No. | Film No. | Neg. No. |                                    |      |         |
| 6         | 6       | -        | -        | -        | -        | General shot showing bracken       | NW   | 12/1/09 |
| 7         | 7       | 1        | 6        | 1        | 5        | General shot – eastern end of site | NE   | 12/1/09 |
| 8         | 8       | 1        | 7        | 1        | 6        | General shot – eastern end of site | ENE  | 12/1/09 |
| 9         | 9       | -        | -        | -        | -        | Where digger slid                  | SW   | 12/1/09 |
| 10        | 10      | -        | -        | -        | -        | Where digger slid                  | NE   | 12/1/09 |
| 11        | 11      | 1        | 8        | 1        | 7        | Tr 27                              | SW   | 12/1/09 |
| 12        | 12      | 1        | 9        | 1        | 8        | Tr 26a                             | SW   | 12/1/09 |
| 13        | 13      | 1        | 10       | 1        | 9        | Tr 26b                             | SW   | 12/1/09 |
| 14        | 14      | 1        | 11       | 1        | 10       | Tr 30                              | E    | 12/1/09 |
| 15        | 25      | -        | -        | -        | -        | Machine working on slope – Tr 15   | -    | 13/1/09 |
| 16        | 26      | -        | -        | -        | -        | Machine working on slope – Tr 15   | -    | 13/1/09 |
| 17        | 27      | -        | -        | -        | -        | Slope below Tr 15                  | -    | 13/1/09 |
| 18        | 28      | -        | -        | -        | -        | Machine working on slope – Tr 15   | -    | 13/1/09 |
| 19        | 29      | 1        | 12       | 1        | 11       | Tr 21                              | SW   | 13/1/09 |
| 20        | 30      | -        | -        | -        | -        | General shot – Tr 21               | S    | 13/1/09 |
| 21        | 31      | 1        | 13       | 1        | 12       | General shot – Tr 21               | E    | 13/1/09 |
| 22        | 32      | 1        | 14       | 1        | 13       | General shot – Tr 21               | SE   | 13/1/09 |
| 23        | 33      | 1        | 15       | 1        | 14       | Tr 20                              | NE   | 13/1/09 |
| 24        | 34      | 1        | 16       | 1        | 15       | Tr 19a                             | NE   | 13/1/09 |
| 25        | 35      | 1        | 17       | -        | -        | Tr 19b                             | NE   | 13/1/09 |
| 26        | 36      | 1        | 18       | -        | -        | Tr 15                              | ESE  | 13/1/09 |
| 27        | 37      | 1        | 19       | -        | -        | Tr 16                              | SE   | 13/1/09 |
| 28        | 38      | -        | -        | -        | -        | General shot – Tr 16               | SE   | 13/1/09 |
| 29        | 39      | -        | -        | -        | -        | General shot – Tr 16               | W    | 13/1/09 |
| 30        | 40      | -        | -        | -        | -        | General shot – Tr 16               | SE   | 13/1/09 |
| 31        | 41      | 1        | 20       | 1        | 16       | Tr 9                               | SE   | 13/1/09 |
| 32        | 42      | 1        | 21       | 1        | 17       | Site shot – Tr 9                   | E    | 13/1/09 |
| 33        | 43      | 1        | 22       | 1        | 18       | Site shot – Tr 9                   | SE   | 13/1/09 |
| 34        | 44      | -        | -        | -        | -        | Site shot – trees                  | W    | 13/1/09 |
| 35        | 45      | -        | -        | -        | -        | Site shot – trees                  | SE   | 13/1/09 |
| 36        | 46      | 1        | 23       | 1        | 19       | Tr 10                              | SW   | 13/1/09 |

| Image No. | Digital | Print    |          | Slide    |          | Description                   | From | Date    |
|-----------|---------|----------|----------|----------|----------|-------------------------------|------|---------|
|           |         | Film No. | Neg. No. | Film No. | Neg. No. |                               |      |         |
| 37        | 47      | 1        | 24       | -        | -        | Trees NW of Tr 10             | E    | 13/1/09 |
| 38        | 48      | -        | -        | -        | -        | Trees SE of Tr 10             | NW   | 13/1/09 |
| 39        | 49      | -        | -        | -        | -        | Trees SE of Tr 8              | NE   | 13/1/09 |
| 40        | 50      | 1        | 25       | -        | -        | Tr 4                          | SW   | 13/1/09 |
| 41        | 51      | 1        | 26       | 1        | 20       | Trees below Tr 9              | W    | 13/1/09 |
| 42        | 52      | 1        | 27       | 1        | 21       | Trees below Tr 4              | SE   | 13/1/09 |
| 43        | 53      | 1        | 28       | -        | -        | Tr 8                          | NW   | 13/1/09 |
| 44        | 54      | 1        | 29       | -        | -        | Tr 13                         | NW   | 13/1/09 |
| 45        | 55      | 1        | 30       | -        | -        | Tr 14                         | NW   | 13/1/09 |
| 46        | 56      | 1        | 31       | -        | -        | Area NW of Tr 4, 8, 9, 13, 14 | SW   | 13/1/09 |
| 47        | 57      | 1        | 32       | -        | -        | Area NW of Tr 4, 8, 9, 13, 14 | WSW  | 13/1/09 |
| 48        | 58      | -        | -        | -        | -        | Area NW of Tr 4, 8, 9, 13, 14 | SW   | 13/1/09 |
| 49        | 59      | 1        | 33       | -        | -        | Tr 3                          | WNW  | 14/1/09 |
| 50        | 60      | 1        | 34       | -        | -        | Tr 2                          | WNW  | 14/1/09 |
| 51        | 61      | 1        | 35       | 1        | 22       | Tr 1                          | WNW  | 14/1/09 |
| 52        | 62      | -        | -        | -        | -        | General Shot                  | NW   | 14/1/09 |
| 53        | 63      | -        | -        | -        | -        | General Shot                  | SE   | 14/1/09 |
| 54        | 64      | -        | -        | -        | -        | General Shot                  | SE   | 14/1/09 |
| 55        | 65      | -        | -        | -        | -        | General Shot                  | SE   | 14/1/09 |
| 56        | 66      | -        | -        | -        | -        | General Shot                  | SE   | 14/1/09 |
| 57        | 67      | -        | -        | -        | -        | General Shot                  | S    | 14/1/09 |
| 58        | 68      | -        | -        | -        | -        | General Shot                  | SW   | 14/1/09 |
| 59        | 69      | -        | -        | -        | -        | General Shot                  | E    | 14/1/09 |
| 60        | 70      | -        | -        | -        | -        | General Shot                  | W    | 14/1/09 |
| 61        | 71      | 1        | 36       | -        | -        | Tr 22                         | NW   | 14/1/09 |
| 62        | 72      | 2        | 2        | 1        | 23       | Tr 23                         | NW   | 14/1/09 |
| 63        | 73      | 2        | 3        | 1        | 24       | Tr 24                         | W    | 14/1/09 |
| 64        | 74      | 2        | 4        | -        |          | Tr 5                          | NW   | 14/1/09 |
| 65        | 75      | 2        | 5        | -        |          | Tr 5                          | SE   | 14/1/09 |
| 66        | 76      | 2        | 6        | -        |          | Tr 7                          | NE   | 14/1/09 |
| 67        | 77      | 2        | 7        | -        |          | Tr 6                          | NE   | 14/1/09 |



| Image No. | Digital | Print    |          | Slide    |          | Description   | From | Date    |
|-----------|---------|----------|----------|----------|----------|---------------|------|---------|
|           |         | Film No. | Neg. No. | Film No. | Neg. No. |               |      |         |
| 68        | 78      | -        | -        | -        | -        | General Shots | -    | 14/1/09 |
| 69        | 79      | -        | -        | -        | -        | General Shots | -    | 14/1/09 |
| 70        | 80      | -        | -        | -        | -        | General Shots | -    | 14/1/09 |
| 71        | 81      | -        | -        | -        | -        | General Shots | -    | 14/1/09 |
| 72        | 82      | -        | -        | -        | -        | General Shots | -    | 14/1/09 |
| 73        | 83      | -        | -        | -        | -        | General Shots | -    | 14/1/09 |
| 74        | 84      | -        | -        | -        | -        | General Shots | -    | 14/1/09 |
| 75        | 85      | -        | -        | -        | -        | General Shots | -    | 14/1/09 |
| 76        | 86      | -        | -        | -        | -        | General Shots | -    | 14/1/09 |
| 77        | 87      | -        | -        | -        | -        | General Shots | -    | 14/1/09 |
| 78        | 88      | -        | -        | -        | -        | General Shots | -    | 14/1/09 |
| 79        | 89      | -        | -        | -        | -        | General Shots | -    | 14/1/09 |
| 80        | 90      | -        | -        | -        | -        | General Shots | -    | 14/1/09 |
| 81        | 91      | -        | -        | -        | -        | General Shots | -    | 14/1/09 |

*Drawing Register*

| Drawing No. | Sheet No. | Area/Trench | Drawing Type | Scale | Description | Drawer | Date    |
|-------------|-----------|-------------|--------------|-------|-------------|--------|---------|
| 01          | 1         | Tr 29       | Plan         | 1:100 | Tr 29       | CW     | 12/1/09 |
| 02          | 1         | Tr 28       | Plan         | 1:100 | Tr 28       | CW     | 12/1/09 |
| 03          | 1         | Tr 27       | Plan         | 1:100 | Tr 27       | CW     | 12/1/09 |
| 04          | 1         | Tr 26a      | Plan         | 1:100 | Tr 26a      | CW     | 12/1/09 |
| 05          | 1         | Tr 26b      | Plan         | 1:100 | Tr 26b      | CW     | 12/1/09 |
| 06          | 1         | Tr 30       | Plan         | 1:100 | Tr 30       | CW     | 12/1/09 |
| 07          | 1         | Tr 21       | Plan         | 1:100 | Tr 21       | CW     | 12/1/09 |
| 08          | 2         | Tr 20       | Plan         | 1:100 | Tr 20       | CW     | 13/1/09 |
| 09          | 2         | Tr 19a      | Plan         | 1:100 | Tr 19a      | CW     | 13/1/09 |
| 10          | 2         | Tr 19b      | Plan         | 1:100 | Tr 19b      | CW     | 13/1/09 |
| 11          | 2         | Tr 15       | Plan         | 1:100 | Tr 15       | CW     | 13/1/09 |
| 12          | 2         | Tr 16       | Plan         | 1:100 | Tr 16       | CW     | 13/1/09 |
| 13          | 2         | Tr 9        | Plan         | 1:100 | Tr 9        | CW     | 13/1/09 |

| <b>Drawing No.</b> | <b>Sheet No.</b> | <b>Area/<br/>Trench</b> | <b>Drawing Type</b> | <b>Scale</b> | <b>Description</b> | <b>Drawer</b> | <b>Date</b> |
|--------------------|------------------|-------------------------|---------------------|--------------|--------------------|---------------|-------------|
| 14                 | 2                | Tr 10                   | Plan                | 1:100        | Tr 10              | CW            | 13/1/09     |
| 15                 | 2                | Tr 8                    | Plan                | 1:100        | Tr 8               | CW            | 13/1/09     |
| 16                 | 2                | Tr 4                    | Plan                | 1:100        | Tr 4               | CW            | 13/1/09     |
| 17                 | 2                | Tr 13                   | Plan                | 1:100        | Tr 13              | CW            | 13/1/09     |
| 18                 | 3                | Tr 3                    | Plan                | 1:100        | Tr 3               | CW            | 14/1/09     |
| 19                 | 3                | Tr 2                    | Plan                | 1:100        | Tr 2               | CW            | 14/1/09     |
| 20                 | 3                | Tr 1                    | Plan                | 1:100        | Tr 1               | CW            | 14/1/09     |
| 21                 | 3                | Tr 14                   | Plan                | 1:100        | Tr 14              | CW            | 14/1/09     |
| 22                 | 3                | Tr 22                   | Plan                | 1:100        | Tr 22              | CW            | 14/1/09     |
| 23                 | 3                | Tr 23                   | Plan                | 1:100        | Tr 23              | CW            | 14/1/09     |
| 24                 | 3                | Tr 24                   | Plan                | 1:100        | Tr 24              | CW            | 14/1/09     |
| 25                 | 4                | Tr 5                    | Plan                | 1:100        | Tr 5               | CW            | 14/1/09     |
| 26                 | 4                | Tr 7                    | Plan                | 1:100        | Tr 7               | CW            | 14/1/09     |
| 27                 | 4                | Tr 6                    | Plan                | 1:100        | Tr 6               | CW            | 14/1/09     |

## Appendix 3: Discovery &amp; Excavation in Scotland

|  |   |
|--|---|
| <b>LOCAL AUTHORITY:</b>  | Inverclyde Council  |
| <b>PROJECT TITLE/SITE NAME:</b>  | Whinhill Farm, Greenock   |
| <b>PROJECT CODE:</b>   | RA08060   |
| <b>PARISH:</b>   | Greenock  |
| <b>NAME OF CONTRIBUTOR:</b>  | Alan Matthews   |
| <b>NAME OF ORGANISATION:</b>   | Rathmell Archaeology Limited  |
| <b>TYPE(S) OF PROJECT:</b>   | Evaluation  |
| <b>NMRS NO(S):</b>   | None  |
| <b>SITE/MONUMENT TYPE(S):</b>  | None  |
| <b>SIGNIFICANT FINDS:</b>  | None  |
| <b>NGR (2 letters, 6 figures)</b>  | NS 273 748  |
| <b>START DATE (this season)</b>  | 12 <sup>th</sup> January 2009   |
| <b>END DATE (this season)</b>  | 16 <sup>th</sup> January 2009   |
| <b>PREVIOUS WORK (incl. DES ref.)</b>  | None  |
| <b>MAIN (NARRATIVE) DESCRIPTION:</b> (may include information from other fields) | The coverage of the evaluation trenches was limited in some places by the danger posed by the slope of the ground and by the location of several large trees this resulted in 6.2% of the development area being evaluated. No significant archaeological features were located anywhere within the proposed development area. In all of the evaluation trenches natural drift geology was reached and the only noted disturbance to the natural soil was as a result of tree roots or modern features. |
| <b>PROPOSED FUTURE WORK</b>  | None  |
| <b>SPONSOR OR FUNDING BODY:</b>  | Zoom Developments   |
| <b>ADDRESS OF MAIN CONTRIBUTOR:</b>  | 8 Ashgrove Workshops, Kilwinning, Ayrshire KA13 6PU   |
| <b>E MAIL:</b>   | contact@rathmell-arch.co.uk   |
| <b>ARCHIVE LOCATION (intended/deposited)</b>                                     | Report to West of Scotland Archaeology Service and archive to National Monuments Record of Scotland.  |

## Contact Details

Rathmell Archaeology can be contacted at its Registered Office or through the web:

**Rathmell Archaeology Ltd**  
Unit 8 Ashgrove Workshops  
Kilwinning  
Ayrshire  
KA13 6PU

[www.rathmell-arch.co.uk](http://www.rathmell-arch.co.uk)

t.: 01294 542848

f.: 01294 542849

e.: [contact@rathmell-arch.co.uk](mailto:contact@rathmell-arch.co.uk)

End of Document