

Devon County Council Historic Environment Record

Civil Parish & District: Winkleigh, Torridge	National Grid Reference SS 6312 0803	Number:
Subject: Removal of timber gates and fence and erection of new dwelling with garage at Linden House, Castle Street, Winkleigh, Devon.		Photo attached? YES
Planning Application no: 1/0692/2012/FUL	Recipient museum: MBND	
OASIS ID: southwes1-138317	Museum Accession no: NDDMS2012.50	
Contractor's reference number/code: WLH12	Dates fieldwork undertaken: 21 st & 25 th of February, 2013	
<p>Description of Works: South West Archaeology Ltd monitored the excavation of topsoil in an area subject to footing and service trenching for a dwelling on land west of Linden House, Castle Street, Winkleigh, Devon (Figures 2, 3.1; Photo 6). The work was carried out according to a written scheme of investigation drawn up in accordance to a brief issued by the Devon County Historic Environment Team (DCHET) (Ann Marie Dick, 28.11.2012). The topsoil was stripped from the area using a 1.60m wide toothless grading bucket and the footing trench was excavated using a 0.60m wide trenching bucket. The topsoil directly overlaid natural in the north-east corner of the site, in which two post-medieval linear features were revealed. The rest of the site was overlaid by a substantial layer of subsoil, obscuring any other features. No more features were revealed in section within the footing trench.</p> <p>Site Stratigraphy: (Figures 3.1, 4.4-4.9; Photos 3, 4, 5) 0.22-0.36m of Topsoil (100). Dark brown-grey, friable clay-silt with occasional small sub-angular stones and charcoal flecks. Finds included 19th-20th century pottery, plastic, CBM. The finds were discarded. 0.14-0.34m of Subsoil (101). Mid grey-brown, friable clay-silt with occasional small angular stones and charcoal flecks. Finds included 18th-19th century pottery and CBM. 0.38-0.40m of 2nd Subsoil (109). Mid grey-brown, friable clay-silt with occasional angular grit. Similar to (101), but more soft. Finds included a single sherd of pottery. Occurring below a depth of c.0.30-1.05m, Natural (102). Mid mottled brown-orange, compact shillet rock bonded with clay.</p> <p>Results: The sections revealed that the natural sloped downwards from north to south, with the trend of the immediate topography; with the relatively level garden area under development having substantial amounts of subsoil in its southern half. This is probably re-deposited from towards Castle Road and adjacent gardens (the garden of Linden house, immediately to the east contains the old village bowling green). A gully and ditch, which seem to go into disuse in the late medieval or early post-medieval period, occurred in the north-east corner of the site (Figures 3.1-3.4 & 4.1-4.4; Photos 1-3). These linear features may have their origins in the medieval period proper. Gully [103], aligned NW-SE, was 0.46m wide. It was cut by and seemed to terminate within Ditch [105]; a steep sided, flat bottomed ditch 0.68m wide, 0.22m deep, aligned NE-SW. Both contained a single fill ((104) and (106) respectively) and produced a relatively large amount (906g from less than 2m's of excavated segments) of post-medieval and late medieval pottery (16th-17th Century). The fill (106) of Ditch [105] was overlain by subsoil (101) and its continuation across the site is only suggested by a stony patch, (108), in the subsoil with residual pottery which seemed to line up with the orientation of the ditch. Ditch [105] is on the same alignment as, although set to the west, of Shute Lane; a medieval roadway providing access to a former strip field system (Devon & Dartmoor HER, MDV62467). This may reflect some continuity of an aspect of the original town layout into the post-medieval period. No other features were identified within the footing trench of the dwelling (Photo 6). Although a copper alloy strap end of possible late 14th century date and some Medieval North Devon wares were found within later contexts. See the full finds concordance below (Figure 1). Evidently the site was undeveloped from 1843 up to the present. The site occupies an area which on the 1843 tithe map (plot 82) is apportioned as a private lawn belonging to a Mary Heal Payne, located behind a house and barn. By 1889, on the first edition OS map, it is associated with the school, most probably the yard or playground (Figure 2). The continuity of the lack of development on the site may be pushed back further by the evidence of the lack of features across most of the site.</p>		
<p>A plan as well as any other relevant drawings must be attached showing the location and extent of site, areas investigated and features exposed.</p>		

Recorder: Joe Bampton, South West Archaeology Ltd	Date sent to HER: 22.05.2013
--	-------------------------------------

Please email completed form to: archaeol@devon.gov.uk or post to County Archaeology Service, Environment Directorate, Matford Lane Offices, County Hall, Topsham Road, Exeter EX2 4QW. Information recorded on this form will be added to the Historic Environment Record, and made available to all researchers. Any plans or photographs embedded within or attached to this form remain the copyright © of the recorder, and must not be reproduced in any publication without the explicit consent of the copyright holder.

Context	Notes	POTTERY			OTHER			DATE
		Sherds	Wgt. (g)	Notes	Frgs.	Wgt. (g)	Notes	
(100)		14	79	×11 WRE (×4 with blue transfer print; ×2 rims; ×1 each for brown, lilac & green transfer print); ×1 English porcelain/bone china; ×2 post-medieval North Devon gravel-free ware	1	4	Brick	C19-C20
(101)		6	69	×4 post-medieval North Devon gravel-free ware; ×1 post-medieval North Devon gravel-tempered ware; ×1 Jackfield ware	1	5	Stem frag.	Late C18-C19
(104)		5	344	Post-medieval North Devon gravel-tempered ware (rim type 3 bowl)	1	28	Fired clay frag.	
(106)		19	192	×1 Bristol/Staffordshire yellow slip ware, closed form; ×10 post-medieval North Devon gravel-tempered ware (1 rim); ×1 post-medieval North Devon gravel-free ware; ×7 North Devon medieval coarse ware	1	24	Animal bone (tooth)	C16-C17
(108)		17	146	×3 post-medieval North Devon gravel-free ware; ×1 c.1660-1700 North Devon scraffito from possible jug or chamber pot with leaf & complex floral pattern; ×13 North Devon medieval coarse wares, late medieval in local jug form	3	14	Stem frags.	
(109)		1	76	North Devon gravel-free jug, late medieval	1	32	Fe frag.	C17 or earlier
					1	2	Clinker	
		62	906		1	9	Cu alloy object, possible C14-C15 strap end	C16
		62	906		10	118		

Figure 1: Complete finds concordance.

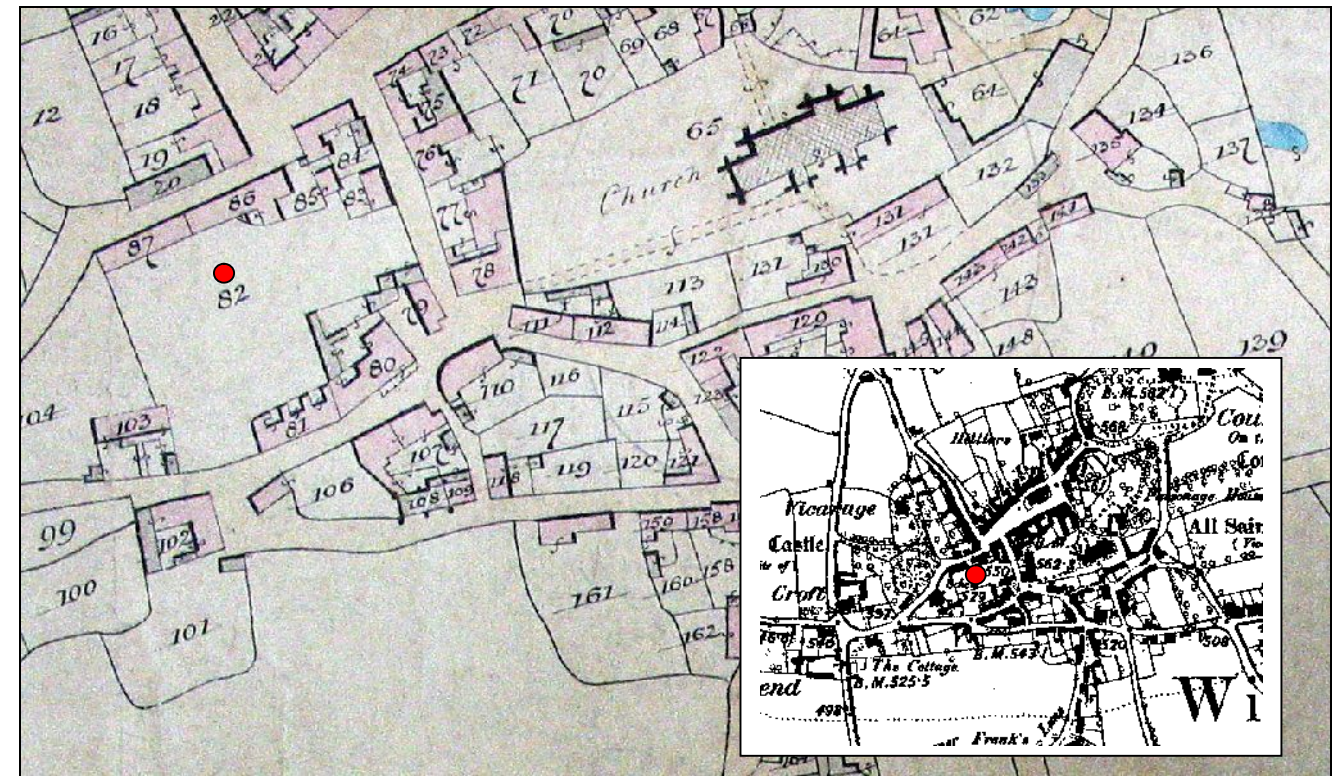
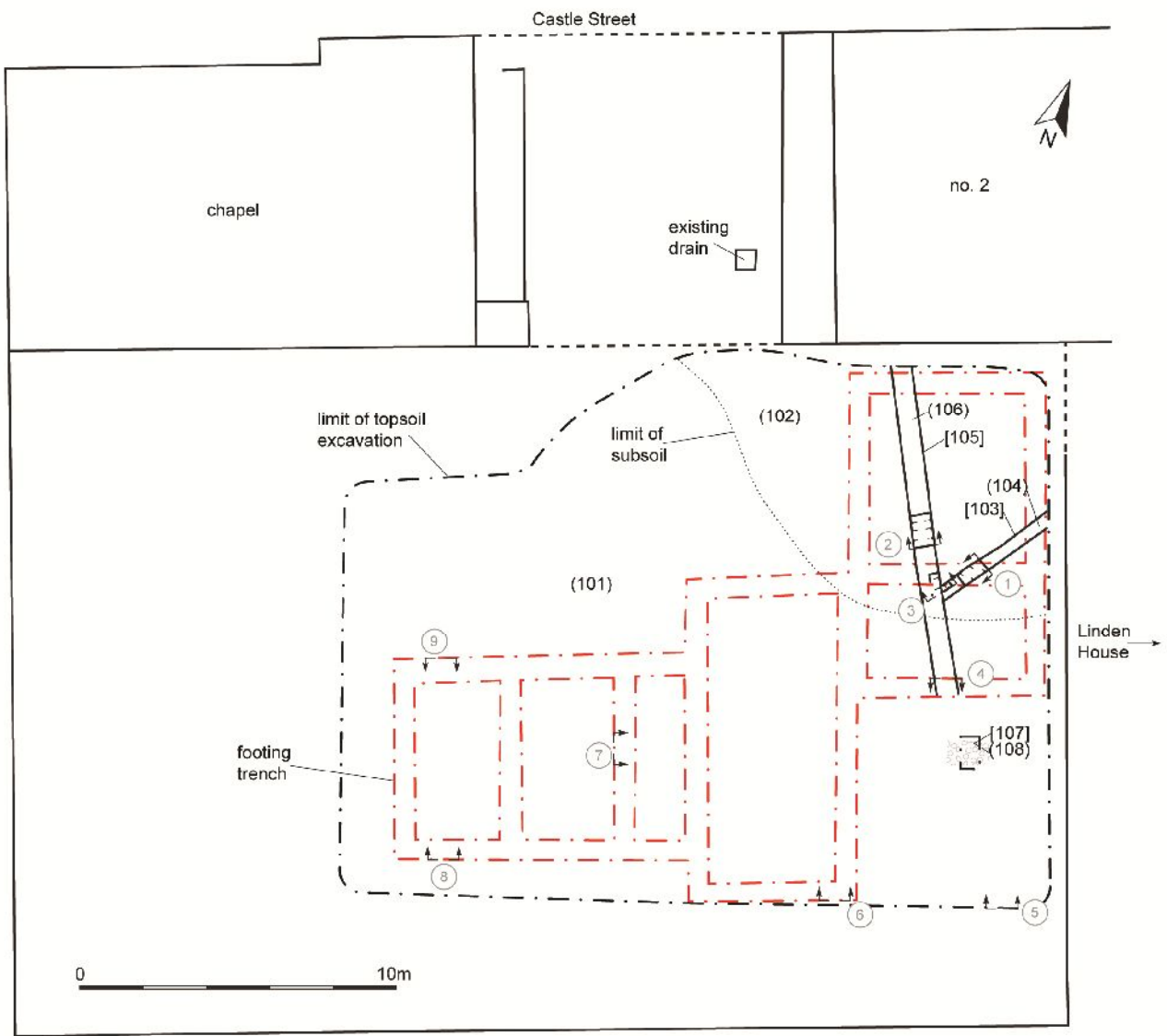
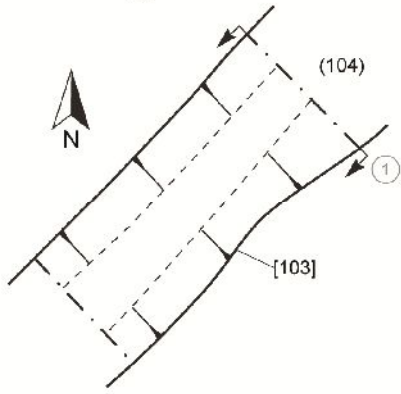

Figure 2: Extract from the 1843 Winkleigh tithe map. The development area is indicated with a red dot (Courtesy Devon record Office.) (Insert: from the Ordnance Survey First Edition map at six inches to the mile published 1889 (Courtesy of North Devon Record Office)).

① Site plan showing area excavated of topsoil, footing trench and sections



② Gully [103], plan



③ Ditch [105], plan

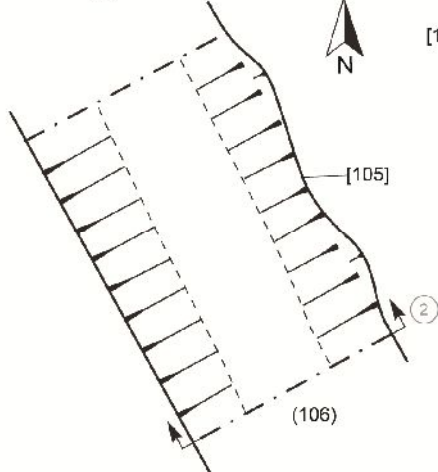

④ Gully [103] & Ditch [105], plan

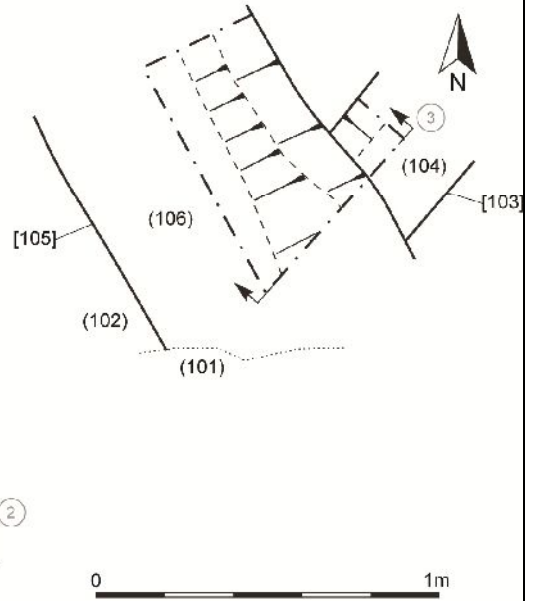
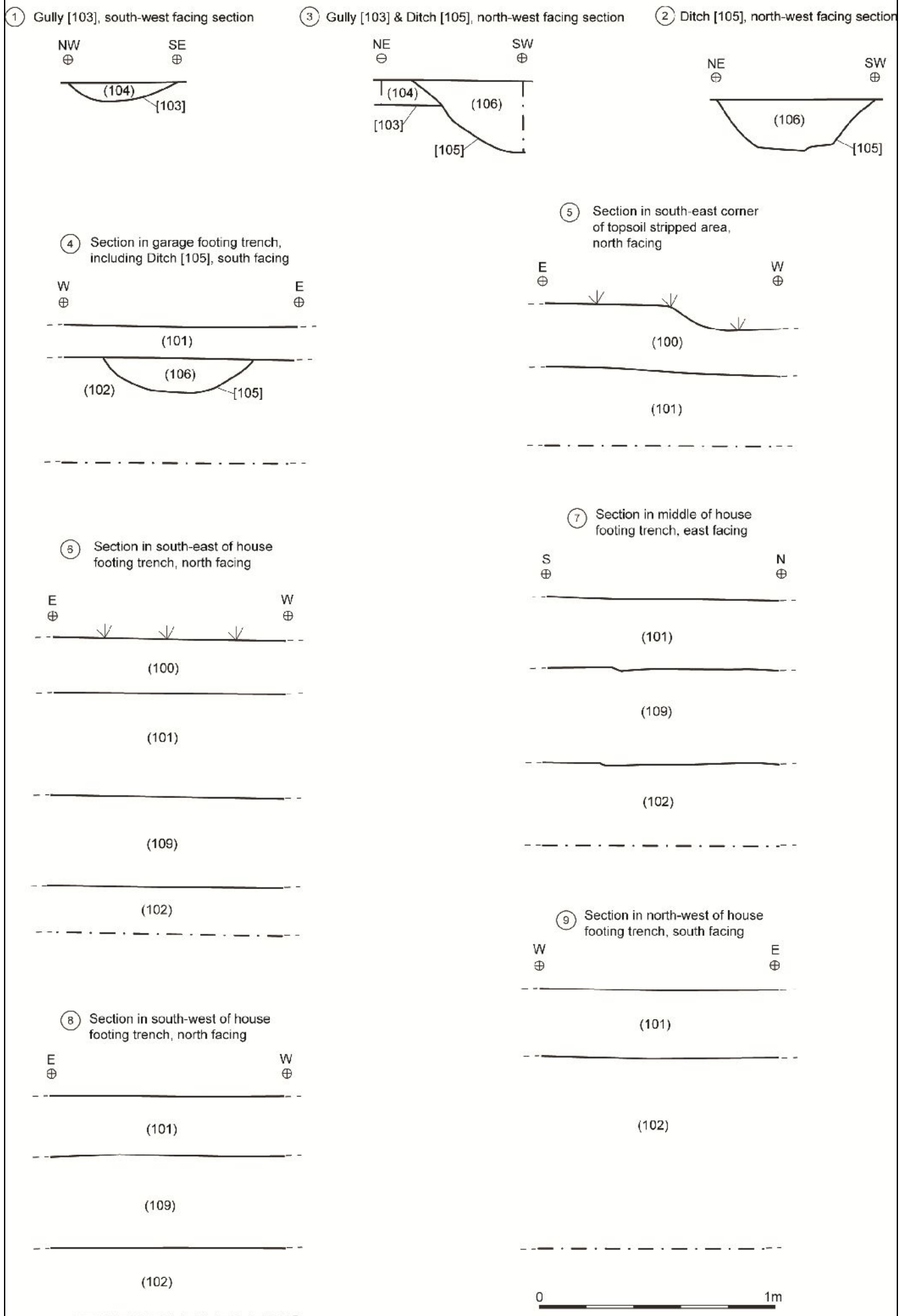

Figure 3: Plans: Site plan & plans of excavated segments.



Figures 4: Section drawings.



Photo1: Gully [103], looking South-West (scale 1m).



Photo 2: Gully [103] & Ditch [105], looking South-East (scale 1m).



Photo 3: Ditch [105], looking South-East (scale 1m).



Photo 4: Sample section in South-East corner of house footings, looking South (scale 1m).



Photo 5: Sample section in middle of house footings, looking West (scale 1m).



Photo 6: Footings across site post-excitation, looking East (scales -).