



# Cornwall & Scilly Historic Environment Record

## Historic Environment Record, Historic Environment Service, Environment & Heritage, Cornwall Council

Fal Building, County Hall, Treyew Road, Truro, Cornwall, TR1 3AY,  
Tel: 01872 323 603; Email: [hes@cornwall.gov.uk](mailto:hes@cornwall.gov.uk)

Site Name: Roscarrack House, Bickland Water Road, Falmouth, Cornwall	
Grid ref (10-fig): SW 78991 31682	OS Map No:
Parish: Falmouth	
Site Type: Construction of residential development; 11 plots with access and parking	
Period: Bronze Age, post-medieval, modern	Form: Archaeological Monitoring and Recording
<p><b>Description:</b></p> <p>An archaeological monitoring and recording was undertaken by South West Archaeology Ltd. (SWARCH) at the request of Louise Parkinson of Chichester Homes Ltd. (the Client) of the proposed construction of 11 dwellings with access and parking on land at Roscarrack House, Bickland Water Road, Falmouth, Cornwall, TR11 4SB (Figures 5). This work was undertaken by Dr S. Walls, L. Radcliffe and J. Bampton between 26/08/13 and 06/09/13 in accordance with a WSI drawn up in consultation with Cornwall Council Historic Environment Planning Advice Officer, Phil Markham.</p> <p>The site occupies the eastern garden of Roscarrack House, a Grade II listed building on the western outskirts of Falmouth. It is on land recorded by the Cornwall and Scilly Historic Environment Record (HER) as being “Anciently Enclosed Land” and therefore held high potential for surviving archaeological deposits. The HER also records a potential Iron Age/Romano-British ‘round’ (HER No.18571) east of the site and Roscarrack itself as the site of a Medieval settlement first recorded in 1286 (HER No.18627).</p> <p>The turf was stripped from the areas of the site subject to groundworks (c.0.20m in depth). The ground across the access track was reduced by 0.30m and then made up at its south end; subsoil was revealed at its north end. 0.6-1.2m wide footing trenches were then excavated for the 11 units to a depth of between 0.55m and 1m (Figures 1, 2, 6). A large number of modern tree-throws were encountered across the site, most of which were extant plants prior to groundworks commencing. No significant archaeological features or deposits were recovered.</p> <p><b>Site Stratigraphy (Figures 4, 7):</b></p> <p>Topsoil (100), c.0.50m thick, a mid orange-brown, friable sandy-silt with occasional small sub-angular stones and shillet fragments and major recent bioturbation (root damage). It produced 3 sherds (220g) of 18<sup>th</sup> Century Cornish coarseware; 4 sherds (39g) of one piece of abraded Bronze Age (Trevsker?) pottery; and a moderate amount of 19<sup>th</sup> and 20<sup>th</sup> Century pottery, CBM and glass. The Bronze Age pottery was recovered from the base of a tree-throw created during the removal of vegetation prior to groundworks, which was cut by the north footing trench for plot 3.</p> <p>Subsoil (101), 0.08-0.20m+ thick, a light yellow-orange and orange-yellow, soft clayey-silt, with very occasional small sub-angular stones. Where it was shallow it was intermittent and/or graded to weathered natural. A sondage at the south-east end of the site indicated a thickness of above 0.30m.</p> <p>Natural, occurred below a depth of 0.50-0.70m+, a mid-dark blue-grey, compact clay and shillet.</p> <p><b>Results:</b></p> <p>The sherd of Bronze Age pottery indicates activity in the area in the bronze Age, but no features or deposits were encountered in the footing trenches. The access track was not excavated in most places to a significant enough depth to reveal archaeological deposits. Therefore, if any archaeological remains or features exist on site they are most likely preserved <i>in-situ</i> beneath the development and do not include any substantial linear features running across the site. A fuel pipe of the Government Pipelines and Storage System (GPSS), modified during the 2<sup>nd</sup> World War, which ran from Falmouth to St Mawgan on the north coast of Cornwall was revealed along the length of the access track (Figure 3); and a modern water service pipe, aligned north-east by south-west was revealed at the north end of the site. However, no significant archaeological features or deposits were encountered.</p>	
Land Use (Area): Residential and farming	Land Use (Site): Private garden
Date of Site Visit: 26/08/13 - 06/09/13	
Recorder's name, address and phone number: Joe Bampton, The Old Dairy, Hacche Lane Business Park, Pathfields Business Park, South Molton, Devon, EX36 3LH (01769 573555)	



Figure 1: Post-ex footings trench for plots 1 and 2, viewed from the south (2m scale).



Figure 2: Post-ex footings trench for plot 4, viewed from the south-west (no scale).



Figure 3: Excavation of access road showing cut of fuel pipe, viewed from the north-west, (no scale).



Figure 4: Sample section 4; plot 5, viewed from the north-west (1m scale).

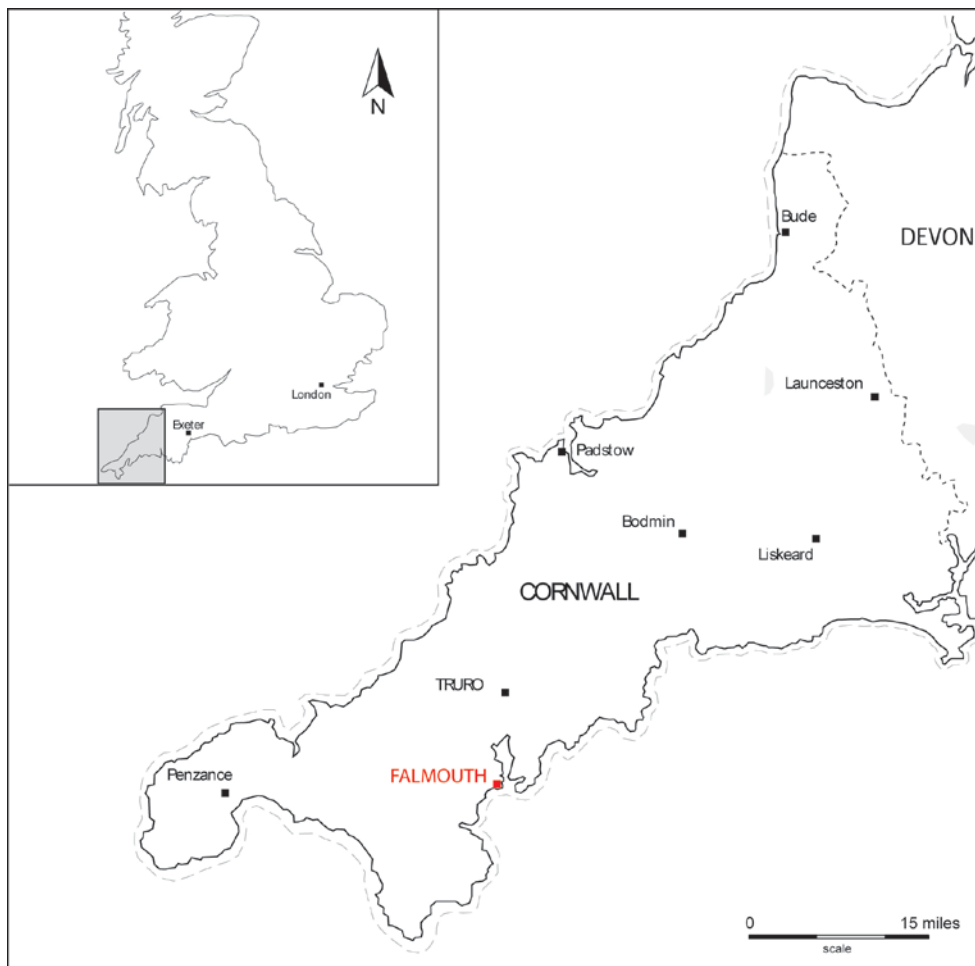

Figure 5: Location map.

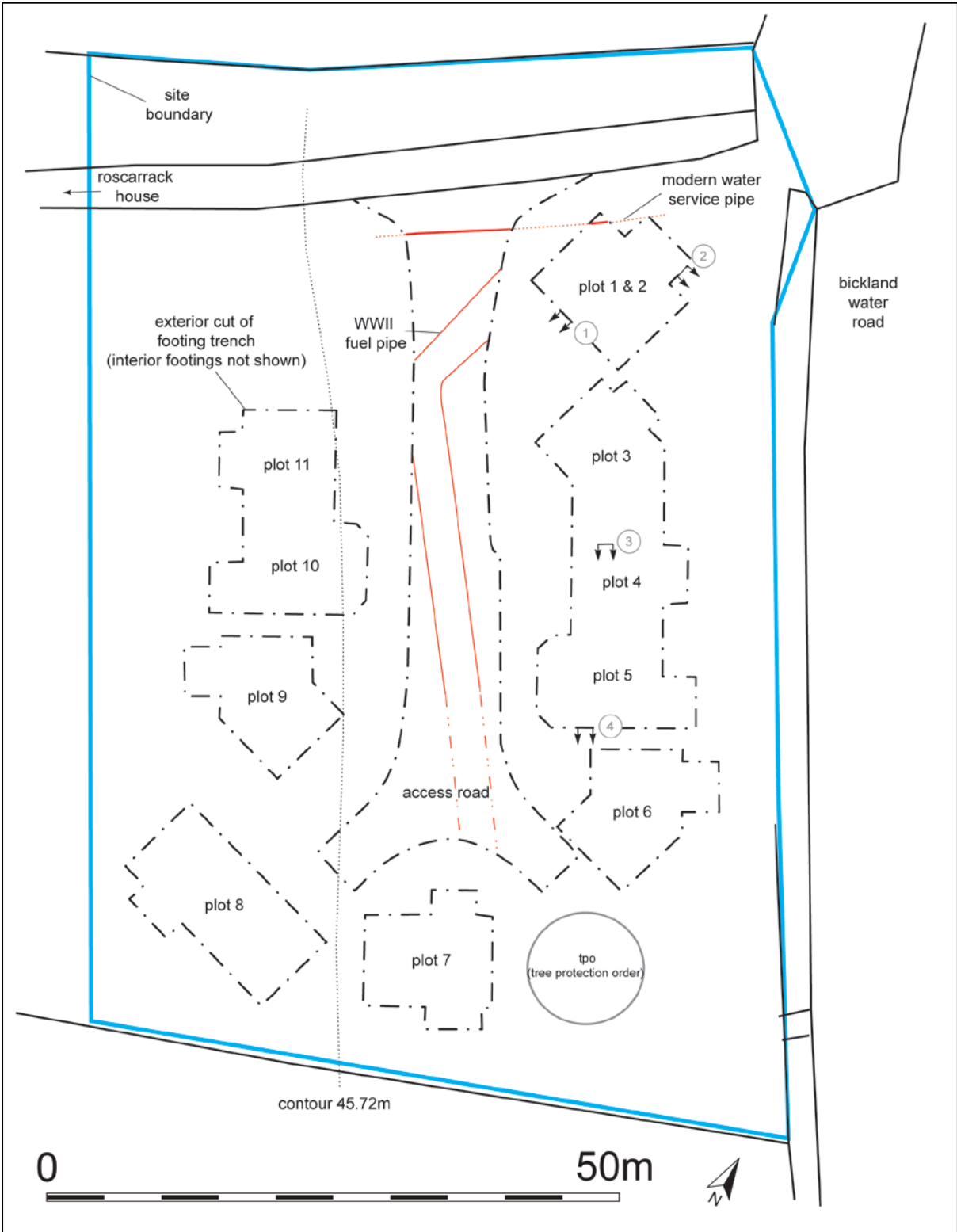

Figure 6: Site plan; grey-scale section numbers correspond to section numbers in Figure 7.

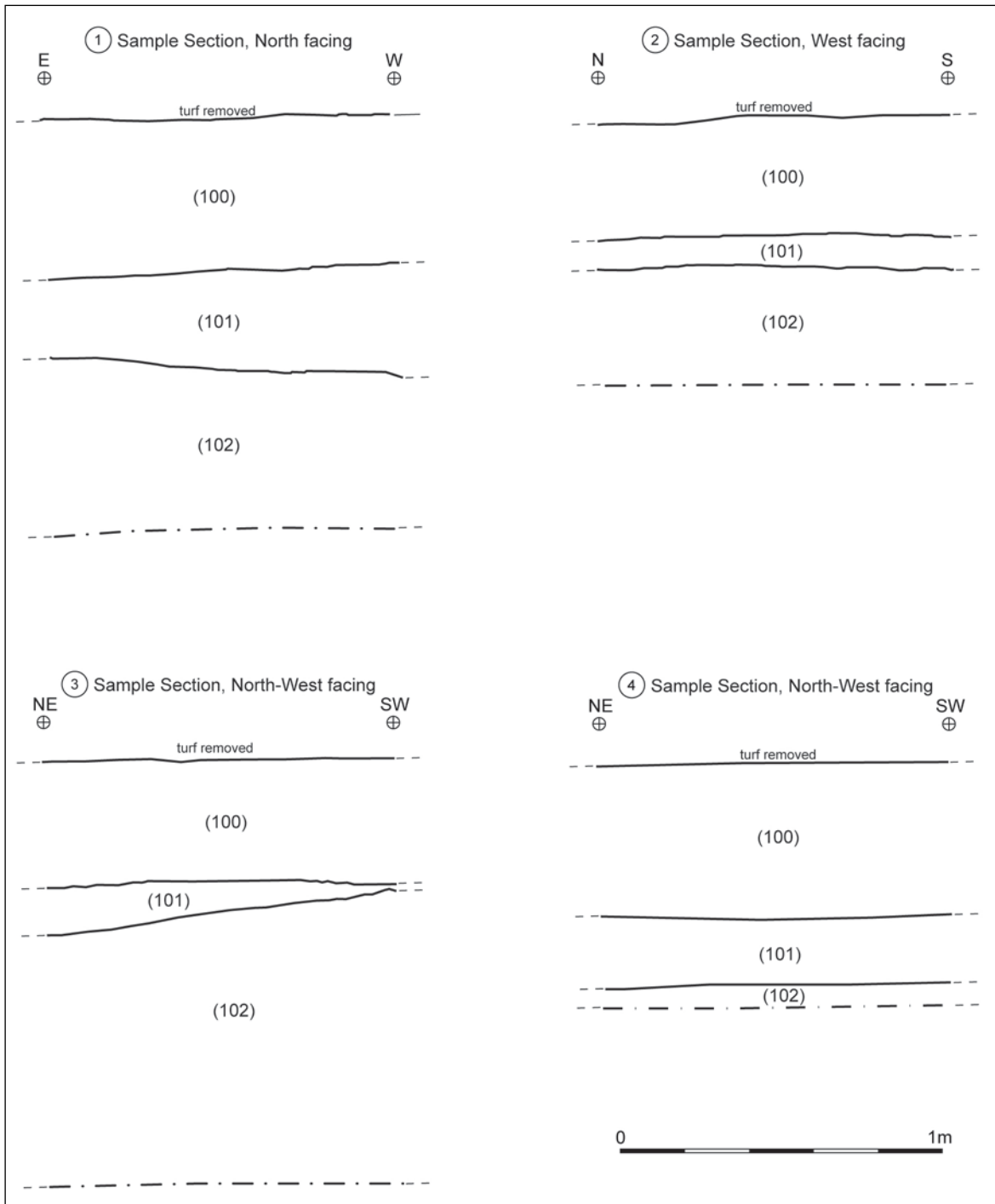

Figure 7: Section drawings; site sample sections from within footing trenches.