

Reproduced from Ordnance Survey's 1:25 000 map of 1998 with the permission of the controller of Her Majesty's Stationery Office. Crown Copyright reserved. Licence No: AL 50125A
Licencee:
Stratascan Ltd.
Vineyard House
Upper Hook Road
Upton Upon Severn
WR8 0SA

OS 100km square = SW



50

49

48

47

46

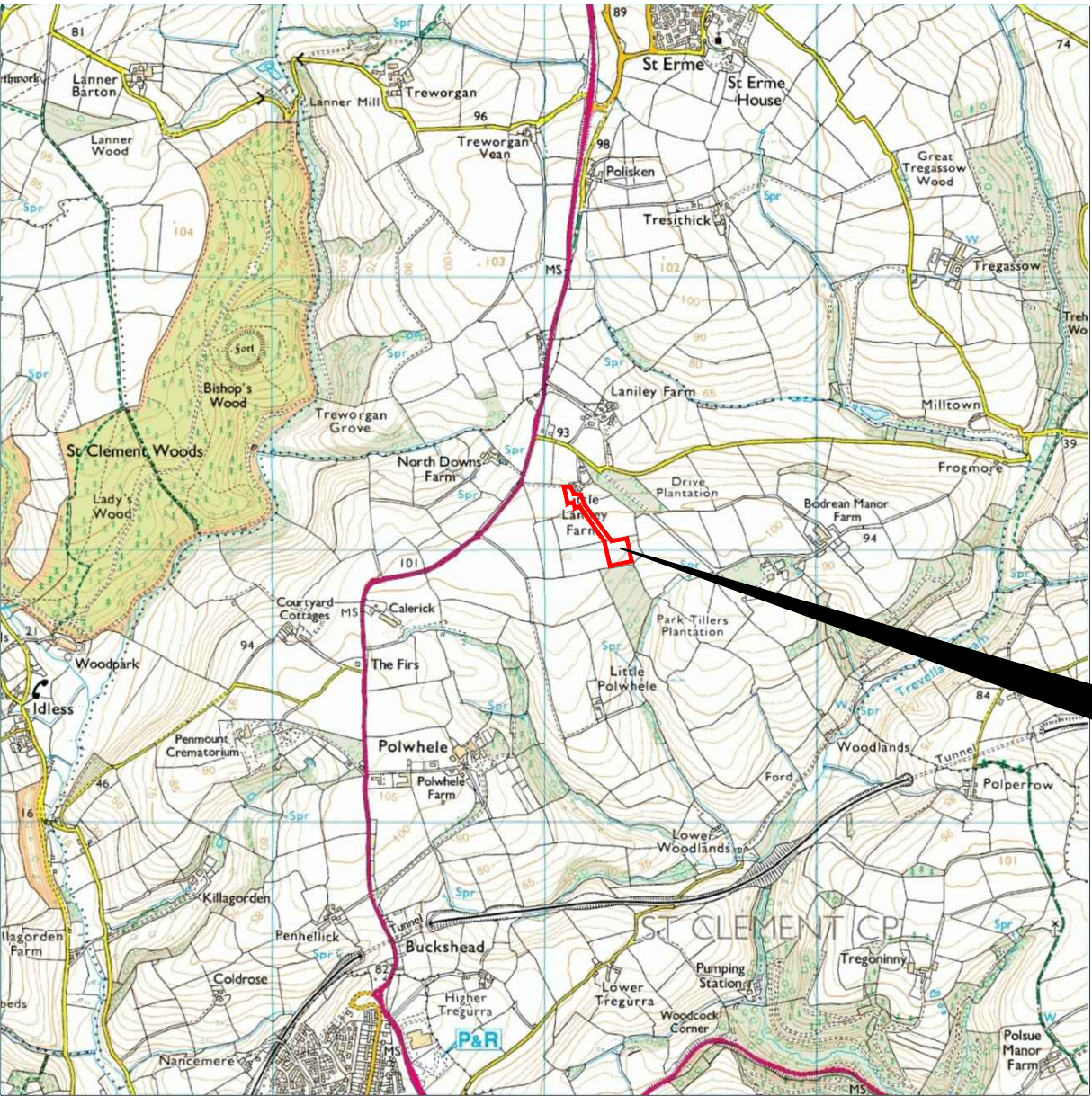

82

83

84

85

86

Amendments

Issue No.	Date	Description
-	-	-
-	-	-

© Stratascan Ltd - 2014



Site centred on NGR SW 842 479

Client
SOUTH WEST ARCHAEOLOGY LTD

Project Title Job No. J7321
LITTLE LANLEY FARM, ST.ERME,
CORNWALL

Subject
LOCATION PLAN OF SURVEY AREA

STRATASCAN™

GEOPHYSICS FOR ARCHAEOLOGY
AND ENGINEERING

VINEYARD HOUSE T: 01684 592266
UPTON UPON SEVERN E: info@stratascan.co.uk
WR8 0SA www.stratascan.co.uk

EUROPEAN
GPR
ASSOCIATION

SUMO
Survey Services

SUMO
GROUP
MEMBER



UKAS
ISO 9001
certified

UKAS
ISO 14001
certified

Scale 1:25000 0m 500 1000m

Plot A3	Checked by DGE	Issue No. 01
Survey date AUG 14	Drawn by TR	Figure No. 01

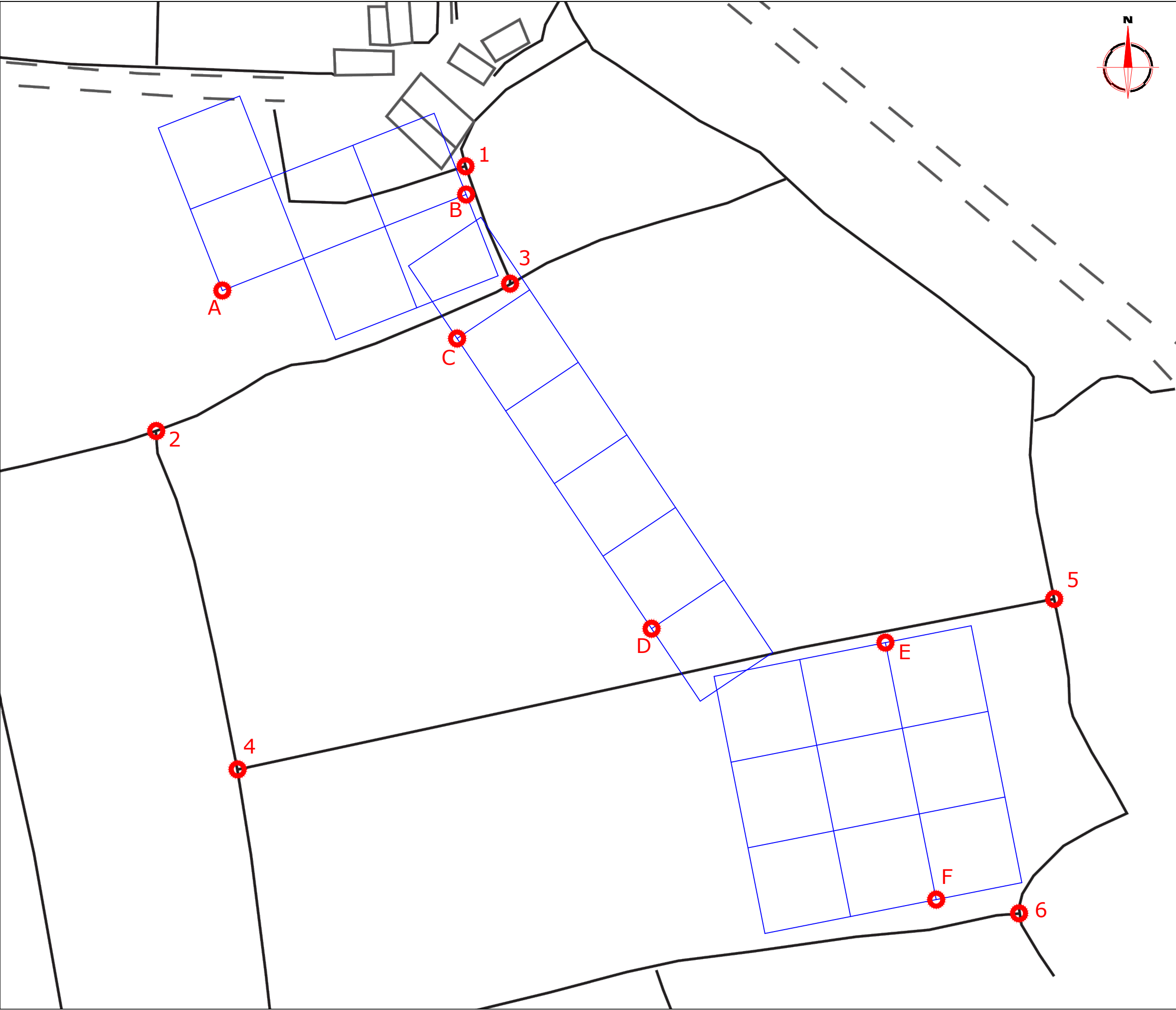

Amendments

Issue No.	Date	Description
-	-	-
-	-	-

© Stratascan Ltd - 2014

REFERENCING INFORMATION

A-B	90m	A-1	93.82m	A-2	53.34m
A-3	98.88m	B-1	9.71m	B-2	133.90m
B-3	34.14m	C-D	120m	C-2	108.12m
C-3	26.20m	C-4	166.12m	D-2	183.20m
D-3	128.10m	D-4	150.18m	E-F	90m
E-4	226.74m	E-5	59.88m	E-6	103.71m
F-4	244.10m	F-5	110.96m	F-6	28.83m

A-B

Base line

1,2,3

Referencing points

Client

SOUTH WEST ARCHAEOLOGY LTD

Project Title

Job No.

LITTLE LANILEY FARM, ST.ERME, CORNWALL

J7321

Subject

LOCATION OF SURVEY GRIDS AND REFERENCING

STRATASCAN™

GEOPHYSICS FOR ARCHAEOLOGY AND ENGINEERING

VINEYARD HOUSE
UPTON UPON SEVERN
WR8 0SA

T: 01684 592266
E: info@stratascan.co.uk
www.stratascan.co.uk

EUROPEAN GPR ASSOCIATION

SURVEY SERVICES

REGISTERED ORGANISATION

ISO 9001 certified

UKAS MANAGEMENT SYSTEMS

ISO 14001 certified

UKAS ENVIRONMENTAL MANAGEMENT

SUMO GROUP MEMBER

Scale

1:1250

0m

10

20

30

40

50m

Plot

A3

Checked by

DGE

Issue No.

01

Survey date

AUG 14

Drawn by

TR

Figure No.

02



Amendments

Issue No.	Date	Description
-	-	-
-	-	-

© Stratascan Ltd - 2014

Data collected by
South West Archaeology
Interpretation and reporting by
Stratascan

Plotting parameters
Maximum +100nT (red)
Minimum -100nT (blue)

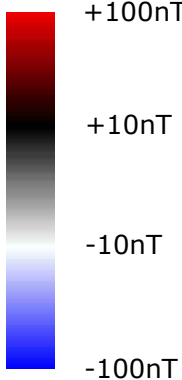

Client
SOUTH WEST ARCHAEOLOGY LTD

Project Title
LITTLE LANILEY FARM, ST.ERME, CORNWALL

Job No. J7321

Subject
COLOUR PLOT OF GRADIOMETER DATA SHOWING EXTREME VALUES

STRATASCAN™
GEOPHYSICS FOR ARCHAEOLOGY AND ENGINEERING
VINEYARD HOUSE T: 01684 592266
UPTON UPON SEVERN E: info@stratascan.co.uk
WR8 0SA www.stratascan.co.uk



SUMO GROUP MEMBER



Scale 1:1250 0m 10 20 30 40 50m

Plot A3	Checked by DGE	Issue No. 01
Survey date AUG 14	Drawn by TR	Figure No. 03



Amendments

Issue No.	Date	Description
-	-	-
-	-	-

© Stratascan Ltd - 2014

Data collected by
South West Archaeology
Interpretation and reporting by
Stratascan

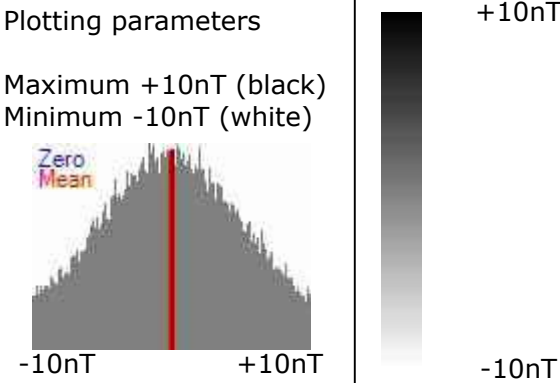

Client
SOUTH WEST ARCHAEOLOGY LTD

Project Title Job No. J7321
**LITTLE LANILEY FARM, ST.ERME,
CORNWALL**

Subject
**PLOT OF MINIMALLY PROCESSED
GRADIOMETER DATA**

STRATASCAN™
**GEOPHYSICS FOR ARCHAEOLOGY
AND ENGINEERING**
VINEYARD HOUSE T: 01684 592266
UPTON UPON SEVERN E: info@stratascan.co.uk
WR8 0SA www.stratascan.co.uk



SUMO
GROUP
MEMBER



Scale 0m 10 20 30 40 50m
1:1250

Plot A3	Checked by DGE	Issue No. 01
Survey date AUG 14	Drawn by TR	Figure No. 04



Amendments

Issue No.	Date	Description
-	-	-
-	-	-

© Stratascan Ltd - 2014

KEY

PROBABLE ARCHAEOLOGY

	Positive anomaly / weak positive anomaly - probable cut feature of archaeological origin
	Negative anomaly / weak negative anomaly - probable bank or earthwork of archaeological origin
	Moderate strength discrete anomaly - probable thermoremanent feature
	Widely spaced curving parallel linear anomalies - probably related to ridge-and-furrow

POSSIBLE ARCHAEOLOGY

	Positive anomaly / weak positive anomaly - possible cut feature of archaeological origin
	Negative anomaly / weak negative anomaly - possible bank or earthwork of archaeological origin
	Moderate strength discrete anomaly - possible thermoremanent feature

OTHER ANOMALIES

	Closely spaced parallel linear anomalies - probably related to agricultural activity such as ploughing
	Linear anomaly - probably related to a modern service trench
	Linear anomaly - possibly related to land drain
	Magnetic disturbance associated with nearby metal object such as service or field boundary
	Strong magnetic debris - possible disturbed or made ground
	Scattered magnetic debris
	Area of amorphous magnetic variation - probable natural (e.g. geological or pedological) origin
	Magnetic spike - probable ferrous object

Client

SOUTH WEST ARCHAEOLOGY LTD

Project Title

Job No.

J7321

LITTLE LANILEY FARM, ST.ERME, CORNWALL

Subject

ABSTRACTION AND INTERPRETATION OF GRADIOMETER ANOMALIES

STRATASCAN™

GEOPHYSICS FOR ARCHAEOLOGY AND ENGINEERING

VINEYARD HOUSE UPTON UPON SEVERN WR8 0SA

T: 01684 592266 E: info@stratascan.co.uk www.stratascan.co.uk

Scale

1:1250

0m 10 20 30 40 50m

Plot

A3

Checked by

DGE

Issue No.

01

Survey date

AUG 14

Drawn by

TR

Figure No.

05