



<b>Site Name:</b> Land South of Bosnoweth, Clodgey Lane, Helston, Cornwall	
<b>Grid ref (10-fig):</b> SW 66792 27202	<b>OS Map No:</b> OSGB36
<b>Parish:</b> Helston	<b>OASIS No:</b> southwes1-313009
<b>Site Type:</b> Industrial commercial development	<b>Date of Site Visits:</b> 11/05/18 – 18/05/18
<b>Period:</b> Post-Medieval	<b>Form:</b> Monitoring and Recording event
<p><b>Description:</b> Archaeological monitoring was undertaken by South West Archaeology Ltd. (SWARCH) at the request of Hollie Nicholls of Laurence Associates (the Agent) on behalf of Matt Lugg of MJL Group Ltd (the Client) during groundworks associated with the proposed construction of industrial; commercial units on land south of Bosnoweth, Clodgey Lane, Helston, Cornwall. The work was carried out by J. Bampton between the 11<sup>th</sup> and 18<sup>th</sup> of May 2018 in accordance with a WSI (Balmond 2018) drawn up in consultation with Sean Taylor, Senior Development Officer, Historic Environment, Cornwall Council (SDOHE).</p> <p>The site is located across a field off Clodgey Lane, immediately south of the A394, opposite a residential estate on the south-east edge of Helston. The soils of this area are the well drained fine loamy soils of the Denbigh 2 Association (SSEW 1983), overlying the slate and siltstone of the Mylor Slate Formation (BGS 2016). The site was at a height of between 60m and 65m AOD. The Cornwall Historic Landscape Characterisation characterises the site as post-medieval enclosed land, likely to have formerly been upland rough ground, surrounded by Medieval farmland.</p> <p>The Cornwall and Scilly HER does not record any archaeological features on the site itself however it is located near the medieval settlement of Tresprison, which was first documented in 1304 (HER No.30243). There is speculative evidence from cropmarks for prehistoric activity in the area of the site with a number of prehistoric pits, field boundary and possible rounds located immediately east of the site (HER Nos.51936, 51937, 51938). An archaeological assessment of the site was carried out by CAU in 2001 that identified a high potential for prehistoric activity. Evaluation trenching encountered one fragment of later medieval pottery and a ditch feature within the area of the proposed development, approximately 1m wide. The eastern part of the proposed site was recorded as heavily disturbed by machinery and no finds were encountered in this area.</p> <p>The site sloped into a slight valley across the survey area orientated approximately ESE-WNW. Striations in the Natural, (1002) could be seen on the same orientation; as was a transition in the Natural between a rocky shillet on the upper slopes and a clayey deposit within the trough of the slight valley, both of which contained occasional-moderate large angular stones. The natural was overlain across the site by a Subsoil (1001); a mid orange-brown, friable sandy silt with moderate angular stones, &lt;0.27m thick. The subsoil was then overlain by Topsoil (1000); a mid grey-brown, friable clay-silt, &lt;0.24m thick. Bioturbation and modern disturbance from groundworks and heavy plant were intermittently evident across the site. Topsoil (1000) and Subsoil (1001) contained 19-20<sup>th</sup> century finds. A single struck flint, a re-touched flake blade (11g), was recovered from Subsoil (1001).</p> <p>The monitoring took place during- and subsequent to the removal of spoil heaps that covered the site from groundworks associated with works on the A394 in the 2000's. These earlier works resulted in the truncation of some parts of the wider development area and deposition of large spoil heaps. An area approximately 100m×55m was excavated to the depth of <i>in-situ</i> weathered natural. Five linear features associated with historic boundaries and modern drainage were identified and excavated. Bank material (1006), a mid brown-orange, friable clay-silt with moderate-frequent angular stones (including the southern face of a stone lined bank was 0.19m thick and overlain by bank demolition spread (1007), which was overlain by topsoil. Ephemeral spread of probable remnant ditch material (1012) was parallel to Layer (1006) and together probably equated to a boundary that was present on the 1843 Wendron tithe map and that was partially extant on the site during the survey. Drain [1003] was parallel to Layer (1006), overlain by (1007) and contained 20<sup>th</sup> century finds. Drain [1010] contained 19<sup>th</sup>-20<sup>th</sup> century finds, was comparable to Drain [1003] and equated to a drain cut beside a boundary that was removed between the surveying of the 1880 1<sup>st</sup> edition Ordnance Survey (OS) map and the 1907 2<sup>nd</sup> edition OS map. Ditch [1008] was undated, however, it was perpendicular to the post-medieval/historic boundaries and had similar sediments to both layers (1006) and (1012) alluding to it being contemporary with the sites post-medieval field system. Two evaluation trenches from 2001 were also present. A feature in one of these trenches ostensibly equated to Deposits (1006) and (1007) or Drain [1003].</p> <p>No significant archaeological features were identified on the site, the only remains relating to 21<sup>st</sup> century groundworks or post-medieval to modern field boundaries. A single prehistoric flint tool was recovered from the subsoil.</p> <p><b>Bibliography</b>  <b>Balmond, F.</b> 2018: <i>Land South of Bosnoweth, Clodgey Lane, Helston, Cornwall: Written Scheme of Investigation</i>. SWARCH Report No. HLC18WSlv1  <b>British Geological Survey</b> 2017: <i>Geology of Britain Viewer</i>. <a href="http://maps.bgs.ac.uk/geologyviewer_google/googleviewer.html">http://maps.bgs.ac.uk/geologyviewer_google/googleviewer.html</a> [accessed 21.05.2017].  <b>Soil Survey of England and Wales</b> 1983: <i>Legend for the 1:250,000 Soil Map of England and Wales</i>  <b>Tapper, B.P.</b> 2001: <i>Clodgey Lane, Helston, Cornwall: Archaeological Assessment</i>. CAU Report No. 2001R004</p>	
<b>Land Use (Area):</b> Agricultural/Suburban fringe	<b>Land Use (Site):</b> Agricultural
<p><b>Recorder's name, address and phone number:</b> J. Bampton, South West Archaeology Ltd., The Old Dairy, Hacche Lane Business Park, Pathfields Business Park, South Molton, Devon, EX36 3LH</p>	
<p>01769 573555 <a href="mailto:mail@swarch.net">mail@swarch.net</a></p>	

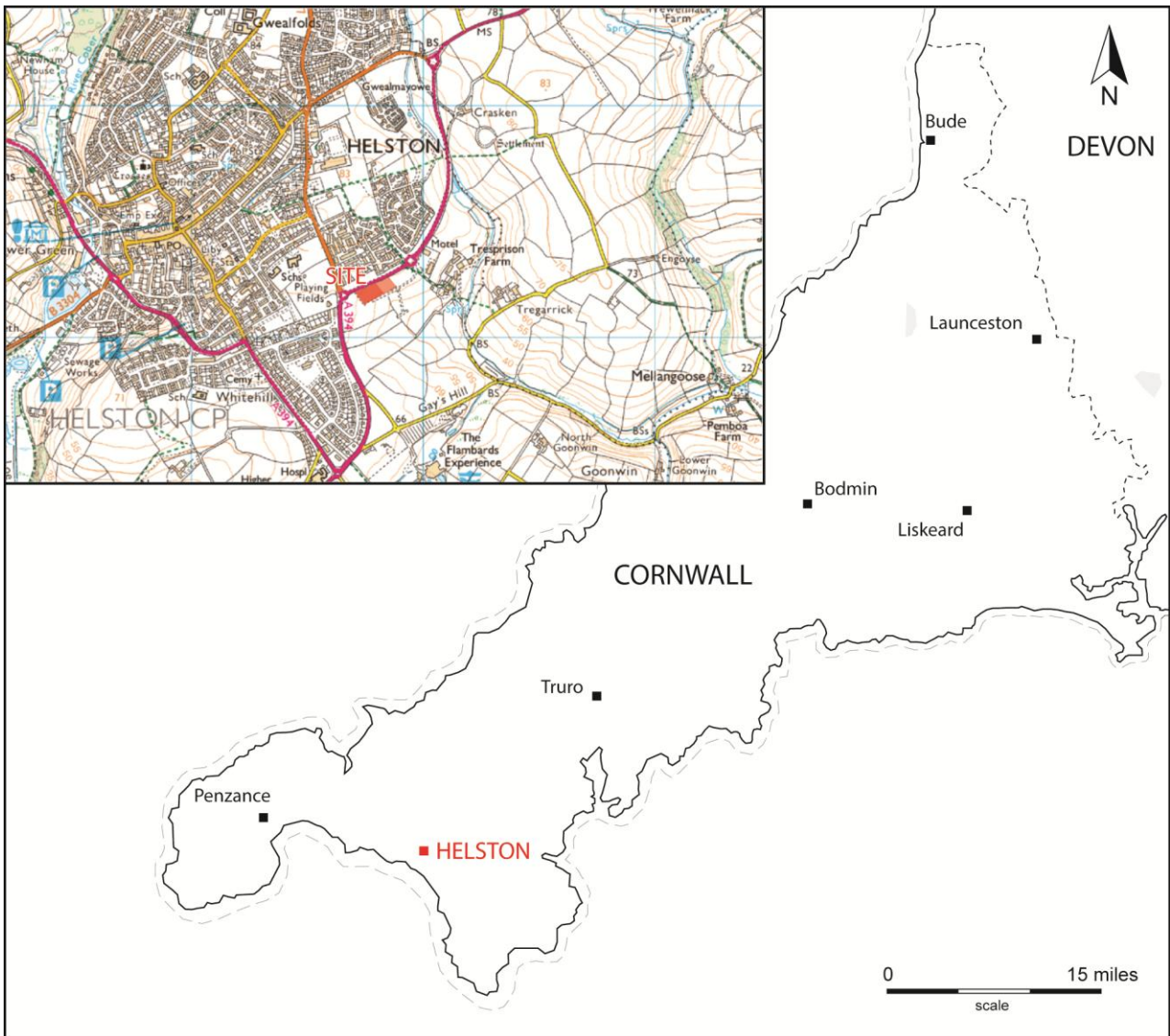

FIGURE 1: SITE LOCATION.

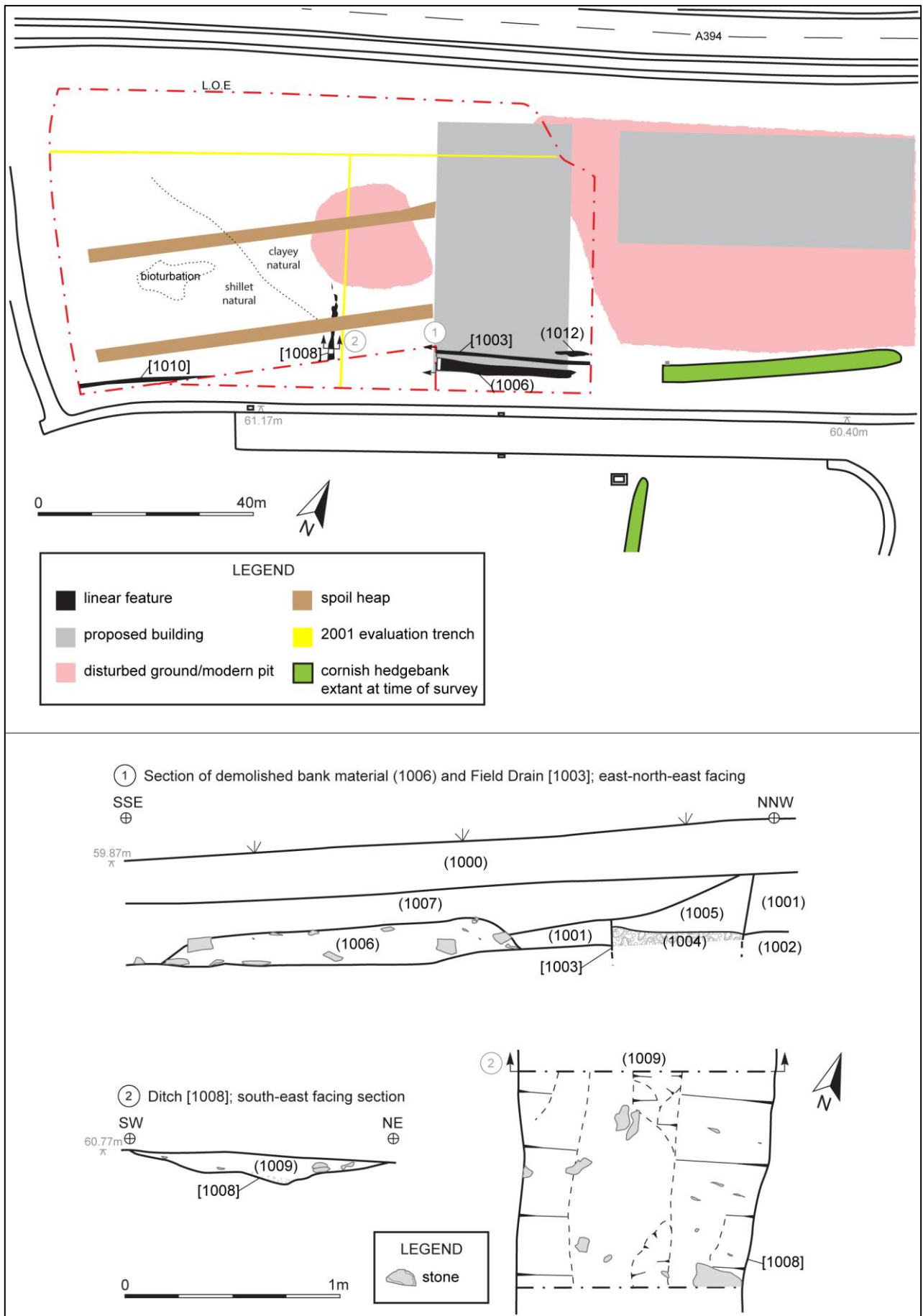

FIGURE 2: SITE PLAN AND FEATURE SECTION DRAWINGS AND PLAN.



FIGURE 3: BANK MATERIAL (1006) AND STONY DRAIN [1003]; VIEWED FROM THE NORTH-EAST (2M SCALE).



FIGURE 4: DITCH [1008] AND EVALUATION TRENCH; VIEWED FROM THE SOUTH-EAST (2M SCALE).



FIGURE 5: SITE SHOT, POST-EXCAVATION; VIEWED FROM THE NORTH-EAST (NO SCALE).