

Site Name: Land at Barn Park, Bodmin, Cornwall	Planning Ref: PA16/00610
Grid ref (10-fig): SW 08343 66880	OS Map No: OSGB36
Parish: Bodmin	OASIS Ref: southwes1-334627
Site Type: Residential Development	
Period: Modern	Form: Archaeological monitoring and recording event
<p>Description: Archaeological monitoring was undertaken by South West Archaeology Ltd. (SWARCH) at the request of Pearce Fine Homes as part of ground works associated with a residential development at Land at Barn Park, Bodmin, Cornwall. The work was carried out by S. Stevens on the 16th of January 2023 in accordance with the Written Scheme of Investigation (WSI; Balmond 2018) drawn up in consultation with Cornwall Council.</p> <p>The site is located on a south-east facing slope at c.165-150m AOD. The site on the eastern edge of Bodmin within an area categorised as post-medieval enclosed land by the Cornwall and Scilly Historic Landscape Characterisation. There are no designated heritage assets in the immediate vicinity of the sites and there are very few records for this area on the Cornwall and Scilly HER. A relict field boundary to the west (HER: MCO41432), a post-medieval quarry to the north (HER: MCO41434), and the site of a lost (now destroyed) medieval chapel (HER: MCO10084) to the east. Wessex Archaeology has investigated a large (c.36ha) area to the south of the site; however, geophysical survey and evaluation trenching failed to identify any significant archaeological remains on this site (WA 2012). The soils here are the well-drained fine loamy soils over slate or slate rubble of the Denbigh 2 Association (SSEW 1983); these overlie the slates and siltstones of the Saltash Formation (BGS 2018).</p> <p>An 'L' shaped area measuring c.100m long east-west and turning to the south-west for a further c.75m and approximately 7m wide throughout, marking out road access throughout the south field, was excavated by machine with a toothless grading bucket, to natural level (Figure 1). It was excavated to a maximum depth of c.0.45m.</p> <p>The observed stratigraphy of the site comprised the topsoil (100) a mid red-brown soft-friable silt clay c.0.45m thick, overlying natural (101), a mid red-grey shillet.</p> <p>No archaeological features were observed and no finds were recovered.</p> <p>Conclusion: Given that no archaeological features or deposits were seen in these initial monitored excavations it was considered unlikely that any further archaeology will be present on this Site and so no further monitoring was deemed appropriate and this was agreed with Cornwall Council.</p> <p>Bibliography: Balmond ,F. 2018: <i>Land at Barn Park, Bodmin, Cornwall: Written Scheme of Investigation</i>. SWARCH Report No. BLB18WSIv1 British Geological Survey 2020: <i>Geology of Britain Viewer</i>. http://maps.bgs.ac.uk/geologyviewer_google/googleviewer.html Soil Survey of England and Wales 1983: <i>Legend for the 1:250,000 Soil Map of England and Wales</i>. Wessex Archaeology 2012: <i>Land east of Bodmin, Cornwall: Archaeological Trial Trench Evaluation Report</i></p>	
Land Use (Area): Settlement	Land Use (Site): Pasture
Date of Site Visits: 16.01.23	
Recorder's name, address and telephone number: S. Stevens, South West Archaeology Ltd., Hacche Lane Business Park, Pathfields Business Park, South Molton, Devon, EX36 3LH; 01769 573555.	

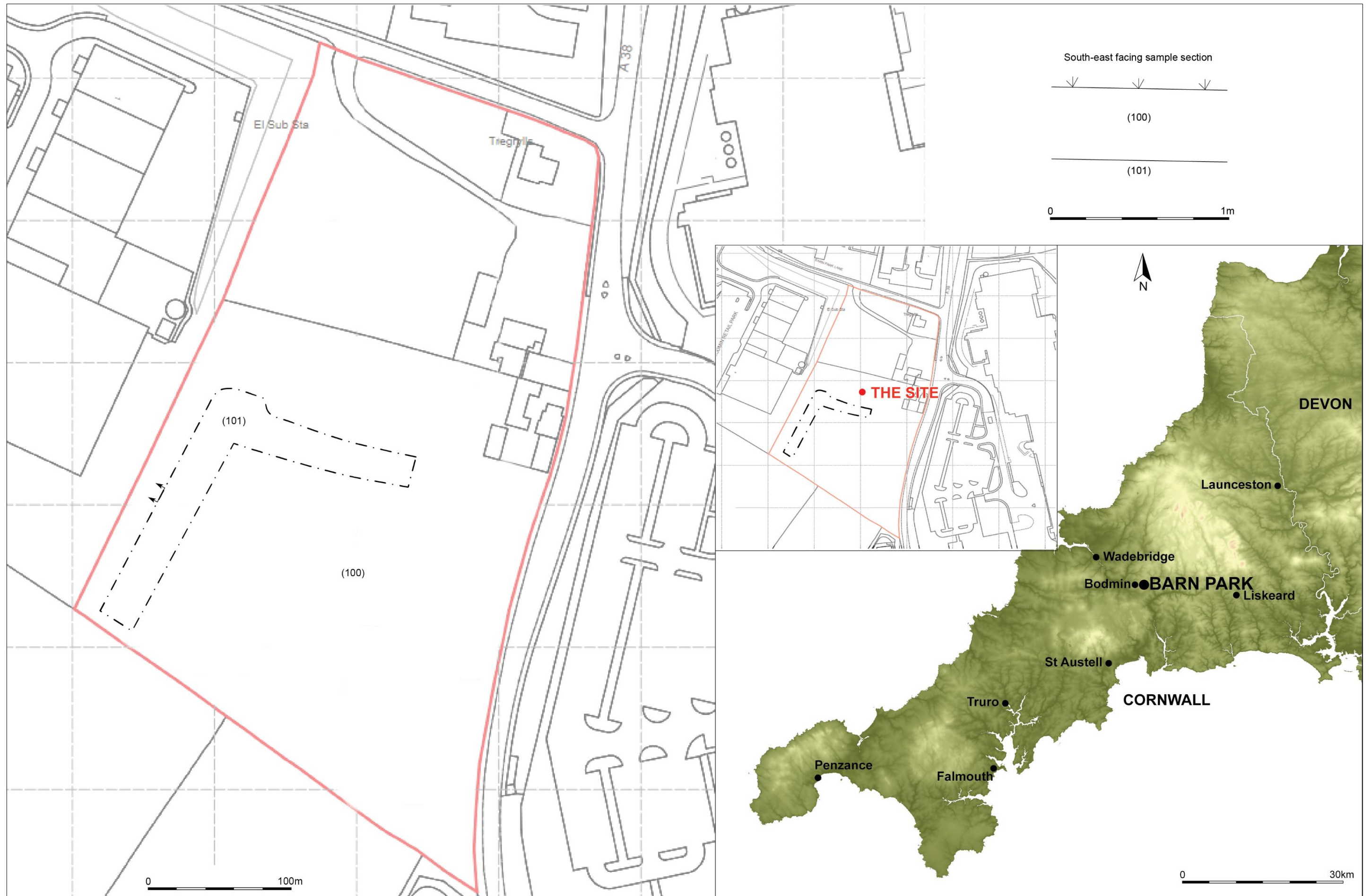

FIGURE 1: SITE AND LOCATION PLAN.



FIGURE 2: SOUTH-EAST FACING SAMPLE SECTION; FROM THE SOUTH-EAST (1M SCALE).



FIGURE 3: PLAN OF THE SITE; FROM THE EAST (1M + 2M SCALE).