

Devon County Council Historic Environment Record

Civil Parish & District: Galmpton, Torbay	National Grid Reference SX 90426 56417	Number:
Subject: Archaeological monitoring and recording during exploratory works in advance of opening up the Western Door at Churston Ferrers Church, Galmpton, Torbay, Devon		Photo attached? Yes
Planning Application no: P/2018/0929	Recipient museum: N/A	
OASIS ID: southwes1-335951	Museum Accession no: N/A	
Contractor's reference number/code: CFC18	Dates fieldwork undertaken: 4 th March 2019	
<p>Description of works.</p> <p>Archaeological monitoring and recording was undertaken by South West Archaeology Ltd. (SWARCH) during exploratory works prior to the proposed re-opening of the western door at Churston Ferrers Church, Galmpton, Torbay, Devon. The work was carried out on 4th March 2019 in accordance with a Written Scheme of Investigation (Boyd 2018) drawn up in consultation with the Archaeological Advisor of the Diocese Advisory Committee (DAC) of the Diocese of Exeter and Devon County Historic Environment Team (DCHET).</p> <p>Churston Ferrers is located c.0.8km east of Galmpton and c.1.8km west of Brixham. The church lies towards the eastern end of the village, approximately 550m south of the coast, at a height of c.50m AOD. The soils of this area are the very shallow and shallow well-drained loamy soils of the Crwbin Association (SSEW 1983); overlying the sedimentary limestone of the Churston Member (BGS 2019).</p> <p>The Church was originally a private chapel for the adjacent Churston Court. The church was granted by its owners to the church at Brixham in 1480-90, although regarded as a 'parish by tradition' and with its own churchwardens. Much of the fabric of the present church is 15th century in origin, although the tower is of 13th century date. The church was heavily restored twice during the 18th century. The doorway proposed for re-opening is likely a 15th century feature and was blocked in the late 19th century (c.1864-66) during extensive renovations to the building.</p> <p>The opening up work consisted of excavating a small hole (c.0.3m x 0.2m) just outside of the blocked doorway and breaking through the door blocking material to fully gauge the nature of its build and the thickness. The door is blocked with a mix of limestone rubble in a cement bond, and does not appear to contain any materials or architectural fragments of interest. The stone rubble infill was only 0.25m thick and was revealed to be built upon a concrete foundation. The need for a concrete foundation appears to have been as the earlier (19th century?) rainwater drainage had formerly run immediately in front of the west elevations footing. The drainage has subsequently been moved to run in its present location further away from the building, along the approximate centre of the narrow strip of churchyard west of the church. The small excavated hole simply exposed the void of this redundant drain.</p> <p>There were no finds or archaeological features encountered during these opening-up works.</p> <p>Conclusions</p> <p>The presence of a largely cement bond, and concrete footing confirm a late 19th century if not 20th century date for the blocking and there appears to be little merit in monitoring the rest of the material being removed once the works progress. There is nothing of archaeological significance which will be impacted by the proposed works. Furthermore, whilst there will be some minimal groundworks to match the levels and create a wheelchair accessible access between inside the church and the slightly higher churchyard these will all be within the modern and disturbed made-ground levels.</p> <p>Bibliography</p> <p>Boyd, N. 2019: <i>Churston Ferrers, Galmpton, Torbay, Devon: Written Scheme of Investigation</i>. SWARCH WSI no CFC18WSIv1.</p> <p>British Geological Survey 2018: <i>Geology of Britain Viewer</i>. http://maps.bgs.ac.uk/geologyviewer_google/googleviewer.html</p> <p>Morris, B. 2015: <i>Recording work at Churston Ferrers Church</i>; SWARCH No. 151025.</p> <p>Soil Survey of England and Wales 1983: <i>Legend for the 1:250,000 Soil Map of England and Wales</i>.</p>		
Recorder: S. Walls		Date sent to HER: 08.05.19

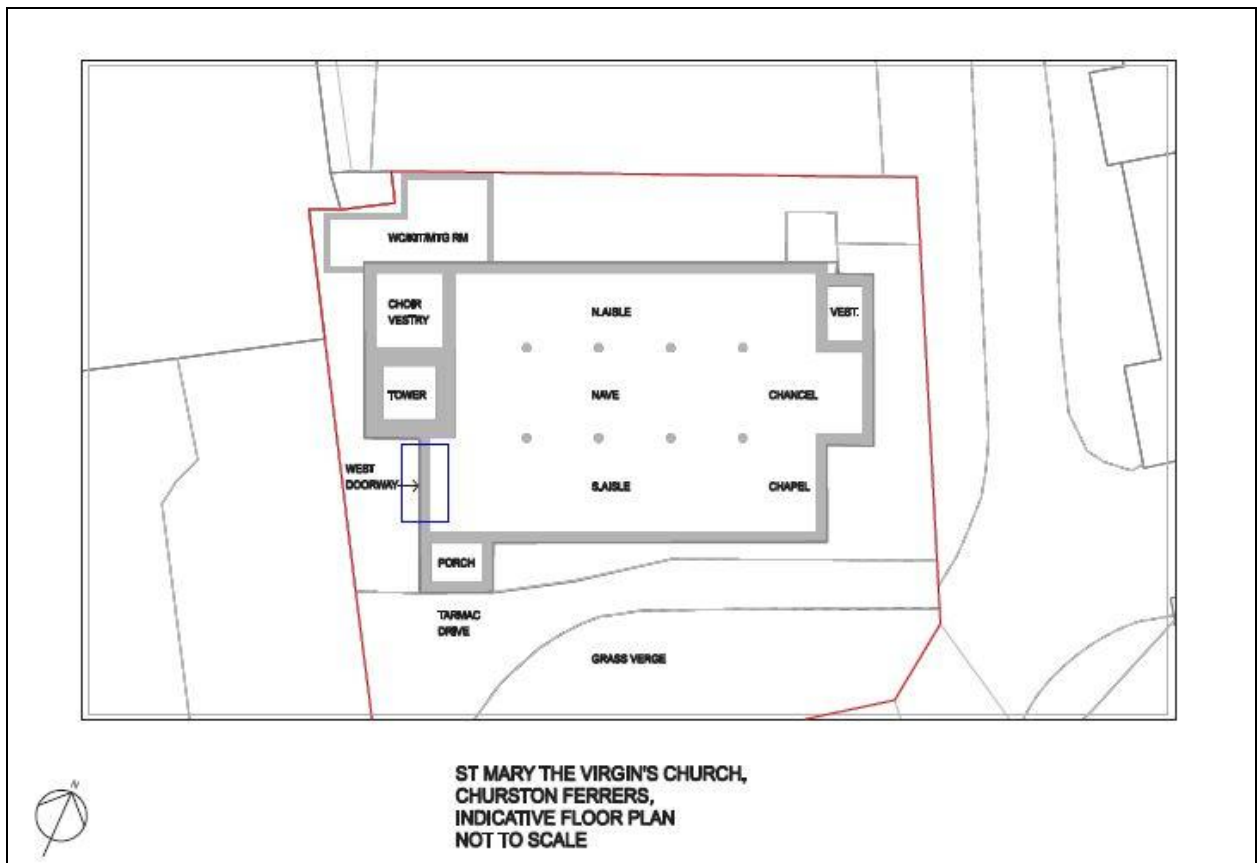

FIGURE 1: SITE PLAN SHOWING LOCATION OF THE WEST DOOR (BY APSE ARCHITECTS).



FIGURE 2: PHOTO OF THE OPENED UP AREA, VIEWED FROM THE WEST (1M SCALE).