

Archaeological Services & Consultancy Ltd

**WATCHING BRIEF:
ODDY HILL BUNGALOW
FOX ROAD
WIGGINTON
HERTFORDSHIRE**

NGR: SP 93438 10664

on behalf of Mr J Stevens



Martin Cuthbert BA (Hons) AIFA

January 2013

ASC: 1451/OHB/2



Letchworth House
Chesney Wold, Bleak Hall
Milton Keynes MK6 1NE
Tel: 01908 608989 Fax: 01908 605700
Email: office@archaeological-services.co.uk
Website: www.archaeological-services.co.uk



Site Data

<i>ASC project code:</i>	OHB	<i>ASC Project No:</i>	1451
<i>OASIS ref:</i>	109277	<i>Event/Accession no:</i>	DACHT:4306
<i>County:</i>	Hertfordshire		
<i>Village/Town:</i>	Wigginton		
<i>Civil Parish:</i>	Wigginton		
<i>NGR (to 8 figs):</i>	SP 93438 10664		
<i>Extent of site:</i>	c. 0.19 hectares		
<i>Present use:</i>	House and garden		
<i>Planning proposal:</i>	Demolition of existing building and construction		
<i>Local Planning Authority:</i>	Dacorum Borough Council		
<i>Planning application ref/date:</i>	4/01670/09		
<i>Date of fieldwork:</i>	24 March 2012		
<i>Commissioned by</i>	Mr James Stevens 57 Station Road Tring Hertfordshire HP23 5NW		
<i>Contact name:</i>	James Stevens		

Internal Quality Check

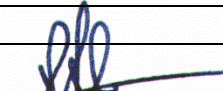
<i>Primary Author:</i>	Martin Cuthbert	<i>Date:</i>	08-01-2013
<i>Revisions:</i>		<i>Date:</i>	
<i>Edited/Checked By:</i>		<i>Date:</i>	8 th Jan 2013

© Archaeological Services & Consultancy Ltd

No part of this document is to be copied in any way without prior written consent.

Every effort is made to provide detailed and accurate information. However, Archaeological Services & Consultancy Ltd cannot be held responsible for errors or inaccuracies within this report.

© Ordnance Survey maps reproduced with the sanction of the Controller of Her Majesty's Stationery Office.
ASC Licence No. AL 100015154

CONTENTS

Summary.....	4
1. Introduction	4
2. Aims & Methods	7
3. Archaeological & Historical Background	8
4. Results.	10
5. Conclusions	13
6. Acknowledgements	14
7. Archive	14
8. References	15

Appendices:

1. ASC Watching Brief Monitoring Sheets	16
2. Photo List.....	17
3. ASC OASIS Form	18

Figures:

1. General location	3
2. Site plan indicating location of the former bungalow	5
3. Proposed development.....	6
4. Excavated areas	11

Plates:

Cover: General view of site

1. Footing trenches, looking SE	12
2. Modern pit in west facing section, looking SE.....	12
3. Soakaway and service trench, looking NW	12

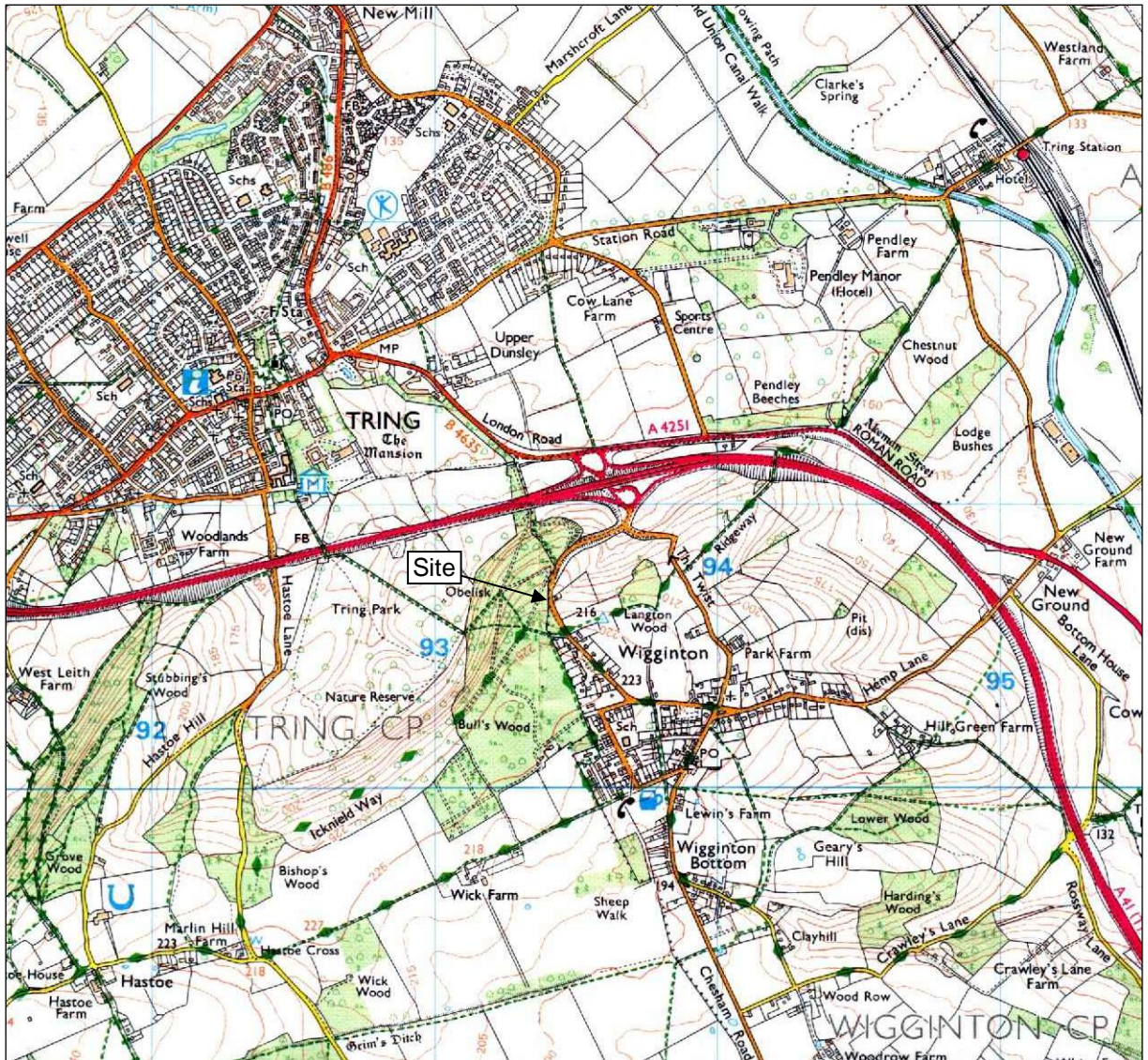

Figure 1: General location (Scale 1:25,000)

Summary

In March 2012 a watching brief was carried out during the ground works for the construction of a new bungalow at Oddy Hill Bungalow, Fox Road, Wigginton, Hertfordshire. No deposits or finds of archaeological significance were revealed. However, as the ground works were limited in scope this does not preclude the presence of archaeological remains elsewhere on the site.

1. Introduction

1.1 In March 2012 *Archaeological Services and Consultancy Ltd* (ASC) carried out a watching brief at Oddy Hill Bungalow, Fox Road, Wigginton, Hertfordshire. The project was commissioned by *Mr J Stevens*, and was carried out according to a written scheme of investigation prepared by ASC (Fell 2011), and approved by the *Historic Environment Unit of Hertfordshire County Council*, archaeological advisor (AA) to the local planning authority (LPA), *Dacorum Borough Council*.

1.2 *Planning Background*

This watching brief was required under the terms of *Planning Policy Statement 5* (PPS5), superseded by the *National Planning Policy Framework* (NPPF), as a condition of planning permission for the development of the site. The relevant planning application reference is 4/01670/09.

1.3 *Archaeological Services & Consultancy Ltd*

ASC is an independent archaeological practice providing a full range of archaeological services including consultancy, field evaluation, mitigation and post-excavation studies, historic building recording and analysis. ASC is recognised as a *Registered Organisation* by the Institute for Archaeologists and is also accredited ISO 9001, in recognition of its high standards and working practices.

1.4 *The Site*

1.4.1 *Location & Description*

The site is situated in Wigginton, in the administrative district of Dacorum Hertfordshire (Fig. 1). It lies to the north of the village, on the east side of Bull's Wood and is centred on Ordnance Survey National Grid Reference SP 93438 10664 (Fig. 2). The site comprises a sub-rectangular plot on the east side of Fox Road, from which access is gained. The site slopes from south to north and lies at an elevation of c.208m.

1.4.2 *Topography & Geology*

The natural soils of the area comprise the *Batcombe Association*, namely fine silty soils over plateau drift and Clay with-Flints (Soil Survey 1983, 582a). The underlying geology comprises Upper Chalk (BGS, Sheet 238).

1.4.3 *Proposed Development*

The development proposal comprised the demolition of the former bungalow and construction of a replacement house on approximately the same footprint (Fig. 3).

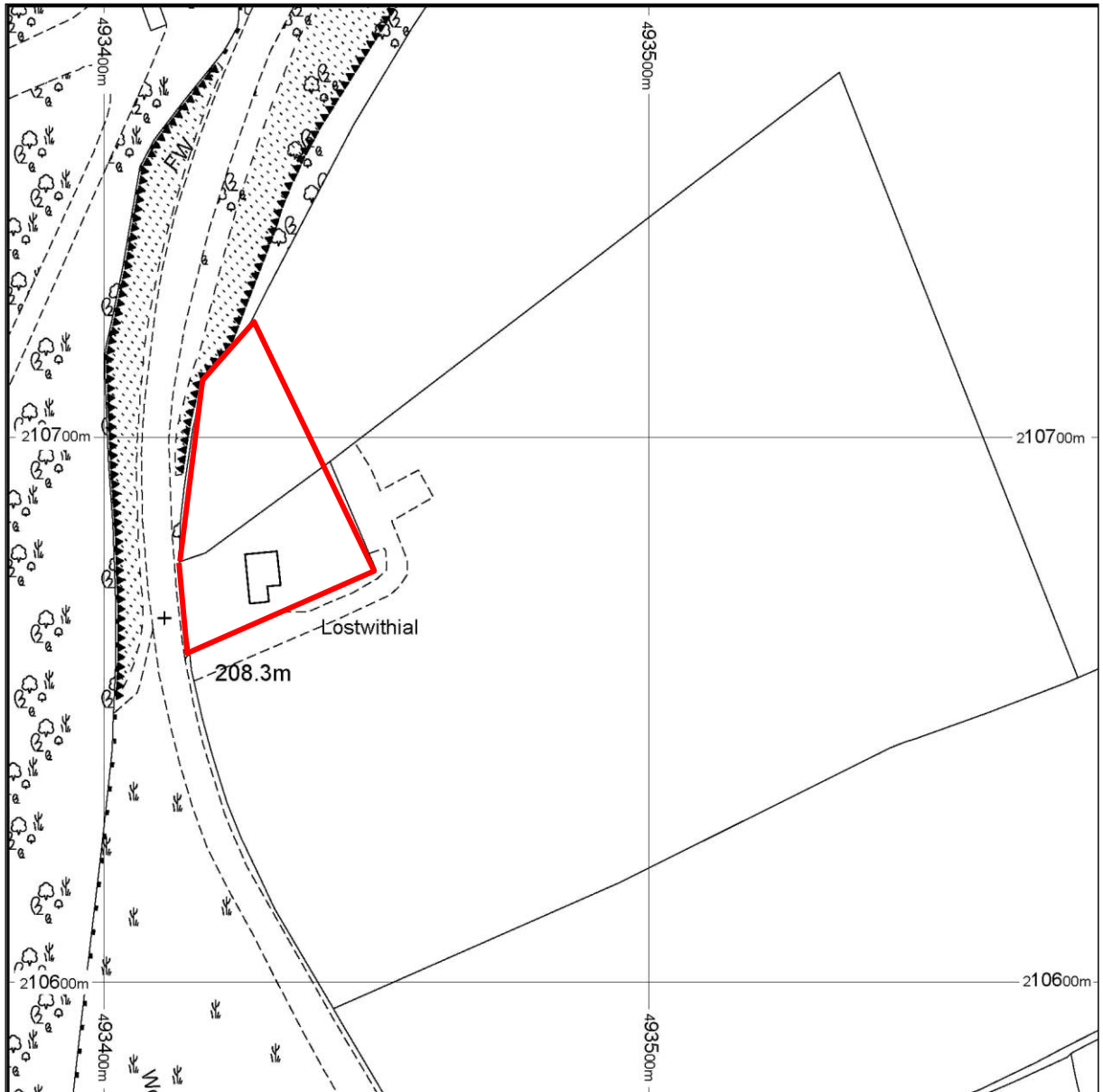

Figure 2: Site plan indicating location of the former bungalow (*Scale 1:1250*)

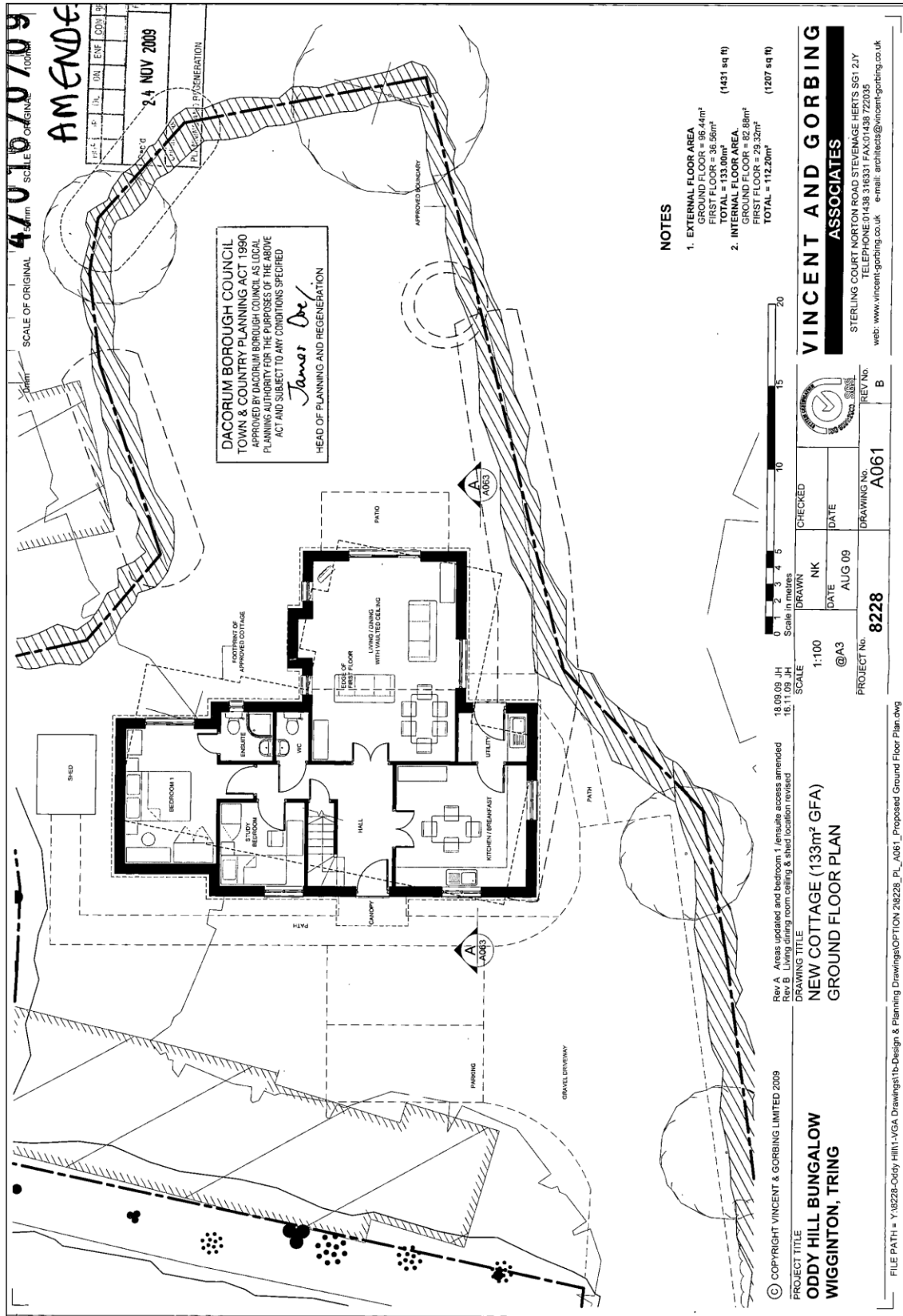

Figure 3: Proposed development (Scale as shown)

2. Aims & Methods

2.1 *Aims*

In line with the requirements of the AA the aims of the project were

- To ensure archaeological monitoring of all aspects of the development programme likely to affect archaeological remains
- To secure the adequate recording of any archaeological remains revealed by the development programme
- To secure the analysis, conservation and long-term storage of any artefactual/ecofactual material recovered from the site

2.2 *Standards*

The work conformed to the requirements of the AA, to the relevant sections of the Institute of Archaeologists' *Standard & Guidance Notes* (IFA 2001) and *Code of Conduct* (IFA 2000a), to the Association of Local Government Archaeological Officers East of England Region *Standards for Field Archaeology in the East of England* (ALGAO 2003), to English Heritage guidelines (EH 1991), and to the relevant sections of ASC's own *Operations Manual*.

2.3 *Methods*

In line with the requirements of the AA, the methods to be adopted for this project were:

- The archaeological monitoring of footing trenches and associated services
- The rapid investigation and recording of any archaeological features/deposits
- Examination of spoil-heaps for archaeological material

2.4 *Constraints*

Terracing of the southern limit of the proposed development occurred prior to the commencement of the watching brief and was therefore not monitored.

3. Archaeological & Historical Background

3.1 The following section provides a summary of the readily available archaeological and historical background to the site and its environs. Wigginton is an area of considerable archaeological and historical importance and this has been recognised by the local planning authority by the designation of the area as an *Area of Archaeological Importance* (no. 13). The site has the potential to reveal evidence of a range of periods but the focus of interest is considered to lie in the prehistoric and Roman periods.

This section has been compiled with information from the Hertfordshire *Historic Environment Record* (HER- search no. 159/11), *Hertfordshire Archives and Local Studies* and ASC's in-house collection.

3.2 *Early Prehistoric* (before 600BC)

Little is known of early prehistoric settlement in the area and the only prehistoric artefact recorded from Wigginton is a Bronze Age knife, discovered during the 19th century (HER4145). Environmental evidence suggests that the Chilterns themselves were largely covered with deciduous woodland in the sixth to fourth millennia BC (Holgate 1995, 3). Early prehistoric activity was probably limited to the river valleys and excavations in advance of the A41 Berkhamsted bypass revealed activity from the Neolithic period onwards at Bottom House Lane, c.1.5km east of the site (McDonald 1995, 121). The boundary earthwork known as Grims Ditch, dated to the late Bronze Age / early Iron Age, lies to the south of Wigginton (HER 50). Tring lies on the route of the *Icknield Way*, generally considered to be a trackway of prehistoric date, following the Chiltern scarp.

3.3 *Iron Age* (600BC-AD43)

Little is known of Iron Age activity in the area but finds by antiquarians during the 19th century include a bronze coin of Cunobelin (HER 169) and a lynch pin (HER204). Two late Iron Age iron furnaces have been identified in Tring Park (HER17474) c.1km west of the site and further iron production sites and smelting furnaces have been found at Tring (HER6069) to the north of the site. Late Iron Age coins (HER153) and a probable gold torc (HER6059) have also been found in the Tring area. Early Iron Age pottery has also been found to the east of Brook Street, Tring, in association with a late Roman coin (HER6390).

3.4 *Roman* (AD43-c.450)

During the Roman period, the area fell within the *civitas* (tribal territory) of the *Catuvellauni*, with its administrative centre at *Verulamium* (St Albans). The Roman road from St Albans to Alchester (Oxon), latterly known as *Akeman Street* (now the A4251) runs c.1km to the north east (HER4590; Copeland 2009, map 2). The Victoria County History refers to the discovery of Roman tiles and coins in Wigginton (HER1599; Page 1971, 169) but the nearest Roman settlement to the site was at Cow Roast, 2km to the south-east. Little is known of the settlement, though it was evidently associated with a significant metal-working industry (Zeepvat 1997). Fieldwork on the National Trust's Ashridge Estate, c.3.5km east of the site, has recorded a number of surviving earthworks of field systems and enclosures, possibly of Roman date, in established woodland.

3.5 *Saxon and Medieval (c.450-1500)*

No Saxon material has been recorded in the area. In the late Saxon period, up to the Danish wars of the 9th century, west Hertfordshire fell within the kingdom of Mercia (Gover *et al* 1970). During those wars much of Hertfordshire was annexed by the Danes, so much so that the western hundred of the county was known as *Dacorum*, the ‘Danish hundred’ (*ibid.*).

The early history of Wigginton is not understood in detail, but a settlement may have been established by the Saxon period (HER2635). The village is included in the Domesday survey (1086) where it is referred to as *Wigentone* (Morris 1976). The medieval settlement developed to the south of the site and was centred on the church of St Bartholomew, which dates from the 13th century (HER4375; Pevsner & Cherry 2002, 407).

3.6 *Post-medieval & Modern (1500-1900-present)*

The parish is dominated by Tring Park (HER15957), which extends over much of the land on the west side of Fox Road and comprises an 18th century landscaped park and woodland (HER7343). It is registered as Grade II on the English Heritage national register of historic parks and gardens. The principal building is attributed to Sir Christopher Wren and dates from the late 17th century (Pevsner & Cherry 2002, 369-70). The grounds contain a number of significant features, including an obelisk (HER 12637 and the Temple Summer House (HER12638).

Fox Road is a long established route and is shown on the 1841 Tithe Map of Wigginton. The site forms part of a more extensive land parcel, labelled ‘4’ on the map and later Ordnance Survey maps also show the site as open ground.

The former bungalow was built in 1931 by Mr. C. Hearn, presumably to house a farm labourer working on Dunsley Farm (HER 15580). Originally known as ‘*Lostwithial*’ it was extended and modernised in the late 1960s/early 1970s (Crank & Semmelmann 2006).

4. Results

4.1 The new development covers an area of *c.* 0.19 hectares and replaces the former bungalow (Figs 2 & 3). In addition to footing trenches, excavation of a soakaway and service trench to the northeast of the new development took place (Fig. 4).

4.2 *Excavated areas* (Fig 4, Plates 1-3)

4.2.1 Observations were made during excavation of the footing trenches (Fig. 4, Plate 1 and cover). The footing trenches were 0.8m wide, and 1.1- 2.5m deep. The northern and eastern footings cut through 0.2m of topsoil and into the natural geology consisting of beige yellow chalky clay. Areas at the south and west of the new development had been terraced prior to the monitored works. At the southern limit *c.*1.2m of overburden had been removed prior to the excavation of the footing trenches.

4.2.2 A large modern pit was noted in the footing trench at the southeastern corner of the new development (Plate 2). Modern brick and glass fragments were observed in its lower deposits. The pit is outside of the footprint of the former 1930's bungalow and maybe contemporary with this. No pre-modern archaeological features were observed and no artefacts were recovered from the up-cast deposits.

4.2.3 The soakaway was located *c.*22m northeast of the most north-easterly corner of the new development. It measured 2m² and *c.*2m deep, and cut through 0.3m of topsoil, 0.6m of mid brown orange chalky clay subsoil and the natural chalk deposit (Plate 3). No archaeology was revealed within the soakaway.

4.2.4 The service trench ran NNW from the soakaway to the site limit (Plate 3). It measured 0.6m wide and *c.* 0.7m deep. The service trench cut through 0.1m of topsoil and turf, 0.3m of subsoil and into the natural chalk deposit. No archaeology was revealed within the service trench.

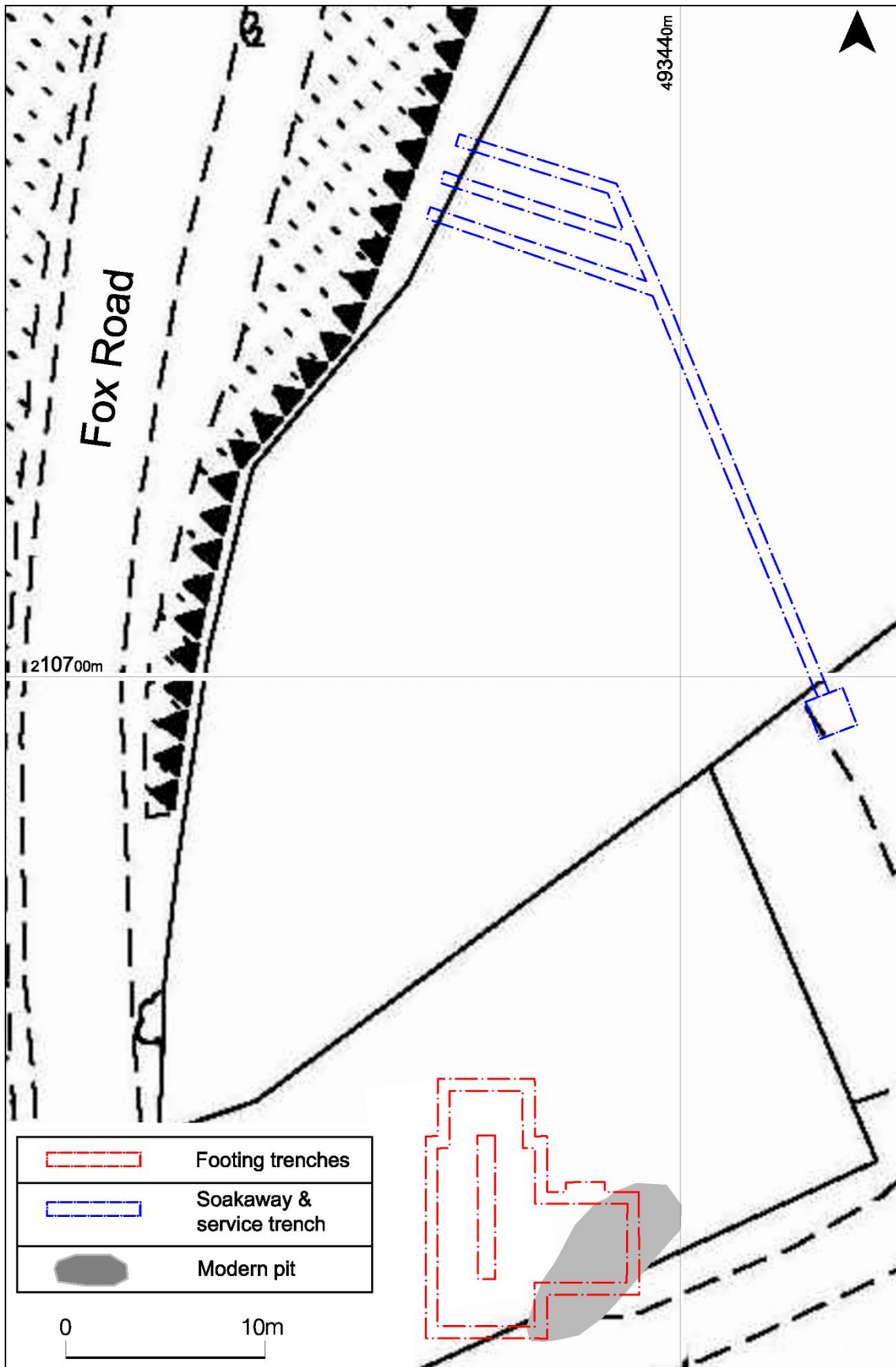

Figure 3: Excavated areas (Scale 1:300)



Plate 1: Footing trenches, looking SE



Plate 2: Modern pit in west facing section, looking SE



Plate 3: Soakaway and service trench, looking NW

5. Conclusions

5.1 Significant archaeological features were not observed in the excavated areas. While the existence of individual, isolated archaeological features, away from excavated areas cannot be entirely excluded, it is unlikely that large numbers of archaeological features or artefacts are present on the site. It is unlikely that the proposed development will have a significant impact on archaeological remains.

5.2 *Confidence Rating*

On-site conditions for the archaeological works were good and the work took place in dry weather. Reasonable co-operation was received from the contractors and a high degree of confidence is attached to the results of the archaeological works.

6. Acknowledgements

Thanks are due to *Mr J Stevens* who commissioned ASC for this project. The project was monitored by *Kate Batt* of the *Historic Environment Unit* of *Hertfordshire County Council*, on behalf of the local planning authority. Thanks are also due to the on site contractors.

The project was managed for ASC by Bob Zeepvat BA MIFA. Fieldwork was carried out by Martin Cuthbert BA (Hons) AIFA. The report was prepared by Martin Cuthbert and edited by Bob Zeepvat.

7. Archive

7.1 The project archive will comprise:

1. Brief
2. Project Design
3. Initial Report
4. Clients site plans
5. Site Monitoring Sheets
6. Site record drawings
7. List of photographs
8. B/W prints & negatives
9. CDROM with copies of all digital files.

7.2 The archive will be deposited with Dacorum Heritage Trust.

8. References

Standards & Specifications

- ALGAO 2003 *Standards for Field Archaeology in the East of England*. East Anglian Archaeology Occasional Paper **14**.
- EH 1991 *The Management of Archaeological Projects*, 2nd edition. English Heritage (London).
- EH 2006 *The Management of Research Projects in the Historic Environment*. English Heritage (London).
- Fell D 2011 *Written Scheme of Investigation for Archaeological Watching Brief: Oddy Hill Bungalow, Wigginton, Hertfordshire*: ASC document ref. 1451/OHB/1.
- IFA 2010 Institute for Archaeologists' *Code of Conduct*.
- IFA 2008 Institute for Archaeologists' *Code of Approved Practice for the Regulation of Contractual Arrangements in Field Archaeology*.
- IFA (various dates) Institute for Archaeologists' *Standard & Guidance* documents (*Desk-Based Assessments 2011, Watching Briefs 2008, Evaluations 2009, Excavations 2008, Investigation and Recording of Standing Buildings 2008, Finds 2008, Archiving 2009*).

Secondary Sources

- BGS *British Geological Survey 1:50,000 Series, Solid & Drift Geology*.
- Copeland T, 2009 *Akeman Street: Moving through Iron Age and Roman Landscapes*. The History Press
- Crank N & Semmelmann K, 2006 *Historic Building and Desk Based Assessments: Oddy Hill Bungalow, Fox Road, Wigginton, Hertfordshire*. Archaeological Services and Consultancy Ltd report no. **745/OHB/02**
- Gover, JEB, Mawer A & Stenton FM 1970 *The Place-Names of Hertfordshire*. English Place-Name Soc. **40** (Cambridge).
- Holgate R 1995 'Early prehistoric settlement of the Chilterns' in Holgate (ed.), *'Chiltern Archaeology. Recent Work: A Handbook for the Next Decade'* 3-17.
- McDonald, T 1995 'The A41 project, Hertfordshire Archaeological Trust' in 'Holgate (ed.), 120-124.
- Morris J (ed), 1976 *The Domesday Book: Hertfordshire*. History from the Sources. Phillimore
- Page W (ed) 1971 *The Victoria History of the County of Hertfordshire* **4**. Dawsons of Pall Mall
- Pevsner N & Cheery B, 2002 *The Buildings of England. Hertfordshire*. Yale University Press
- Soil Survey 1983 *1:250,000 Soil Map of England and Wales, and accompanying legend*
- Zeepvat B 1997 *The Roman Settlement at Cow Roast, Hertfordshire: Updated Project Design & Assessment Report*. Hertfordshire Archaeological Trust, May 1997.

Appendix 1: Monitoring Sheets



WATCHING BRIEF RECORD

Project: ODDY Hill Wigginton, Herts		Project No/Code: 1451 / OHB	Sheet: 1 of
Client/Developer		Date of visit: 24/3/12	
Contact: Jim Stevens		Phone: 07878 550923	
Duration of Visit (inc. travel):	Start: 10:30	Finish: 14:00	
Completed by: M.C			
Development Type:			
Footings <input checked="" type="checkbox"/>	Services	Roads	Levelling
			Quarrying
			Pipelines
			Other (specify):
Site & weather conditions: dry + Sunny			
Observations: Footings trenches for new house - see reverse Soakaway + drainage trenches - see fig 2 in PD (ripped out) site slopes from south to north. terraced into bank c. 1.2m ^{deep} at southern end. - then the footings trenches ^{were} dug. Northern + eastern footings are not into terraced ground i.e. topsoil is visible. large pit - see plan - is 1.1m deep (max) a number of layers ^{c.g.} including redeposited natural cat be seen in section. (both brick fragments + glass are in the lower deposit of the pit. photo taken but section not warranted. pit in location of previous bungalows patio No other archaeology			
Comments: Service trenches to be dug in 2-3 months. They'll let us know if + when this happens.			

Appendix 2: List of Photographs

SITE NAME: Oddy Hill Bungalow, Wigginton, Hertfordshire			SITE NO/CODE: 1451/OHB/2
Shot	B&W	Digital	Subject
1		✓	Section through initial ground reduction, looking SSE
2		✓	Modern pit within the footings trenches, looking southeast
3		✓	Modern pit within the footings trenches, looking northeast
4		✓	Modern pit within the footings trenches, looking northeast
5		✓	General site shot looking west
6		✓	Footings trench at northern limit, indicating topsoil still in situ, looking northeast
7		✓	General site shot looking south
8		✓	Soakaway, looking west
9		✓	Soakaway and drainage trench, looking NNW
10		✓	Soakaway and drainage trench, looking NNW
11		✓	Drainage trench stratigraphy, looking west
12		✓	Drainage trenches, looking northwest
13		✓	Modern pit within the footings trenches, looking northwest
14		✓	General site shot looking east
15		✓	General site shot indicating two stages of terracing, looking east

Appendix 3: ASC OASIS Form

PROJECT DETAILS			
Project Name:	Oddy Hill Bungalow, Wigginton	OASIS reference:	Archaeol2-109277
Short Description:	In March 2012 a watching brief was carried out during the ground works for the construction of a new bungalow at Oddy Hill Bungalow, Fox Road, Wigginton, Hertfordshire. No deposits or finds of archaeological significance were revealed. However, as the ground works were limited in scope this does not preclude the presence of archaeological remains elsewhere on the site.		
Project Type:	Watching Brief		
Previous work: (eg. SMR refs)	None	Site status: (eg. none, SAM, listed)	None
Current land use:	Residential garden and former bungalow	Future work: (yes/no/unknown)	No
Monument type:	Pit	Monument period:	Post-medieval
Significant finds: (artefact type & period)	None		
PROJECT LOCATION			
County:	Hertfordshire	OS reference: (8 figs min)	SP 93438 10664
Site address: (+ postcode if known)	Oddy Cottage, Fox Road, Wigginton, Tring, HP23 6EE		
Study area: (sq. m. / ha)	c.135sq m	Height OD: (metres)	c.208m OD
PROJECT CREATORS			
Organisation:	Archaeological Services & Consultancy Ltd		
Project brief originator:	N/a	Project design originator:	ASC Ltd (Fell 2011)
Project Manager:	Bob Zepvat BA MIFA	Director/Supervisor:	Martin Cuthbert BA AIFA
Sponsor / funding body:	Mr J Stevens		
PROJECT DATE			
Start date:	23 rd March 2012	End date:	
PROJECT ARCHIVES			
	Location (Accession no.)	Content (eg. pottery, animal bone, files/sheets)	
Physical:	Dacorum Heritage Trust	None	
Paper:		Site records, report, site plans, B&W prints and negatives	
Digital:		Images, report	
BIBLIOGRAPHY (Journal/monograph, published or forthcoming, or unpublished client report)			
Title:	Watching Brief: Oddy Hill Bungalow, Wigginton, Herts		
Serial title & volume:	ASC Ltd Report ref. 1451/OHB/2		
Author(s):	Martin Cuthbert BA (Hons) PIFA		
Page nos	18	Date:	08-01-2012