



Archaeological Services & Consultancy Ltd

**WATCHING BRIEF:
MILL FARM
MILL ROAD
WATER EATON
BLETCHLEY**

on behalf of SG Properties Ltd.



Lizzie Gill BDC PgDip

September 2007

ASC: 971/BMF/1

Letchworth House
Chesney Wold, Bleak Hall,
Milton Keynes MK6 1NE
Tel: 01908 608989 Fax: 01908 605700
Email: office@archaeological-services.co.uk
Website: www.archaeological-services.co.uk



Site Data

<i>ASC project code:</i>	BMF	<i>ASC Project No:</i>	971
<i>Event No:</i>	1136	<i>Accession No:</i>	
<i>County:</i>	Buckinghamshire		
<i>Village/Town:</i>	Bletchley		
<i>Civil Parish:</i>	Bletchley		
<i>NGR (to 8 figs):</i>	SP 8826 3294		
<i>Present use:</i>	Out buildings		
<i>Planning proposal:</i>	Residential development		
<i>Planning application ref/date:</i>	06/01283/FUL		
<i>Local Planning Authority:</i>	Milton Keynes Council		
<i>Date of fieldwork:</i>	10/09/97-12/09/07		
<i>Client:</i>	SG Properties Ltd. 52 Penny Lane Liverpool L18 1DG		
<i>Contact name:</i>	Graham Patrick		

Internal Quality Check

<i>Primary Author:</i>	Lizzie Gill	<i>Date:</i>	27 th September 2007
------------------------	-------------	--------------	---------------------------------

<i>Revisions:</i>		<i>Date:</i>	
-------------------	--	--------------	--

<i>Edited/Checked By:</i>		<i>Date:</i>	
---------------------------	--	--------------	--

© Archaeological Services & Consultancy Ltd

No part of this document is to be copied in any way without prior written consent.

Every effort is made to provide detailed and accurate information. However, Archaeological Services & Consultancy Ltd cannot be held responsible for errors or inaccuracies within this report.

© Ordnance Survey maps reproduced with the sanction of the Controller of Her Majesty's Stationery Office.

ASC Licence No. AL 100015154

CONTENTS

Summary	4
1. Introduction	4
2. Aims & Methods	7
3. Archaeological & Historical Background	8
4. Results	9
5. Conclusions	11
6. Acknowledgements	12
7. Archive	12
8. References	13

Appendices:

1. ASC Watching Brief Monitoring Sheets	14
2. Photo List.....	18
3. ASC OASIS Form	19

Figures:

1. General location	3
2. Site plan	5
3. Plan of development	6

Plates:

Cover: View E towards Mill Farm House

1. Looking NW towards Mill Farm House.....	10
2. E facing section of footing trench.....	10
3. W facing section through footing trenches 1m scale.....	10
4. View NE across the footing trenches.....	10
5. E facing section showing more bricks from demolished buildings.....	10
6. View of the western end of the site	10

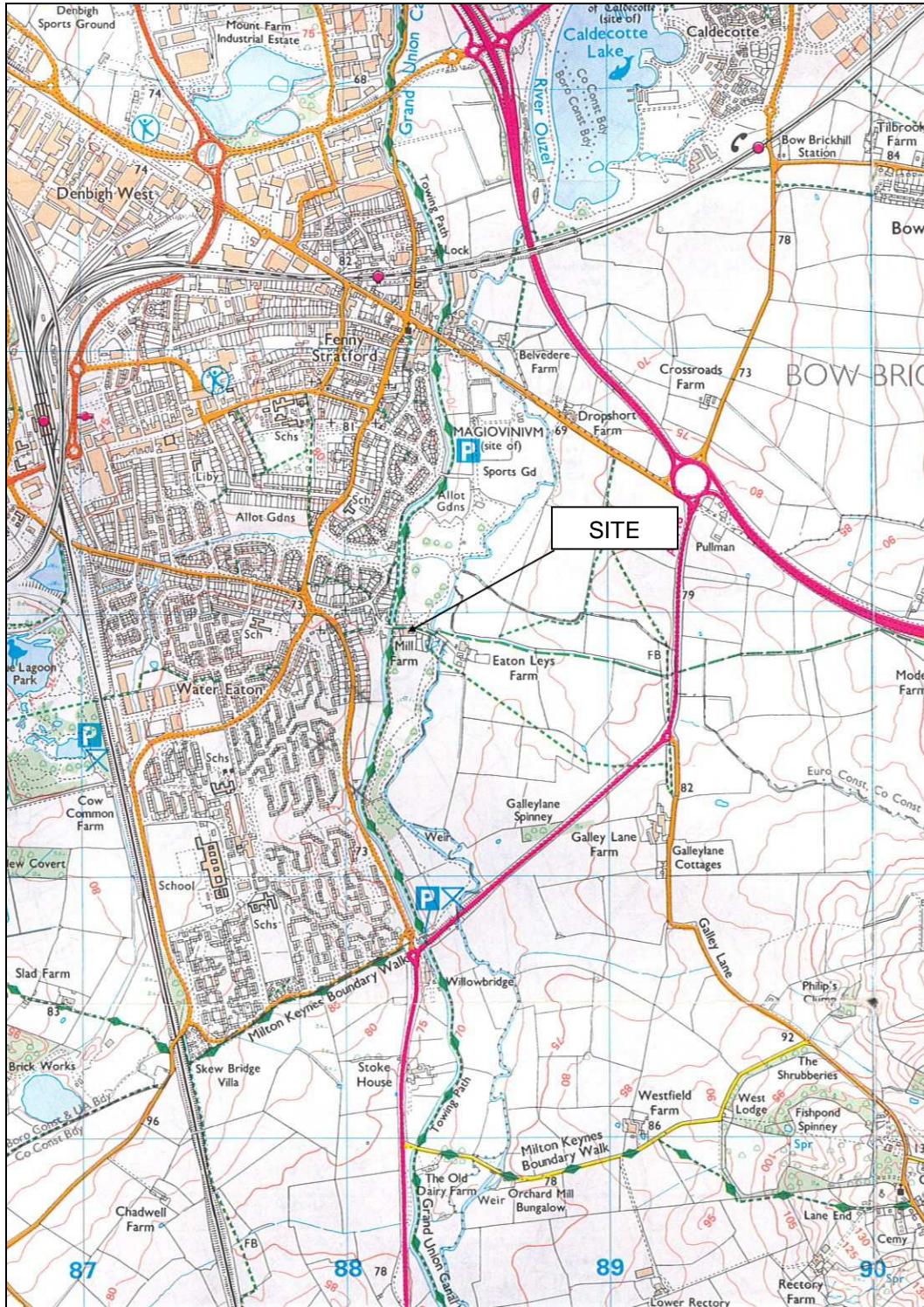

Figure 1: General location (scale 1:25,000)

Summary

In September 2007 Archaeological Services and Consultancy Ltd. undertook a watching brief (ASC) on land adjacent to Mill Farm, Mill Lane, Water Eaton, Bletchley, Milton Keynes in advance of the construction of a large detached property. Three visits were made to this site and all footing trenches were observed. No archaeological remains were found.

1 Introduction

1.1 In September 2007 *Archaeological Services and Consultancy Ltd* (ASC) carried out a watching brief at Mill Farm, Mill Road, Water Eaton, Bletchley, Milton Keynes (NGR SP 8826 3294: Fig. 1). The project was commissioned by SG Properties Ltd., and the work was agreed on behalf of the local planning authority (LPA), *Milton Keynes Council*, by their archaeological advisor (AA), *the Milton Keynes Archaeological Officer*. The relevant planning application reference is 06/01283/FUL.

1.2 *Planning Background*

This watching brief has been required as a planning condition under the terms of *Planning Policy Guidance Note 16* (PPG16), in response to proposals for the construction of a large detached dwelling.

1.3 *Location and Description*

The site is situated on the western edge of Bletchley and Water Eaton, in the administrative district of Milton Keynes, c. 2km E of Bletchley centre. The area of the watching brief consists of an irregularly shaped piece of land adjacent to the W side of Mill Farm House. Buildings that recently occupied the land have been demolished and there are large piles of bricks on the site. Access is gained via Mill Lane at the eastern end of the site, which forms the northern boundary of the site. The site is at an elevation of c.73m OD

1.5 *Geology & Topography*

The soils are described as the *Hanslope Association*, which comprises *slowly permeable calcareous clayey soils. Some slowly permeable non-calcareous clayey soils. Slight risk of water erosion.* (Soil Survey 1983, 411d).



Figure 2: Site plan (scale 1:5000)

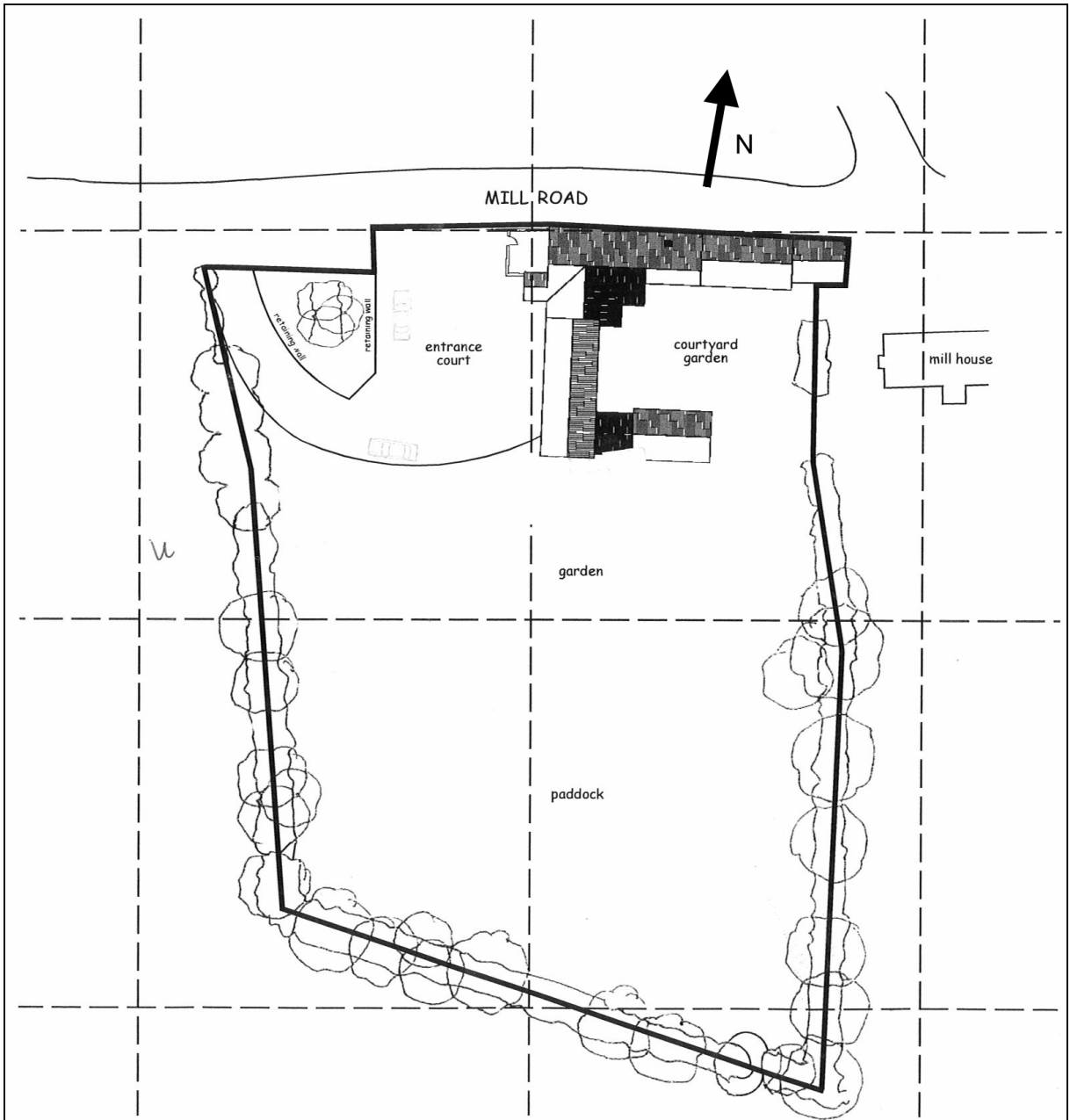

Figure 3: Plan of development (not to scale)

2 Aims & Methods

2.1 Aims

As agreed with the AA, the aims of the watching brief were:

- To ensure any archaeological features were fully recorded and interpreted
- To ensure any significant evidence was recorded and analysed to appropriate standards

2.2 Standards

The work conformed to the project design, to the relevant sections of the Institute of Archaeologists' *Code of Conduct* (IFA 2000) and *Standard & Guidance Notes* (IFA 2001), to the Association of Local Government Archaeological Officers East of England Region *Standards for Field Archaeology in the East of England* (ALGAO 2003), and to the relevant sections of ASC's own *Operations Manual*.

2.3 Methods

The work was carried out as agreed with the AA:

- A programme of archaeological observation, investigation and recording during any development works likely to affect archaeological remains.

3 Archaeological & Historical Background

CAS= County Archaeological Service

- 3.1 Bletchley is an area of considerable archaeological and historical importance. The site has the potential to reveal evidence of a variety of periods but the focus of attention is likely to lie in the Roman period.
- 3.2 A variety of prehistoric finds are known in the Ouzel valley, but remains of this period are not known from the site. Late Iron Age settlement is known from the Lakes Estate, Bletchley (CAS no. 303500000) and also near the development area. Further settlement of the period has been recorded at Saffron Gardens c.400m north of the site. Late Iron Age pottery has also been recorded in a field on the east side of Stoke Road, c.550m SW of the site (CAS 305501001).
- 3.3 The area was of considerable importance during the Roman period, notably due to the existence of a major road, now known as *Watling Street*, which passed c.900m northeast of the site. The road and river valley attracted settlement during this period and the small Roman town of *Magiovinium* was situated c.400m north of the site (Neal 1987). A number of Roman coins have been recorded in a field c.600m south of the site (CAS 305500000).
- 3.4 The west side of the site is c.50m from the Grand Union Canal. This was opened in 1797 as the *Grand Junction Canal* as far as Fenny Stratford and was a major impetus for the economic development of Bletchley and the surrounding area. The works associated with the canal may have caused localised disturbance to the site, but the area has probably always comprised open ground. It is shown on the Bletchley tithe map (1813), and comprised two separate land parcels. The same layout is recorded on the 1885 edition Ordnance Survey map.
- 3.5 During December 2005 Archaeological Services and Consultancy Ltd undertook archaeological excavation of a 3500 sq m area at land adjacent to Stoke Road, Water Eaton, Bletchley, Milton Keynes. The excavation followed a program of evaluation which had located ditches and pits containing mid Saxon pot sherds. Removal of the topsoil revealed ditches, gullies, pits, post holes and one sunken featured building which defined the position of fenced boundaries, structures, an enclosure and an appended field system. The assemblage of potsherds recovered from excavated features was small but suggests that the majority of the archaeological features may date to the mid Saxon period. The recovered finds, excavated archaeological features and environmental evidence appear to identify the location of a short lived farmstead occupied during the 8th – 9th centuries.

4. Results

- 4.1 Three visits were made to the site on the 10th 11th and 12th of September 2007. During these visits all the footing trenches for the development were observed.
- 4.2 All footing trenches were dug to a maximum depth of c.1.35m into natural geology and contained the same stratum throughout. This consisted of natural mid yellowish brown silty clay with frequent calcareous inclusions overlain by mixed re-deposited natural and mid brownish grey silty loam topsoil. The maximum depth of this layer across the footing trenches was c.1.30m toward the NE corner of site. The minimum depth was c.0.9m towards the western end of the development.
- 4.3 Walls from the recently demolished outbuildings were visible in sections across the footing trenches (Plate 2) and large piles of bricks from this process were present on site (Plate 6).
- 4.4 No archaeology was observed during this watching brief.



Plate 1: Looking NW towards Mill Farm House



Plate 2: E facing section of footing trench showing wall foundations of recently demolished building 1m scale

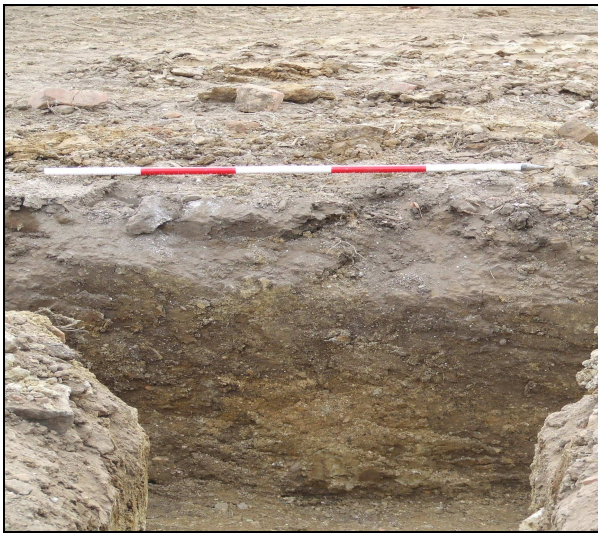

Plate 3: W facing section through footing trenches 1m scale



Plate 4: View NE across the footing trenches



Plate 5: E facing section showing more bricks from demolished buildings



Plate 6: View of the western end of the site and the large amount of bricks from the demolished

5. Conclusions

- 5.1 The outbuildings recently demolished on the site are present on the 1892 Ordnance Survey map of the area and examination of bricks from the footing trenches confirms that they are of modern date.
- 5.2 It is likely that the footing trenches for these previous outbuildings have disturbed the entire area of the ground covered by the footprint of the proposed development. It is therefore unlikely that archaeological remains, if present have survived in the study area and the archaeological impact of the development is judged to be minimal.
- 5.3 It is possible that archaeology may survive outside the study area and this should be taken into account if further development is planned in the vicinity.
- 5.4 *Confidence Rating*
This watching brief was undertaken in warm, dry weather with partly sunny skies by an experienced archaeologist. Full co-operation was received from the contractors and subsequently the confidence rating attached to the project is high.

6. Acknowledgements

The writer is grateful to SG Properties Ltd. for commissioning Archaeological Services and Consultancy Ltd. (ASC) to carry out this project. The help and advice of Nick Crank, Archaeological Officer for Milton Keynes Council is also gratefully acknowledged.

Lizzie Gill BSc PgDip, on behalf of ASC Ltd., carried out the monitoring visits, and wrote this report. David Fell MA MIFA managed the project and edited this report.

7. Archive

7.1 The project archive will comprise:

1. Initial Report
2. Clients site plans
3. Site Monitoring Sheets
4. List of photographs
5. B/W prints & negatives
6. CDROM with copies of all digital files.

7.2 The archive will be deposited with Buckinghamshire County Museum.

8. References

Standards & Specifications

ALGAO 2003 *Standards for Field Archaeology in the East of England*. East Anglian Archaeology Occasional Paper **14**.

EH 1991 *The Management of Archaeological Projects*, 2nd edition. English Heritage (London).

IFA 2000a Institute of Field Archaeologists' *Code of Conduct*.

IFA 2000b Institute of Field Archaeologists' *Code of Approved Practice for the Regulation of Contractual Arrangements in Field Archaeology*.

IFA 2001 Institute of Field Archaeologists' *Standard & Guidance documents (Desk-Based Assessments, Watching Briefs, Evaluations, Excavations, Investigation and Recording of Standing Buildings, Finds)*.

Secondary Sources

Fell D. 2004 *Project Design for Archaeological Evaluation: Footbridge Over Grand Union Canal, Stoke Road, Water Eaton, Bletchley, Milton Keynes* ASC Report 622/BSB/01

Giggins B 2004 *Footbridge over Grand Union Canal, Stoke Road, Bletchley. Brief for Archaeological Evaluation*. Milton Keynes Council

Hancock A. 2006 *Archaeological Excavation: Land Adjacent to Stoke Road, Water Eaton, Bletchley, Milton Keynes* ASC 742/WES/02

Neal D S 1987 *Excavations in Magiovinium, Buckinghamshire, 1978-80* Records of Buckinghamshire **29**, 1-124

Soil Survey 1983 *1:250,000 Soil Map of England and Wales, and accompanying legend* (Harpenden).

Appendix 1: Monitoring Sheets

A.S.C. LTD		ARCHAEOLOGICAL FIELD MONITORING RECORD				
Project: Mill farm, Mill rd. Bletchley		Project No/Code: 971 1 BMF		Sheet: 1 of 1		
Client/Developer: SLR properties Ltd		Date of visit: 10/09/07				
Contact: —		Phone: —				
Duration of Visit (inc. travel):		Start: 9.10am		Finish: 10.30am		
Completed by: LIZZIE GILL						
Development Type:						
<input checked="" type="checkbox"/> Footings	<input type="checkbox"/> Services	<input type="checkbox"/> Roads	<input type="checkbox"/> Levelling	<input type="checkbox"/> Quarrying	<input type="checkbox"/> Pipelines	<input type="checkbox"/> Other (specify):
Site & weather conditions: Overcast						
Observations: Big pile of bricks over place where footing trenches supposed to be dug, so they're not starting today - will be tomorrow afternoon probably. Have given my number to Patrick on site who will ring be when they start digging the footings						
Comments: Visit tomorrow 11/09/07.						

For sketch plan, use reverse

©ASC, 2003



A.S.C. LTD

ARCHAEOLOGICAL FIELD MONITORING RECORD

Project: Mill Farm, Mill rd., Bletchley		Project No/Code: 971 1 BMF		Sheet: 1 of 1		
		Date of visit: 11/09/07				
Client/Developer: SGT homes - Graham						
Contact:			Phone:			
Duration of Visit (inc. travel):		Start: 11 am		Finish: 13.00		
Completed by: LIZZIE GILL						
Development Type:						
Footings <input checked="" type="checkbox"/>	Services	Roads	Levelling	Quarrying	Pipelines	Other (specify):
Site & weather conditions: Warm + Sunny						
Observations:						
Excavation of footing trenches by machine has begun - See sketch plan for trenches dug at this time.						
Natural geology reached in all trenches - strat above this is v. disturbed + contains mod. bricks, bits of plastic etc. None of the trenches show undisturbed strat.						
No archaeology observed in any trenches on this visit.						
Walls visible in trenches clearly belong to buildings recently demolished on site.						
Comments:						
Return Wednesday (12/09) to see all trenches open as pouring will not commence until Thursday (13/09)						

For sketch plan, use reverse

©ASC, 2003



SKETCH SHEET

Site Name: Mill farm, Mill rd,	Site Code: 971/BMF	Orientation:
Context: Bletchley		

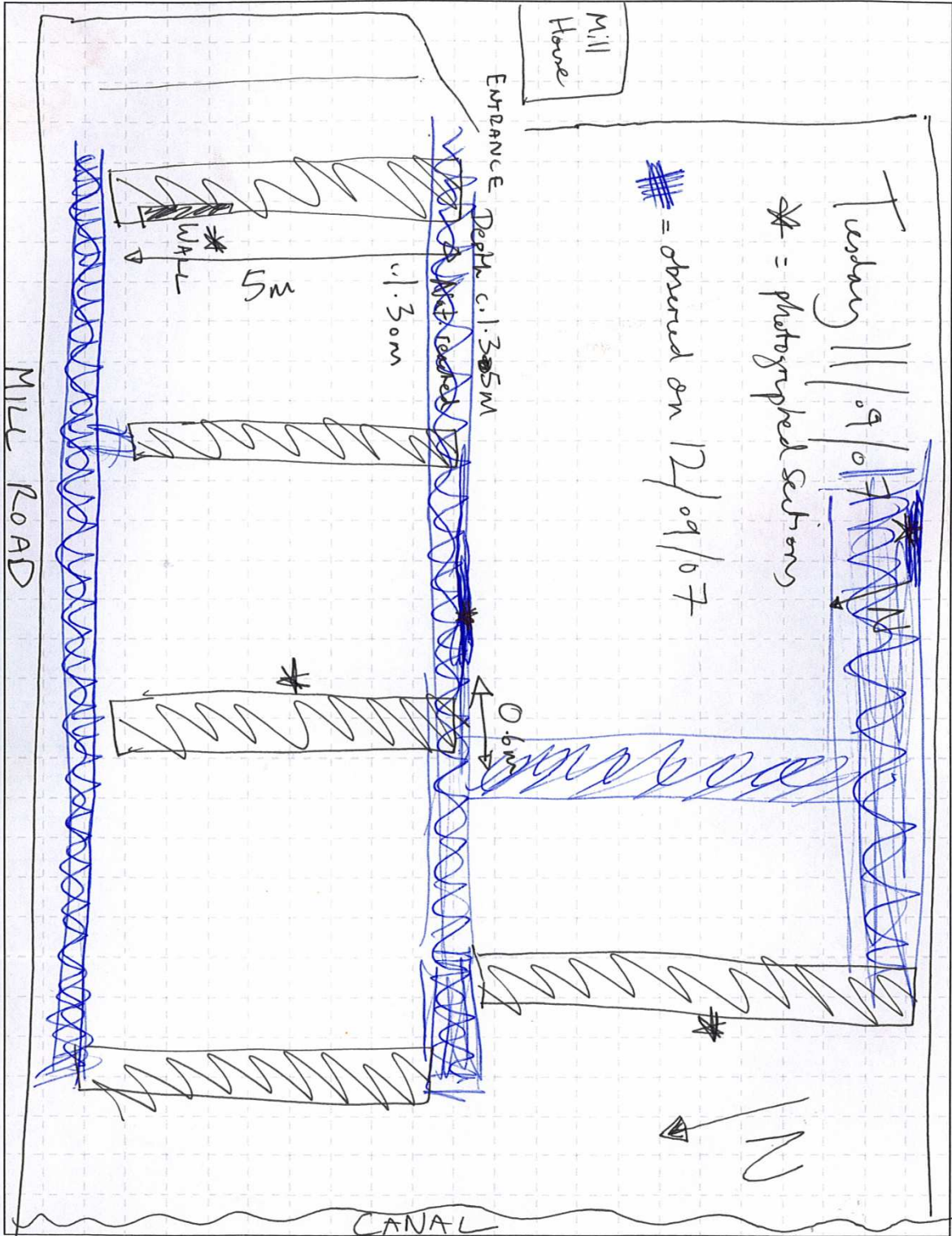

RECORDING NOTES

Recorded by: C1221E	Date: 11/09/07	Digitised by: —	Date: —	Sheet number: 1 of 1
---------------------	----------------	-----------------	---------	----------------------



A.S.C. LTD

ARCHAEOLOGICAL FIELD MONITORING RECORD

Project: Mill farm, Mill rd, Bletchley		Project No/Code: 971 1 BMF	Sheet: 1 of 1
Client/Developer SG Homes		Date of visit: 12/09/07	
Contact: Graham		Phone:	
Duration of Visit (inc. travel):	Start: 13.30	Finish: 15.07	
Completed by: LIZZIE GILL			
Development Type:			
Footings <input checked="" type="checkbox"/>	Services	Roads	Levelling
			Quarrying
			Pipelines
			Other (specify):
Site & weather conditions: Sunny + cloudy by turns			
Observations: All footings observed c. 0.96m deep although this does vary slightly across the site - towards the NE end of the site they are deeper at c. 1.35m. Natural geology of mid yellowish brown silty clay with frequent calcareous inclusions seen at the bottom of all footing trenches but stratum above this a mixture of redeposited red and mid brownish grey topsoil / subsoil with occ. inclusions of bricks from recently demolished buildings.			
Comments:			

For sketch plan, use reverse

©ASC, 2003

Appendix 2: List of Photographs

SITE NAME: Mill Farm, Mill Road, Water Eaton, Bletchley, Milton Keynes			SITE NO/CODE: 971/BMF
Shot	B&W	Digital	Subject
1			Looking NW towards Mill Farm House
2			E facing section of footing trench showing wall foundations of recently demolished building 1m scale
3			W facing section through footing trenches 1m scale
4			View NE across the footing trenches
5			E facing section showing more bricks from demolished buildings
6			View of the western end of the site and the large amount of bricks from the demolished buildings

Appendix 3: ASC OASIS Form

PROJECT DETAILS			
Project Name:	Mill Farm, Mill Road, Water Eaton, Bletchley, Milton Keynes		
Short Description:	<i>In September 2007 Archaeological Services and Consultancy Ltd. undertook a watching brief (ASC) on land adjacent to Mill Farm, Mill Lane, Bletchley, Milton Keynes in advance of the construction of a large detached property. Three visits were made to this site and all footing trenches were observed. No archaeological remains were found.</i>		
Project Type: (indicate all that apply)	Watching Brief		
Site status: (eg. none, SAM, Listed)	none	Previous work: (eg. SMR refs)	-
Current land use:	Wasteland	Future work: (yes / no / unknown)	-
Monument type:	-	Monument period:	-
Significant finds: (artefact type & period)	none		
PROJECT LOCATION			
County:	Buckinghamshire	OS reference: (8 figs min)	SP 8826 3294
District:	Bletchley	Parish:	Water Eaton
Site address: (with postcode if known)	Mill Farm, Mill Road, Water Eaton, Bletchley, Milton Keynes		
Study area: (sq. m. or ha)	c.30x40x115x20 sq.m	Height OD: (metres)	c.73m OD
PROJECT CREATORS			
Organisation:	Archaeological Services & Consultancy Ltd		
Project brief originator:	-	Project design originator:	-
Project Manager:	David Fell MA MIFA	Director/Supervisor:	Lizzie Gill BSc PgDip
Sponsor / funding body:			
PROJECT DATE			
Start date:	10/09/07	End date:	12/09/07
PROJECT ARCHIVES			
	Location (Accession no.)	Content (eg. pottery, animal bone, files/sheets)	
Physical:			
Paper:			
Digital:			
BIBLIOGRAPHY (Journal/monograph, published or forthcoming, or unpublished client report)			
Title:			
Serial title & volume:			
Author(s):			