

Archaeological Services & Consultancy Ltd

**WATCHING BRIEF:
3 FISHER ROAD
BISHOPS ITCHINGTON
SOUTHAM
WARWICKSHIRE**

NGR: SP 3893 5781

on behalf of Mr Simon Tagg-Wilkinson



J Richards BA PIFA

May 2008

ASC: 1074/BIF/2

Letchworth House
Chesney Wold, Bleak Hall,
Milton Keynes MK6 1NE
Tel: 01908 608989 Fax: 01908 605700
Email: office@archaeological-services.co.uk
Website: www.archaeological-services.co.uk



Site Data

<i>ASC project code:</i>	BIF	<i>ASC Project No:</i>	1074
<i>OASIS ref:</i>	TBA	<i>Event/Accession no:</i>	TBA
<i>County:</i>	Warwickshire		
<i>Village/Town:</i>	Bishops Itchington		
<i>Civil Parish:</i>	Bishops Itchington		
<i>NGR (to 8 figs):</i>	SP 3893 5781		
<i>Extent of site:</i>	c. 2034m ²		
<i>Present use:</i>	Residential		
<i>Planning proposal:</i>	New double garage		
<i>Planning application ref/date:</i>	07/01829/FUL		
<i>Local Planning Authority:</i>	Stratford-upon-Avon District Council		
<i>Date of fieldwork:</i>	13 th to 15 th May 2008		
<i>Client:</i>	Mr Simon Tagg-Wilkinson 3 Fisher Road, Bishops Itchington Southam Warwickshire CV47 2RE		
<i>Contact name:</i>	Mr Simon Tagg-Wilkinson		

Internal Quality Check

<i>Primary Author:</i>	J Richards BA PIFA	<i>Date:</i>	16 th May 2008
------------------------	--------------------	--------------	---------------------------

<i>Revisions:</i>		<i>Date:</i>	
-------------------	--	--------------	--

<i>Edited/Checked By:</i>		<i>Date:</i>	
---------------------------	--	--------------	--

© Archaeological Services & Consultancy Ltd

No part of this document is to be copied in any way without prior written consent.

Every effort is made to provide detailed and accurate information. However, Archaeological Services & Consultancy Ltd cannot be held responsible for errors or inaccuracies within this report.

© Ordnance Survey maps reproduced with the sanction of the Controller of Her Majesty's Stationery Office.
ASC Licence No. AL 100015154

CONTENTS

Summary.....	4
1. Introduction	4
2. Aims & Methods	8
3. Archaeological & Historical Background.....	9
4. Results.	11
5. Conclusions	14
6. Acknowledgements	15
7. Archive	15
8. References	16

Appendices:

1. ASC Watching Brief Monitoring Sheets	17
2. Photo List.....	20
3. ASC OASIS Form	21

Figures:

1. General location	3
2. Site plan	6
3. Proposed development.....	7
4. Sample section.....	11
5. OS 1 st edition	13

Plates:

Cover: Site from southeast

1. Section of footing trench	12
2. Footing trenches and footprint of new garage	12
3. New access	12



Figure 1: General location (Scale 1:25,000)

Summary

In May 2008 ASC Ltd carried out a watching brief at 3 Fisher Road, Bishop's Itchington, Warwickshire as a condition of planning permission for the construction of a new garage. No archaeological finds or features were observed during the watching brief and the impact of the development is considered to be low. The site appears to have always formed a parcel of land used for small-scale agriculture or market gardening.

1. Introduction

1.1 In May 2008 *Archaeological Services and Consultancy Ltd* (ASC) carried out a watching brief at 3 Fisher Road, Bishops Itchington, Warwickshire. The project was commissioned by Mr Simon Tagg-Wilkinson, and was carried out according to a brief (Stocks 2008) prepared on behalf of the local planning authority (LPA), *Stratford-upon-Avon District Council*, by their archaeological advisor (AA), the *Museum Service of Warwickshire County Council*, and a project design prepared by ASC. The relevant planning application reference is 07/01829/FUL.

1.2 *Planning Background*

This watching brief was required under the terms of *Planning Policy Guidance Note 16* (PPG16), as a condition of planning permission for the development of the site.

1.3 *Archaeological Services & Consultancy Ltd*

Archaeological Services & Consultancy Ltd (ASC) is an independent archaeological practice providing a full range of archaeological services including consultancy, field evaluation, mitigation and post-excavation studies, historic building recording and analysis. ASC is recognised as a *Registered Archaeological Organisation* by the Institute of Field Archaeologists, in recognition of its high standards and working practices.

1.4 *Management*

The assessment was managed by Karin Semmelmann BA MA AIFA, and was carried out under the overall direction of Bob Zeepvat BA MIFA.

1.5 *The Site*

1.5.1 *Location & Description*

The site is located in Bishops Itchington, in the administrative district of Stratford-upon-Avon, Warwickshire (Figure 1). It is situated in the centre of the village, on the north side of Fisher Road and is centred on National Grid Reference SP 3893 5781 (Figure 2). The site lies within the probable extent of the medieval settlement of Bishops Itchington (Warwickshire Historic Environment Record MWA 9046).

The site comprises a sub-rectangular area of land, currently occupied by a detached house and garden (Figure 2).

1.5.2 *Geology & Topography*

The soils of the area comprise the *Evesham 2 Association*, namely slowly permeable calcareous clayey soils (Soil Survey 1983, 411b). The underlying geology comprises Jurassic and Cretaceous Clay (BGS, Sheet 201).

The site lies at approximately 115m above Ordnance Datum and slopes gently downwards from northeast to southwest.

1.5.3 *Proposed Development*

The proposed development is for the construction of a new garage on the east side of the existing house (Figure 3).



Figure 2: Site plan (Scale 1:1250)

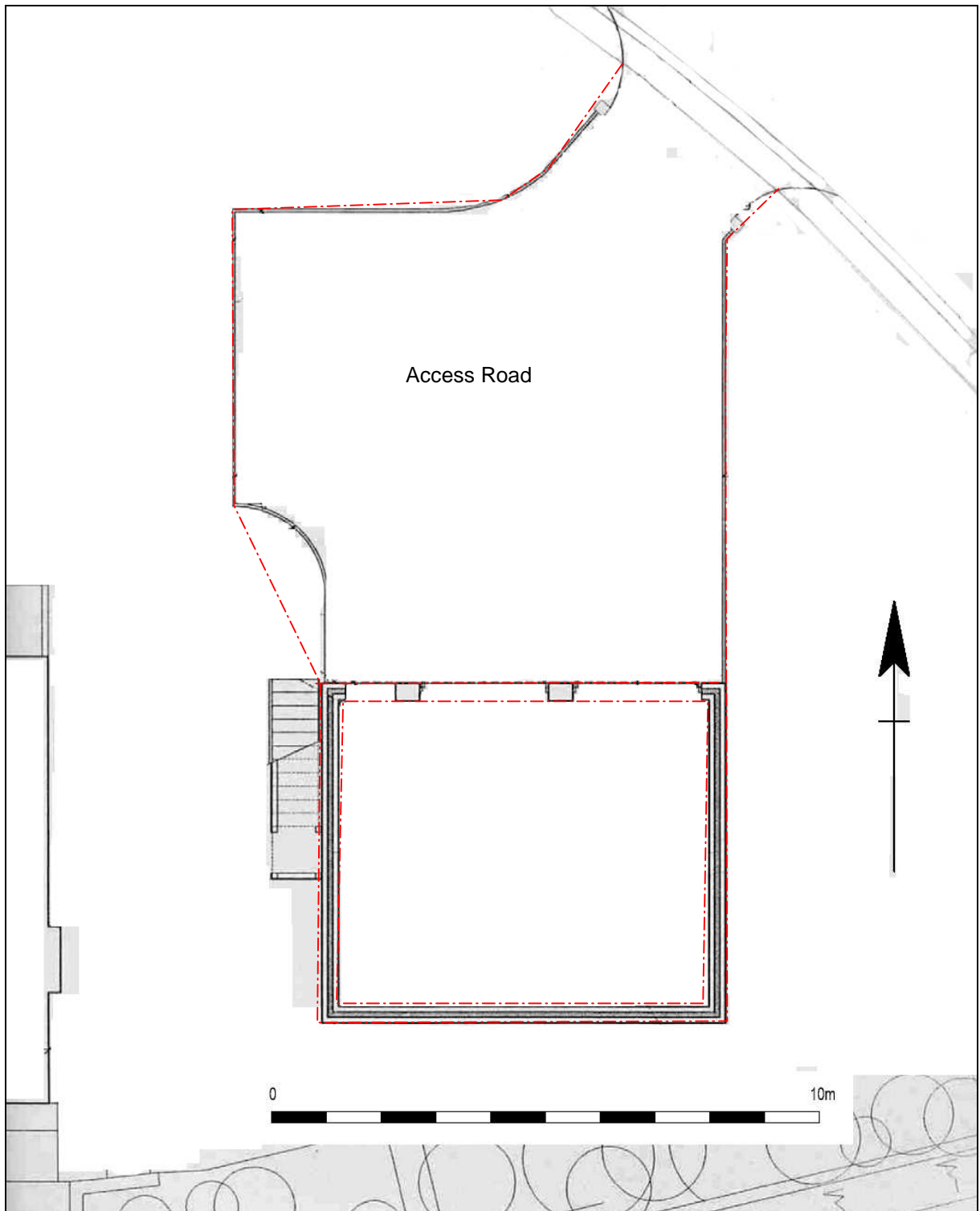

Figure 3: Proposed development, monitored areas shown in red (*Scale 1:100*)

2. Aims & Methods

2.1 Aims

As described in the brief (Section 3), the aims of the watching brief were:

- To obtain an adequate record of any archaeological deposits or finds disturbed or exposed by work associated with the development

2.2 Standards

The work conformed to the project design, to the relevant sections of the Institute of Archaeologists' *Code of Conduct* (IFA 2000) and *Standard & Guidance Notes* (IFA 2001), and to the relevant sections of ASC's own *Operations Manual*.

2.3 Methods

The work was carried out according to the brief (Sections 3 & 4), which required:

- Archaeological monitoring of all groundworks. Ground reduction within the footprint of the new building and for the new access was undertaken using a wide, toothless ditching bucket
- Investigation and recording of all archaeological contexts and artefacts disturbed or exposed
- A programme of sampling of appropriate materials for environmental or other scientific analysis.

2.4 Constraints

As no archaeological features were observed during the watching brief, no environmental sampling was carried out.

3. Archaeological & Historical Background

- 3.1 The following section provides a summary of the readily available archaeological and historical background to the development site and its environs. The site lies within an area of archaeological and historical interest, and has the potential to reveal evidence of a range of periods.

This section has been compiled with information from the Warwickshire Historic Environment Record (HER) and the Victoria History of the County of Warwick (Salzman 1951).

3.2 ***Prehistoric & Iron Age*** (before AD43)

Little is known of the area during the prehistoric periods. The only prehistoric activity recorded in the area is a group of three possible round barrows (burial mounds) c.2km southeast of the site (HER 806). These are located on a hill known locally as ‘coffin hill’.

3.3 ***Roman*** (AD43-c.450)

During the Roman period the area was some distance from the main centres of occupation, which was focused on the small town of Chesterton, 5km west of Bishops Itchington. Chesterton developed on a major Roman road, now known as the *Fosse Way* (OS 1979), which linked *Corinium* (Cirencester) with *Ratae* (Leicester). The only evidence of Roman activity in the village is a group of Roman coins discovered c.1km southwest of the site (Salzman 1951).

3.4 ***Saxon*** (c.450-1066)

Little is known of the early development of the village, which originated during the Saxon period. Bishops Itchington is mentioned in the Domesday survey (1086), where it is referred to as *Icetone*. The land was held by the Abbey of Coventry and was valued at £12 (Williams & Martin 2003, 653).

3.5 ***Medieval*** (1066-1500)

The village developed during the medieval period and was granted a market in 1259 (HER 9046; Slater 1997, fig. 57). The development site is in the medieval core of the village. The presence of earthworks on the west side of the village (HER 4929) suggests that the area of medieval settlement extended further to the west and that the settlement subsequently contracted. A second shrunken settlement is present c.1km south of the site, centred on Old Town Farm (HER 6181) where a number of earthworks are interpreted as medieval or post-medieval fishponds (HER 6183). Areas of medieval ridge and furrow cultivation strips are present in the fields surrounding the village.

3.6 ***Post-Medieval & Modern*** (1500-present)

The present street layout of the village had largely been established by the early 19th century. The first edition Ordnance Survey map shows the High Street and Fisher Road, but Station Road was constructed later in the 19th century, to provide access to the railway station, which was situated north of the village.

The site is situated *c.*100m northeast of the village church (HER 623). A church is known to have stood on the site since the medieval period but the current church was constructed in 1872 to a design by Ewan Christian (Pevsner & Wedgewood 2003, 214). It is a Grade II Listed Building.

4. Results

- 4.1 Between 13th and 15th May 2008 three visits were made to monitor the groundworks for a new double garage and associated access.
- 4.2 Footing trenches were excavated to a depth of between 1m and 1.50m below the existing ground level. The ground within the footprint of the new garage was reduced by up to 0.30m using a toothless bucket. The hedge was removed using a toothed bucket and the ground level for the new access was reduced by up to 0.25m with a toothless bucket.
- 4.3 Dark brownish black silty clay topsoil overlay the site to a depth of up to 0.50m. Below this was mid yellowish brown silty clay subsoil with occasional inclusions of large, roughly shaped sandstone and smaller blue lias boulders, concentrated in the southeast corner of the footing trench. The natural strata, stiff mid yellowish brown clay, was observed at a depth of 1m below existing ground level (Fig. 4).
- 4.4 Fragments of glazed pottery of probable 18th century date were observed in the topsoil, and the client reports frequently finding clay pipe stems whilst gardening. No other archaeological finds or features were observed during the watching brief.
- 4.5 A tree in the southeast corner of the site had caused minimal ground disturbance and its roots did not extend beyond the topsoil. The hedge boundary to the northeast of the site had also caused minimal ground disturbance within the topsoil.

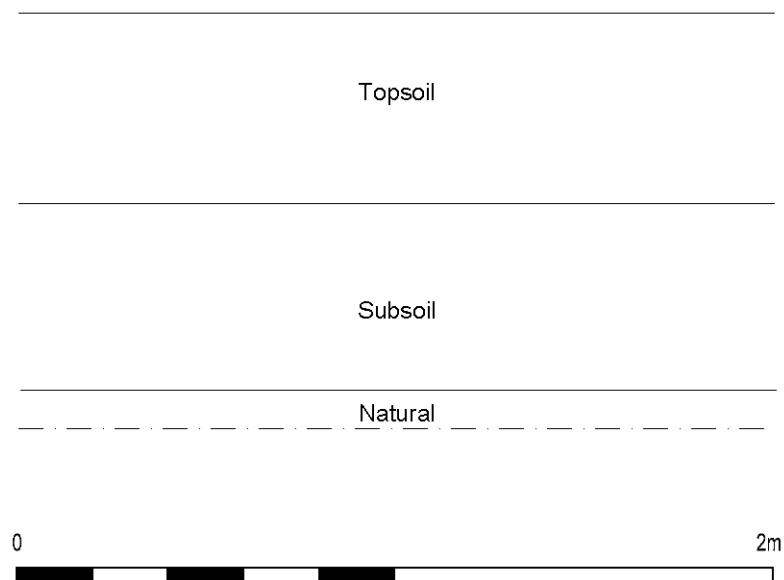

Figure 4: Sample section of footing trench (*Scale 1:20*)



Plate 1: South facing section of southern footing trench



Plate 2: Footing trenches and footprint of new garage



Plate 3: New access

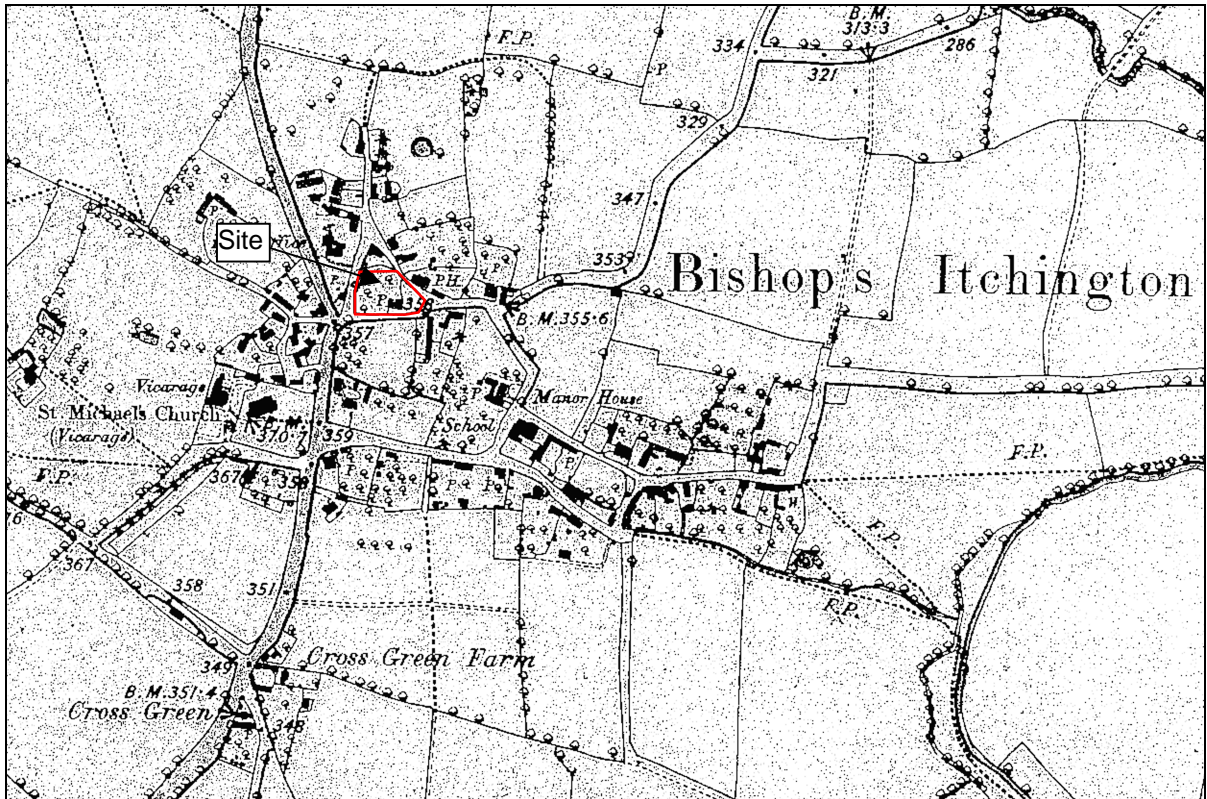

Figure 5: OS 1st edition 1886 (Scale 1:10,560)

5. Conclusions

- 5.1 No structured archaeological work had previously been carried out in Bishop's Itchington. This watching brief therefore provided an opportunity to investigate the history of the village.
- 5.2 The existing building on the development site is one of the earliest buildings in Bishop's Itchington. Information supplied by the client indicates that the house may be timber-framed, it could therefore be of medieval or post-medieval date. The existing building is shown on the 1st edition Ordnance Survey map of 1886 (Fig. 5).
- 5.3 No archaeological features were observed during the watching brief and the only archaeological finds were occasional fragments of pottery in the topsoil. These fragments of pottery were glazed and clearly of 18th or 19th century date.
- 5.4 The site appears to have always formed part of the garden of 3 Fisher Road, also known as Fern House. The house may have medieval origins although it is equally likely to be later.
- 5.5 *Confidence Rating*
The excavation of footing trenches for the new garage and ground reduction for both the garage and the new access were monitored. Weather conditions were favourable and no factors hindered the watching brief. A high confidence rating is therefore attached to the results.

6. Acknowledgements

The evaluation was commissioned by Mr Simon Tagg-Wilkinson; the writer is grateful for his assistance. The project was monitored by Anna Stocks of the *Warwickshire Museum Service* on behalf of the local planning authority.

The project was managed for ASC by Karin Semmelmann BA MA AIFA. Fieldwork was carried out by Jenny Richards BA PIFA. The report was prepared by Jenny Richards and edited by Bob Zeepvat BA MIFA.

7. Archive

7.1 The project archive will comprise:

1. Brief
2. Project Design
3. Initial Report
4. Clients site plans
5. Site Monitoring Sheets
6. List of photographs
7. B/W prints & negatives
8. CDROM with copies of all digital files.

7.2 The archive will be deposited with *Warwickshire Museum Service*.

8. References

Standards & Specifications

- EH 1991 *The Management of Archaeological Projects*, 2nd edition. English Heritage (London).
- IFA 2000a Institute of Field Archaeologists' *Code of Conduct*.
- IFA 2000b Institute of Field Archaeologists' *Code of Approved Practice for the Regulation of Contractual Arrangements in Field Archaeology*.
- IFA 2001 Institute of Field Archaeologists' *Standard & Guidance documents (Desk-Based Assessments, Watching Briefs, Evaluations, Excavations, Investigation and Recording of Standing Buildings, Finds)*.
- Richards, J. 2008 *Project Design for Archaeological Watching Brief at 3 Fisher Road, Bishops Itchington, Warwickshire* (ASC Ltd)
- Stocks, A. 2008 *Brief for Archaeological Work, 3 Fisher Road, Bishops Itchington* (Warwickshire Museum)

Secondary Sources

- Beresford, M. W. 1946 "The Deserted Villages of Warwickshire" in *Birmingham Archaeological Society Transactions and Proceedings* **66** (Oxford)
- BGS *British Geological Survey 1:50,000 Series, Solid & Drift Geology*.
- Salzman, L. F. 1951 *The Victoria History of the County of Warwick* **6** (London)
- Soil Survey 1983 *1:250,000 Soil Map of England and Wales, and accompanying legend* (Harpenden).
- Ordnance Survey 1886 *1st edition 6" to 1 mile sheet 40SW*
- Ordnance Survey 1979 *Ordnance Survey Map of Roman Britain*. Ordnance Survey
- Pevsner N & Wedgewood A, 2003 *The Buildings of England: Warwickshire*. Yale University Press
- Slater, T. 1997 *A History of Warwickshire*. Darwen County History Series. Phillimore
- Williams A & Martin G H (eds) 2003 *Domesday Book. A Complete Translation*. Penguin

Appendix 1: Monitoring Sheets

A.S.C. LTD		ARCHAEOLOGICAL FIELD MONITORING RECORD				
Project: 3 FISHER ROAD, BISHOPS ITCHINGTON		Project No/Code: 1074 / BIF		Sheet: of		
Client/Developer SIMON TAYLOR - WILKINSON.		Date of visit: 18/05/08.				
Contact:			Phone:			
Duration of Visit (inc. travel):	Start: 8:00	Finish: 15:00.				
Completed by: SR						
Development Type:						
Footings <input checked="" type="checkbox"/>	Services	Roads	Levelling <input checked="" type="checkbox"/>	Quarrying	Pipelines	Other (specify):
Site & weather conditions: GARDEN, SUNNY AND DRY.						
Observations:						
EASTERN AND SOUTHERN FOOTINGS & TRENCHES EXCAVATED WITH 0.60M WIDE TOOTHED BUCKET TO DEPTH OF BETWEEN 1m AND 1.50m.						
SOME ROOT DISTURBANCE BY TREE IN SE CORNER WITHIN TOPSOIL.						
TOPSOIL 400-500mm THICK, BLACK SILTY CLAY, FRIABLE, KINDS OF CLAY PIPE STEMS AND POST MED POTTERY REPORTED BY CLIENT (FOUND WHILE GARDENING)						
SUBSOIL 500mm THICK, MID YELLOWISH BROWN SILTY CLAY, SOME STONE RUBBLE (50-300mm SIZE) TO SE CORNER, C18 POTTERY (DRIP SLIP); FRIABLE.						
NATURAL: MID YELLOWISH BROWN CLAY, STIFF.						
Comments:						
GROUNDWORKS CONTINUING TOMORROW, FURTHER VISITS NEEDED.						

For sketch plan, use separate sheet

©ASC 2007



A.S.C. LTD

ARCHAEOLOGICAL FIELD MONITORING RECORD

Project: 3 FISHER RD, BISHOPS ITCHINGTON		Project No/Code: 1074 BIF.	Sheet: of
		Date of visit: 14/05/08.	
Client/Developer SIMON TAYLOR-WILKINSON.			
Contact:		Phone:	
Duration of Visit (inc. travel):	Start: 13:00	Finish: 15:30.	
Completed by: JR			
Development Type:			
Footings <input checked="" type="checkbox"/>	Services	Roads	Levelling <input checked="" type="checkbox"/>
			Quarrying
			Pipelines
			Other (specify):
Site & weather conditions: DBY, SUNNY; GARDEN.			
Observations: WEST FOOTING TRENCH HAS BEEN EXCAVATED. GROUND REDUCTION WITHIN FOOTPRINT OF GARAGE WITH TOOTHLESS BUCKET TO DEPTH OF c.0.20M BELOW EXISTING GROUND LEVEL - WITHIN TOPSOIL. DUE TO FLOOR DESIGN. NO ARCHAEOLOGICAL FINDS OR FEATURES OBSERVED. GROUNDWORKS CONTINUING TOMORROW.			
Comments: FURTHER VISITS NECESSARY.			

For sketch plan, use separate sheet

©ASC 2007



A.S.C. LTD

ARCHAEOLOGICAL FIELD MONITORING RECORD

Project: 3 FISHER ROAD, BISHOPS ITCHINGTON		Project No/Code: 1074/BIF	Sheet: of
		Date of visit: 15/05/08.	
Client/Developer MR SIMON TAYLOR-WILKINSON.			
Contact:		Phone:	
Duration of Visit (inc. travel):	Start: 13:45	Finish: 17:10.	
Completed by: JL			
Development Type:			
Footings <input checked="" type="checkbox"/>	Services	Roads	Levelling <input checked="" type="checkbox"/>
			Quarrying
			Pipelines
			Other (specify):
Site & weather conditions: GARDEN; RAINING.			
Observations:			
FOOTING TRENCHES COMPLETED, AS IS GROUND REDUCTION WITHIN FOOTPRINT (TO DEPTH OF 0.30m BELOW EXISTING GROUND LEVEL - STILL IN TOPSOIL)			
HEDGE REMOVED FROM NE BOUNDARY FOR NEW ACCESS, GROUND REDUCTION OF DRIVEWAY TO 0.25m BELOW EXISTING (MAX).			
NO ARCHAEOLOGICAL FINDS OR FEATURES OBSERVED.			
Comments:			
NO FURTHER VISITS NECESSARY.			

For sketch plan, use separate sheet

©ASC 2007

Appendix 2: List of Photographs

SITE NAME: 3 Fisher Road, Bishops Itchington			SITE NO/CODE: 1074/BIF
Shot	B&W	Digital	Subject
1	✓	✓	View of footings from SW
2		✓	View of W footing trench from S
3		✓	View of S footing trench from W
4		✓	View of E footing trench from S
5		✓	View of E footing trench from N
6		✓	View of S footing trench from E
7	✓	✓	S facing section of footing trench
8	✓	✓	View of new access from SE
9	✓	✓	View of footings from NE
10	✓	✓	New access from E

Appendix 3: ASC OASIS Form

PROJECT DETAILS			
Project Name:	3 Fisher Road, Bishops Itchington		
Short Description:	In May 2008 ASC Ltd carried out a watching brief at 3 Fisher Road, Bishop's Itchington, Warwickshire as a condition of planning permission for the construction of a new garage. No archaeological finds or features were observed during the watching brief and the impact of the development is considered to be low. The site appears to have always formed a parcel of land used for small-scale agriculture or market gardening.		
Project Type: (indicate all that apply)	Watching Brief		
Site status: (eg. none, SAM, Listed)	None	Previous work: (eg. SMR refs)	None
Current land use:	Residential	Future work: (yes / no / unknown)	Unknown
Monument type:	None	Monument period:	None
Significant finds: (artefact type & period)	None		
PROJECT LOCATION			
County:	Warwickshire	OS reference: (8 figs min)	SP 3893 5781
District:	Stratford-upon-Avon	Parish:	Bishops Itchington
Site address: (with postcode if known)	3 Fisher Road, Bishops Itchington, Southam, Warwickshire		
Study area: (sq. m. or ha)	c. 2034 sq. m.	Height OD: (metres)	c. 115
PROJECT CREATORS			
Organisation:	Archaeological Services & Consultancy Ltd		
Project brief originator:	A Stocks	Project design originator:	J Richards
Project Manager:	K Semmelmann	Director/Supervisor:	J Richards
Sponsor / funding body:	Mr Simon Tagg-Wilkinson		
PROJECT DATE			
Start date:	13 th May 2008	End date:	15 th May 2008
PROJECT ARCHIVES			
	Location (Accession no.)	Content (eg. pottery, animal bone, files/sheets)	
Physical:	N/A	N/A	
Paper:	Warwickshire Museum	Site records, Project Design, Report, Clients plans, B&W photos and negatives	
Digital:	Warwickshire Museum	CDRom with copies of all digital files	
BIBLIOGRAPHY (Journal/monograph, published or forthcoming, or unpublished client report)			
Title:	Watching Brief: 3 Fisher Road, Bishops Itchington, Southam, Warwickshire		
Serial title & volume:	ASC Ltd Report ref. 1074/BIF/2		
Author(s):	J Richards BA PIFA		
Page nos	21	Date:	16 th May 2008