

Archaeological Services & Consultancy Ltd

**WATCHING BRIEF:
CORNER OF OXFORD ROAD AND UNION STREET
LUTON
BEDFORDSHIRE**

on behalf of Hill Partnerships (Western) Ltd



J Richards BA PIFA

August 2007

ASC: 973/LOR/2

Letchworth House
Chesney Wold, Bleak Hall,
Milton Keynes MK6 1NE
Tel: 01908 608989 Fax: 01908 605700
Email: office@archaeological-services.co.uk
Website: www.archaeological-services.co.uk



Site Data

<i>ASC project code:</i>	LOR	<i>ASC Project No:</i>	973
<i>Event No:</i>	N/A	<i>Accession No:</i>	2007/111
<i>County:</i>	Bedfordshire		
<i>Village/Town:</i>	Luton		
<i>Civil Parish:</i>	Unparished		
<i>NGR (to 8 figs):</i>	TL 0925 2088		
<i>Present use:</i>	Residential		
<i>Planning proposal:</i>	Residential		
<i>Planning application ref/date:</i>	06/1226/FUL		
<i>Local Planning Authority:</i>	Luton Borough Council		
<i>Date of fieldwork:</i>	Between 30 th July and 31 st August 2007		
<i>Client:</i>	Hill Partnerships (Western) Ltd. Unit 2 Osprey House Trinity Business Park Chingford, E4 8TD		
<i>Contact name:</i>	Mr Patrick Connolly		

Internal Quality Check

<i>Primary Author:</i>	J Richards BA PIFA	<i>Date:</i>	11 th September 2007
------------------------	--------------------	--------------	---------------------------------

<i>Revisions:</i>		<i>Date:</i>	
-------------------	--	--------------	--

<i>Edited/Checked By:</i>		<i>Date:</i>	
---------------------------	--	--------------	--

© Archaeological Services & Consultancy Ltd

No part of this document is to be copied in any way without prior written consent.

Every effort is made to provide detailed and accurate information. However, Archaeological Services & Consultancy Ltd cannot be held responsible for errors or inaccuracies within this report.

© Ordnance Survey maps reproduced with the sanction of the Controller of Her Majesty's Stationery Office.

ASC Licence No. AL 100015154

CONTENTS

Summary	4
1. Introduction	4
2. Aims & Methods	6
3. Archaeological & Historical Background	8
4. Results	10
5. Conclusions	14
6. Acknowledgements	15
7. Archive	15
8. References	16

Appendices:

1. ASC Watching Brief Monitoring Sheets.....	17
2. Photo List.....	30
3. ASC OASIS Form.....	31

Figures:

1. General location	3
2. Site plan.....	5
3. Proposed development	7
4. Site plan showing location of cellars and wells.....	11

Plates:

Cover: overview of site from south east

1. Cellar on Oxford Road.....	12
2. Probable well	12
3. Typical test pit section	12
4. Brick lined well	13
5. Cellars along Union Street.....	13

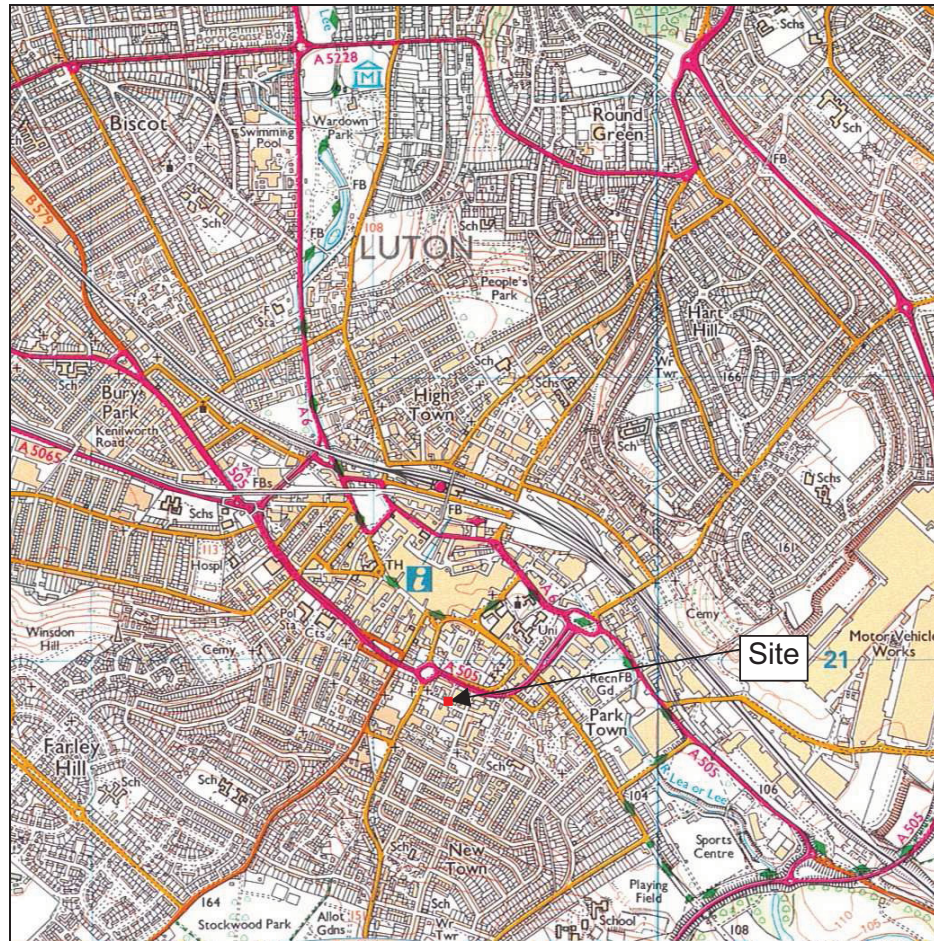

Figure 1: General location (scale 1:25,000)

Summary

During August 2007 Archaeological Services and Consultancy Ltd conducted a watching brief at a site on the corner of Oxford Road and Union Street, Luton, on behalf of Hill Partnership (Western) Ltd, during ground reduction, and the excavation of test pits for piled foundations, and drainage trenches. Cellars dating to the late 19th or early 20th century, along with two associated wells were observed. No finds or features pre-dating the 19th century were observed.

1 Introduction

1.1 In August 2007 *Archaeological Services and Consultancy Ltd* (ASC) carried out a watching brief at the corner of Oxford Road and Union Street, Luton (NGR TL 0925 2088: Fig. 1). The project was commissioned by Hill Partnerships (Western) Ltd, and was carried out according to a brief prepared on behalf of the local planning authority (LPA), *Luton Borough Council*, by their archaeological advisor (AA), *Bedfordshire County Council*, and a project design prepared by ASC. The relevant planning application reference is 06/1226/FUL.

1.2 *Planning Background*

This watching brief has been required as a planning condition under the terms of *Planning Policy Guidance Note 16* (PPG16), in response to proposals for the construction of two blocks of flats.

1.3 *Location and description*

The proposed development is located within an existing housing development to the south of Luton town centre. It is centred on OS Grid Reference TL 0925 2088 and has an approximate area of 1700 square metres (Fig. 2). It is situated at the junction of Oxford Road and Union Street, on the east side of Castle Street, and was previously occupied by houses constructed in the late 19th or early 20th century.

1.4 *Geology & Topography*

The application area is situated on a valley side overlooking the River Lea at an average height of c.117m AOD. The area has been extensively disturbed and urbanised and the natural soils are unlikely to survive. If a natural soil profile remains, it is probable that it would comprise soils of the Batcombe Association, consisting of “*fine silty over clayey and fine loamy over clayey soils...some well drained clayey soils over chalk*”. The underlying geology is made up of plateau drift and of clay with flints (Soil Survey 1983; 582a).

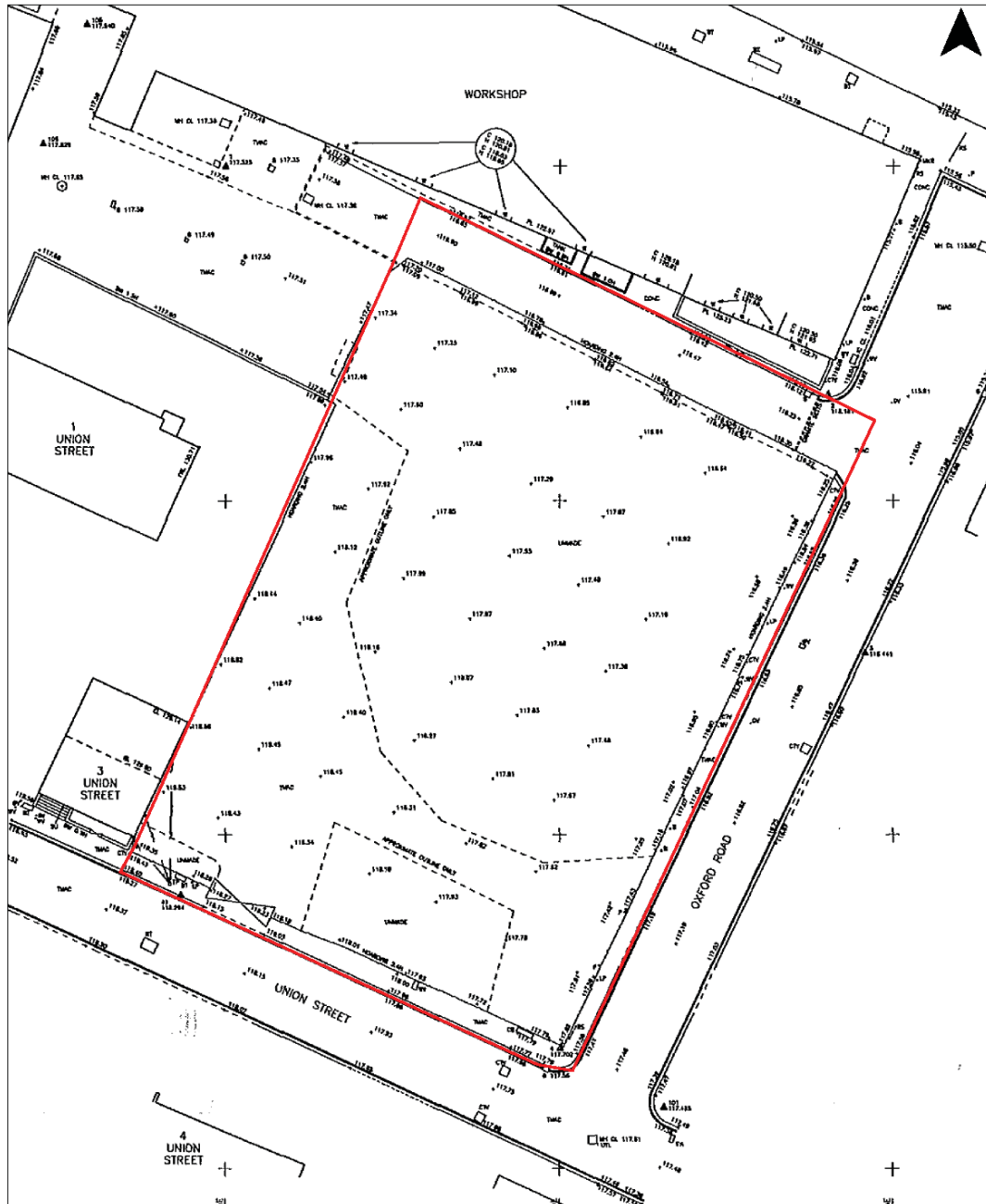

Figure 2: Site location (1:500)

2 Aims & Methods

2.1 Aims

As described in the brief (Section 4.3), the aims of the watching brief were:

- To establish the date, nature and extent of activity or occupation in the development site
- To establish the relationship of any remains found to the surrounding contemporary landscapes
- To recover artefacts to assist in the development of type series within the region
- To recover palaeo-environmental remains to determine local environmental conditions

2.2 Standards

The work will conform to the requirements of the *brief*, to the relevant sections of the Institute of Archaeologists' *Standard & Guidance Notes* (IFA 2001) and *Code of Conduct* (IFA 2000a), to current English Heritage guidelines (EH 1991), to *Standards for Field Archaeology in the East of England* (Gurney 2003), and to the relevant sections of ASC's own *Operations Manual*.

2.3 Methods

The work was carried out according to the brief (Section 5), which required:

- An intensive watching brief requiring the presence of a suitably qualified archaeologist during any intrusive groundworks or ground reduction.
- If archaeological features or deposits were encountered they would be investigated and recorded.
- The relationship between archaeological features and deposits would be investigated and recorded.
- Sampling for retrieval of environmental, organic and artefactual material would be carried out during excavation of features and deposits.
- Provision was made for delays caused by the need for archaeological recording and a contingency allowance made for more detailed recording of exceptional finds. The AA was to be consulted before any contingency allowance was deployed.



Figure 3: Proposed development (client's plan) 1:500

3 Archaeological & Historical Background

- 3.1 Luton is an area of considerable archaeological and historical importance. This has been defined in the *Luton Extensive Archaeological Urban Survey* (Albion Archaeology 2004). Unlike the neighbouring town of Dunstable, there has been little archaeological investigation in Luton, and in consequence the archaeology of Luton is not well understood.
- 3.2 Luton is situated in the valley of the River Lea. River valleys in the wider Bedfordshire area are known to have attracted settlement during the later prehistoric periods. A small number of prehistoric occupation sites are recorded at this type of location in the Luton area (Holgate 1995).
- 3.3 An important archaeological site known as *Waulud's Bank*, lies c.3km to the north of the site. Excavation revealed evidence of Neolithic and Iron Age occupation (Dyer 1964). A further prehistoric site known as Galley Hill lies c.5km north of Luton town centre. Evidence for Neolithic occupation and round barrows (prehistoric burial mounds) was recorded (Dyer 1974). A further group of barrows known as the Five Knolls are located c.7km to the west of the site, above the Icknield Way, a suggested prehistoric trackway leading from southwest England to East Anglia.
- 3.4 The extent of Roman activity in the area of the development is unclear. The small Roman town of *Durocobrivis* (Dunstable) was located c.5km west of the site and is likely to have formed the major settlement in this area (Matthews 1989). Disparate Roman finds are recorded in Luton town centre: a kiln (HER 205) was discovered on the site of the Arndale Centre, a quern (HER 1979) was recorded c.1km southeast of the site, and a number of Roman coins and other artefacts (HER 1516, 1977, 15236, 1981, etc.) have been found in the vicinity of the site.
- 3.5 The origin and early development of Saxon and medieval Luton is not understood in detail. It is possible that a settlement developed adjacent to the river in the area of the present modern town centre during the Saxon period (HER 16993). The town was mentioned in the Domesday Survey (1086) and was held by the king (Williams & Martin 2003, 563).
- 3.6 The development is located north of the remains of a castle built in 1139 AD by Robert de Waudari (HER 186). The fortification is likely to have been built of timber atop a motte with an associated bailey, the structure was extant for only 15 years. A second castle was built north of the site of the original fortification in 1221 AD by Fulk de Breauté (Coles 2004). The memory of the castles is perpetuated in the names Castle Street and Castle Close.
- 3.7 Recent work c.200m southwest of the development have revealed a substantial ditch, which was interpreted as being part of the ditch surrounding the bailey of the original castle (Coles 2004). Further remains of a substantial ditch were recently identified during work at a former University of Luton building located c.100m southwest of the development area (Albion Archaeology 2005). This investigation indicated that the ditch may extend into the area affected by the proposed development.

- 3.8 Luton is extensively urbanised and is, in the main, an industrial town. The site lies south of the modern commercial centre and the present houses on the site probably date from the late 19th or early 20th centuries.

4 Results

- 4.1 Ground reduction was monitored, as were the test pits for pile foundations and the excavation of drainage trenches. In total eleven visits were made between 30th July and 31st August 2007.
- 4.2 Cellars were noted along the frontages of Oxford Road and Union Street. These extended 3.5m back from the street frontages, and were constructed of bricks. They had been backfilled with demolition rubble from the buildings above, including bricks, corroded iron, glass and plastic items. The cellars were cut into the natural strata of yellow sand at a depth of 1.5m below current ground level. Some of the cellars had concrete floors; others had no observable floor.
- 4.3 A well, constructed of frogged bricks, produced after 1850, was noted in the centre of the site, and a second probable well, of apparently earlier date was noted 2 metres to the south west of this. The fill of this earlier well included some large fragments of brick.
- 4.4 No archaeological finds or features pre-dating the 19th century were observed.

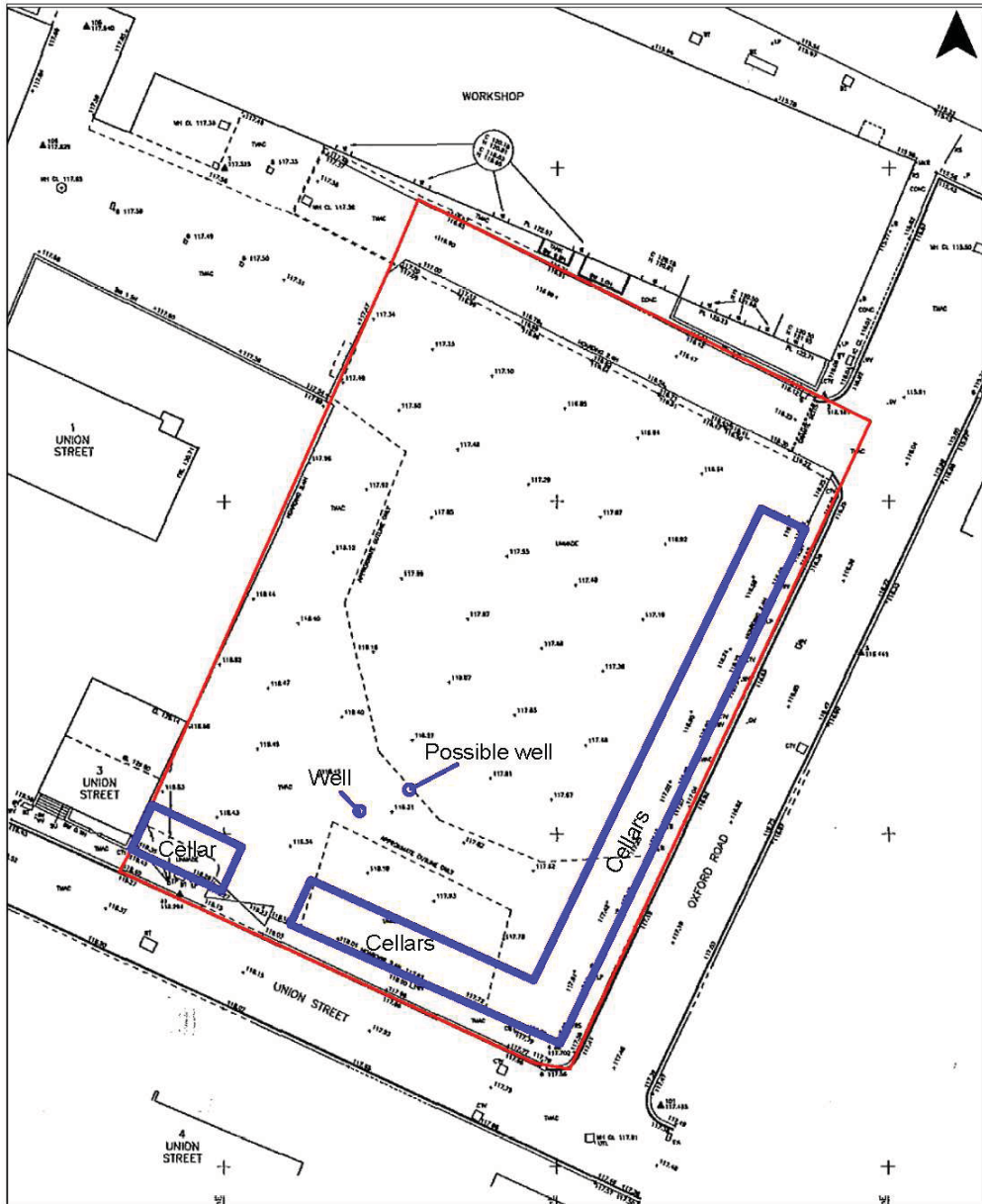

Figure 4: site plan showing location of cellars and wells



Plate 1: cellar along Oxford Road



Plate 2: probable well



Plate 3: typical test pit section



Plate 4: Brick lined well



Plate 5: cellars along Union Street

5. Conclusions

- 5.1 Although this site is situated close to two sites where archaeological remains of medieval date have been observed, no archaeological remains predating the 19th century were observed during this watching brief.
- 5.2 Cellars relating to earlier buildings on Union Street and Oxford Road were observed. These were constructed of brick, and had been backfilled with demolition rubble (bricks, metal, glass and plastics). The cellars on the site extended 3.5 m back from the street frontages. Also noted was a well, also constructed of frogged bricks. This is likely to have been associated with the houses. A second probable well, predating this was also noted, 2m to the south west of the brick lined well. This had been backfilled with material including large fragments of brick.
- 5.3 It is likely that any earlier archaeological remains on this site were impacted upon by the construction of the houses in the late 19th to early 20th century.
- 5.4 Full co-operation was received from Hill Partnerships (Western) Ltd, site conditions were good, and a high confidence rating is therefore attached to the results of this watching brief.

6. Acknowledgements

- 6.1 The writer is grateful to Hill Partnerships (Western) Ltd, for commissioning this work, their contractors and ground workers for their co-operation, and to Martin Oake of Bedfordshire County Council for curatorial advice.
- 6.2 Fieldwork was carried out by J Richards, C Rouse and A Hancock; the report was written by J Richards and edited by Bob Zeepvat BA MIFA.

7. Archive

- 7.1 The project archive will comprise:
1. Brief
 2. Project Design
 3. Initial Report
 4. Clients site plans
 5. Site Monitoring Sheets
 6. List of photographs
 7. B/W prints & negatives
 8. CDROM with copies of all digital files.
- 7.2 The archive will be deposited with Luton Museum, under accession number 2007/111.

8. References

Standards & Specifications

- ALGAO 2003 *Standards for Field Archaeology in the East of England*. East Anglian Archaeology Occasional Paper 14.
- EH 1991 *The Management of Archaeological Projects*, 2nd edition. English Heritage (London).
- Hancock, A. J. 2007 Project Design for Watching Brief at Oxford Road, Union Street, Luton, on behalf of Hill Partnerships (Western) Ltd (ASC Ltd).
- IFA 2000a Institute of Field Archaeologists' *Code of Conduct*.
- IFA 2000b Institute of Field Archaeologists' *Code of Approved Practice for the Regulation of Contractual Arrangements in Field Archaeology*.
- IFA 2001 Institute of Field Archaeologists' *Standard & Guidance documents (Desk-Based Assessments, Watching Briefs, Evaluations, Excavations, Investigation and Recording of Standing Buildings, Finds)*.
- Mather L-A 2007 *Brief for a Programme of Archaeological Observation, Investigation, Recording, Analysis and Publication at the corner of Oxford Road and Union Street, Luton, Bedfordshire* Bedfordshire County Council

Secondary Sources

- Albion Archaeology 2004 *Luton Extensive Archaeological Urban Survey* Bedfordshire County Council
- Albion Archaeology 2005 *Land at Castle Street/Holly Street, Luton: Assessment of Potential and Updated Project Design* Albion Archaeology Report 2005/35
- Coles, S 2004 "Excavation at Castle Street Luton: The site of Robert de Waudari's castle?" *Bedfordshire Archaeology* 25 pp201-207
- Dyer, J F 1964 "A Secondary Neolithic Camp at Waulud's Bank, Leagrave" *Bedfordshire Archaeological Journal* 2 pp1-15
- Dyer J F 1974 "The excavation of two barrows on Galley Hill, Streatley" *Bedfordshire Archaeological Journal* 9 pp13-34
- Holgate, R (ed.) 1995 *Chiltern Archaeology Recent Work: A Handbook for the Next Decade* The Book Castle Dunstable
- Matthews, C L 1989 *Ancient Dunstable. A Prehistory of the District* Manshead Archaeological Society
- Soil Survey 1983 *1:250,000 Soil Map of England and Wales, and accompanying legend* (Harpenden).
- Williams A & Martin G H (eds.) 2003 *Domesday Book: A Complete Translation* Penguin

Appendix 1: Monitoring Sheets

 A.S.C. LTD		ARCHAEOLOGICAL FIELD MONITORING RECORD				
Project: CORNER OF UNION ST AND OXFORD ROAD, LUTON		Project No/Code: 973 1 LOR		Sheet: 1 of 1		
Client/Developer HILL PARTNERSHIPS		Date of visit: 30/7/07				
Contact: DAVE NORCROSS (SITE MANAGER)		Phone: 07966 121172				
Duration of Visit (inc. travel):	Start: 9.00	Finish: 11.30				
Completed by: AJW						
Development Type:						
<input checked="" type="checkbox"/> Footings	<input type="checkbox"/> Services	<input type="checkbox"/> Roads	<input checked="" type="checkbox"/> Levelling	<input type="checkbox"/> Quarrying	<input type="checkbox"/> Pipelines	<input type="checkbox"/> Other (specify):
Site & weather conditions: URBAN WASTE GROUND SUNNY WARM						
Observations: SITE MEETING WITH SITE MANAGER. HAVE BROKEN SOME ASPHALT AND STRIPPED VEGETATION AND SOME TOPSOIL - NOT PENETRATED BELOW DEMOLITION/LEVELLING. RUBBLE OF (20 DATE). WORK WILL NOT PROCEED UNTIL APPROVAL RECEIVED FOR WATCHING BRIEF PROJECT DESIGN						
Comments: CONTACT MARTIN OAKE TO ENQUIRE ABOUT PROGRESS OF APPROVAL OF PD.						

For sketch plan, use reverse

©ASC, 2003



A.S.C. LTD

ARCHAEOLOGICAL FIELD MONITORING RECORD

Project: CORNER OXFORD RD AND UNION ST LUTON		Project No/Code: 973 / LOR	Sheet: 1 of
Client/Developer HILL PARTNERSHIPS		Date of visit: 07/08/07	
Contact: DAE NORCROSS (SITE MANAGER)	Phone:		
Duration of Visit (inc. travel):	Start: 9.00	Finish: 16.00	
Completed by: ASH			
Development Type:			
<input checked="" type="checkbox"/> Footings	<input type="checkbox"/> Services	<input type="checkbox"/> Roads	<input checked="" type="checkbox"/> Levelling
		<input type="checkbox"/> Quarrying	<input type="checkbox"/> Pipelines
Other (specify):			
Site & weather conditions: DISUSED WABAN SUNNY WARM			
Observations: START OF GROUNDWORKS. LEVELLING AREA AT NE OF SITE TO MAXIMUM DEPTH OF c. 1.2M AT SOUTH. STILL IN MADE GROUND AT NORTHERN THIRTY METERS - MODERN - CONTAINS BRICK, PLASTIC CORRODED FERROUS ETC. SURFACE OF NATURAL CLAY WITH FLINT (MID YELLOWISH BROWN, SLIGHTLY LOAMY) REVEALED ACROSS REST OF AREA. SOME AREAS OF BRICK FOUNDATION, ONE SERVICE PIPE OBSERVED - ALL LATE 19TH OR 20TH CENTURY. STRIP DISCONTINUED AT 4PM UNTIL SOIL REMOVED NO ARCHAEOLOGICAL FINDS OR FEATURES PREDATING THE LATE (19 OBSERVED)			
Comments: FURTHER VISITS NECESSARY - LIASE WITH SITE MANAGER			

For sketch plan, use reverse

©ASC, 2003



A.S.C. LTD

ARCHAEOLOGICAL FIELD MONITORING RECORD

Project: UNION STREET LUTON	Project No/Code: 973/LOR	Sheet: 2 of
Date of visit: 8/8/07		

Client/Developer
Hill PARTNERSHIPS

Contact:
DAVE NORCROSS

Phone:
07966121172

Duration of Visit (inc. travel):

Start: 1:00

Finish: 4:30

Completed by:
JENNY RICHARDS

Development Type:						
Footings	Services	Roads	Levelling	Quarrying	Pipelines	Other (specify):
<input checked="" type="checkbox"/>	<input type="checkbox"/>	<input type="checkbox"/>	<input checked="" type="checkbox"/>	<input type="checkbox"/>	<input type="checkbox"/>	

Site & weather conditions:
Dry + sunny, disused urban

Observations:

Levelling continuing between removal of spoil heap

Comments:

collected plan of pile locations
No levelling on 9/8/07, will re-start on 10/8/07

For sketch plan, use reverse

©ASC, 2003



A.S.C. LTD

ARCHAEOLOGICAL FIELD MONITORING RECORD

Project: UNION STREET, LUTON		Project No/Code: 9731 LOR	Sheet: 3 of
		Date of visit: 16/08/07.	
Client/Developer HILL PARTNERSHIP			
Contact: DAVE NORCROSS		Phone: 07966121172.	
Duration of Visit (inc. travel):	Start: 10:00	Finish: 12:30.	
Completed by: JR.			
Development Type:			
Footings <input checked="" type="checkbox"/>	Services	Roads	Levelling <input checked="" type="checkbox"/>
		Quarrying	Pipelines
		Other (specify):	
Site & weather conditions: DRY, OVERCAST. DISUSED URBAN.			
Observations:			
SOUTHERN SECTION OF SITE HAS BEEN REDUCED BY C. 0.50M, STILL IN MADE GROUND. OF C20 DATE TEST PITS WERE EXCAVATED BY MACHINE TO MAXIMUM DEPTH OF 1.20M BELOW SURFACE.			
CELLARS TO EAST AND SOUTH. PROBABLE WELL OF LATE C19/EARLY C20 DATE IN CENTRE OF AREA.			
CIRCULAR FEATURE (WITH BRICK INCLUSIONS) WAS NOTED 2m SW OF THIS C. 1.00M BELOW SURFACE, THIS MAY BE AN EARLIER WELL, THOUGH THE BRICK FRAGMENTS WITHIN THE FILL SUGGEST THAT IT WAS NOT MUCH EARLIER.			
CELLARS ALONG UNION STREET FRONTAGE EXTEND C. 3.50M NORTH FROM STREET			
Comments:			
FURTHER STRIPPING WILL TAKE PLACE ON MONDAY 20/08/07: PHONE TO CONFIRM ON FRIDAY.			

For sketch plan, use reverse

©ASC, 2003





A.S.C. LTD

ARCHAEOLOGICAL FIELD MONITORING RECORD

Project: <u>Oxford Rd, Luton</u>		Project No/Code: <u>9731 LOR</u>	Sheet: <u>of</u>			
		Date of visit: <u>20/08/07</u>				
Client/Developer: <u>HILL PARTNERSHIP</u>						
Contact: <u>DAVE NORCROSS</u>		Phone:				
Duration of Visit (inc. travel):	Start: <u>8:00</u>	Finish: <u>12:30</u>				
Completed by: <u>[Signature]</u>						
Development Type:						
Footings	Services	Roads	Levelling <input checked="" type="checkbox"/>	Quarrying	Pipelines	Other (specify):
Site & weather conditions: <u>DISUSED URBAN, DRY BUT OVERCAST.</u>						
Observations: <u>REMOVAL OF OVERBURDEN FROM SOUTH WEST OF SITE BY MACHINE WITH TOOTHLESS BUCKET.</u> <u>CELLARS REVEALED ALONG UNION STREET. AND</u> <u>DRAINAGE INSPECTION CHAMBERS NOTED BETWEEN THE TWO AREAS OF CELLARS</u>						
Comments: <u>FURTHER GROUNDWORKS TOMORROW (21/08/07)</u>						

For sketch plan, use reverse

©ASC, 2003



A.S.C. LTD

ARCHAEOLOGICAL FIELD MONITORING RECORD

Project: Oxford Rd & Union St Luton		Project No/Code: 973 LOR	Sheet: 1 of 1
Client/Developer Hill Partnerships		Date of visit: 21/08/07	
Contact: Dave Abrams		Phone: 07966 121172	
Duration of Visit (inc. travel):	Start: 8.45	Finish: 3pm	
Completed by: C. ROUSE			
Development Type:			
Footings —	Services	Roads	Levelling
			Quarrying
			Pipelines
			Other (specify):
Site & weather conditions: overcast, damp			
Observations: Observed piling pit for 3 houses in SW corner of site - approx 5m x 15m, approx 1.2m deep Observed brick wall around edge of site below parking - modern Otherwise, no archaeology observed			
Comments:			

For sketch plan, use reverse

©ASC, 2003



A.S.C. LTD

ARCHAEOLOGICAL FIELD MONITORING RECORD

Project: Oxford Rd, Luton		Project No/Code: 973 1	Sheet: of
		Date of visit: 22/08/07	
Client/Developer Hill Partnership			
Contact: Dave Norman		Phone: 07966 121172	
Duration of Visit (inc. travel):	Start: 9.00	Finish: 3pm	
Completed by: C. Rouse			
Development Type:			
Footings <input checked="" type="checkbox"/>	Services	Roads	Levelling
			Quarrying
			Pipelines
			Other (specify):
Site & weather conditions: Overcast, dry			
Observations: Continuation of yesterday Observed brick lined well - see sketch over approx 20m deep Otherwise no archaeology archaeology - all made up ground - lots of bricks & tarmac.			
Comments:			

For sketch plan, use reverse

©ASC, 2003

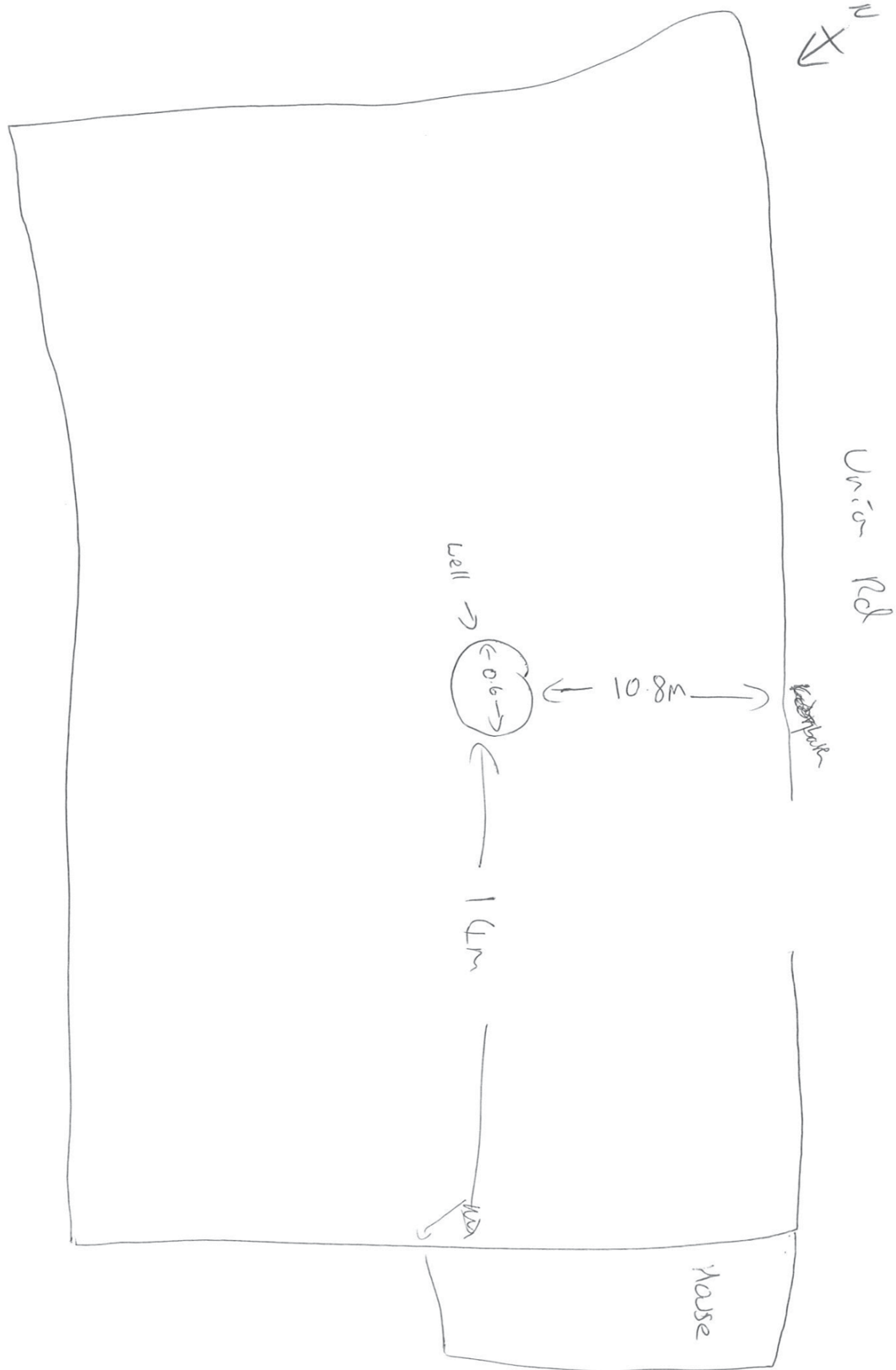



A.S.C. LTD

ARCHAEOLOGICAL FIELD MONITORING RECORD

Project: UNION STREET, LUTON		Project No/Code: 973 1 LOR	Sheet: of
		Date of visit: 23/8/07	
Client/Developer HILL PARTNERSHIPS			
Contact: DAVE NONCROSS		Phone: 07966 121172	
Duration of Visit (inc. travel):	Start: 11.00	Finish: 1.30	
Completed by: N3W			
Development Type:			
Footings	Services	Roads	Levelling <input checked="" type="checkbox"/>
			Quarrying
			Pipelines
			Other (specify):
Site & weather conditions: OVERCAST			
Observations: CAR PARKING AREA IN NW CORNER OF THE SITE HAS BEEN REDUCED. ALL MATERIAL REMOVED LATE 19/20 th CENTURY. C.15X15m			
Comments: THEY WILL CONTACT US WHEN WE ARE NEEDED AGAIN. SPoke WITH ALAN. TOOK GENERAL PHOTO OF THE AREA			

For sketch plan, use reverse

©ASC, 2003



A.S.C. LTD

ARCHAEOLOGICAL FIELD MONITORING RECORD

Project: Union Rd, Union St Luton		Project No/Code: 973 1 LOR	Sheet: 1 of 1			
Client/Developer: Hill Partnerships		Date of visit: 29/08/07				
Contact:		Phone:				
Duration of Visit (inc. travel):	Start: 9.30	Finish: 11.00				
Completed by: CR						
Development Type:						
Footings	Services /	Roads	Levelling	Quarrying	Pipelines	Other (specify):
Site & weather conditions: Clear, sunny						
Observations: Sewer manhole in along northern boundary. Approx 1.5 - 2m deep " 2m x 2m NO archaeology observed						
Comments:						

For sketch plan, use reverse

©ASC, 2003



A.S.C. LTD

ARCHAEOLOGICAL FIELD MONITORING RECORD

Project: <i>Union St, Luton</i>		Project No/Code: <i>973 1 LOR</i>	Sheet: <i>1 of 1</i>			
Client/Developer: <i>Hill Partnerships</i>		Date of visit:				
Contact:	Phone:					
Duration of Visit (inc. travel):	Start: <i>9.00</i>	Finish: <i>12.00</i>				
Completed by: <i>Calli</i>						
Development Type:						
Footings	Services <i>/</i>	Roads	Levelling	Quarrying	Pipelines	Other (specify):
Site & weather conditions: <i>overcast, dry</i>						
Observations: <i>Observed excavation of manhole approx 5m SW of yesterday's manhole</i> <i>No archaeology</i>						
Comments:						

For sketch plan, use reverse

©ASC, 2003



A.S.C. LTD

ARCHAEOLOGICAL FIELD MONITORING RECORD

Project: Union Street		Project No/Code: 973 1 LOR		Sheet: 1 of 1		
Luton		Date of visit: 31/08/07				
Client/Developer: Mill Partnerships						
Contact:			Phone:			
Duration of Visit (inc. travel):		Start: 9am		Finish: 12.45		
Completed by:						
Development Type:						
Footings	Services —	Roads	Levelling	Quarrying	Pipelines	Other (specify):
Site & weather conditions: overcast / sunny, dry						
Observations: Observed manhole adjacent to manhole seen on 29 th August NO archaeology						
Comments: Tom - 07865952229 (STAND IN SITE MANAGER) LEN LAWRENCE 07966317880 (OFFICE BOB)						

For sketch plan, use reverse

©ASC, 2003

Appendix 2 List of Photographs

SITE NAME: Corner of Union Road and Oxford Street, Luton			SITE NO/CODE: 973/LOR
Shot	B&W	Digital	Subject
1	/	/	Entrance to site
2	/	/	Overview of site from SE
3	/	/	Overview of site
4	/	/	Section of ground reduction
5	/	/	Working shot
6	/	/	Working shot
7	/	/	Working shot
8	/	/	Working shot
9	/	/	E side of site
10	/	/	W facing view of site
11	/	/	Cellar one
12	/	/	Cellar two
13	/	/	Cellar two
14	/	/	View of cellar 2 showing cut
15	/	/	Working shot
16	/	/	Base of cellar 3
17	/	/	Test pit
18	/	/	Test pit
19	/	/	Overview of north part of site
20	/	/	Well
21	/	/	Section of test pit
22	/	/	Test pit
23	/	/	Test pit
24	/	/	Probable well
25	/	/	Cellars along Union Road
26	/	/	Cellars along Union Road
27	/	/	Cellars along Union Road
28	/	/	Test pit in south west of site
29	/	/	Test pit in south west of site
30	/	/	Test pit in south west of site
31	/	/	Ground reduction in SW of site
32	/	/	Ground reduction in SW of site
33	/	/	Ground reduction in SW of site
34	/	/	Ground reduction in SW of site
35	/	/	Ground reduction in SW of site
36	/	/	Brick lined well
37	/	/	Brick lined well
38	/	/	Brick lined well
39	/	/	Overview of NW corner of site
40	/	/	Drainage inspection chamber 1
41	/	/	Drainage inspection chamber 1
42	/	/	Drainage inspection chamber 1
43	/	/	Drainage inspection chamber 2
44	/	/	Drainage inspection chamber 2
45	/	/	Drainage inspection chamber 2
46	/	/	Drainage inspection chamber 2
47	/	/	Drainage inspection chamber 3

Appendix 3 ASC OASIS Form

PROJECT DETAILS			
Project Name:	Corner of Oxford Road and Union Street, Luton		
Short Description:	During August 2007 Archaeological Services and Consultancy Ltd conducted a watching brief at a site on the corner of Oxford Road and Union Street, Luton, on behalf of Hill Partnership (Western) Ltd, during ground reduction, the excavation of test pits for piled foundations, and drainage trenches. No finds or features pre-dating the 19 th century were observed.		
Project Type: (indicate all that apply)	Watching Brief		
Site status: (eg. none, SAM, Listed)	None	Previous work: (eg. SMR refs)	None
Current land use:	Residential	Future work: (yes / no / unknown)	No
Monument type:	None	Monument period:	None
Significant finds: (artefact type & period)	None		
PROJECT LOCATION			
County:	Bedfordshire	OS reference: (8 figs min)	TL 0925 2088
District:	Luton	Parish:	Unparished
Site address: (with postcode if known)	Corner of Oxford Road and Union Street, Luton, Bedfordshire		
Study area: (sq. m. or ha)	1700sq. m.	Height OD: (metres)	117mAOD
PROJECT CREATORS			
Organisation:	Archaeological Services & Consultancy Ltd		
Project brief originator:	Bedfordshire County Council	Project design originator:	A J Hancock BSc PgDip
Project Manager:	A J Hancock BSc PgDip	Director/Supervisor:	J Richards BA PIFA
Sponsor / funding body:	Hill Partnerships (Western) Ltd		
PROJECT DATE			
Start date:	30/07/07	End date:	11/09/07
PROJECT ARCHIVES			
	Location (Accession no.)	Content (eg. pottery, animal bone, files/sheets)	
Physical:	None	N/a	
Paper:	Luton Museum 2007/111	Brief, Project Design, Report, site plans, monitoring sheets, list of photographs, B&W negatives and prints,	
Digital:	Luton Museum 2007/111	CDROM with copies of: Project Design, Report, scanned copies of monitoring sheets and site plans, Digital photos.	
BIBLIOGRAPHY (Journal/monograph, published or forthcoming, or unpublished client report)			
Title:	Watching Brief Report: Corner of Union Road and Oxford Street, Luton, Bedfordshire, on behalf of Hill Partnerships (Western) Ltd. ASC Report number 973/LOR/2		
Serial title & volume:			
Author(s):	J Richards BA PIFA		
Page nos	31	Date:	11 th September 2007