

**ARCHAEOLOGICAL EVALUATION REPORT:
TRIAL TRENCHING ON LAND OFF HURN ROAD, PETERBROUGH, CAMBRIDGESHIRE**

Planning Reference: 13/00981/FUL
NGR: TF 1543 0363
AAL Site Code: PEHR 15
OASIS Reference Number: allenarc1-205439



Report prepared for Frankham Consultancy Group

By
Allen Archaeology Limited
Report Number AAL2015028

March 2015

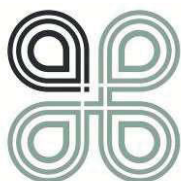

Allenarchaeology



Contents

Executive Summary	1
1.0 Introduction.....	1
2.0 Site Location and Description.....	1
3.0 Planning Background.....	1
4.0 Archaeological and Historical Background.....	1
5.0 Methodology	2
6.0 Results	2
Trench 1 (Figures 1 and 2).....	2
7.0 Discussion and Conclusions.....	3
8.0 Effectiveness of Methodology.....	4
9.0 Acknowledgements	4
10.0 References.....	4

List of Plates

Plate 1: Southeast facing representative section. Scale 1x1m.....	3
Plate 2: Trench 1 looking southwest. Scales 1x2m and 1x1m.....	3

List of Appendices

Appendix 1: Context Summary List	5
Appendix 2: Figures	6

List of Figures

Figure 1: Site location outlined in red	6
Figure 2: Trench 1 within footprint of replacement dwelling	7
Figure 3: Trench 1 at scale 1:100 and representative section at 1:20	8

Document Control

Element:	Name:	Date:
Report prepared by:	Aaron Chapman	16/03/2015
Illustrations prepared by:	Aaron Chapman	16/03/2015
Report edited by:	Chris Clay	16/03/2015
Report produced by:	AAL2015028	16/03/2015

Allen Archaeology reports are printed double sided on 100% recycled paper to reduce our carbon footprint.

Cover image: Looking northeast over the development area

Executive Summary

- Allen Archaeology Limited was commissioned by Frankham Consultancy Group to undertake an evaluation by trial trenching on land off Hurn Road, Peterborough, as a condition of planning permission for erection of a replacement dwelling.
- The site is archaeologically sensitive, lying in an area of archaeological interest and potential, with evidence for Iron Age and Roman activity in the surrounding landscape, as well as evidence for medieval agricultural activity.
- A single 15m long by 1.6m wide trench was excavated within the footprint of the replacement dwelling. The trench exposed only topsoil, subsoil and natural geology, with two modern service trenches.

1.0 Introduction

- 1.1 Allen Archaeology Limited was commissioned by Frankham Consultancy Group to undertake an archaeological evaluation by trial trenching on land off Hurn Road, Peterborough, Cambridgeshire, as a condition of planning permission for erection of a replacement dwelling.
- 1.2 The site works and reporting conformed to current national guidelines, as set out in the Chartered Institute for Archaeologists '*Standard and guidance for archaeological field evaluations*' (ClfA 2014), and regional guidelines '*Research and Archaeology Revisited: a revised framework for the East of England*' (Medlycott 2011). All relevant English Heritage guidelines on archaeological best practice will also be followed (www.helm.org/server/show/nav.7740).

2.0 Site Location and Description

- 2.1 The proposed development area is located c.6km north-northwest of central Peterborough, on the northwest side of Hurn Road and northeast of a railway line, centred on NGR TF 1543 0363.
- 2.2 The bedrock geology of the site comprises interbedded sandstone and siltstone of the Kellaways Sand Member, with no superficial deposits recorded (<http://mapapps.bgs.ac.uk/geologyofbritain/home.html>).

3.0 Planning Background

- 3.1 Planning permission has been granted for '*demolition of existing dwelling and erection of 1 x 3 bed dwelling*' (Reference 13/00981/FUL). Permission was granted subject to conditions, including for a programme of archaeological evaluation by trial trenching in advance of development.
- 3.2 The approach adopted is consistent with the recommendations of Chapter 12: Conserving and Enhancing the Historic Environment of the National Planning Policy Framework (NPPF) (Department for Communities and Local Government 2012) and Policy CS17 of the adopted Peterborough Core Strategy DPD.

4.0 Archaeological and Historical Background

- 4.1 Evidence for prehistoric and Roman activity has been recorded in the vicinity of the site. An aerial photography assessment of a 133 hectare area centred c.1km to the north of the site has identified a series of ditched enclosures of possible Iron Age or Roman date, with numerous features corresponding closely to surface finds of that date (PHER Reference 51456). Approximately 1.2km east of the site a substantial enclosure was excavated at Werrington in 1980. The site was occupied from the late Iron Age into the 4th century AD (PHER Reference 00497, 00563). Possible round houses were recorded within the enclosure, but there had been some truncation by medieval ridge and furrow. Nearby a substantial Roman building has been excavated producing finds of 4th century date, with associated, enclosures, pits and ditches of 2nd to 4th century date identified from aerial photography and intrusive works. Scatters of Iron Age and Roman pottery were also recovered during groundworks for a new road scheme c.1.5km northeast of the site (PHER Reference 02195), and southwest of Woodcroft Castle

approximately 1.6km to the west-northwest (PHER Reference 02214). Further Iron Age to Roman finds and features were identified on the line of a Transco pipeline c.1.6km to the southwest (PHER References 50674 and 50675).

- 4.2 At the time of the Domesday Book in 1086, Werrington was a land holding of Peterborough Abbey, populated by 53 villagers and 4 slaves, suggesting a fairly populous settlement. Evidence for medieval activity in the vicinity of the site is sparse, with ridge and furrow recorded in several locations near to the site, such as off Papyrus Road c.500m to the east (PHER Reference 50643), indicating the site was likely to have been in an agricultural zone at the time. However a possible moated site has been identified by aerial photography, also c.500m east of the site (PHER Reference 50134).

5.0 Methodology

- 5.1 A programme of trial trenching has been agreed with the Archaeologist at Peterborough City Council, comprising a single evaluation trench measuring 15m long by 1.6m wide, as shown on the attached plan.
- 5.2 The trench was located on site using a Leica GS08 RTK NetRover GPS, allowing centimetre accurate real-time precision. In the trench, all non-archaeological topsoil and overburden was removed by mechanical excavator with a toothless ditching bucket in spits no greater than 0.10m in depth. The process was repeated until the first archaeologically significant or natural horizon was exposed. All contexts were recorded on pro-forma AAL context records sheets.

6.0 Results

Trench 1 (Figures 1 and 2)

- 6.1 Trench 1 was located within the footprint area of the replacement dwelling, aligned northeast to southwest. This trench contained a natural geology of sandy clay 101, sealed by a silty clay subsoil 102, 0.15m thick.
- 6.2 Subsoil 102 was sealed by a clayey silt topsoil 100, 0.21m thick. This topsoil was the uppermost deposit across the site. The only features identified within the trench were two modern services, aligned broadly northwest to southeast towards the centre of the trench.



Plate 1: Southeast facing representative section. Scale 1x1m



Plate 2: Trench 1 looking southwest. Scales 1x2m and 1x1m

7.0 Discussion and Conclusions

- 7.1 The evaluation trench was devoid of archaeological features or deposits, exposing a sequence of natural geology overlain by subsoil and topsoil, with two modern services recorded.
- 7.2 The evidence indicates a negligible archaeological potential for the site, and the proposed development is unlikely to have any impact upon the archaeological resource of the area.

8.0 Effectiveness of Methodology

8.1 The methodology employed was appropriate to the nature and extent of the proposed development. It has indicated a negligible archaeological potential for the proposed development site.

9.0 Acknowledgements

9.1 Allen Archaeology would like to thank Frankham Consultancy Group for this commission.

10.0 References

Department for Communities and Local Government, 2012, *National Planning Policy Framework*. London, Department for Communities and Local Government

CifA, 2014, *Standard and guidance for archaeological field evaluations*, Institute for Archaeologists, Reading

Medlycott, M (ed.), 2011, *Research and Archaeology Revisited: a revised framework for the East of England*, East Anglian Archaeology Occasional Paper 24

Appendix 1: Context Summary List

Context	Type	Description	Interpretation
100	Layer	Firm mid grey brown clayey silt, 0.21m thick, seals 102	Topsoil
101	Layer	Firm yellowish orange sandy clay, sealed by 102	Natural
102	Layer	Firm orange brown silty clay, 0.15m thick; sealed by 100, seals 101	Subsoil

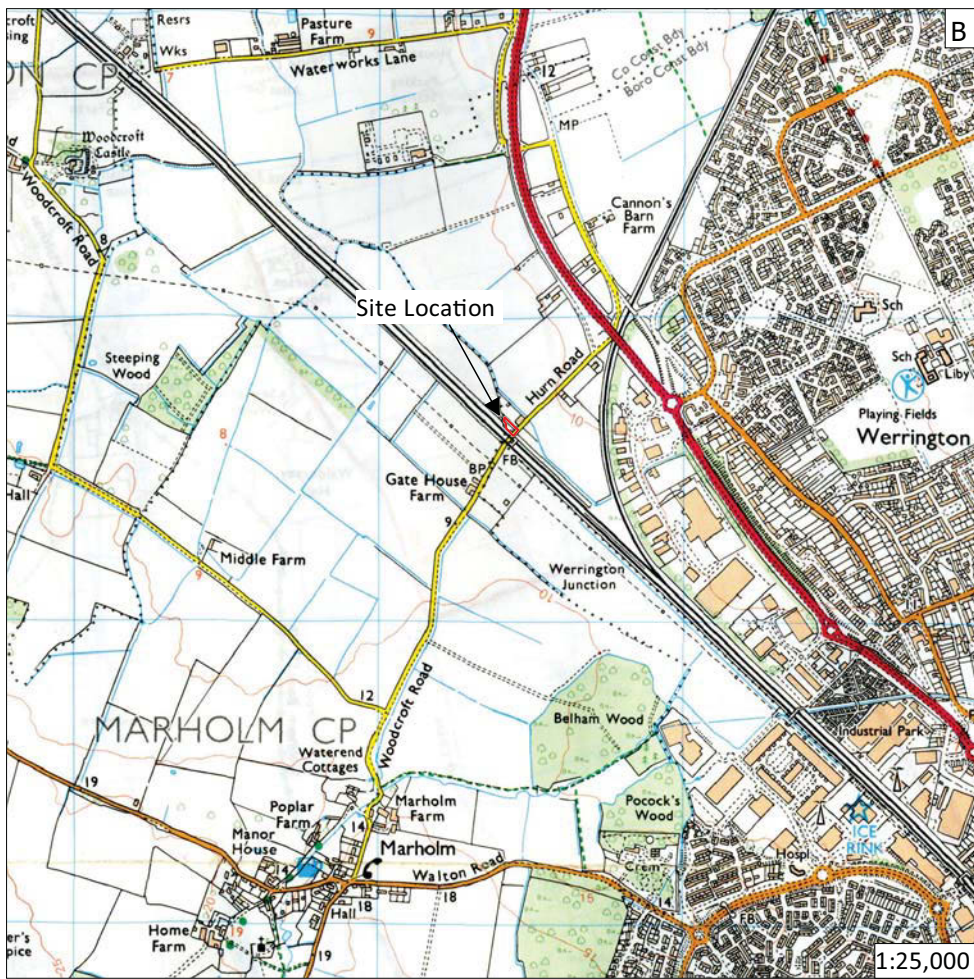
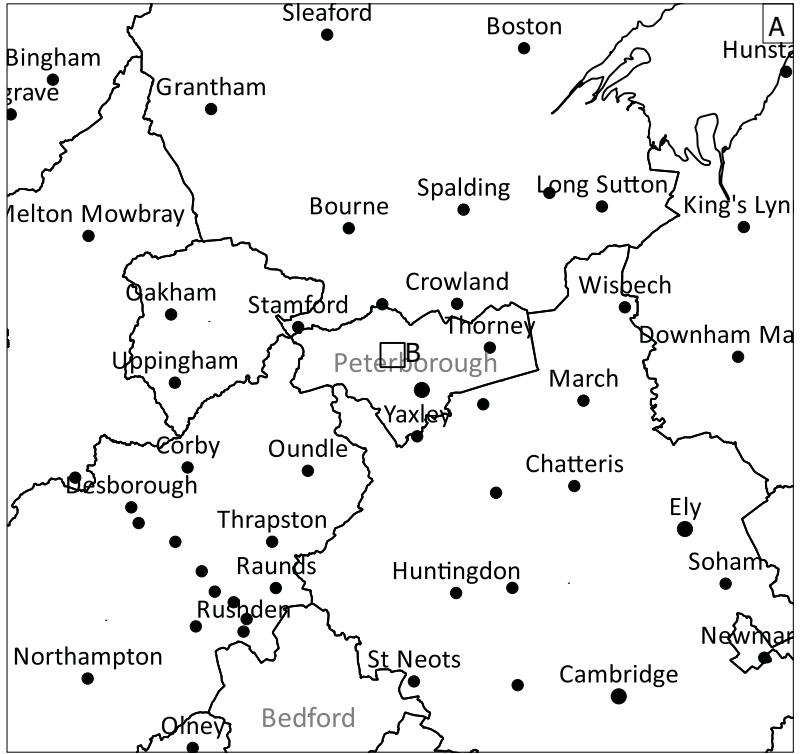
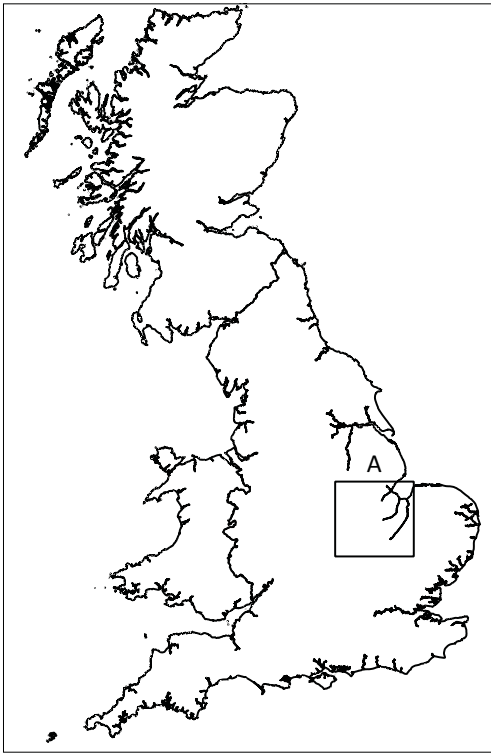

Figure 1: Site location outlined in red

© Crown copyright 2000. All rights reserved. Licence Number 100047330

Site Code	PEHR 15
Scale	1:25,000 @ A4
Drawn by	A Chapman
Date	25/02/15



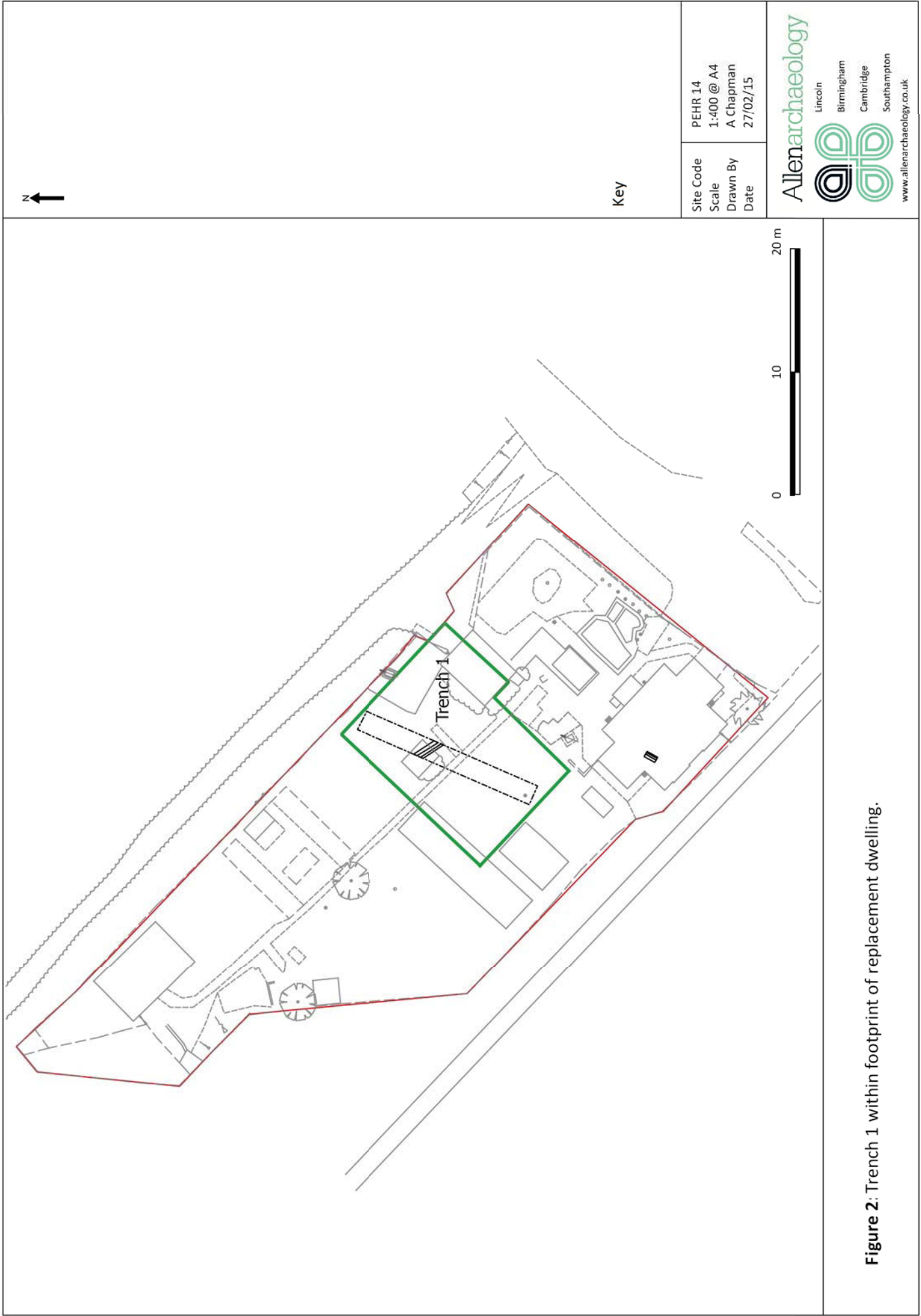
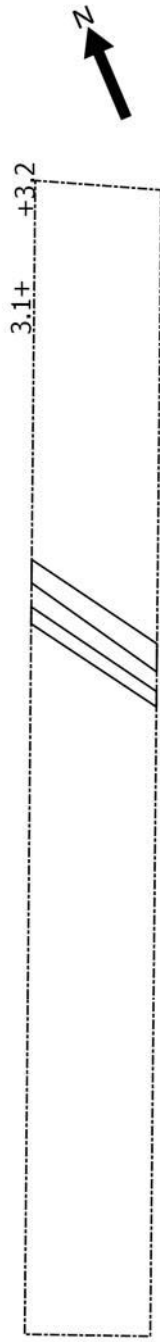
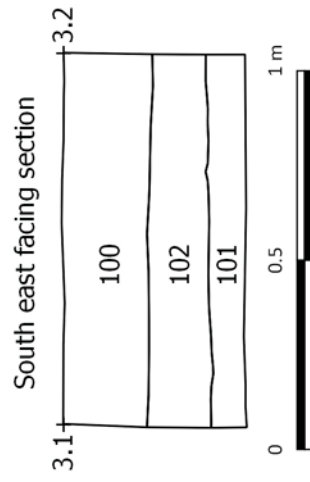

Figure 2: Trench 1 within footprint of replacement dwelling.



Scale 1:100



Scale 1:20

Site Code
Scale
Drawn By
Date

PEHR 15
1:100/1:20 @ A4
A Chapman
27/02/15

Allenarchaeology



Lincoln
Birmingham
Cambridge
Southampton

www.allenarchaeology.co.uk

Figure 3: Trench 1 at scale 1:100 and representative section at 1:20



Allen Archaeology Limited
Website: www.allenarchaeology.co.uk

Company Registered in England and Wales No: 6935529

Lincoln
Whisby Lodge
Hillcroft Business Park
Whisby Road
Lincoln
LN6 3QL

Birmingham
Arion Business Centre
Harriet House
118 High Street
Birmingham
B23 6BG

Cambridge
Wellington House
East Road
Cambridge
CB1 1BH

Southampton
International House
Southampton International Business Park
George Curl Way
Southampton
SO18 2RZ

Tel/Fax: +44 (0) 1522 685356
Email: info@allenarchaeology.co.uk

Tel/Fax: +44 (0) 800 610 2545
Email: birmingham@allenarchaeology.co.uk

Tel/Fax: +44 (0) 800 610 2550
Email: cambridge@allenarchaeology.co.uk

Tel: +44 (0) 800 610 2555
Email: southampton@allenarchaeology.co.uk