

**Land South of Western Way, Bowerhill,
Melksham,
Wiltshire**

Archaeological Evaluation



for
RPS

CA Project: 5119
CA Report: 14542

November 2014

LAND SOUTH OF WESTERN WAY BOWERHILL, MELKSHAM WILTSHIRE.

Archaeological Evaluation

CA Project: 5119
CA Report: 14542

prepared by	Adam Howard (Archaeologist)
date	21 November 2014
checked by	Damian De Rosa Project Manager
date	26 November 2014
approved by	Richard Greatorex Principal Fieldwork Manager
signed	
date	27 November 2014
issue	01

This report is confidential to the client. Cotswold Archaeology accepts no responsibility or liability to any third party to whom this report, or any part of it, is made known. Any such party relies upon this report entirely at their own risk. No part of this report may be reproduced by any means without permission.

© Cotswold Archaeology

<p>Cirencester Building 11 Kemble Enterprise Park Kemble, Cirencester Gloucestershire, GL7 6BQ t. 01285 771022 f. 01285 771033</p>	<p>Milton Keynes 41 Burners Lane South Kiln Farm Milton Keynes MK11 3HA t. 01908 564660</p>	<p>Andover Stanley House Walworth Road Andover, Hampshire SP10 5LH t. 01264 347630</p>
e. enquiries@cotswoldarchaeology.co.uk		

CONTENTS

SUMMARY	2
1. INTRODUCTION.....	3
<i>The site</i>	3
<i>Archaeological background</i>	4
<i>Archaeological objectives</i>	4
<i>Methodology</i>	4
2. RESULTS (FIGS 2-5).....	5
<i>The finds</i>	6
<i>Palaeoenvironmental evidence</i>	8
3. DISCUSSION.....	8
4. CA PROJECT TEAM.....	9
5. REFERENCES.....	9
APPENDIX B: THE FINDS	15
APPENDIX C: THE PALAEOENVIRONMENTAL EVIDENCE	16
APPENDIX D: OASIS REPORT FORM.....	17

LIST OF ILLUSTRATIONS

- Fig. 1 Site location plan (1:25,000)
- Fig. 2 Trench location plan showing archaeological features,(1:1500)
- Fig. 3 Trenches 20 and 21: plans (1:250)
- Fig. 4 Trench 20: sections and photographs (1:20)
- Fig. 5 Trench 21: sections and photographs (1:20)

SUMMARY

Project Name:	Land South of Western Way, Bowerhill, Melksham,
Location:	Wiltshire
NGR:	ST 91180 62610
Type:	Evaluation
Date:	3rd to 7th of November 2014
Site Code:	LBM14

An archaeological evaluation was undertaken by Cotswold Archaeology in November 2014 at Land South of Western Way, Bowerhill, Melksham, Wiltshire. Twenty one trenches were excavated within two fields (Fields 1 and 2). Archaeological features of likely medieval date were only identified within Trenches **20** and **21**, however features of post-medieval/modern date were identified in other parts of the site.

Trench **20** was located within the north-west of Field 2 and contained a series of undated ditch features with shallow U-shaped profiles. A shallow undated pit was also identified.

Trench **21** was located within the north-west of Field 2 and contained two small pits, a posthole and a ditch/gully. A pit located in the north-east of the trench produced a large amount of medieval Minety ware pottery dating to the 12th to 15th centuries, which may provide an indication of the date of the other undated archaeological features recorded within Trenches **20** to **21**. The environmental sample evidence from the pit also suggests that this could be representative of domestic activity.



1. INTRODUCTION

- 1.1 In November 2014 Cotswold Archaeology (CA) carried out an archaeological evaluation for RPS at Land South of Western Way, Bowerhill, Melksham, Wiltshire (centred at NGR: ST 91180 62610 Fig. 1). Outline planning consent is being sought for development at the site comprising residential properties with associated infrastructure and landscaping. The archaeological evaluation along with a previously undertaken Heritage Assessment (RPS 2014) and Geophysical Survey (AS 2014) have been undertaken in support of the proposed planning application.
- 1.2 The evaluation was carried out in accordance with a *Written Scheme of Evaluation* (WSI) (RPS 2014) for archaeological evaluation and Project Design CA (2014) approved by Rachel Foster, Assistant County Archaeologist for Wiltshire Council (WC), prior to the commencement of fieldwork. The fieldwork also followed the *Standard and guidance for archaeological field evaluation* (IfA 2009), the *Management of Archaeological Projects* (English Heritage 1991) and the *Management of Research Projects in the Historic Environment (MORPHE): Project Manager's Guide* (English Heritage 2006). A site meeting was held with Mick Rawlings (RPS), Claire King (WC) and Damian De Rosa (CA) on 6 November 2014 to monitor the progress of the work.

The site

- 1.3 The site comprises two triangular shaped fields approximately 10.5 ha in size and is located immediately north of Bowerhill Industrial Estate and lies to the south of Western Way (A365). The two fields lay to the east and west of and are divided by the road that leads to the Bowerhill trading estate from the A365 (Figure. 1).
- 1.4 The western field has a very slight slope down towards the north falling from c. 43.50m above Ordnance Datum (aOD) to c. 38.70m aOD. The eastern field also slopes from north to south falling from c.45.00m aOD to 39.50m aOD.
- 1.5 The underlying geology is mudstone from the Oxford Clay formation with overlying head deposits of clay and silt within the north eastern part of Area 2 in the eastern side of the site.

Archaeological background

- 1.5 There are no designated heritage assets within the proposal site. The historic core of Melksham is located more than a kilometre to the north-west and is based around a royal estate that was present at the time of the Norman Conquest. Melksham was a prosperous settlement by the later medieval period, with wealth derived from the weaving of broadcloth. The key historic buildings are incorporated within the Melksham Conservation Area (Site 1) which is more than 700 m from the nearest part of the proposal site.

Archaeological objectives

- 1.6 The objectives of the evaluation were to provide information about the archaeological resource within the site, including its presence/absence, character, extent, date, integrity, state of preservation and quality, in accordance with the *Standard and guidance for archaeological field evaluation* (IfA 2009). This information will enable Wiltshire Council to identify and assess the particular significance of any heritage asset, consider the impact of the proposed development upon it, and to avoid or minimise conflict between the heritage asset's conservation and any aspect of the development proposal, in line with the *National Planning Policy Framework* (DCLG 2012).

Methodology

- 1.7 The fieldwork comprised the excavation of 21 no. 30m x 1.8m trenches. Trenches were set out on OS National Grid (NGR) co-ordinates using Leica GPS and surveyed in accordance with CA Technical Manual 4 *Survey Manual* (2012).
- 1.8 All trenches were excavated by mechanical excavator equipped with a toothless grading bucket. All machine excavation was undertaken under constant archaeological supervision to the top of the first significant archaeological horizon or the natural substrate, whichever was encountered first. Where archaeological deposits were encountered they were excavated by hand in accordance with CA Technical Manual 1: *Fieldwork Recording Manual* (2013).

- 1.9 Deposits were assessed for their palaeoenvironmental potential in accordance with CA Technical Manual 2: *The Taking and Processing of Environmental and Other Samples from Archaeological Sites* (2003) and, 4 samples were taken. All artefacts recovered were processed in accordance with Technical Manual 3 *Treatment of Finds Immediately after Excavation* (1995).
- 1.10 The archive and artefacts from the evaluation are currently held by CA at their offices in Kemble. Subject to the agreement of the legal landowner the artefacts will be deposited with Devizes Museum along with the site archive. However Devizes Museum is currently not accepting any further archives and until this situation is resolved the artefacts and archive will remain at the offices of CA in Andover. A summary of information from this project, set out within Appendix D, will be entered onto the OASIS online database of archaeological projects in Britain.

2. RESULTS (FIGS 2-5)

- 2.1 Archaeological features of likely medieval date were only identified within Trenches **20** and **21**, however features of post-medieval/modern date were identified in other parts of the site.
- 2.2 Across the remainder of the site (Figure 2) two parallel linear shallow ditches (indicated on the geophysical survey) were identified within Trenches **1**, **2**, **12** and **14** but positive artefactual evidence confirmed that these features date to the post-medieval/modern period and cut the underlying subsoil. Residual Roman and medieval pottery was recovered from the ditch **1204** in Trench 12. No archaeological features or deposits were found within Trenches **3** to **11** and **13** within Field 1 and Trenches **15** to **19** within Field 2. Land drains were identified within Trenches **3**, **4**, **6**, **7**, **9**, **10** and **13** within Field 1 and Trenches **15**, **17**, **18** and **19**. A modern service was identified within Trench **18** within Field 2. Significant artefact evidence was absent from both the topsoil and subsoil within both Field 1 and 2. However a small scattered assemblage of post-medieval to modern ceramics and ceramic building material fragments was observed but not retained during the evaluation work.

Trench 20 (Figs 2, 3 and 4)

- 2.3 Trench **20** contained ditches **2004**, **2009**, **2014**, **2017**, gully **2011** and pit **2006**. Ditch **2004** was linear in plan with a NE/SW alignment and had moderately sloping convex

sides and a flat base. It was 2m long 1.07m wide and 0.16m deep, it was filled by **2003** from which a single very small sherd of Roman-British pottery was recovered. Ditch **2009** was linear in plan on a SW/NE alignment with moderate straight sides a flat base with a gradual concave break of slope on its north side. It was 1.1m long 1.37m wide and 0.18m deep and filled by **2007**, and **2008**. Ditch **2014** was linear in plan on a SW/NE alignment with convex sides and a flat base. It was 2.3m long, 0.7m wide and 0.14m deep and filled by **2012** and **2014**. Ditch **2017** was linear in plan gradual concave sides east side is longer than the west creating an asymmetrical profile. Flat to shallow concave base N/S alignment. It was 3m long 0.84m wide and 0.16m deep and filled by **2015** and **2016**. Gully **2011** was linear in plan with gradual strait on the SE side and steep concave on NW side and a shallow concave base with a NE/SW alignment. It was 2.1m long, 0.69m wide and 0.14m deep and filled with **2010**. Pit **2006** was circular in plan moderate irregular convex and strait sides.

Trench 21 (Figs 2, 3 and 5)

- 2.4 Trench **21** contained a ditch **2107**, pits **2103** and **2105**, posthole **2109**. Ditch **2107** was linear in plan with moderate strait sides V shaped profile a flat base and a NW/SE alignment. It was 0.73m long, 0.25m wide, 0.14m deep and filled by **2108** from which three scraps of Cotswold oolitic limestone-tempered ware, which is dateable to the 11th to 13th centuries was recovered.
- 2.5 Pit **2103** was circular in plan with steep vertical sides and a flat base. It was 0.25m long and 0.4m wide and 0.24m deep and filled by **2104** from which a large amount (98 sherds) of medieval Minety Ware pottery dating to the 12th to 15th centuries was recovered. Pit **2105** was oval in plan with rounded corners, steep concave sides and a flat base. It was 0.48m, long 0.28m wide, 0.14m deep and filled by **2016**. Posthole **2109** was oval in plan with rounded corners, gentle concave sides and a flat base. It was 0.39m long, 0.21m wide, 0.10m deep and filled by **2110**.

The finds

- 2.6 Finds recovered from the evaluation included pottery, ceramic building material and clay tobacco pipe.

Pottery: Roman

- 2.7 Pottery of broadly Roman date consisted of: an unfeathered bodysherd of greyware from ditch fill 1203 and one in a fine, oxidised fabric from ditch fill 2003. Both sherds were of small size and abraded.

Medieval

- 2.8 Bulk soil sampling of ditch fill 2108 produced three scraps of Cotswold oolitic limestone-tempered ware, which is dateable to the 11th to 13th centuries
- 2.9 Ninety-two unfeathered bodysherds of Minety and six scraps in a medieval sandy fabric ware were recorded in pit fill 2104. The majority of these were recovered from bulk soil sampling. Minety ware was produced at Minety in north Wiltshire across the 12th to 15th centuries (McSloy 2013, 160).
- 2.10 Single sherds of Lacock-Nash Hill ware were recovered from three fills (see Appendix B). That from topsoil 2000 was a rimsherd from a jar with a slightly thickened, everted rim. This pottery type was manufactured in Wiltshire from the late 13th to 16th centuries (McCarthy 1974, 100–1).

Post-medieval/modern

- 2.10 Topsoil 2000 produced a bodysherd of Creamware of 18th century date, and a base sherd of refined whiteware, dating to the late 18th to 19th centuries.

Ceramic building material

- 2.11 A single fragment of ceramic building material of post-medieval date was recorded in topsoil 2000. It was too fragmentary for further classification.

Clay tobacco pipe

- 2.12 Furrow fill 101 produced a single fragment from the stem of a clay tobacco pipe of late 16th to late 19th century date.

Industrial waste

- 2.13 A total of four fragments of iron-working slag, weighing 348g, were recovered from three deposits. That from furrow fill 109 was identifiable as smelting residue.

Worked flint

- 2.14 A total of five flint chips were recovered from bulk soil sampling of three deposits. These residual finds are indicative of prehistoric flint knapping in the vicinity.

Palaeoenvironmental evidence

- 2.15 Four environmental samples (46 litres of soil) were retrieved from four deposits with the intention of recovering evidence of industrial or domestic activity and material for radiocarbon dating. The samples were processed by standard flotation procedures (CA Technical Manual No. 2).

Medieval

- 2.16 Sample 2201 was recovered from fill 2104 within pit 2103 and contained a single free-threshing wheat and indeterminate cereal grain. Charcoal was present in moderate quantities and identified as oak. The moderately abundant charcoal suggests that this deposit represents a dump of hearth waste and given the small number of cereal grains within the assemblage, it is possible this is representative of domestic activity (crop processing or domestic food production).

Undated

- 2.17 Samples were recovered from ditches 2105 (sample 2202) and 2107 (sample 2203) and posthole 2109 (sample 2204). Ditches 2105 and 2107 contained a single indeterminate cereal grain each and a small amount of poorly preserved charcoal identified as oak. This small amount of poorly preserved material can be attributed to wind-blown hearth debris. Posthole 2109 contained no plant macrofossil or charcoal remains.

3. DISCUSSION

- 3.1 The trial trench evaluation, which was targeted on the results of the previously undertaken geophysical survey, has been able to identify across the majority of the site that there is a low potential for the presence of archaeological features that pre-date the post-medieval or modern periods.

- 3.2 However, within the north-west corner of the Site (Field 2) there is a concentration of archaeological features, although largely undated, comprising ditches, pits and postholes in Trenches 20 and 21. The features corresponded well to geophysical anomalies, and are likely to be an indication of medieval activity on the basis of the dating evidence recovered from Trench 21. The recorded evidence within the

trenches does not make it clear whether this evidence could be related to simple agricultural activity such as a field system or stock enclosures or whether it could be an indication of wider settlement or domestic activity. However, the evidence from the sample taken from pit 2104 in Trench 21 along with the large number of pottery sherds recovered could indicate the presence of domestic activity dating to the medieval period. It is unclear however, if all the features are related and whether they belong to the same date.

- 3.3 Across the remainder of the site although recorded features were seen to correspond to geophysical anomalies these were shown to be of undoubted post-medieval or modern date. In particular two parallel linear features within Field 1 were shown to be very shallow and cut the subsoil. These features are likely to relate to a trackway that is indicated on historic mapping. A cluster of anomalies targeted in Trenches 3 and 4 were also shown to be non-archaeological in nature and seemed to relate to more recent ground disturbance within this part of the site. Land drains were also extensively identified across the site.
- 3.4 Significant artefact evidence was absent from both the topsoil and subsoil within both Field 1 and 2. However a small scattered assemblage of post-medieval to modern ceramics and ceramic building material fragments was observed but not retained during the evaluation work.

4. CA PROJECT TEAM

Fieldwork was undertaken by Matt Nichol, assisted by Jeremy Clutterbuck, Steve Bush, Tom Hackett, and Colin Forrestal. The report was written by Adam Howard and Matt Nichol and edited by Damian De Rosa. The illustrations were prepared by Leo Heatley. The archive has been compiled and prepared for deposition by Adam Howard. The project was managed for CA by Damian De Rosa.

5. REFERENCES

BGS (British Geological Survey) 2014 *Geology of Britain Viewer*
http://maps.bgs.ac.uk/geology_viewer_google/googleviewer.html

CA 2003 *The taking and processing of environmental and other samples from archaeological sites* CA Technical Manual No. 2

CA 2014. Land South Of Western Way, Bowerhill, Wiltshire *Project design for an Archaeological Evaluation*

McCarthy, M. R. 1974 'The Medieval Kilns on Nash Hill, Lacock, Wiltshire'. *The Wiltshire Archaeological and Natural History Magazine*. **69**, 97–160.

McSloy, E. R. 2013 'Medieval Pottery', in Ridgeway, V. and Watts, M. (eds.) 2013, 155–75.

Ridgeway, R. and Watts, M. 2013 *Friars, Quakers, Industry and Urbanisation: The Archaeology of the Broadmead Expansion Project, Cabot Circus, Bristol, 2005-2008*. Cirencester. CAPCA.

RPS 2014 Land South Of Western Way, Bowerhill, Wiltshire *Heritage Assessment*

RPS 2014 Land South Of Western Way, Bowerhill, Wiltshire *Written Scheme of Investigation*



Trench No.	Context No.	Type	Fill of	Context interpretation	Description	L (m)	W (m)	Depth/thickness (m)	Spot-date
1	100	Layer		Topsoil	Dark brown clay silt	32	2	0-0.28	
1	101	Fill	103	Fill	Grey silty clay with abundant reddish brown and orange mottling		3.05	0.24	
1	102	Layer		Natural	Compact bluish grey with light orange yellow mottling silty clay	32	2	0.41+	
1	103	Cut		Furrow	Cut of furrow	2+	3.05	0.28-0.52	
1	104	Cut		Ditch	U shaped ditch	2+	0.3	0.28-0.56	
1	105	Fill	104	Fill	Bluish grey and mid yellowish brown clay silt	1	0.3	0.28	
1	106	Cut		Tree throw	Tree throw				
1	107	Fill	106	Fill	Fill of tree throw				
1	108	Cut		Furrow	Cut of furrow	2+	1.75	0.2	
1	109	Fill	108	Fill	Grey silty clay with abundant reddish brown and orange mottling	1	1.75	0.2	
1	110	Cut		Land drain	Modern land drain or fence line	2	0.4	0.3	
1	111	Fill	110	Fill	Bluish grey and mid yellowish brown clay silt	1	0.4	0.3	
1	112	Layer		Subsoil	Light yellowish brown silty clay	32	2	0.28-0.34	
2	200	Layer		Topsoil	Dark greyish brown silty clay	29.4	1.84	0-0.25	
2	201	Layer		Subsoil	Light greyish brown silty clay	29.4	1.84	0.25-0.34	
2	202	Layer		Natural	Light yellowish brown with orange mottles silty clay	29.4	1.84	0.34+	
2	203	Cut		Ditch	Unexcavated ditch	1.84+	1.25		
2	204	Fill	203	Fill	Mid greyish reddish brown silty clay, unexcavated	1.84	1.25		
2	205	Cut		Ditch	Continuation of ditch 103, unexcavated	1.84+	1.1		
2	206	Fill	205	Fill	Mid greyish reddish brown silty clay	1.84	1.1		
3	300	Layer		Topsoil	Dark grey clay silt	30	2	0-0.16	
3	301	Layer		Modern debris	Mid bluish grey clay	30	2	0.16-0.27	
3	302	Layer		Subsoil	Light greyish brown silty clay	30	2	0.27-0.53	
3	303	Layer		Subsoil	Light yellowish brown silty clay	30	2	0.53-0.68	
3	304	Layer		Natural	Bluish grey clay and light yellowish brown silt	30	2	0.68+	
4	400	Layer		Topsoil	Dark grey clay silt	30	2	0-0.14	
4	401	Layer		Modern debris	Mid bluish grey clay	30	2	0.14-0.25	
4	402	Layer		Subsoil	Light greyish brown silty clay	30	2	0.25-0.5	
4	403	Layer		Subsoil	Light yellowish brown silty clay	30	2	0.5-0.66	
4	404	Layer		Natural	Bluish grey clay and light yellowish brown silt	30	2	0.66+	
5	500	Layer		Topsoil	Dark brown silty clay	29.7	1.9	0-0.28	
5	501	Layer		Natural	Light orange brown clay	29.7	1.9	0.28+	
5	502	Layer		Natural	Light greyish orange clay	29.7	1.9	0.28+	
6	600	Layer		Topsoil	Dark brown clay silt	31	2	0-0.22	
6	601	Layer		Subsoil	Light yellowish brown silty clay	31	2	0.22-0.3	
6	602	Layer		Natural	Yellowish brown with grey mottling silty clay	31	2	0.3+	
6	603	Cut		Furrow	Possible furrow	2	1	0.22-0.69	
6	604	Fill	603	Fill	Mid greyish yellowish brown clay silt	1	1	0.47	
Trench No.	Context No.	Type	Fill of	Context interpretation	Description	L (m)	W (m)	Depth/thickness (m)	Spot-date

6	605	Cut		Post hole	U shaped post hole with flat base	0.38	0.27	0.06	
6	606	Fill	605	Fill	Mid brownish orange silty clay	0.38	0.27	0.06	
7	700	Layer		Topsoil	Mid grey brown silty clay	30	2	0-0.25	
7	701	Layer		Subsoil	Mid yellowish brown sandy silty clay	30	2	0.25-0.5+	
7	702	Layer		Natural	Yellowish brown silty clay	30	2	0.5+	
8	800	Layer		Topsoil	Dark brown silty clay	30.4	1.9	0-0.22	
8	801	Layer		Natural	Light orange brown clay	30.4	1.9	0.22+	
8	802	Layer		Natural	Light greyish orange clay	30.4	1.9	0.22+	
9	900	Layer		Topsoil	Dark greyish brown silt	30.6	2	0-0.18	
9	901	Layer		Colluvium	Mid reddish brown clay silt	30.6	2	0.18-0.33	
9	902	Layer		Subsoil	Light yellowish brown silty clay	30.6	2	0.33-0.52	
9	903	Layer		Natural	Light bluish grey and orange silty clay with patches of limestone and flint gravels	30.6	2	0.52+	
10	1000	Layer		Topsoil	Dark greyish brown silt	30.7	2	0-0.18	
10	1001	Layer		Colluvium	Mid reddish brown clay silt	30.7	2	0.18-0.33	
10	1002	Layer		Subsoil	Light yellowish brown silty clay	30.7	2	0.33-0.52	
10	1003	Layer		Natural	Light bluish grey and orange silty clay with patches of limestone and flint gravels	30.7	2	0.52+	
11	1100	Layer		Topsoil	Dark greyish clay silt	30	2	0-0.28	
11	1101	Layer		Subsoil	Light yellowish brown silty clay	30	2	0.28-0.52	
11	1102	Layer		Natural	Light bluish grey clay with bands of light yellowish brown silty clay with occasional gravel patches	30	2	0.52+	
12	1200	Layer		Topsoil	Dark brown silty clay	32.7	1.95	0-0.24	
12	1201	Layer		Natural	Light orange brown clay	32.7	1.95	0.24+	
12	1202	Layer		Natural	Light greyish orange clay	32.7	1.95	0.24+	
12	1203	Fill	1204	Fill	Dark greyish orange sandy clay	1	3.13	0.29	
12	1204	Cut		Ditch	Moderately sloping concave and flat bottomed ditch	1.95+	3.13	0.24-0.53	
12	1205	Fill	1206	Fill	Dark orange grey silty clay	1	0.31	0.34	
12	1206	Cut		Ditch	Field boundary, moderately sloping sides and a flat base	1.95+	0.31	0.24-0.58	
13	1300	Layer		Topsoil	Dark brown silty clay	30.2	1.85	0-0.17	
13	1301	Layer		Subsoil	Light greyish brown silty clay	30.2	1.85	0.17-0.35	
13	1302	Layer		Natural	Light orange brown silty clay	30.2	1.85	0.35+	
13	1303	Layer		Natural	Light greyish brown clay	30.2	1.85	0.35+	
13	1304	Cut		Land drain	Modern land drain				
13	1305	Fill	1304	Fill	Fill of Land drain				
14	1400	Layer		Topsoil	Dark grey clay silt	29.5	2	0-0.28	
14	1401	Layer		Subsoil	Light yellowish brown silty clay	29.5	2	0.28-0.48	
14	1402	Layer		Natural	Bluish grey clay and light yellowish brown silt	29.5	2	0.48+	
14	1403	Fill	1403	Fill	Unexcavated fill of ditch				
14	1404	Cut		Ditch	Unexcavated ditch				
15	1500	Layer		Topsoil	Mid greyish brown silt	30	2	0-0.23	

Trench No.	Context No.	Type	Fill of	Context interpretation	Description	L (m)	W (m)	Depth/thickness (m)	Spot-date
15	1501	Layer		Subsoil	Light yellowish brown silty clay	30	2	0.23-0.29	
15	1502	Layer		Natural	Light bluish grey clay	30	2	0.29+	
16	1600	Layer		Topsoil	Dark greyish brown silt	30	2	0-0.24	
16	1601	Layer		Subsoil	Light yellowish brown silty clay	30	2	0.24-0.37	
16	1602	Layer		Natural	Light brownish grey and dark orangey brown silty clay	30	2	0.37+	
17	1700	Layer		Topsoil	Mid greyish brown clay silt	30	2	0-0.24	
17	1701	Layer		Subsoil	Light yellowish brown silty clay	30	2	0.24-0.34	
17	1702	Layer		Natural	Light bluish grey and light orange clay and silty clay	30	2	0.34+	
18	1800	Layer		Topsoil	Dark greyish brown clay silt	30	2	0-0.18	
18	1801	Layer		Subsoil	Light yellowish brown silty clay	30	2	0.18-0.32	
18	1802	Layer		Natural	Light bluish greyish brown clay	30	2	0.32+	
19	1900	Layer		Topsoil	Mid greyish brown silt	30	2	0-0.22	
19	1901	Layer		Subsoil	Light yellowish brown silty clay	30	2	0.22-0.36	
19	1902	Layer		Natural	Light bluish grey with light orange mottling silty clay	30	2	0.36+	
20	2000	Layer		Topsoil	Dark brown silty clay	30.1	2	0-0.28	
20	2001	Layer		Subsoil	Yellowish orange silty clay	30.1	2	0.28-0.48	
20	2002	Layer		Natural	Light orangey grey clay	30.1	2	0.48+	
20	2003	Fill	2004	Fill	Dark greyish orange silty clay	1	1.07	0.48-0.72	
20	2004	Cut		Ditch	Possible field boundary with moderately sloping convex sides and a flat base NE/SW alignment	2+	1.07	0.24	
20	2005	Fill	2006	Fill	Mid orange brown silty clay friable	1.04	2	0.16	
20	2006	Cut		Pit	Circular in plan moderate irregular convex and strait sides	1.04	2	0.16	
20	2007	Fill	2009	Fill	Light orange brown silty clay friable subangular chert and stone inclusions	1.10	1.37	0.09	
20	2008	Fill	2009	Fill	Mid orange brown silty clay friable subangular chert inclusions	1.1	1.37	0.09	
20	2009	Cut		Ditch	Linear in plan moderate strait sides flat base with a gradual concave break of slope on north side SW/NE alignment	1.1	1.37	0.18	
20	2010	Fill	2011	Fill	Mid orange brown silty clay Friable rare subangular chert inclusions	2.1	0.69	0.14	
20	2011	Cut		Gully	Linear in plan gradual strait on SE side steep concave on NW Side shallow concave base NE/SW alignment	2.1	0.69	0.14	
20	2012	Fill	2014	Fill	Dark grey silty clay friable	2.30	0.7	0.08	
20	2013	Fill	2014	Fill	Mid orange grey silty clay friable	2.3	0.7	0.05	
20	2014	Cut		ditch	Linear in plan moderate convex sides flat base SW/NE alignment	2.3	0.7	0.14	
20	2015	Fill	2017	Fill	Light grey silty clay friable	3	0.84	0.11	
20	2016	Fill	2017	Fill	Mid orange grey silty clay friable	3	0.84	0.05	
20	2017	Cut		ditch	Linear in plan gradual concave sides east side is longer than the west creating an asymmetrical profile. Flat to shallow concave base N/S	3	0.84	0.16	

Trench No.	Context No.	Type	Fill of	Context interpretation	Description	L (m)	W (m)	Depth/thickness (m)	Spot-date
21	2100	Layer		Topsoil	Dark brown silty clay friable	29.6	1.89	0-0.26	
21	2101	Layer		Subsoil	Mid orange brown silty clay Compact	29.6	1.89	0.26-0.48	
21	2102	Layer		Natural	Light orangey brown clay compact grey mottling	29.6	1.89	0.48+	
21	2103	Cut		Pit	Circular in plan rounded corners steep vertical sides flat base	0.25	0.4	0.24+	
21	2104	Fill	2103	Fill	Mid brownish grey silty clay compact malleable charcoal flecks and common subangular stone inclusions	0.25	0.37	0.24+	
21	2105	Cut		Pit	Oval in plan rounded corners steep concave sides flat base	0.48	0.28	0.14	
21	2106	Fill	2105	Fill	Mid to light yellowish grey silty clay compact malleable	0.36	0.28	0.14	
21	2107	Cut		Ditch	Linear in plan moderate strait Sides V shaped profile flat base NW/SE alignment	0.73+	0.25	0.14	
21	2108	Fill	2107	Fill	Mid brownish grey with silty clay compact malleable small stone inclusions	0.73	0.24	0.14	
21	2109	Cut		Posthole	Oval in plan rounded corners gentle concave sides flat base	0.21	0.39	0.10	
21	2110	Fill	2109	Fill	Mid/dark brownish grey silty clay compact some charcoal inclusions	0.21	0.35	0.10	

APPENDIX B: THE FINDS

Table 1: Finds concordance

Context	Description	Count	Weight(g)	Spot-date
101	Clay tobacco pipe: stem	1	3	LC16-LC19
	Slag	2	247	
109	Slag	1	59	-
1203	Roman pottery: greyware	1	3	LC13-C16
	Medieval pottery: Lacock-Nash Hill ware	1	<1	
	Slag	1	42	
1701	Medieval pottery: Lacock-Nash Hill ware	1	2	LC13-C16
2000	Medieval pottery: Lacock-Nash Hill ware	1	7	LC18-C19
	Post-medieval/modern pottery: Creamware; refined whiteware	2	5	
	Post-medieval ceramic building material	1	4	
2003	Roman pottery: fine, oxidised fabric	1	<1	RB
2104	Medieval pottery: Minety ware; sandy coarseware	3	6	MC12-LC15
	Sample <2201> Medieval pottery: Minety ware; sandy coarseware	95	10	
	Sample <2201> Worked flint: chip	1	<0.1	
2106	Sample <2202> Ceramic building material	1	<0.1	-
2108	Sample <2203> Medieval pottery: Cotswold oolitic limestone-tempered ware	3	0.4	C11-C13
	Sample <2203> Worked flint: chips	3	0.1	
	Sample <2203> Slag	1	<0.1	
2110	Sample <2204> Worked flint: chip	1	<0.1	-

APPENDIX C: THE PALAEOENVIRONMENTAL EVIDENCE

Table 2: Plant macrofossil identifications

Context number				2104	2106	2108	2110
Feature number				2103	2105	2107	2109
Sample number (SS)				2201	2202	2203	2204
Flot volume (ml)				28	5	4	1
Sample volume processed (l)				20	10	9	7
Soil remaining (l)				10	0	0	0
Period				Med	U/D	U/D	U/D
Plant macrofossil preservation				Poor	Poor	Poor	N/A
Habitat Code	Family	Species	Common Name				
E	Poaceae	<i>Triticum aestivum/ turgidum/durum</i>	Free-threshing wheat grain	+			
		<i>Poaceae</i>	Indeterminate cereal grain (fragment)	+	+	+	

Table 3: Charcoal identifications

Context number				2104	2106	2108	2110
Feature number				2103	2105	2107	2109
Sample number (SS)				2201	2202	2203	2204
Flot volume (ml)				28	5	4	1
Sample volume processed (l)				20	10	9	7
Soil remaining (l)				10	0	0	0
Period				Med	U/D	U/D	U/D
Charcoal quantity				++++	+++	+	0
Charcoal preservation				Moderate	Poor	Moderate	N/A
Family	Species	Common Name					
Fagaceae	<i>Quercus petraea</i> (Matt.) Liebl./ <i>Quercus robur</i> L.	Sessile Oak/ Pedunculate Oak	10	4	1		
		Indeterminate		6			
Total:				10	4	1	0

Key

E = Economic species

+ = 1–4 fragments; ++ = 4–20 items; +++ = 21–49 items; ++++ = 50–99 items; +++++ = 100–500 items; ++++++ = >500 items

U/D= Undated

Med = medieval

APPENDIX D: OASIS REPORT FORM

PROJECT DETAILS		
Project Name	Land South of Western Way, Bowerhill, Melksham, Wiltshire	
Short description (250 words maximum)	<p>An archaeological evaluation was undertaken by Cotswold Archaeology in November 2014 at Land South of Western Way, Bowerhill, Melksham, Wiltshire. Twenty One trenches were excavated within two fields (Fields 1 and 2). Archaeological features of likely medieval date were only identified within Trenches 20 and 21, however features of post-medieval/modern date were identified in other parts of the site.</p> <p>Trench 20 was located within the north-west of Field 2 and contained a series of undated ditch features with shallow U-shaped profiles. A shallow undated pit was also identified.</p> <p>Trench 21 was located within the north-west of Field 2 and contained two small pits, a posthole and a ditch/gully. A pit located in the north-east of the trench produced medieval Minety ware pottery dating to the 12th to 15th centuries, which may provide an indication of the date of the other undated archaeological features recorded within Trenches 20 to 21. The environmental sample evidence from the pit also suggests that this could be representative of domestic activity</p>	
Project dates	3rd to the 7th of November 2014	
Project type	Evaluation	
Previous work	Heritage Assessment (RPS 2014) and Geophysical Survey (AS 2014)	
Future work	Unknown	
PROJECT LOCATION		
Site Location	Land South of Western Way, Bowerhill, Melksham, Wiltshire	
Study area (M ² /ha)	10.5 ha	
Site co-ordinates	ST 91180 62610	
PROJECT CREATORS		
Name of organisation	Cotswold Archaeology	
Project Brief originator		
Project Design (WSI) originator	CA, RPS	
Project Manager	Damian De Rosa	
Project Supervisor	Matt Nichol	
MONUMENT TYPE	None	
SIGNIFICANT FINDS	Medieval Minety Ware Pottery	
PROJECT ARCHIVES		
	Intended final location of archive (museum/Accession no.)	Content (e.g. pottery, animal bone etc)
Physical	TBC	ceramics, animal bone glass, metalwork.
Paper	TBC	Context sheets, Trench sheets, Section drawings, registers.
Digital	TBC	Final report, digital photos.

BIBLIOGRAPHY	
---------------------	--

CA (Cotswold Archaeology) 2009 Land South of Western Way, Bowerhill, Melksham, Wiltshire <i>Archaeological Evaluation</i> . CA typescript report 14542	
---------------------------------------------------------------------------------------------------------------------------------------------------------------	--



0 1km

Reproduced from the 2007 Ordnance Survey Explorer map with the permission of Ordnance Survey on behalf of The Controller of Her Majesty's Stationery Office © Crown copyright
Cotswold Archaeology Ltd 100002109



Cirencester 01285 771022
Milton Keynes 01908 564660
Andover 01264 347630
www.cotswoldarchaeology.co.uk
enquiries@cotswoldarchaeology.co.uk

PROJECT TITLE

Land South of Western Way, Bower Hill, Melksham, Wiltshire

FIGURE TITLE

Site location plan

PROJECT NO.	5119	DATE	11-11-2014	FIGURE NO.
DRAWN BY	AO	REVISION	00	1
APPROVED BY	JB	SCALE@A4	1:25,000	

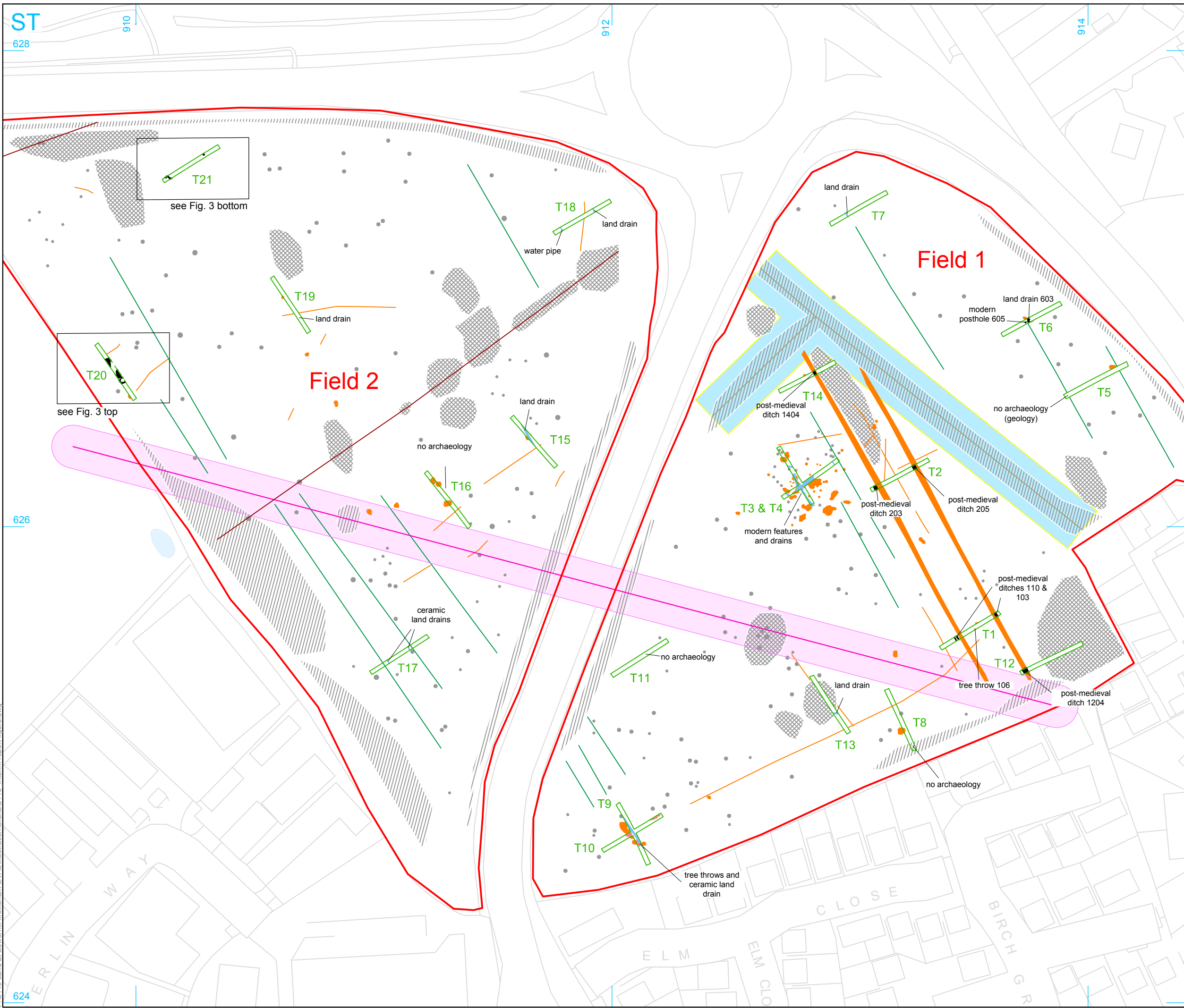

- site
- evaluation trench excavated
- overhead cable with 9m buffer
- underground service with 10m buffer
- archaeological feature
- modern feature and field drain
- treethrow

Geophysics Key
Archaeological Surveys Ltd

- Positive linear anomaly - possible ditch-like feature
- Linear anomaly - ridge and furrow
- Positive linear anomaly - former field boundary
- Discrete positive response - possible pit-like feature
- Magnetic debris - spread of magnetically thermoremanent/ferrous material
- Magnetic disturbance from ferrous material
- Strong multiple dipolar linear anomaly - pipeline / cable / service
- Strong dipolar anomaly - ferrous object



Reproduced from the Ordnance Survey Digital mapping with the permission of Ordnance Survey on behalf of The Controller of Her Majesty's Stationery Office © Crown copyright Cotswold Archaeology Ltd 100002109.

Cotswold Archaeology

Cirencester 01285 771022
 Milton Keynes 01908 564660
 Andover 01264 347630
www.cotswoldarchaeology.co.uk
enquiries@cotswoldarchaeology.co.uk

PROJECT TITLE
 Land South of Western Way, Bower Hill, Melksham, Wiltshire

FIGURE TITLE
 Trench location plan showing archaeological features

PROJECT NO. 5119	DATE 07/11/2014	FIGURE NO. 2
DRAWN BY RJH/AO	REVISION 00	
APPROVED BY JBI/ATB	SCALE@A3 1:1500	

P:\5119 Land at Bowerhill Melksham EVA\Illustration\Drafts\5119 interim report figure.dwg

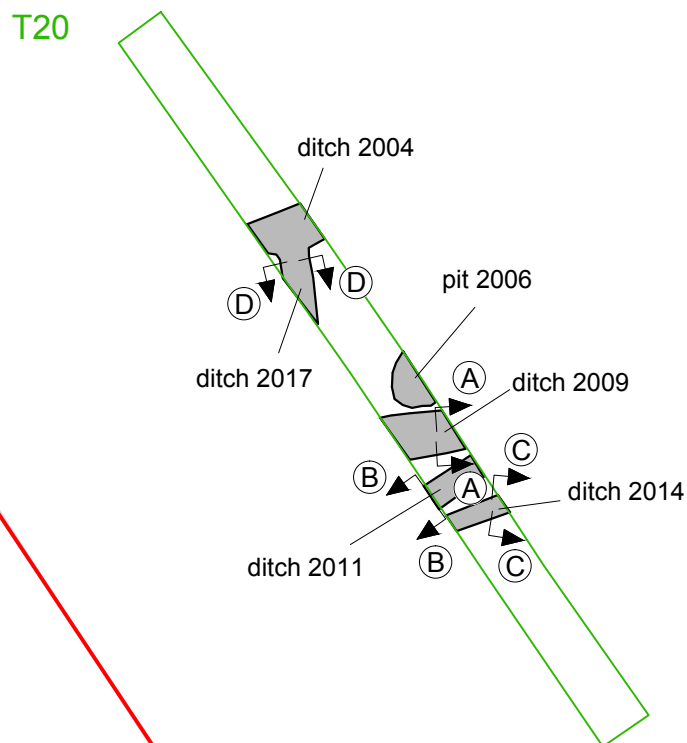
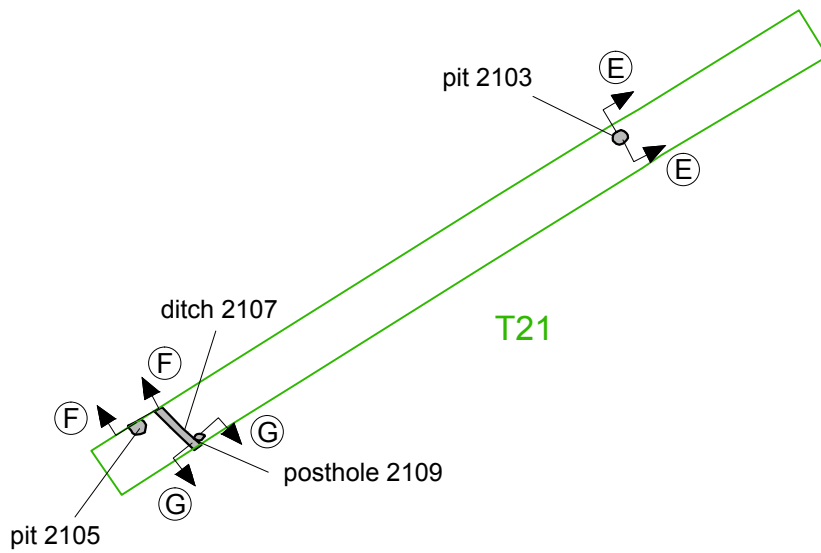

- site
- evaluation trench
- archaeological feature



Cirencester 01285 771022
 Milton Keynes 01908 564660
 Andover 01264 347630
www.cotswoldarchaeology.co.uk
enquiries@cotswoldarchaeology.co.uk

PROJECT TITLE
 Land South of Western Way, Bower Hill,
 Melksham, Wiltshire

FIGURE TITLE
Trenches 20 and 21: plans

PROJECT NO.	5119	DATE	19/11/2014	FIGURE NO.
DRAWN BY	AO	REVISION	00	3
APPROVED BY	JB/ATB	SCALE@A4	1:250	



Section AA

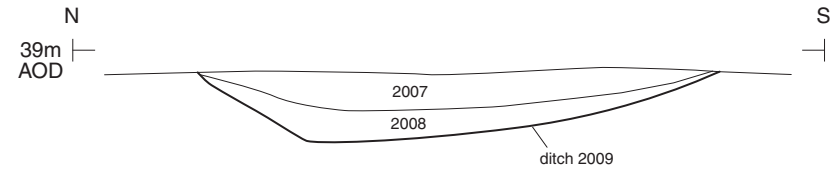

Ditch 2009, looking east (1m scale)

Section BB

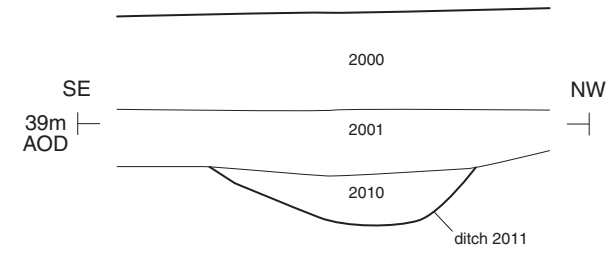

Ditch 2011, looking south-west (1m scale)

Section CC

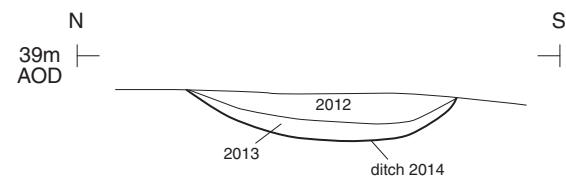

Ditch 2014, looking east (0.5m scale)

Section DD

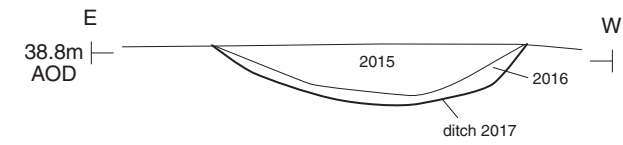

Ditch 2017, looking south (0.5m scale)



Cotswold Archaeology
 Cirencester 01285 771022
 Milton Keynes 01908 564660
 Andover 01264 347630
 www.cotswoldarchaeology.co.uk
 enquiries@cotswoldarchaeology.co.uk

PROJECT TITLE
 Land South of Western Way, Bower Hill,
 Melksham, Wiltshire

FIGURE TITLE
Trench 20: sections and photographs

PROJECT NO. 5119 DATE 18/11/2014 FIGURE NO.
 DRAWN BY AO REVISION 00 4
 APPROVED BY JB SCALE@A4 1:20



Section EE



Posthole 2103, looking north-east (0.5m scale)

Section FF

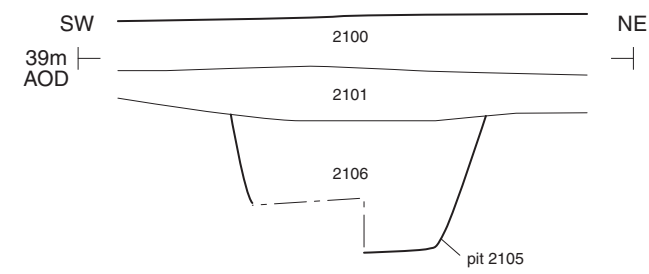

Pit 2105, looking south-west (0.5m scale)

Section GG

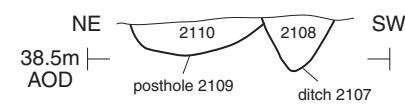

Posthole 2109 and ditch 2107, looking south-east (0.5m scale)



 **Cotswold Archaeology**
 Cirencester 01285 771022
 Milton Keynes 01908 564660
 Andover 01264 347630
 www.cotswoldarchaeology.co.uk
 enquiries@cotswoldarchaeology.co.uk

PROJECT TITLE
 Land South of Western Way, Bower Hill,
 Melksham, Wiltshire

FIGURE TITLE
Trench 21: sections and photographs