

CA Project 770519
CA Report 17089
Trumps Farm, Chertsey, Surrey
Archaeological Watching Brief

FIELDWORK SUMMARY

By Ray Kennedy

8th February 2017

In February 2017 Cotswold Archaeology (CA) carried out an archaeological watching brief for CgMs on behalf of Crest and Aviva Investors at Trumps Farm, Chertsey, Surrey (centred on NGR: SU 9876 6537; Fig. 1).

The watching brief was undertaken to fulfil a condition attached to a planning consent for the development of a small car park adjacent to Kitsmead Lane (Planning ref: RU.13/0857).

Condition 16

No development shall take place in any phase (including any ground preparation and any works causing below ground disturbance) until the applicant has secured the implementation of a programme of archaeological work for that phase (and any other phase proposed to be included) in accordance with a Written Scheme of Investigation which has been first submitted to and approved in writing by the Local Planning Authority. Development shall be carried out in accordance with the approved details.

Reason: To allow archaeological information to be recorded and to comply with saved Policy BE15 of the Runnymede Borough Local Plan Second Alteration 2001 and guidance in the NPPF.

The watching brief was carried out in accordance with Written Statement of Investigation produced by CgMs (2016) and approved by Runnymede Borough Council, the LPA, acting on the advice of Nick Truckle, Archaeological Officer (Development Control), Heritage Conservation Team, Surrey County Council. The fieldwork also followed Standard and guidance: Archaeological watching brief (ClfA 2014).

The site

The underlying solid geology on site comprises the Bagshot Formation (Sand). No superficial deposits are recorded across the majority of the site although it is probable that

Head deposits are present in the northern margins (identified by the streams at surface). The Head deposits comprise Clay, Silt, Sand and Gravel.

Archaeological Background

Research has indicated that there are no known archaeological resources within the vicinity of the site.

Aim and Objectives

The objectives of the archaeological works were:

- to monitor groundworks, and to identify, investigate and record all significant buried archaeological deposits revealed on the site during the course of the development groundworks;
- at the conclusion of the project, to produce an integrated archive for the project work and a report setting out the results of the project and the archaeological conclusions that can be drawn from the recorded data.

Methodology

The fieldwork followed the methodology set out within the WSI (CgMs 2016). An archaeologist was present during intrusive groundworks comprising the development of a small car park adjacent to Kitsmead Lane. (Fig. 2).

Results

No features or deposits of archaeological interest were observed during groundworks and, despite visual scanning of spoil, no artefactual material pre-dating the modern period was recovered.

Discussion

The watching brief identified no archaeological remains within the area of observed groundworks as the works did not go deep enough to impact the natural substrate.

References

BGS (British Geological Survey) Geology of Britain Viewer Accessed 9 February 2017

CgMs, 2016, Trumps Farm, Chertsey, Surrey, Written Statement of Investigation for an Archaeological Watching Brief.

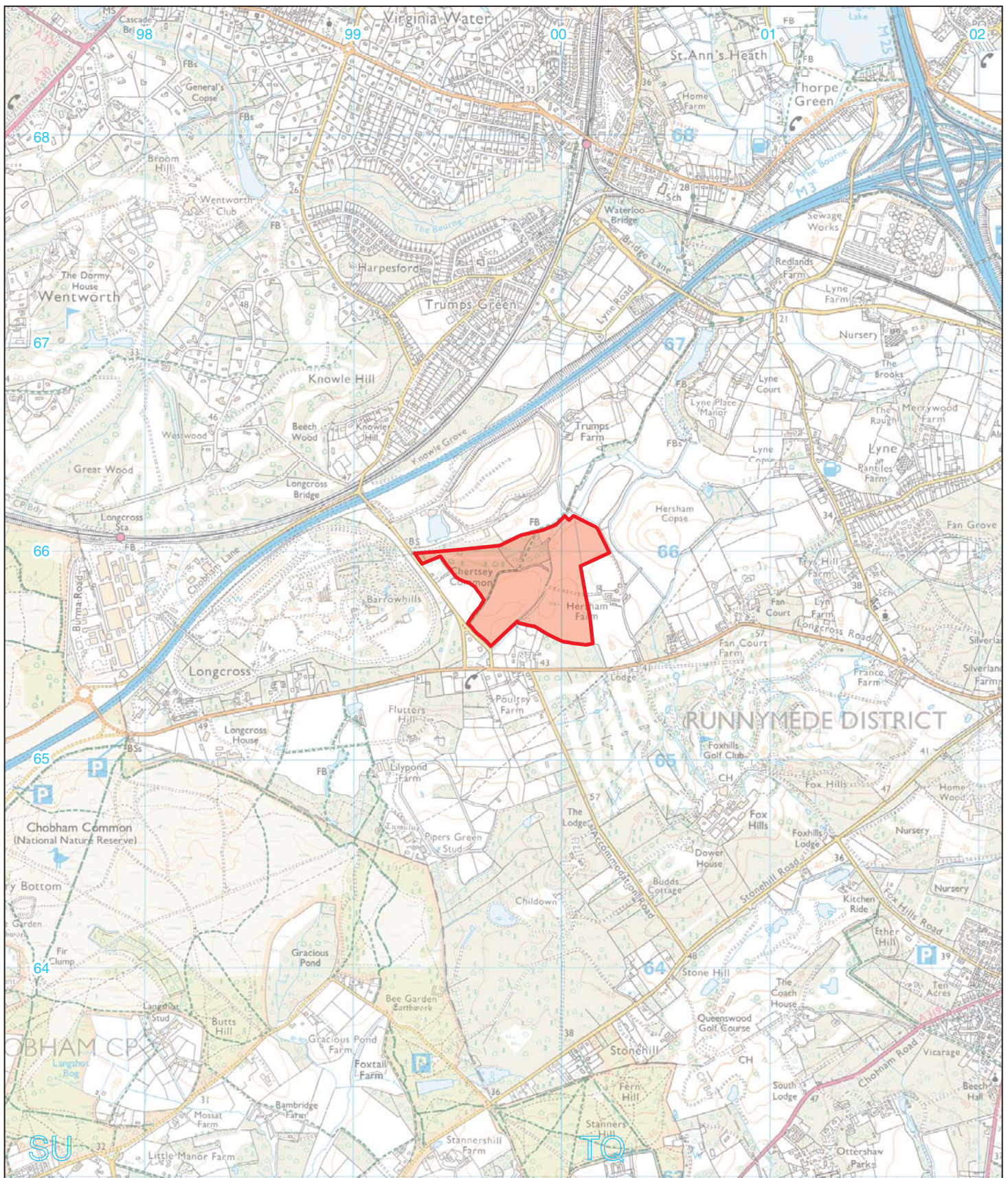

Andover 01264 347630
 Cirencester 01285 771022
 Exeter 01392 826185
 Milton Keynes 01908 564660
www.cotswoldarchaeology.co.uk
enquiries@cotswoldarchaeology.co.uk

PROJECT TITLE
 Trumps Farm, Chertsey, Surrey

FIGURE TITLE
 Site location plan

DRAWN BY	SO	PROJECT NO.	770519	FIGURE NO.
CHECKED BY	DJB	DATE	14/02/2017	
APPROVED BY	RK	SCALE @A4	1:25,000	1

Reproduced from the digital Ordnance Survey Explorer map with the permission of Ordnance Survey on behalf of The Controller of Her Majesty's Stationery Office © Crown copyright Cotswold Archaeology Ltd 100002109

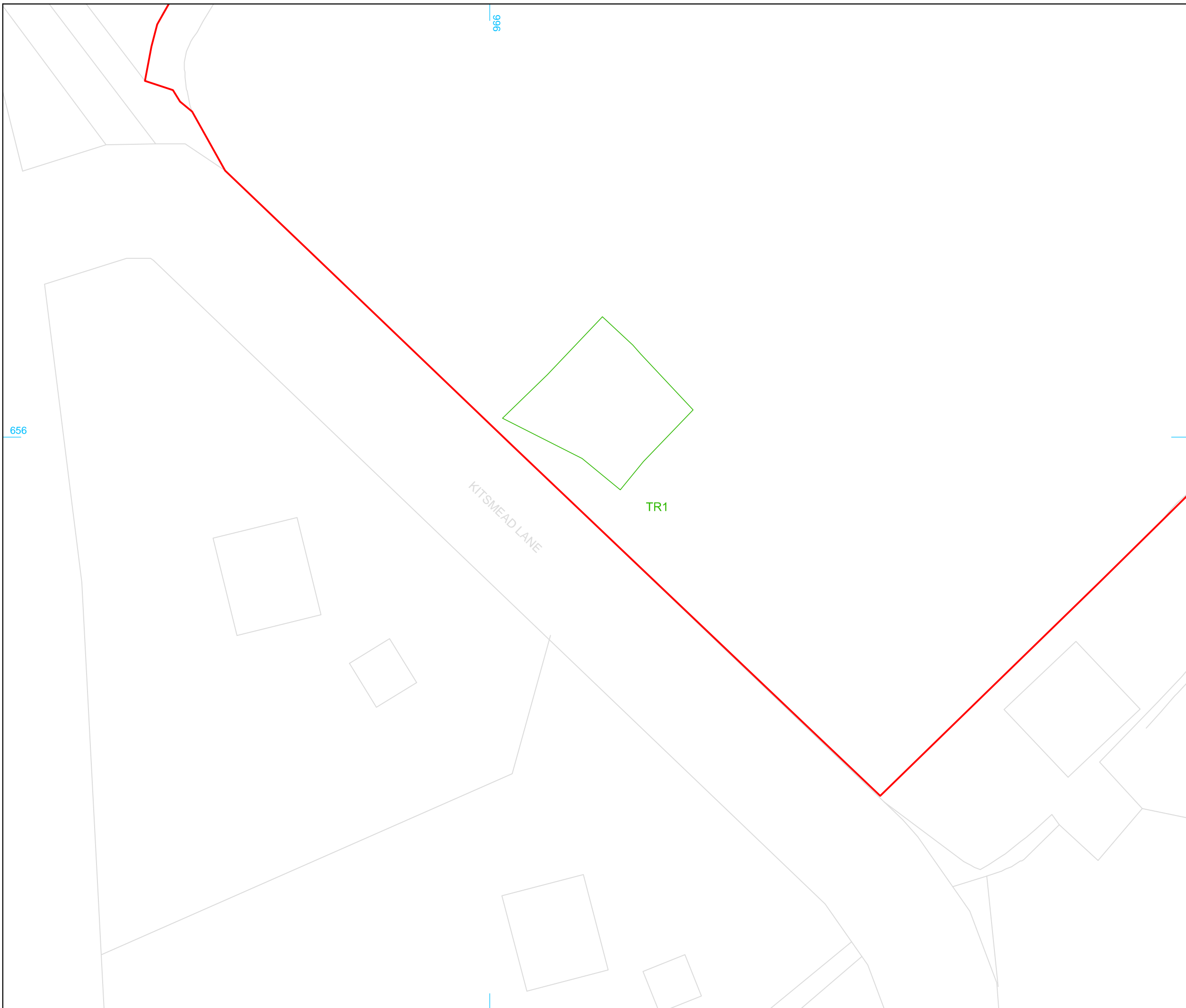

- site boundary
- excavation area



Reproduced from the Ordnance Survey digital mapping with the permission of Ordnance Survey on behalf of The Controller of Her Majesty's Stationery Office © Crown copyright Cotswold Archaeology Ltd 100002109.

Cotswold Archaeology

Andover	01264 347630
Cirencester	01285 771022
Exeter	01392 826185
Milton Keynes	01908 564660
w www.cotswoldarchaeology.co.uk	
e enquiries@cotswoldarchaeology.co.uk	

PROJECT TITLE
Trumps Farm, Chertsey, Surrey

FIGURE TITLE
Trench location plan

DRAWN BY SO	PROJECT NO. 770519	FIGURE NO.
CHECKED BY DJB	DATE 14/02/2017	2
APPROVED BY RK	SCALE@A3 1:500	



Working shot 1



Working shot 2



Working shot 3

Cotswold Archaeology
 Andover 01264 347630
 Cirencester 01285 771022
 Exeter 01392 826185
 Milton Keynes 01908 564660
www.cotswoldarchaeology.co.uk
enquiries@cotswoldarchaeology.co.uk

PROJECT TITLE
Trumps Farm, Chertsey, Surrey

FIGURE TITLE
Photographs

DRAWN BY	SO	PROJECT NO.	770519	FIGURE NO.
CHECKED BY	DJB	DATE	14/02/2017	3
APPROVED BY	RK	SCALE @A4	N/A	