

Reproduced from Ordnance Survey's 1:25 000 map of 1998 with the permission of the controller of Her Majesty's Stationery Office. Crown Copyright reserved. Licence No: AL 50125A  
 Licensee:  
 Stratascan Ltd.  
 Vineyard House  
 Upper Hook Road  
 Upton Upon Severn  
 WR8 0SA  
 OS 100km square = SU

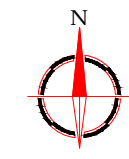

80  
79  
78  
77  
76

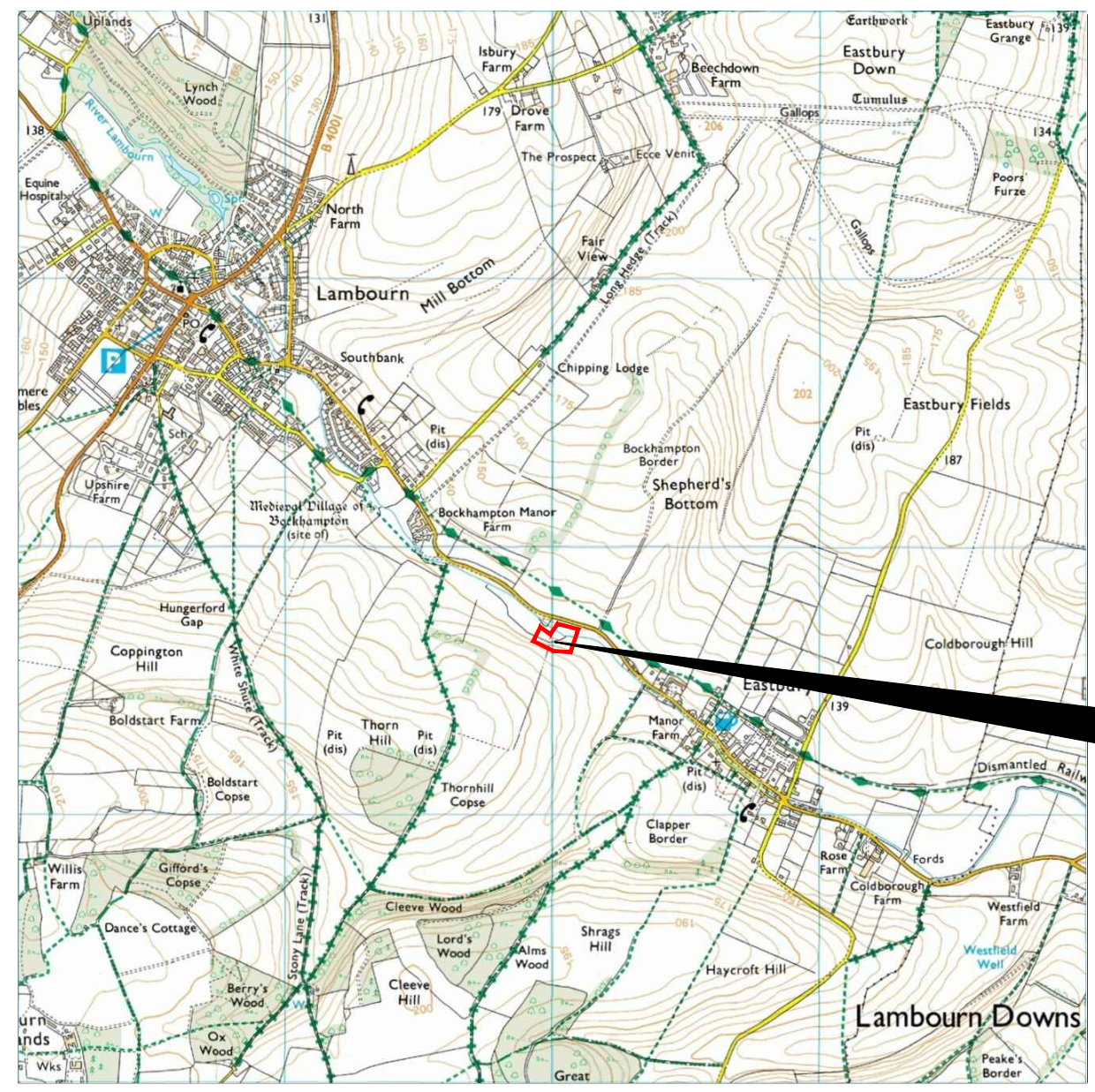

32 33 34 35 36

**Amendments**

| Issue No. | Date | Description |
|-----------|------|-------------|
| -         | -    | -           |
| -         | -    | -           |

© Stratascan Ltd - 2014



Site centred on NGR SU 340 776

Client  
**ENVIRONMENT AGENCY**

Project Title Job No. J6901  
**GEOPHYSICAL SURVEY - EASTBURY, WEST BERKSHIRE**

Subject  
**LOCATION PLAN OF SURVEY AREA**

**STRATASCAN**™  
 GEOPHYSICS FOR ARCHAEOLOGY AND ENGINEERING  
 VINEYARD HOUSE T: 01684 592266  
 UPTON UPON SEVERN E: info@stratascan.co.uk  
 WR8 0SA www.stratascan.co.uk



Scale 1:25000  
 0m 500m 1000m

|                       |                   |                  |
|-----------------------|-------------------|------------------|
| Plot<br>A3            | Checked by<br>DGE | Issue No.<br>01  |
| Survey date<br>MAY 14 | Drawn by<br>RD    | Figure No.<br>01 |

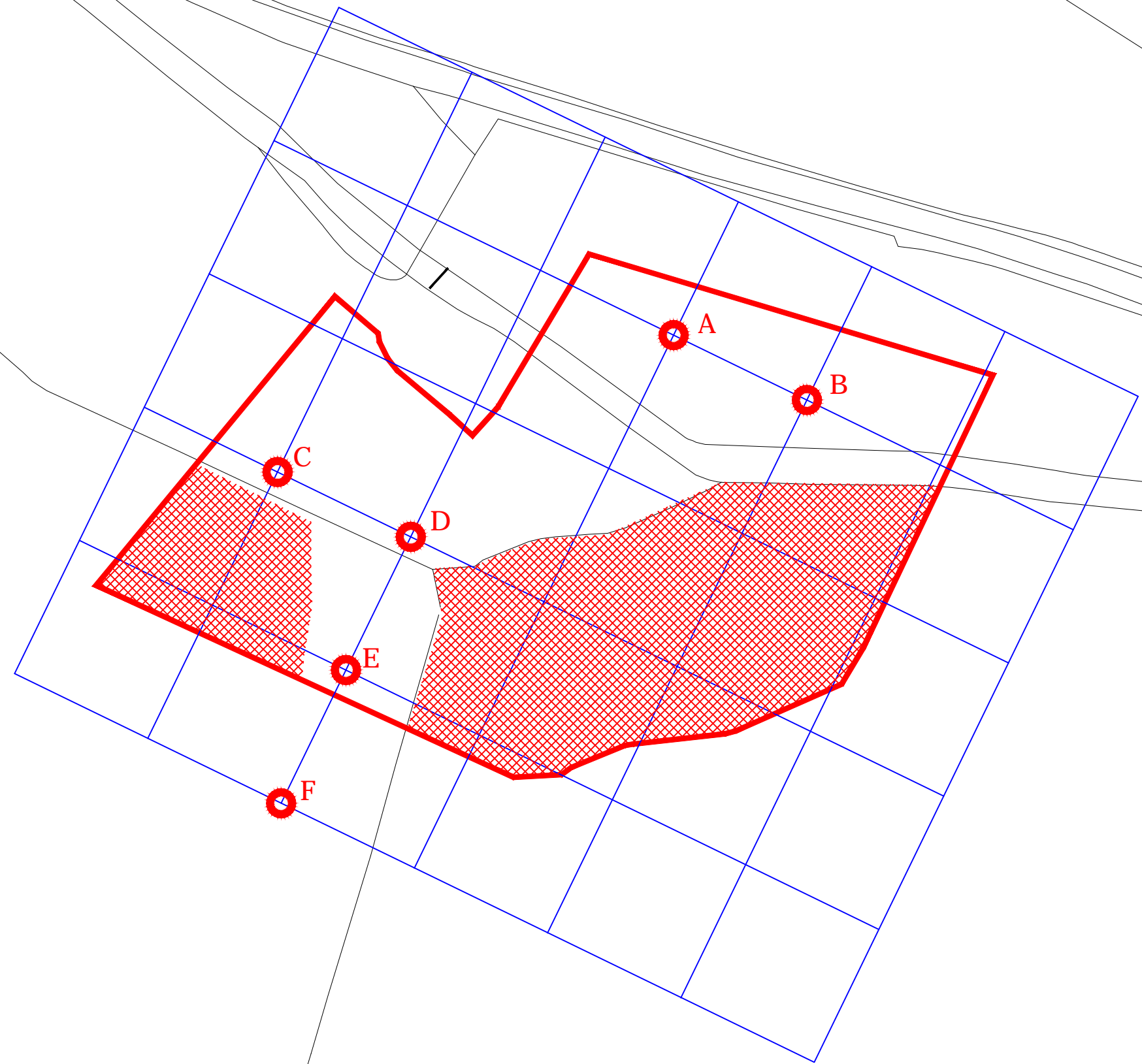

**Amendments**

| Issue No. | Date | Description |
|-----------|------|-------------|
| -         | -    | -           |
| -         | -    | -           |

© Stratascan Ltd - 2014

**KEY**

|   |                                   |
|---|-----------------------------------|
|  | Area unsurveyable - oil seed rape |
|---|-----------------------------------|

**OS GRID REFERENCES**

|          |                      |
|----------|----------------------|
| <b>A</b> | 434042.47, 177687.93 |
| <b>B</b> | 434069.45, 177674.80 |
| <b>C</b> | 433962.27, 177660.23 |
| <b>D</b> | 433989.25, 177647.10 |
| <b>E</b> | 433976.12, 177620.13 |
| <b>F</b> | 433962.99, 177593.15 |

Client  
**ENVIRONMENT AGENCY**

Project Title Job No. J6901  
**GEOPHYSICAL SURVEY - EASTBURY,  
WEST BERKSHIRE**

Subject  
**LOCATION OF SURVEY GRIDS AND  
REFERENCING**

**STRATASCAN™**  
GEOPHYSICS FOR ARCHAEOLOGY  
AND ENGINEERING  
VINEYARD HOUSE T: 01684 592266  
UPTON UPON SEVERN E: info@stratascan.co.uk  
WR8 0SA www.stratascan.co.uk

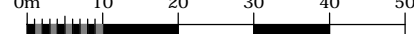

Scale 1: 1000 

|                              |                          |                         |
|------------------------------|--------------------------|-------------------------|
| Plot<br><b>A3</b>            | Checked by<br><b>DGE</b> | Issue No.<br><b>01</b>  |
| Survey date<br><b>MAY 14</b> | Drawn by<br><b>RD</b>    | Figure No.<br><b>02</b> |





**Amendments**

| Issue No. | Date | Description |
|-----------|------|-------------|
| -         | -    | -           |
| -         | -    | -           |

© Stratascan Ltd - 2014

Plotting parameters

Maximum + 100nT (red)  
Minimum - 100nT (blue)

Client  
**ENVIRONMENT AGENCY**

Project Title Job No. J6901  
**GEOPHYSICAL SURVEY - EASTBURY,  
WEST BERKSHIRE**

Subject  
**COLOUR PLOT OF GRADIOMETER  
DATA SHOWING EXTREME VALUES**

**STRATASCAN™**  
GEOPHYSICS FOR ARCHAEOLOGY  
AND ENGINEERING  
VINEYARD HOUSE T: 01684 592266  
UPTON UPON SEVERN E: info@stratascan.co.uk  
WR8 0SA www.stratascan.co.uk



Scale **1:750**

|                              |                          |                         |
|------------------------------|--------------------------|-------------------------|
| Plot<br><b>A3</b>            | Checked by<br><b>DGE</b> | Issue No.<br><b>01</b>  |
| Survey date<br><b>MAY 14</b> | Drawn by<br><b>RD</b>    | Figure No.<br><b>03</b> |



**Amendments**

| Issue No. | Date | Description |
|-----------|------|-------------|
| -         | -    | -           |
| -         | -    | -           |

© Stratascan Ltd - 2014

Plotting parameters

Maximum +2nT (black)  
Minimum -2nT (white)

Zero Mean

Client  
**ENVIRONMENT AGENCY**

Project Title Job No. J6901  
**GEOPHYSICAL SURVEY - EASTBURY,  
WEST BERKSHIRE**

Subject  
**PLOT OF MINIMALLY PROCESSED  
GRADIOMETER DATA**

**STRATASCAN™**  
GEOPHYSICS FOR ARCHAEOLOGY  
AND ENGINEERING  
VINEYARD HOUSE T: 01684 592266  
UPTON UPON SEVERN E: info@stratascan.co.uk  
WR8 0SA www.stratascan.co.uk



Scale **1:750**  
0m 5 15 30m

|                              |                          |                         |
|------------------------------|--------------------------|-------------------------|
| Plot<br><b>A3</b>            | Checked by<br><b>DGE</b> | Issue No.<br><b>01</b>  |
| Survey date<br><b>MAY 14</b> | Drawn by<br><b>RD</b>    | Figure No.<br><b>04</b> |

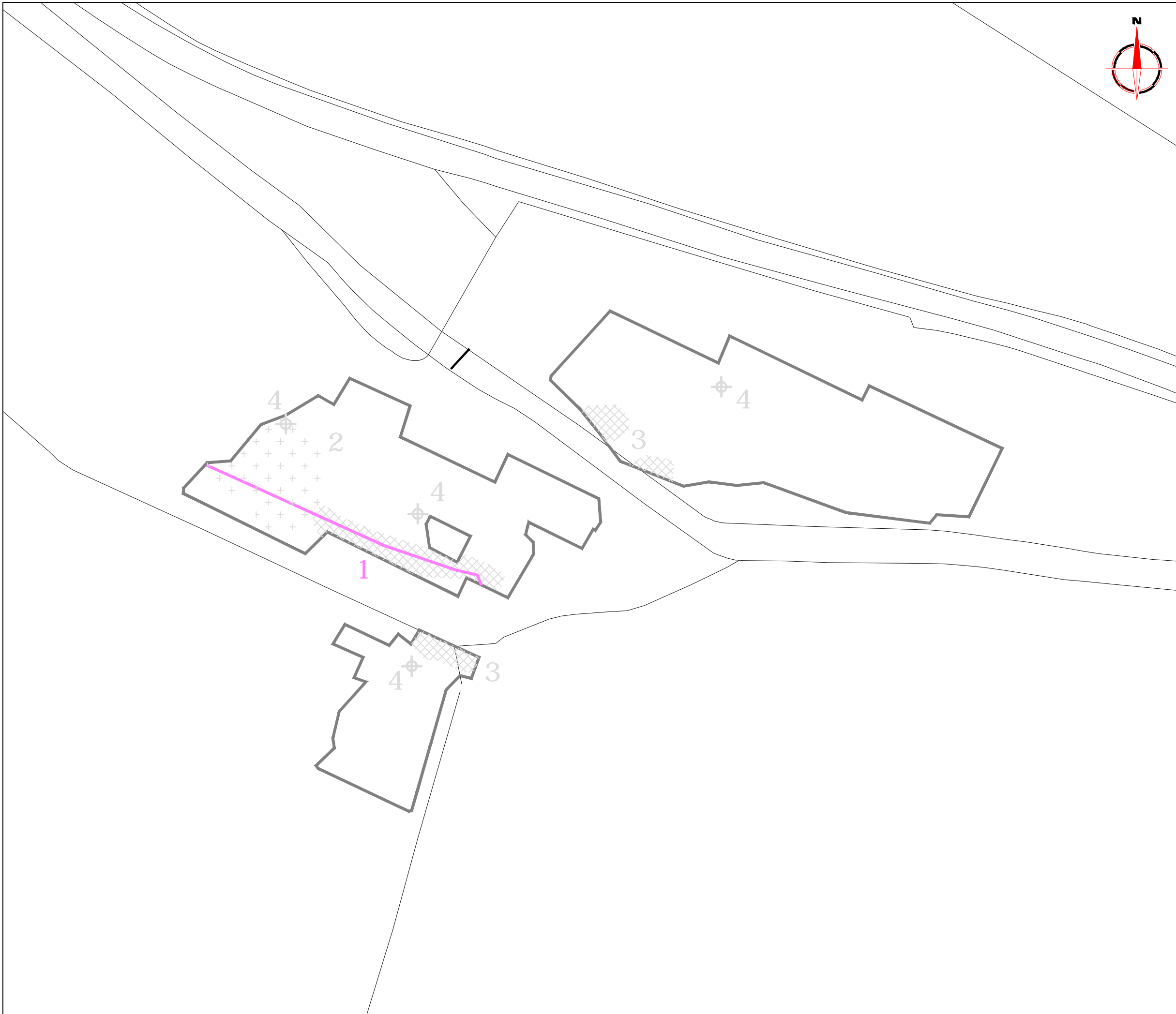

| Amendments   |  |  |
|--|--|--|
| Issue No.  | Date   | Description                                      |
| -  | -  | -  |
| -  | -  | -  |
| © Stratascan Ltd - 2014  |  |  |
| KEY  |  |  |
| PROBABLE ARCHAEOLOGY   |  |  |
|  | Positive anomaly / weak positive anomaly - probable cut feature of archaeological origin               |  |
|  | Negative anomaly / weak negative anomaly - probable bank or earthwork of archaeological origin         |  |
|  | Moderate strength discrete anomaly - probable thermoremanent feature                                   |  |
|  | Widely spaced curving parallel linear anomalies - probably related to ridge-and-furrow                 |  |
| POSSIBLE ARCHAEOLOGY   |  |  |
|  | Positive anomaly / weak positive anomaly - possible cut feature of archaeological origin               |  |
|  | Negative anomaly / weak negative anomaly - possible bank or earthwork of archaeological origin         |  |
|  | Moderate strength discrete anomaly - possible thermoremanent feature                                   |  |
| OTHER ANOMALIES  |  |  |
|  | Closely spaced parallel linear anomalies - probably related to agricultural activity such as ploughing |  |
|  | Linear anomaly - probably related to pipe, cable or other modern service                               |  |
|  | Linear anomaly - possibly related to land drain  |  |
|  | Magnetic disturbance associated with nearby metal object such as service or field boundary             |  |
|  | Strong magnetic debris - possible disturbed or made ground   |  |
|  | Scattered magnetic debris  |  |
|  | Area of amorphous magnetic variation - probable natural (e.g. geological or pedological) origin        |  |
|  | Magnetic spike - probable ferrous object   |  |
| Client   |  |  |
| <b>ENVIRONMENT AGENCY</b>                                      |  |  |
| Project Title  |  | Job No. J6901                                    |
| <b>GEOPHYSICAL SURVEY - EASTBURY, WEST BERKSHIRE</b>           |  |  |
| Subject  |  |  |
| <b>ABSTRACTION AND INTERPRETATION OF GRADIOMETER ANOMALIES</b> |  |  |
| <b>STRATASCAN™</b>   |  |  |
| GEOPHYSICS FOR ARCHAEOLOGY AND ENGINEERING                     |  |  |
| VINEYARD HOUSE   |  | T: 01684 592266                                  |
| UPTON UPON SEVERN  | WR8 0SA  | E: info@stratascan.co.uk<br>www.stratascan.co.uk |
|  |  |  |
|  | SUMO GROUP MEMBER  |  |
| Scale  |  |  |
| 1: 750   |  |  |
| Plot   | Checked by   | Issue No.  |
| A3   | DGE  | 01   |
| Survey date  | Drawn by   | Figure No.                                       |
| MAY 14   | RD   | 05   |