

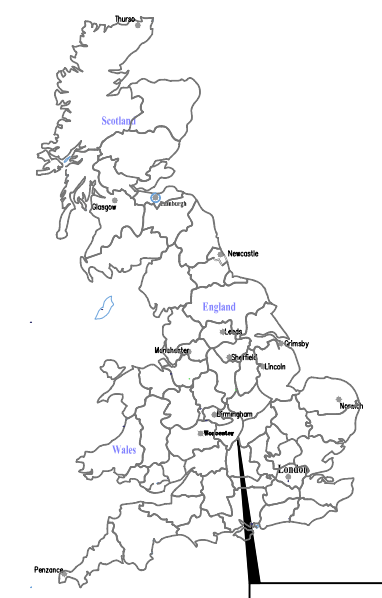

Amendments

Issue No.	Date	Description
-	-	-
-	-	-

© Stratascan Ltd - 2014



Site centred on NGR SP 466 462

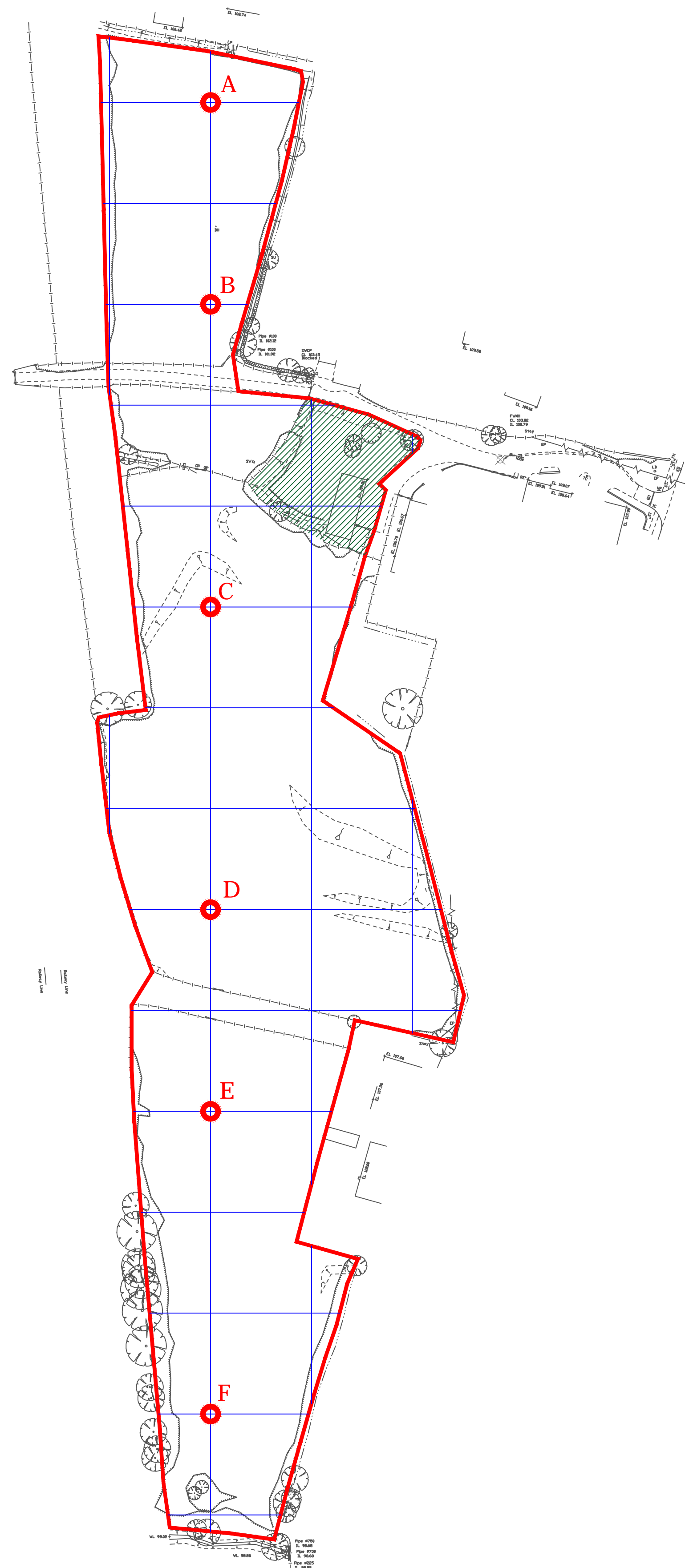

Reproduced from Ordnance Survey's 1:25 000 map of 1998 with the permission of the controller of Her Majesty's Stationary Office. Crown Copyright reserved. Licence No. AL 50125A

Licensee:
Stratascan Ltd.
Vineyard House
Upper Hook Road
Upton Upon Severn
WR8 0SA

OS 100km square = SP

KEY

Area unsurveyable - overgrown vegetation

OS REFERENCING INFORMATION

A	446582.04, 246530.68
B	446582.04, 246470.68
C	446582.04, 246380.68
D	446582.04, 246290.68
E	446582.04, 246230.68
F	446582.04, 246140.68

Job No. J7430 Survey Date NOV 14

Client
CgMs CONSULTING LTD

Project Title
CROPREDY, OXFORDSHIRE

Subject
SITE LOCATION, SURVEY AREA & REFERENCING

STRATASCAN™
GEOPHYSICS FOR ARCHAEOLOGY AND ENGINEERING

VINEYARD HOUSE UPTON UPON SEVERN WR8 0SA
T: 01684 592266
E: info@stratascan.co.uk
www.stratascan.co.uk



Scale 1:1000
0m 10 20 30 40 50 60m

Plot A1	Checked by DGE	Issue No. P1
Date NOV 14	Drawn by TR	Figure No. 01

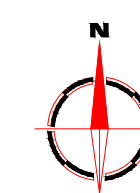
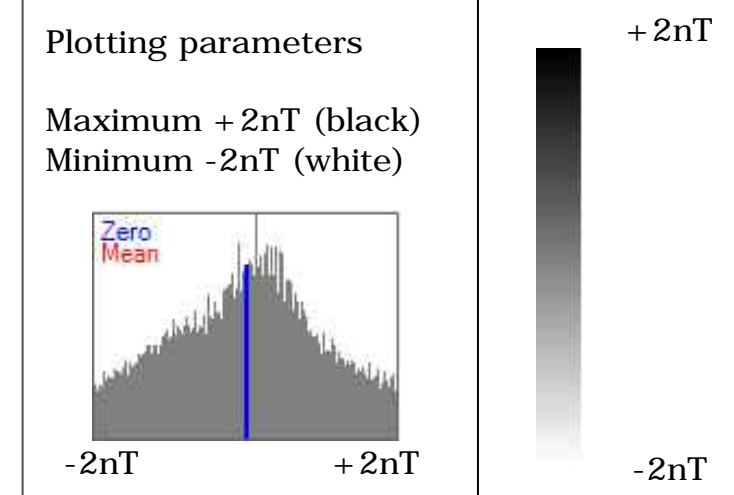
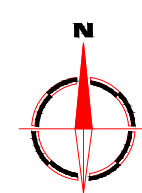
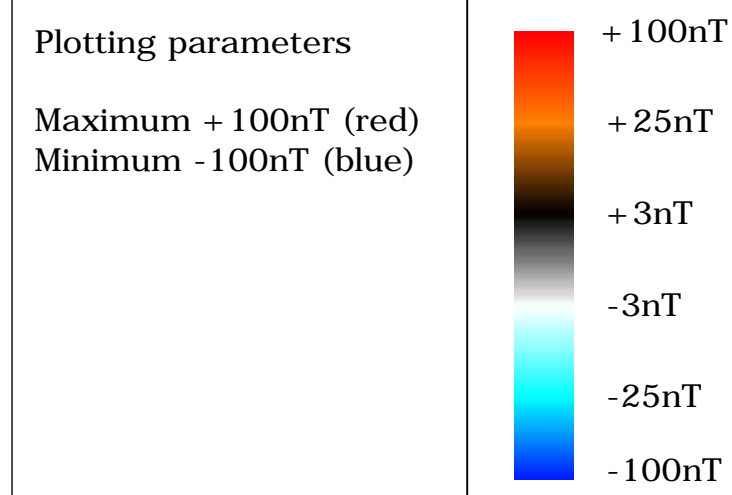

Amendments		
Issue No.	Date	Description
-	-	-
-	-	-
© Stratascan Ltd - 2014		

Job No. J7430 Survey Date NOV 14

Client CgMs CONSULTING LTD

Project Title CROPREDY, OXFORDSHIRE

Subject GRADIOMETER DATA

STRATASCANTM
GEOPHYSICS FOR ARCHAEOLOGY
AND ENGINEERING
VINEYARD HOUSE T: 01684 592266
UPTON UPON SEVERN E: info@stratascan.co.uk
WR8 0SA www.stratascan.co.uk



Scale 1:1000 0m 10 20 30 40 50 60m

Plot A1	Checked by DGE	Issue No. P1
Date NOV 14	Drawn by TR	Figure No. 02

COLOUR PLOT OF GRADIOMETER DATA SHOWING EXTREME VALUES

GREYSCALE PLOT OF GRADIOMETER DATA

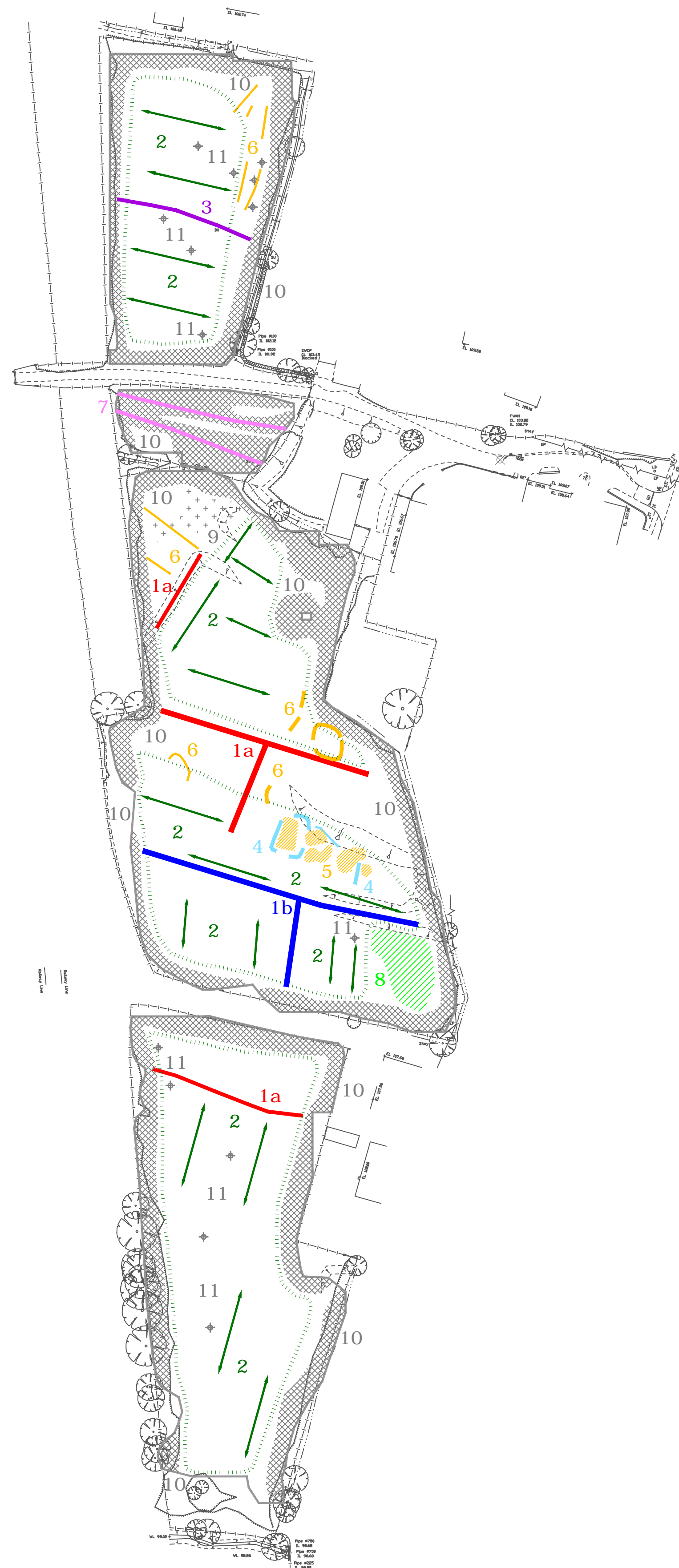

Amendments

Issue No.	Date	Description
-	-	-
-	-	-
-	-	-

© Stratascan Ltd - 2014

KEY

PROBABLE ARCHAEOLOGY

- Positive anomaly / weak positive anomaly - probable cut feature of archaeological origin
- Negative anomaly / weak negative anomaly - probable bank or earthwork of archaeological origin
- Linear anomaly - probable post-medieval field boundary not present on available mapping
- Widely spaced curving parallel linear anomalies - probably related to ridge-and-furrow

POSSIBLE ARCHAEOLOGY

- Positive anomaly / weak positive anomaly - possible cut feature of archaeological origin
- Negative anomaly / weak negative anomaly - possible bank or earthwork of archaeological origin

OTHER ANOMALIES

- Closely spaced parallel linear anomalies - probably related to agricultural activity such as ploughing
- Linear anomaly - probably related to pipe, cable or other modern service
- Linear anomaly - possibly related to land drain
- Magnetic disturbance associated with nearby metal object such as service or field boundary
- Strong positive, with associated negative anomaly - unknown origin
- Scattered magnetic debris
- Area of amorphous magnetic variation - probable natural (e.g. geological or pedological) origin
- Magnetic spike - probable ferrous object

Job No.	J7430	Survey Date	NOV 14
---------	-------	-------------	--------

Client
CgMs CONSULTING LTD

Project Title
CROPREDY, OXFORDSHIRE

Subject
ABSTRACTION AND INTERPRETATION OF GRADIOMETER ANOMALIES

STRATASCAN™
GEOPHYSICS FOR ARCHAEOLOGY AND ENGINEERING
VINEYARD HOUSE T: 01684 592266
UPTON UPON SEVERN E: info@stratascan.co.uk
WR8 0SA www.stratascan.co.uk

GPR ASSOCIATION
SUMO GROUP MEMBER
ISO 9001 certified
ISO 14001 certified

Scale
1:1000
0m 10 20 30 40 50 60m

Plot	A1	Checked by	DGE	Issue No.	P1
Date	NOV 14	Drawn by	TR	Figure No.	03