

Reproduced from Ordnance Survey's 1:25 000 map of 1998 with the permission of the controller of Her Majesty's Stationary Office. Crown Copyright reserved. Licence No: AL 50125A
Licencee:
Stratascan Ltd.
Vineyard House
Upper Hook Road
Upton Upon Severn
WR8 0SA

OS 100km square = ST

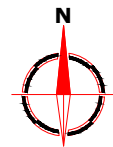

Amendments

Issue No.	Date	Description
-	-	-
-	-	-

© Stratascan Ltd - 2014



Site centred on NGR ST 672 185

Client
COTSWOLD ARCHAEOLOGY

Project Title Job No. J6647
MILBORNE PORT, SOMERSET

Subject
LOCATION PLAN OF SURVEY AREA

STRATASCAN™

GEOPHYSICS FOR ARCHAEOLOGY
AND ENGINEERING

VINEYARD HOUSE T: 01684 592266
UPTON UPON SEVERN E: info@stratascan.co.uk
WR8 0SA www.stratascan.co.uk

EUROPEAN
GPR
ASSOCIATION



SUMO
Survey Services

SUMO
GROUP
MEMBER



Scale 1:25000 0m 500 1000m

Plot A3	Checked by DGE	Issue No. 01
Survey date APR 14	Drawn by TR	Figure No. 01

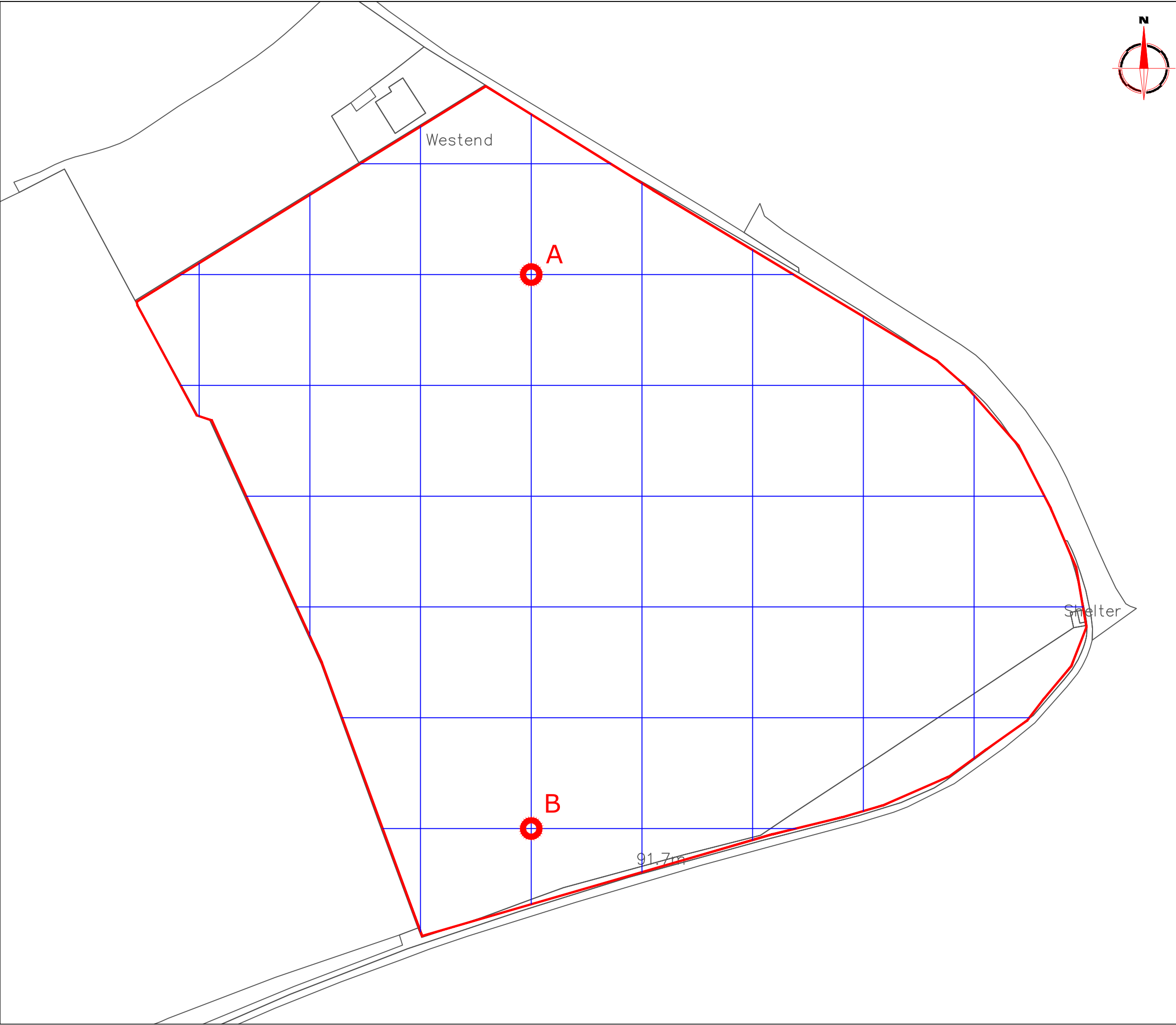

Amendments

Issue No.	Date	Description
-	-	-
-	-	-

© Stratascan Ltd - 2014

OS GRID REFERENCES

A	367186.45, 118671.82
B	367186.45, 118521.82

Client
COTSWOLD ARCHAEOLOGY

Project Title
MILBORNE PORT, SOMERSET

Job No. J6647

Subject
LOCATION OF SURVEY GRIDS AND
REFERENCING

STRATASCAN™
GEOPHYSICS FOR ARCHAEOLOGY
AND ENGINEERING

VINEYARD HOUSE T: 01684 592266
UPTON UPON SEVERN E: info@stratascan.co.uk
WR8 0SA www.stratascan.co.uk

EUROPEAN GPR ASSOCIATION

sumo SUMO GROUP MEMBER

REGISTERED ORGANISATION

ims ISO 9001 certified

ims ISO 14001 certified

Scale 1:1000 0m 10 20 30 40 50

Plot A3	Checked by DGE	Issue No. 01
Survey date APR 14	Drawn by TR	Figure No. 02

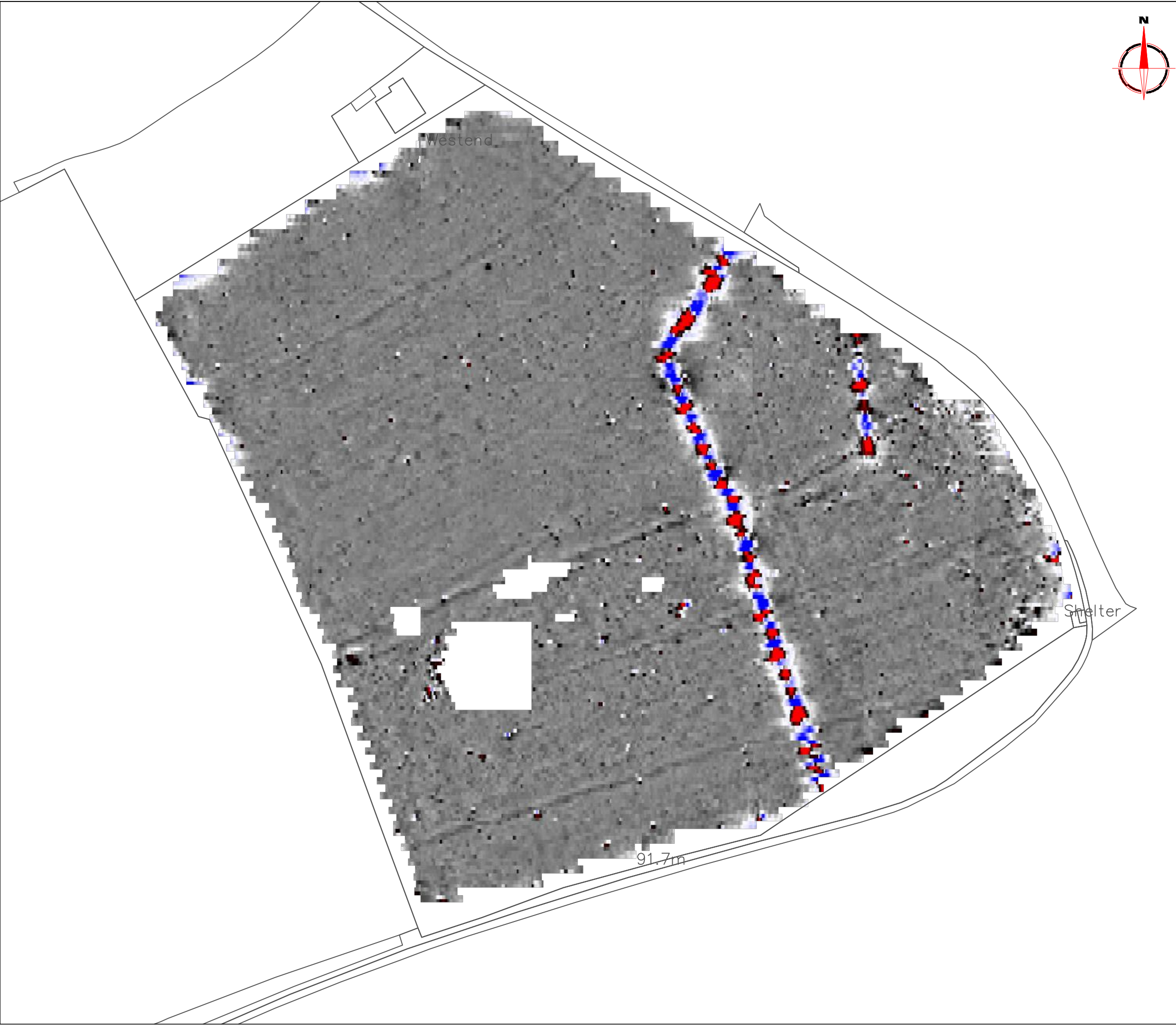

Amendments		
Issue No.	Date	Description
-	-	-
-	-	-
© Stratascan Ltd - 2014		
Plotting parameters		<div><div></div><div>+100nT</div><div>+10nT</div><div>-10nT</div><div>-100nT</div></div>
Maximum +100nT (red)		
Minimum -100nT (blue)		
Client		
COTSWOLD ARCHAEOLOGY		
Project Title		Job No. J6647
MILBORNE PORT, SOMERSET		
Subject		
COLOUR PLOT OF GRADIOMETER DATA SHOWING EXTREME VALUES		
<div><div>STRATASCAN™</div><div>GEOPHYSICS FOR ARCHAEOLOGY AND ENGINEERING</div><div>VINEYARD HOUSE UPTON UPON SEVERN WR8 0SA</div><div>T: 01684 592266 E: info@stratascan.co.uk www.stratascan.co.uk</div><div><div>EUROPEAN GPR ASSOCIATION</div><div>SURVEY SERVICES</div><div>SUMO GROUP MEMBER</div><div>REGISTERED ORGANISATION</div><div>ims ISO 9001 certified</div><div>UKAS MANAGEMENT SYSTEMS 078</div><div>ims ISO 14001 certified</div><div>UKAS ENVIRONMENTAL MANAGEMENT SYSTEMS 078</div></div></div>		
Scale 1:1000 <div>0m 10 20 30 40 50</div>		
Plot	Checked by	Issue No.
A3	DGE	01
Survey date	Drawn by	Figure No.
APR 14	TR	03



Amendments

Issue No.	Date	Description
-	-	-
-	-	-

© Stratascan Ltd - 2014

Plotting parameters

Maximum +2nT (black)
Minimum -2nT (white)

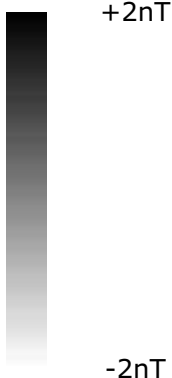
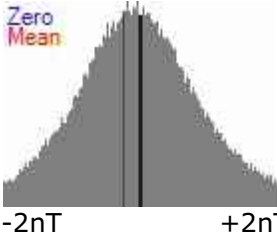

Client
COTSWOLD ARCHAEOLOGY

Project Title
MILBORNE PORT, SOMERSET

Job No.
J6647

Subject
PLOT OF MINIMALLY PROCESSED
GRADIOMETER DATA

STRATASCAN™
GEOPHYSICS FOR ARCHAEOLOGY
AND ENGINEERING
VINEYARD HOUSE
UPTON UPON SEVERN
WR8 0SA
T: 01684 592266
E: info@stratascan.co.uk
www.stratascan.co.uk

Scale
1:1000
0m 10 20 30 40 50

Plot
A3

Checked by
DGE

Issue No.
01

Survey date
APR 14

Drawn by
TR

Figure No.
04

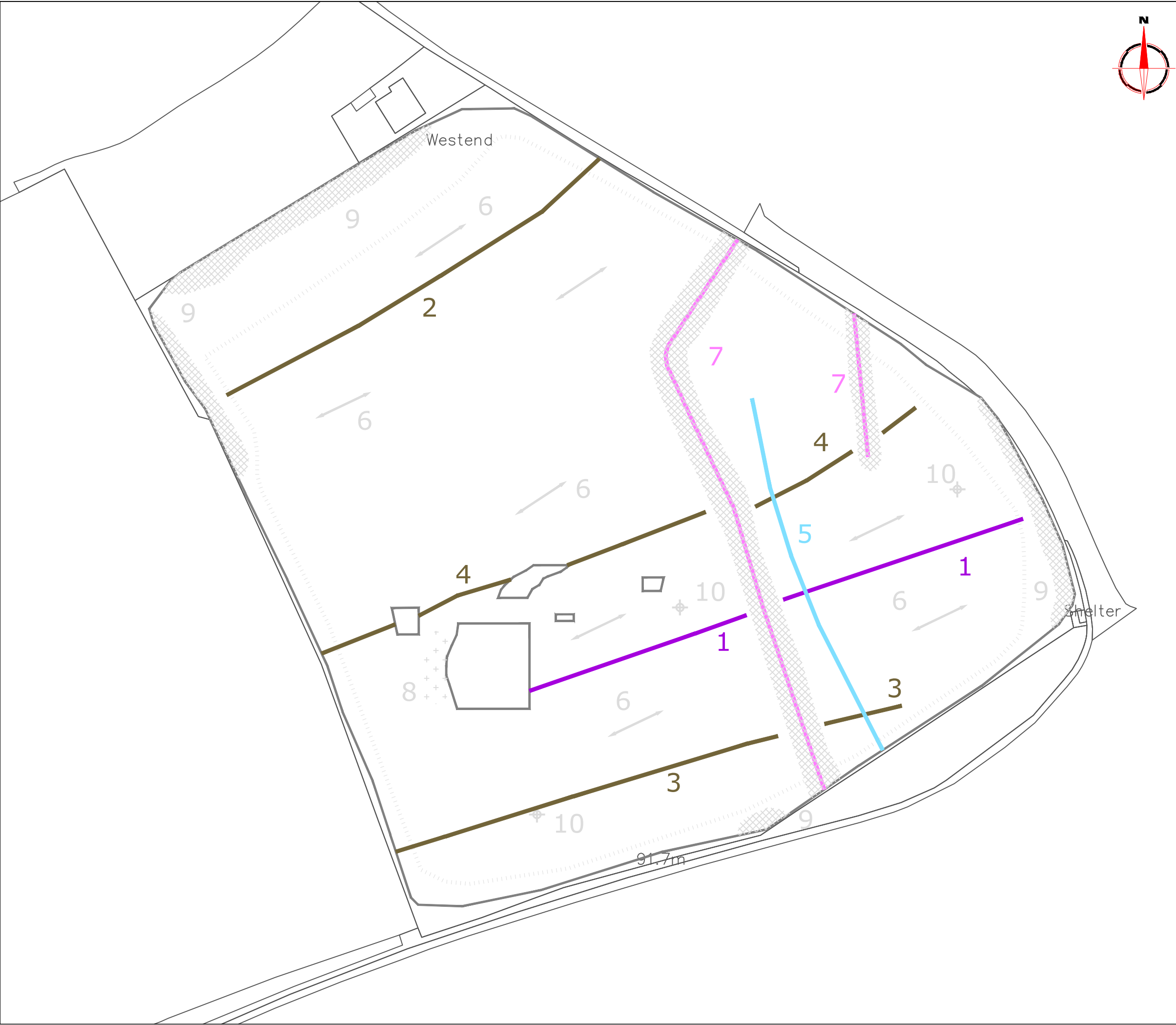

Amendments		
Issue No.	Date	Description
-	-	-
-	-	-
© Stratascan Ltd - 2014		
KEY		
PROBABLE ARCHAEOLOGY		
	Positive anomaly / weak positive anomaly - probable cut feature of archaeological origin	
	Negative anomaly / weak negative anomaly - probable bank or earthwork of archaeological origin	
	Linear anomaly - probable former field boundary not present on available mapping	
	Linear anomaly - former field boundary present on available mapping pre-1900	
	Widely spaced curving parallel linear anomalies - probably related to ridge-and-furrow	
POSSIBLE ARCHAEOLOGY		
	Positive anomaly / weak positive anomaly - possible cut feature of archaeological origin	
	Negative anomaly / weak negative anomaly - possible bank or earthwork of archaeological origin	
OTHER ANOMALIES		
	Closely spaced parallel linear anomalies - probably related to agricultural activity such as ploughing	
	Linear anomaly - probably related to pipe, cable or other modern service	
	Linear anomaly - possibly related to land drain	
	Magnetic disturbance associated with nearby metal object such as service or field boundary	
	Strong magnetic debris - possible disturbed or made ground	
	Scattered magnetic debris	
	Area of amorphous magnetic variation - probable natural (e.g. geological or pedological) origin	
	Magnetic spike - probable ferrous object	
Client		
COTSWOLD ARCHAEOLOGY		
Project Title		
Job No. J6647		
MILBORNE PORT, SOMERSET		
Subject		
ABSTRACTION AND INTERPRETATION OF GRADIOMETER ANOMALIES		
GEOPHYSICS FOR ARCHAEOLOGY AND ENGINEERING		
VINEYARD HOUSE		
T: 01684 592266		
UPTON UPON SEVERN		
E: info@stratascan.co.uk		
WR8 0SA		
www.stratascan.co.uk		
SUMO GROUP MEMBER		
Scale		
1:1000		
Plot	Checked by	Issue No.
A3	DGE	01
Survey date	Drawn by	Figure No.
APR 14	TR	05