

Reproduced from Ordnance Survey's 1:25 000 map of 1998 with the permission of the controller of Her Majesty's Stationery Office. Crown Copyright reserved. Licence No: AL 50125A
 Licencee:
 Stratascan Ltd.
 Vineyard House
 Upper Hook Road
 Upton Upon Severn
 WR8 0SA
 OS 100km square = SU

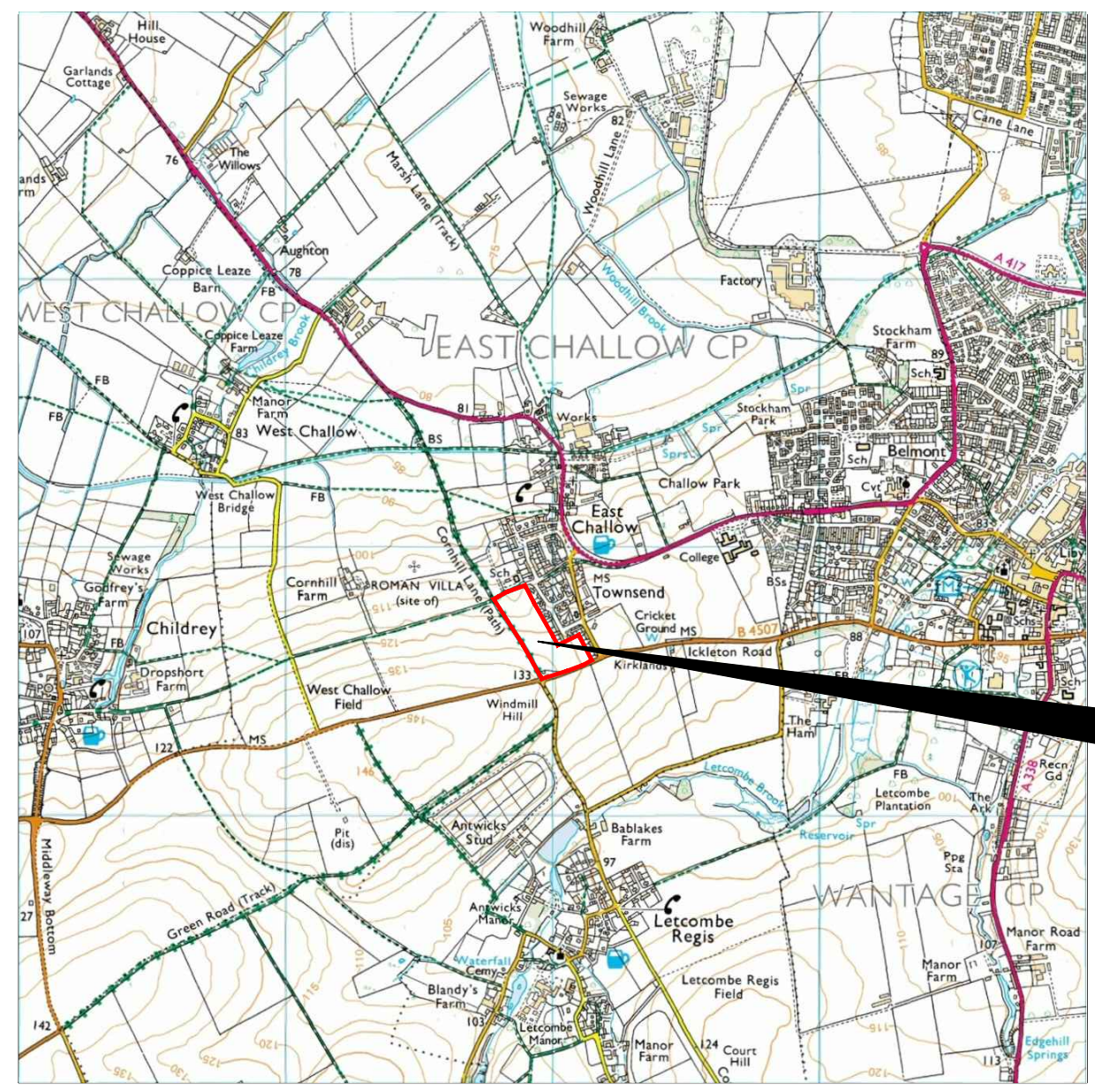

90
89
88
87
86



36 37 38 39 40

Amendments

Issue No.	Date	Description
-	-	-
-	-	-

© Stratascan Ltd - 2014



Site centred on NGR SU 378 877

Client
OXFORD ARCHAEOLOGY

Project Title Job No. J6649
EAST CHALLOW, OXFORDSHIRE

Subject
LOCATION PLAN OF SURVEY AREA

STRATASCAN™
GEOPHYSICS FOR ARCHAEOLOGY AND ENGINEERING
 VINEYARD HOUSE T: 01684 592266
 UPTON UPON SEVERN E: info@stratascan.co.uk
 WR8 0SA www.stratascan.co.uk

EUROPEAN GPR ASSOCIATION
SUMO SURVEYS SUMO GROUP MEMBER
 ISO 9001 certified UKAS ISO 14001 certified

Scale 1:25000 0m 500m 1000m

Plot A3	Checked by DGE	Issue No. 01
Survey date APR 14	Drawn by TR	Figure No. 01

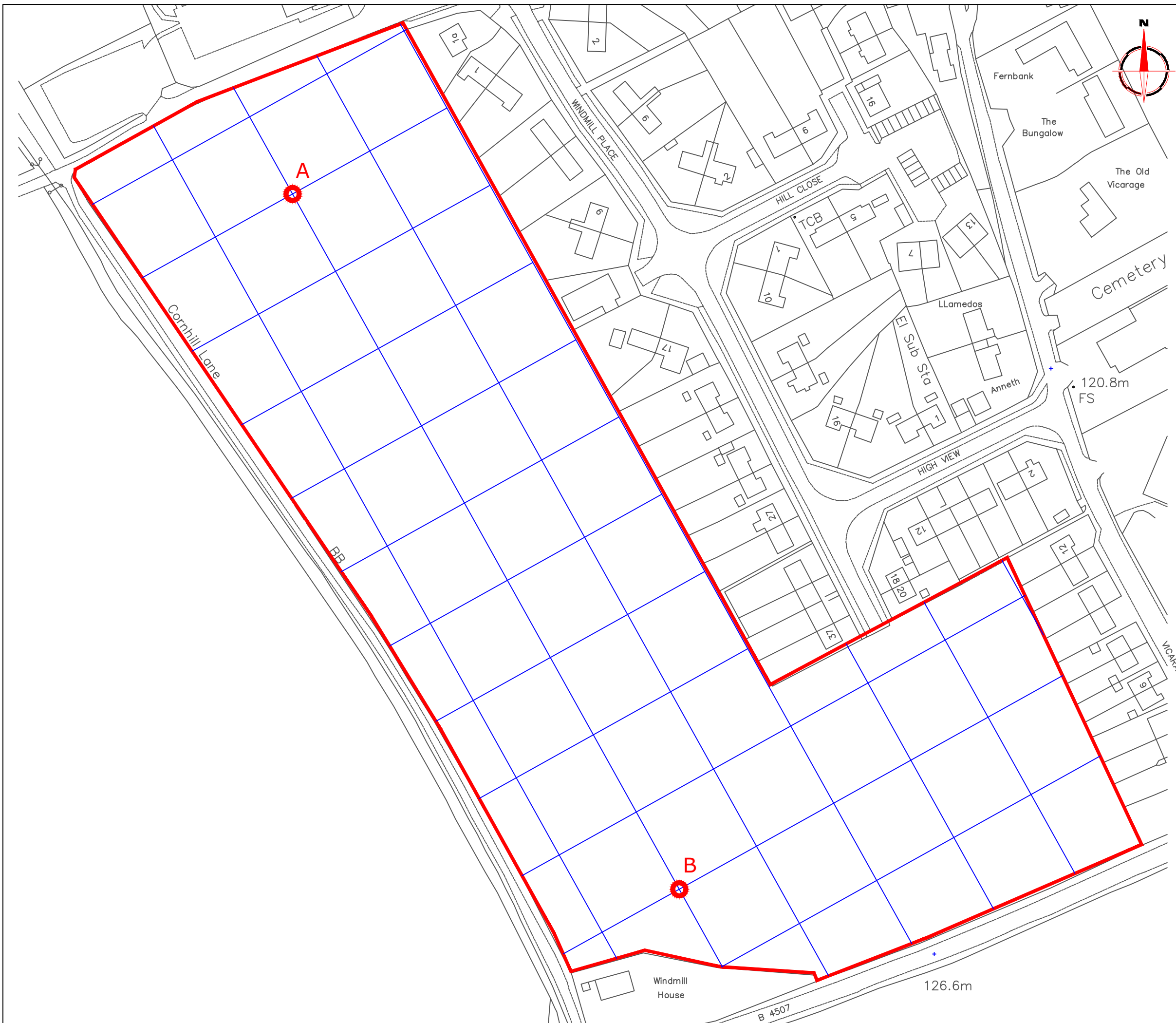

Amendments						
Issue No.	Date	Description				
-	-	-				
-	-	-				
© Stratascan Ltd - 2014						
<p>OS GRID REFERENCES</p> <table border="1"> <tr> <td>A</td> <td>437856.02, 187800.63</td> </tr> <tr> <td>B</td> <td>437987.34, 187564.72</td> </tr> </table>			A	437856.02, 187800.63	B	437987.34, 187564.72
A	437856.02, 187800.63					
B	437987.34, 187564.72					
Client OXFORD ARCHAEOLOGY						
Project Title EAST CHALLOW, OXFORDSHIRE		Job No. J6649				
Subject LOCATION OF SURVEY GRIDS AND REFERENCING						
<p>STRATASCAN™ GEOPHYSICS FOR ARCHAEOLOGY AND ENGINEERING VINEYARD HOUSE T: 01684 592266 UPTON UPON SEVERN E: info@stratascan.co.uk WR8 0SA www.stratascan.co.uk</p>						
<p>EUROPEAN GPR ASSOCIATION SUMO GROUP MEMBER </p>						
Scale 1:1250						
Plot A3	Checked by DGE	Issue No. 01				
Survey date APR 14	Drawn by TR	Figure No. 02				

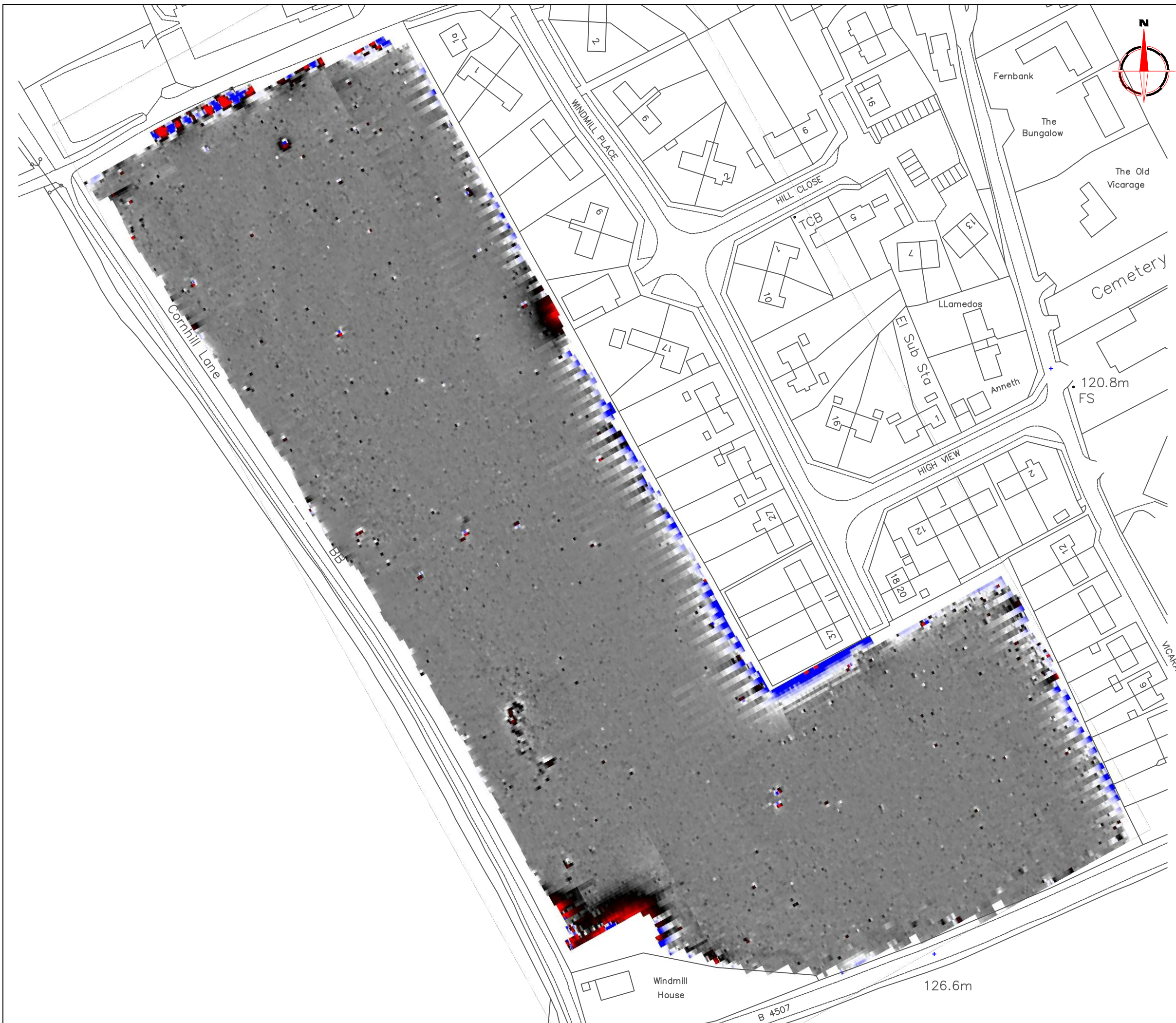

Amendments

Issue No.	Date	Description
-	-	-
-	-	-

© Stratascan Ltd - 2014

Plotting parameters

Maximum +100nT (red)
Minimum -100nT (blue)

Client
OXFORD ARCHAEOLOGY

Project Title
EAST CHALLOW, OXFORDSHIRE

Job No. J6649

Subject
COLOUR PLOT OF GRADIOMETER DATA SHOWING EXTREME VALUES

STRATASCAN™
GEOPHYSICS FOR ARCHAEOLOGY AND ENGINEERING

VINEYARD HOUSE T: 01684 592266
UPTON UPON SEVERN E: info@stratascan.co.uk
WR8 0SA www.stratascan.co.uk

EUROPEAN GPR ASSOCIATION

SUMO GROUP MEMBER

REGISTERED ORGANISATION

ims ISO 9001 certified

ims ISO 14001 certified

Scale 1:1250

Plot A3	Checked by DGE	Issue No. 01
Survey date APR 14	Drawn by TR	Figure No. 03



Amendments		
Issue No.	Date	Description
-	-	-
-	-	-
© Stratascan Ltd - 2014		

<p>Plotting parameters</p> <p>Maximum +2nT (black) Minimum -2nT (white)</p> <p>Zero Mean</p> <p>-2nT +2nT</p>	<p>+2nT</p> <p>-2nT</p>
--	-------------------------

Client	OXFORD ARCHAEOLOGY	
Project Title	EAST CHALLOW, OXFORDSHIRE	
Project No.	6649	
Subject	PLOT OF MINIMALLY PROCESSED GRADIOMETER DATA	

STRATASCAN™
GEOPHYSICS FOR ARCHAEOLOGY AND ENGINEERING

VINEYARD HOUSE T: 01684 592266
 UPTON UPON SEVERN E: info@stratascan.co.uk
 WR8 0SA www.stratascan.co.uk

SUMO GROUP MEMBER			

Scale	1:1250	
Plot	A3	Checked by DGE
Survey date	MAR 14	Drawn by TR
Issue No.	01	
Figure No.	04	



Amendments

Issue No.	Date	Description
-	-	-
-	-	-

© Stratascan Ltd - 2014

KEY

PROBABLE ARCHAEOLOGY

- Positive anomaly / weak positive anomaly - probable cut feature of archaeological origin
- Negative anomaly / weak negative anomaly - probable bank or earthwork of archaeological origin
- Moderate strength discrete anomaly - probable thermoremanent feature
- Widely spaced curving parallel linear anomalies - probably related to ridge-and-furrow

POSSIBLE ARCHAEOLOGY

- Positive anomaly / weak positive anomaly - possible cut feature of archaeological origin
- Negative anomaly / weak negative anomaly - possible bank or earthwork of archaeological origin
- Moderate strength discrete anomaly - possible thermoremanent feature

OTHER ANOMALIES

- Closely spaced parallel linear anomalies - probably related to agricultural activity such as ploughing
- Linear anomaly - probably related to pipe, cable or other modern service
- Linear anomaly - possibly related to land drain
- Magnetic disturbance associated with nearby metal object such as service or field boundary
- Strong magnetic debris - possible disturbed or made ground
- Scattered magnetic debris
- Area of amorphous magnetic variation - probable natural (e.g. geological or pedological) origin
- Magnetic spike - probable ferrous object

Client
OXFORD ARCHAEOLOGY

Project Title Job No. J6649
EAST CHALLOW, OXFORDSHIRE

Subject
ABSTRACTION AND INTERPRETATION OF GRADIOMETER ANOMALIES

STRATASCAN™
GEOPHYSICS FOR ARCHAEOLOGY AND ENGINEERING

VINEYARD HOUSE T: 01684 592266
UPTON UPON SEVERN E: info@stratascan.co.uk
WR8 0SA www.stratascan.co.uk

GPR ASSOCIATION

SUMO GROUP MEMBER

ISO 9001 certified

ISO 14001 certified

Scale **1:1250**

Plot A3	Checked by DGE	Issue No. 01
Survey date APR 14	Drawn by TR	Figure No. 05