

Reproduced from Ordnance Survey's 1:25 000 map of 1998 with the permission of the controller of Her Majesty's Stationery Office. Crown Copyright reserved. Licence No: AL 50125A Licencee: Stratascan Ltd. Vineyard House Upper Hook Road Upton Upon Severn WR8 0SA

OS 100km square = ST



Amendments

Issue No.	Date	Description
-	-	-
-	-	-

© Stratascan Ltd - 2014



Site centred on NGR ST 543 947

Client CgMs CONSULTING LTD.

Project Title Job No. 6629
GEOPHYSICAL SURVEY - TUTSHILL,
GLOUCESTERSHIRE

Subject
LOCATION PLAN OF SURVEY AREA

STRATASCANTM
GEOPHYSICS FOR ARCHAEOLOGY
AND ENGINEERING
VINEYARD HOUSE
UPTON UPON SEVERN
WR8 0SA
T: 01684 592266
E: info@stratascan.co.uk
www.stratascan.co.uk



SUMO
GROUP
MEMBER



Scale 1:25000 0m 500 1000m

Plot A3	Checked by DGE	Issue No. 01
Survey date MAR 14	Drawn by JHS	Figure No. 01

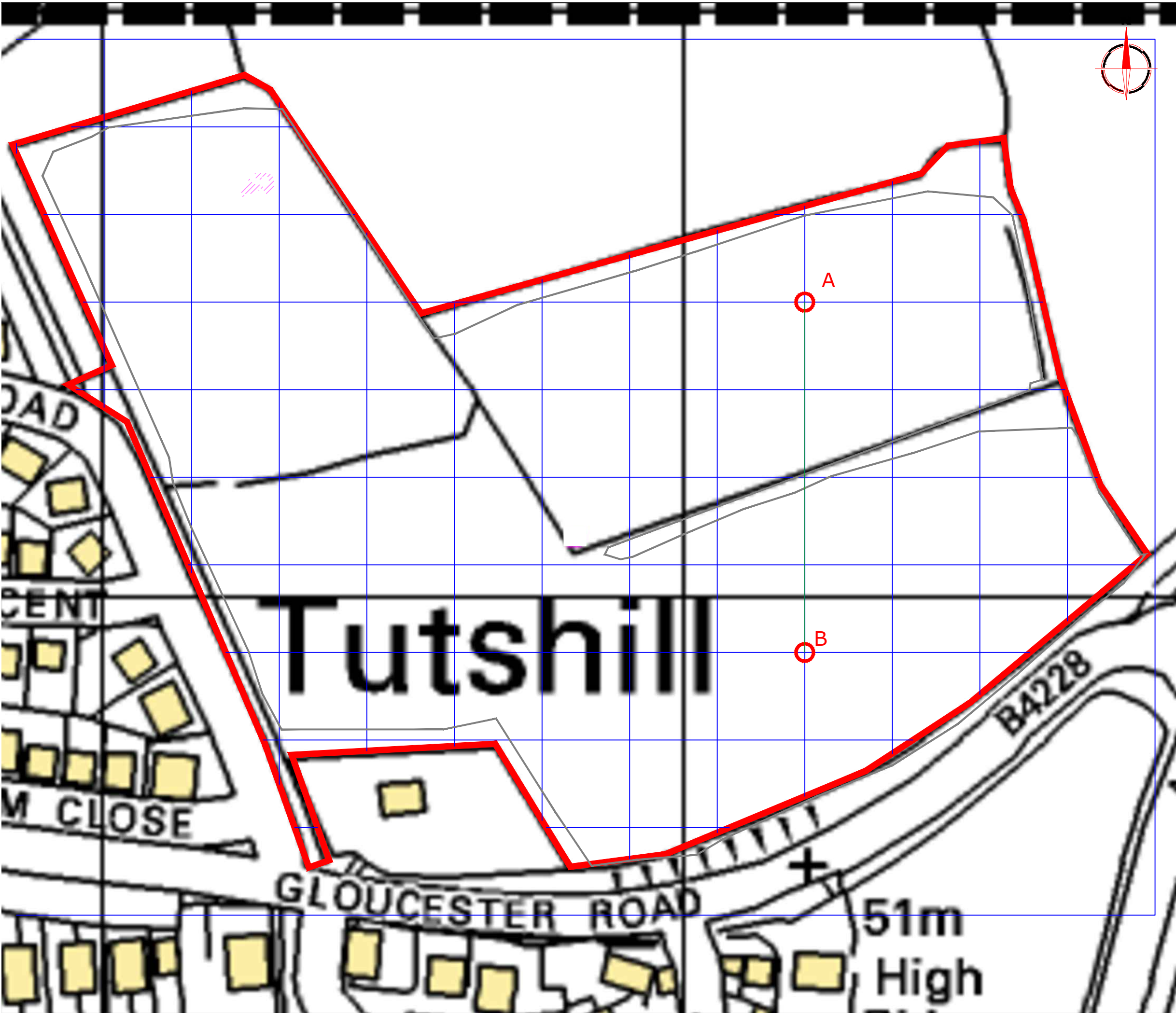

Amendments		
Issue No.	Date	Description
-	-	-
-	-	-
© Stratascan Ltd - 2014		

OS GRID REFERENCES	
A	354438.85, 194902.55
B	354438.85, 194782.55

Client
CgMs CONSULTING LTD.

Project Title
GEOPHYSICAL SURVEY - TUTSHILL, GLOUCESTERSHIRE

Job No. 6629

Subject
LOCATION OF SURVEY GRIDS AND REFERENCING

STRATASCAN
GEOPHYSICS FOR ARCHAEOLOGY AND ENGINEERING

VINEYARD HOUSE
UPTON UPON SEVERN
WR8 0SA

T: 01684 592266
E: info@stratascan.co.uk
www.stratascan.co.uk

GPR
ASSOCIATION

SUMO
SURVEY SERVICE

SUMO GROUP MEMBER

ims ISO 9001 certified

ims ISO 14001 certified

Scale 1:1250

0m 10 20 30 40 50

Plot A3	Checked by DGE	Issue No. 01
Survey date MAR 14	Drawn by JHS	Figure No. 02

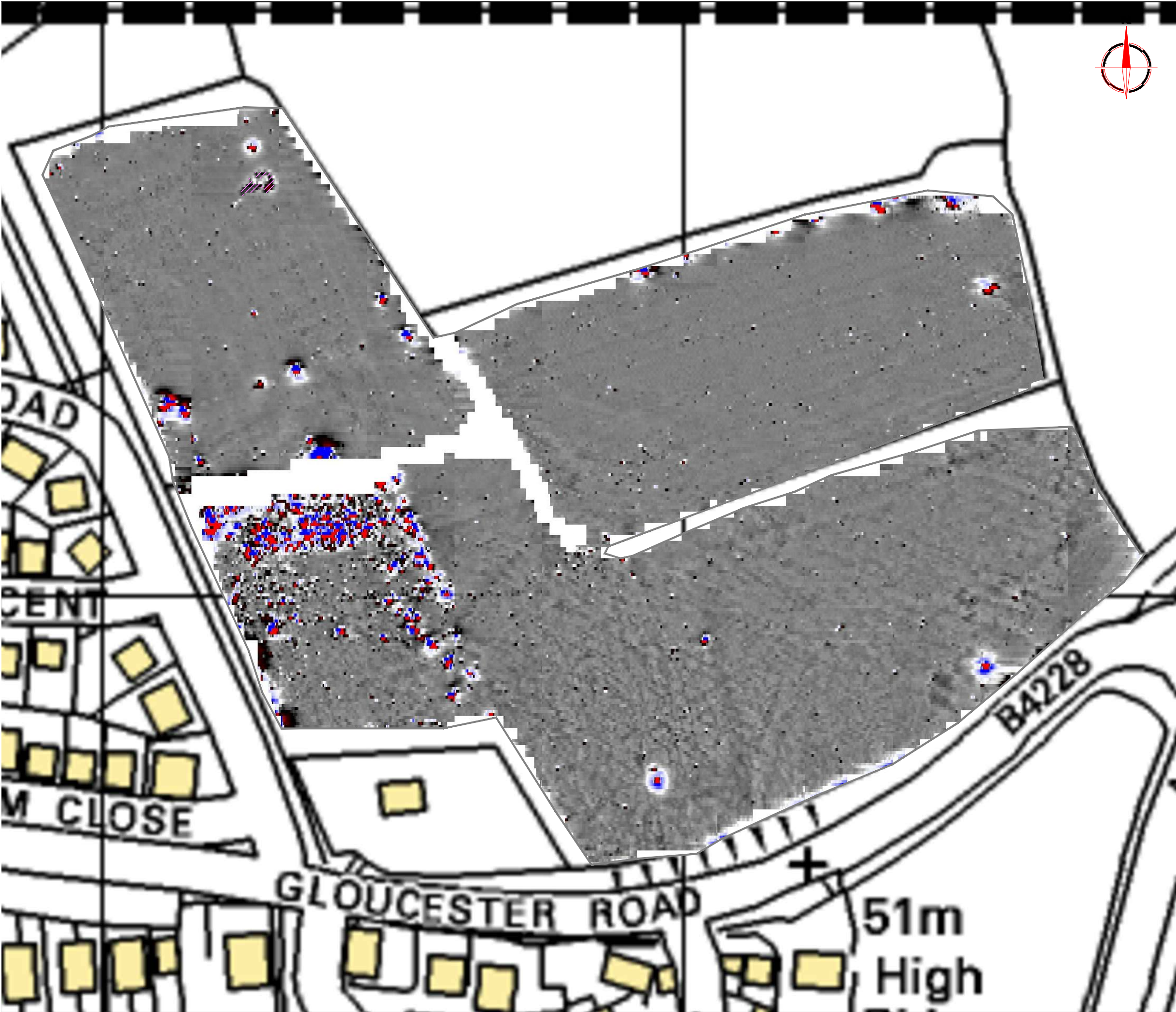

Amendments

Issue No.	Date	Description
-	-	-
-	-	-

© Stratascan Ltd - 2014

Plotting parameters

Maximum +100nT (red)
Minimum -100nT (blue)

+100nT

-10nT

-10nT

-100nT

Client

CgMs CONSULTING LTD.

Project Title

Job No. 6629

GEOPHYSICAL SURVEY - TUTSHILL,
GLOUCESTERSHIRE

Subject

COLOUR PLOT OF GRADIOMETER
DATA SHOWING EXTREME VALUES

STRATASCANTM

GEOPHYSICS FOR ARCHAEOLOGY
AND ENGINEERING

VINEYARD HOUSE
UPTON UPON SEVERN
WR8 0SA

T: 01684 592266
E: info@stratascan.co.uk
www.stratascan.co.uk

EUROPEAN
GPR
ASSOCIATION

SURVEY
SERVICE

SURVEY
SERVICE

SUMOGROUP
MEMBER

ims
ISO 9001
certified

UKAS
QUALITY
MANAGEMENT
SYSTEMS

ims
ISO 14001
certified

UKAS
ENVIRONMENTAL
MANAGEMENT
SYSTEMS

Scale

1:1250

0m 10 20 30 40 50m

Plot A3	Checked by DGE	Issue No. 01
Survey date MAR 14	Drawn by OJP	Figure No. 03



Amendments

Issue No.	Date	Description
-	-	-
-	-	-

© Stratascan Ltd - 2014

-2nT +2nT

Client

CgMs CONSULTING LTD.

Project Title Job No. 6629
GEOPHYSICAL SURVEY - TUTSHILL,
GLOUCESTERSHIRE

Subject
PLOT OF MINIMALLY PROCESSED
GRADIOMETER DATA

STRATASCANTM
GEOPHYSICS FOR ARCHAEOLOGY
AND ENGINEERING

VINEYARD HOUSE T: 01684 592266
UPTON UPON SEVERN E: info@stratascan.co.uk
WR8 0SA www.stratascan.co.uk

EUROPEAN GPR ASSOCIATION
sumo
Survey Services

SUMO GROUP MEMBER

ims ISO 9001 certified UKAS ISO 9001 certified ims ISO 14001 certified UKAS ISO 14001 certified

Scale 1:1250 0m 10 20 30 40 50m

Plot A3	Checked by DGE	Issue No. 01
Survey date MAR 14	Drawn by OJP	Figure No. 04

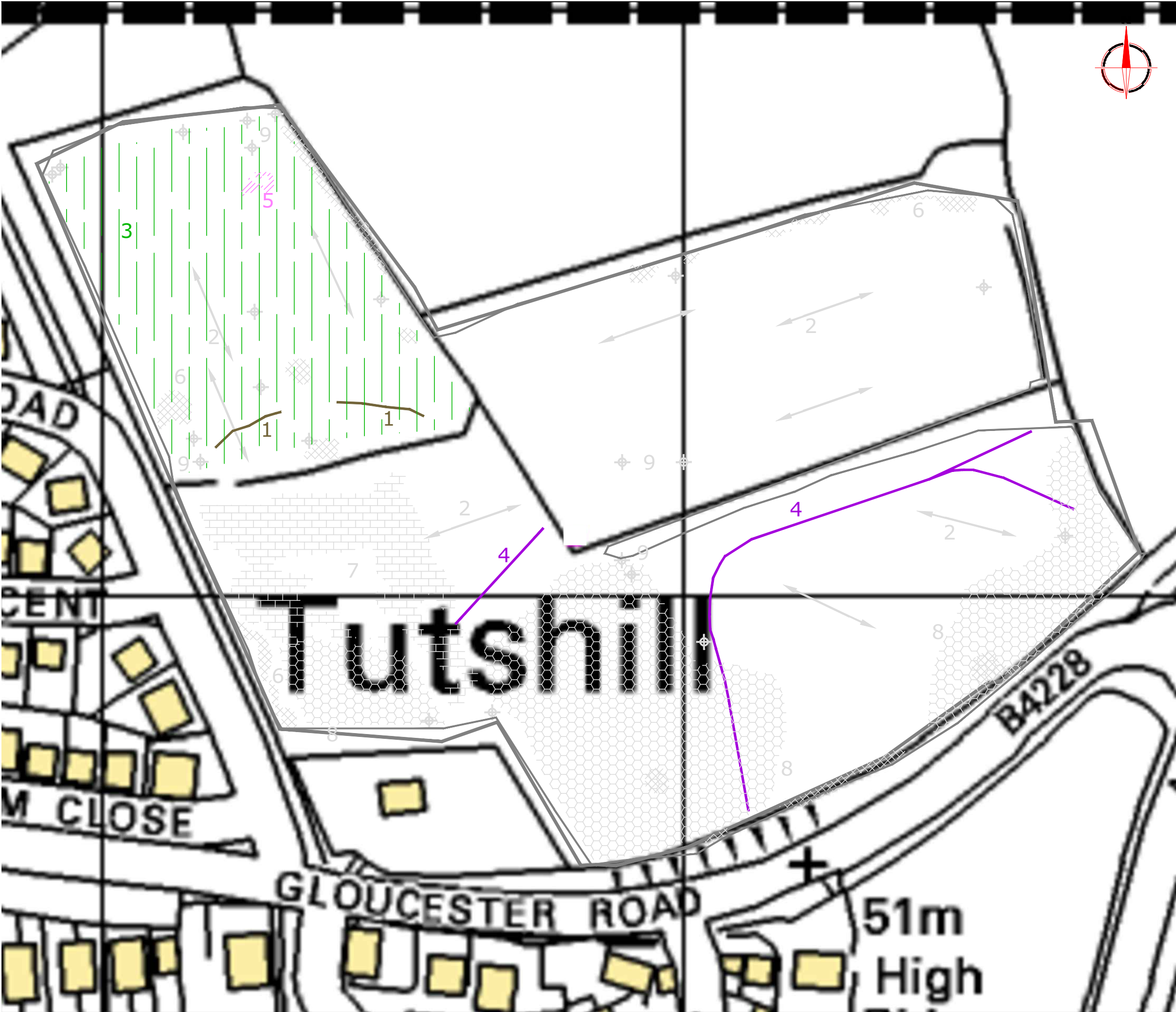

Amendments		
Issue No.	Date	Description
-	-	-
-	-	-
© Stratascan Ltd - 2014		
KEY		
PROBABLE ARCHAEOLOGY		
	Positive anomaly / weak positive anomaly - probable cut feature of archaeological origin	
	Negative anomaly / weak negative anomaly - probable bank or earthwork of archaeological origin	
	Linear anomaly - probably related to former field boundary visible on 1891 mapping	
	Widely spaced curving parallel linear anomalies - probably related to ridge-and-furrow	
POSSIBLE ARCHAEOLOGY		
	Positive anomaly / weak positive anomaly - possible cut feature of archaeological origin	
	Negative anomaly / weak negative anomaly - possible bank or earthwork of archaeological origin	
OTHER ANOMALIES		
	Closely spaced parallel linear anomalies - probably related to agricultural activity such as ploughing	
	Regularly spaced point anomalies probably related to former orchard area visible on 1891 mapping	
	Linear anomaly - possibly related to former field boundary	
	Magnetic anomaly of unknown origin	
	Magnetic disturbance associated with nearby metal object such as service or field boundary	
	Strong magnetic debris - possible disturbed or made ground	
	Scattered magnetic debris	
	Area of amorphous magnetic variation - probable natural (e.g. geological or pedological) origin	
	Magnetic spike - probable ferrous object	
Client		
CgMs CONSULTING LTD.		
Project Title		
GEOPHYSICAL SURVEY - TUTSHILL, GLOUCESTERSHIRE		
Job No. 6629		
Subject		
ABSTRACTION AND INTERPRETATION OF GRADIOMETER ANOMALIES		
GEOPHYSICS FOR ARCHAEOLOGY AND ENGINEERING		
VINEYARD HOUSE		
UPTON UPON SEVERN		
WR8 0SA		
T: 01684 592266		
E: info@stratascan.co.uk		
www.stratascan.co.uk		
SUMO GROUP MEMBER		
Scale		
1:1250		
Plot	Checked by	Issue No.
A3	DGE	01
Survey date	Drawn by	Figure No.
MAR 14	OJP	05