

Reproduced from Ordnance Survey's 1:25 000 map of 1998 with the permission of the controller of Her Majesty's Stationery Office. Crown Copyright reserved. Licence No: AL 50125A
 Licensee:
 Stratascan Ltd.
 Vineyard House
 Upper Hook Road
 Upton Upon Severn
 WR8 0SA
 OS 100km square = SP

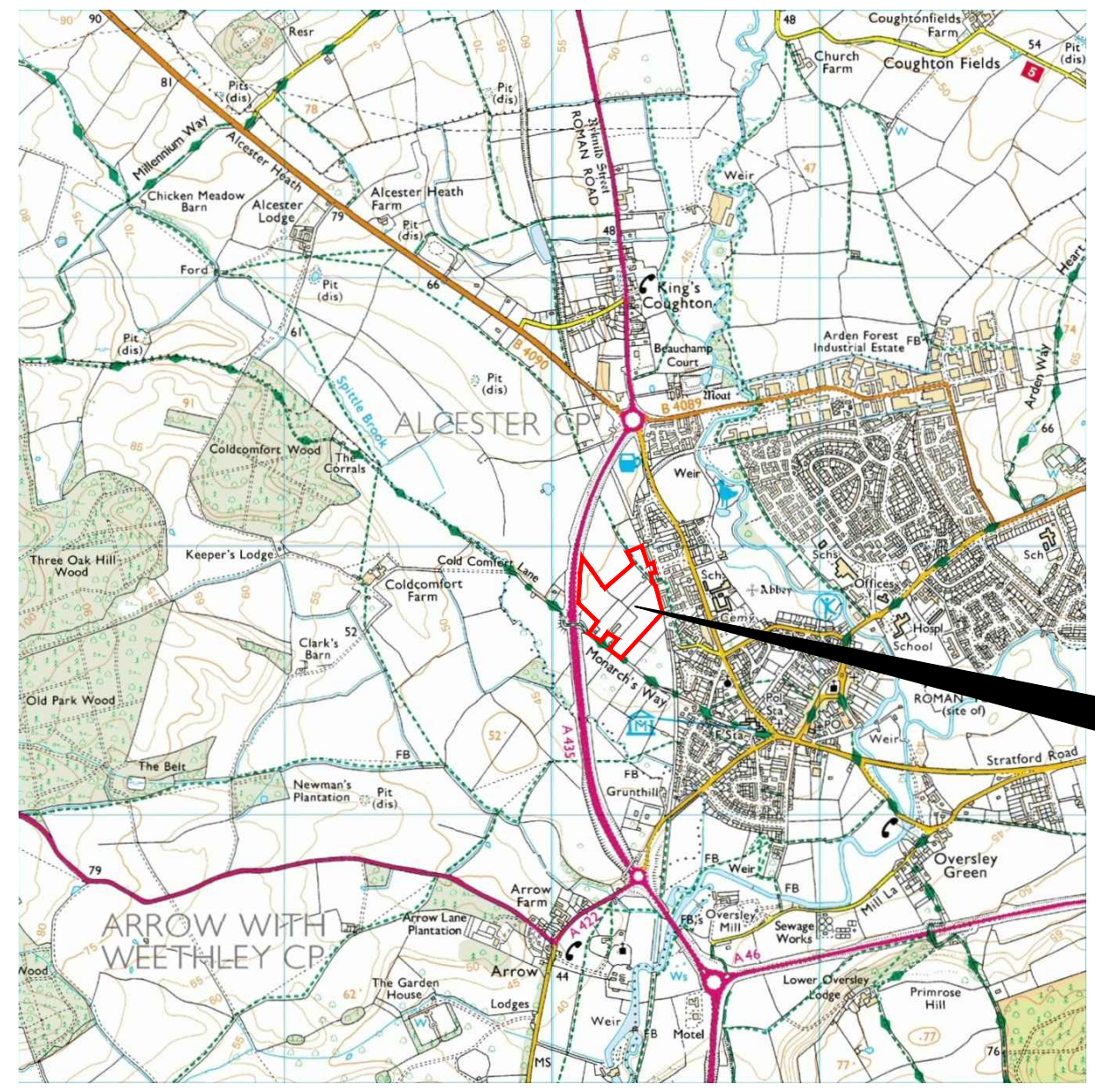

60
59
58
57
56



06 07 08 09 10

Amendments

Issue No.	Date	Description
-	-	-
-	-	-

© Stratascan Ltd - ----



Site centred on NGR **SP 082 577**

Client
HALCROW GROUP LTD

Project Title **ALLIMORE LANE, ALCESTER, WARWICKSHIRE** Job No. **J7433**

Subject
LOCATION PLAN OF SURVEY AREA

STRATASCAN™
GEOPHYSICS FOR ARCHAEOLOGY AND ENGINEERING
 VINEYARD HOUSE T: 01684 592266
 UPTON UPON SEVERN E: info@stratascan.co.uk
 WR8 0SA www.stratascan.co.uk



SUMO GROUP MEMBER



Scale **1:25000** 0m 500m 1000m

Plot A3	Checked by DGE	Issue No. 01
Survey date OCT 14	Drawn by TR	Figure No. 01

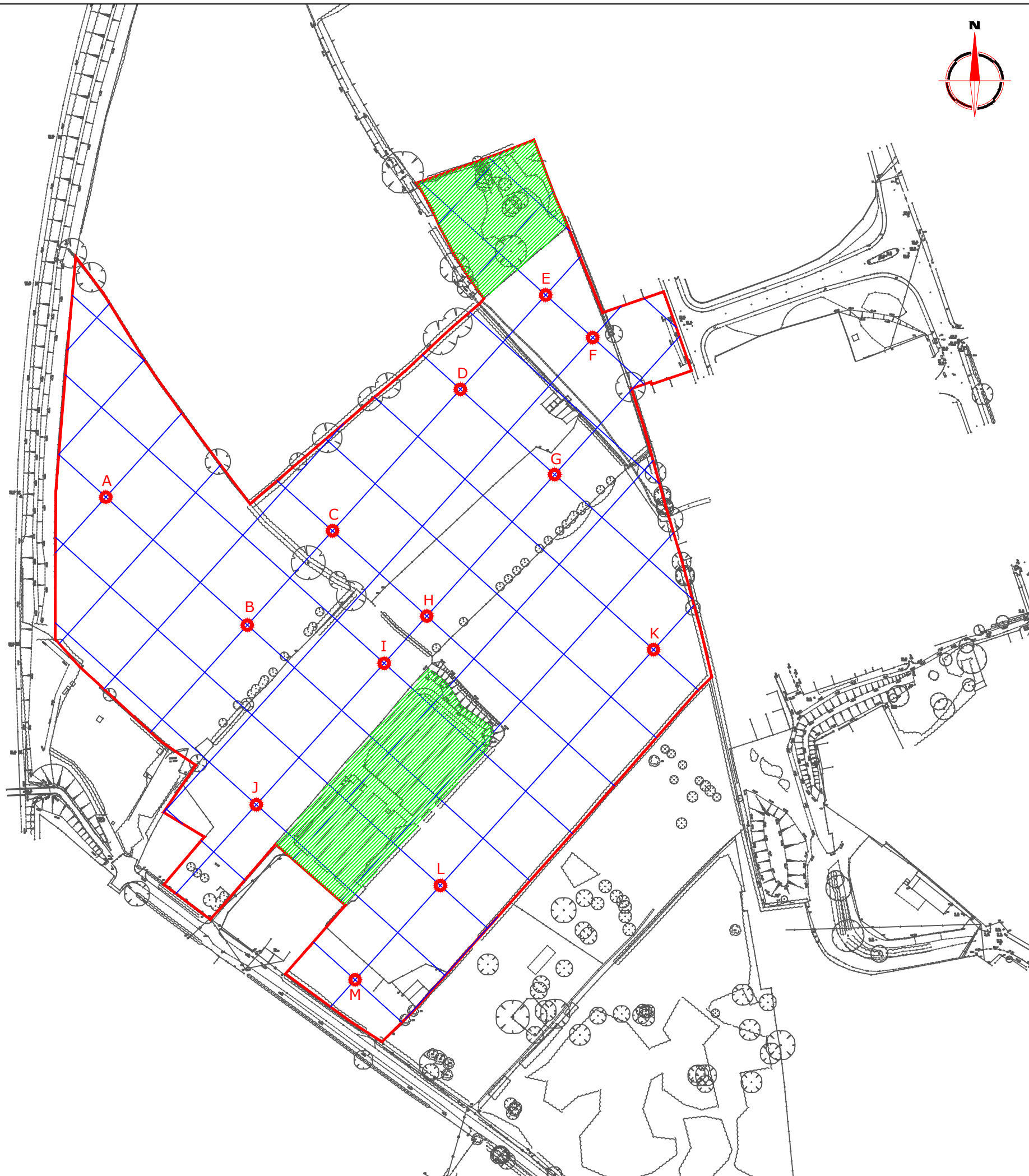

Amendments

Issue No.	Date	Description
-	-	-
-	-	-

© Stratascan Ltd - ----

KEY

	Area unsurveyable - overgrown vegetation
--	--

OS GRID REFERENCES

A	408123.59, 257846.08
B	408190.35, 257785.72
C	408230.59, 257830.22
D	408290.95, 257896.98
E	408331.20, 257941.48
F	408353.45, 257921.36
G	408335.46, 257856.73
H	408275.09, 257789.98
I	408254.97, 257767.73
J	408194.61, 257700.97
K	408382.09, 257774.12
L	408281.48, 257662.86
M	408241.24, 257618.36

Client
HALCROW GROUP LTD

Project Title Job No. J7433
ALLIMORE LANE, ALCESTER, WARWICKSHIRE

Subject
LOCATION OF SURVEY GRIDS AND REFERENCING

STRATASCAN™
GEOPHYSICS FOR ARCHAEOLOGY AND ENGINEERING
 VINEYARD HOUSE T: 01684 592266
 UPTON UPON SEVERN E: info@stratascan.co.uk
 WR8 0SA www.stratascan.co.uk

EUROPEAN GPR ASSOCIATION
SUMO GROUP MEMBER

Scale **1:2000**
 0m 20 40 60 80 100m

Plot A3	Checked by DGE	Issue No. 01
Survey date OCT 14	Drawn by TR	Figure No. 02



Amendments		
Issue No.	Date	Description
-	-	-
-	-	-

© Stratascan Ltd - ----

Plotting parameters

Maximum +100nT (red)
Minimum -100nT (blue)

Client
HALCROW GROUP LTD

Project Title
ALLIMORE LANE, ALCESTER, WARWICKSHIRE

Job No. J7433

Subject
COLOUR PLOT OF GRADIOMETER DATA SHOWING EXTREME VALUES - OVERVIEW

STRATASCAN™
GEOPHYSICS FOR ARCHAEOLOGY AND ENGINEERING

VINEYARD HOUSE T: 01684 592266
UPTON UPON SEVERN E: info@stratascan.co.uk
WR8 0SA www.stratascan.co.uk

EUROPEAN GPR ASSOCIATION

SUMO GROUP MEMBER

ims ISO 9001 certified **UKAS** **ims ISO 14001 certified** **UKAS**

Scale 1:1500
0m 10 20 30 40 50m

Plot A3	Checked by DGE	Issue No. 01
Survey date OCT 14	Drawn by TR	Figure No. 03

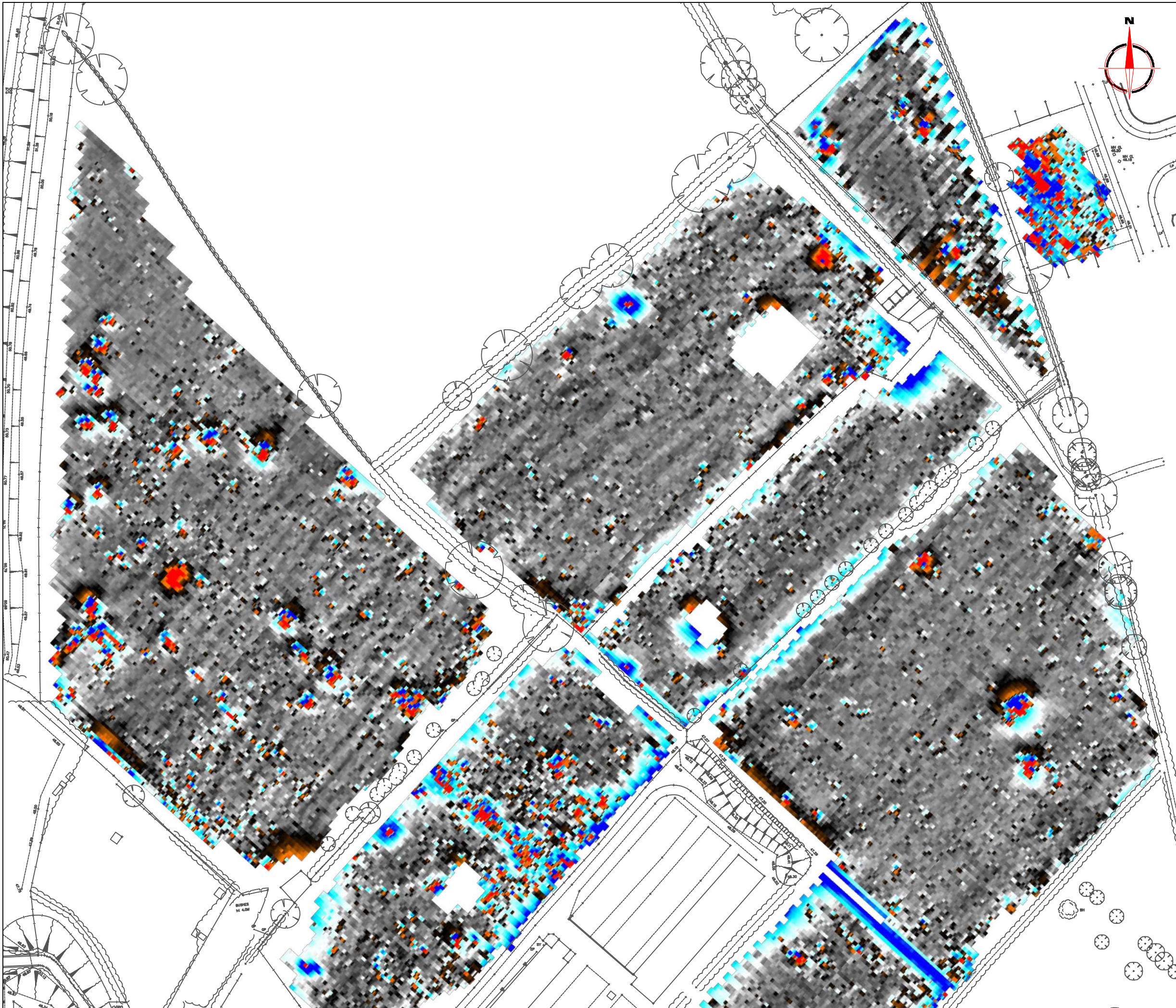

Amendments		
Issue No.	Date	Description
-	-	-
-	-	-

© Stratascan Ltd - ----

Plotting parameters

Maximum +100nT (red)
Minimum -100nT (blue)

Client

HALCROW GROUP LTD

Project Title Job No. J7433
**ALLIMORE LANE, ALCESTER,
WARWICKSHIRE**

Subject
**COLOUR PLOT OF GRADIOMETER
DATA SHOWING EXTREME VALUES -
NORTH**

STRATASCAN™
GEOPHYSICS FOR ARCHAEOLOGY
AND ENGINEERING

VINEYARD HOUSE T: 01684 592266
UPTON UPON SEVERN E: info@stratascan.co.uk
WR8 0SA www.stratascan.co.uk

EUROPEAN GPR ASSOCIATION
SUMO SUMO GROUP MEMBER
ISO 9001 certified
UKAS ISO 14001 certified

Scale **1:1000** 0m 10 20 30 40 50

Plot A3	Checked by DGE	Issue No. 01
Survey date OCT 14	Drawn by TR	Figure No. 04

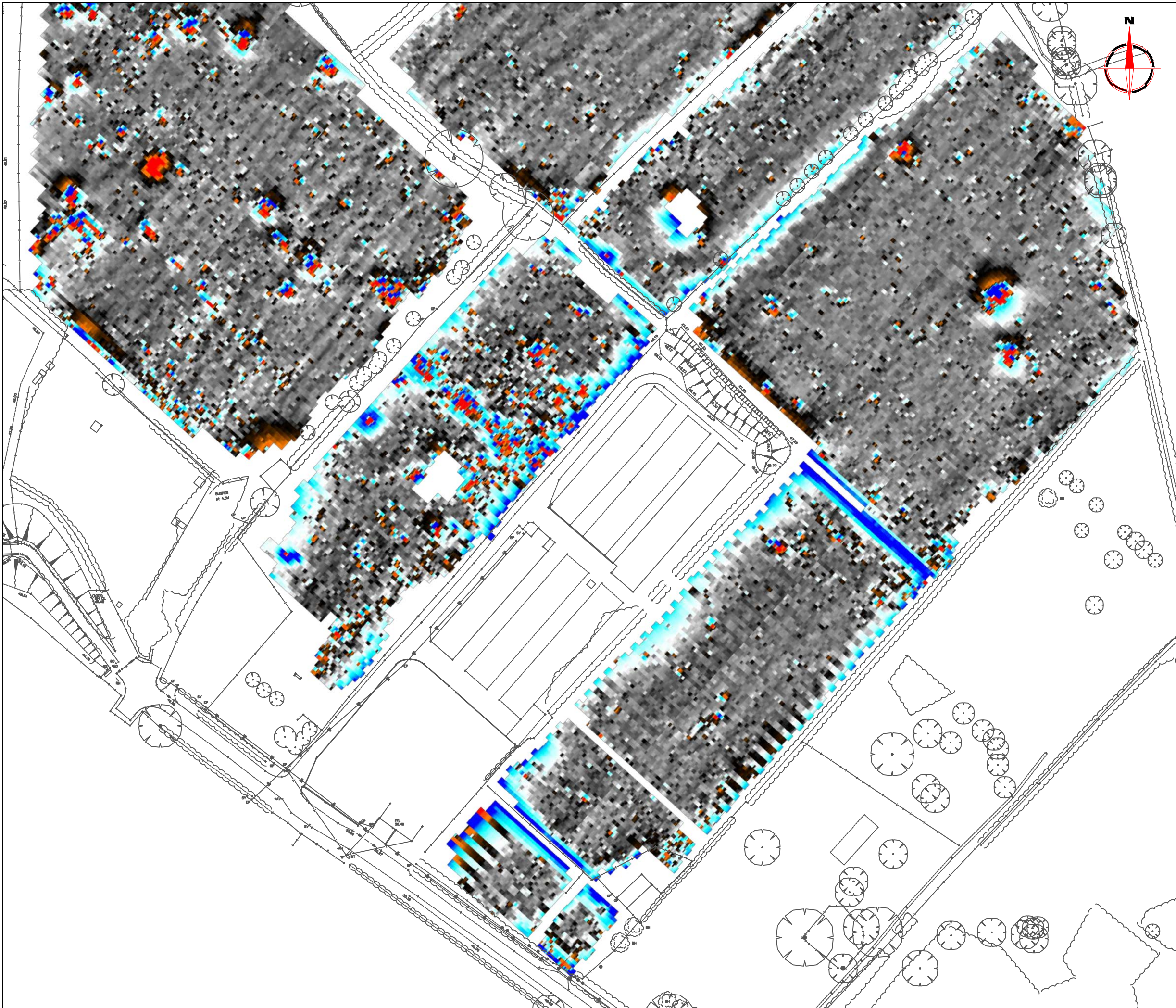

Amendments		
Issue No.	Date	Description
-	-	-
-	-	-
© Stratascan Ltd - ----		

Plotting parameters	
Maximum +100nT (red)	
Minimum -100nT (blue)	

Client	HALCROW GROUP LTD	
Project Title	ALLIMORE LANE, ALCESTER, WARWICKSHIRE	Job No. J7433
Subject	COLOUR PLOT OF GRADIOMETER DATA SHOWING EXTREME VALUES - SOUTH	

STRATASCANTM
 GEOPHYSICS FOR ARCHAEOLOGY AND ENGINEERING

VINEYARD HOUSE T: 01684 592266
 UPTON UPON SEVERN E: info@stratascan.co.uk
 WR8 0SA www.stratascan.co.uk

Scale 1:1000

Plot	Checked by	Issue No.
A3	DGE	01
Survey date	Drawn by	Figure No.
OCT 14	TR	05



Amendments		
Issue No.	Date	Description
-	-	-
-	-	-

© Stratascan Ltd - ----

Plotting parameters

Maximum +2nT (black)
Minimum -2nT (white)

Zero Mean

-2nT +2nT

+2nT

-2nT

Client

HALCROW GROUP LTD

Project Title Job No. J7433

**ALLIMORE LANE, ALCESTER,
WARWICKSHIRE**

Subject

**PLOT OF MINIMALLY PROCESSED
GRADIOMETER DATA - OVERVIEW**

STRATASCAN™
GEOPHYSICS FOR ARCHAEOLOGY
AND ENGINEERING

VINEYARD HOUSE T: 01684 592266
UPTON UPON SEVERN E: info@stratascan.co.uk
WR8 0SA www.stratascan.co.uk

Scale 0m 10 20 30 40 50m

1:1500

Plot	Checked by	Issue No.
A3	DGE	01
Survey date	Drawn by	Figure No.
OCT 14	TR	06



Amendments

Issue No.	Date	Description
-	-	-
-	-	-

© Stratascan Ltd - ----

Plotting parameters

Maximum +2nT (black)
Minimum -2nT (white)

Zero Mean

-2nT +2nT

+2nT

-2nT

Client
HALCROW GROUP LTD

Project Title Job No. J7433
**ALLIMORE LANE, ALCESTER,
WARWICKSHIRE**

Subject
**PLOT OF MINIMALLY PROCESSED
GRADIOMETER DATA - NORTH**

STRATASCAN™
GEOPHYSICS FOR ARCHAEOLOGY
AND ENGINEERING

VINEYARD HOUSE T: 01684 592266
UPTON UPON SEVERN E: info@stratascan.co.uk
WR8 0SA www.stratascan.co.uk

EUROPEAN GPR ASSOCIATION

SUMO SUMO GROUP MEMBER

ISO 9001 certified

UKAS

ISO 14001 certified

UKAS

Scale 1:1000

Plot A3	Checked by DGE	Issue No. 01
Survey date OCT 14	Drawn by TR	Figure No. 07



Amendments

Issue No.	Date	Description
-	-	-
-	-	-

© Stratascan Ltd - ----

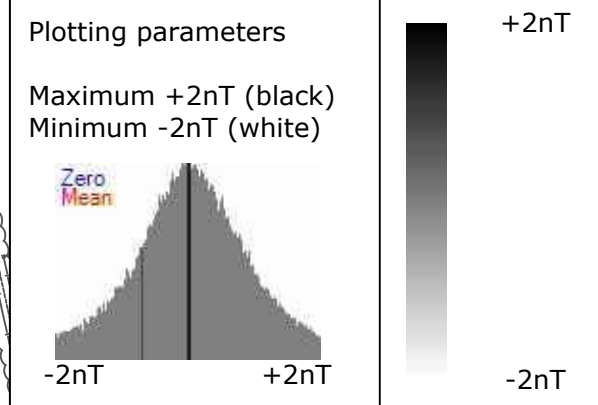

Client
HALCROW GROUP LTD

Project Title Job No. J7433
**ALLIMORE LANE, ALCESTER,
WARWICKSHIRE**

Subject
**PLOT OF MINIMALLY PROCESSED
GRADIOMETER DATA - SOUTH**

STRATASCAN™
GEOPHYSICS FOR ARCHAEOLOGY
AND ENGINEERING

VINEYARD HOUSE T: 01684 592266
UPTON UPON SEVERN E: info@stratascan.co.uk
WR8 0SA www.stratascan.co.uk



Plot A3	Checked by DGE	Issue No. 01
Survey date OCT 14	Drawn by TR	Figure No. 08

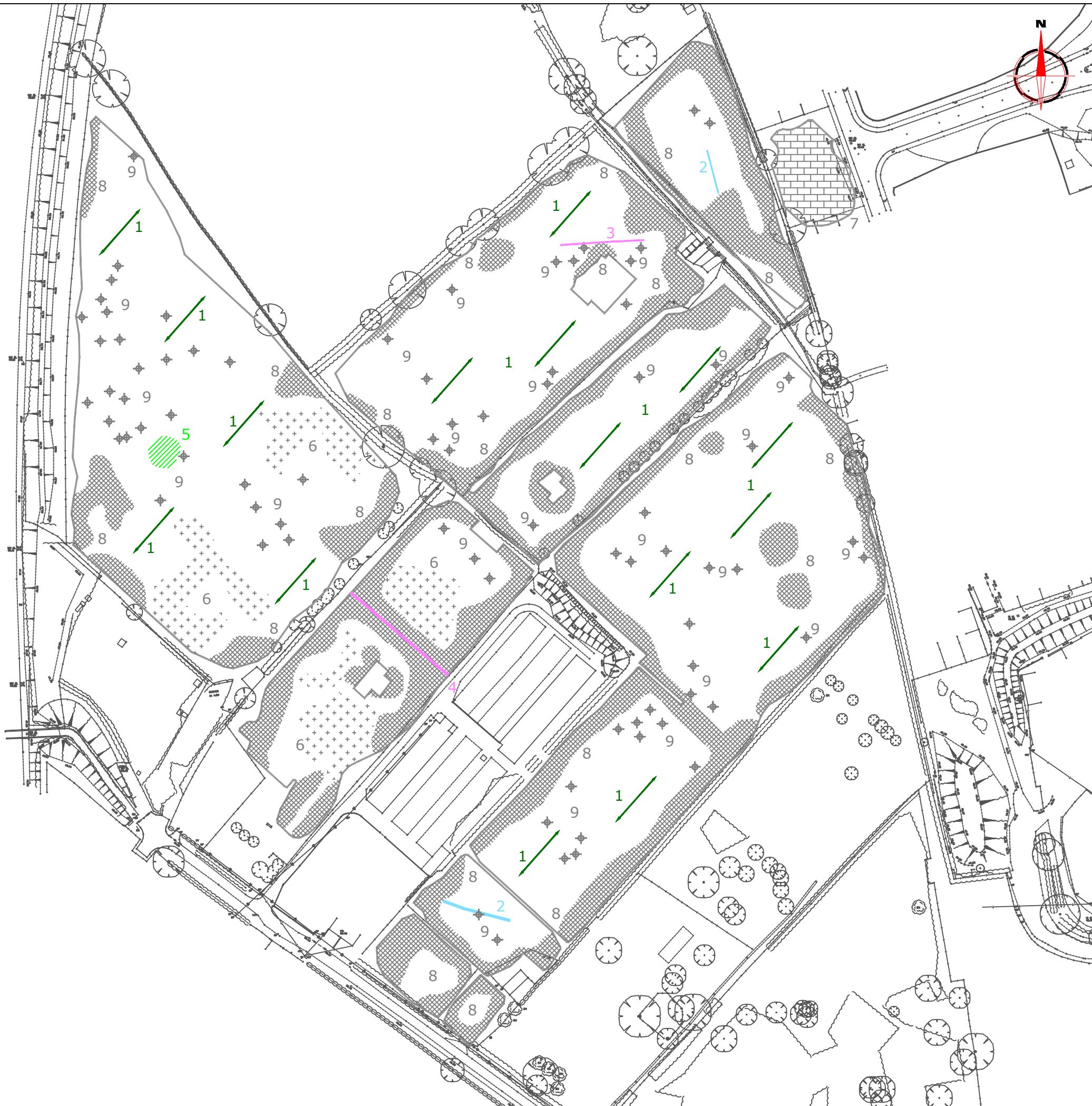

Amendments		
Issue No.	Date	Description
-	-	-
-	-	-
© Stratascan Ltd - ----		
KEY		
PROBABLE ARCHAEOLOGY		
	Positive anomaly / weak positive anomaly - probable cut feature of archaeological origin	
	Negative anomaly / weak negative anomaly - probable bank or earthwork of archaeological origin	
	Moderate strength discrete anomaly - probable thermoremanent feature	
	Widely spaced curving parallel linear anomalies - probably related to ridge-and-furrow	
POSSIBLE ARCHAEOLOGY		
	Positive anomaly / weak positive anomaly - possible cut feature of archaeological origin	
	Negative anomaly / weak negative anomaly - possible bank or earthwork of archaeological origin	
	Moderate strength discrete anomaly - possible thermoremanent feature	
OTHER ANOMALIES		
	Closely spaced parallel linear anomalies - probably related to agricultural activity such as ploughing	
	Linear anomaly - possibly related to pipe, cable or other modern service	
	Unknown origin - likely to be modern	
	Magnetic disturbance associated with nearby metal object such as service or field boundary	
	Strong magnetic debris - possible disturbed or made ground	
	Scattered magnetic debris	
	Area of amorphous magnetic variation - probable natural (e.g. geological or pedological) origin	
	Magnetic spike - probable ferrous object	
Client		
HALCROW GROUP LTD		
Project Title	Job No. J7433	
ALLIMORE LANE, ALCESTER, WARWICKSHIRE		
Subject	ABSTRACTION AND INTERPRETATION OF GRADIOMETER ANOMALIES - OVERVIEW	
STRATASCAN™		
GEOPHYSICS FOR ARCHAEOLOGY AND ENGINEERING		
VINEYARD HOUSE		T: 01684 592266
UPTON UPON SEVERN		E: info@stratascan.co.uk
WR8 0SA		www.stratascan.co.uk
SUMO GROUP MEMBER ISO 9001 certified ISO 14001 certified		
Scale	0m 10 20 30 40 50m	
1:1500		
Plot	Checked by	Issue No.
A3	DGE	01
Survey date	Drawn by	Figure No.
OCT 14	TR	09

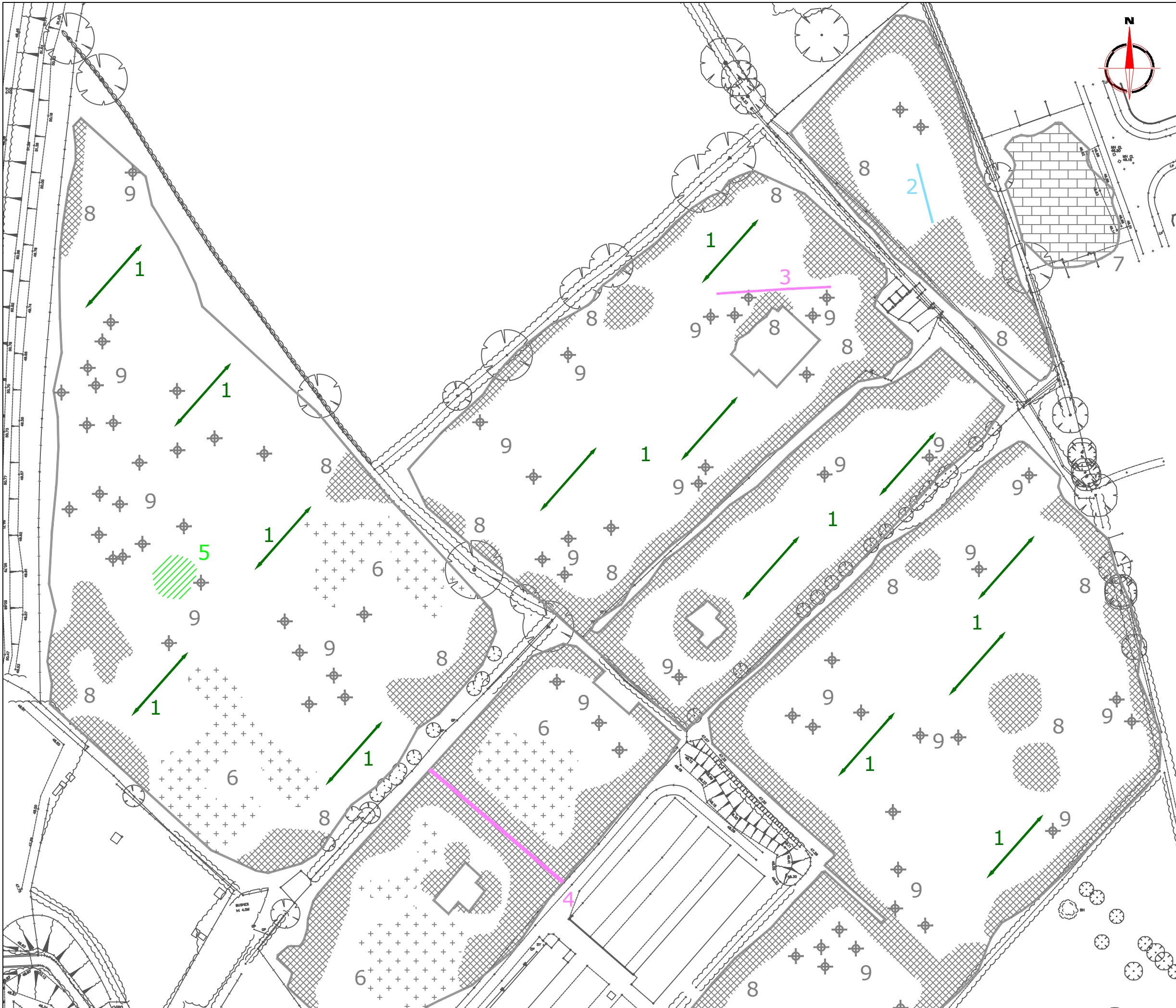

Amendments		
Issue No.	Date	Description
-	-	-
-	-	-
© Stratascan Ltd - ----		
KEY		
PROBABLE ARCHAEOLOGY		
	Positive anomaly / weak positive anomaly - probable cut feature of archaeological origin	
	Negative anomaly / weak negative anomaly - probable bank or earthwork of archaeological origin	
	Moderate strength discrete anomaly - probable thermoremanent feature	
	Widely spaced curving parallel linear anomalies - probably related to ridge-and-furrow	
POSSIBLE ARCHAEOLOGY		
	Positive anomaly / weak positive anomaly - possible cut feature of archaeological origin	
	Negative anomaly / weak negative anomaly - possible bank or earthwork of archaeological origin	
	Moderate strength discrete anomaly - possible thermoremanent feature	
OTHER ANOMALIES		
	Closely spaced parallel linear anomalies - probably related to agricultural activity such as ploughing	
	Linear anomaly - possibly related to pipe, cable or other modern service	
	Unknown origin - likely to be modern	
	Magnetic disturbance associated with nearby metal object such as service or field boundary	
	Strong magnetic debris - possible disturbed or made ground	
	Scattered magnetic debris	
	Area of amorphous magnetic variation - probable natural (e.g. geological or pedological) origin	
	Magnetic spike - probable ferrous object	
Client		
HALCROW GROUP LTD		
Project Title		Job No. J7433
ALLIMORE LANE, ALCESTER, WARWICKSHIRE		
Subject		
ABSTRACTION AND INTERPRETATION OF GRADIOMETER ANOMALIES - NORTH		
STRATASCAN™		
GEOPHYSICS FOR ARCHAEOLOGY AND ENGINEERING		
VINEYARD HOUSE		T: 01684 592266
UPTON UPON SEVERN		E: info@stratascan.co.uk
WR8 0SA		www.stratascan.co.uk
Scale		
1:1000		
Plot	Checked by	Issue No.
A3	DGE	01
Survey date	Drawn by	Figure No.
OCT 14	TR	10

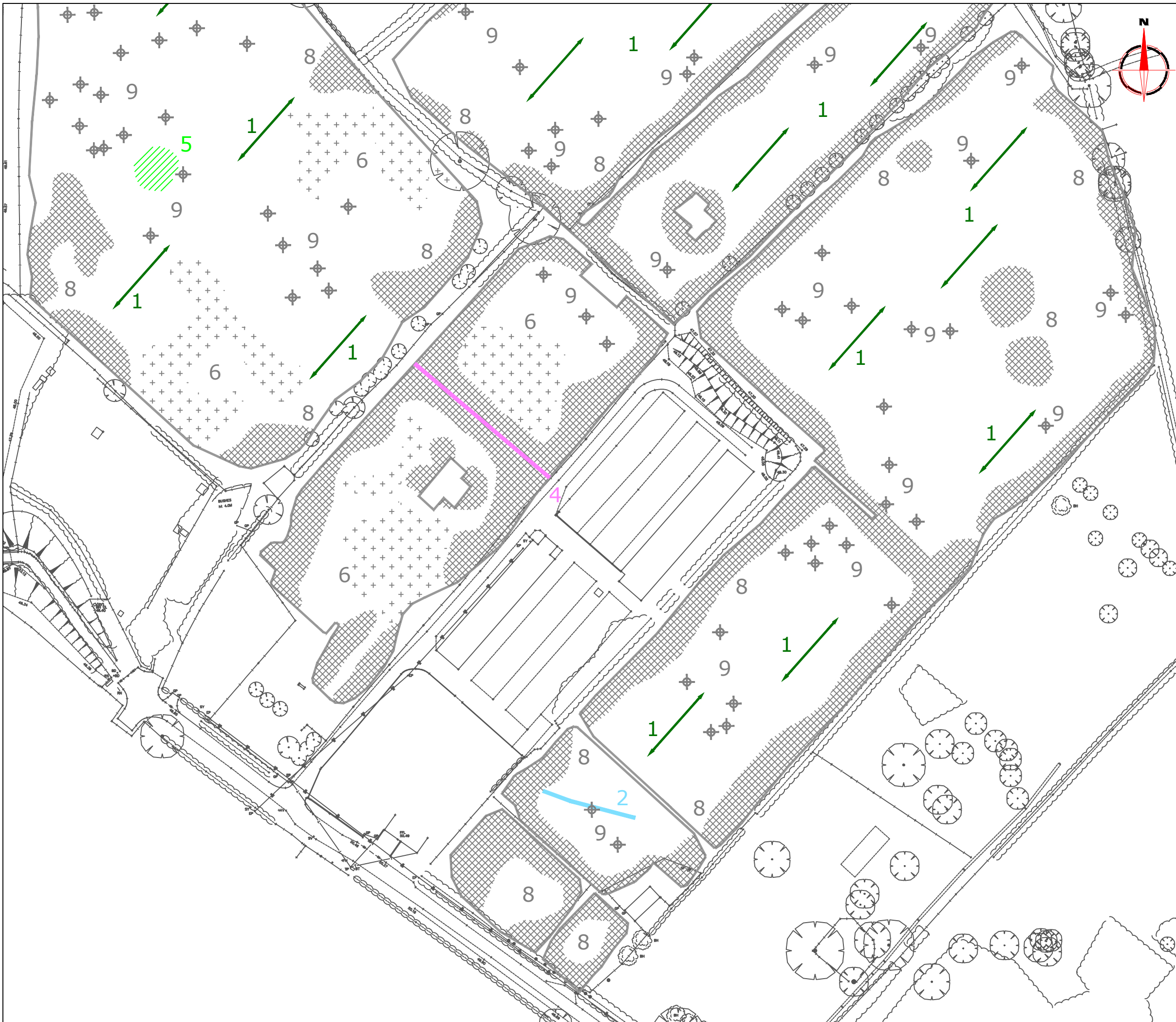

Amendments		
Issue No.	Date	Description
-	-	-
-	-	-
© Stratascan Ltd - ----		

KEY

PROBABLE ARCHAEOLOGY

- Positive anomaly / weak positive anomaly - probable cut feature of archaeological origin
- Negative anomaly / weak negative anomaly - probable bank or earthwork of archaeological origin
- Moderate strength discrete anomaly - probable thermoremanent feature
- Widely spaced curving parallel linear anomalies - probably related to ridge-and-furrow

POSSIBLE ARCHAEOLOGY

- Positive anomaly / weak positive anomaly - possible cut feature of archaeological origin
- Negative anomaly / weak negative anomaly - possible bank or earthwork of archaeological origin
- Moderate strength discrete anomaly - possible thermoremanent feature

OTHER ANOMALIES

- Closely spaced parallel linear anomalies - probably related to agricultural activity such as ploughing
- Linear anomaly - possibly related to pipe, cable or other modern service
- Unknown origin - likely to be modern
- Magnetic disturbance associated with nearby metal object such as service or field boundary
- Strong magnetic debris - possible disturbed or made ground
- Scattered magnetic debris
- Area of amorphous magnetic variation - probable natural (e.g. geological or pedological) origin
- Magnetic spike - probable ferrous object

Client
HALCROW GROUP LTD

Project Title Job No. J7433
ALLIMORE LANE, ALCESTER, WARWICKSHIRE

Subject
ABSTRACTION AND INTERPRETATION OF GRADIOMETER ANOMALIES - SOUTH

STRATASCAN™
GEOPHYSICS FOR ARCHAEOLOGY AND ENGINEERING

VINEYARD HOUSE T: 01684 592266
UPTON UPON SEVERN E: info@stratascan.co.uk
WR8 0SA www.stratascan.co.uk

EUROPEAN GPR ASSOCIATION
SUMO GROUP MEMBER

Scale 1:1000

Plot A3	Checked by DGE	Issue No. 01
Survey date OCT 14	Drawn by TR	Figure No. 11