

Reproduced from Ordnance Survey's 1:25 000 map of 1998 with the permission of the controller of Her Majesty's Stationery Office. Crown Copyright reserved. Licence No: AL 50125A
 Licensee:
 Stratascan Ltd.
 Vineyard House
 Upper Hook Road
 Upton Upon Severn
 WR8 0SA
 OS 100km square = SJ

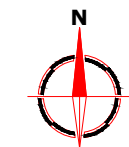

31
30
29
28
27

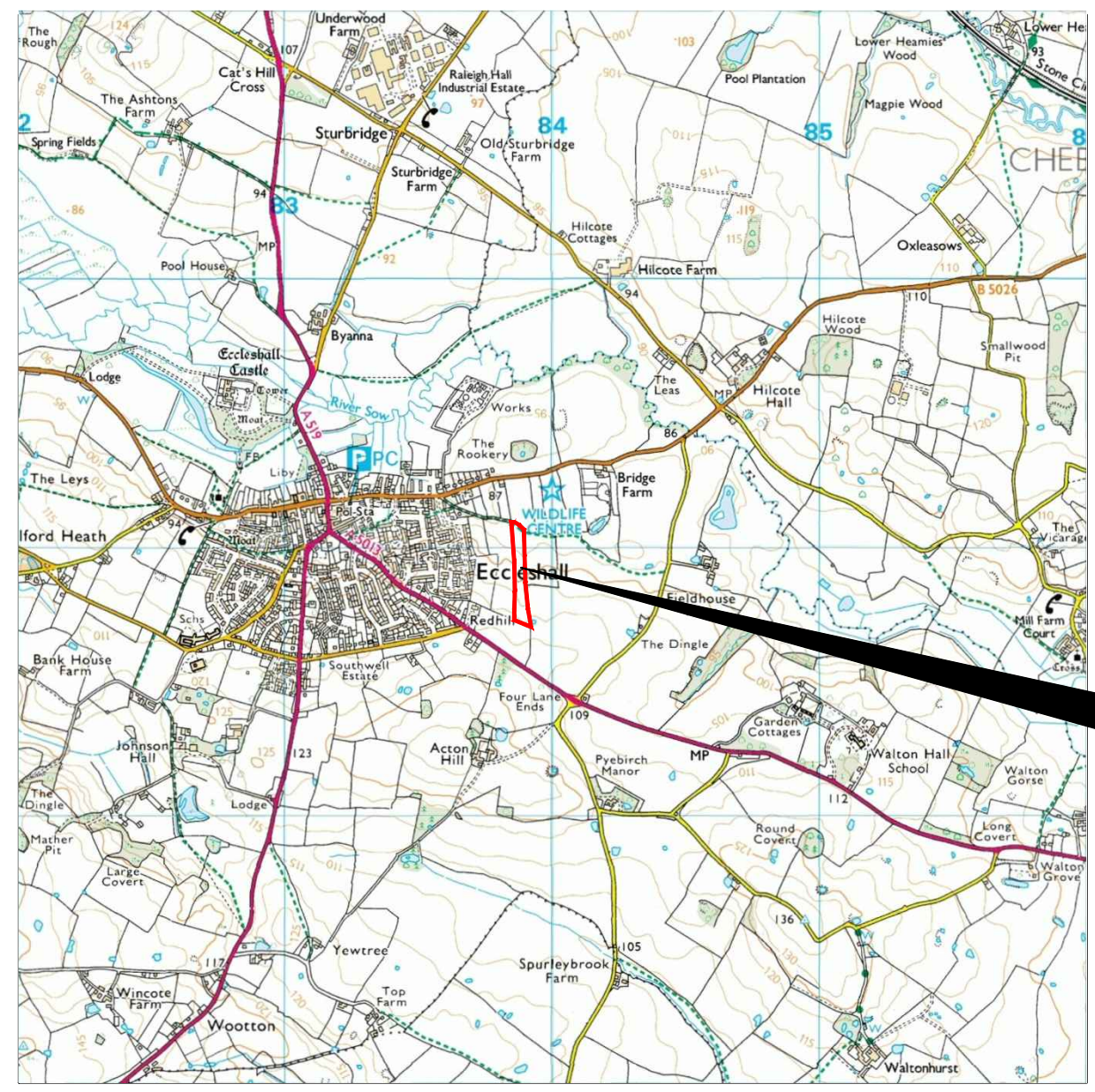

82 83 84 85 86

Amendments

Issue No.	Date	Description
-	-	-
-	-	-

© Stratascan Ltd - 2014



Site centred on NGR SJ 838 290

Client
CgMs CONSULTING LTD

Project Title Job No. J7135
ECCLESHALL, STAFFORDSHIRE

Subject
LOCATION PLAN OF SURVEY AREA

STRATASCAN™
 GEOPHYSICS FOR ARCHAEOLOGY AND ENGINEERING
 VINEYARD HOUSE T: 01684 592266
 UPTON UPON SEVERN E: info@stratascan.co.uk
 WR8 0SA www.stratascan.co.uk

GPR ASSOCIATION
SUMO SURVEYS SUMO GROUP MEMBER
 ISO 9001 certified ISO 14001 certified

Scale 1:25000 0m 500m 1000m

Plot A3	Checked by DGE	Issue No. 01
Survey date JULY 14	Drawn by TR	Figure No. 01

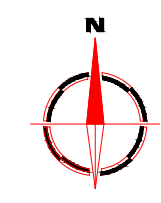
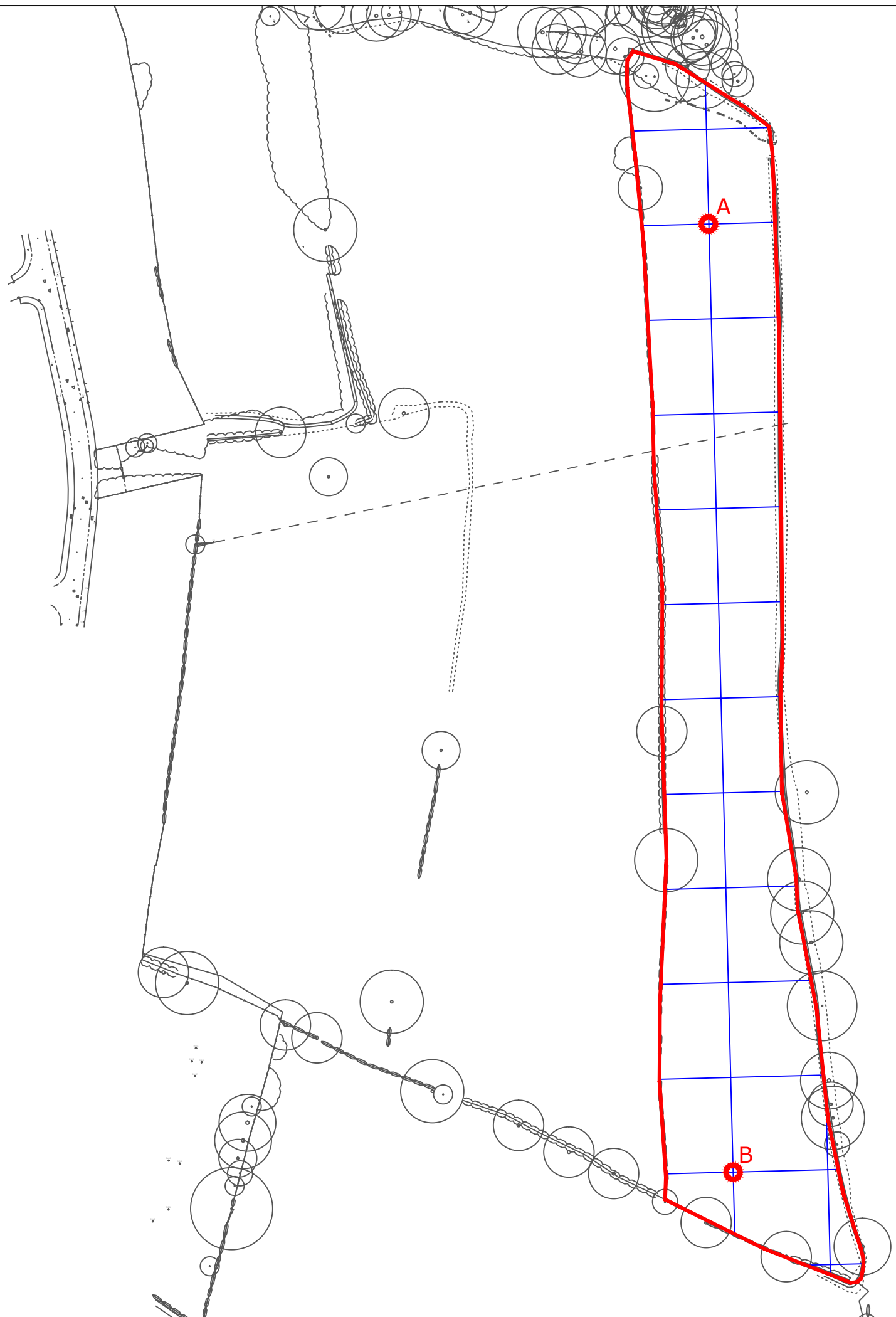

Amendments

Issue No.	Date	Description
-	-	-
-	-	-

© Stratascan Ltd - 2014

OS GRID REFERENCES

A	383876.32, 329037.58
B	383884.12, 328737.68

Client
CgMs CONSULTING LTD

Project Title Job No. J7135
ECCLESHALL, STAFFORDSHIRE

Subject
LOCATION OF SURVEY GRIDS AND REFERENCING

STRATASCAN™
GEOPHYSICS FOR ARCHAEOLOGY AND ENGINEERING
 VINEYARD HOUSE T: 01684 592266
 UPTON UPON SEVERN E: info@stratascan.co.uk
 WR8 0SA www.stratascan.co.uk



SUMO GROUP MEMBER



Scale **1:1500**
 0m 10 20 30 40 50m

Plot A3	Checked by DGE	Issue No. 01
Survey date JULY 14	Drawn by TR	Figure No. 02

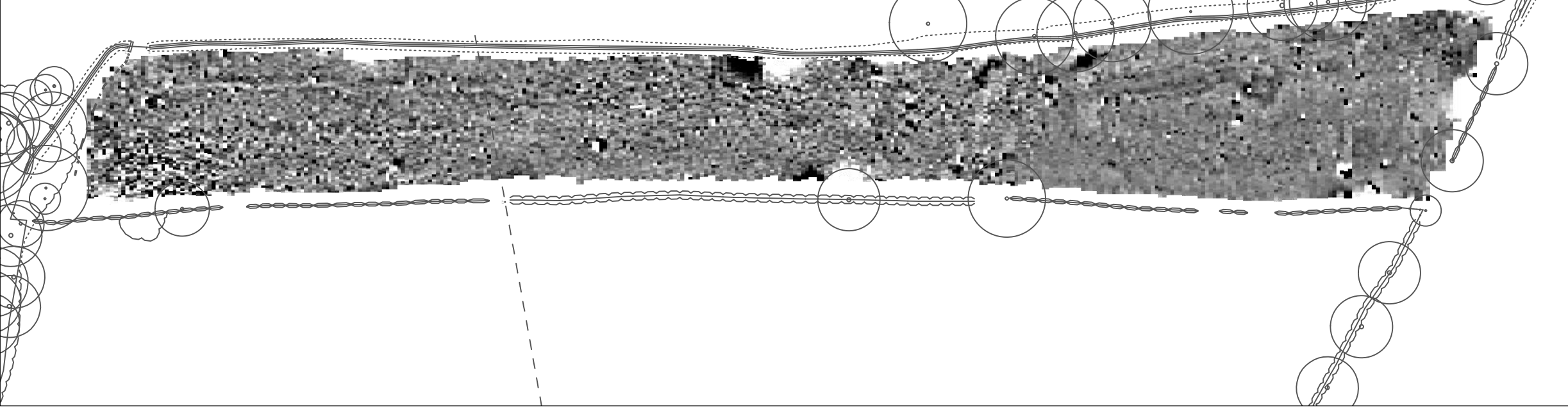
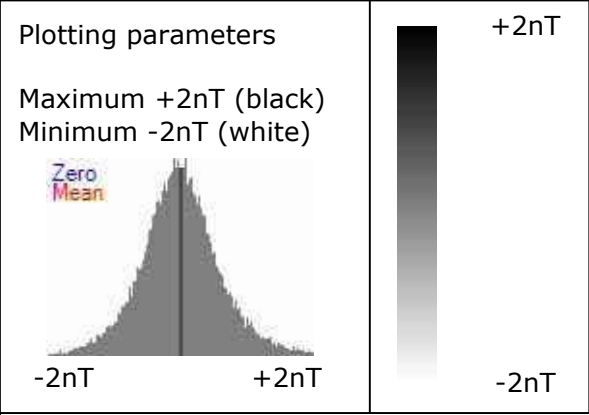
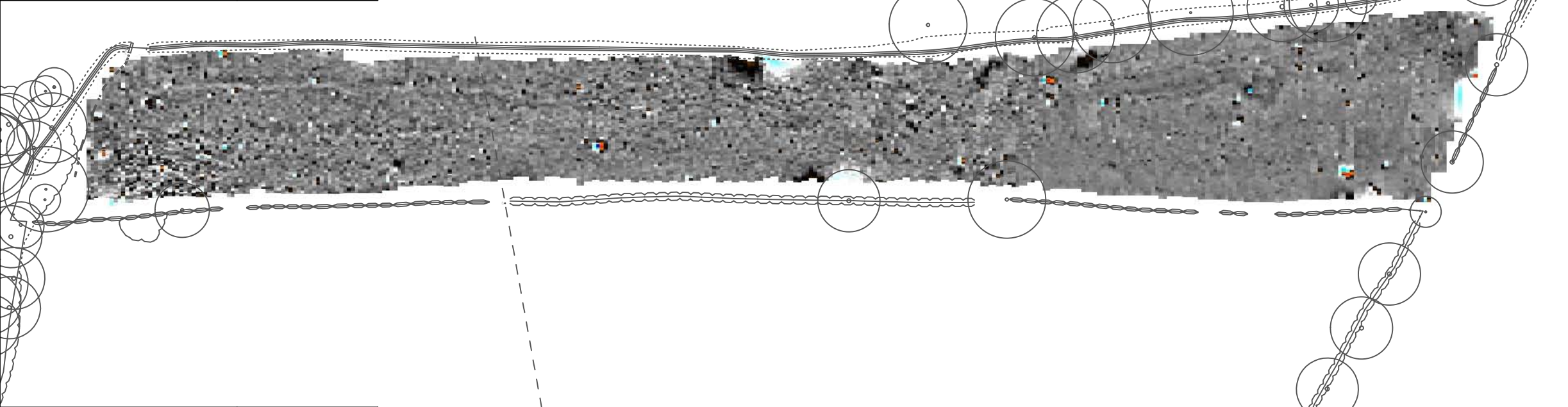
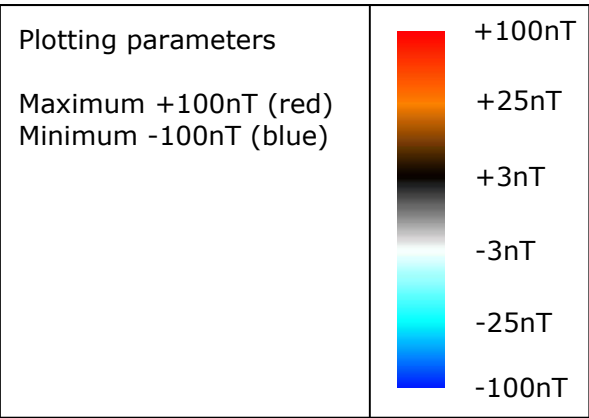

Amendments		
Issue No.	Date	Description
-	-	-
-	-	-
© Stratascan Ltd - 2014		

Client
CgMs CONSULTING LTD

Project Title
ECCLESHALL, STAFFORDSHIRE

Job No. J7135

Subject
COLOUR AND GREYSCALE PLOTS OF GRADIOMETER DATA

STRATASCAN™
GEOPHYSICS FOR ARCHAEOLOGY AND ENGINEERING

VINEYARD HOUSE T: 01684 592266
UPTON UPON SEVERN E: info@stratascan.co.uk
WR8 0SA www.stratascan.co.uk

Scale
1:1250

Plot A3	Checked by DGE	Issue No. 01
Survey date JULY 14	Drawn by TR	Figure No. 03



Amendments		
Issue No.	Date	Description
-	-	-
-	-	-
© Stratascan Ltd - 2014		
KEY		
PROBABLE ARCHAEOLOGY		
	Positive anomaly / weak positive anomaly - probable cut feature of archaeological origin	
	Negative anomaly / weak negative anomaly - probable bank or earthwork of archaeological origin	
	Moderate strength discrete anomaly - probable thermoremanent feature	
	Widely spaced curving parallel linear anomalies - probably related to ridge-and-furrow	
POSSIBLE ARCHAEOLOGY		
	Positive anomaly / weak positive anomaly - possible cut feature of archaeological origin	
	Negative anomaly / weak negative anomaly - possible bank or earthwork of archaeological origin	
	Moderate strength discrete anomaly - possible thermoremanent feature	
OTHER ANOMALIES		
	Closely spaced parallel linear anomalies - probably related to agricultural activity such as ploughing	
	Linear anomaly - probably related to pipe, cable or other modern service	
	Linear anomaly - possibly related to land drain	
	Magnetic disturbance associated with nearby metal object such as service or field boundary	
	Strong magnetic debris - possible disturbed or made ground	
	Scattered magnetic debris	
	Area of amorphous magnetic variation - probable natural (e.g. geological or pedological) origin	
	Magnetic spike - probable ferrous object	
Client		
CgMs CONSULTING LTD		
Project Title		Job No. J7135
ECCLESHALL, STAFFORDSHIRE		
Subject		
ABSTRACTION AND INTERPRETATION OF GRADIOMETER ANOMALIES		
STRATASCAN™		
GEOPHYSICS FOR ARCHAEOLOGY AND ENGINEERING		
VINEYARD HOUSE		T: 01684 592266
UPTON UPON SEVERN		E: info@stratascan.co.uk
WR8 0SA		www.stratascan.co.uk
	SUMO GROUP MEMBER	
Scale		
1:1250		
0m 10 20 30 40 50m		
Plot	Checked by	Issue No.
A3	DGE	01
Survey date	Drawn by	Figure No.
JULY 14	TR	04