

Amendments

| Issue No. | Date | Description |
|-----------|------|-------------|
| - | - | - |
| - | - | - |

© Stratascan Ltd - 2014

Survey area
Site centred on NGR TM 107 332

KEY

PROBABLE ARCHAEOLOGY

Area unsurveyable - overgrown, boggy ground

OS REFERENCING INFORMATION

| | |
|---|----------------------|
| A | 610773.75, 233494.19 |
| B | 610773.75, 233404.19 |
| C | 610863.75, 233494.19 |
| D | 610863.75, 233404.19 |
| E | 610713.75, 233344.19 |
| F | 610923.75, 233344.19 |
| G | 610623.75, 233314.19 |
| H | 610623.75, 233194.19 |
| I | 610953.75, 233254.19 |
| J | 611013.75, 233254.19 |
| K | 611103.75, 233194.19 |
| L | 611193.75, 233194.19 |

Job No. J6858 Survey Date MAY 14

Client
CgMs CONSULTING LTD

Project Title
BRANTHAM, SUFFOLK

Subject
SITE LOCATION, SURVEY AREA & REFERENCING

STRATASCAN
GEOPHYSICS FOR ARCHAEOLOGY AND ENGINEERING

VINEYARD HOUSE T: 01684 592266
UPTON UPON SEVERN E: info@stratascan.co.uk
WR8 0SA www.stratascan.co.uk

GPR ASSOCIATION

SUMO GROUP MEMBER

ISO 9001 certified
ISO 14001 certified

Scale 1:1250

0m 10 20 30 40 50 60 70 80m

| | | |
|--------------|----------------|---------------|
| Plot A1 | Checked by DGE | Issue No. 01 |
| Date JUNE 14 | Drawn by TR | Figure No. 01 |

Survey area

Reproduced from Ordnance Survey's 1:25 000 map of 1998 with the permission of the controller of Her Majesty's Stationary Office. Crown Copyright reserved. Licence No: AL 50125A

Licence:
Stratascan Ltd.
Vineyard House
Upton Hook Road
Upton Upon Severn
WR8 0SA

OS 100km square = TM

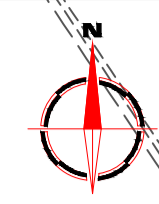

Amendments

| Issue No. | Date | Description |
|-----------|------|-------------|
| - | - | - |
| - | - | - |

© Stratascan Ltd - 2014

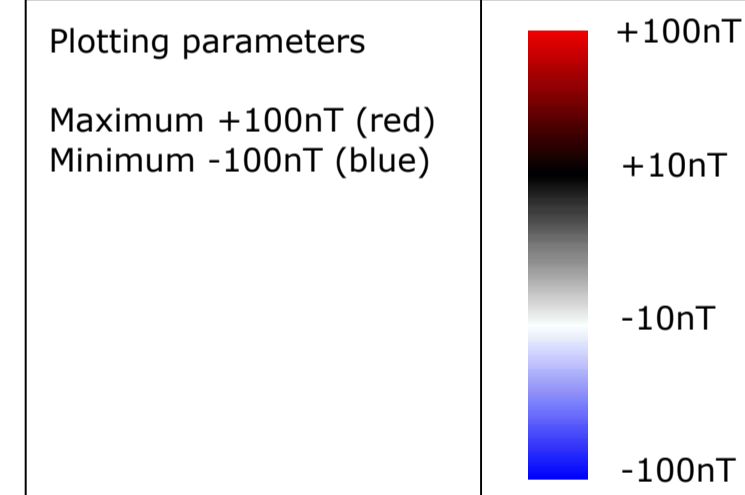

| | | | |
|---------|-------|-------------|--------|
| Job No. | J6858 | Survey Date | MAY 14 |
|---------|-------|-------------|--------|

Client
CgMs CONSULTING LTD

Project Title
BRANTHAM, SUFFOLK

Subject
**COLOUR PLOT OF
GRADIOMETER DATA
SHOWING EXTREME VALUES**

STRATASCAN™
 GEOPHYSICS FOR ARCHAEOLOGY
 AND ENGINEERING
 VINEYARD HOUSE T: 01684 592266
 UPTON UPON SEVERN E: info@stratascan.co.uk
 WR8 0SA www.stratascan.co.uk

GPR ASSOCIATION
SUMO GROUP MEMBER
 ISO 9001 certified
 ISO 14001 certified

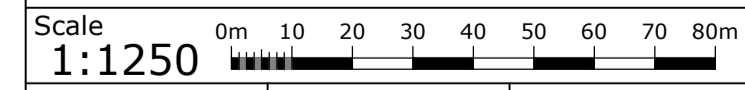

| | | | | | |
|------|---------|------------|-----|------------|----|
| Plot | A1 | Checked by | DGE | Issue No. | 01 |
| Date | JUNE 14 | Drawn by | TR | Figure No. | 02 |

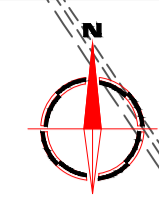

Amendments

| Issue No. | Date | Description |
|-----------|------|-------------|
| - | - | - |
| - | - | - |

© Stratascan Ltd - 2014

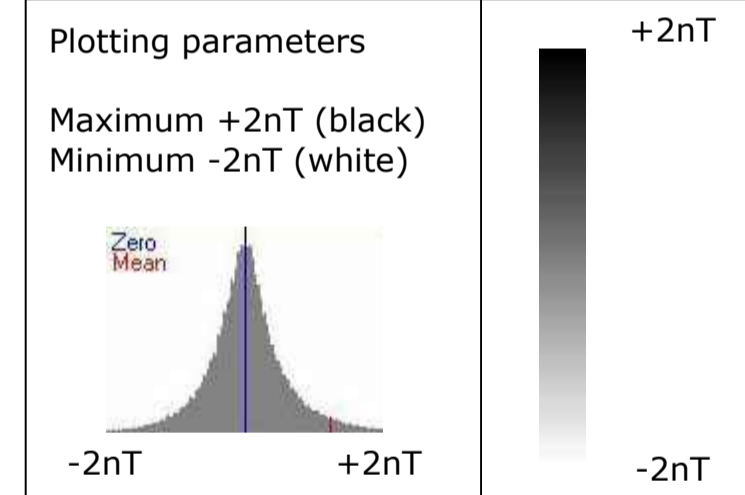

| | |
|---------|-------------|
| Job No. | Survey Date |
| J6858 | MAY 14 |

Client
CgMs CONSULTING LTD

Project Title
BRANTHAM, SUFFOLK

Subject
PLOT OF MINIMALLY PROCESSED GRADIOMETER DATA

STRATASCAN™
GEOPHYSICS FOR ARCHAEOLOGY AND ENGINEERING
VINEYARD HOUSE T: 01684 592266
UPTON UPON SEVERN E: info@stratascan.co.uk
WR8 0SA www.stratascan.co.uk



Scale 0m 10 20 30 40 50 60 70 80m
1:1250

| | | |
|---------|------------|------------|
| Plot | Checked by | Issue No. |
| A1 | DGE | 01 |
| Date | Drawn by | Figure No. |
| JUNE 14 | TR | 03 |

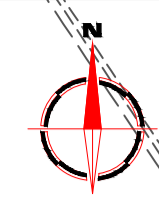
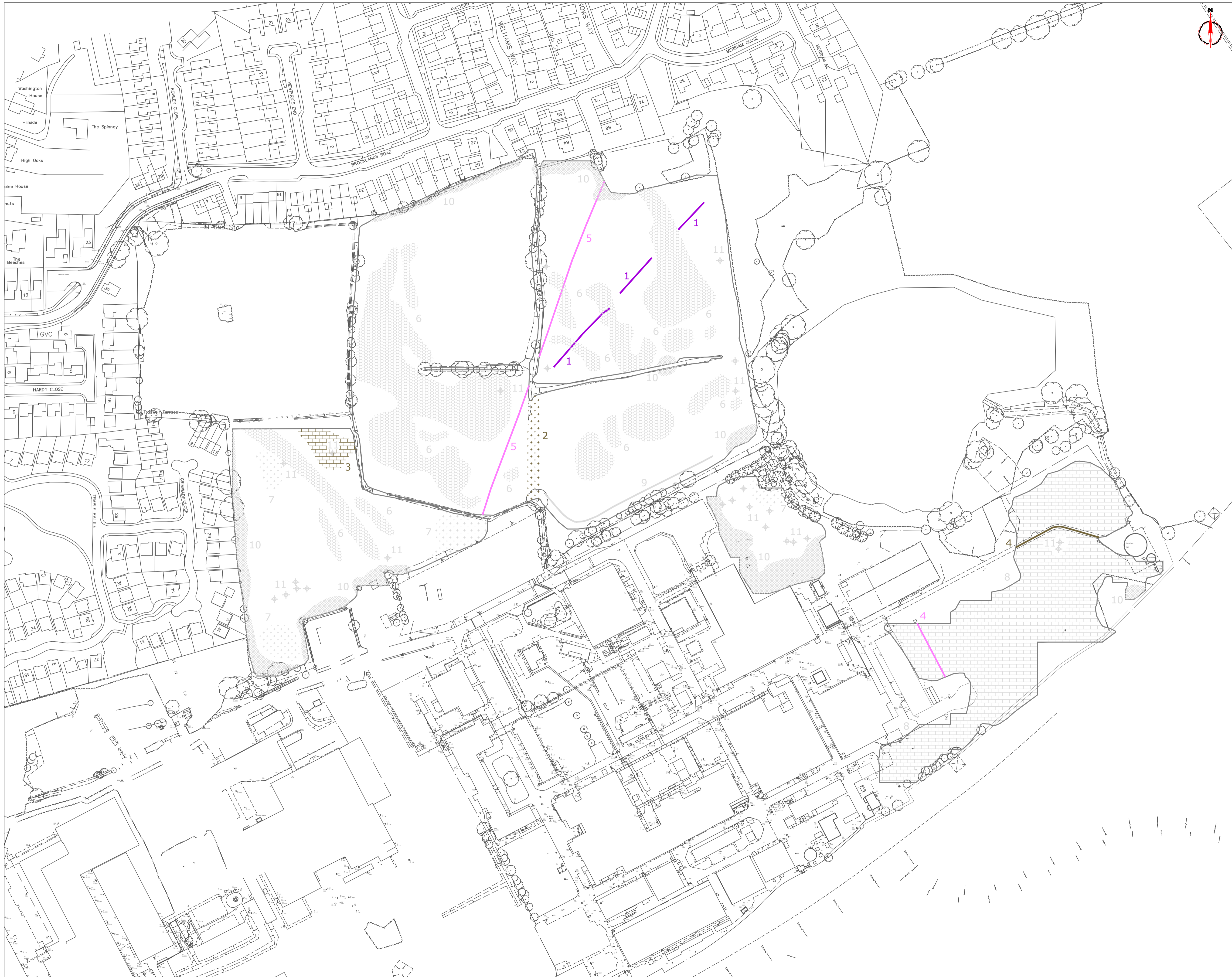

Amendments

| Issue No. | Date | Description |
|-----------|------|-------------|
| - | - | - |
| - | - | - |

© Stratascan Ltd - 2014

KEY

PROBABLE ARCHAEOLOGY

- Positive anomaly / weak positive anomaly - probable cut feature of archaeological origin
- Negative anomaly / weak negative anomaly - probable bank or earthwork of archaeological origin
- Linear area of scattered magnetic debris - former field boundary present on available mapping 1880-1984
- Linear anomaly - probable former footpath not present on available mapping
- Widely spaced curving parallel line anomalies - probably related to ridge-and-furrow

POSSIBLE ARCHAEOLOGY

- Positive anomaly / weak positive anomaly - possible cut feature of archaeological origin
- Negative anomaly / weak negative anomaly - possible bank or earthwork of archaeological origin

OTHER ANOMALIES

- Linear anomaly - probably related to agricultural activity such as ploughing
- Linear anomaly - probably related to pipe, cable or other modern service
- Linear anomaly - modern path way
- Linear anomaly - possibly related to land drain
- Magnetic disturbance associated with nearby metal object such as service or field boundary
- Strong magnetic debris - possible disturbed or made ground
- Magnetic disturbance - former pond present on available mapping 1880-1974
- Scattered magnetic debris
- Area of amorphous magnetic variation - probable natural (e.g. geological or pedological) origin
- Magnetic spike - probable ferrous object

Job No. **J6858** Survey Date **MAY 14**

Client
CgMs CONSULTING LTD

Project Title
BRANTHAM, SUFFOLK

Subject
INTERPRETATION

STRATASCAN™
 GEOPHYSICS FOR ARCHAEOLOGY
 AND ENGINEERING
 VINEYARD HOUSE T: 01684 592266
 UPTON UPON SEVERN E: info@stratascan.co.uk
 WR8 0SA www.stratascan.co.uk

GPR ASSOCIATION
SUMO GROUP MEMBER
 ISO 9001 certified
 ISO 14001 certified
 ISO 18001 certified

Scale 0m 10 20 30 40 50 60 70 80m
1:1250

| | | |
|---------------------|-----------------------|----------------------|
| Plot A1 | Checked by DGE | Issue No. 01 |
| Date JUNE 14 | Drawn by TR | Figure No. 04 |