

Reproduced from Ordnance Survey's 1:25 000 map of 1998 with the permission of the controller of Her Majesty's Stationery Office. Crown Copyright reserved. Licence No: AL 50125A
 Licencee:
 Stratascan Ltd.
 Vineyard House
 Upper Hook Road
 Upton Upon Severn
 WR8 0SA
 OS 100km square = SW

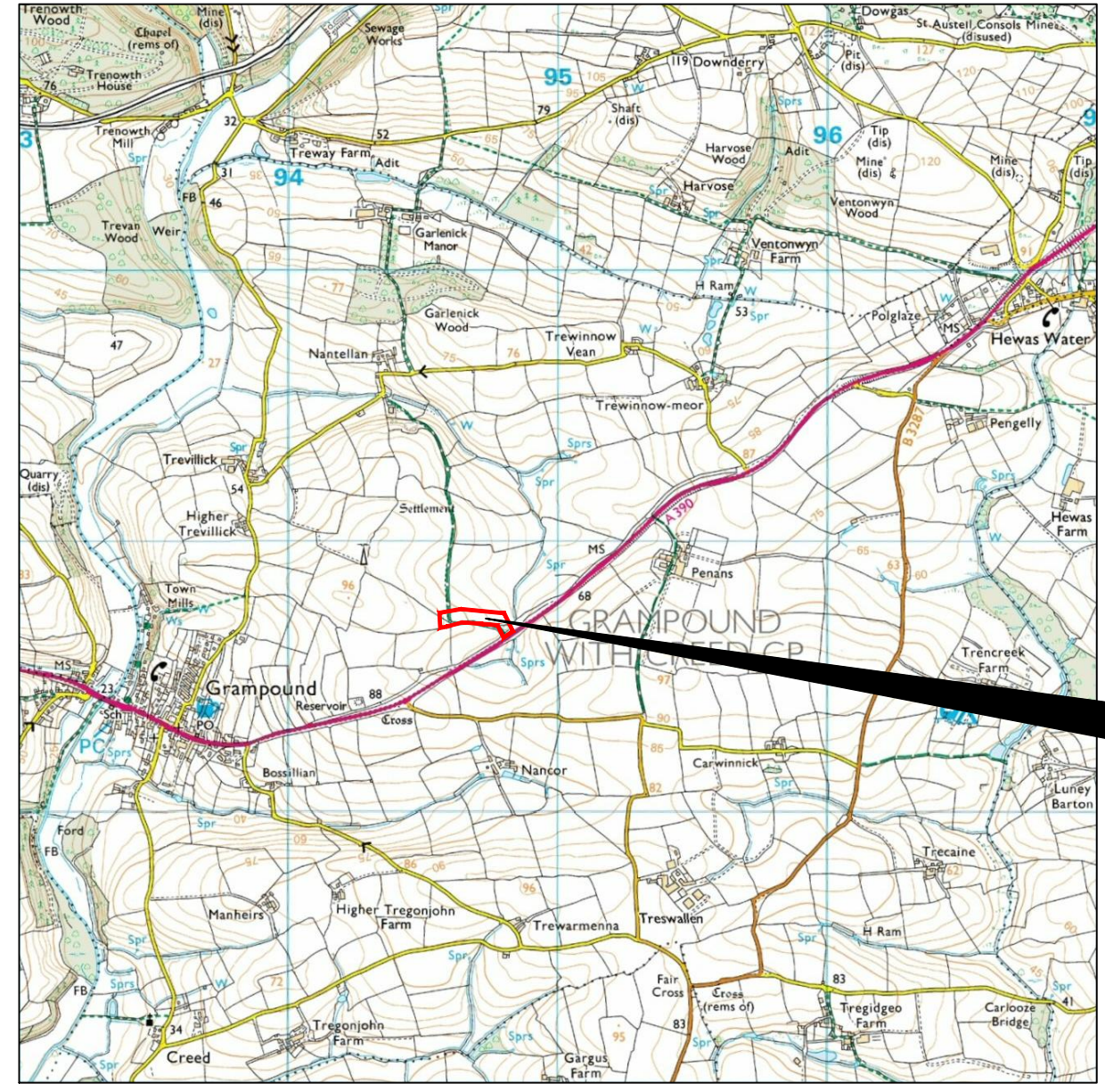

51
50
49
48
47



93 94 95 96 97

Amendments

Issue No.	Date	Description
-	-	-
-	-	-

© Stratascan Ltd - ----

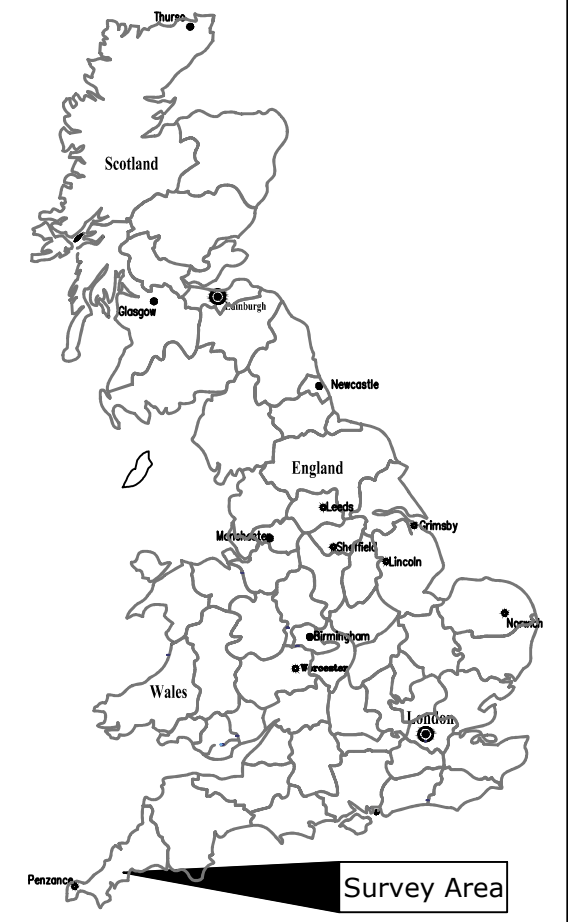

Site centred on NGR **SW 944 484**

Client
CORNWALL COUNCIL

Project Title **PENNANS LAND, CORNWALL** Job No. **J7442**

Subject
LOCATION PLAN OF SURVEY AREA

STRATASCAN™
GEOPHYSICS FOR ARCHAEOLOGY AND ENGINEERING
 VINEYARD HOUSE T: 01684 592266
 UPTON UPON SEVERN E: info@stratascan.co.uk
 WR8 0SA www.stratascan.co.uk

EUROPEAN GPR ASSOCIATION
sumo SUMO GROUP MEMBER
 ISO 9001 certified ISO 14001 certified

Scale **1:25000** 0m 500m 1000m

Plot A3	Checked by DGE	Issue No. 01
Survey date SEPT 14	Drawn by TR	Figure No. 01

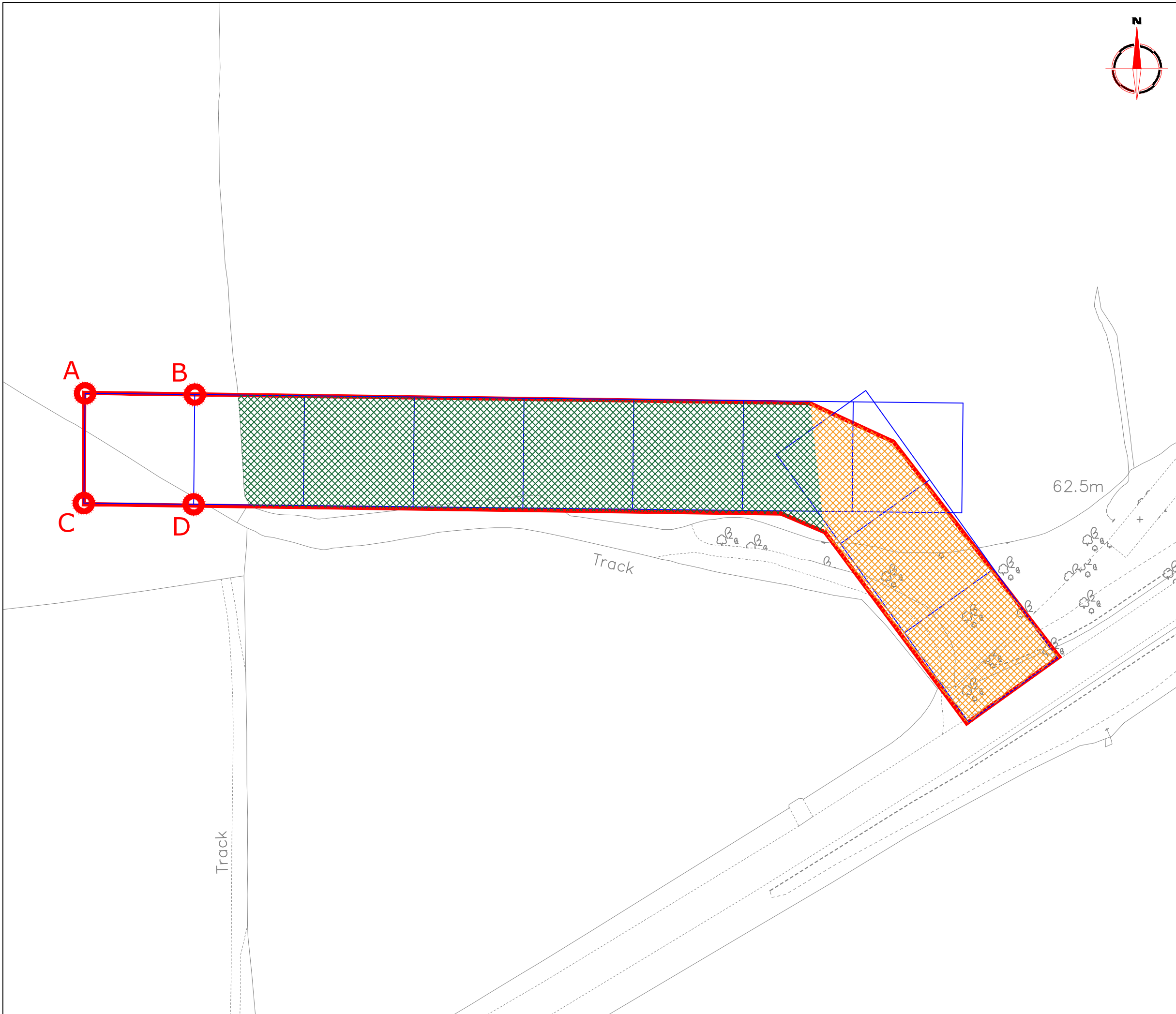

Amendments

Issue No.	Date	Description
-	-	-
-	-	-

© Stratascan Ltd - ----

KEY

	Area unsurveyable - crop
	Area unsurveyable - building site

OS GRID REFERENCES

A	194561.95, 048731.05
B	194591.95, 048730.78
C	194561.62, 048701.05
D	194591.62, 048700.72

Client
CORNWALL COUNCIL

Project Title Job No. J7442
PENNANS LAND, CORNWALL

Subject
LOCATION OF SURVEY GRIDS AND REFERENCING



GEOPHYSICS FOR ARCHAEOLOGY AND ENGINEERING

VINEYARD HOUSE T: 01684 592266
UPTON UPON SEVERN E: info@stratascan.co.uk
WR8 0SA www.stratascan.co.uk



SUMO GROUP MEMBER



Scale **1:1000**

Plot A3	Checked by DGE	Issue No. 01
Survey date SEPT 14	Drawn by TR	Figure No. 02

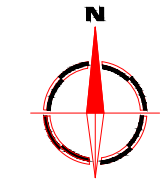
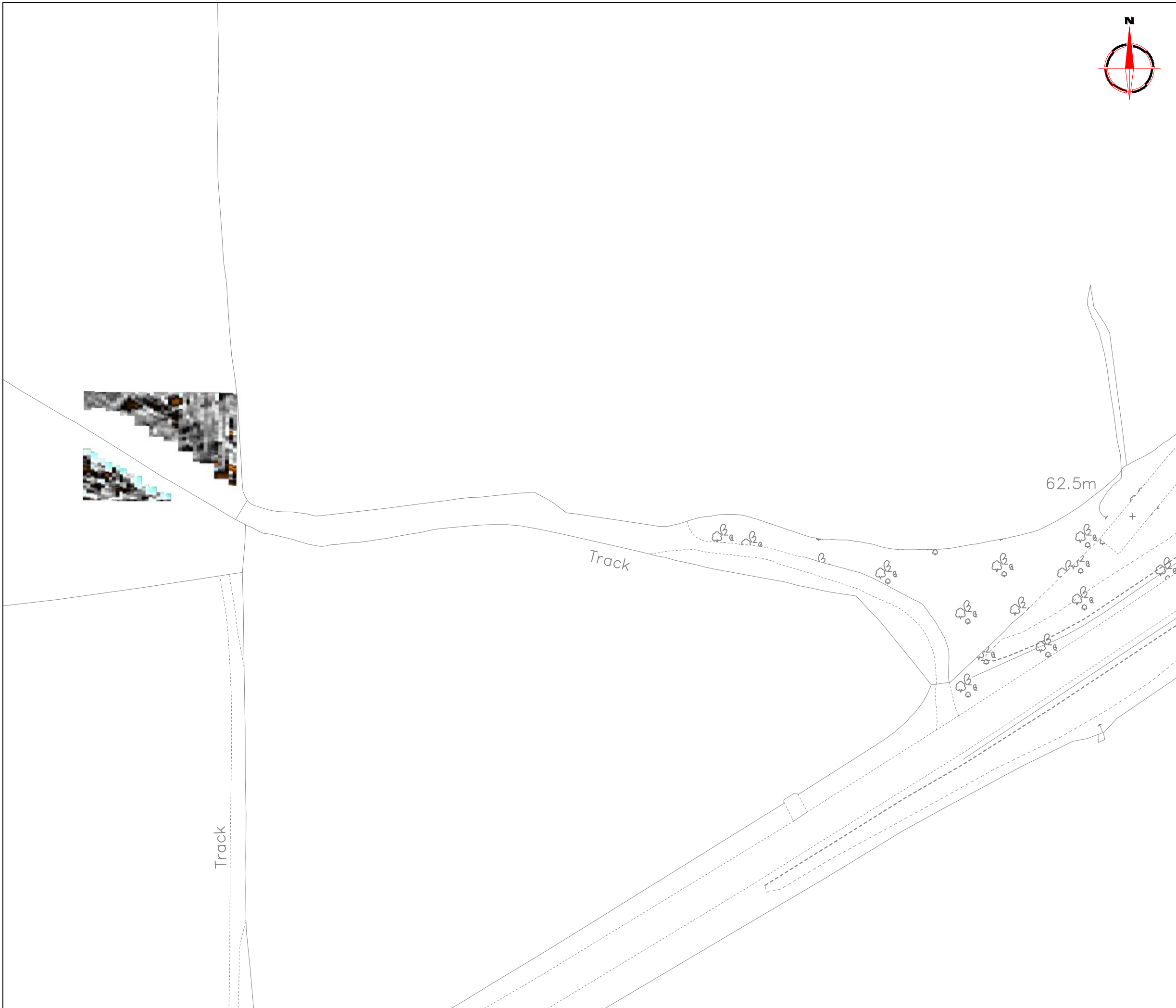

Amendments		
Issue No.	Date	Description
-	-	-
-	-	-
© Stratascan Ltd - ----		

Plotting parameters	
Maximum +100nT (red)	
Minimum -100nT (blue)	

Client	CORNWALL COUNCIL	
Project Title	Job No. J7442	
	PENNANS LAND, CORNWALL	
Subject	COLOUR PLOT OF GRADIOMETER DATA SHOWING EXTREME VALUES	
 STRATASCAN™ GEOPHYSICS FOR ARCHAEOLOGY AND ENGINEERING VINEYARD HOUSE T: 01684 592266 UPTON UPON SEVERN E: info@stratascan.co.uk WR8 0SA www.stratascan.co.uk		
 SUMO GROUP MEMBER		
Scale	0m 10 20 30 40 50	
	1:1000	
Plot	Checked by	Issue No.
A3	DGE	01
Survey date	Drawn by	Figure No.
SEPT 14	TR	03

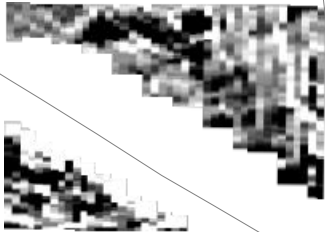

Amendments		
Issue No.	Date	Description
-	-	-
-	-	-
© Stratascan Ltd - ----		

<p>Plotting parameters</p> <p>Maximum +2nT (black) Minimum -2nT (white)</p> <p>-2nT +2nT</p>	<p>+2nT</p> <p>-2nT</p>
---	-------------------------

Client	CORNWALL COUNCIL
Project Title	Job No. J7442
PENNANS LAND, CORNWALL	
Subject	PLOT OF MINIMALLY PROCESSED GRADIOMETER DATA

STRATASCAN™
GEOPHYSICS FOR ARCHAEOLOGY AND ENGINEERING

VINEYARD HOUSE T: 01684 592266
 UPTON UPON SEVERN E: info@stratascan.co.uk
 WR8 0SA www.stratascan.co.uk

EUROPEAN GPR ASSOCIATION

SUMO SURVEYS SUMO GROUP MEMBER

Scale 1:1000 0m 10 20 30 40 50

Plot	Checked by	Issue No.
A3	DGE	01
Survey date	Drawn by	Figure No.
SEPT 14	TR	04

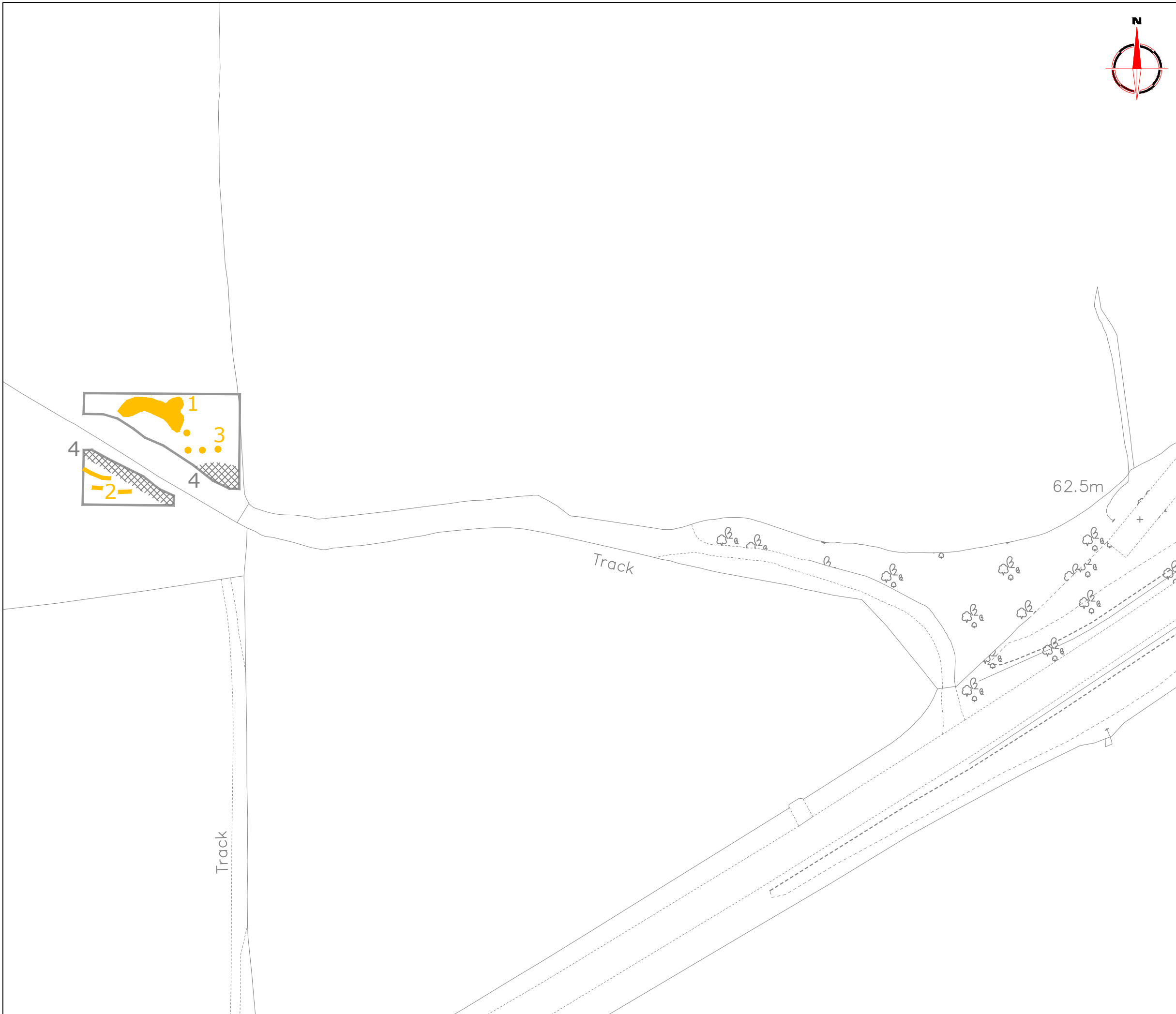

Amendments

Issue No.	Date	Description
-	-	-
-	-	-

© Stratascan Ltd - ----

KEY

PROBABLE ARCHAEOLOGY

- Positive anomaly / weak positive anomaly - probable cut feature of archaeological origin
- Negative anomaly / weak negative anomaly - probable bank or earthwork of archaeological origin
- Moderate strength discrete anomaly - probable thermoremanent feature
- Widely spaced curving parallel linear anomalies - probably related to ridge-and-furrow

POSSIBLE ARCHAEOLOGY

- Positive anomaly / weak positive anomaly - possible cut feature of archaeological origin
- Negative anomaly / weak negative anomaly - possible bank or earthwork of archaeological origin
- Moderate strength discrete anomaly - possible thermoremanent feature

OTHER ANOMALIES

- Closely spaced parallel linear anomalies - probably related to agricultural activity such as ploughing
- Linear anomaly - probably related to pipe, cable or other modern service
- Linear anomaly - possibly related to land drain
- Magnetic disturbance associated with nearby metal object such as service or field boundary
- Strong magnetic debris - possible disturbed or made ground
- Scattered magnetic debris
- Area of amorphous magnetic variation - probable natural (e.g. geological or pedological) origin
- Magnetic spike - probable ferrous object

Client
CORNWALL COUNCIL

Project Title Job No. J7442
PENNANS LAND, CORNWALL

Subject
ABSTRACTION AND INTERPRETATION OF GRADIOMETER ANOMALIES

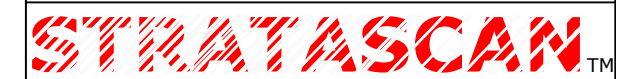

GEOPHYSICS FOR ARCHAEOLOGY AND ENGINEERING

VINEYARD HOUSE T: 01684 592266
UPTON UPON SEVERN E: info@stratascan.co.uk
WR8 0SA www.stratascan.co.uk



SUMO GROUP MEMBER



Scale **1:1000**

Plot A3	Checked by DGE	Issue No. 01
-------------------	--------------------------	------------------------

Survey date SEPT 14	Drawn by TR	Figure No. 05
-------------------------------	-----------------------	-------------------------