

Reproduced from Ordnance Survey's 1:25 000 map of 1998 with the permission of the controller of Her Majesty's Stationery Office. Crown Copyright reserved. Licence No: AL 50125A
 Licences:
 Stratascan Ltd
 Vineyard House
 Upper Hook Road
 Upton Upon Severn
 WR8 0SA
 OS 100km square = ST

Survey area

NORTH

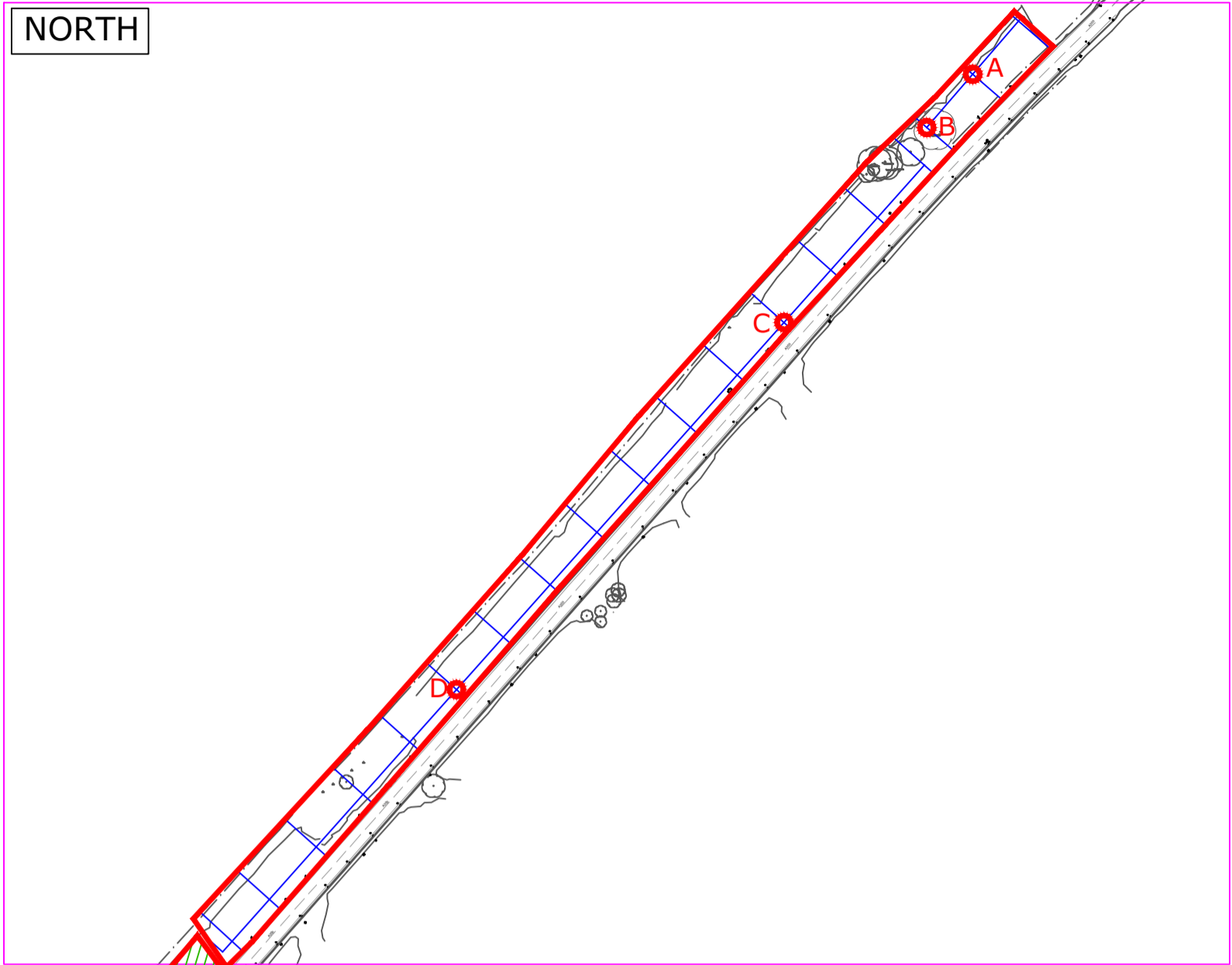

CENTRE

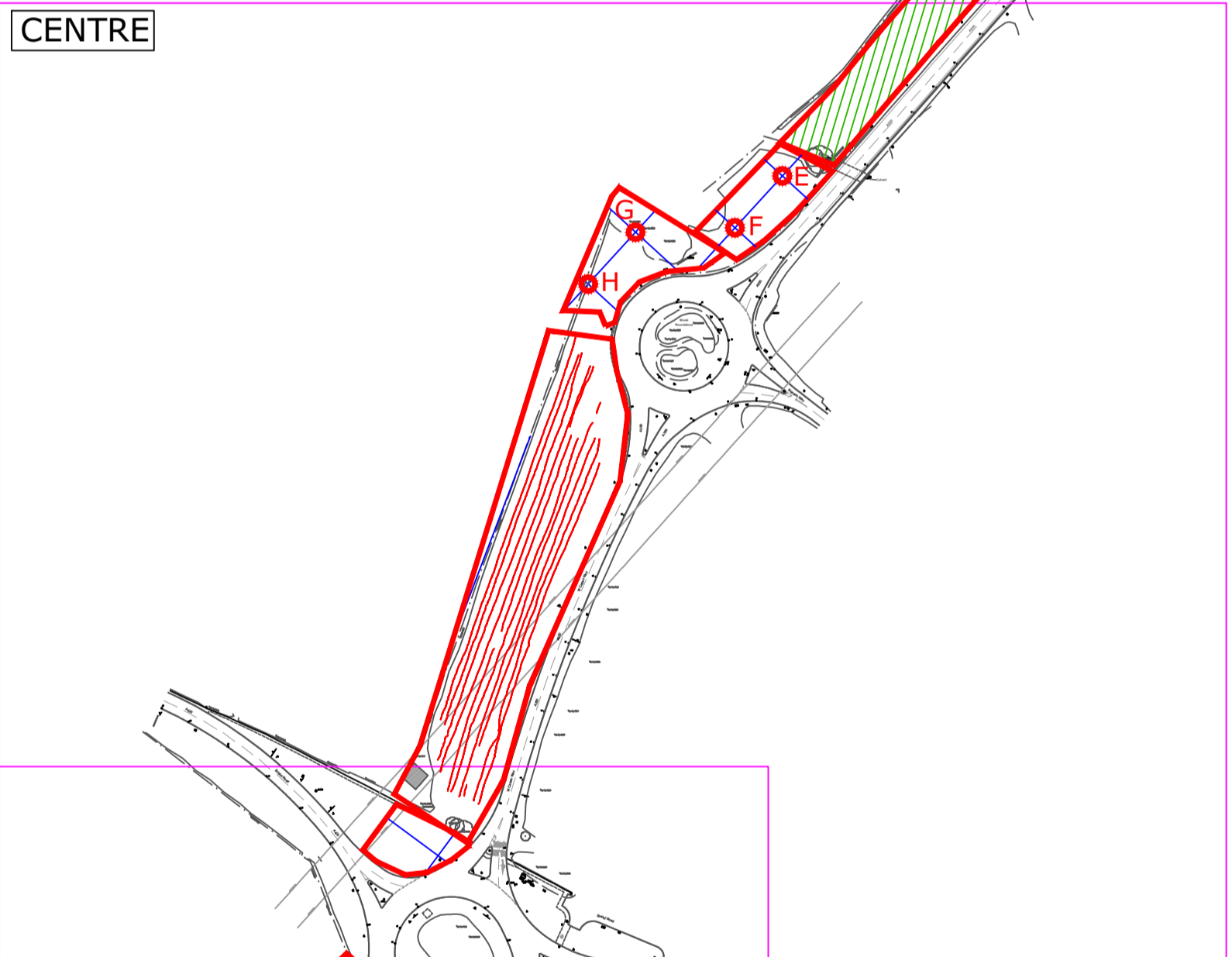

SOUTH

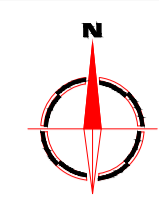
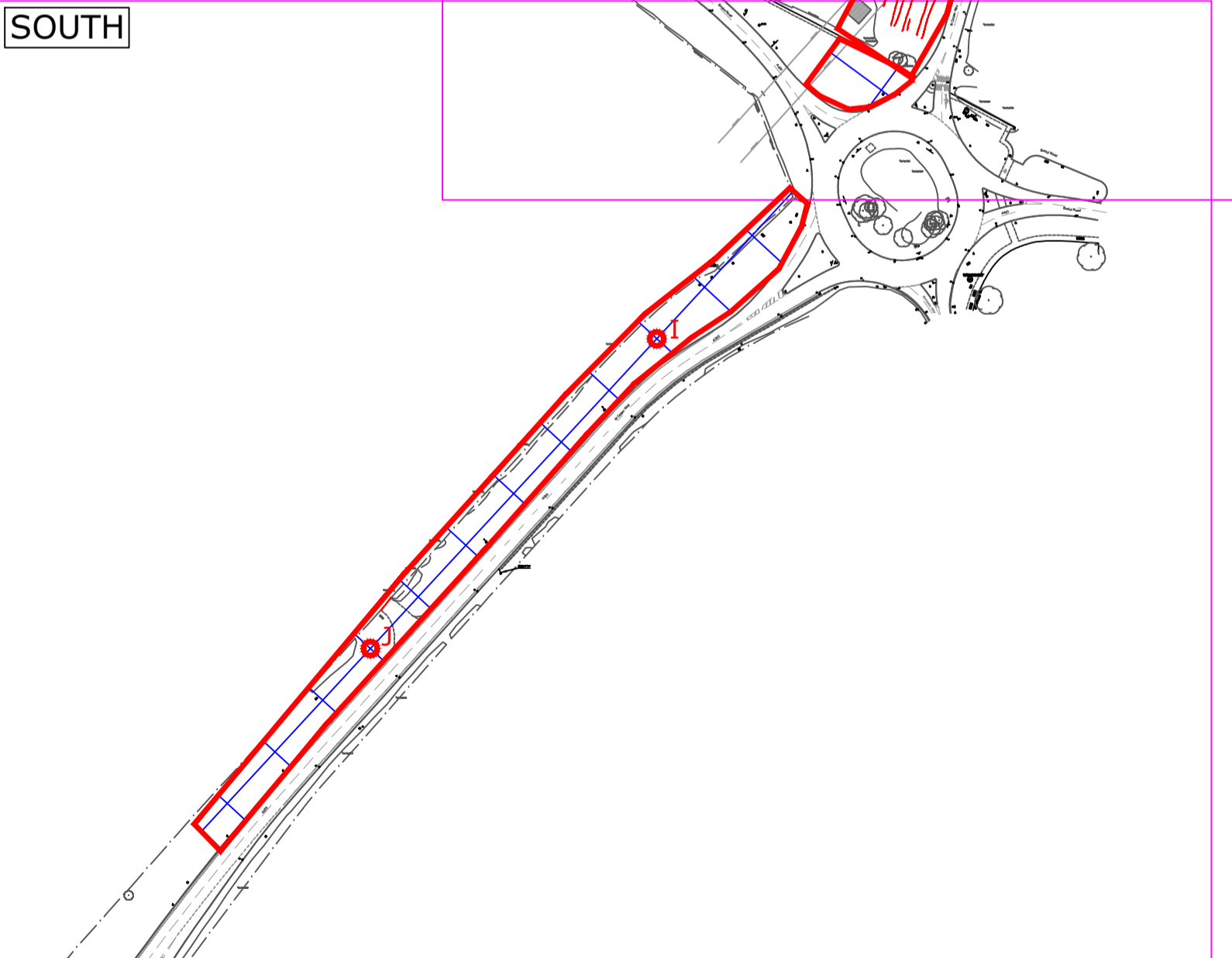

Amendments

Issue No.	Date	Description
-	-	-
-	-	-

© Stratascan Ltd - 2015

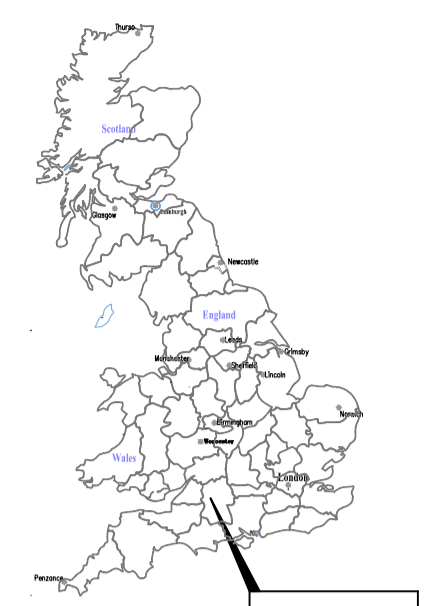

Site centred on NGR ST 902 747

	Hand collected grids
	Cart traverses
	Area unsurveyable due to plant

OS REFERENCING INFORMATION

A	390788.69, 175310.89
B	390769.09, 175288.18
C	390708.17, 175204.98
D	390568.42, 175048.24
E	390287.50, 174744.21
F	390267.25, 174722.10
G	390224.87, 174720.19
H	390204.62, 174698.06
I	390044.75, 174348.09
J	389922.53, 174215.95

Job No.	8583	Survey Date	JUN/JUL 15
---------	------	-------------	------------

Client
ATKINS HERITAGE

Project Title
**GEOPHYSICAL SURVEY - A350
 CHIPPENHAM, WILTSHIRE**

Subject
**SITE LOCATION, SURVEY
 AREA & REFERENCING**

STRATASCAN™
 GEOPHYSICS FOR ARCHAEOLOGY
 AND ENGINEERING
 VINEYARD HOUSE T: 01684 592266
 UPTON UPON SEVERN E: info@stratascan.co.uk
 WR8 0SA www.stratascan.co.uk

GPR ASSOCIATION
SUMO GROUP MEMBER
 ISO 9001 certified
 ISO 14001 certified

Scale 0m 50 100 150m
1:2500

Plot	A1	Checked by	DGE	Issue No.	01
Date	JUL 15	Drawn by	RD	Figure No.	01

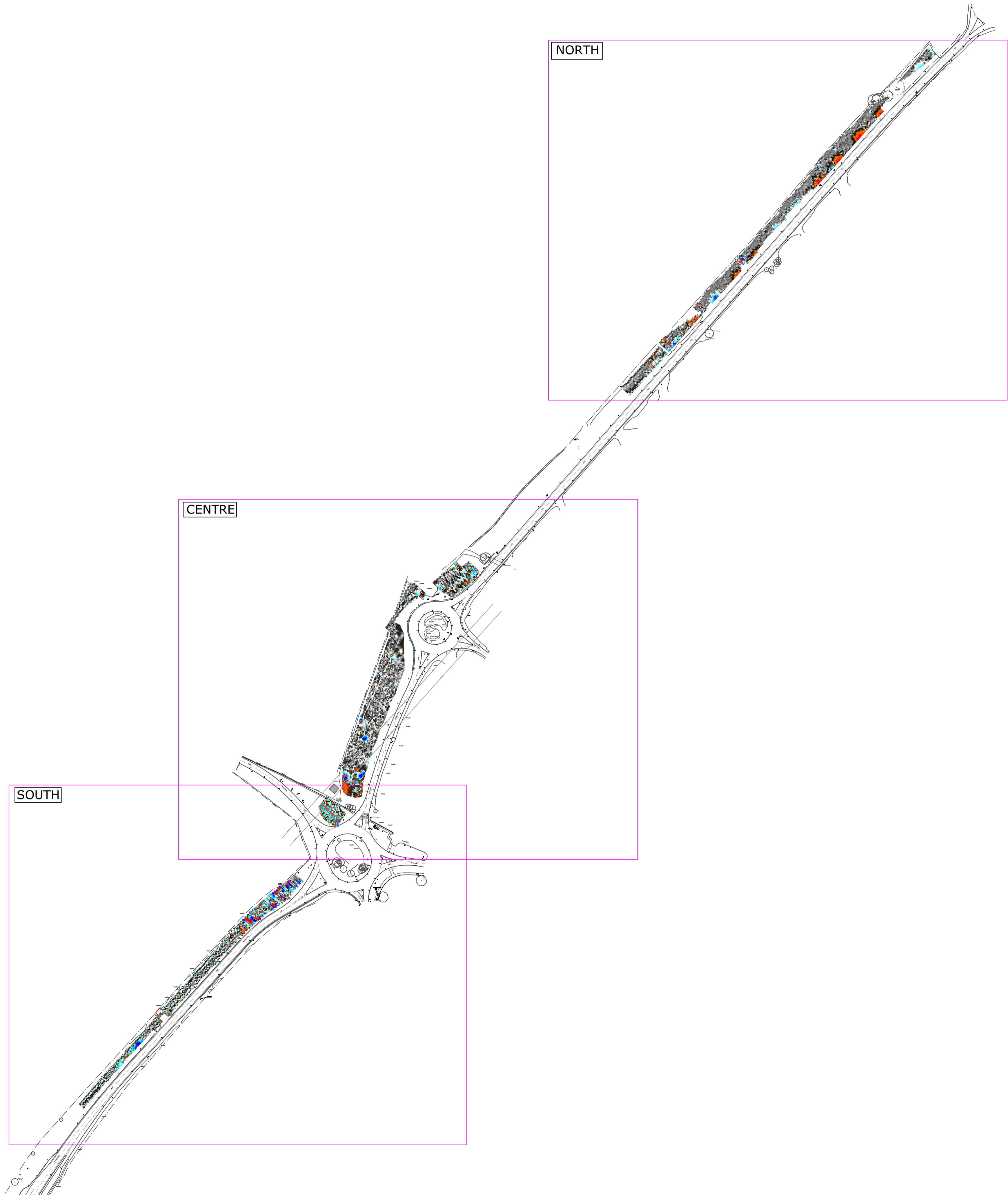

Amendments

Issue No.	Date	Description
-	-	-
-	-	-

© Stratascan Ltd - 2015

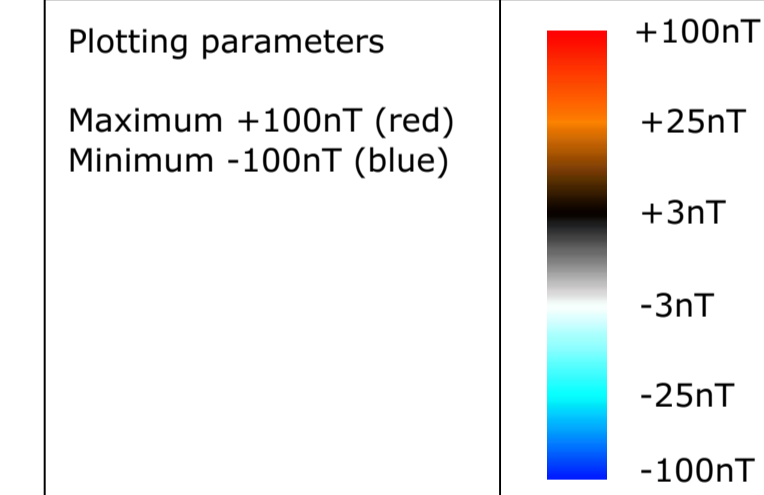

Job No.	8583	Survey Date	JUN/JUL 15
---------	------	-------------	------------

Client
ATKINS HERITAGE

Project Title
**GEOPHYSICAL SURVEY - A350
CHIPPENHAM, WILTSHIRE**

Subject
**COLOUR PLOT OF
GRADIOMETER DATA SHOWING
EXTREME VALUES - OVERVIEW**

STRATASCAN™
GEOPHYSICS FOR ARCHAEOLOGY
AND ENGINEERING

VINEYARD HOUSE T: 01684 592266
UPTON UPON SEVERN E: info@stratascan.co.uk
WR8 0SA www.stratascan.co.uk



Scale 0m 50 100 150m
1:2500

Plot	A1	Checked by	DGE	Issue No.	01
Date	JUL 15	Drawn by	RD	Figure No.	02

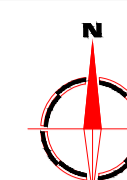

Amendments

Issue No.	Date	Description
-	-	-
-	-	-

© Stratascan Ltd - 2015

Plotting parameters

Maximum +100nT (red)
Minimum -100nT (blue)

Job No.	8583	Survey Date	JUN/JUL 15
---------	------	-------------	------------

Client
ATKINS HERITAGE

Project Title
**GEOPHYSICAL SURVEY - A350
CHIPPENHAM, WILTSHIRE**

Subject
**COLOUR PLOT OF
GRADIOMETER DATA SHOWING
EXTREME VALUES - NORTH**

STRATASCAN™
GEOPHYSICS FOR ARCHAEOLOGY
AND ENGINEERING

VINEYARD HOUSE T: 01684 592266
UPTON UPON SEVERN E: info@stratascan.co.uk
WR8 0SA www.stratascan.co.uk

GPR ASSOCIATION

SUMO GROUP MEMBER

ISO 9001 certified
ISO 14001 certified

Scale 0m 10 20 30 40 50m
1:750

Plot	A1	Checked by	DGE	Issue No.	01
Date	JUL 15	Drawn by	RD	Figure No.	03

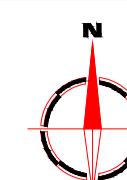
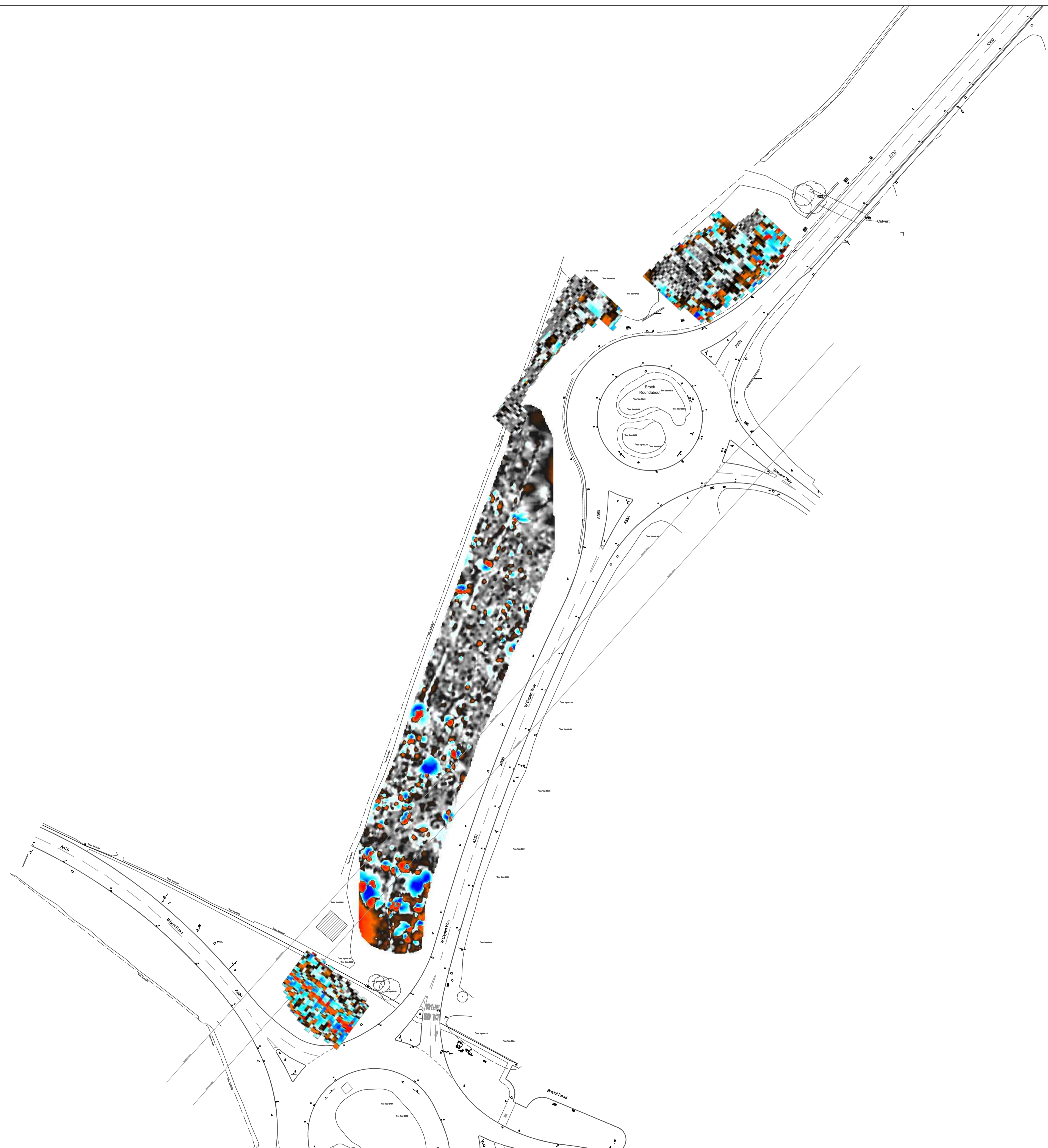

Amendments

Issue No.	Date	Description
-	-	-
-	-	-

© Stratascan Ltd - 2015

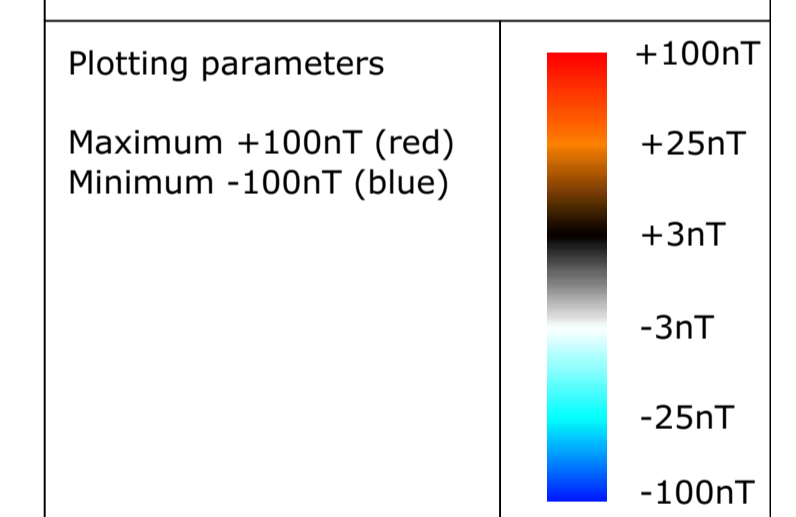

Job No.	8583	Survey Date	JUN/JUL 15
---------	------	-------------	------------

Client
ATKINS HERITAGE

Project Title
**GEOPHYSICAL SURVEY - A350
CHIPPENHAM, WILTSHIRE**

Subject
**COLOUR PLOT OF
GRADIOMETER DATA SHOWING
EXTREME VALUES - CENTRE**

STRATASCAN™
GEOPHYSICS FOR ARCHAEOLOGY
AND ENGINEERING
VINEYARD HOUSE T: 01684 592266
UPTON UPON SEVERN E: info@stratascan.co.uk
WR8 0SA www.stratascan.co.uk



Scale 0m 10 20 30 40 50m
1:750

Plot	A1	Checked by	DGE	Issue No.	01
Date	JUL 15	Drawn by	RD	Figure No.	04

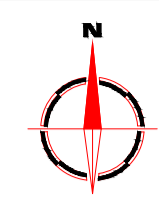
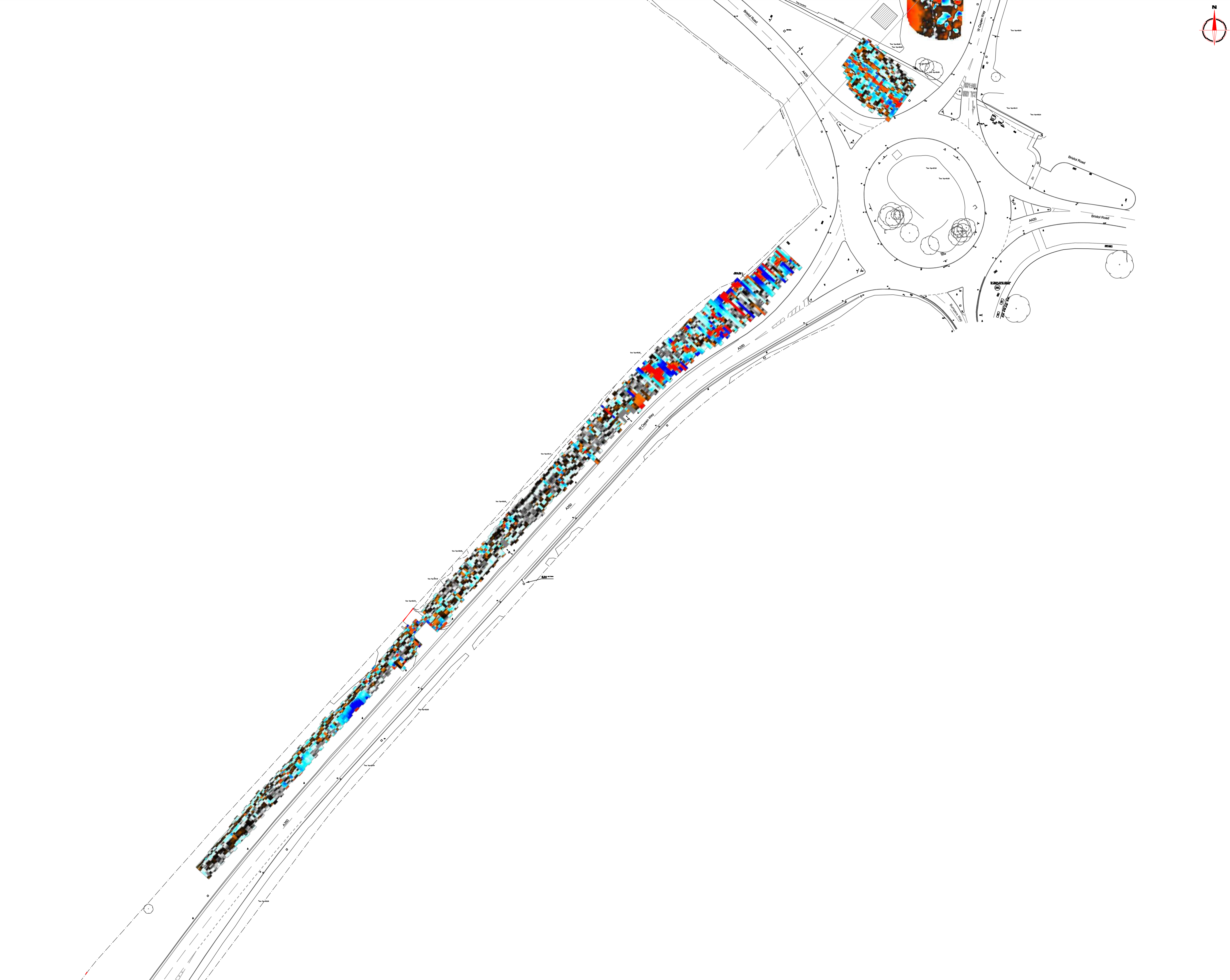

Amendments

Issue No.	Date	Description
-	-	-
-	-	-

© Stratascan Ltd - 2015

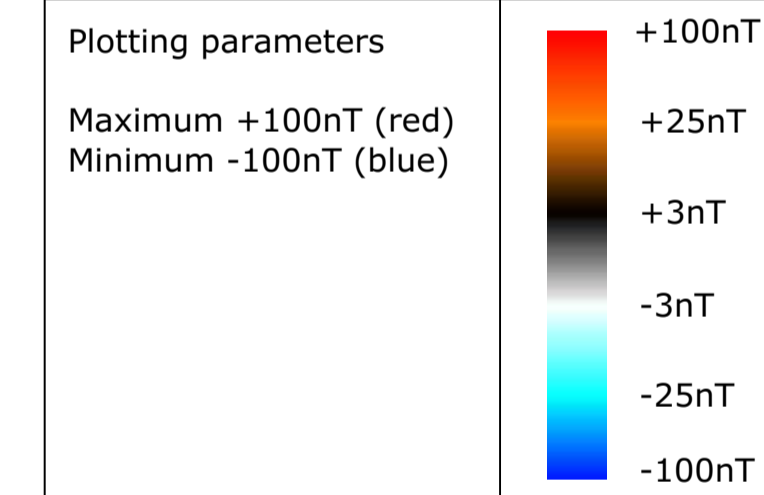

Job No.	8583	Survey Date	JUN/JUL 15
---------	------	-------------	------------

Client
ATKINS HERITAGE

Project Title
**GEOPHYSICAL SURVEY - A350
CHIPPENHAM, WILTSHIRE**

Subject
**COLOUR PLOT OF
GRADIOMETER DATA SHOWING
EXTREME VALUES - SOUTH**

STRATASCAN™
GEOPHYSICS FOR ARCHAEOLOGY
AND ENGINEERING

VINEYARD HOUSE T: 01684 592266
UPTON UPON SEVERN E: info@stratascan.co.uk
WR8 0SA www.stratascan.co.uk

GPR ASSOCIATION

SUMO GROUP MEMBER

ISO 9001 certified
ISO 14001 certified

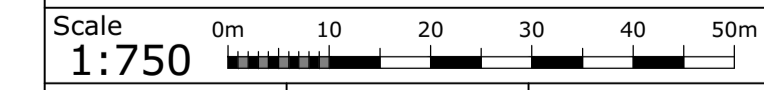

Plot	A1	Checked by	DGE	Issue No.	01
Date	JUL 15	Drawn by	RD	Figure No.	05

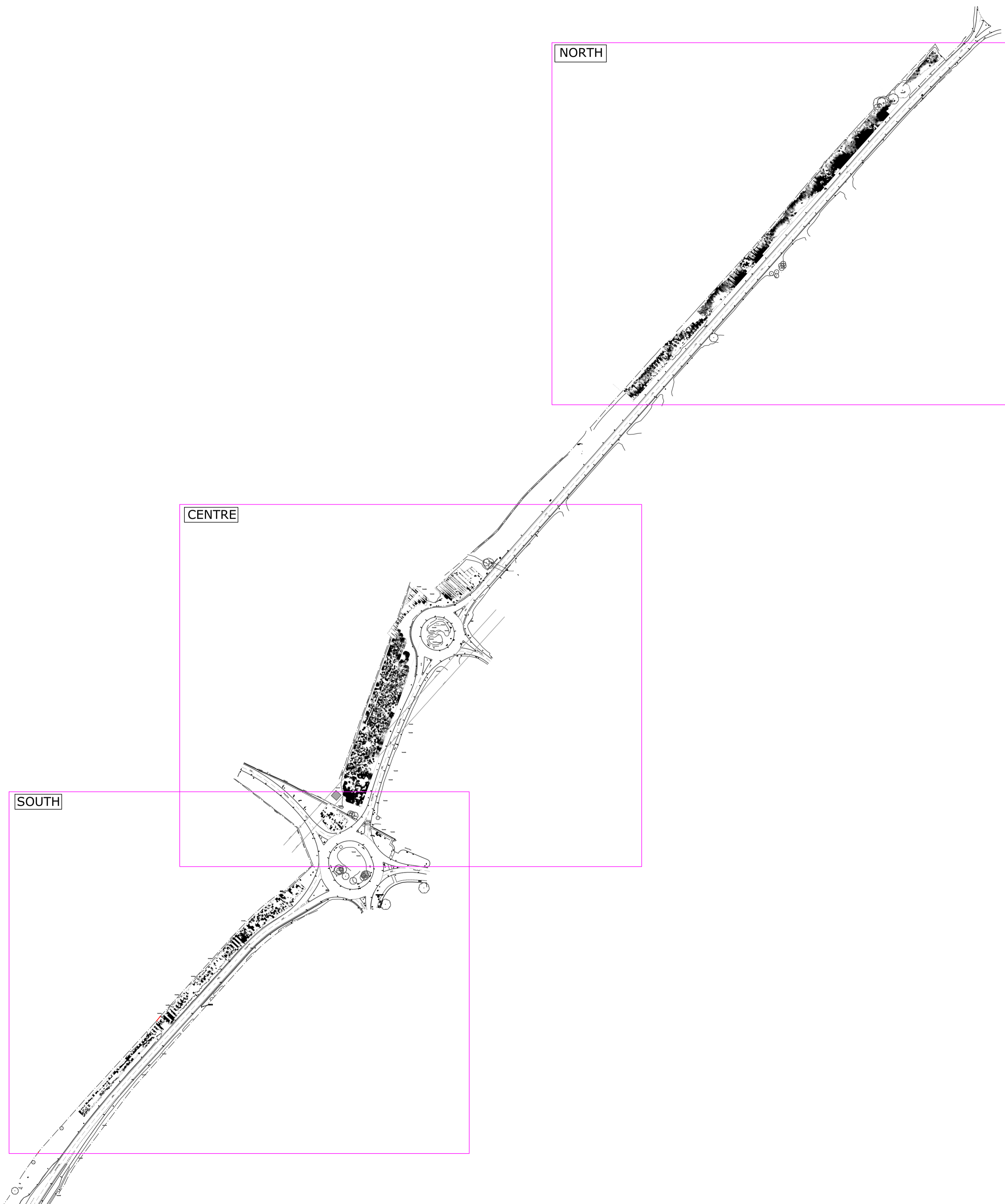

Amendments

Issue No.	Date	Description
-	-	-
-	-	-

© Stratascan Ltd - 2015

Plotting parameters

Maximum +2nT (black)
Minimum -2nT (white)

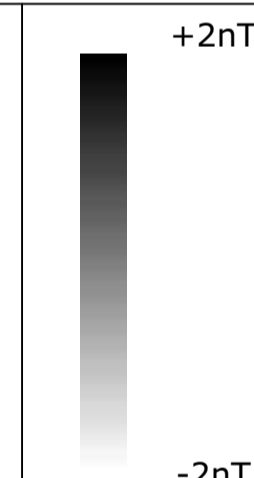
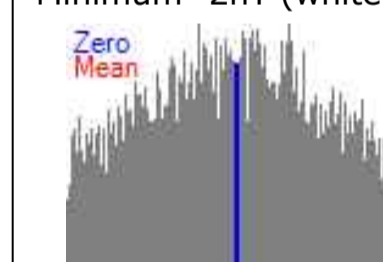

Job No. 8583 Survey Date JUN/JUL 15

Client
ATKINS HERITAGE

Project Title
**GEOPHYSICAL SURVEY - A350
CHIPPENHAM, WILTSHIRE**

Subject
**PLOT OF MINIMALLY
PROCESSED GRADIOMETER
DATA - OVERVIEW**



**GEOPHYSICS FOR ARCHAEOLOGY
AND ENGINEERING**

VINEYARD HOUSE T: 01684 592266
UPTON UPON SEVERN E: info@stratascan.co.uk
WR8 0SA www.stratascan.co.uk



Scale 0m 50 100 150m
1:2500

Plot A1	Checked by DGE	Issue No. 01
Date JUL 15	Drawn by RD	Figure No. 06

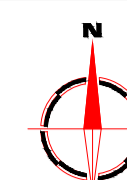
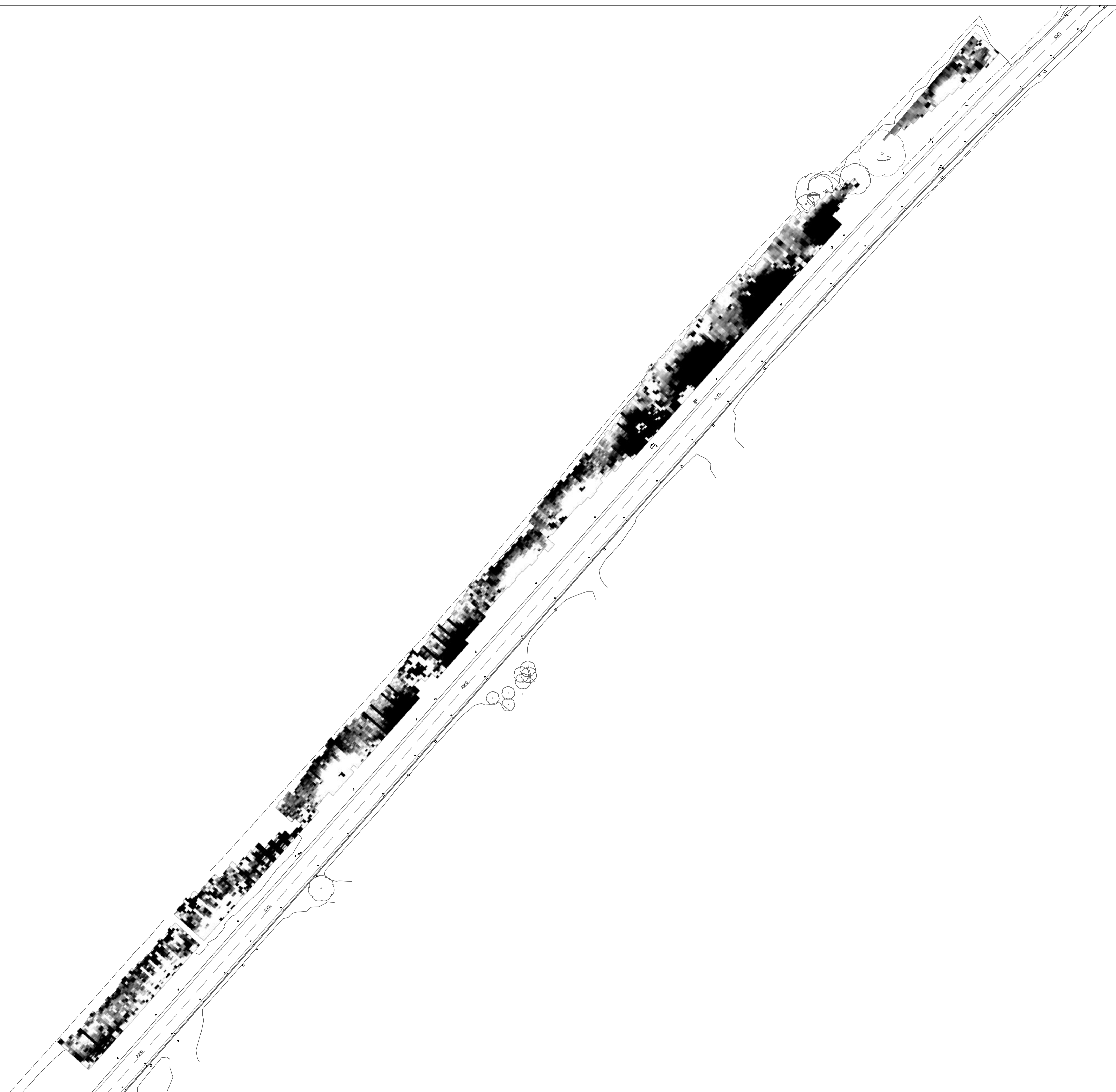

Amendments

Issue No.	Date	Description
-	-	-
-	-	-

© Stratascan Ltd - 2015

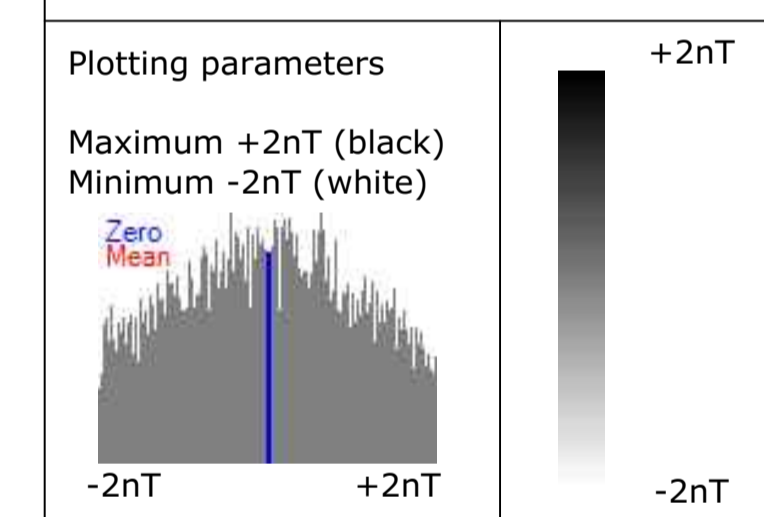

Job No.	8583	Survey Date	JUN/JUL 15
---------	------	-------------	------------

Client
ATKINS HERITAGE

Project Title
**GEOPHYSICAL SURVEY - A350
CHIPPENHAM, WILTSHIRE**

Subject
**PLOT OF MINIMALLY
PROCESSED GRADIOMETER
DATA - NORTH**

STRATASCAN™
GEOPHYSICS FOR ARCHAEOLOGY
AND ENGINEERING
VINEYARD HOUSE UPTON UPON SEVERN WR8 0SA T: 01684 592266 E: info@stratascan.co.uk www.stratascan.co.uk



Scale 0m 10 20 30 40 50m
1:750

Plot	A1	Checked by	DGE	Issue No.	01
Date	JUL 15	Drawn by	RD	Figure No.	07

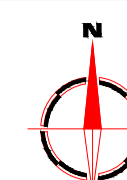
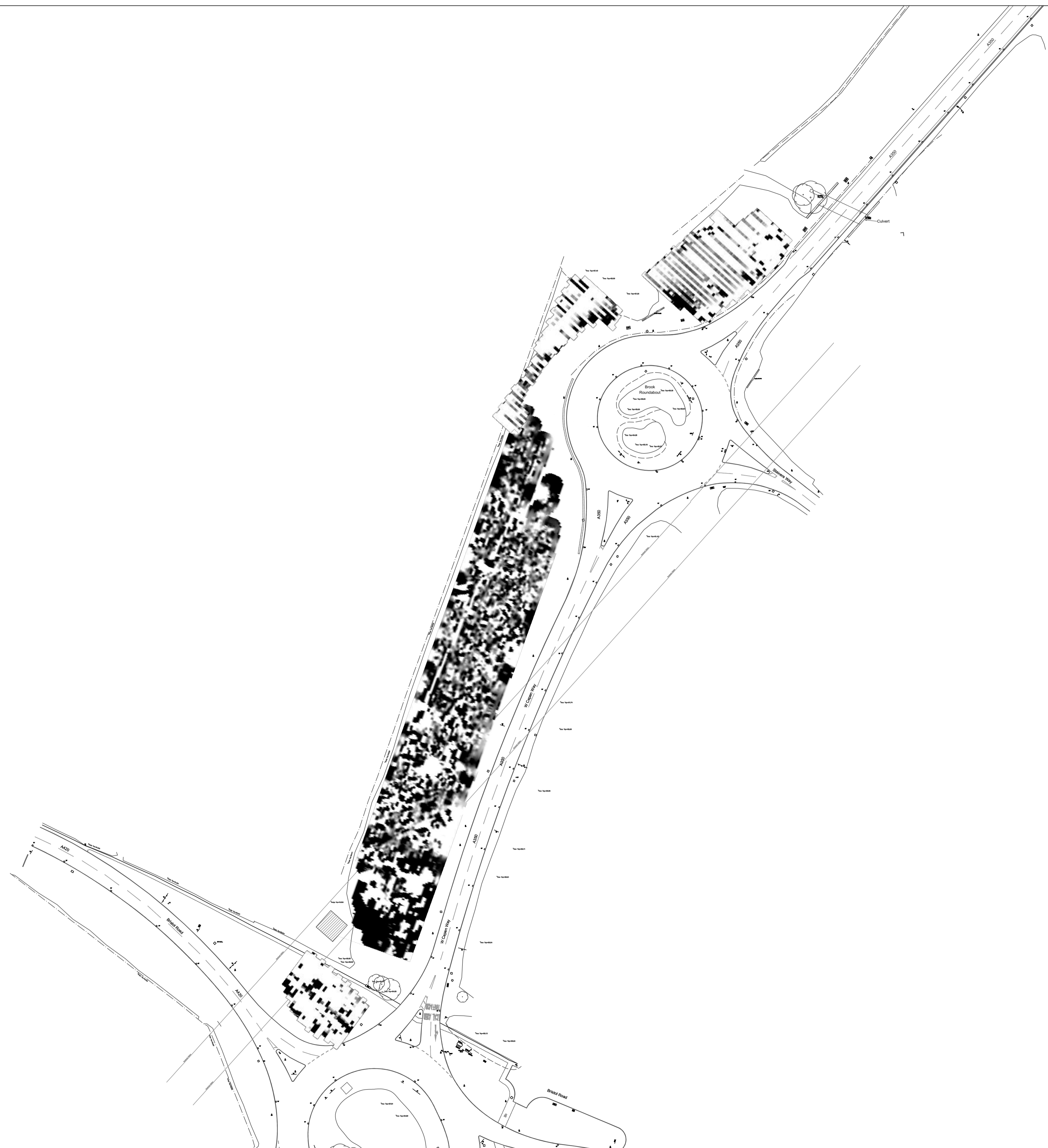

Amendments		
Issue No.	Date	Description
-	-	-
-	-	-

© Stratascan Ltd - 2015

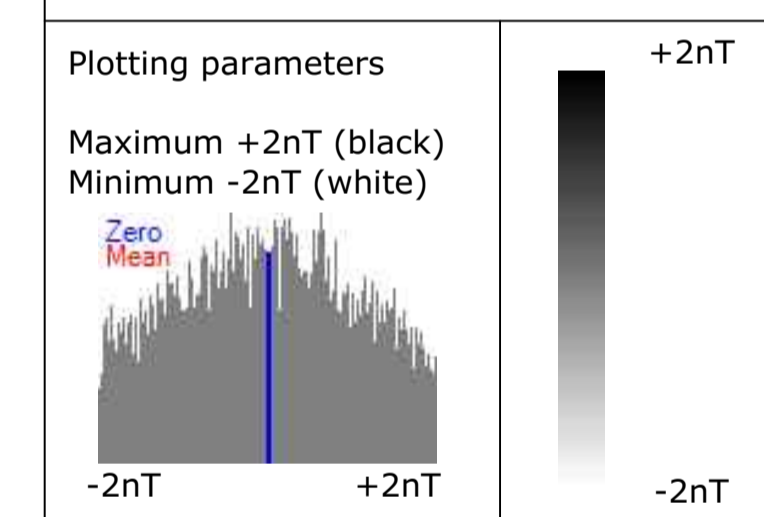

Job No.	8583	Survey Date	JUN/JUL 15
---------	------	-------------	------------

Client
ATKINS HERITAGE

Project Title
**GEOPHYSICAL SURVEY - A350
CHIPPENHAM, WILTSHIRE**

Subject
**PLOT OF MINIMALLY
PROCESSED GRADIOMETER
DATA - CENTRE**

STRATASCAN™
GEOPHYSICS FOR ARCHAEOLOGY
AND ENGINEERING
VINEYARD HOUSE T: 01684 592266
UPTON UPON SEVERN E: info@stratascan.co.uk
WR8 0SA www.stratascan.co.uk



Scale 0m 10 20 30 40 50m
1:750

Plot	A1	Checked by	DGE	Issue No.	01
Date	JUL 15	Drawn by	RD	Figure No.	08



Amendments

Issue No.	Date	Description
-	-	-
-	-	-

© Stratascan Ltd - 2015

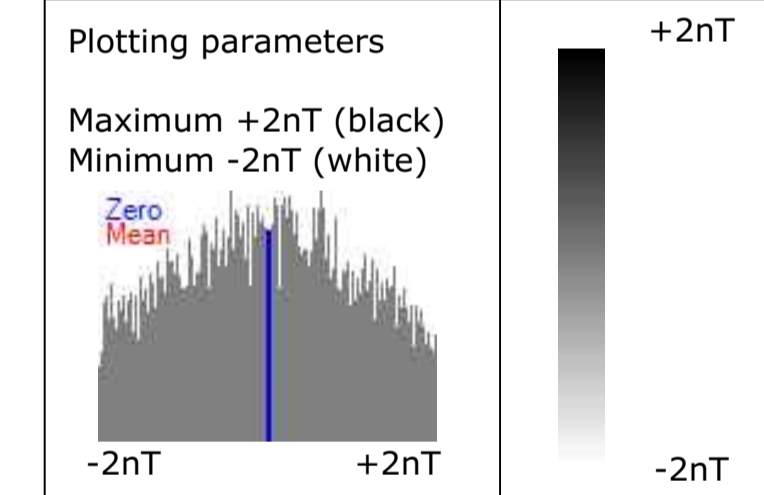
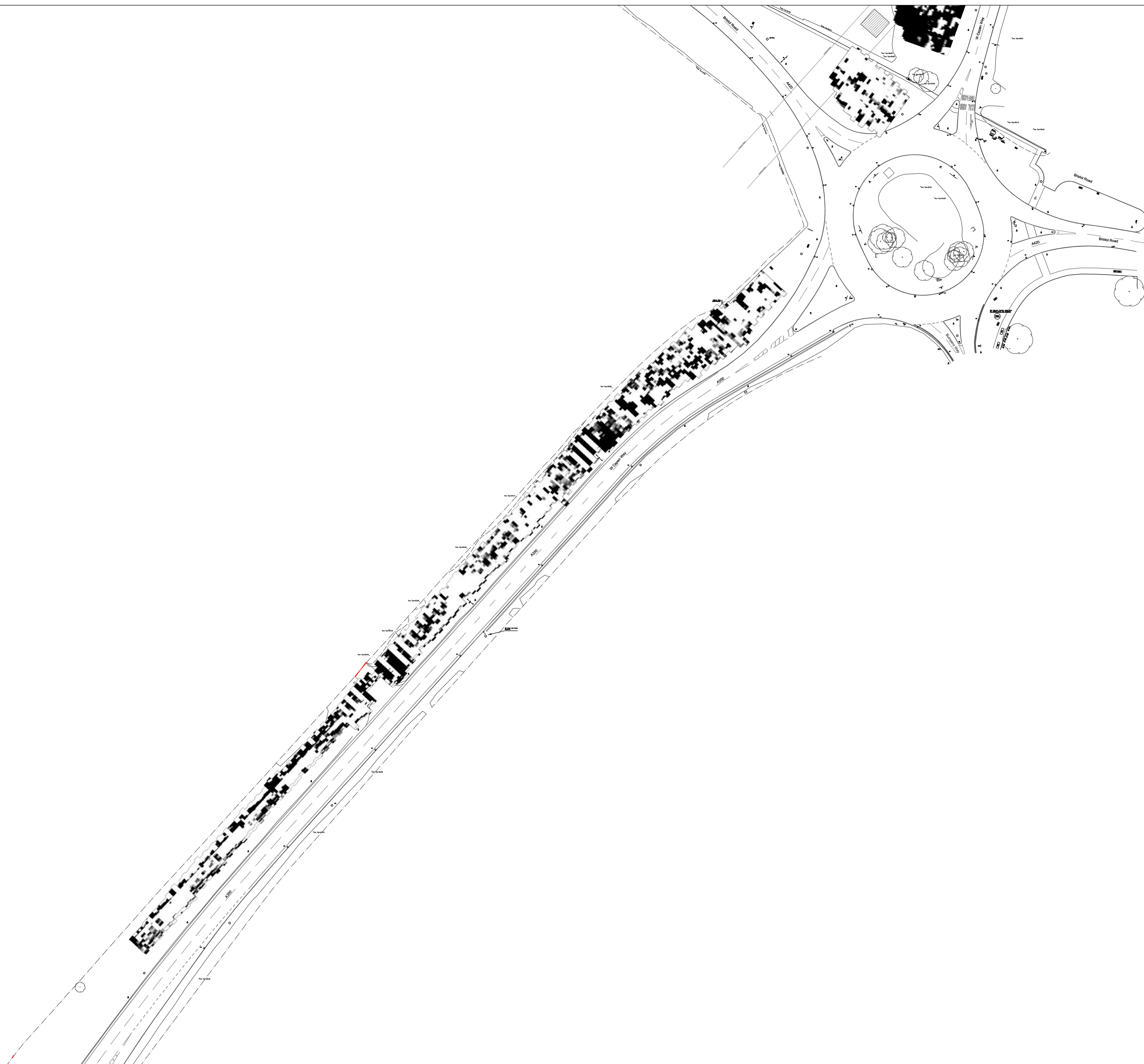

Job No.	8583	Survey Date	JUN/JUL 15
---------	------	-------------	------------

Client

ATKINS HERITAGE

Project Title

**GEOPHYSICAL SURVEY - A350
CHIPPENHAM, WILTSHIRE**

Subject

**PLOT OF MINIMALLY
PROCESSED GRADIOMETER
DATA - SOUTH**

STRATASCAN™
GEOPHYSICS FOR ARCHAEOLOGY
AND ENGINEERING

VINEYARD HOUSE T: 01684 592266
UPTON UPON SEVERN E: info@stratascan.co.uk
WR8 0SA www.stratascan.co.uk



Scale 0m 10 20 30 40 50m
1:750

Plot	A1	Checked by	DGE	Issue No.	01
Date	JUL 15	Drawn by	RD	Figure No.	09



Amendments

Issue No.	Date	Description
-	-	-
-	-	-

© Stratascan Ltd - 2015

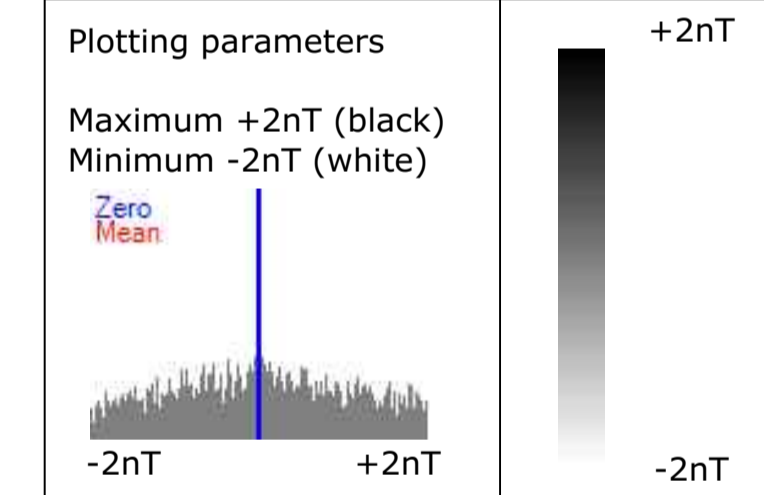
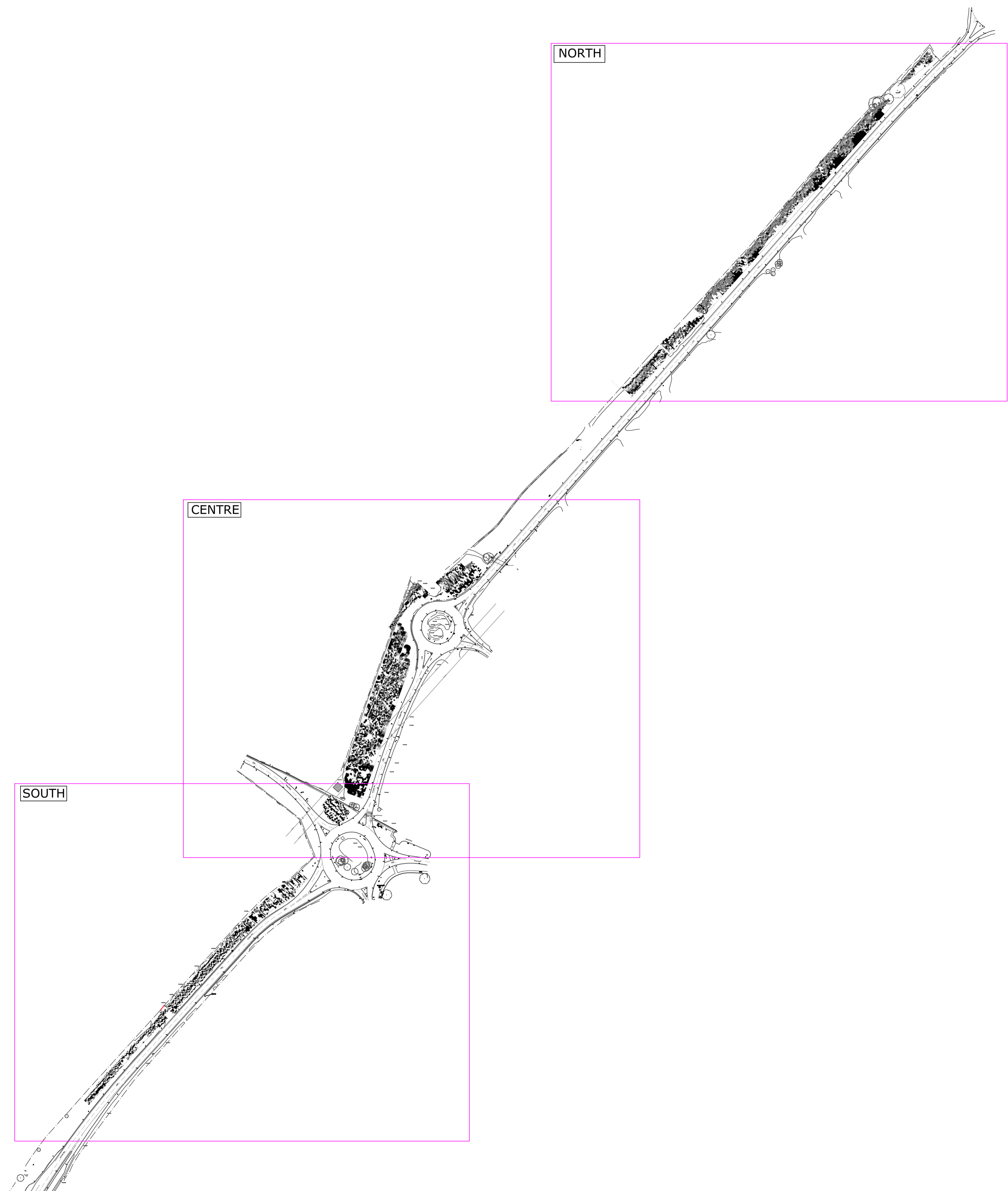

Job No.	8583	Survey Date	JUN/JUL 15
---------	------	-------------	------------

Client
ATKINS HERITAGE

Project Title
**GEOPHYSICAL SURVEY - A350
CHIPPENHAM, WILTSHIRE**

Subject
**PLOT OF PROCESSED
GRADIOMETER DATA -
OVERVIEW**

STRATASCAN™
GEOPHYSICS FOR ARCHAEOLOGY
AND ENGINEERING
VINEYARD HOUSE UPTON UPON SEVERN WR8 0SA T: 01684 592266 E: info@stratascan.co.uk www.stratascan.co.uk



Scale 0m 50 100 150m
1:2500

Plot	Checked by	Issue No.
A1	DGE	01
Date	Drawn by	Figure No.
JUL 15	RD	10

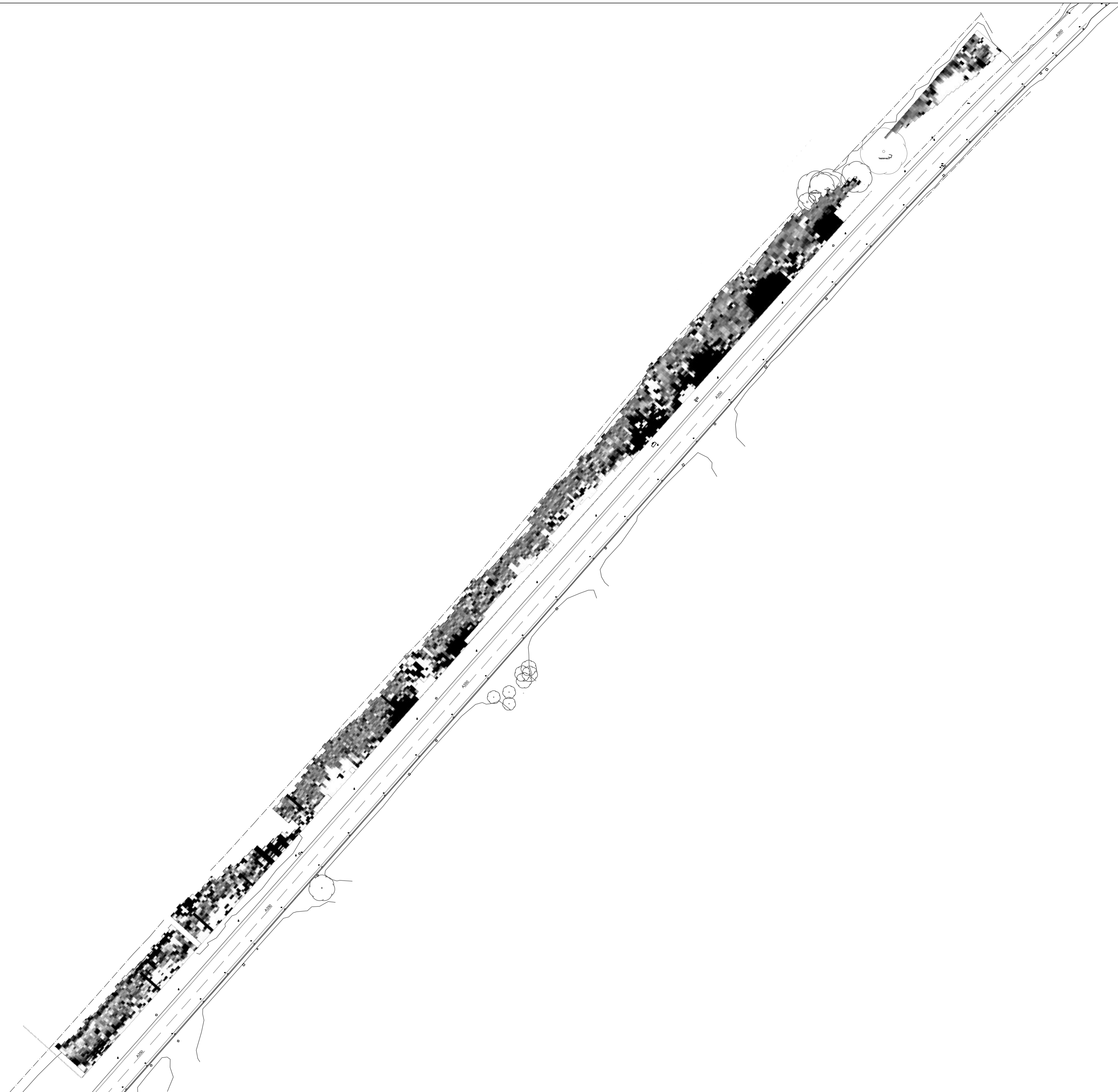

Amendments

Issue No.	Date	Description
-	-	-
-	-	-

© Stratascan Ltd - 2015

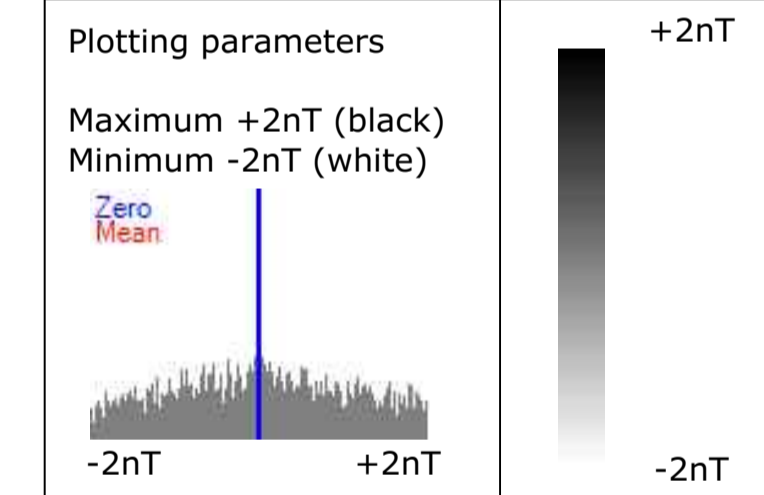

Job No.	8583	Survey Date	JUN/JUL 15
---------	------	-------------	------------

Client
ATKINS HERITAGE

Project Title
**GEOPHYSICAL SURVEY - A350
CHIPPENHAM, WILTSHIRE**

Subject
**PLOT OF PROCESSED
GRADIOMETER DATA - NORTH**

STRATASCAN™
GEOPHYSICS FOR ARCHAEOLOGY
AND ENGINEERING
VINEYARD HOUSE T: 01684 592266
UPTON UPON SEVERN E: info@stratascan.co.uk
WR8 0SA www.stratascan.co.uk



Scale 0m 10 20 30 40 50m
1:750

Plot	A1	Checked by	DGE	Issue No.	01
Date	JUL 15	Drawn by	RD	Figure No.	11

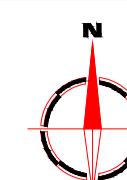
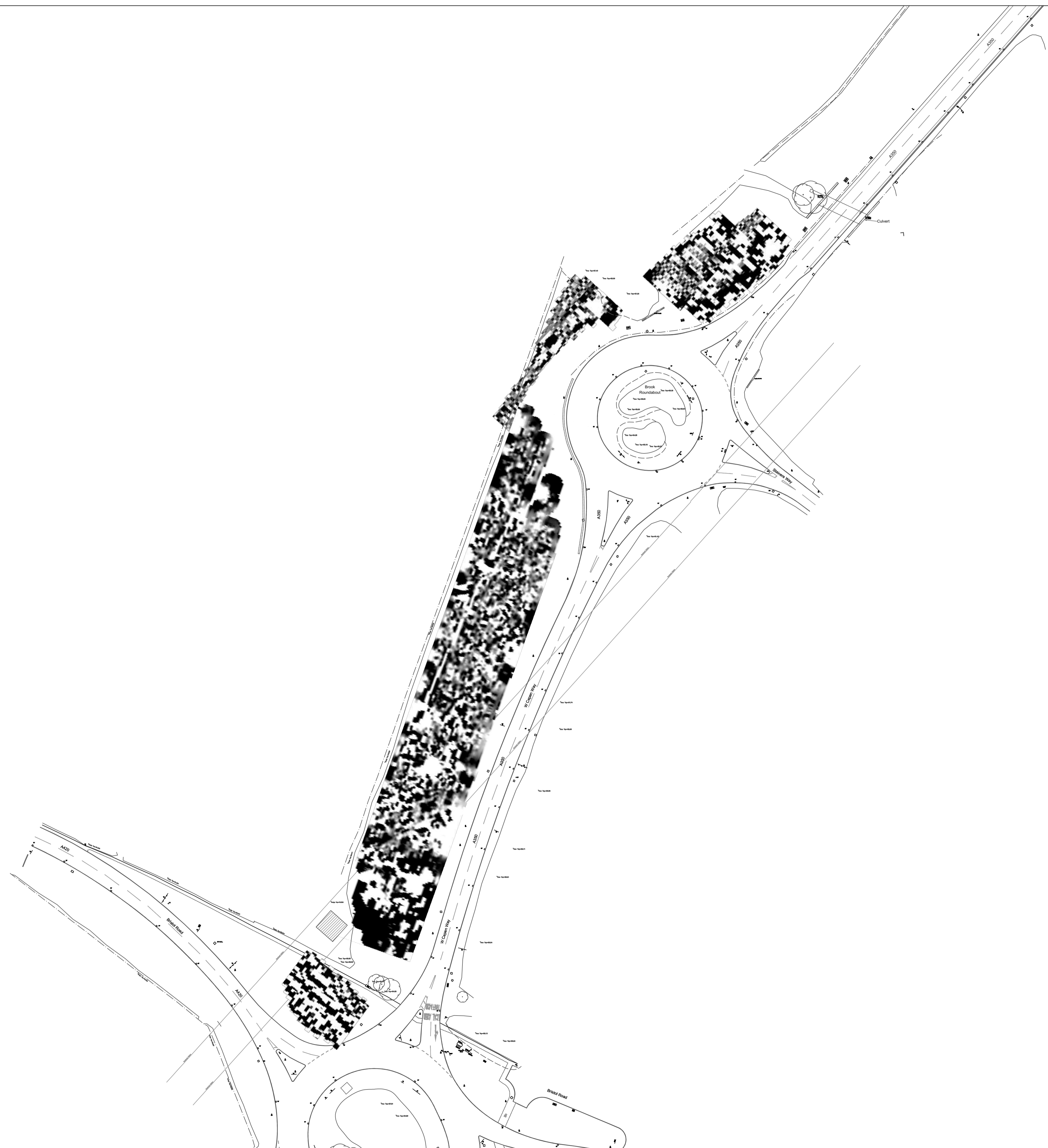

Amendments		
Issue No.	Date	Description
-	-	-
-	-	-

© Stratascan Ltd - 2015

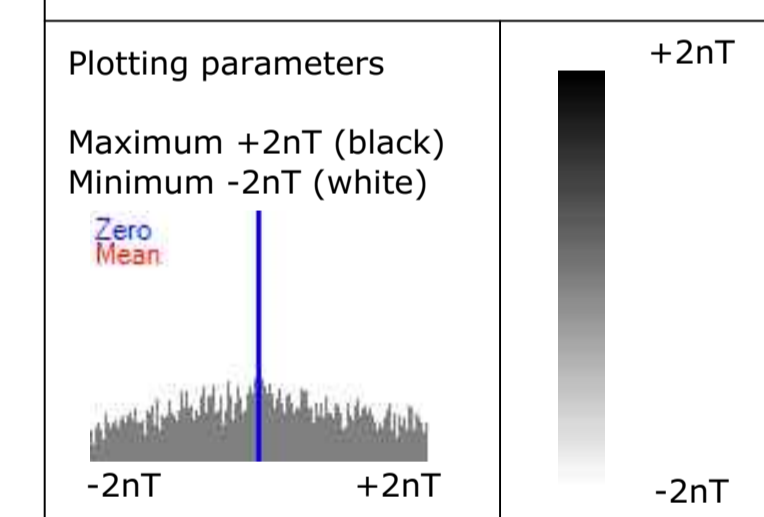

Job No.	8583	Survey Date	JUN/JUL 15
---------	------	-------------	------------

Client
ATKINS HERITAGE

Project Title
**GEOPHYSICAL SURVEY - A350
CHIPPENHAM, WILTSHIRE**

Subject
**PLOT OF PROCESSED
GRADIOMETER DATA - CENTRE**

STRATASCAN™
GEOPHYSICS FOR ARCHAEOLOGY
AND ENGINEERING
VINEYARD HOUSE T: 01684 592266
UPTON UPON SEVERN E: info@stratascan.co.uk
WR8 0SA www.stratascan.co.uk



Scale 0m 10 20 30 40 50m
1:750

Plot	A1	Checked by	DGE	Issue No.	01
Date	JUL 15	Drawn by	RD	Figure No.	12

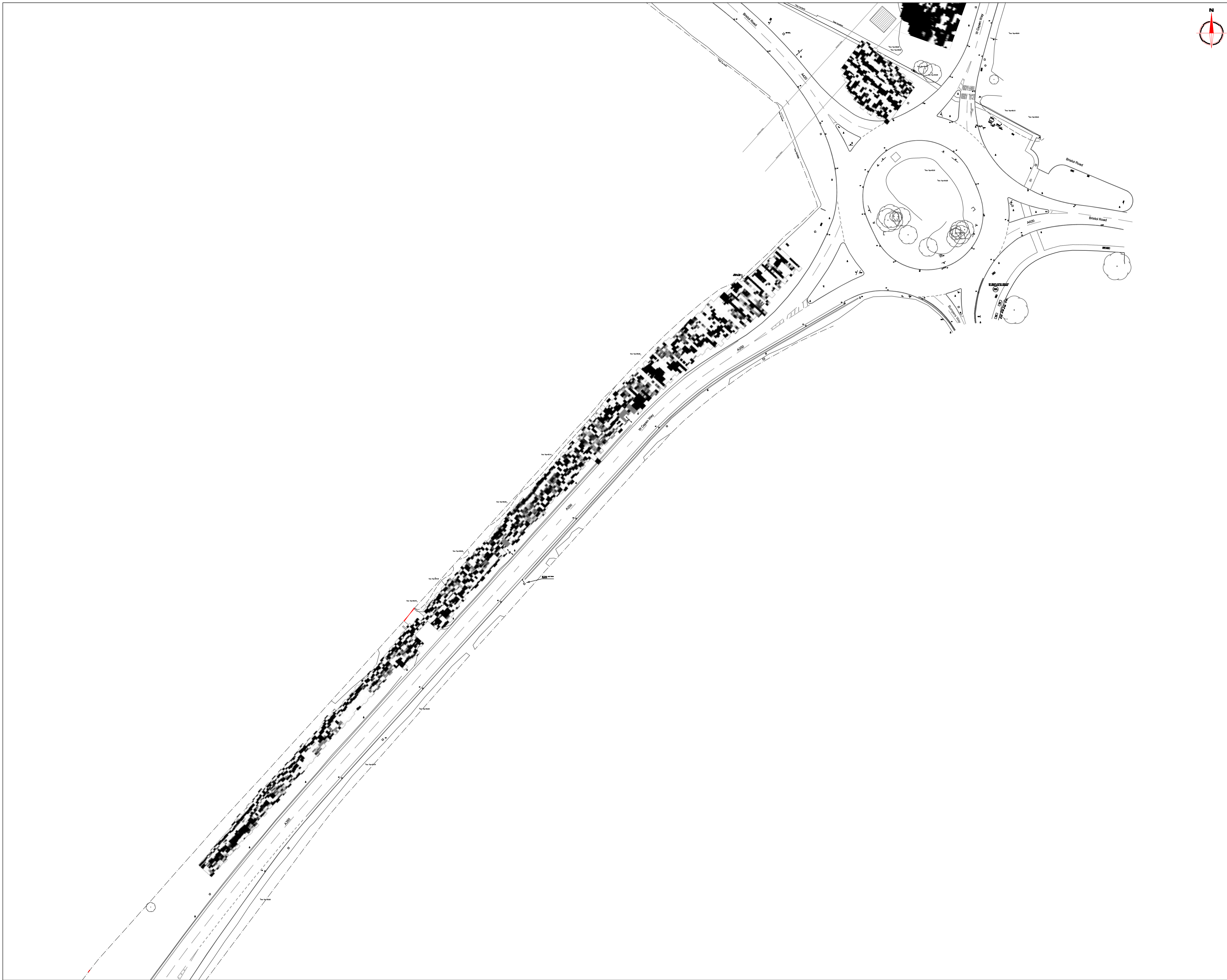

Amendments

Issue No.	Date	Description
-	-	-
-	-	-

© Stratascan Ltd - 2015

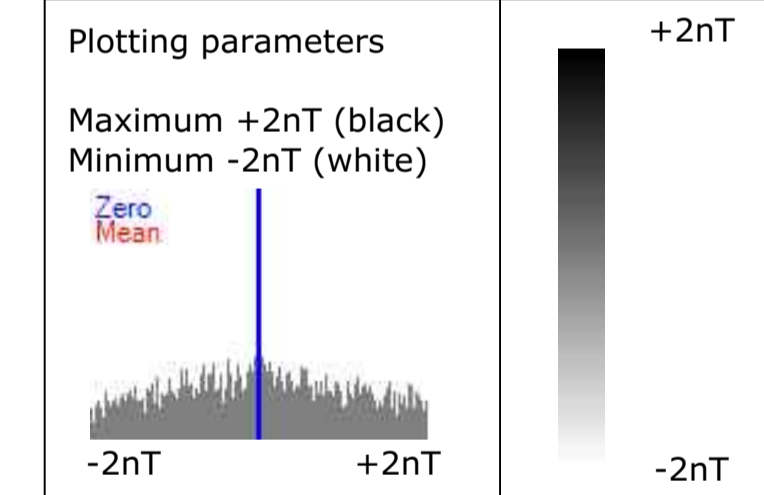

Job No.	8583	Survey Date	JUN/JUL 15
---------	------	-------------	------------

Client
ATKINS HERITAGE

Project Title
**GEOPHYSICAL SURVEY - A350
CHIPPENHAM, WILTSHIRE**

Subject
**PLOT OF PROCESSED
GRADIOMETER DATA - SOUTH**

STRATASCAN™
GEOPHYSICS FOR ARCHAEOLOGY
AND ENGINEERING
VINEYARD HOUSE UPTON UPON SEVERN WR8 0SA
T: 01684 592266
E: info@stratascan.co.uk
www.stratascan.co.uk



Scale 1:750
0m 10 20 30 40 50m

Plot	A1	Checked by	DGE	Issue No.	01
Date	JUL 15	Drawn by	RD	Figure No.	13

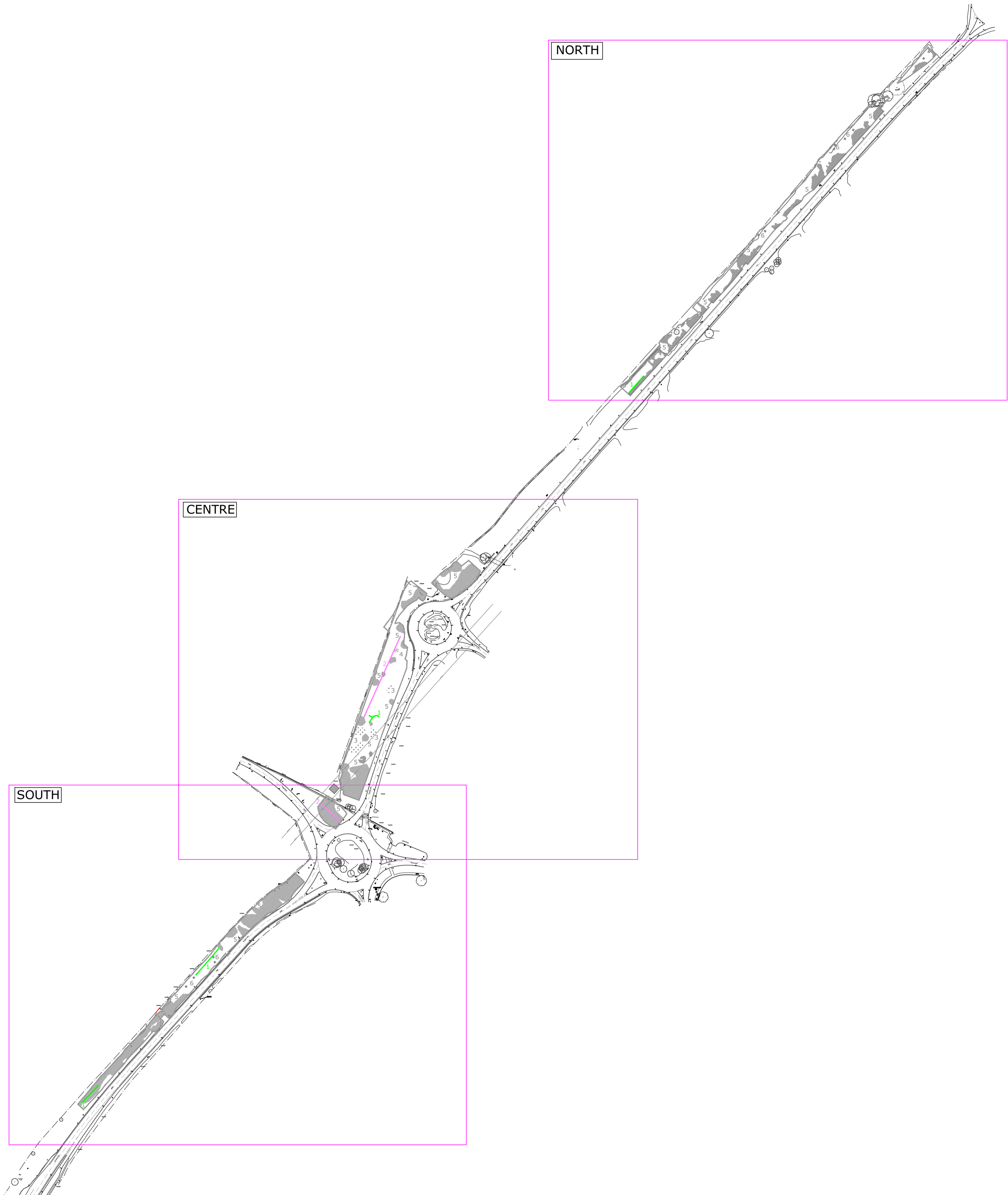

Amendments

Issue No.	Date	Description
-	-	-
-	-	-

© Stratascan Ltd - 2015

PROBABLE ARCHAEOLOGY

- Positive anomaly / weak positive anomaly - probable cut feature of archaeological origin
- Negative anomaly / weak negative anomaly - probable bank or earthwork of archaeological origin

POSSIBLE ARCHAEOLOGY

- Positive anomaly / weak positive anomaly - possible cut feature of archaeological origin
- Negative anomaly / weak negative anomaly - possible bank or earthwork of archaeological origin

MEDIEVAL/POST-MEDIEVAL AGRICULTURE

- Widely spaced curving parallel linear anomalies - probably related to ridge-and-furrow
- Closely spaced parallel linear anomalies - probably related to agricultural activity such as ploughing
- Linear anomaly - probably related to a former field boundary not present on available mapping
- Linear anomaly - related to a former field boundary present on available mapping

OTHER ANOMALIES

- Linear anomaly - probably related to pipe, cable or other modern service
- Linear anomaly - unknown origin, likely to be modern
- Magnetic disturbance associated with nearby metal object such as service or field boundary
- Strong magnetic debris - possible disturbed or made ground
- Scattered magnetic debris
- Area of amorphous magnetic variation - probable natural (e.g. geological or pedological) origin
- Magnetic spike - probable ferrous object

Job No.	8583	Survey Date	JUN/JUL 15
---------	------	-------------	------------

Client
ATKINS HERITAGE

Project Title
**GEOPHYSICAL SURVEY - A350
CHIPPENHAM, WILTSHIRE**

Subject
**ABSTRACTION AND
INTERPRETATION OF
GRADIOMETER ANOMALIES -
OVERVIEW**

STRATASCAN™
GEOPHYSICS FOR ARCHAEOLOGY
AND ENGINEERING
VINEYARD HOUSE UPTON UPON SEVERN WR8 0SA T: 01684 592266 E: info@stratascan.co.uk www.stratascan.co.uk

GPR ASSOCIATION
SUMO GROUP MEMBER
IMS GROUP MEMBER

Scale 0m 50 100 150m
1:2500

Plot	A1	Checked by	DGE	Issue No.	01
Date	JUL 15	Drawn by	JHS/RD	Figure No.	14

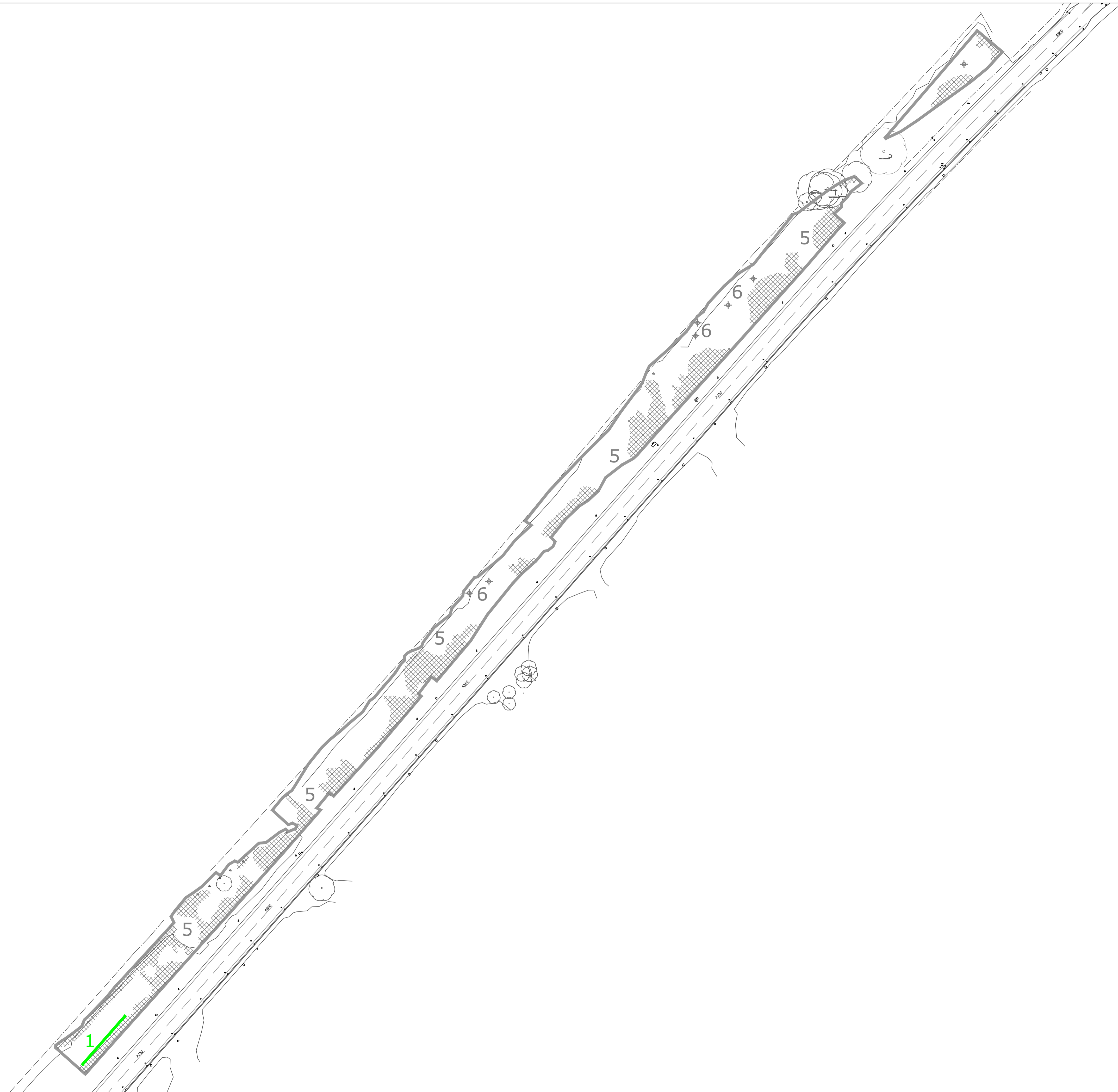

Amendments

Issue No.	Date	Description
-	-	-
-	-	-

© Stratascan Ltd - 2015

PROBABLE ARCHAEOLOGY

- Positive anomaly / weak positive anomaly - probable cut feature of archaeological origin
- Negative anomaly / weak negative anomaly - probable bank or earthwork of archaeological origin

POSSIBLE ARCHAEOLOGY

- Positive anomaly / weak positive anomaly - possible cut feature of archaeological origin
- Negative anomaly / weak negative anomaly - possible bank or earthwork of archaeological origin

MEDIEVAL/POST-MEDIEVAL AGRICULTURE

- Widely spaced curving parallel linear anomalies - probably related to ridge-and-furrow
- Closely spaced parallel linear anomalies - probably related to agricultural activity such as ploughing
- Linear anomaly - probably related to a former field boundary not present on available mapping
- Linear anomaly - related to a former field boundary present on available mapping

OTHER ANOMALIES

- Linear anomaly - probably related to pipe, cable or other modern service
- Linear anomaly - unknown origin, likely to be modern
- Magnetic disturbance associated with nearby metal object such as service or field boundary
- Strong magnetic debris - possible disturbed or made ground
- Scattered magnetic debris
- Area of amorphous magnetic variation - probable natural (e.g. geological or pedological) origin
- Magnetic spike - probable ferrous object

Job No.	8583	Survey Date	JUN/JUL 15
---------	------	-------------	------------

Client
ATKINS HERITAGE

Project Title
**GEOPHYSICAL SURVEY - A350
CHIPPENHAM, WILTSHIRE**

Subject
**ABSTRACTION AND
INTERPRETATION OF
GRADIOMETER ANOMALIES -
NORTH**

STRATASCAN™
GEOPHYSICS FOR ARCHAEOLOGY
AND ENGINEERING
VINEYARD HOUSE UPTON UPON SEVERN WR8 0SA T: 01684 592266 E: info@stratascan.co.uk www.stratascan.co.uk

GPR ASSOCIATION
SUMO GROUP MEMBER
ISO 9001 certified
ISO 14001 certified
ISO 18001 certified

Scale 0m 10 20 30 40 50m
1:750

Plot	A1	Checked by	DGE	Issue No.	01
Date	JUL 15	Drawn by	JHS/RD	Figure No.	15

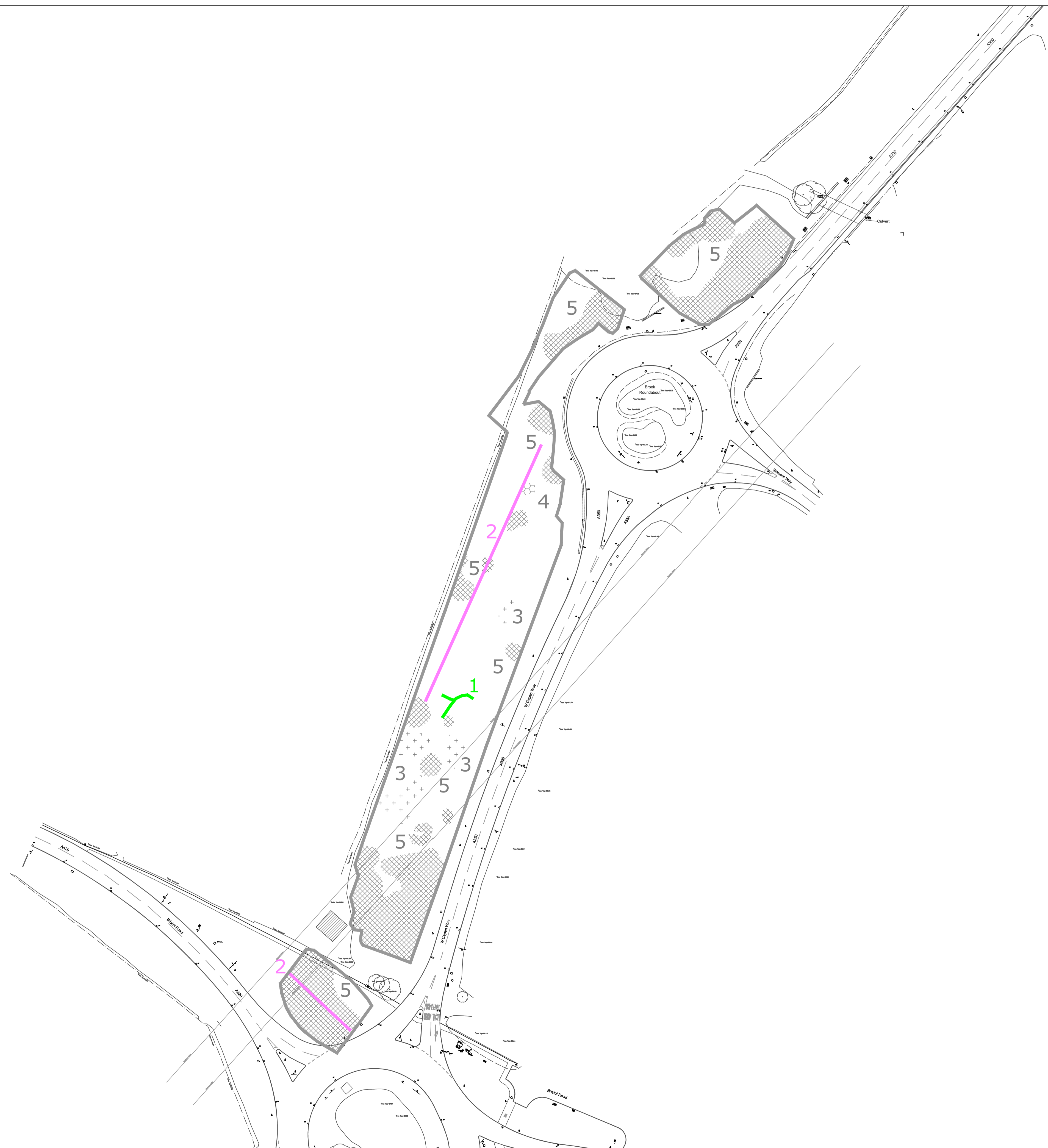

Amendments

Issue No.	Date	Description
-	-	-
-	-	-

© Stratascan Ltd - 2015

PROBABLE ARCHAEOLOGY

- Positive anomaly / weak positive anomaly - probable cut feature of archaeological origin
- Negative anomaly / weak negative anomaly - probable bank or earthwork of archaeological origin

POSSIBLE ARCHAEOLOGY

- Positive anomaly / weak positive anomaly - possible cut feature of archaeological origin
- Negative anomaly / weak negative anomaly - possible bank or earthwork of archaeological origin

MEDIEVAL/POST-MEDIEVAL AGRICULTURE

- Widely spaced curving parallel linear anomalies - probably related to ridge-and-furrow
- Closely spaced parallel linear anomalies - probably related to agricultural activity such as ploughing
- Linear anomaly - probably related to a former field boundary not present on available mapping
- Linear anomaly - related to a former field boundary present on available mapping

OTHER ANOMALIES

- Linear anomaly - probably related to pipe, cable or other modern service
- Linear anomaly - unknown origin, likely to be modern
- Magnetic disturbance associated with nearby metal object such as service or field boundary
- Strong magnetic debris - possible disturbed or made ground
- Scattered magnetic debris
- Area of amorphous magnetic variation - probable natural (e.g. geological or pedological) origin
- Magnetic spike - probable ferrous object

Job No.	8583	Survey Date	JUN/JUL 15
---------	------	-------------	------------

Client
ATKINS HERITAGE

Project Title
**GEOPHYSICAL SURVEY - A350
CHIPPENHAM, WILTSHIRE**

Subject
**ABSTRACTION AND
INTERPRETATION OF
GRADIOMETER ANOMALIES -
CENTRE**

STRATASCAN™
GEOPHYSICS FOR ARCHAEOLOGY
AND ENGINEERING

VINEYARD HOUSE T: 01684 592266
UPTON UPON SEVERN E: info@stratascan.co.uk
WR8 0SA www.stratascan.co.uk

GPR ASSOCIATION

SUMO GROUP MEMBER

IMS GROUP MEMBER

ISO 9001 certified

ISO 14001 certified

UKAS

Scale 0m 10 20 30 40 50m
1:750

Plot	A1	Checked by	DGE	Issue No.	01
Date	JUL 15	Drawn by	JHS/RD	Figure No.	16



Amendments

Issue No.	Date	Description
-	-	-
-	-	-

© Stratascan Ltd - 2015

PROBABLE ARCHAEOLOGY

- Positive anomaly / weak positive anomaly - probable cut feature of archaeological origin
- Negative anomaly / weak negative anomaly - probable bank or earthwork of archaeological origin

POSSIBLE ARCHAEOLOGY

- Positive anomaly / weak positive anomaly - possible cut feature of archaeological origin
- Negative anomaly / weak negative anomaly - possible bank or earthwork of archaeological origin

MEDIEVAL/POST-MEDIEVAL AGRICULTURE

- Widely spaced curving parallel linear anomalies - probably related to ridge-and-furrow
- Closely spaced parallel linear anomalies - probably related to agricultural activity such as ploughing
- Linear anomaly - probably related to a former field boundary not present on available mapping
- Linear anomaly - related to a former field boundary present on available mapping

OTHER ANOMALIES

- Linear anomaly - probably related to pipe, cable or other modern service
- Linear anomaly - unknown origin, likely to be modern
- Magnetic disturbance associated with nearby metal object such as service or field boundary
- Strong magnetic debris - possible disturbed or made ground
- Scattered magnetic debris
- Area of amorphous magnetic variation - probable natural (e.g. geological or pedological) origin
- Magnetic spike - probable ferrous object

Job No.	8583	Survey Date	JUN/JUL 15
---------	------	-------------	------------

Client
ATKINS HERITAGE

Project Title
**GEOPHYSICAL SURVEY - A350
CHIPPENHAM, WILTSHIRE**

Subject
**ABSTRACTION AND
INTERPRETATION OF
GRADIOMETER ANOMALIES -
SOUTH**

STRATASCAN™
GEOPHYSICS FOR ARCHAEOLOGY
AND ENGINEERING

VINEYARD HOUSE UPTON UPON SEVERN WR8 0SA
T: 01684 592266
E: info@stratascan.co.uk
www.stratascan.co.uk

GPR ASSOCIATION

SUMO GROUP MEMBER

IMS GROUP MEMBER

ISO 9001 certified

ISO 14001 certified

ISO 45001 certified

Scale 0m 10 20 30 40 50m
1:750

Plot	A1	Checked by	DGE	Issue No.	01
Date	JUL 15	Drawn by	JHS/RD	Figure No.	17

