

Reproduced from Ordnance Survey's 1:25 000 map of 1998 with the permission of the controller of Her Majesty's Stationery Office. Crown Copyright reserved. Licence No: AL 50125A  
Licencee:  
Stratascan Ltd.  
Vineyard House  
Upper Hook Road  
Upton Upon Severn  
WR8 0SA  
OS 100km square = SX



91

90

89

88

87

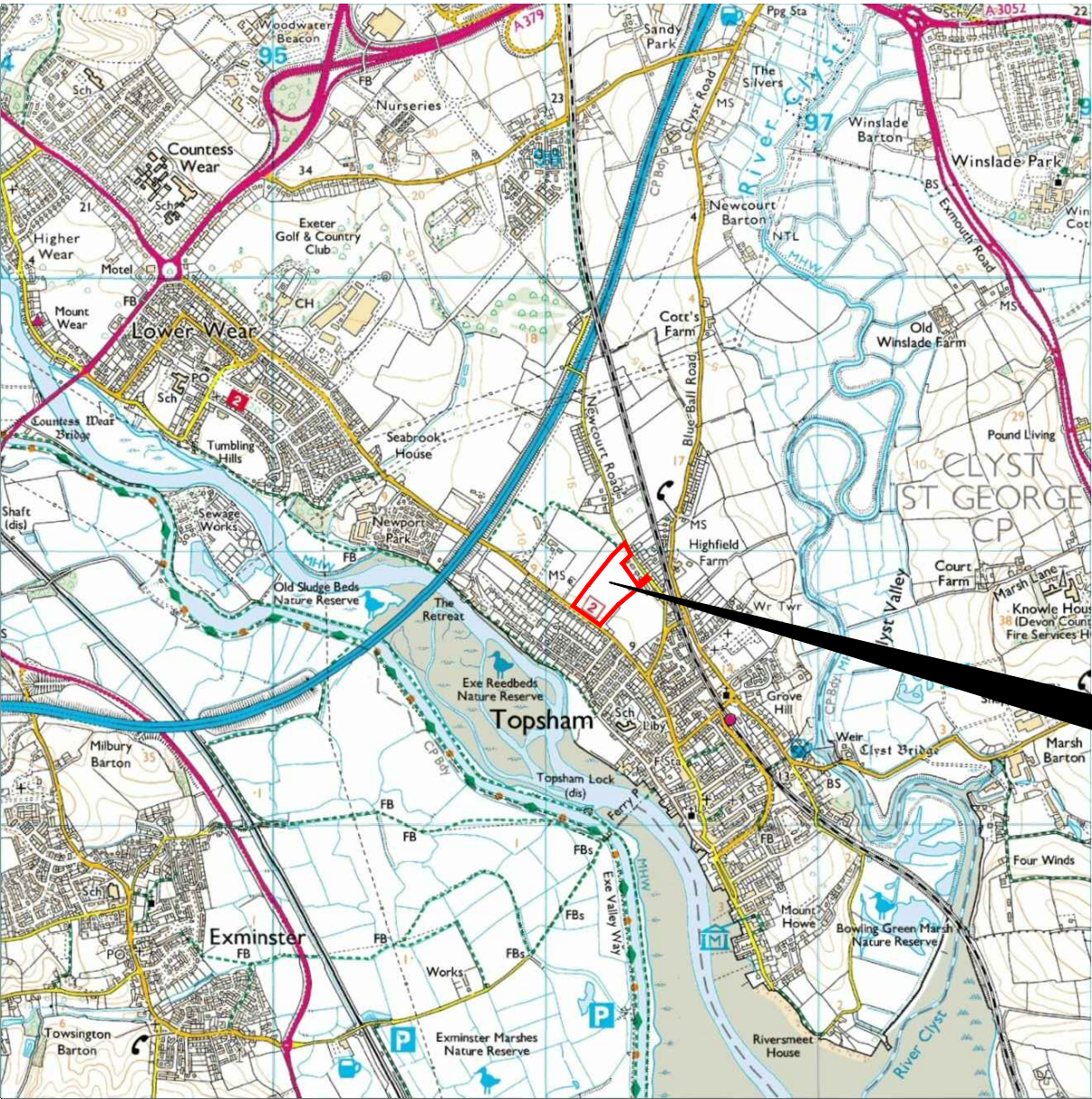

Survey Area

94

95

96

97

98

Amendments

Issue No.	Date	Description
-	-	-
-	-	-

© Stratascan Ltd - ----



Site centred on NGR SX 962 888

Client  
COTSWOLD ARCHAEOLOGY

Project Title Job No. J6930  
EXETER ROAD, TOPSHAM, DEVON

Subject  
LOCATION PLAN OF SURVEY AREA

**STRATASCAN™**  
GEOPHYSICS FOR ARCHAEOLOGY  
AND ENGINEERING  
VINEYARD HOUSE T: 01684 592266  
UPTON UPON SEVERN E: info@stratascan.co.uk  
WR8 0SA www.stratascan.co.uk



Scale 1:25000 0m 500 1000m

Plot A3	Checked by DGE	Issue No. 01
Survey date JUNE 14	Drawn by TR	Figure No. 01



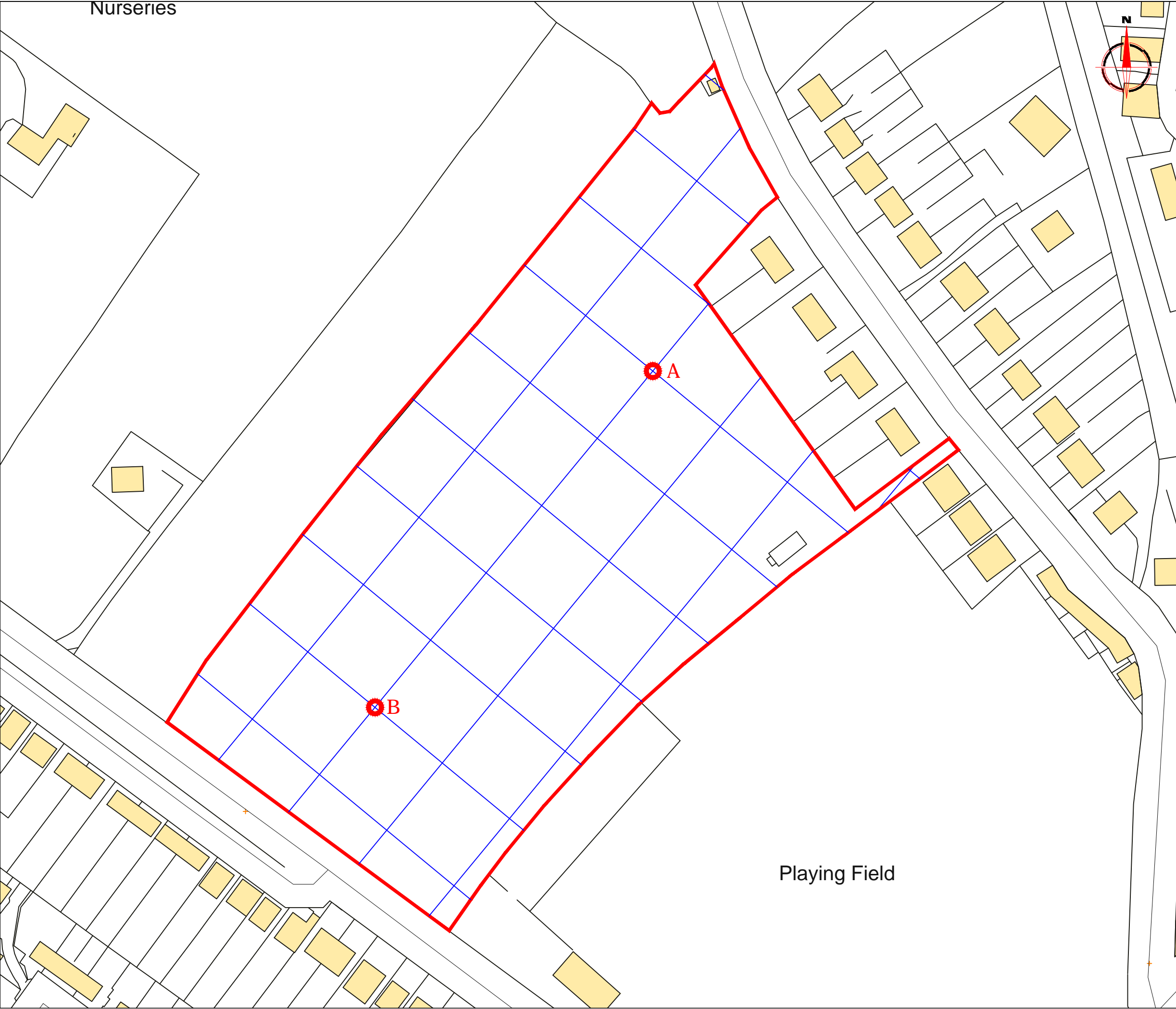

### Amendments

Issue No.	Date	Description
-	-	-
-	-	-

© Stratascan Ltd - ----

### OS GRID REFERENCES

<b>A</b>	296265.69, 088919.47
<b>B</b>	296170.15, 088803.83

Client

**COTSWOLD ARCHAEOLOGY**

Project Title	Job No.
<b>EXETER ROAD, TOPSHAM, DEVON</b>	<b>J6930</b>

Subject

**LOCATION OF SURVEY GRIDS AND REFERENCING**

**STRATASCAN™**  
GEOPHYSICS FOR ARCHAEOLOGY  
AND ENGINEERING

VINEYARD HOUSE  
UPTON UPON SEVERN  
WR8 0SA

T: 01684 592266  
E: info@stratascan.co.uk  
www.stratascan.co.uk

REGISTERED ORGANISATION

SUMO GROUP MEMBER

ISO 9001 certified

UKAS

ISO 14001 certified

UKAS

Scale

**1: 1250**

0m 10 20 30 40 50m

Plot	Checked by	Issue No.
<b>A3</b>	<b>DGE</b>	<b>01</b>
Survey date	Drawn by	Figure No.
<b>JUNE 14</b>	<b>TR</b>	<b>02</b>



### Amendments

Issue No.	Date	Description
-	-	-
-	-	-

© Stratascan Ltd - ----

Plotting parameters

Maximum + 100nT (red)  
Minimum - 100nT (blue)

+ 100nT

+ 10nT

- 10nT

- 100nT

Client

COTSWOLD ARCHAEOLOGY

Project Title

EXETER ROAD, TOPSHAM, DEVON

Job No.

J6930

Subject

COLOUR PLOT OF GRADIOMETER DATA SHOWING EXTREME VALUES

**STRATASCAN**™

GEOPHYSICS FOR ARCHAEOLOGY AND ENGINEERING

VINEYARD HOUSE  
UPTON UPON SEVERN  
WR8 0SA

T: 01684 592266  
E: info@stratascan.co.uk  
www.stratascan.co.uk

EUROPEAN  
**GPR**  
ASSOCIATION

**sumo**  
Survey Services

SUMO GROUP MEMBER

ims ISO 9001 certified

ims ISO 14001 certified

REGISTERED ORGANISATION

UKAS

Scale

1: 1250

0m 10 20 30 40 50m

Plot	A3	Checked by	DGE	Issue No.	01
Survey date	JUNE 14	Drawn by	SRC	Figure No.	03





### Amendments

Issue No.	Date	Description
-	-	-
-	-	-

© Stratascan Ltd - ----

Plotting parameters

Maximum +2nT (black)  
Minimum -2nT (white)

Zero Mean

-2nT                      +2nT

+2nT  
-2nT

Client

COTSWOLD ARCHAEOLOGY

Project Title

EXETER ROAD, TOPSHAM, DEVON

Job No. J6930

Subject

PLOT OF MINIMALLY PROCESSED GRADIOMETER DATA

**STRATASCAN**™

GEOPHYSICS FOR ARCHAEOLOGY AND ENGINEERING

VINEYARD HOUSE  
UPTON UPON SEVERN  
WR8 0SA

T: 01684 592266  
E: info@stratascan.co.uk  
www.stratascan.co.uk

**EUROPEAN GPR ASSOCIATION**

**sumo** SURVEY SERVICES

SUMO GROUP MEMBER

IMS ISO 9001 certified

UKAS ISO 9001

IMS ISO 14001 certified

UKAS ISO 14001

Scale

1: 1250

0m 10 20 30 40 50m

Plot	A3	Checked by	DGE	Issue No.	01
Survey date	JUNE 14	Drawn by	SRC	Figure No.	04



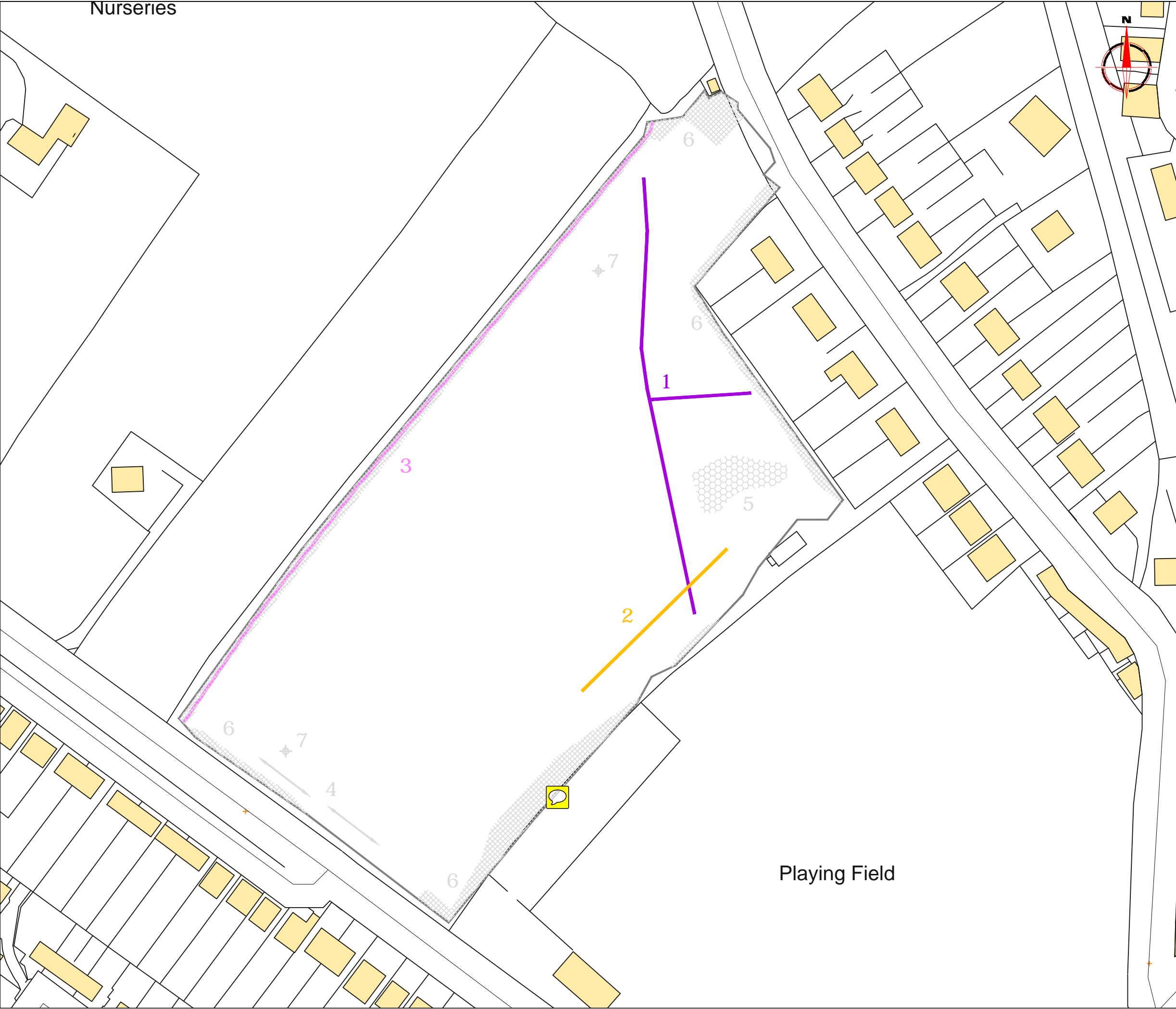

Amendments

Issue No.	Date	Description
-	-	-
-	-	-

© Stratascan Ltd - ----

KEY

PROBABLE ARCHAEOLOGY

	Positive anomaly / weak positive anomaly - probable cut feature of archaeological origin
	Negative anomaly / weak negative anomaly - probable bank or earthwork of archaeological origin
	Linear anomaly - probable former field boundary not present on available mapping
	Widely spaced curving parallel linear anomalies - probably related to ridge-and-furrow

POSSIBLE ARCHAEOLOGY

	Positive anomaly / weak positive anomaly - possible cut feature of archaeological origin
	Negative anomaly / weak negative anomaly - possible bank or earthwork of archaeological origin

OTHER ANOMALIES

	Linear anomalies - probably related to agricultural activity such as ploughing
	Linear anomaly - probably related to pipe, cable or other modern service
	Linear anomaly - possibly related to land drain
	Magnetic disturbance associated with nearby metal object such as service or field boundary
	Strong magnetic debris - possible disturbed or made ground
	Scattered magnetic debris
	Area of amorphous magnetic variation - probable natural (e.g. geological or pedological) origin
	Magnetic spike - probable ferrous object

Client

COTSWOLD ARCHAEOLOGY

Project Title

Job No.

J6930

EXETER ROAD, TOPSHAM, DEVON

Subject

ABSTRACTION AND INTERPRETATION OF GRADIOMETER ANOMALIES

STRATASCAN™

GEOPHYSICS FOR ARCHAEOLOGY AND ENGINEERING

VINEYARD HOUSE

UPTON UPON SEVERN

WR8 0SA

T: 01684 592266

E: info@stratascan.co.uk

www.stratascan.co.uk

Scale

1: 1250

Plot	Checked by	Issue No.
A3	DGE	01
Survey date	Drawn by	Figure No.
JUNE 14	SRC	05