

Reproduced from Ordnance Survey's 1:25 000 map of 1998 with the permission of the controller of Her Majesty's Stationary Office. Crown Copyright reserved. Licence No: AL 50125A  
 Licence: Stratascan Ltd. Vineyard House Upper Hook Road Upton Upon Severn WR8 0SA  
 OS 100km square = SO

Survey area

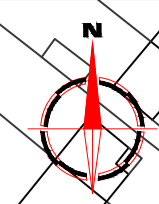
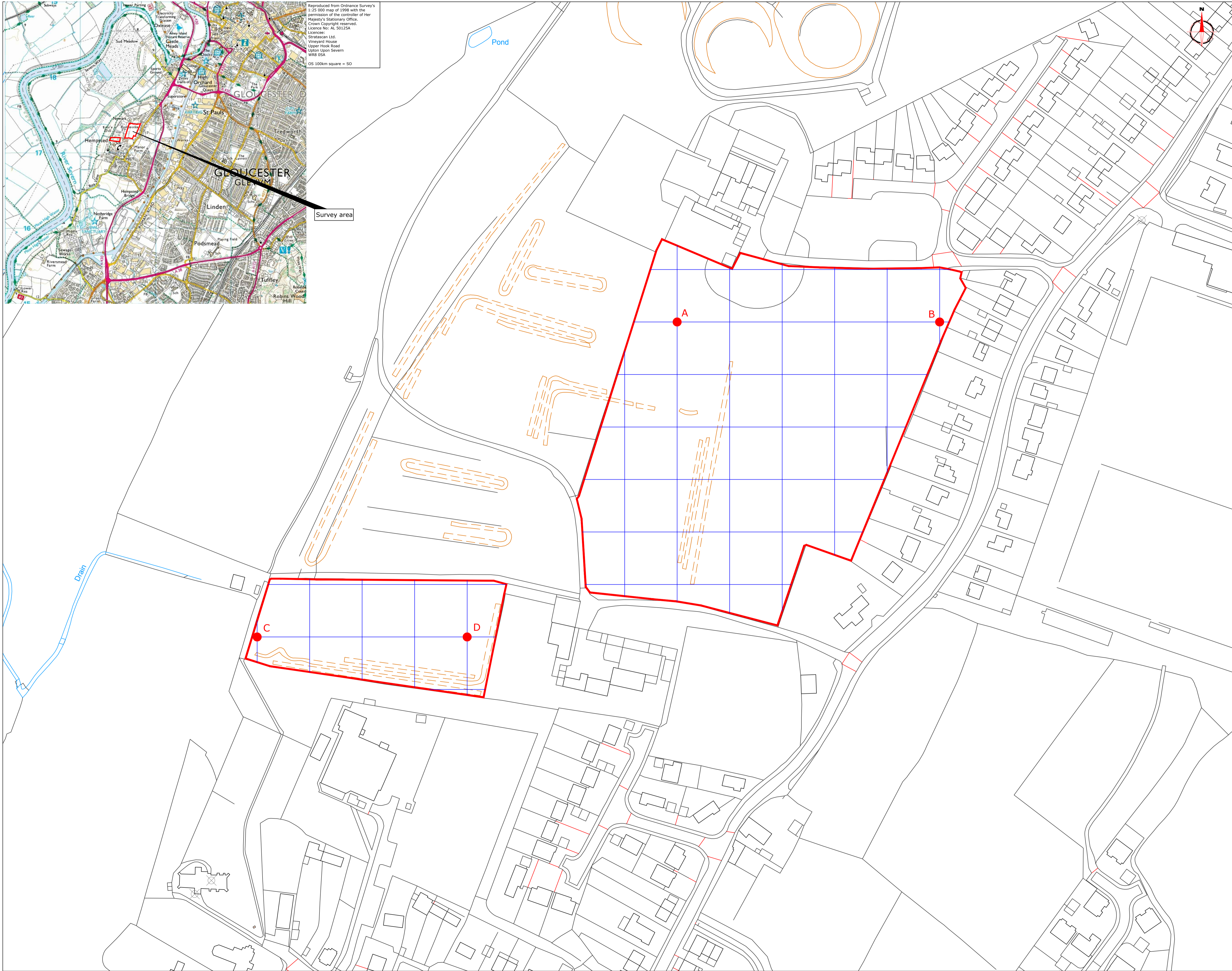

Amendments		
Issue No.	Date	Description
-	-	-
-	-	-
© Stratascan Ltd - 2014		

Survey area

Site centred on NGR SO 817 172

**OS REFERENCING INFORMATION**

<b>A</b>	381634.43, 217352.64
<b>B</b>	381784.43, 217352.64
<b>C</b>	381394.43, 217172.64
<b>D</b>	381514.43, 217172.64

Job No.	J6671	Survey Date	APR 14
---------	-------	-------------	--------

Client  
**CgMs CONSULTING LTD**

Project Title  
**HEMPSTED, GLOUCESTER**

Subject  
**SITE LOCATION, SURVEY AREA & REFERENCING**

**STRATASCAN™**  
 GEOPHYSICS FOR ARCHAEOLOGY AND ENGINEERING  
 VINEYARD HOUSE UPTON UPON SEVERN WR8 0SA  
 T: 01684 592266  
 E: info@stratascan.co.uk  
 www.stratascan.co.uk

**GPR ASSOCIATION**  
**SUMO GROUP MEMBER**  
 ISO 9001 certified  
 ISO 14001 certified

Scale  
 1:1000  
 0m 10 20 30 40 50 60m

Plot	A1	Checked by	DGE	Issue No.	01
Date	APR 14	Drawn by	TJH	Figure No.	01





Amendments		
Issue No.	Date	Description
-	-	-
-	-	-
© Stratascan Ltd - 2014		

Plotting parameters

Maximum +100nT (red)  
Minimum -100nT (blue)

Job No.	J6671	Survey Date	APR 14
Client	CgMs CONSULTING LTD		
Project Title	HEMPSTED, GLOUCESTER		
Subject	COLOUR PLOT OF GRADIOMETER DATA SHOWING EXTREME VALUES		

**STRATASCAN™**  
GEOPHYSICS FOR ARCHAEOLOGY AND ENGINEERING

VINEYARD HOUSE UPTON UPON SEVERN WR8 0SA T: 01684 592266 E: info@stratascan.co.uk www.stratascan.co.uk

**GPR ASSOCIATION**

**SUMO GROUP MEMBER**

ISO 9001 certified

ISO 14001 certified

Scale 1:1000

Plot	A1	Checked by	DGE	Issue No.	01
Date	APR 14	Drawn by	TJH	Figure No.	02





Amendments		
Issue No.	Date	Description
-	-	-
-	-	-
© Stratascan Ltd - 2014		

Plotting parameters

Maximum +2nT (black)  
Minimum -2nT (white)

-2nT      +2nT

Job No. J6671      Survey Date APR 14

Client  
**CgMs CONSULTING LTD**

Project Title  
**HEMPSTED, GLOUCESTER**

Subject  
**PLOT OF MINIMALLY PROCESSED GRADIOMETER DATA**

**STRATASCAN™**  
GEOPHYSICS FOR ARCHAEOLOGY AND ENGINEERING  
VINEYARD HOUSE      T: 01684 592266  
UPTON UPON SEVERN      E: info@stratascan.co.uk  
WR8 0SA      www.stratascan.co.uk

**GPR ASSOCIATION**      **SUMO GROUP MEMBER**      **ISO 9001 certified**      **ISO 14001 certified**

Scale 1:1000      0m 10 20 30 40 50 60m

Plot A1	Checked by DGE	Issue No. 01
Date APR 14	Drawn by JHS	Figure No. 03



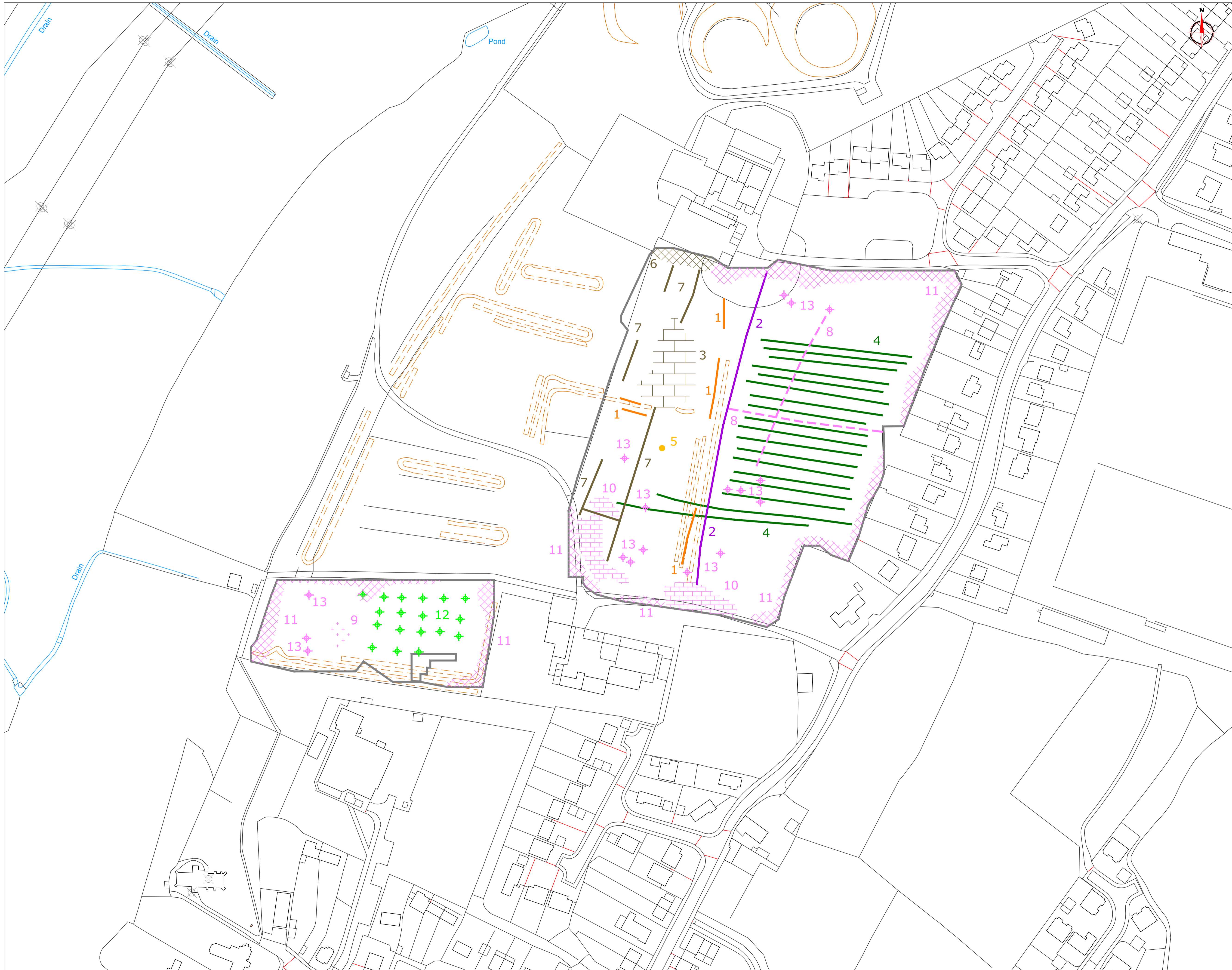

Amendments		
Issue No.	Date	Description
-	-	-
-	-	-
© Stratascan Ltd - 2014		
KEY		
Earthwork		
PROBABLE ARCHAEOLOGY		
	Positive linear anomaly related to known earthwork	
	Positive anomaly / weak positive anomaly - probable cut feature of archaeological origin	
	Negative anomaly / weak negative anomaly - probable bank or earthwork of archaeological origin	
	Strong magnetic debris related to a former pond present on available mapping pre-1900	
	Linear area of scattered magnetic debris - former field boundary present on available mapping pre-1900	
	Widely spaced curving parallel linear anomalies - probably related to ridge-and-furrow	
POSSIBLE ARCHAEOLOGY		
	Positive anomaly / weak positive anomaly - possible cut feature of archaeological origin	
	Negative anomaly / weak negative anomaly - possible bank or earthwork of archaeological origin	
OTHER ANOMALIES		
	Closely spaced parallel linear anomalies - probably related to agricultural activity such as ploughing	
	Linear anomaly - probably related to pipe, cable or other modern service	
	Linear anomaly - possibly related to land drain	
	Linear anomaly related to a former field boundary present on available mapping in 1970	
	Magnetic disturbance associated with former building present on available mapping in 1970	
	Magnetic disturbance associated with nearby metal object such as service or field boundary	
	Scattered magnetic debris	
	Strong magnetic debris - possible disturbed or made ground	
	Magnetic spike- fenced tree	
	Magnetic spike - probable ferrous object	
Job No.	Survey Date	
J6671	APR 14	
Client	CgMs CONSULTING LTD	
Project Title	HEMPSTED, GLOUCESTER	
Subject	INTERPRETATION	
<b>STRATASCAN™</b> GEOPHYSICS FOR ARCHAEOLOGY AND ENGINEERING		
VINEYARD HOUSE		T: 01684 592266
UPTON UPON SEVERN		E: info@stratascan.co.uk
WR8 0SA		www.stratascan.co.uk
Scale	0m 10 20 30 40 50 60m	
1:1000		
Plot	Checked by	Issue No.
A1	DGE	01
Date	Drawn by	Figure No.
APR 14	TJH	04