

Reproduced from Ordnance Survey's 1:25 000 map of 1998 with the permission of the controller of Her Majesty's Stationery Office. Crown Copyright reserved. Licence No: AL 50125A
Licencee:
Stratascan Ltd.
Vineyard House
Upper Hook Road
Upton Upon Severn
WR8 0SA
OS 100km square = SO



44

43

42

41

40

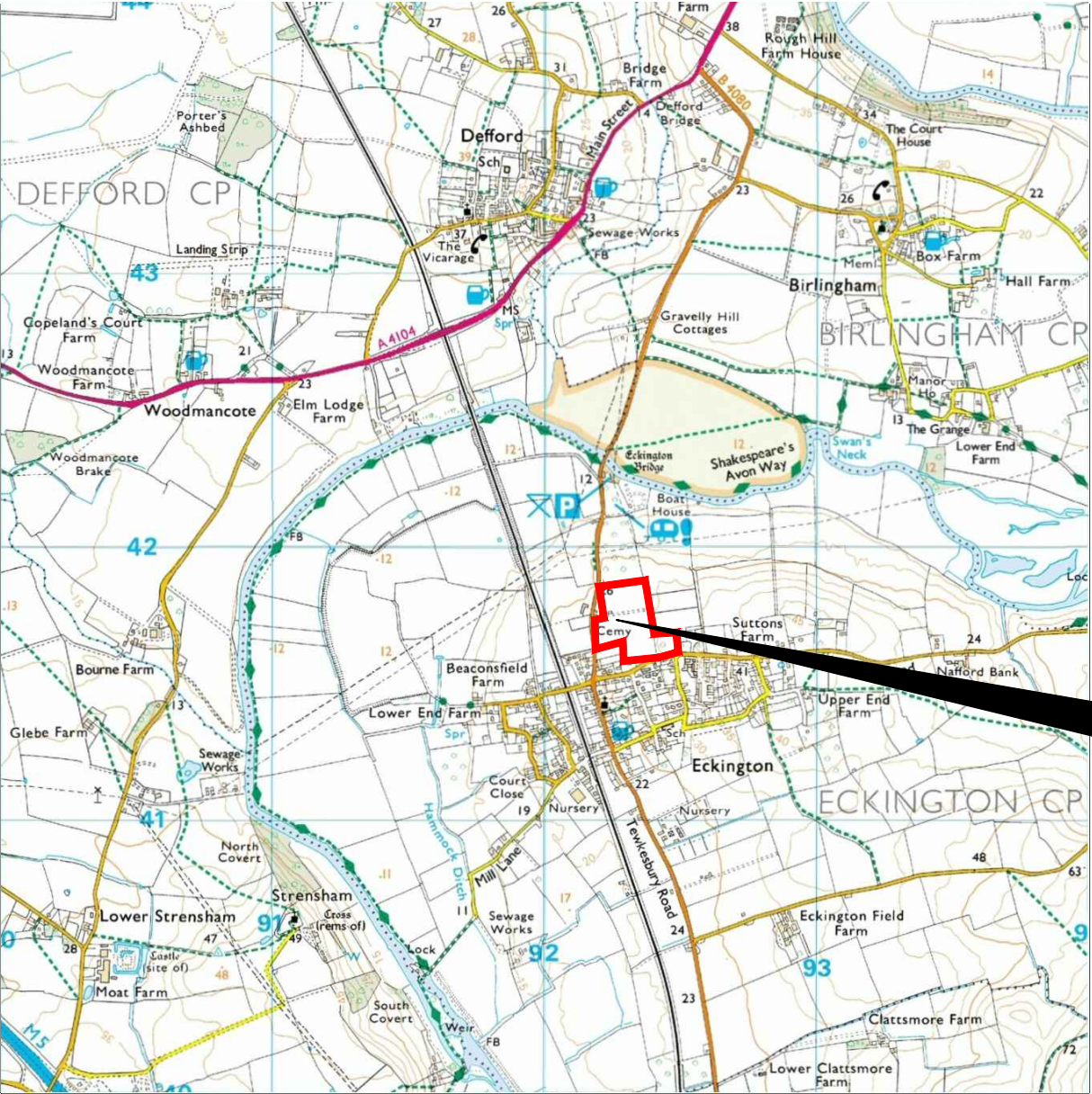

90

91

92

93

94

Amendments

Issue No.	Date	Description
-	-	-
-	-	-
© Stratascan Ltd - 2014		
Site centred on NGR SO 923 416		
Client CgMs CONSULTING LTD.		
Project Title LAND AT ECKINGTON, WORCESTERSHIRE		
Subject LOCATION PLAN OF SURVEY AREA		
 GEOPHYSICS FOR ARCHAEOLOGY AND ENGINEERING VINEYARD HOUSE UPTON UPON SEVERN WR8 0SA T: 01684 592266 E: info@stratascan.co.uk www.stratascan.co.uk		
 SUMO GROUP MEMBER ISO 9001 certified UKAS ISO 9001 UKAS ISO 14001		
Scale 1:25000 0m 500 1000m		
Plot A3	Checked by DGE	Issue No. 01
Survey date JULY 14	Drawn by JHS	Figure No. 01

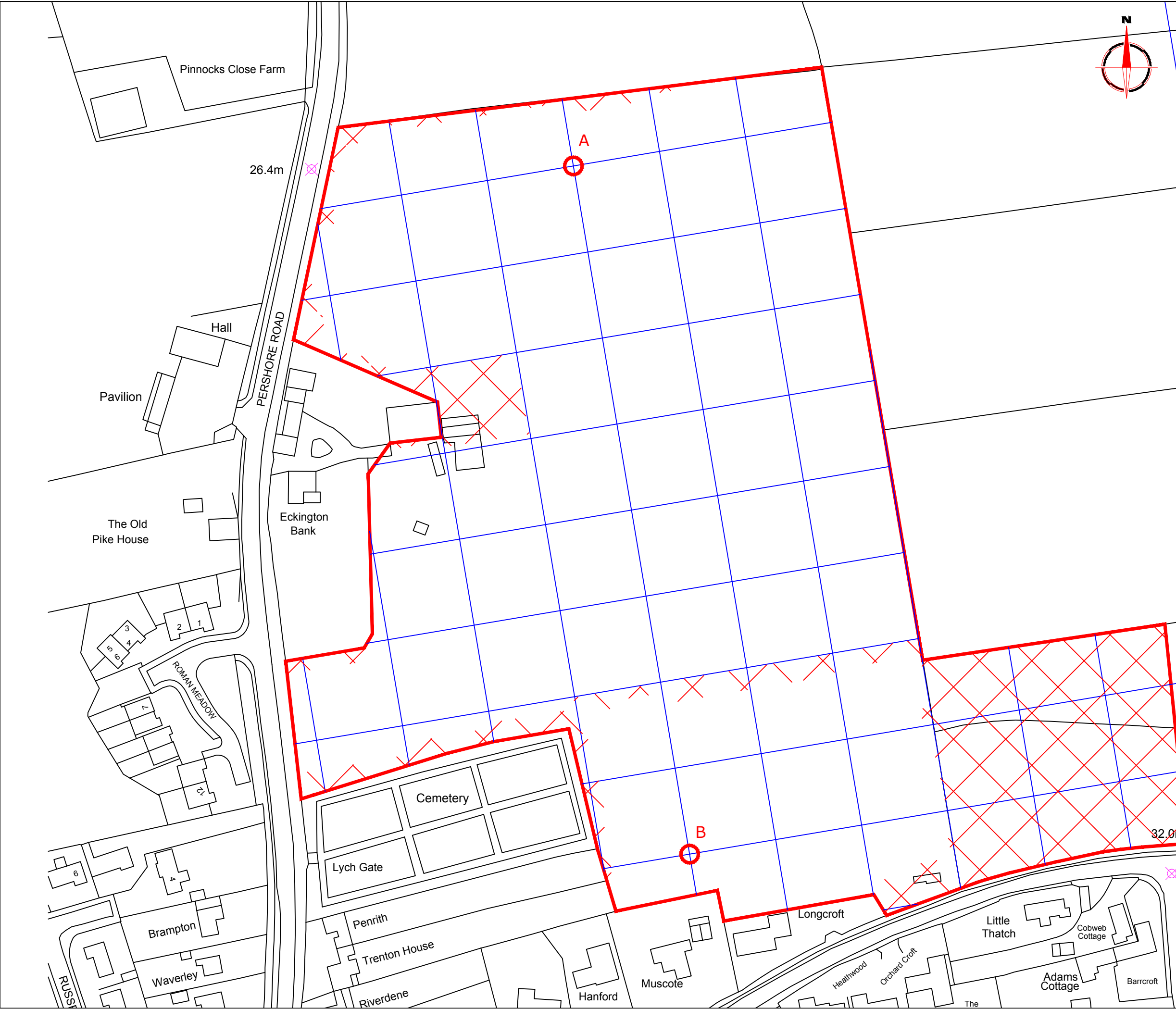

Amendments

Issue No.	Date	Description
-	-	-
-	-	-

© Stratascan Ltd - 2014

Area unsurveyable

OS GRID REFERENCES

A	392279.53, 241846.82
B	392319.50, 241610.18

Client

CgMs CONSULTING LTD.

Project Title	Job No.
LAND AT ECKINGTON, WORCESTERSHIRE	7088

Subject

LOCATION OF SURVEY GRIDS AND
REFERENCING

STRATASCAN™

GEOPHYSICS FOR ARCHAEOLOGY
AND ENGINEERING

VINEYARD HOUSE
UPTON UPON SEVERN
WR8 0SA

T: 01684 592266
E: info@stratascan.co.uk
www.stratascan.co.uk

EUROPEAN
GPR
ASSOCIATION

SURVEY
SERVICES

SUMO
GROUP
MEMBER

REGISTERED
ORGANISATION

ims
ISO 9001
certified

ims
ISO 14001
certified

Scale

1:1250

0m 10 20 30 40 50m

Plot	Checked by	Issue No.
A3	DGE	01
Survey date	Drawn by	Figure No.
JULY 14	JHS	02

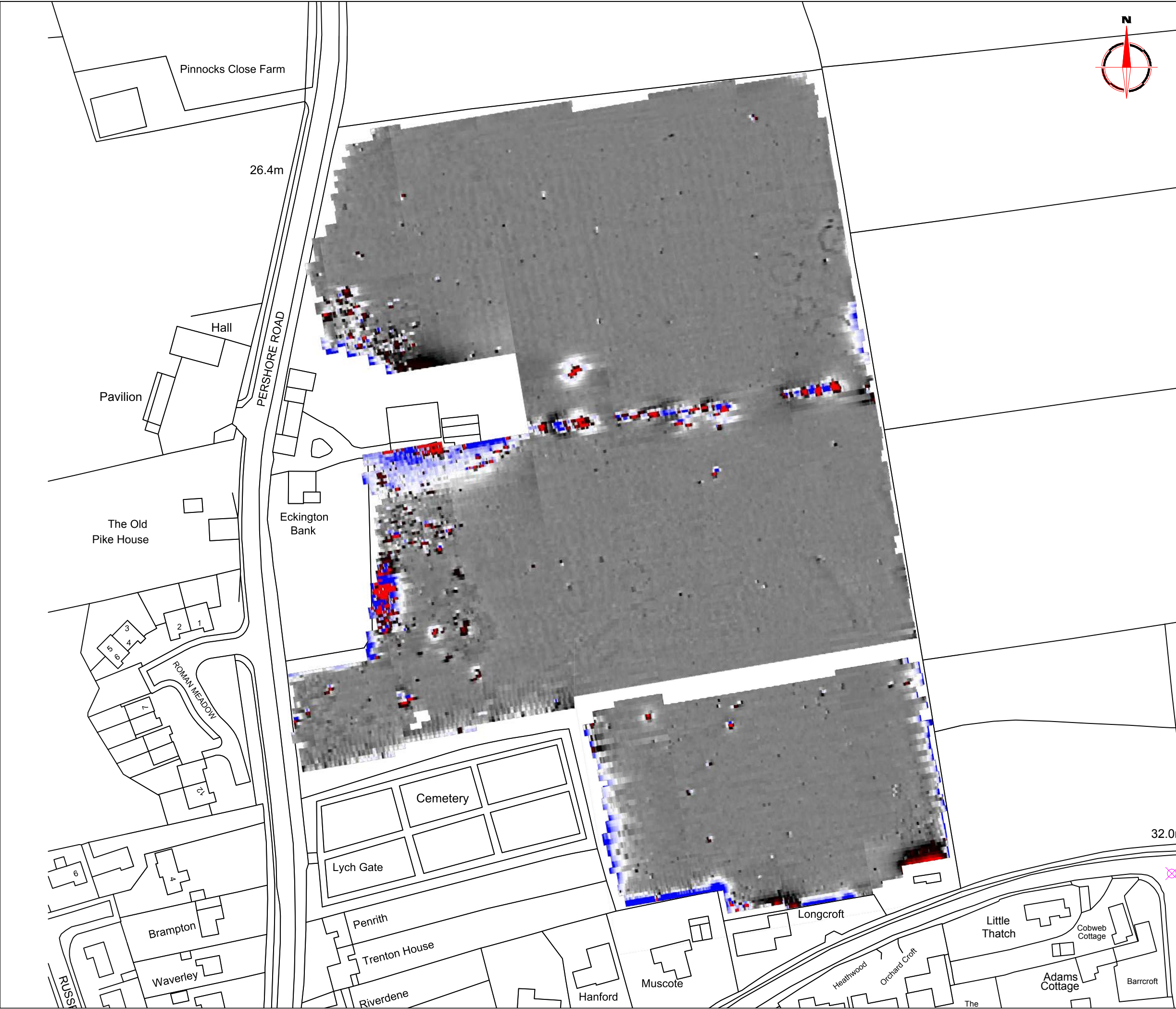

Amendments

Issue No.	Date	Description
-	-	-
-	-	-

© Stratascan Ltd - 2014

Plotting parameters

Maximum +100nT (red)
Minimum -100nT (blue)

+100nT

+10nT

-10nT

-100nT

Client

CgMs CONSULTING LTD.

Project Title

Job No. 7088

LAND AT ECKINGTON,
WORCESTERSHIRE

Subject

COLOUR PLOT OF GRADIOMETER
DATA SHOWING EXTREME VALUES

STRATASCAN™
GEOPHYSICS FOR ARCHAEOLOGY
AND ENGINEERING

VINEYARD HOUSE
UPTON UPON SEVERN
WR8 0SA

T: 01684 592266
E: info@stratascan.co.uk
www.stratascan.co.uk

**EUROPEAN
GPR
ASSOCIATION**

SUMO
SURVEY SERVICES

SUMO GROUP MEMBER

Scale

1:1250

0m

10

20

30

40

50m

Plot	A3	Checked by	DGE	Issue No.	01
Survey date	JULY 14	Drawn by	RD	Figure No.	03



Amendments

Issue No.	Date	Description
-	-	-
-	-	-

© Stratascan Ltd - 2014

-2nT +2nT -2nT

Client

CgMs CONSULTING LTD.

Project Title

LAND AT ECKINGTON,
WORCESTERSHIRE

Job No. 7088

Subject

PLOT OF MINIMALLY PROCESSED
GRADIOMETER DATA

STRATASCAN™
GEOPHYSICS FOR ARCHAEOLOGY
AND ENGINEERING

VINEYARD HOUSE
UPTON UPON SEVERN
WR8 0SA

T: 01684 592266
E: info@stratascan.co.uk
www.stratascan.co.uk

EUROPEAN GPR ASSOCIATION

SUMO
SUMO GROUP MEMBER

IMS
ISO 9001 certified

IMS
ISO 14001 certified

Scale

1:1250

0m 10 20 30 40 50m

Plot	A3	Checked by	DGE	Issue No.	01
Survey date	JULY 14	Drawn by	RD	Figure No.	04



Amendments

Issue No.	Date	Description
-	-	-
-	-	-

© Stratascan Ltd - 2014

KEY

PROBABLE ARCHAEOLOGY

Positive anomaly / weak positive anomaly - probable cut feature of archaeological origin

Negative anomaly / weak negative anomaly - probable bank or earthwork of archaeological origin

Moderate strength discrete anomaly - probable thermoremanent feature

Widely spaced curving parallel linear anomalies - probably related to ridge-and-furrow

POSSIBLE ARCHAEOLOGY

Positive anomaly / weak positive anomaly - possible cut feature of archaeological origin

Negative anomaly / weak negative anomaly - possible bank or earthwork of archaeological origin

Moderate strength discrete anomaly - possible thermoremanent feature

OTHER ANOMALIES

Closely spaced parallel linear anomalies - probably related to agricultural activity such as ploughing

Linear anomaly - probably related to pipe, cable or other modern service

Linear anomaly - possibly related to land drain

Magnetic disturbance associated with nearby metal object such as service or field boundary

Strong magnetic debris - possible disturbed or made ground

Weak scattered magnetic debris

Area of amorphous magnetic variation - probable natural (e.g. geological or pedological) origin

Magnetic spike - probable ferrous object

Client

CgMs CONSULTING LTD.

Project Title

LAND AT ECKINGTON,
WORCESTERSHIRE

Job No.

7088

Subject

ABSTRACTION AND INTERPRETATION
OF GRADIOMETER ANOMALIES

STRATASCAN™

GEOPHYSICS FOR ARCHAEOLOGY
AND ENGINEERING

VINEYARD HOUSE
UPTON UPON SEVERN
WR8 0SA

T: 01684 592266
E: info@stratascan.co.uk
www.stratascan.co.uk

EUROPEAN
GPR
ASSOCIATION

SURVEY
SERVICES

SUMO
GROUP
MEMBER

ims
ISO 9001
certified

UKAS
QUALITY
MANAGEMENT
078

ims
ISO 14001
certified

UKAS
ENVIRONMENTAL
MANAGEMENT
078

Scale

1:1250

0m1020304050m

Plot

A3

Checked by

DGE

Issue No.

01

Survey date

JULY 14

Drawn by

RD

Figure No.

05