

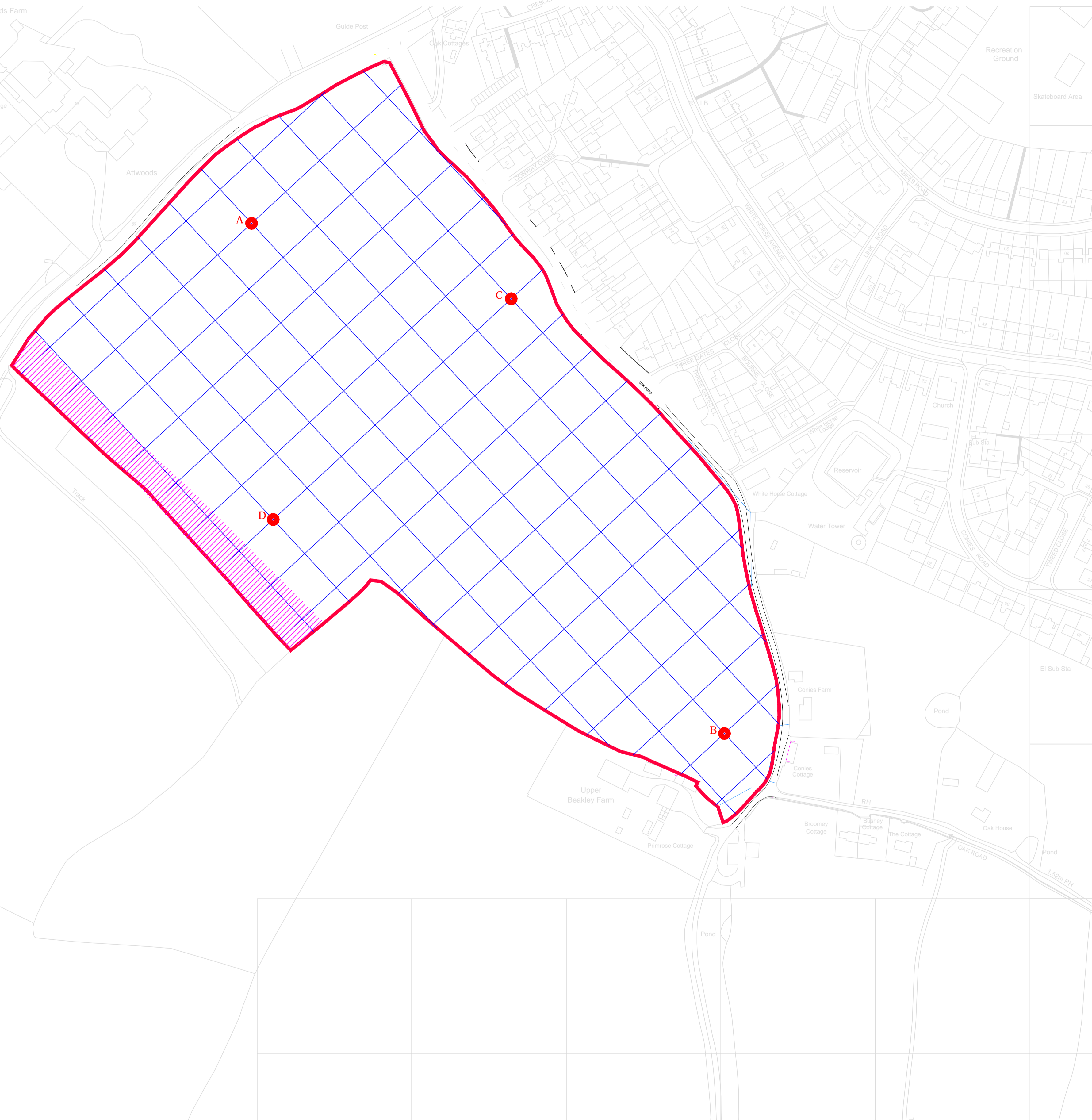

Survey Area



Amendments

Issue No.	Date	Description
-	-	-

© Stratascan Ltd - 2014



Site centred on NGR TL 804 297

Reproduced from Ordnance Survey's 1:25,000 map of 1988 with the permission of the controller of Her Majesty's Stationery Office. Crown Copyright reserved. Licence No. AL 50125X
 Licensee: Stratascan Ltd, Vineyard House, Upper Hook Road, Epton Upon Severn, WR8 0SA
 OS 100km square = TL

Unsurveyable area due to overgrown vegetation

OS REFERENCING INFORMATION

A	580396.38, 229736.81
B	580702.32, 229406.81
C	580564.36, 229687.99
D	580410.36, 229545.23

Job No.	7144	Survey Date	AUG 14
---------	------	-------------	--------

Client
CGMS CONSULTING LTD.

Project Title
GEOPHYSICAL SURVEY - HALSTEAD, ESSEX

Subject
SITE LOCATION, SURVEY AREA & REFERENCING

STRATASCAN™
 GEOPHYSICS FOR ARCHAEOLOGY AND ENGINEERING
 VINEYARD HOUSE T: 01684 592266
 UPTON UPON SEVERN E: info@stratascan.co.uk
 WR8 0SA www.stratascan.co.uk



Scale 0m 10 20 30 40 50 60 70 80 90m
1:1500

Plot	A1	Checked by	DGE	Issue No.	01
Date	SEP 14	Drawn by	OJP	Figure No.	01



Amendments		
Issue No.	Date	Description
-	-	-
-	-	-
© Stratascan Ltd - 2014		

Plotting parameters	
Maximum +100nT (red) Minimum -100nT (blue)	

Job No.	7144	Survey Date	AUG 14
Client	CgMs CONSULTING LTD.		
Project Title	GEOPHYSICAL SURVEY - HALSTEAD, ESSEX		
Subject	COLOUR PLOT OF MINIMALLY PROCESSED GRADIOMETER DATA SHOWING EXTREME VALUES		
<small>GEOPHYSICS FOR ARCHAEOLOGY AND ENGINEERING</small>			
<small>VINEYARD HOUSE UPTON UPON SEVERN WR8 0SA</small>		<small>T: 01684 592266 E: info@stratascan.co.uk www.stratascan.co.uk</small>	

Scale	0m 10 20 30 40 50 60m		
1: 1000			
Plot	A1	Checked by	DGE
Date	SEP 14	Issue No.	01
		Figure No.	02



Amendments

Issue No.	Date	Description
-	-	-
-	-	-

© Stratascan Ltd - 2014

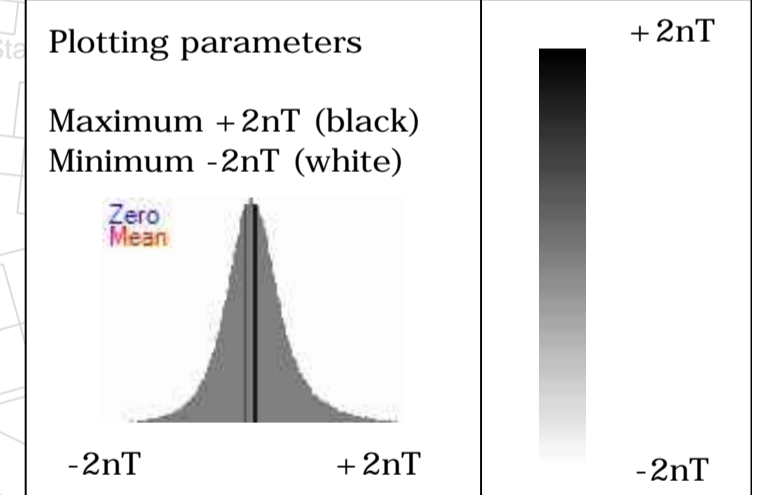

Job No.	7144	Survey Date	AUG 14
---------	------	-------------	--------

Client
CgMs CONSULTING LTD.

Project Title
**GEOPHYSICAL SURVEY -
HALSTEAD, ESSEX**

Subject
**PLOT OF MINIMALLY
PROCESSED GRADIOMETER
DATA**

STRATASCAN™
GEOPHYSICS FOR ARCHAEOLOGY
AND ENGINEERING
VINEYARD HOUSE T: 01684 592266
UPTON UPON SEVERN E: info@stratascan.co.uk
WR8 0SA www.stratascan.co.uk



Scale 0m 10 20 30 40 50 60m
1: 1000

Plot	A1	Checked by	DGE	Issue No.	01
Date	SEP 14	Drawn by	OJP	Figure No.	03

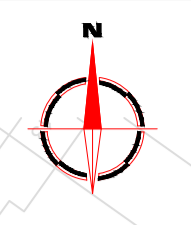
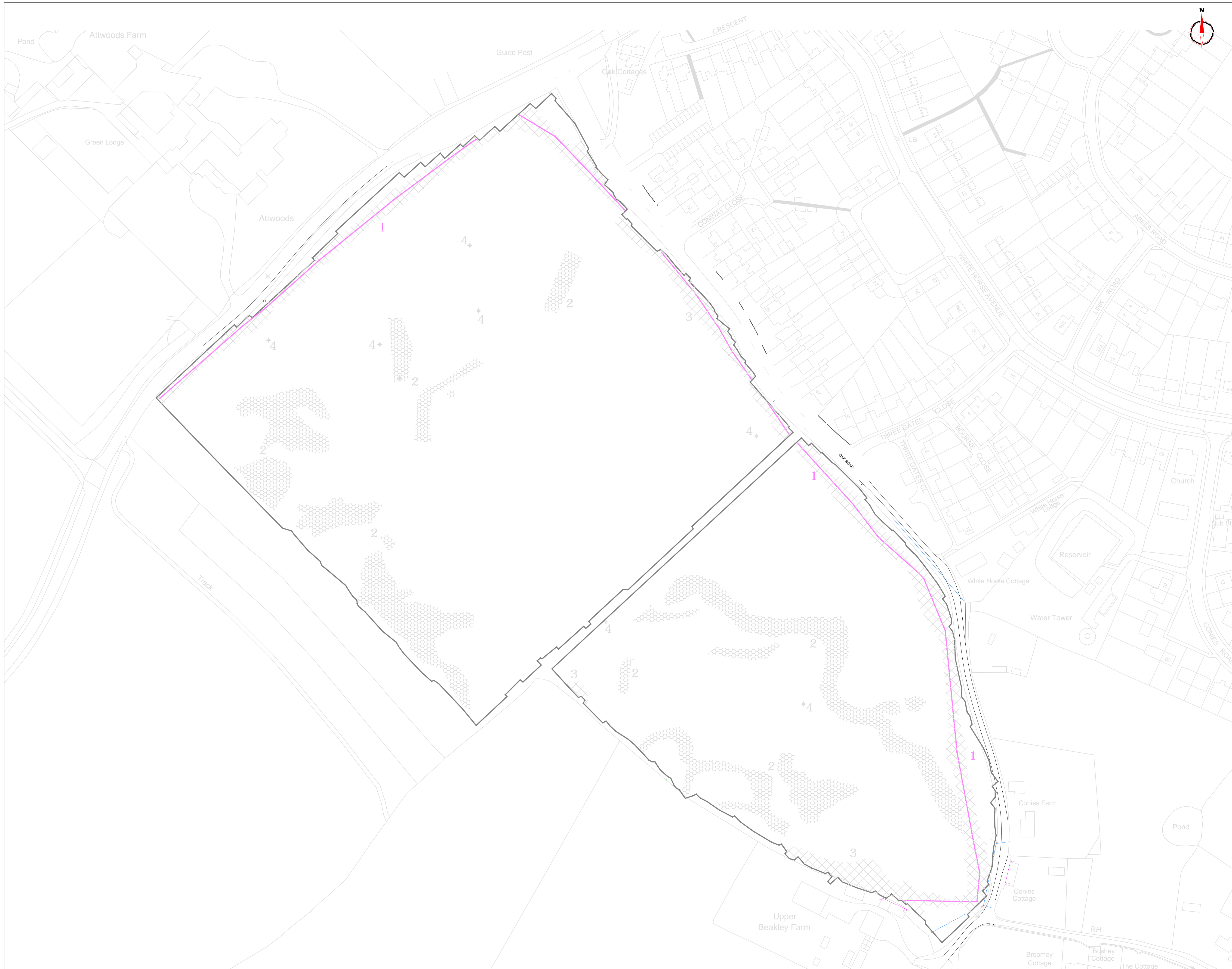

Amendments

Issue No.	Date	Description
-	-	-
-	-	-

© Stratascan Ltd - 2014

KEY

PROBABLE ARCHAEOLOGY

- Positive anomaly / weak positive anomaly - probable cut feature of archaeological origin
- Negative anomaly / weak negative anomaly - probable bank or earthwork of archaeological origin
- Moderate strength discrete anomaly - probable thermoremanent feature
- Widely spaced curving parallel linear anomalies - probably related to ridge-and-furrow

POSSIBLE ARCHAEOLOGY

- Positive anomaly / weak positive anomaly - possible cut feature of archaeological origin
- Negative anomaly / weak negative anomaly - possible bank or earthwork of archaeological origin
- Moderate strength discrete anomaly - possible thermoremanent feature

OTHER ANOMALIES

- Closely spaced parallel linear anomalies - probably related to agricultural activity such as ploughing
- Linear anomaly - probably related to pipe, cable or other modern service
- Linear anomaly - possibly related to land drain
- Magnetic disturbance associated with nearby metal object such as service or field boundary
- Strong magnetic debris - possible disturbed or made ground
- Scattered magnetic debris
- Area of amorphous magnetic variation - probable natural (e.g. geological or pedological) origin
- Magnetic spike - probable ferrous object

Job No.	7144	Survey Date	AUG 14
---------	------	-------------	--------

Client
CgMs CONSULTING LTD.

Project Title
GEOPHYSICAL SURVEY - HALSTEAD, ESSEX

Subject
INTERPRETATION

STRATASCAN™
GEOPHYSICS FOR ARCHAEOLOGY AND ENGINEERING
VINEYARD HOUSE T: 01684 592266
UPTON UPON SEVERN E: info@stratascan.co.uk
WR8 0SA www.stratascan.co.uk

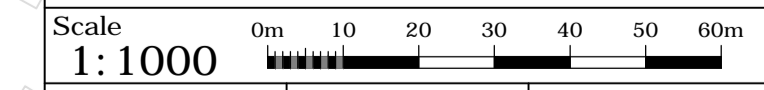

Plot	A1	Checked by	DGE	Issue No.	01
Date	SEP 14	Drawn by	OJP	Figure No.	04