

Reproduced from Ordnance Survey's 1:25 000 map of 1998 with the permission of the controller of Her Majesty's Stationery Office. Crown Copyright reserved. Licence No: AL 50125A
 Licencee:
 Stratascan Ltd.
 Vineyard House
 Upper Hook Road
 Upton Upon Severn
 WR8 0SA
 OS 100km square = SS

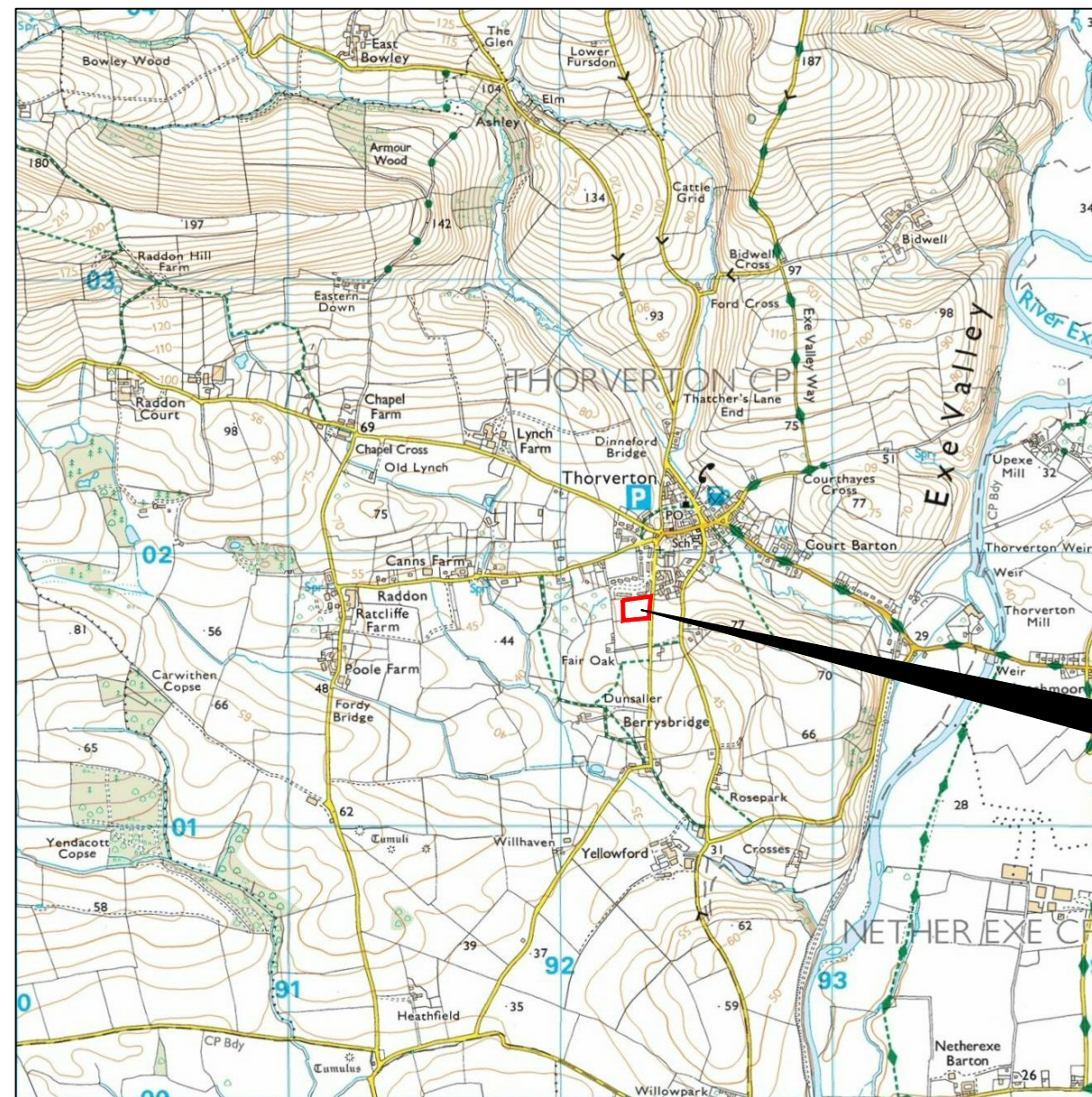

04
03
02
01
00



90 91 92 93 94

Amendments

Issue No.	Date	Description
-	-	-
-	-	-

© Stratascan Ltd - 2016



Site centred on NGR SS 922 018

Client
CgMs CONSULTING

Project Title Job No. 9625
GEOPHYSICAL SURVEY - THORVERTON, DEVON

Subject
LOCATION PLAN OF SURVEY AREA

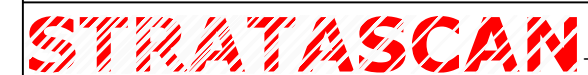

VINEYARD HOUSE T: 01684 592266
 UPTON UPON SEVERN E: info@stratascan.co.uk
 WR8 0SA www.stratascan.co.uk



SUMO GROUP MEMBER



Scale 1:25000
 0m 500m 1000m

Plot A3	Checked by DGE	Issue No. 01
Survey date MAR 16	Drawn by MU	Figure No. 01

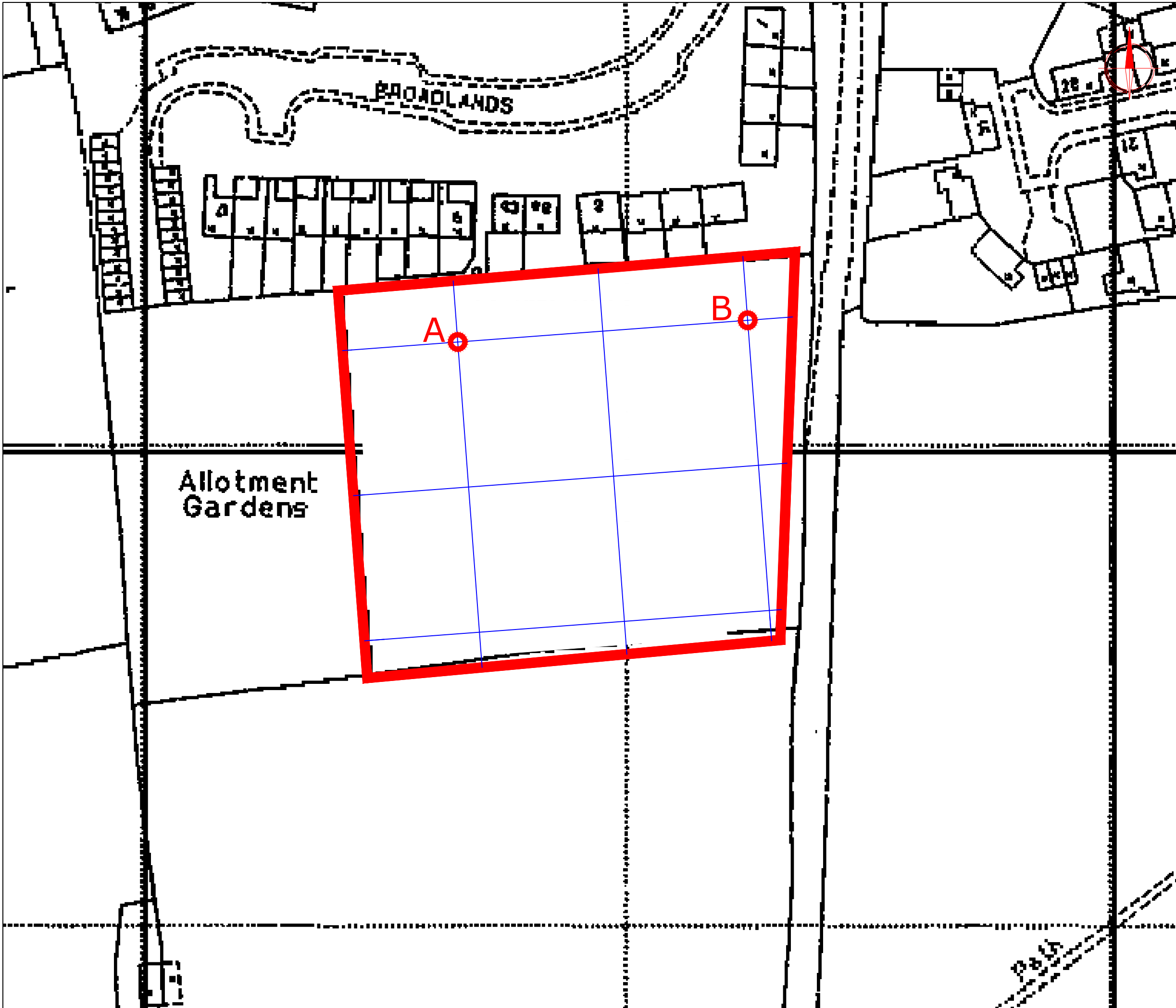

Amendments

Issue No.	Date	Description
-	-	-
-	-	-

© Stratascan Ltd - 2016

OS GRID REFERENCES

A	292264.97, 101822.85
B	292324.81, 101827.33

Client
CgMs CONSULTING

Project Title Job No. 9625
GEOPHYSICAL SURVEY - THORVERTON, DEVON

Subject
LOCATION OF SURVEY GRIDS AND REFERENCING



GEOPHYSICS FOR ARCHAEOLOGY AND ENGINEERING

VINEYARD HOUSE T: 01684 592266
UPTON UPON SEVERN E: info@stratascan.co.uk
WR8 0SA www.stratascan.co.uk



SUMO GROUP MEMBER



Scale **1:750**

Plot A3	Checked by DGE	Issue No. 01
Survey date MAR 16	Drawn by MU	Figure No. 02



Amendments

Issue No.	Date	Description
-	-	-
-	-	-

© Stratascan Ltd - 2016

Plotting parameters

Maximum +100nT (red)
Minimum -100nT (blue)

+100nT
+25nT
+3nT
-3nT
-25nT
-100nT

Client
CgMs CONSULTING

Project Title **GEOPHYSICAL SURVEY - THORVERTON, DEVON** Job No. 9625

Subject
COLOUR PLOT OF GRADIOMETER DATA SHOWING EXTREME VALUES

STRATASCAN™
GEOPHYSICS FOR ARCHAEOLOGY AND ENGINEERING
 VINEYARD HOUSE T: 01684 592266
 UPTON UPON SEVERN E: info@stratascan.co.uk
 WR8 0SA www.stratascan.co.uk

EUROPEAN GPR ASSOCIATION
SUMO SUMO GROUP MEMBER

Scale 1:750
 0m 5 15 30m

Plot A3	Checked by DGE	Issue No. 01
Survey date MAR 16	Drawn by RD	Figure No. 03

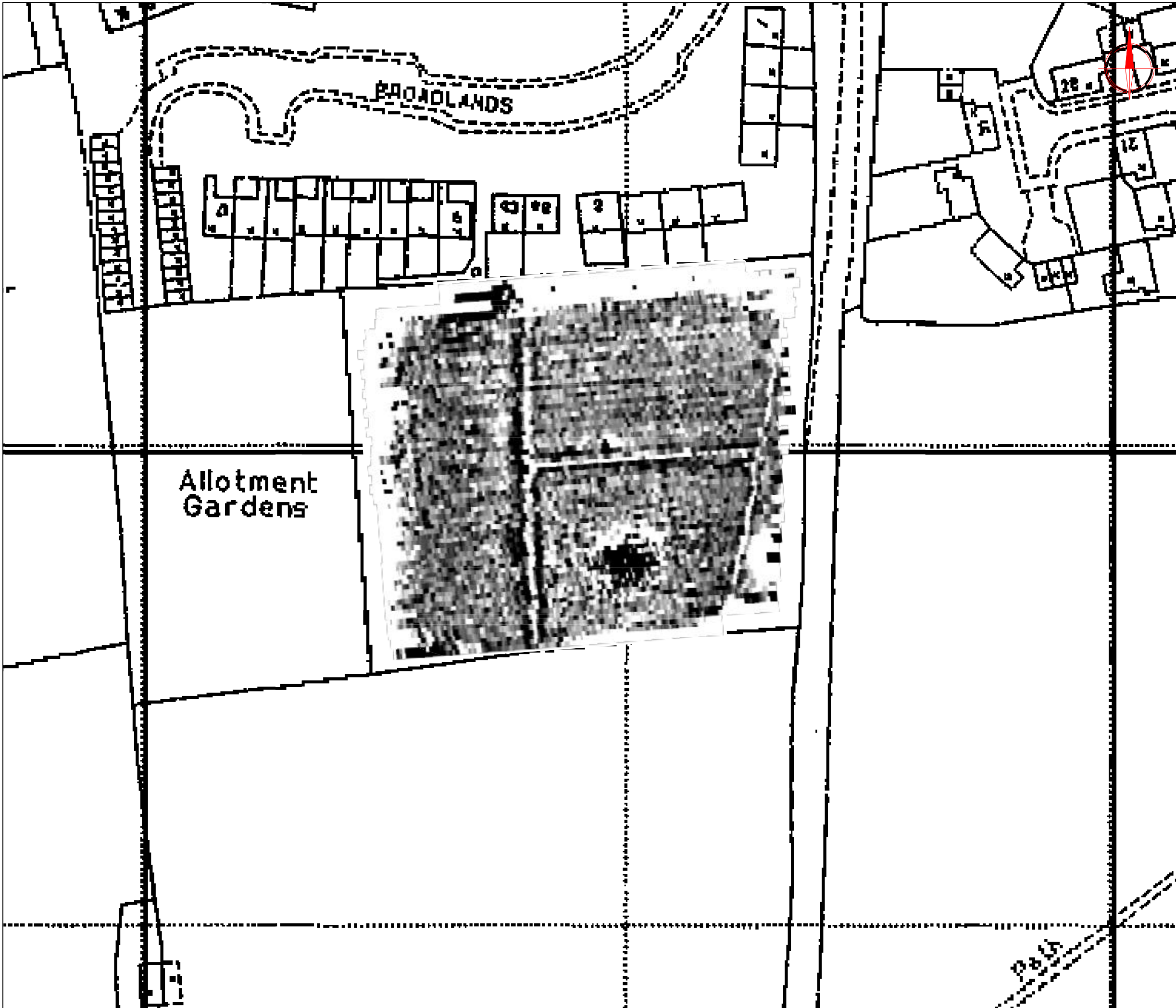

Amendments		
Issue No.	Date	Description
-	-	-
-	-	-
© Stratascan Ltd - 2016		

Plotting parameters	+2nT
Maximum +2nT (black)	
Minimum -2nT (white)	
Zero Mean -2nT +2nT -2nT	

Client	CgMs CONSULTING
--------	-----------------

Project Title	Job No. 9625
GEOPHYSICAL SURVEY - THORVERTON, DEVON	

Subject	PLOT OF MINIMALLY PROCESSED GRADIOMETER DATA
---------	--

STRATASCAN™
 GEOPHYSICS FOR ARCHAEOLOGY AND ENGINEERING

VINEYARD HOUSE T: 01684 592266
 UPTON UPON SEVERN E: info@stratascan.co.uk
 WR8 0SA www.stratascan.co.uk

SUMO GROUP MEMBER

Scale		
1:750		

Plot	Checked by	Issue No.
A3	DGE	01
Survey date	Drawn by	Figure No.
MAR 16	RD	04



Amendments		
Issue No.	Date	Description
-	-	-
-	-	-
© Stratascan Ltd - 2016		
PROBABLE ARCHAEOLOGY		
		Positive anomaly / weak positive anomaly - probable cut feature of archaeological origin
		Negative anomaly / weak negative anomaly - probable bank or earthwork of archaeological origin
POSSIBLE ARCHAEOLOGY		
		Positive anomaly / weak positive anomaly - possible cut feature of archaeological origin
		Negative anomaly / weak negative anomaly - possible bank or earthwork of archaeological origin
MEDIEVAL/POST-MEDIEVAL AGRICULTURE		
		Widely spaced curving parallel linear anomalies - probably related to ridge-and-furrow
		Closely spaced parallel linear anomalies - probably related to agricultural activity such as ploughing
		Linear anomaly - related to former trackway present on available mapping
		Linear anomaly - related to a former field boundary present on available mapping
OTHER ANOMALIES		
		Linear anomaly - probably related to pipe, cable or other modern service
		Linear anomaly - likely to be of modern origin, possibly related to footpath
		Magnetic disturbance associated with nearby metal object such as service or field boundary
		Strong magnetic debris - uncertain origin, likely modern
		Scattered magnetic debris
		Area of amorphous magnetic variation - probable natural (e.g. geological or pedological) origin
		Magnetic spike - probable ferrous object
Client		
CgMs CONSULTING		
Project Title		Job No. 9625
GEOPHYSICAL SURVEY - THORVERTON, DEVON		
Subject		
ABSTRACTION AND INTERPRETATION OF GRADIOMETER ANOMALIES		
STRATASCAN™		
GEOPHYSICS FOR ARCHAEOLOGY AND ENGINEERING		
VINEYARD HOUSE		T: 01684 592266
UPTON UPON SEVERN	E: info@stratascan.co.uk	
WR8 0SA	www.stratascan.co.uk	
Scale		
1:750		
Plot	Checked by	Issue No.
A3	DGE	01
Survey date	Drawn by	Figure No.
MAR 16	RD	05