

CFA Archaeology Ltd

archaeological consultants

Advice on Archaeology & Planning

Environmental Impact Assessment

Intpretation, Design & Display

Finds/ Environmental Analysis

Field Evaluation & Excavation

Historic Building Recording

Site & Landscape Survey

Geophysical Survey

**3 Smeaton Grove
Inveresk, Musselburgh
East Lothian**

Archaeological Watching Brief

Report No. 1882

CFA ARCHAEOLOGY LTD

The Old Engine House
Eskmills Business Park
Musselburgh
East Lothian
EH21 7PQ

Tel: 0131 273 4380
Fax: 0131 273 4381
email: info@cfa-archaeology.co.uk
web: www.cfa-archaeology.co.uk

Author	Bruce Glendinning BSc PgDip MifA
Illustrator	Graeme Carruthers MA MAAIS
Editor	Melanie Johnson MA PhD FSA Scot MifA
Commissioned by	Mr and Mrs Caughey
Date issued	April 2011
Version	0
OASIS Reference	cfaarcha1-100067
Planning Application No	07/00668/FUL
Grid Ref	NT 3495 7150

This document has been prepared in accordance with CFA Archaeology Ltd
standard operating procedures.

**3 Smeaton Grove
Inveresk, Musselburgh
East Lothian**

Archaeological Watching Brief

Report No. 1882

CONTENTS

1.	Introduction	3
2.	Working Methods	4
3.	Archaeological Results	4
4.	Conclusion	5
5.	References	5

Appendices

1.	Photographic Register	6
----	-----------------------	---

Illustrations (bound at rear)

Fig. 1	Site location map and trench plan
Fig. 2	Service Trench looking North-west
Fig. 3	Service Trench looking South-east

1. INTRODUCTION

1.1 General

- 1.1.1 This report presents the results of an archaeological watching brief by CFA Archaeology Ltd (CFA) in March and April 2011 at 3 Smeaton Grove, Inveresk, Musselburgh, East Lothian (NGR: NT 3495 7150) (Fig. 1). The work was commissioned by Mr and Mrs Caughey and was undertaken during the insertion of services to the house plots. This represents the final phase of a programme of archaeological works to be undertaken on this site by the client with reference to planning application Number 07/00668/FUL. Further phases of work may be required by individual householders with reference to this planning application or subsequent planning applications made on the site.
- 1.1.2 A Written Scheme of Investigation (WSI) dated 01 July 2010 for this programme of works was produced by CFA on behalf of Mr and Mrs Caughey. The WSI was designed to meet the requirements of the East Lothian Council Archaeology Officer.
- 1.1.3 The site has been split up into five areas (Area 1 – Area 5) (Fig. 1). This report presents the results from the insertion of services through Areas 3, 4 & 5. The findings from a pre-determination evaluation are contained within CFA Report No. 1416 (Hill 2007). A later phase of evaluation and watching brief was undertaken when the house that was present on the site was demolished. This affected Area 5 and is reported on in (Kirby 2010). This report should be read in conjunction with the two aforementioned documents.

1.2 Background

- 1.2.1 Planning consent (Ref No. 07/00668/FUL) has been granted for the construction of three dwelling houses, a garage and access on the site of 3 Smeaton Grove, Eskbank, Musselburgh. The planning consent was subject to a condition requiring a programme of archaeological works.
- 1.2.2 The proposed development area is located on the south side of Smeaton Grove and lies c.50m to the west of the scheduled area associated with Pinkiehill Roman field system (SAM No. 3611). Other archaeological remains identified within the area include Mortonhall Junction Roman camps and prehistoric settlement (SAM No. 3610). This group of sites includes a Bronze Age Cursus monument.
- 1.2.5 A pre-determination archive assessment and evaluation undertaken by CFA in November 2007 (Hill 2007) (Fig. 1) identified archaeological remains from the Roman period. It identified the remains of two ditches potentially of Roman date, three apparently linear features which are undated, two pits of unknown date, and a modern feature containing building debris. Pottery of Roman date was found in the two ditches and in the topsoil. These ditches may be boundary ditches associated with nearby Roman field systems.

- 1.2.6 A programme of further fieldwork was required during and after the demolition of the house that previously occupied the site (Kirby 2010). The watching brief was undertaken during the grubbing up of the foundations of the building and an evaluation was undertaken within Area 5. A large pit containing two sherds of Roman period pottery was identified. The pottery was comparatively unabraded suggesting that it was deposited shortly after breakage. The pit is likely to have been a borrow-pit for the quarrying of the sandy gravel subsoil within this area.

1.3 Objectives

- 1.3.1 The objectives of the project are to establish the presence/absence, extent, condition, character, quality and date of any archaeological features or deposits within the proposed development area; to establish their vulnerability to the proposed development; and to propose mitigation measures.

2. WORKING METHODS

2.1 General

- 2.1.1 CFA Archaeology Ltd follows the Institute for Archaeologists' Code of Conduct, Standards and Guidance.

2.2 Watching Brief

- 2.2.1 The terms of the WSI required a watching brief during insertion of services (Fig 1). Excavation was undertaken with a 360⁰ mini excavator fitted with a smooth ditching bucket. The gas services (Figs 2-3) were inserted in March and the water and drainage in April. Each was set in a separate track running adjacent to each other. Electrical services have still to be laid but will be in the side of the drainage and water track so in already disturbed ground.

3. ARCHAEOLOGICAL RESULTS

3.1 Watching Brief

- 3.1.1 The service tracks were stripped of topsoil and subsoil down to the clean undisturbed natural gravel. The gas pipe track and the connection tails for water and drainage were 0.4m wide and the main water and drainage track was 0.9m wide. Across most of the site Topsoil lay over a well developed reddish brown agricultural subsoil which lay over natural gravels. Combined depths of topsoil and subsoil ranged between 0.6m and 0.8m.
- 3.1.2 No features of archaeological significance were identified. No finds were recovered.

4. CONCLUSIONS

- 4.1 No archaeological features or finds were identified during the insertion of the services. No further excavation of undisturbed areas (that require monitoring) will be undertaken by the client. The access road will be constructed using a “no dig” cellular confinement system.
- 4.2 The project archive, comprising all CFA record sheets, maps and reports, will be deposited with the National Monuments Record of Scotland (NMRS) and copies of reports will be lodged with the East Lothian Council Sites and Monuments Record.
- 4.3 A summary statement will be submitted for publication in *Discovery and Excavation in Scotland* and the project will also be reported on through *OASIS Scotland*.

5. REFERENCES

Hill, I (2007) *3 Smeaton Grove, Inveresk, Musselburgh: Archaeological Desk-Based Assessment and Evaluation*. CFA Data Structure Report No 1416.

Kirby, M (2010) *Area 5, 3 Smeaton Grove, Inveresk, Musselburgh, East Lothian: Archaeological Works* CFA Data Structure Report No. 1798.

APPENDIX 1: Photographic Register

Digital

Shot	Description	Facing	Conditions
1	Post ex of gas pipe service trench	NW	Sun
1	Detail of gas pipe service trench base and SW facing section showing topsoil depth	SW	Sun
3	Post ex of gas pipe service trench	NE	Sun
4	Detail of gas pipe service trench base and NW facing section showing topsoil depth	NW	Sun
5	Post ex of gas pipe service trench	SW	Sun
6	Gas pipe service trench running out of site entrance	N	Sun
7	Gas pipe service trench from site entrance	S	Sun
8-9	Post-ex of Water and sewer trench	SW	Sun
10-11	Post-ex of Water and sewer trench	SW	Sun
12-13	Post-ex of Water and sewer trench	NW	Sun
14-15	Post-ex of Water and sewer trench	NW	Sun
16-17	Post-ex of Water and sewer trench	NW	Sun
18	Post-ex of Water and sewer trench	SE	Sun



IFA-registered archaeological organisation

Key:

- Evaluation trenches
- Archaeological features
- Service trench monitored under watching brief (2011)

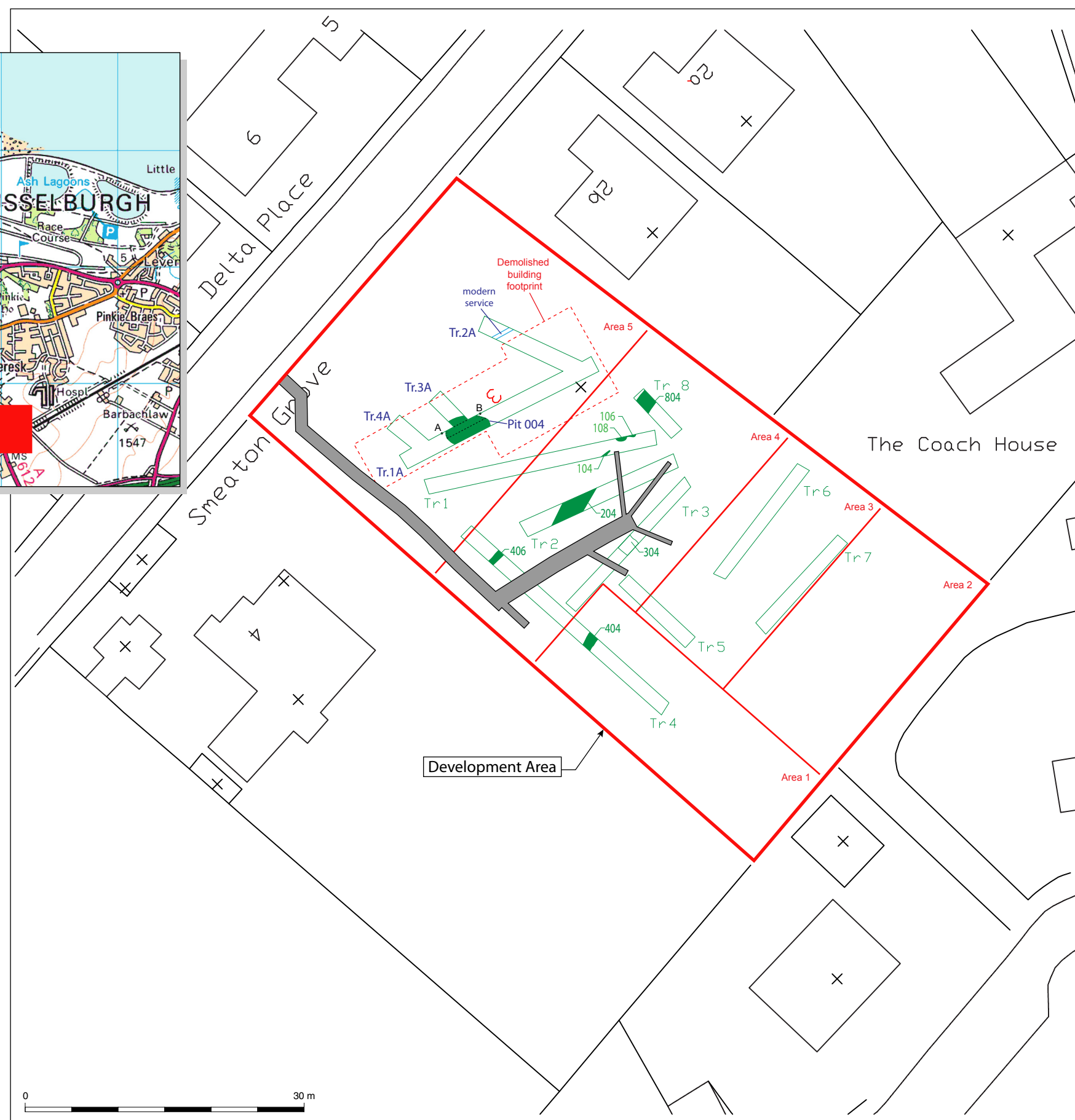

CFA ARCHAEOLOGY LTD
The Old Engine House
Eskmills Park
Musselburgh
East Lothian, EH21 7PQ
t: 0131 273 4380
f: 0131 273 4381
e: info@cfa-archaeology.co.uk
w: www.cfa-archaeology.co.uk

Fig. No: 1	Revision: A
------------	-------------

Title:
Site Location Map

Project:
Smeaton Grove Watching Brief - Inveresk.

Scale:
1:500 @ A3

Client:
Mr and Mrs Caughey

Drawn by: GC	Report No: 1882
--------------	-----------------



Fig. 2
Service trench looking
north-west



Fig. 3 - Service trench looking south-east

Key:	Fig. No:	2-3	Revision:		Client:	Mr and Mrs Caughey		 <div>CFA ARCHAEOLOGY LTD The Old Engine House Eskmills Park Musselburgh East Lothian, EH21 7PQ t: 0131 273 4380 f: 0131 273 4381 e: info@cfa-archaeology.co.uk w: www.cfa-archaeology.co.uk</div>	
	Title:								
	Project:								
Scale:		Smeaton Grove Watching Brief - Inveresk.							
		Drawn by:			GC		Page No:	Report No:	1882