

# CFA Archaeology Ltd

*archaeological consultants*

*Advice on Archaeology & Planning*

*Environmental Impact Assessment*

*Interpretation, Design & Display*

*Finds/ Environmental Analysis*

*Field Evaluation & Excavation*

*Historic Building Recording*

*Site & Landscape Survey*

*Geophysical Survey*

## **Abbotsford House, Melrose, Scottish Borders**

### **Architectural recording and archaeological Watching brief**

**Report No. 2135**

## **CFA ARCHAEOLOGY LTD**

The Old Engine House  
Eskmills Business Park  
Musselburgh  
East Lothian  
EH21 7PQ

Tel: 0131 273 4380  
Fax: 0131 273 4381  
email: [info@cfa-archaeology.co.uk](mailto:info@cfa-archaeology.co.uk)  
web: [www.cfa-archaeology.co.uk](http://www.cfa-archaeology.co.uk)

Author	Michael Cressey BA MSc PhD FSA Scot MIFA
Illustrator	Leeanne Whitelaw BSc MifA
Editor	Bruce Glendinning Bsc PgDip MifA
Commissioned by	LDN Architects LLP <i>per</i> The Abbotsford Trust
Date issued	November 2012
Version	0
OASIS Reference	cfaarcha1-137361
Planning Ref No.	10/00720/FUL
Grid Ref	NT 50815 34266

This document has been prepared in accordance with CFA Archaeology Ltd standard operating procedures.

**Abbotsford House,  
Melrose, Scottish Borders**

**Architectural recording  
and archaeological  
Watching brief**

**Report No. 2135**

## CONTENTS

1.	Introduction	4
2.	Methodology	6
3.	Building Survey Results	8
4.	Watching Brief Results	12
5.	Discussion	13
6.	Conclusion	14
7.	References	14

## Appendices

1.	Photograph Register	15
2	DES Entry	17

## List of Figures (bound at rear)

1.	General location map
2a	Ground floor plan showing areas of intervention and areas monitored
2b	Ground floor plan showing areas of intervention and areas monitored
2c	First floor plan showing areas of intervention and areas monitored
2d-e	Areas monitored- Gas pipe and water pipe
3	Stores/wash house boiler stance
4a	Plan of the Ice House and passage, and Game Larder roof section location
4b	Section drawing of the capping material above the Game Larder roof (Section A-B)
4c	Profile drawing of the Ice House passage roof (Section D-C)
5	Photo location plan of the walled gardens

## List of Plates (bound at rear)

1	Basement corridor in area B.48 showing flagstones in situ prior to removal
2	Basement corridor in area B.17 showing flagstones in situ prior to removal
3	Basement corridor area B.48, exposed wall foundations recorded during underpinning work
4	Basement corridor area B.48, close-up of exposed wall fabric
5	Basement corridor area B.17, general shot of exposed culvert
6	Basement corridor, area B.17 detailed shot of the culvert
7	Hall B.38, exposed well with modern capping material
8	Hall B.38, vertical photograph looking down the well
9	Storeroom B.28, general view of the boiler foundations
10	Storeroom B.28, general shot of the interior fireboxes

- 11 Storeroom B.28, general shot of the blocked opening on the south-west wall
- 12 Store B.35 general view of the cobble floor and central drain
- 13 Store B.35 general view of the cobble floor
- 14 Room G.14 showing the fireproof cupboard in the corner of the room
- 15 Room G.14 showing the cast-iron four paneled door
- 16 Room G.14 showing stone shelf detail
- 17 Room G.14 showing lock plate on the rear of the door
- 18 Room G.14 showing the arched brickwork on the cupboard interior
- 19 Room G.14 showing the arched brickwork
- 20 Room G.14 showing a cross-section of a fireproof brick taken from the cupboard
- 21 Library G.07 showing the exposed floor-joists exposed during refurbishment work
- 22 Room F.21, exposed cast-iron beam at the base of the wall
- 23 Ice house passage roof exposed prior to conservation work
- 24 Lead sheets covering the roof of ice house and game larder
- 25 Game larder roof inspection trench within the domed interior of the parapet
- 26 Game larder roof construction material exposed in section
- 27 Kitchen garden wall entrance and wall detail
- 28 Kitchen garden wall showing poor condition of the brickwork
- 29 Water pipe trench leading to Abbotsford House
- 30 Water pipe trench leading to Abbotsford House
- 31 Gas pipe trench on the north side of Abbotsford House, general view looking east
- 32 Gas pipe on the north side of Abbotsford House showing in-situ box-drain
- 33 Gas pipe trench through the gardeners' path, general shot showing the route
- 34 Gas pipe trench through the gardeners' path, general shot of the hypocaust flue
- 35 Gas pipe trench through the gardeners' path, interior of the hypocaust flue

CD Photographic Folders 1-9



## **1. INTRODUCTION**

### **1.1 General**

This report presents the results of Level 1-2 building recording work and watching briefs carried out by CFA Archaeology Ltd between December 2011 and August 2012 at Abbotsford House, Abbotsford, Melrose, Scottish Borders (NGR: NT 5105 3434) (Fig. 1). The work was commissioned by LDN Architects LLP (LDN) on behalf of The Abbotsford Trust.

A Written Scheme of Investigation (WSI) dated 25 May 2011 was produced by CFA on behalf of LDN Architects. The WSI was designed to fulfil the requirements of the Scottish Borders Council Archaeologist.

### **1.2 Background**

Abbotsford House is a Grade A-Listed building is an amalgam of many additions and phases which combine to create an irregular layout plan in which identifiable Baronial elements include steeply pitched roofs, turrets, bartizans, and crowstepped gables associated with Scottish castles and fortified houses (RCAHMS Site No. NT53SW 41). In various parts of the building's fabric there is an eclectic mix of curiosities from historical structures, such as the doorway of the old Tollbooth in Edinburgh.

A programme of archaeological strip map and sampling was undertaken during the groundworks associated with the construction of a new car park and Visitor Reception Building on land to the north-east of Abbotsford House. Nothing of archaeological significance was identified (Savory, 2011).

A programme of internal and external renovations to the house were also undertaken and this programme of work also included the insertion of a number of new services. The Borders Council Archaeologist was keen to ensure that these works were adequately recorded. In order to achieve an adequate archaeological response to the refurbishment works a series of targeted watching briefs and architectural recording survey visits were required. At the start of the project the full extent of the relative impact of the refurbishment works was unknown but a flexible phased-approach was adopted requiring close liaison with the Main Contractor (M. J. Ballantyne Ltd), the Project Architect (LDN) and Project Engineer (Elliot and Co) in order to ensure that certain areas affected by the refurbishment works were adequately recorded according to the prescribed recording levels described in the WSI. Regular weekly updates were held between CFA and the Principal Contractor to ensure no significant detail was lost.

The scope of refurbishment works defined in the Project Outline included:

- Repairs to the exterior fabric, both walls and roofs. This involved indenting, replacement flat roofs, re-slatting selective areas, rebuild of a dormer and certain chimney stacks.
- Alterations to the exterior fabric to form new doorways at basement level within the Hope-Scott inner courtyard.
- External fabric repairs over the Game Larder and Ice House

- Full services replacement including the installation of a sprinkler system.
- Uplift of the majority of the basement floors to create a service trench within the main corridor, service feeds in general within rooms, new floor finishes within the House Manager's accommodation and holiday let accommodation.
- Removal of wall, ceiling and a floor at ground floor level within the House Manager's accommodation and holiday let accommodation immediately above.
- Uplift of floorboards to accommodate the services installation, mainly within the first and second floors.
- Replacement and new bathrooms to the holiday let accommodation.
- Soft strip in general.
- Redecoration of the interior
- Hard and soft landscaping works

### **1.3 Objectives**

The objectives of the archaeological work were:

- To carry out Level 1 and 2 targeted building recording surveys during structural alterations to Abbotsford House and provide a report on those works.
- To conduct a programme of targeted archaeological watching briefs to monitor the installation of services both within and close to Abbotsford House.

## 2. METHODOLOGY

### 2.1 General

CFA followed the Institute for Archaeologist's Code of Conduct, Standards and Guidelines as appropriate.

### 2.2 Desk-based Survey

A desk-based survey was not required as the history and chronological development of Abbotsford House has been comprehensively described and illustrated in the Conservation management Plan produced by LDN (2008).

### 2.3 Architectural recording

Architectural detail recording followed the recommendations outlined in Section 5 *Metric Survey: Standard Specification for an Architectural Survey* (English Heritage 2000).

A Level 1-2 standing building survey, as defined by English Heritage (2006), was carried out and was confined to archaeological drawing (both scaled and sketch recording). Measurements were obtained using tapes and hand-held distometer. All areas recorded were plotted to scale onto the architectural floor plans as appropriate. Standard pro-forma building recording sheets were also completed as appropriate. The key areas subjected to building recording survey (Figs 2a-c) and archaeological watching briefs (Figs 2d-e) are listed in Table 1. The numbers in parentheses are location reference numbers shown on the floor plans. The CFA ID numbers are also shown on the floor plans and indicate the locations of the work that was undertaken.

CFA ID	LDN Room Code	Area of work	Description
<i>Building Recording</i>			
1	Basement Corridor (B.13 and B17)	Service trench and wall underpinning work	Recording exposed sections within a service trench during underpinning work
2	Basement (B.23)	Store room floor reduction	Photographic recording prior to the removal of the existing cobble floor
3	Stores/washhouse ( B.31)	Storeroom floor reduction exposing boiler foundations	Recording a boiler firebox prior to its removal
4	Stores/washhouse (B.31)	Wall stripping exposing blocked opening	Recording prior to wall lining
5	Basement passage (B.21)	Flagstone removal exposing a well	Recording prior to covering
6	Butler's Pantry (G.14)	Fireproof cupboard removal	Recording prior to removal
7	Library (G.07)	Floor uplift for electrical service installation	Photographic record of exposed floor joists
8	Dressing Room (F.21)	Wall opening for electrical service exposing a cast-iron	Recording during exposure

		beam	
9	Game larder	Vaulted passage refurbishment	Feature recording prior to damp course installation
10	Kitchen garden	Main elevations undergoing fabric repair	Photographic survey prior to repair work
<i>Watching Briefs</i>			
11	Gardeners pathway	Gas pipe installation along the garden path	Monitoring during excavation
12	North-west terrace	Water pipe installation through terraces	Monitoring during excavation
13	Service trench	Water main from B6360 road to Main House	Monitoring during excavation

Table 1 Key areas subjected to building recording and archaeological watching briefs.

## 2.4 Photographic recording

Photographic recording was carried out using Nikon D300 digital camera. Photographs were taken under natural and artificially lit conditions including flash photography. A comprehensive photographic survey was carried out on the Kitchen and East Court walled gardens. A photographic record is included in Appendix 1.

### **3. BUILDING SURVEY RESULTS**

#### **3.1 General**

For ease of description, architectural features are described succinctly as either individual features or as groups of features identified in Table 1. The position of the features are shown on their respective floor plans alongside a numerical location identifier.

#### **3.2 Basement recording**

##### *Introduction*

The principal work carried out in the basement corridor included pre-alteration photography of parts of the existing corridor floor and monitoring the excavation of a service trench and excavations for underpinning work. A series of hand dug slots starting from the north-east end of the corridor in Reception Hall B.01 through to Store B.21 were examined. Recording work was also carried out on a well found in Hall B.38 and the foundations of a boiler in Storeroom B.28. A cobble floor was recorded in Store B.35.

##### *Existing basement floor (Fig 2a, Plates 1-2)*

Prior to the construction of the service trench and underpinning work areas of existing floor surfaces considered to be of interest were photographed. In Corridor B.05 a cement screed over flagstones was recorded. Further along the main corridor leading off Corridor B.05 was an area of flagstone flooring covered by a cement screed that was on average 0.4m wide. From here along to Passage B.48 a patchwork of flagstone, concrete and cement formed the floor. Flagstones also formed the floor of Passage B.48. A series of steps marked the position in the change of floor height into Corridor B.17 which was covered in irregular flagstones for a distance of approximately 20m to Staircase B.26. The flagstone floor continued to the rear doorway within Lobby B.27.

##### *Service and wall-underpinning slots (Fig 2a, Plates 3-6)*

The service trench was constructed in a series of short hand dug slots approximately 3.5m in length along the basement corridors. An assessment of the slots dug at the north-east end of the basement corridor confirmed that natural fluvioglacial sands and gravels lay directly under the corridor floor.

A slot dug in Corridor B.17 measured 3.4m by 0.7m and was dug to a depth of 0.7m. In the exposed south-west facing section two floor layers were present. The first was a layer of concrete measuring 0.15m thick overlay a layer of lime mortar that was 0.05m thick. This layer had been laid on top of natural deposits comprising fluvioglacial gravel which included sub-rounded boulders and pebbles that were present throughout the length of the basement corridor.

A slot dug in Corridor B.18 measured 3.5m and 1.2m wide with a depth of 0.75m. At a distance of 1.3m from the south west end of the slot a section of wall measuring

0.5m by 0.58m was exposed in the section. The wall was constructed of rough-dressed blocks of sandstone bonded with lime mortar. Below the wall was a layer of cobbles set edge on and may have represented the vestigial remains of a cobble floor.

A slot dug against the wall of Store B.24 measured 1.7m long and 1.2m wide. At a depth of 0.5m a box drain was recorded. The drain was 0.27m wide comprising a series of heavily mortared side stones. A single capstone was still in place which had been mortared onto the side stones.

#### *Well in Hall B.38 (Fig 2a, Plates 7-8)*

During the removal of the flagstone floor in Hall B.38 a well measuring 0.75m in diameter and 4.7m deep was found directly underneath the flagstones. The well had been capped recently (c.1980s) by a mixture of brick and cement. The well was constructed of dry stone sub-rounded and rectangular stone. At approximately 1.5m from the top of the well were two wooden planks. A lead pipe with a diameter of c.0.05m had been inserted into the well. The pipe had been bent in order for it to run under the floor. It is presumed that the pipe ran under Staircase B.40 through to the Boiler house B.37.

#### *Boiler foundations in B.28 Store/Workshop (Figs 2a & 3, Plates 9-10)*

During the removal of the flagstone floor in the Store/Workshop B.28 the remains of the foundations for a domestic boiler were exposed in the south-east corner of the room (Fig 3). The feature comprised two brick-lined fire-boxes aligned east-west divided by a central section of brickwork with a combined measurement of 1.56m in length and 0.42m in width and 0.26m deep. The bricks measured 9 by 4½ inches and were laid in a crude stretcher bond. The interior of the boxes contained soot, cinder and fragments of coal. It is presumed that the foundations rose to about waist height and supported a cast-iron cauldron that would have been heated by coal to provide hot water suggesting that this may have been a washhouse.

#### *Blocked opening in B.28 Store/Workshop (Fig 2a, Plate 11)*

Following the stripping of the walls within the Store/Workshop (B.28) a blocked opening was recorded. The opening was situated on the south-west wall flanking the staircase B.33. The opening measured 2.3m high and 1m wide and 0.15m deep with a timber lintel above. The blocking work comprised crude sub-angular rubble bonded with lime mortar. The sides of the opening were slightly curved. It seems probable that the opening could have been a cupboard as it appeared too tall to be a doorway.

#### *Cobbled floor in Store B.35 (Fig 2a Plates 12-13)*

Store B.35 situated on the south-west side of the house complex was to be converted into a plant room requiring a new concrete floor to be laid over an existing cobble floor. The storeroom measured 5.9m by 4.8m and 2.7m high walls surmounted by a jack-arched ceiling supported by cast-iron plates. The sloping cobble floor flanked a central drain that had been constructed of individual blocks of sandstone measuring 0.40m by 0.20m. The central drain ran to a circular drain about 1m from the doorway.

### **3.3 Ground floor recording**

Feature recording on the ground floor included a fire-proof cupboard in Room G.14 and floor-joist in the Library G.07 and Drawing Room G.08.

#### *Fireproof Cupboard in Kitchen G.14 (Fig 2b, Plates 14-20)*

A fireproof cupboard was recorded prior to its removal. The cupboard was situated within the north-west corner of Room G.14. It measured 1.9m high by 1m wide and 0.74m deep. The interior of the cupboard was lined with white glazed bricks. Three sandstone shelves each 0.06m thick occupied the interior of the cupboard. The floor was covered with square terracotta tiles. Twenty eight courses of white glazed brick laid in stretcher bond had been used to form the wall surrounding the door. The wall head had a sloping profile which matched the combed ceiling. The cast-iron cream-painted door was 25mm thick and was hinged by two spigots situated on the left hand side of the door (facing). The door had four panels with a single key hole on the lock rail. The back of the door was flush with a large rectangular plate attached to it by rivets.

#### *Wooden floor joists in the Library G.07 (Fig 2b, Plate 21)*

During the refurbishment works a series of floor-joists were exposed in the Library (G.07). The wooden joists measured 0.17m thick and 0.06m wide and 0.27m apart. The joists ran the full width of each room. A series of square notches had been cut into the joists to carry electric cables. The pine tongue-and-grooved floorboards measured 0.11m wide and 0.025m thick.

### **3.4 First Floor recording**

#### *Metal beam in Room F.21 (Fig 2c, Plate 22)*

A cast-iron bressumer beam was partially exposed at the base of the south-east facing wall during electrical service installation. The beam was not fully exposed in order to limit the impact on the historical wall paper that adorned the room. The beam was visible for a length of 1.7m in a 0.1m gap between the wall and the floor level. The load-bearing beam had been installed to support the wall above the ground floor dining room (Peter Elliot pers comm) possibly as part of Scott's refurbishment of Abbotsford in the 1820s.

### **3.5 External architectural feature recording**

The Game Larder was designed by the Architect William Burn and constructed for Charlotte and James Hope-Scott in the early 1850's (it is dated 1851). It incorporates an earlier Ice House built for Sir Walter Scott circa 1820 (CMP). Access from the house to the Game Larder and Ice House is down a flight of stone steps and an inclined underground corridor with barrel-vaulted roof (Fig 4a).

*Ice house passage roof (Figs 4a & 4c, Plates 23-24)*

The vaulted roof was exposed by the contractor in order to carry out conservation work. The roof was exposed in a trench measuring 10.8m long and 2.5m wide running from the north elevation of Abbotsford House and terminating at the lead roof of the Ice House and Game Larder. The width of the passage roof measured 2.25m. The crest of the passage was approximately 0.25m below the ground level and the sides of the passage were 0.95m deep. A thick layer of mortar sealed the brickwork of the roof. Examination of the trench sections confirmed that fluvioglacial gravel was present immediately below the turf line and this material had been used to backfill the construction trench for the passage. The edges of the construction trench lay outside the excavations undertaken by the contractor.

*Game Larder roof (Figs 4a & 4b Plates 25-26)*

A small inspection trench measuring 1.63m long and 0.5m wide was dug by the Contractor into the roof of the Game Larder to establish the nature of its construction. The sections of the trench were hand cleaned and recorded.

A concrete capping layer 0.1m thick formed the domed roof of the Game Larder. The concrete overlay a layer of gravel towards the top of the dome. A small retaining wall of five bricks bonded with lime mortar was present on the south side of the slot. The brickwork revetted a layer of medium sized sub-angular blocks of sandstone within a mixture of rubble. The rubble sealed a thin layer of cement that had been used to seal the domed roof that was a brick-built using half bricks bonded with lime mortar.

*Kitchen Garden wall (Fig 5, Plates 27-28)*

The works on the garden walls focused on the retention of the maximum amount of original material. Prior to the repair work a survey was carried out to provide a photographic record of the walls. Figure 5 shows the orientation of the photographs taken.

The Kitchen Garden walls are believed to date from Scott's refurbishment and are constructed of red brick laid in English Garden bond (12:1) with sandstone coping stones. The wall between the East Court and the kitchen garden is likely to be the earlier (c.1812) and is stone built, with both faces being exposed rubblework. To the north end a flue is evident and is likely to be associated with the former glasshouses in the north-east corner.



## 4. WATCHING BRIEF RESULTS

### 4.1 Introduction

Three areas were monitored as part of the archaeological watching brief. These included the installation of a mains water pipe leading from the B6360 on the south-west side of Abbotsford House. A second water pipe trench was monitored along and through the terrace on the north side of the house. A gas pipe trench was also monitored along the length of the gardener's path on the north side of the East Court and Kitchen walled gardens.

#### *Water pipe trench from the B6360 to Abbotsford House (Fig 2d, Plates 29-30)*

Approximately 50m of the water main service trench leading north from the B6360 to Abbotsford House was monitored. The trench was dug to a depth of 1m and 0.6m wide. Throughout its length the soils comprised fluvioglacial orange-brown clays with bands of sub-rounded boulders, gravel and shingle. No archaeological features were recorded.

#### *Gas pipe trench on the north side of Abbotsford House and Gardeners Path (Figs 2d-e, Plates 31-35)*

A c.56m long gas pipe trench measuring on average 0.35m wide and 0.75m deep and was excavated along the base of the lower terrace on the north side of Abbotsford House (Plate 31). The trench sections contained turf and topsoil to a depth of 0.10m below which was a mixed layer of fluvioglacial sands and clays. Approximately 20m from where the trench turned south towards Abbotsford House, a small box-culvert was recorded. The culvert comprised side-stones of boulders laid on top of each other and capped by a thin slab of sandstone. The sections exposed through the lower and upper terrace confirmed that these were constructed of clay and fluvioglacial gravel.

A trench for a gas pipe was dug through the gardener's path (Plate 33) on the north side of the East Court walled garden (Fig). The trench measured c.40m in length and was 0.5m wide and 0.5m deep. A stone-lined hypocaust flue that was exposed in section close to the bothy yard (Plate 34). The flue measured 0.44m by 0.34m and contained boulder side stones on its west side and brick on its east side. The side stones were capped with a slab of sandstone set at an angle of about 40 degrees (Plate 35). The flue was trending in the direction of the East Court garden and it is assumed that this provided heat to one of the vinery greenhouses built against the south-facing wall of the East Court garden.

## **5. DISCUSSION**

### **5.1 Basement recording**

The recording work carried out within the basement corridors and other areas provided an opportunity to record previously unrecorded features including the well recorded in Passage 21c and the washhouse boiler foundations in Room B.31. It is difficult to predict the age of the well but it may have been associated with the early period of the sites history when the site was occupied by a farmstead named *Cartleyhole* in 1812 (CMP). However, it may have been constructed as part of the house to function in support of the nearby boiler house. In the absence of any dating material (glass/pottery etc) it is difficult to predict the age of the fragment of wall found within the slot dug in Corridor B.17. Again this feature may relate to a wall associated with one of the early farm buildings.

The boiler foundations and blocked opening within the former washhouse (B.31) are again difficult to date. Judging by the bricks the boiler foundations date to the late 19<sup>th</sup> or early 20<sup>th</sup> century. The blocked feature relating to a cupboard within the same room is of unknown date but it is probably contemporary with the rooms use as a washhouse.

The cobble floor recorded within Store B.23 is typical of a basement storage room that potentially required drainage as it was below ground level.

### **5.2 Ground and First Floor Recording**

The recording work carried out on the ground floor was confined to recording the fireproof cupboard prior to its removal from Room G.14 which was also known as the 'Butler's Pantry'. It was often common in high status houses for the head butler to have sole responsibility for the house silver (Muthesius, 1904). It is suggested that the fireproof cupboard provided the security for Abbotsford's silver ware. Room G1 is very close to the Breakfast Room (G.13) and the Dining Room (G.08) which is just along the main corridor and thus supports this theory.

The recent refurbishment work carried out in the Dressing Room (F.17) formerly an old bedroom revealed the presence of a cast-iron bressumer beam which was only visible within a short section of the wall above the skirting board. The use of cast-iron beams in domestic architecture is rare in Scotland (Peter Elliot pers comm.). The beam was probably inserted when Sir Walter Scott refurbished Abbotsford in the 1820s.

### **5.3 Exterior recording**

The vaulted passage leading to the ice house was found to be overlain by fluvioglacial deposits that had been used to backfill the passage roof to a depth of 0.25m. A profile of the roof shows that it was barrel vaulted.

The small trench cut into the game-larder roof confirmed that that roof was overlain by rubble contained by brickwork and capped with concrete.

## 5.4 Watching Briefs

The watching briefs carried out to monitor the service trenches identified limited archaeological remains which included the hypocaust feature recorded in the trench through the gardener's path on the north side of the East Court garden. It is possible that the hypocaust was installed between 1822 and 1824 when the formal East Court walled garden was created by Sir Walter Scott over an earlier 1812 walled garden (CMP). The East Court vinery glasshouses (now demolished) were heated from the former Furnace House now the site of the gardeners bothy, which is built against the outer face of the East Court's north wall.

A small box culvert recorded within the water pipe trench at the base of the lower terrace was the only feature recorded in this trench and the pipe trench on the south-west side of Abbotsford House leading from the B6360 was archaeologically sterile.

## 6. CONCLUSION

In line with the Written Scheme of Investigation for this project, a series of targeted site visits have allowed several features hitherto hidden but brought to light during the refurbishment of Abbotsford House to be recorded.

The project archive, comprising all CFA record sheets, maps and reports, will be deposited with the National Monuments Record of Scotland (NMRS) and copies of reports will be lodged with the Scottish Borders Council Sites and Monuments Record.

A summary statement of the results of this watching brief will be submitted for publication in *Discovery and Excavation in Scotland* (Appendix 2) and an online OASIS form will be completed.

## 7. REFERENCES

Abbotsford House Conservation Management Plan (Unpublished Report)

English Heritage 2000 *Standard Specification for an Architectural Survey*. London

English Heritage 2006 *Recording Historic Buildings. A Descriptive Specification*, 3rd edition. London.

Muthesius, H 1904 'The English House' Volume II: Layout and Construction. (2007 edition, London: Frances Lincoln) p 72

Savory, G 2011 *Abbotsford House, Abbotsford, Melrose, Scottish Borders Archaeological Strip, Map and Sampling*. CFA Unpublished Report 1923

## APPENDIX 1: PHOTOGRAPHIC REGISTER

Shot	Folder Description	From	Conditions
	<i>Folder 1</i>		
001-004	Exposed section in the out-house area south-west end	NE	Dull
005	Room B.31 exposed foundations for a domestic boiler	NW	Flash
006	Room B.31 exposed foundations for a domestic boiler	SE	Flash
007	Room B.31 exposed foundations for a domestic boiler	NW	Flash
008	Room B.31 exposed foundations for a domestic boiler	Vertical	Flash
009	Room B.31 exposed foundations for a domestic boiler	SE	Flash
010	Pipe trench behind Gate 9 general shot of section	SE	Flash
011-012	Pipe trench behind Gate 9 general shot of section	SE	Flash
013-014	Pipe trench behind Gate 9, undisturbed till	SE	Flash
	<i>Folder 2</i>		
001-003	Game larder lead roof following removal of gravel cover	NE	Dull
004-005	Game larder lead roof, drain detail shot	Vertical	Bright
006	Game larder lead roof, drain detail shot	Vertical	Bright
007	Game larder lead roof, drain detail and gutter	NW	Bright
008-009	Game larder lead roof detail shot	SE	Dull
010	Game larder lead roof detail shot	NW	Dull
011-012	Game larder roof inspection slot section	NW	Dull
013	Game larder roof inspection slot section	SE	Dull
014	Game larder roof inspection slot section	NE	Dull
015-016	Ice house passage roof exposed	SW	Bright
017-019	Ice house passage roof exposed, taken from scaffold	NW	Bright
020	Ice house roof excavation trench, exposed section	NW	Bright
021	Game larder roof inspection slot section	NW	Dull
022	Game larder roof inspection slot section	SE	Dull
023	Game larder roof inspection slot section	N	Dull
024-025	Game larder roof inspection slot section	N	Dull
	<i>Folder 3</i>		
001-003	Basement Hall (B.01) exposed service trench section	SW	Flash
004	Basement Hall area B.38 exposed section in the service trench	SW	Flash
005	Reception Hall (B.01) exposed service trench make up layer	NW	Flash
006-007	Basement Hall area B.38, exposed wall foundations	NE	Flash
008	Basement Hall area B.38, exposed wall foundations	SW	Flash
009-011	Basement Hall area B.38, exposed wall in detail	NE	Flash
012	Basement area B.26, exposed culvert in underpinning trench	SW	Flash
013	Basement area B.26, exposed culvert in underpinning trench	NW	Flash
014	Basement area B.26, exposed culvert in underpinning trench	SE	Flash
015	Basement area B.26, exposed culvert in underpinning trench	NW	Flash
016-017	Basement area B.26, exposed culvert in underpinning trench	Vertical	Flash
018	Basement area B.26, exposed culvert in underpinning trench	NW	Flash
019	Passage B.17B well capping material (modern)	Vertical	Flash
020-021	Passage B.17B well, interior well construction fabric	Vertical	Flash
022	Passage B.17B well capping material (modern)	Vertical	Flash
023-024	Passage B.17B well capping material (modern)	SW	Flash
	<i>Folder 4</i>		
001	Basement Hall floor (B.01) exposed service trench	W	Flash
002	Basement Hall (B.01) exposed service trench make up	S	Flash

	layer		
003	Basement corridor floor B.38, floor surface	S	Flash
004	Basement floor corridor B.38, floor surface	S	Flash
005	Basement corridor floor flagstone detail	W	Flash
006	Basement corridor floor flagstone detail	W	Flash
007	Basement corridor floor flagstone detail	W	Flash
008	Basement corridor floor flagstone detail	W	Flash
009	Basement corridor (B.17A) floor flagstone detail	E	Flash
018	Store/washhouse (B.31) blocked opening on the NW elevation	SE	Flash
019	Store/washhouse (B.31) blocked opening on the NW elevation	N	Flash
020	Store B.23 Cobble floor detail	E	Flash
012	Store B.23 Cobble floor detail	E	Flash
022	Store B.23 Cobble floor detail	E	Flash
023	Store B.23 Cobble floor detail	NE	Flash
024	Store B.23 Cobble floor detail	S	Flash
025	Store B.23 Cobble floor detail	E	Flash
026	Store B.23 Cobble floor detail	N	Flash
027	Store B.23 Cobble floor detail	W	Flash
028	Store B.23 Cobble floor detail and door to passage B.21A	E	Flash
029	Watching brief, gas pipe trench on north side of walled gardens	E	Bright
030	Watching brief, gas pipe trench on north side of walled gardens	W	Bright
031	Watching brief, gas pipe trench on north side of walled gardens, hypocaust flue in section	S	Bright
032	Watching brief, gas pipe trench on north side of walled gardens, hypocaust flue in section	S	Bright
033	Watching brief, gas pipe trench on north side of walled gardens, hypocaust flue in section	S	Bright
034	Watching brief, gas pipe trench on north side of walled gardens, hypocaust flue interior (spoilt shot)	S	bright
035	Watching brief, gas pipe trench on north side of walled gardens, hypocaust flue interior (spoilt shot)	S	bright
036	Watching brief, gas pipe trench on north side of walled gardens, hypocaust flue interior (spoilt shot)	S	bright
037	Watching brief, gas pipe trench on north side of walled gardens, hypocaust flue interior (spoilt shot)	S	bright
038	Watching brief, gas pipe trench on north side of walled gardens, hypocaust flue interior (spoilt shot)	S	Bright
039	North side of walled kitchen garden, generals hot	NE	Bright
040	North side of walled kitchen garden (bee bole or vent?)	NE	Bright
041	Gas pipe section, fluvioglacial deposits	N	Bright
042	Courtyard inspection. Wall foundations	E	Bright
043	Courtyard inspection. Wall foundations	E	Bright
044	Courtyard inspection. Wall foundations	E	Bright
045	Courtyard inspection. Wall foundations	E	Bright
046	Courtyard inspection sterile pipe trench	S	Bright
047	Courtyard inspection sterile pipe trench	E	Bright
	<i>Folder 5</i>		
001-002	Dressing Room F.17 exposed cast-iron beam at base of wall	NE	Flash
003-004	Dressing Room F.17 exposed cast-iron beam at base of wall	NE	Flash
005-008	Library G.05 floor board removal and exposed joists	SW	Flash
	<i>Folder 6</i>		
001-002	Walled Gardens, North corner turret and wall	N	Bright

003	Walled gardens, North corner turret detail	N	Bright
004	Walled gardens, return wall from turret	E	Bright
006-007	Walled gardens, arrow slits through north-east wall	E	
008	Walled gardens, turret on the north-east wall	E	
009	Walled gardens, turret above the north-east terrace	E	
010	Walled gardens, turret above the north-east terrace	E	
011	Walled gardens, turret arrow slit walls above north-east terrace	S	
013	Walled gardens, armorial plaque above north-east terrace	E	
014	Walled gardens, armorial plaque, detailed shot	E	
015	Walled gardens, turret and south facing wall	N	
016	Walled gardens, arrow slit detail on the south-facing wall	N	
017-018	Walled gardens, general view of the turret and main wall	W	
019	Walled gardens, turret and main wall	SW	
20	Walled gardens, external west wall of the kitchen garden	SW	
21	Walled gardens, external west wall of the kitchen garden	N	
22	Walled gardens, external west wall of the kitchen garden	N	
23-24	Walled gardens, external west wall of the kitchen garden blocked openings	E	
25	Walled gardens, external west wall of the kitchen garden, north gate	E	
26	Walled gardens, external west wall of the kitchen garden, junction of wall and gardeners shed	E	
27-29	Walled gardens, external west wall, gardeners bothy	N	
30-31	Walled gardens, external west wall, gardeners bothy roof	E	
32	Walled gardens, external west wall, gardeners entrance	E	
33	Walled gardens, external west wall, door to rear terrace	S	
34-36	Walled gardens, external west wall, north corner	S	
37	Walled gardens, external north wall blocked openings	S	
38	Walled gardens, external north wall, lean-to building	E	
39	Walled gardens, external north wall, lean-to building	W	
40	Walled gardens, external north wall, void in return wall	E	
41	Walled gardens, external north wall entrance	S	
42-43	Walled gardens, external north wall general shot	SW	
44	Walled gardens, north wall interior return		
45	Walled gardens, interior north wall		
46-48	Walled gardens. Ornate doorway to East Court	S	
49	Walled gardens, kitchen garden, south interior wall	W	
50	Walled gardens, internal north wall of the kitchen garden	E	
51	Walled gardens, internal west wall of the kitchen garden, showing Gardner's entrance	E	
52	Walled gardens, internal west wall of the kitchen garden	W	
53	Walled gardens, internal west wall of the kitchen garden	W	
54	Walled gardens, internal west wall of the kitchen garden	SW	
55	Walled gardens, internal north wall of the kitchen garden	NW	
56	Walled gardens, internal north wall of the kitchen garden	E	
57-58	Walled gardens, internal north wall orangery	E	
59-60	Walled gardens, internal north wall orangery	N	
61-62	Walled gardens, internal north wall orangery interior wall	N	
63	Walled gardens, internal north wall orangery interior	W	
64	Walled gardens, internal north wall entrance	N	
65	Walled gardens, internal north wall foundations	N	
66	Walled gardens, internal north wall general shot	NW	
67	Walled gardens, internal north and east wall corner	W	
68-69	Walled gardens, internal east wall and doorway	E	
70-71	Walled gardens, internal east wall, general shot	NE	
72-73	Walled gardens, internal east wall, general shot	NE	
74-75	Walled gardens, East Court internal west wall door to	W	

	tower		
76-78	Walled gardens, East Court internal west wall general view at south end	N	
79-81	Walled gardens, East Court internal west wall, doorway	W	
82-84	Walled gardens, East Court internal west wall and borders	NW	
85	Walled gardens, East Court internal west wall	SW	
86	Spoilt shot		
87-89	Walled gardens, East Court internal west wall, south end	SW	
90	Walled gardens, East Court internal west wall	S	
91	Walled gardens, East Court internal west wall	SW	
92	Walled gardens, East Court internal west wall fabric	W	
93-94	Walled gardens, East Court internal north-facing formal entrance	S	
95-96	Walled gardens, East Court internal south-facing formal entrance	N	
97-98	Walled gardens, East Court internal south-facing formal entrance, gargoyles	S	
99-100	Walled gardens, East Court internal south-facing formal entrance	N	
101	Walled gardens, East Court internal south-facing formal entrance, flanking wall	W	
102-103	Walled gardens, East Court internal south-facing formal entrance, flanking wall	W	
104-105	Walled gardens, East Court internal west-facing wall	E	
106	Walled gardens, East Court internal west-facing wall	N	
107	Walled gardens, East Court north-facing steps and entrance	N	
108-109	Walled gardens, East Court internal north-facing entrance and turret	N	
110-117	Panoramic shots of the arcade wall on the south side of the East Court	S to W	
118-120	General view of the East Court	W	
121-122	Steps and railing on the south side of the East Court	S	
123-130	General view of the East Court, panoramic	W to N	
131	Looking towards the north gable of Abottsford House across the East Court	SW	
132	Walled kitchen garden, path leading to East Court	S	
133	Walled kitchen garden, looking west	E	
134-136	Walled kitchen garden, looking north	S	
137-138	Walled kitchen garden, looking north-east	SW	
139	Walled garden, East Court, exterior west wall, north-west corner	W	
140	Walled kitchen garden, East Court, exterior west wall, entrance gate	NW	
141	Walled kitchen garden, East Court, exterior west wall	SW	
142-143	Walled kitchen garden, East Court, exterior west wall	W	
144-145	Walled kitchen garden, East Court, exterior west wall	SW	
146	Walled kitchen garden, East Court, exterior west wall	N	
147-149	Walled kitchen garden, East Court, formal entrance at south end	SW	
150-151	Walled kitchen garden, East Court formal entrance at south end	NW	
	<i>Folder 7</i>		
001-003	Box drain exposed in the gas pipe on at the base of the north terrace	SW	Bright
004	Gas pipe trench alignment at the base of the north terrace	NE	Bright
005	Gas pipe trench alignment at the base of the north terrace	NW	Bright

006-007	Gas pipe trench running eastwards up through the terrace	W	Bright
008	Gas pipe trench section showing terrace construction material	N	Bright
	<i>Folder 8</i>		
001	Water mains trench general shot	SE	Bright
002	Water mains trench general shot	SW	Bright
003	Water mains trench general shot	SW	Bright
004	Water mains trench general shot	SE	Bright
005	Water mains trench general shot	NW	Bright
006	Water mains trench general shot of the section	NE	Bright
007-008	Water mains trench general shot of the section	SE	Bright
009	Water mains trench general shot of the section	NW	Bright
010	Water mains trench general shot	SW	Bright
011	Water mains trench general shot	SW	Bright
012	Water mains trench general shot	NE	Bright
	<i>Folder 9</i>		
001-003	Inner courtyard passage wall, general shot	W	Flash
004	Inner courtyard passage wall, general shot	SW	Flash
005-006	Inner courtyard passage wall, general shot	N	Flash
007	Inner courtyard passage wall, general shot	SW	Flash
008	Inner courtyard passage wall, wall head, general shot	W	Flash
009	Inner courtyard passage wall, wall head, general shot	N	Flash
010	Inner courtyard passage wall, general shot of base	N	Flash
011-012	Room G.14 fireproof cupboard with door open	NE	Flash
013	Room G.14 fireproof cupboard, stone shelf detail	NE	Flash
014	Room G.14 fireproof cupboard, shelf and inner wall detail	N	Flash
015	Room G.14 fireproof cupboard, arched interior roof	Oblique	Flash
016-017	Room G.14 fireproof cupboard, floor tiles	Oblique	Flash
018-020	Room G.14 fireproof cupboard, sample of the firebrick	Oblique	Flash
021	Room G.14 fireproof cupboard, rear of cupboard door	NE	Flash
022	Room G.14 fireproof cupboard, on main SE elevation	NW	Flash
023	Room G.14 fireproof cupboard, rear door lock plate	NE	Flash
024-025	Room G.14 fireproof cupboard, with door closed	NE	Flash



## APPENDIX 2: DISCOVERY & EXCAVATION IN SCOTLAND ENTRY

<b>LOCAL AUTHORITY:</b>	Scottish Borders
<b>PROJECT TITLE/SITE NAME:</b>	Abbotsford House, Melrose, Scottish Borders
<b>PROJECT CODE:</b>	ABBO
<b>PARISH:</b>	Melrose
<b>NAME OF CONTRIBUTOR:</b>	Gary Savory & Michael Cressey
<b>NAME OF ORGANISATION:</b>	CFA Archaeology Ltd
<b>TYPE(S) OF PROJECT:</b>	Building Survey and Archaeological Watching Brief
<b>RCAHMS Site No.</b>	NT53SW 41
<b>SITE/MONUMENT TYPE(S):</b>	Grade A Listed Building
<b>SIGNIFICANT FINDS:</b>	None
<b>NGR (2 letters, 10 figures)</b>	NT 5105 3434
<b>START DATE (this season)</b>	June 2011
<b>END DATE (this season)</b>	August 2012
<b>PREVIOUS WORK (incl. DES ref.)</b>	
<b>MAIN (NARRATIVE) DESCRIPTION:</b> (May include information from other fields)	<p>A watching brief was carried out during groundworks for the construction of a car park and Visitor Reception Building to the east of Abbotsford House, Melrose. There were no features, deposits or artefacts of archaeological significance identified during the watching brief</p> <p>A further programme of building survey and archaeological watching brief was carried out during the refurbishment works at Abbotsford House., Melrose. The principal building features identified included the foundations for a domestic boiler and a stone-lined well. External features that were recorded included the vaulted passage roof to the Ice House and the East Court and Kitchen walled gardens.</p> <p>During a watching brief to monitor the insertion of new services a hypocaust flue or heating duct for the now demolished vinery glasshouses was recorded along with a stone lined culvert.</p>
<b>PROPOSED FUTURE WORK:</b>	None
<b>CAPTION(S) FOR ILLUSTRS:</b>	N/A
<b>SPONSOR OR FUNDING BODY:</b>	Abbotsford Trust
<b>ADDRESS OF MAIN CONTRIBUTOR:</b>	The Old Engine House, Eskmills Park, Musselburgh, EH21 7PQ
<b>EMAIL ADDRESS:</b>	cfa@cfa-archaeology.co.uk
<b>ARCHIVE LOCATION (intended/deposited)</b>	National Monuments Record of Scotland (archive) Scottish Borders Council Sites and Monuments Record (report)



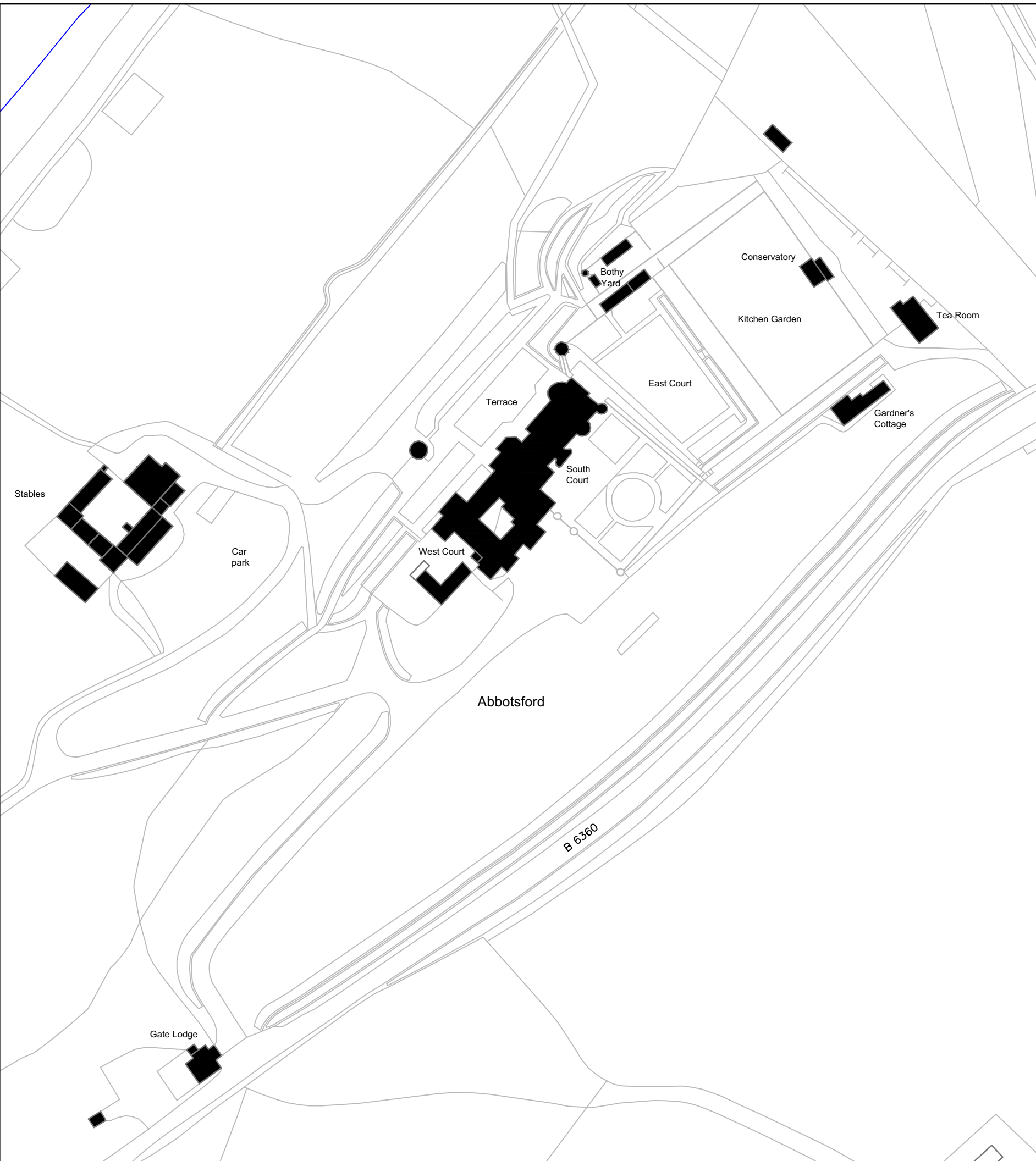
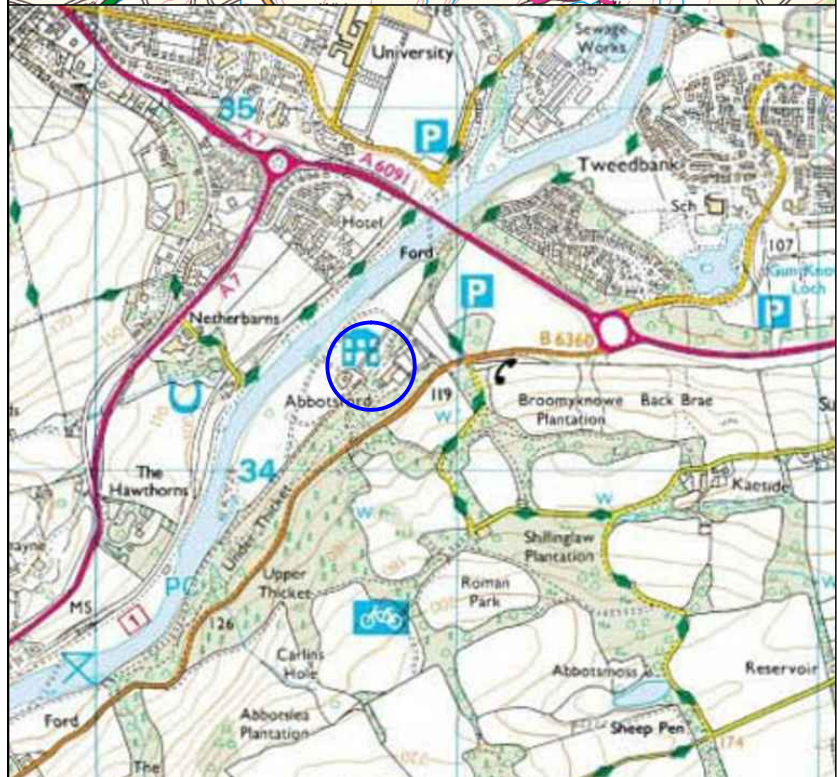
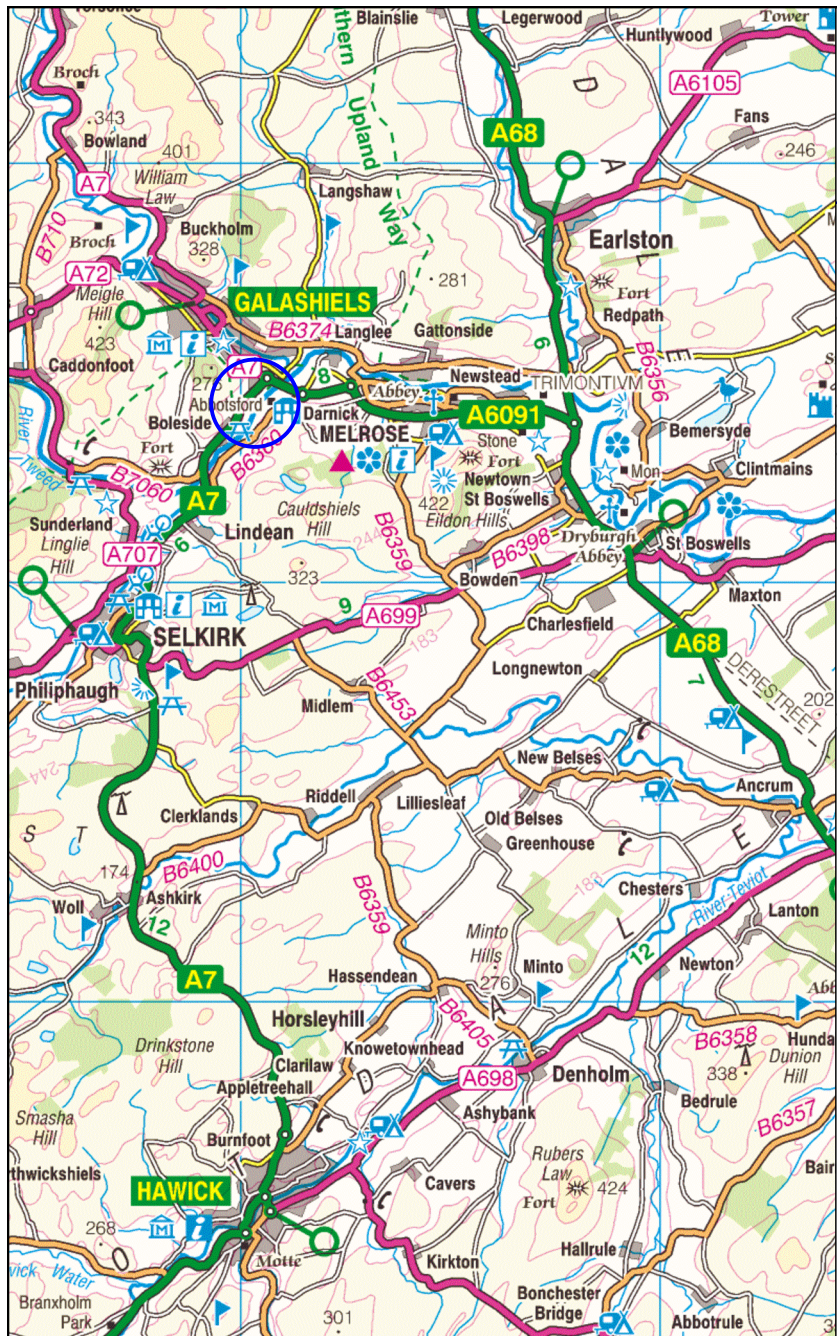

Key:

**CFA** ARCHAEOLOGY LTD  
 The Old Engine House  
 Eskmills Park  
 Musselburgh  
 East Lothian, EH21 7PQ  
 t: 0131 273 4380  
 f: 0131 273 4381  
 e: info@cfa-archaeology.co.uk  
 w: www.cfa-archaeology.co.uk

Fig. No:	1	Revision:	A
----------	---	-----------	---

Title:  
Site Location Plan

Project:  
Abbotsford House,  
Abbotsford, Melrose, Scottish  
Borders.  
Architectural recording and  
archaeological watching brief

Client:  
LDN Architects LLP per The  
Abbotsford Trust

Scale at A3:  
1:1250





Key:

Areas Monitored

CFA ID Numbers

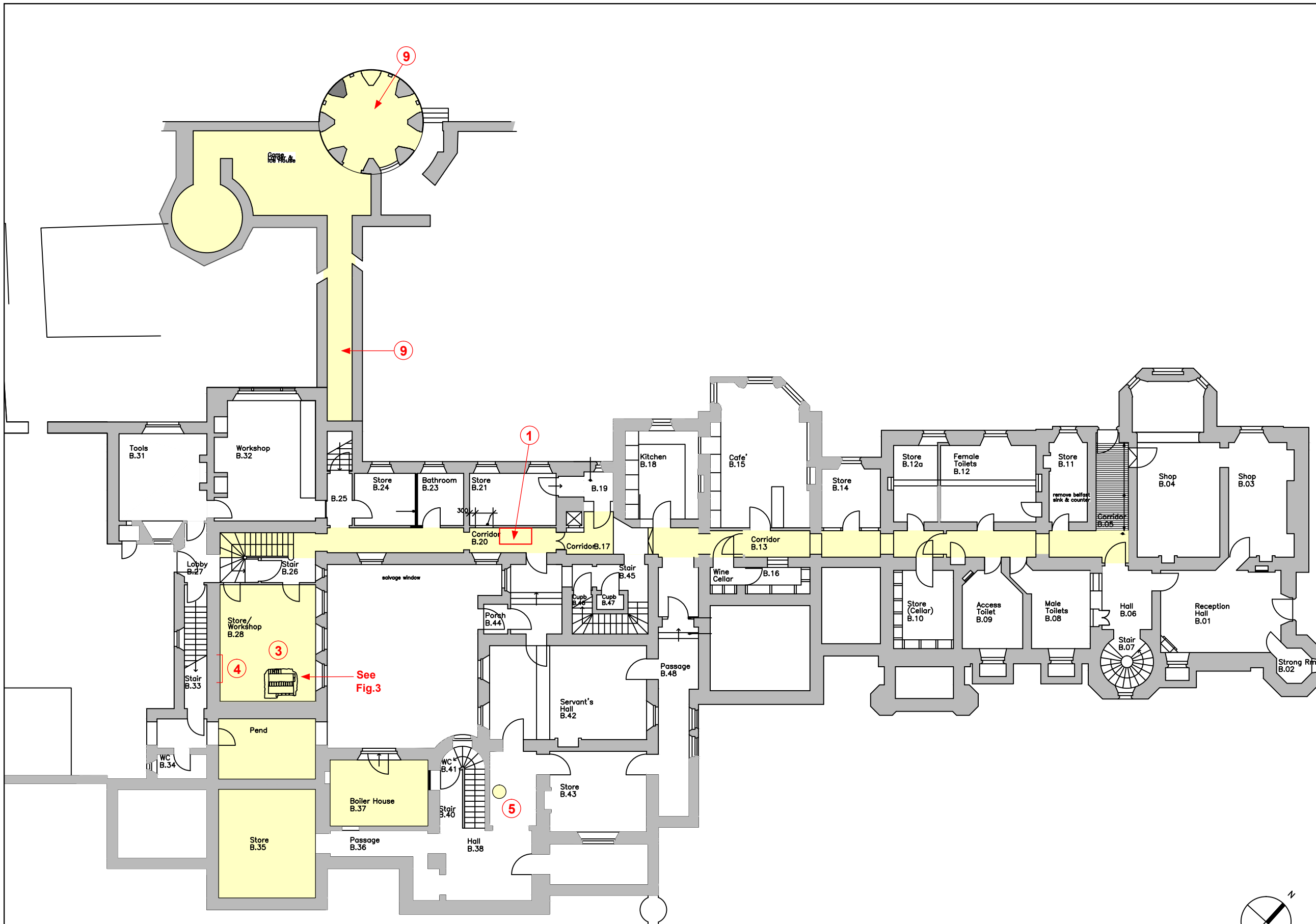

See Fig.3

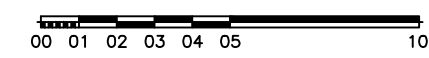
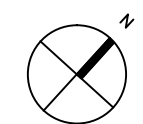

**CFA** ARCHAEOLOGY LTD  
 The Old Engine House  
 Eskmills Park  
 Musselburgh  
 East Lothian, EH21 7PQ  
 t: 0131 273 4380  
 f: 0131 273 4381  
 e: info@cfa-archaeology.co.uk  
 w: www.cfa-archaeology.co.uk

Fig. No: 2a Revision: A

Title:  
**Basement floor plan showing areas of intervention and areas monitored**

Project:  
**Abbotsford House, Abbotsford, Melrose, Scottish Borders. Architectural recording and archaeological watching brief**

Client:  
**LDN Architects LLP per The Abbotsford Trust**

Scale at A3:  
**1:200**



Key:

Areas Monitored

CFA ID Numbers

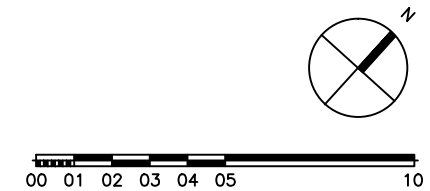
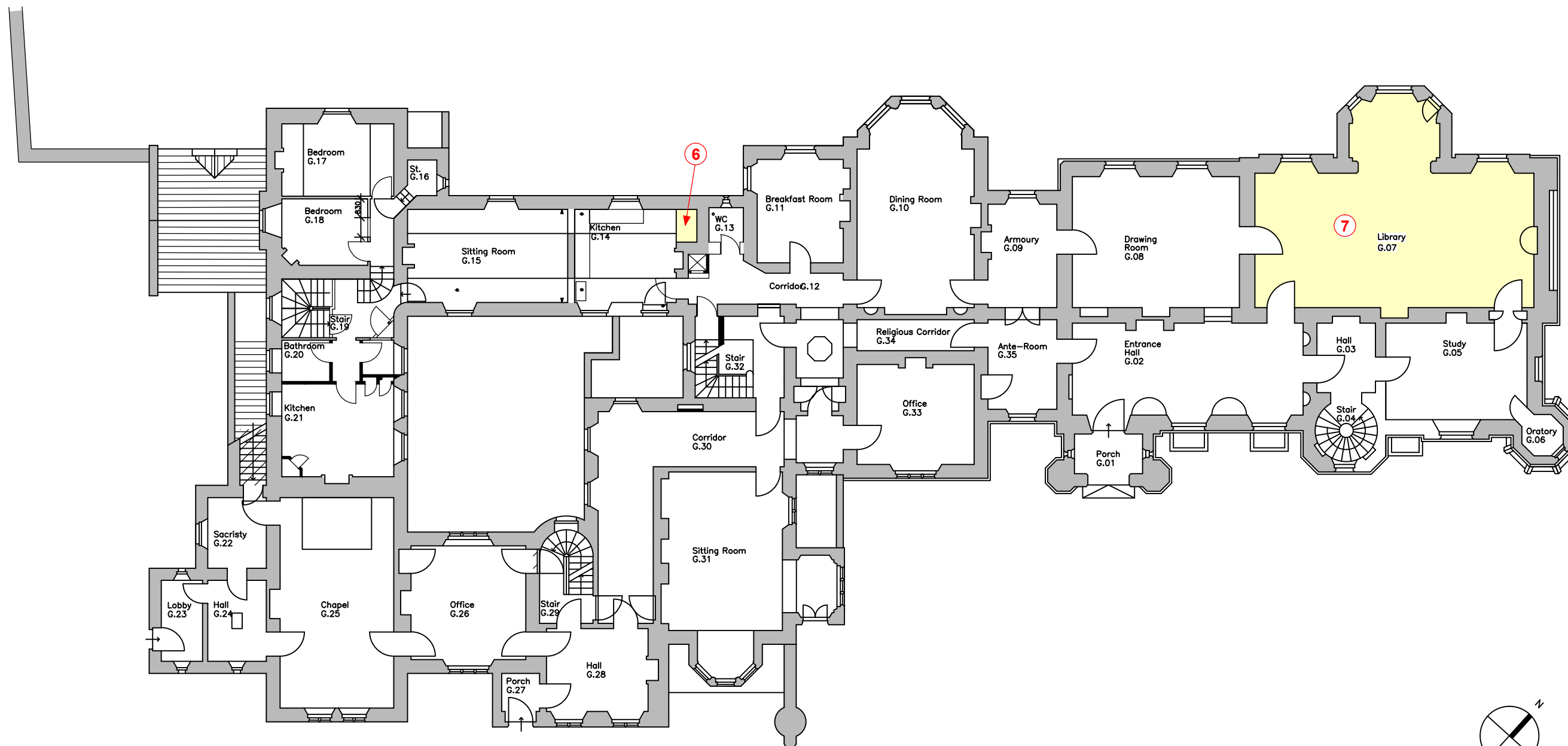

**CFA** ARCHAEOLOGY LTD  
 The Old Engine House  
 Eskmills Park  
 Musselburgh  
 East Lothian, EH21 7PQ  
 t: 0131 273 4380  
 f: 0131 273 4381  
 e: info@cfa-archaeology.co.uk  
 w: www.cfa-archaeology.co.uk

Fig. No: 2b Revision: A

Title:  
Ground floor plan showing areas of intervention and areas monitored

Project:  
Abbotsford House,  
Abbotsford, Melrose, Scottish Borders.  
Architectural recording and archaeological watching brief

Client:  
LDN Architects LLP per The Abbotsford Trust

Scale at A3:  
1:200

Key:

Areas Monitored

CFA ID Numbers

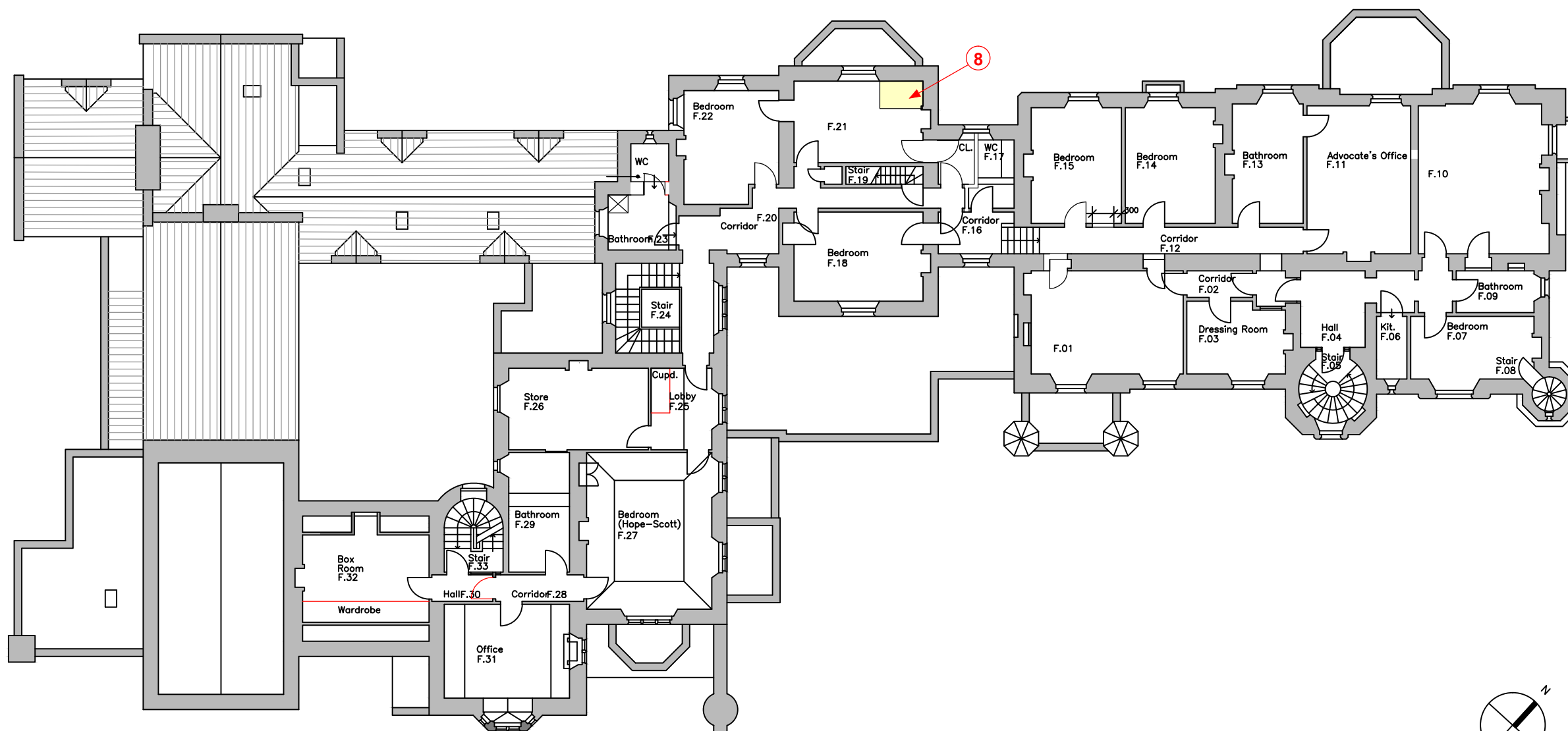

Title:  
**First floor plan showing areas of intervention and areas monitored**

Project:  
**Abbotsford House,  
 Abbotsford, Melrose, Scottish Borders.  
 Architectural recording and archaeological watching brief**

Client:  
**LDN Architects LLP per The Abbotsford Trust**

Scale at A3:  
**1:200**



Key:

 Areas Monitored

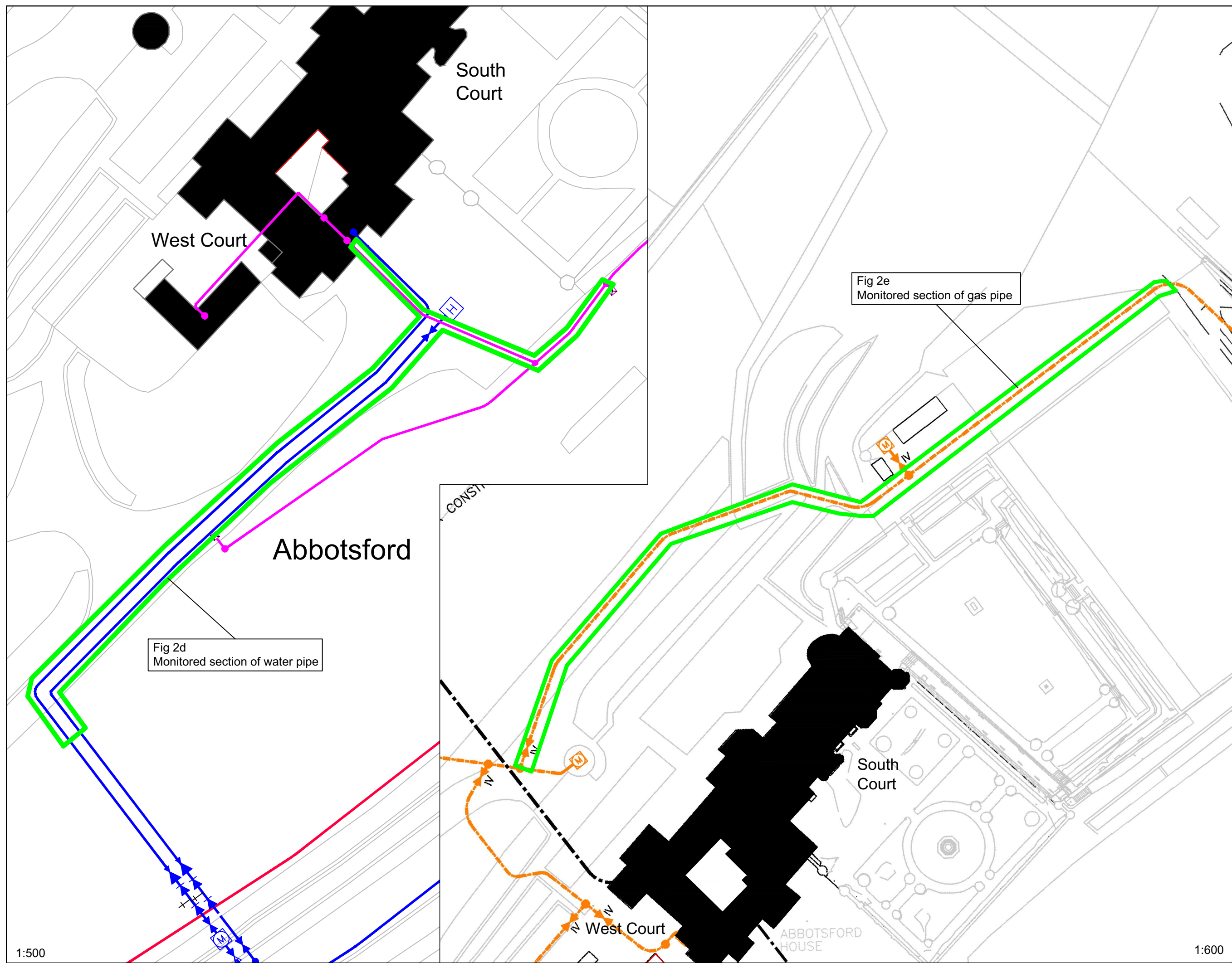

1:500

1:600

**CFA** ARCHAEOLOGY LTD  
 The Old Engine House  
 Eskmills Park  
 Musselburgh  
 East Lothian, EH21 7PQ  
 t: 0131 273 4380  
 f: 0131 273 4381  
 e: info@cfa-archaeology.co.uk  
 w: www.cfa-archaeology.co.uk

Fig. No: 2d-e Revision: A

Title:  
Areas monitored - Gas pipe and water pipe

Project:  
Abbotsford House,  
Abbotsford, Melrose, Scottish  
Borders.  
Architectural recording and  
archaeological watching brief

Client:  
LDN Architects LLP per The  
Abbotsford Trust

Scale at A3:

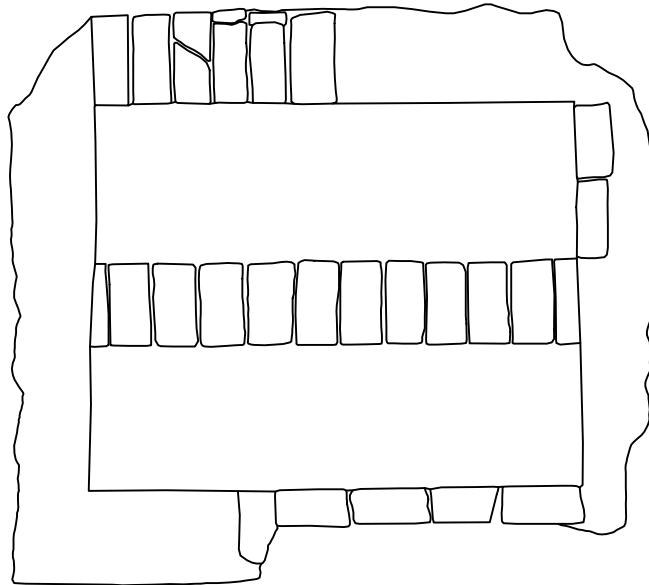
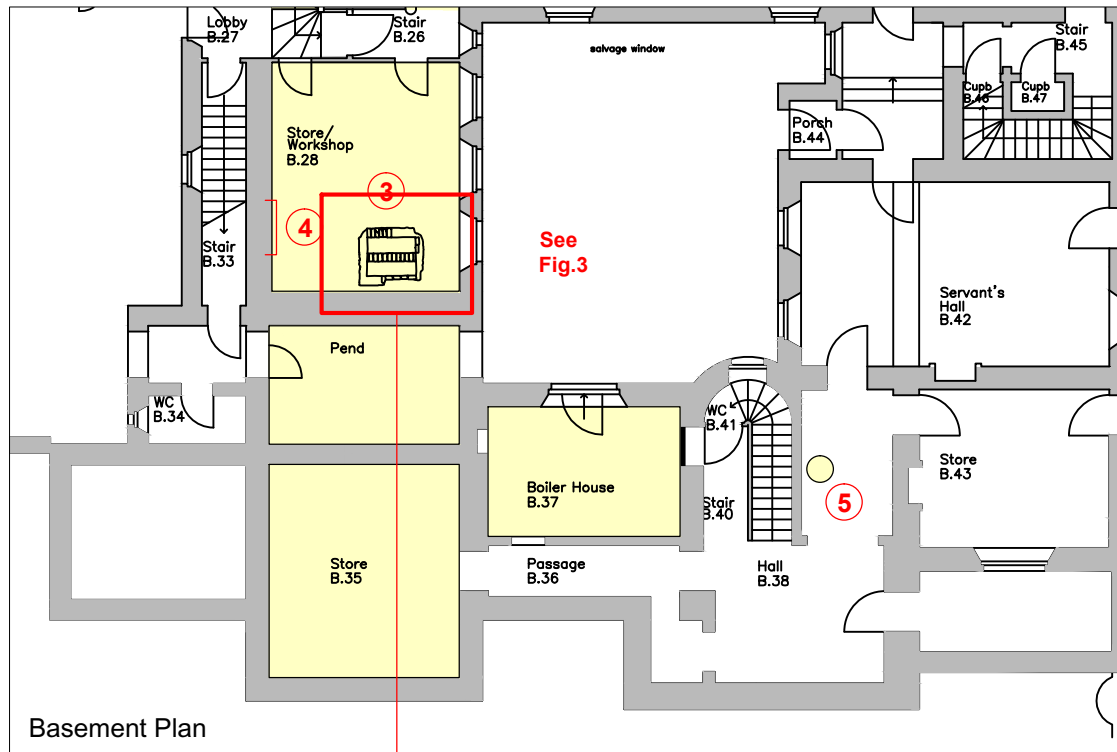

Key:



Fig No:	3	Revision:	A	Client:	LDN Architects LLP per The Abbotsford Trust
Title:	Stores/Wash house boiler stance				
Project:	Abbotsford House, Abbotsford, Melrose, Scottish Borders. Architectural recording and archaeological watching brief				

Scale at A4: 1:20

CFA ARCHAEOLOGY LTD  
 The Old Engine House  
 Eskmills Park  
 Musselburgh  
 East Lothian, EH21 7PQ  
 t: 0131 273 4380  
 f: 0131 273 4381  
 e: info@cfa-archaeology.co.uk  
 w: www.cfa-archaeology.co.uk

Drawn by:	LW	Checked:	LW	Report No:	2135
-----------	----	----------	----	------------	------



Key:

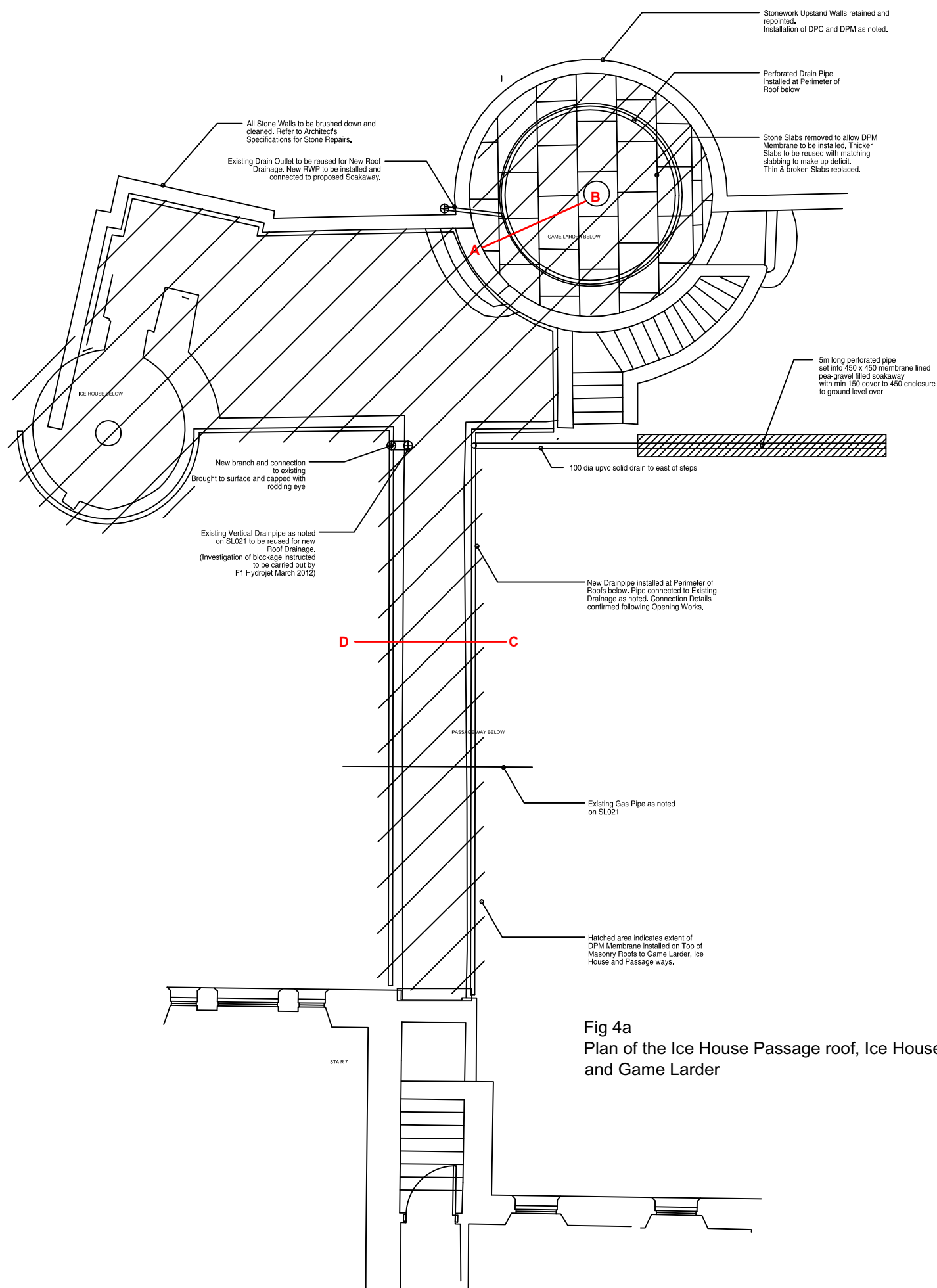

**Fig 4a**  
Plan of the Ice House Passage roof, Ice House and Game Larder

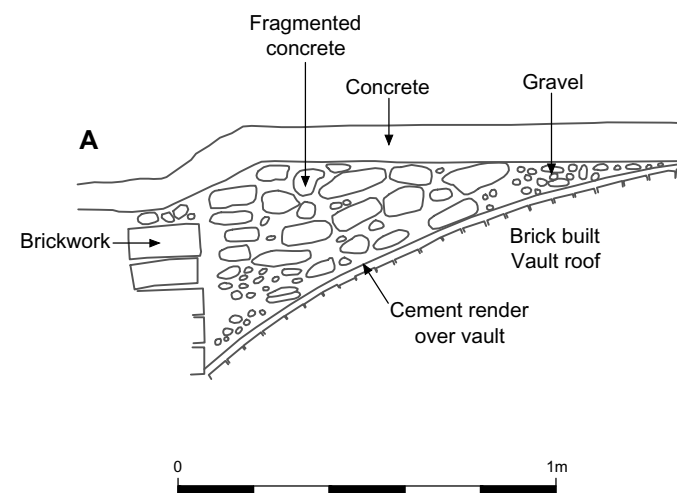

**Fig 4b**  
Section of the Capping material above the game Larder (Section A-B)

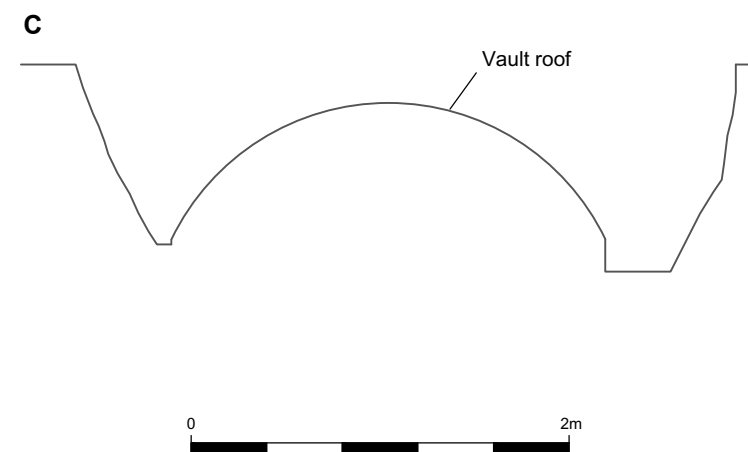

**Fig 4c**  
Profile of the Ice House roof (Section D-C)







Key:

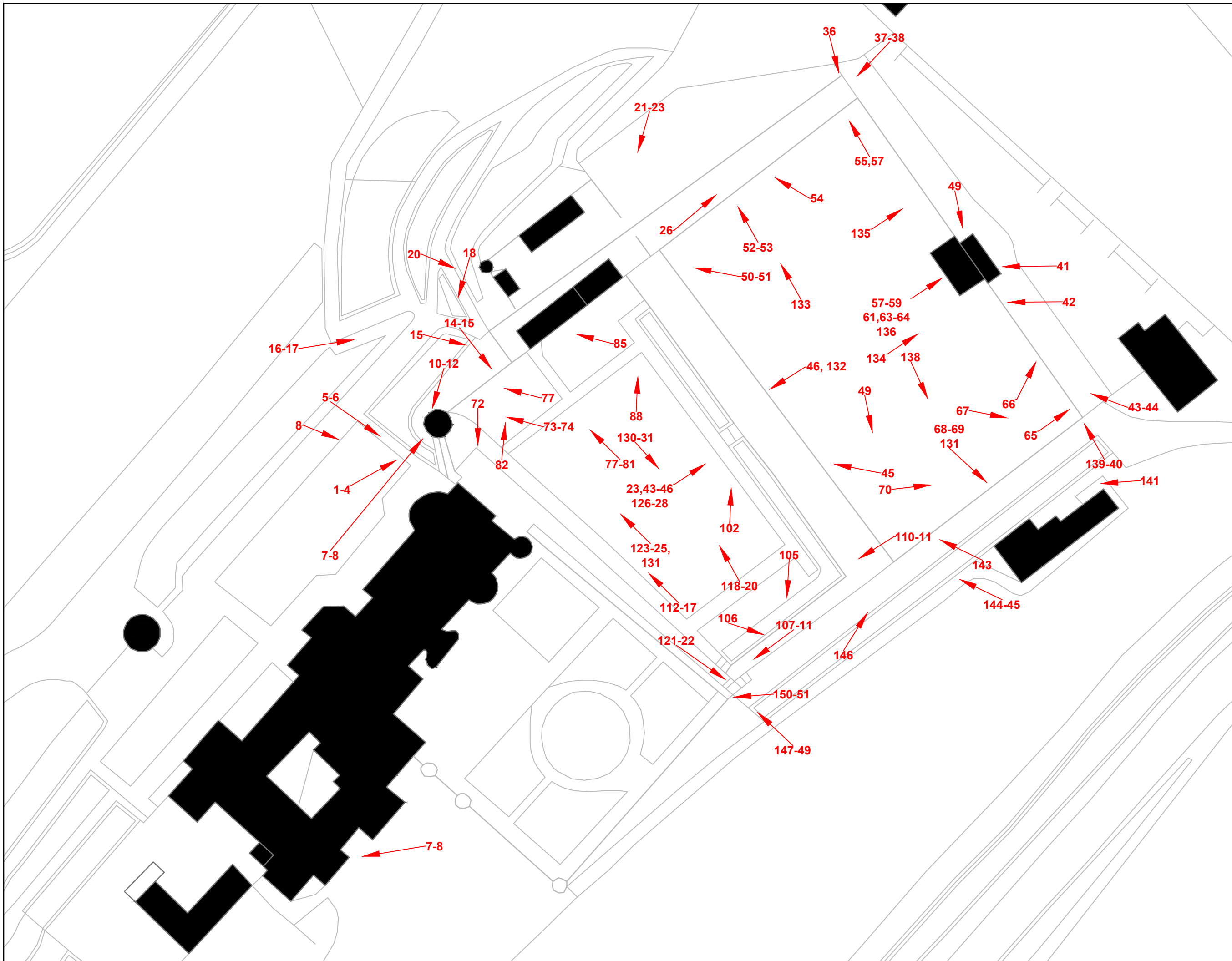

**CFA** ARCHAEOLOGY LTD  
 The Old Engine House  
 Eskmills Park  
 Musselburgh  
 East Lothian, EH21 7PQ  
 t: 0131 273 4380  
 f: 0131 273 4381  
 e: info@cfa-archaeology.co.uk  
 w: www.cfa-archaeology.co.uk

Fig. No:	5	Revision:	A
----------	---	-----------	---

Title:  
 Photo location plan of walled gardens

Project:  
 Abbotsford House,  
 Abbotsford, Melrose, Scottish Borders.  
 Architectural recording and archaeological watching brief

Client:  
 LDN Architects LLP per The Abbotsford Trust

Scale at A3:  
 1:500







Plate 1: Basement corridor in area B.48 showing flagstones in situ prior to removal



Plate 2: Basement corridor in area B.17 showing flagstones in situ prior to removal



Plate 3: Basement corridor area B.48, exposed wall foundations recorded during underpinning work

Plates. No: <b>1-3</b>	Revision: <b>A</b>	Project: Abbotsford House, Abbotsford, Melrose, Scottish Borders. Architectural recording and archaeological Watching briefs			<b>CFA ARCHAEOLOGY LTD</b> The Old Engine House Eskmills Park, Musselburgh East Lothian, Eh21 7PQ  T: 0131 273 4380 F: 0131 273 4381 e: info@cfa-archaeology.co.uk w: www.cfa-archaeology.co.uk
Drawn by: <b>GC</b>	Checked: <b>LW</b>	Report No: <b>2135</b>			

The copyright in this document (including its electronic form) shall remain vested in CFA Archaeology Ltd (CFA) but the Client shall have a licence to copy and use the document for the purpose for which it was provided. CFA shall not be liable for the use by any person of this document for any purpose other than that for which the same was provided by CFA. This document shall not be reproduced in whole or in part or relied upon by third parties for any use whatsoever without the express written authority of CFA.





Plate 4: Basement corridor area B.48, close-up of exposed wall fabric



Plate 5: Basement corridor area B.17, general shot of exposed culvert



Plate 6: Basement corridor, area B.17 detailed shot of the culvert

Plates. No: <b>4-6</b>		Revision: <b>A</b>	Project: Abbotsford House, Abbotsford, Melrose, Scottish Borders. Architectural recording and archaeological Watching briefs
Drawn by: <b>GC</b>	Checked: <b>LW</b>	Report No: <b>2135</b>	Client: <b>LDN Architects LLP per The Abbotsford Trust</b>



**CFA**  
ARCHAEOLOGY LTD

CFA ARCHAEOLOGY LTD  
The Old Engine House  
Eskmills Park, Musselburgh  
East Lothian, Eh21 7PQ

T: 0131 273 4380  
F: 0131 273 4381  
e: info@cfa-archaeology.co.uk  
w: www.cfa-archaeology.co.uk

The copyright in this document (including its electronic form) shall remain vested in CFA Archaeology Ltd (CFA) but the Client shall have a licence to copy and use the document for the purpose for which it was provided. CFA shall not be liable for the use by any person of this document for any purpose other than that for which the same was provided by CFA. This document shall not be reproduced in whole or in part or relied upon by third parties for any use whatsoever without the express written authority of CFA.







Plate 7: Hall B.38, exposed well with modern capping material



Plate 8: Hall B.38, vertical photograph looking down the well



Plate 9: Storeroom B.28, general view of the boiler foundations

Plates. No: <b>7-9</b>		Revision: <b>A</b>	Project: Abbotsford House, Abbotsford, Melrose, Scottish Borders. Architectural recording and archaeological Watching briefs			<b>CFA ARCHAEOLOGY LTD</b> The Old Engine House Eskmills Park, Musselburgh East Lothian, Eh21 7PQ  T: 0131 273 4380 F: 0131 273 4381 e: info@cfa-archaeology.co.uk w: www.cfa-archaeology.co.uk
Drawn by: <b>GC</b>	Checked: <b>LW</b>	Report No: <b>2135</b>	Client: <b>LDN Architects LLP per The Abbotsford Trust</b>			

The copyright in this document (including its electronic form) shall remain vested in CFA Archaeology Ltd (CFA) but the Client shall have a licence to copy and use the document for the purpose for which it was provided. CFA shall not be liable for the use by any person of this document for any purpose other than that for which the same was provided by CFA. This document shall not be reproduced in whole or in part or relied upon by third parties for any use whatsoever without the express written authority of CFA.







Plate 10: Storeroom B.28, general shot of the interior fireboxes



Plate 11: Storeroom B.28, general shot of the blocked opening on the south-west wall



Plate 12: Store B.35 general view of the cobble floor and central drain

Plates. No: <b>10-12</b>		Revision: <b>A</b>	Project: Abbotsford House, Abbotsford, Melrose, Scottish Borders. Architectural recording and archaeological Watching briefs			<b>CFA ARCHAEOLOGY LTD</b> The Old Engine House Eskmills Park, Musselburgh East Lothian, Eh21 7PQ  T: 0131 273 4380 F: 0131 273 4381 e: info@cfa-archaeology.co.uk w: www.cfa-archaeology.co.uk
Drawn by: <b>GC</b>	Checked: <b>LW</b>	Report No: <b>2135</b>	Client: <b>LDN Architects LLP per The Abbotsford Trust</b>			

The copyright in this document (including its electronic form) shall remain vested in CFA Archaeology Ltd (CFA) but the Client shall have a licence to copy and use the document for the purpose for which it was provided. CFA shall not be liable for the use by any person of this document for any purpose other than that for which the same was provided by CFA. This document shall not be reproduced in whole or in part or relied upon by third parties for any use whatsoever without the express written authority of CFA.





Plate 13: Store B.35 general view of the cobble floor



Plate 15: Room G.14 showing the cast-iron four paneled door



Plate 14: Room G.14 showing the fireproof cupboard in the corner of the room



Plate 16: Room G.14 showing stone shelf detail



Plate 17: Room G.14 showing lock plate on the rear of the door

Fig. No: 13-17		Revision: A	Project: Abbotsford House, Abbotsford, Melrose, Scottish Borders. Architectural recording and archaeological Watching briefs
Drawn by: LW	Checked: LW	Report No: 2135	Client: LDN Architects LLP per The Abbotsford Trust



CFA ARCHAEOLOGY LTD  
The Old Engine House  
Eskmills Park, Musselburgh  
East Lothian, Eh21 7PQ

T: 0131 273 4380  
F: 0131 273 4381

e: info@cfa-archaeology.co.uk  
w: www.cfa-archaeology.co.uk

The copyright in this document (including its electronic form) shall remain vested in CFA Archaeology Ltd (CFA) but the Client shall have a licence to copy and use the document for the purpose for which it was provided. CFA shall not be liable for the use by any person of this document for any purpose other than that for which the same was provided by CFA. This document shall not be reproduced in whole or in part or relied upon by third parties for any use whatsoever without the express written authority of CFA.





Plate 18: Room G.14 showing the arched brickwork on the cupboard interior





Plate 19: Room G.14 showing the arched brickwork



Plate 20: Room G.14 showing a cross-section of a fire-proof brick taken from the cupboard



Plate 21: Library G.07 showing the exposed floor-joists exposed during refurbishment work

Plates. No: <b>18-21</b>		Revision: <b>A</b>	Project: Abbotsford House, Abbotsford, Melrose, Scottish Borders. Architectural recording and archaeological Watching briefs			<b>CFA ARCHAEOLOGY LTD</b> The Old Engine House Eskmills Park, Musselburgh East Lothian, Eh21 7PQ  T: 0131 273 4380 F: 0131 273 4381 e: info@cfa-archaeology.co.uk w: www.cfa-archaeology.co.uk
Drawn by: <b>GC</b>	Checked: <b>LW</b>	Report No: <b>2135</b>	Client: <b>LDN Architects LLP per The Abbotsford Trust</b>			

The copyright in this document (including its electronic form) shall remain vested in CFA Archaeology Ltd (CFA) but the Client shall have a licence to copy and use the document for the purpose for which it was provided. CFA shall not be liable for the use by any person of this document for any purpose other than that for which the same was provided by CFA. This document shall not be reproduced in whole or in part or relied upon by third parties for any use whatsoever without the express written authority of CFA.







Plate 22: Room F.21, exposed cast-iron beam at the base of the wall



Plate 23: Ice house passage roof exposed prior to conservation work



Plate 24: Lead sheets covering the roof of ice house and game larder

Plates. No: <b>22-24</b>	Revision: <b>A</b>	Project: Abbotsford House, Abbotsford, Melrose, Scottish Borders. Architectural recording and archaeological Watching briefs			<b>CFA ARCHAEOLOGY LTD</b> The Old Engine House Eskmills Park, Musselburgh East Lothian, Eh21 7PQ  T: 0131 273 4380 F: 0131 273 4381 e: info@cfa-archaeology.co.uk w: www.cfa-archaeology.co.uk
Drawn by: <b>GC</b>	Checked: <b>LW</b>	Report No: <b>2135</b>			

The copyright in this document (including its electronic form) shall remain vested in CFA Archaeology Ltd (CFA) but the Client shall have a licence to copy and use the document for the purpose for which it was provided. CFA shall not be liable for the use by any person of this document for any purpose other than that for which the same was provided by CFA. This document shall not be reproduced in whole or in part or relied upon by third parties for any use whatsoever without the express written authority of CFA.





Plate 25: Game larder roof inspection trench within the domed interior of the parapet



Plate 26: Game larder roof construction material exposed in section



Plate 27: Kitchen garden wall entrance and wall detail



Plate 28: Kitchen garden wall showing poor condition of the brickwork



Plates. No: <b>25-28</b>		Revision: <b>A</b>	Project: Abbotsford House, Abbotsford, Melrose, Scottish Borders. Architectural recording and archaeological Watching briefs
Drawn by: <b>GC</b>	Checked: <b>LW</b>	Report No: <b>2135</b>	Client: <b>LDN Architects LLP per The Abbotsford Trust</b>
<small>The copyright in this document (including its electronic form) shall remain vested in CFA Archaeology Ltd (CFA) but the Client shall have a licence to copy and use the document for the purpose for which it was provided. CFA shall not be liable for the use by any person of this document for any purpose other than that for which the same was provided by CFA. This document shall not be reproduced in whole or in part or relied upon by third parties for any use whatsoever without the express written authority of CFA.</small>			  <p><b>CFA</b> ARCHAEOLOGY LTD</p> <p><small>CFA ARCHAEOLOGY LTD The Old Engine House Eskmills Park, Musselburgh East Lothian, Eh21 7PQ</small></p> <p><small>T: 0131 273 4380 F: 0131 273 4381 e: info@cfa-archaeology.co.uk w: www.cfa-archaeology.co.uk</small></p>





Plate 29: Water pipe trench leading to Abbotsford House



Plate 30: Water pipe trench leading to Abbotsford House



Plate 31: Gas pipe trench on the north side of Abbotsford House, general view looking east



Plates. No: <b>29-31</b>		Revision: <b>A</b>	Project: Abbotsford House, Abbotsford, Melrose, Scottish Borders. Architectural recording and archaeological Watching briefs
Drawn by: <b>GC</b>	Checked: <b>LW</b>	Report No: <b>2135</b>	Client: <b>LDN Architects LLP per The Abbotsford Trust</b>
<small>The copyright in this document (including its electronic form) shall remain vested in CFA Archaeology Ltd (CFA) but the Client shall have a licence to copy and use the document for the purpose for which it was provided. CFA shall not be liable for the use by any person of this document for any purpose other than that for which the same was provided by CFA. This document shall not be reproduced in whole or in part or relied upon by third parties for any use whatsoever without the express written authority of CFA.</small>			  <b>CFA</b> <small>ARCHAEOLOGY LTD</small>
			<small>CFA ARCHAEOLOGY LTD</small> <small>The Old Engine House</small> <small>Eskmills Park, Musselburgh</small> <small>East Lothian, Eh21 7PQ</small>  <small>T: 0131 273 4380</small> <small>F: 0131 273 4381</small> <small>e: info@cfa-archaeology.co.uk</small> <small>w: www.cfa-archaeology.co.uk</small>





Plate 32: Gas pipe on the north side of Abbotsford House showing in-situ box-drain



Plate 33: Gas pipe trench through the gardeners' path, general shot showing the route



Plate 34: Gas pipe trench through the gardeners' path, general shot of the hypocaust flue



Plate 35: Gas pipe trench through the gardeners path, interior of the hypocaust flue

Plates. No: <b>32-35</b>		Revision: <b>A</b>	Project: Abbotsford House, Abbotsford, Melrose, Scottish Borders. Architectural recording and archaeological Watching briefs
Drawn by: <b>GC</b>	Checked: <b>LW</b>	Report No: <b>2135</b>	Client: <b>LDN Architects LLP per The Abbotsford Trust</b>
<p>The copyright in this document (including its electronic form) shall remain vested in CFA Archaeology Ltd (CFA) but the Client shall have a licence to copy and use the document for the purpose for which it was provided. CFA shall not be liable for the use by any person of this document for any purpose other than that for which the same was provided by CFA. This document shall not be reproduced in whole or in part or relied upon by third parties for any use whatsoever without the express written authority of CFA.</p>			