

CFA Archaeology Ltd

archaeological consultants

Advice on Archaeology & Planning

Environmental Impact Assessment

Interpretation, Design & Display

Finds/ Environmental Analysis

Field Evaluation & Excavation

Historic Building Recording

Site & Landscape Survey

Geophysical Survey

**The Stables Buildings,
House of the Binns, West Lothian**

Standing Building Recording Survey

Report No. 3037

CFA ARCHAEOLOGY LTD

The Old Engine House
Eskmills Business Park
Musselburgh
East Lothian
EH21 7PQ

Tel: 0131 273 4380
Fax: 0131 273 4381
email: info@cfa-archaeology.co.uk
web: www.cfa-archaeology.co.uk

| | |
|-----------------|--|
| Author | Michael Cressey HND BA MSc PhD FSA Scot MifA & Stuart Mitchell MA AifA |
| Illustrator | Graeme Carruthers MA MifA |
| Editor | Melanie Johnson MA PhD FSA Scot MifA |
| Commissioned by | National Trust for Scotland |
| Date issued | June 2013 |
| Version | 1 |
| OASIS Reference | cfaarcha1- |
| Grid Ref | NT 05029 78267 |

This document has been prepared in accordance with CFA Archaeology Ltd standard operating procedures.

**The Stables Buildings,
House of the Binns, West Lothian**

Standing Building Recording Survey

Report No. 3037

CONTENTS

| | | |
|----|----------------------------------|----|
| 1. | Introduction | 3 |
| 2. | Methodology | 4 |
| 3. | Desk Based Assessment | 5 |
| 4. | Standing Building Survey Results | 6 |
| 5. | Discussion | 12 |
| 5. | Conclusion | 16 |
| 6. | Conclusions and Recommendations | 13 |
| 7. | References | 13 |

Tables

| | | |
|----|---|----|
| 1. | Specific recording requirements at the Stable Complex | 14 |
| 2. | Key to unique identifiers | 16 |
| 3. | Elements of the exterior elevations | 18 |

Appendices

| | | |
|----|---|----|
| 1. | Principal architectural features within the complex | 15 |
| 2. | Photographic Register | 17 |
| 3. | Discovery and Excavation in Scotland Entry | 19 |

List of Figures (bound at rear)

| | |
|--------------|---------------------|
| Figure 1 | Site location |
| Figures 2a-e | Map Regression |
| Figures 3a-b | Floor plans |
| Figures 4a-e | Building Elevations |
| Figure 5a-m | Selected Plates |

Thumbnails bound at rear

1. INTRODUCTION

1.1 General

This report presents the results of a Level 3 standing building survey carried out at the Stable Complex (NGR: NT 05029 78267) located within the House of the Binns Estate owned by the National Trust for Scotland (NTS). The survey is based on information and architectural drawing produced by the NTS. A standing building survey was required at the former stable building prior to a future scheme of consolidation and repair.

1.2 Background

The roofless stable complex is arranged around a courtyard located to the south-west of a walled garden, which are now ruinous. The stable complex comprises single storey buildings around three sides of a courtyard with a wall enclosing the fourth, eastern side, at the centre of which is a building with an arched entrance. The east wall is crenulated, which rises up the pitch of the pierced central gable forming a prominent feature.

1.3 Objective

The objectives of the programme of archaeological work were:

- To carry out a standing building survey of the Stable Complex prior to their consolidation and repair.
- To establish a more refined understanding of the structural development of the Stable Complex based on the results of the standing building surveys.
- To produce a comprehensive drawn, written and photographic record of the Stable Complex, its construction and the relationship to the surrounding landscape.
- To produce an illustrated standing building survey report in accordance with NTS requirements.

1.4 Acknowledgement

The authors express their gratitude to Andrew P.K. Wright for his interest and advice.

2. METHODOLOGY

2.1 General

CFA follows the Institute for Archaeologists' Code of Conduct, and Standards and Guidelines for Historic Building Survey as appropriate.

A Level 3 standing building survey was carried out, as defined by English Heritage (2006).

2.2 Desk-based Assessment

A rapid desk-based assessment was carried out prior to the survey. Familiarisation with the area's historical and archaeological background was made in order to place the stables in their historical and landscape setting. Examination of early maps and later Ordnance Survey maps was carried out to establish any changes in structural form and layout (Fig. 2).

2.3 Standing Building Survey

A comprehensive building survey (Table 1) was carried out equivalent with a Level 3 analytical survey (English Heritage 2006). This included the following elements:

- A digital photographic survey (conforming to current RCAHMS standards and guidelines) was carried out on the external elevations
- Drawings were produced at 1:200 scale of all elevations showing all significant architectural detail, including fabric detail, fenestration, arched openings and fixtures and fittings.
- A scaled plan (1:100) of the stable complex showing phase-development was also made.

| Recording element | Building survey | Photographic Survey |
|---------------------|-----------------|---------------------|
| External Elevations | Level 3 | Comprehensive |
| Internal Elevations | Level 3 | Comprehensive |
| Ground Plan | Level 3 | N/a |

Table 1. Specific recording requirements at the Stable Complex

Metric Survey

An accurate survey of the stable complex was carried out using an industry-standard, reflectorless Total Station. The data was downloaded using Penmap software and imported to AutoCAD 2010.

Each architectural feature recorded on elevations has been afforded a unique identifying unit number and cross-referenced to the tables within the descriptive narrative.

Standard CFA pro-forma standing building recording forms were completed for each major elevation detailing critical dimensions and other architectural features.

Photographic survey

CFA used professional standard digital photography equipment for building surveys.

A comprehensive photographic record was made and linked to a location plan showing the orientation of each photograph that was taken (Fig. 3a). Selected representative images have been incorporated into this report as appropriate (Fig. 5).

A list of all the photographs taken is produced as Appendix 2. A full set of thumbnail digital photographs is included at the rear of the report.

3. DESK-BASED ASSESSMENT

Cartographic sources

Roy's Military map of 1747-55 (Fig. 2a) depicts a rectangular building set within a rectangular field to the south of *Binns*. It is a matter of conjecture if this schematically represents the stable complex.

Forrest's map of 1818 (Fig. 2b) depicts *Offices* to the west of a walled garden. Three buildings are shown forming a crude courtyard arrangement.

The 1856 First Edition Ordnance Survey (Fig. 2c) map depicts a U-shaped courtyard arrangement of the stable block with a detached square building within the central opening. Between the west range and aforementioned square building is a circular feature interpreted as a horse engine. On the west side of the stables is another range of buildings.

The 1896 Second Edition Ordnance Survey map (Fig. 2d) shows the same U-shaped courtyard arrangement but the building shown in the central opening has been connected to the west range by a wall. Individual partitions walls are also shown. The horse engine has been removed. A pump is also depicted on the north-east side of the stables. The range of buildings on the west side of the stables has been replaced by a single rectangular dwelling with its own property boundary on its south side.

The 1904 Third Edition map (not shown) shows the same detail as that depicted on the 1896 Ordnance Survey map.

National Monuments Record of Scotland (NMRS)

The NMRS holds record NT07NE 4.02 which includes seven digital aerial photographs of the stables. Four historical photographs taken in 1985 and 1986 are also included in the record. The record also cites two historical plans for 'new cottages at stables' dated to 1914 and attributed to Dick, Peddie & MacKay, Architects, Edinburgh

Statutory List

The stable complex does not appear on Historic Scotland's Statutory List of Listed Buildings.

Bibliographic

There are no readily available on-line bibliographic sources associated with the stables.

4. STANDING BUILDING SURVEY RESULTS

4.1 Introduction

The Stable complex in plan forms a U-shaped building comprising a main west range with south and north spurs enclosing a courtyard, and a square carriage house occupying the front centre of the courtyard. The courtyard entrances at each side of the carriage house are blocked off, forming a rectangular building.

The build and character of the exterior elevations and internal units are described in narrative below, followed by a description of architectural elements, outlined in tabular form in the interests of simplicity. Interior units and architectural features such as windows, doors and vents have been ascribed unique identifiers on the architect's plan (Fig. 3a) and this convention has been carried over to the archaeological survey for simplicity of reference. An analytical discussion will follow in Section 5.

A sample key to identifiers is contained in Table 2 below, with detailed descriptions and measurements of elements provided in Appendix 1. All measurements are given in mm.

| Abbreviated Identifier | Full Identifier |
|-------------------------------|--|
| R1 | Room 1 |
| D2 | Door 2 |
| W3 | Window 3 |
| V4 | Vent 4 |
| FP1 | Fireplace 1 |
| EN | Exterior North-facing elevation |
| ICYE | Interior Courtyard East-facing elevation |
| IR7E | Interior Room 7 East-facing elevation |
| IR7W | Interior Room 7 West-facing elevation |

Table 2: Key to Unique Identifiers

4.2 Exterior

4.2.1 General

The main build of the exterior walls was broadly uniform, comprising a mix of mostly basalt with occasional sandstone. Walls are mortar bonded and constructed of a range of rough-hewn blocks and unworked rubble and boulders in a random, mostly uncoursed, build. Wall returns are framed by sandstone quoins with raised margins.

Fenestration comprises doors, archways, windows and slit vents, all of which are framed by sandstone quoins with associated sills and lintels. The quality of finish on the quoins varies according to formality of position on the building and function.

| Identifier | Element |
|------------|---------------------------------------|
| EN1 | Main build of lower wall, north range |
| EN2 | Main build of upper wall, north range |
| EN3 | Main build of gable of west range |
| EE1 | Main build of south range gable |
| EE2 | Stub of pilaster of former blind arch |
| EE3 | Main build of in-fill |
| EE4 | Central facade piers |
| EE5 | Segmented arch |
| EE6 | Main build of central facade spandrel |
| EE7 | Crenelations and upper wall build |
| EE8 | Decorative facade |
| EE9 | Main build of in-fill |
| EE10 | Main build of gable of north range |
| EE11 | Inset blind arch |
| EE12 | Roof scar |
| EE13 | Heightening of wall above roof scar |
| ES1 | Main build of west range |
| ES2 | Arched entrances |
| ES3 | Main build of south range |
| EW1 | Main build of west range |

Table 3: Elements of the External Elevations

4.2.2 North-facing Elevation (Fig. 4a)

Forms the side of the stable facing onto the main track from the East gate leading to the House of the Binns. It measures 20300mm and survives to 2900mm high. It comprises the side of the north range (EN1) and the end of the west range (EN3). The two elements are keyed together and are contemporary. The north range is 13200mm long, and the west range is 7400mm long, and is advanced by 600mm.

A levelling course runs along the elevation of the north range at a height of 2200mm. The wall remains above this course comprises smaller random basalt boulders (EN2) than in the rest of the build. It abuts the east-facing advancement of the west range indicating a secondary phase of the build. The elevation of the west range contains door D10 and window W5. The north range contains doors D11 & D12 and windows W6-W8.

4.2.3 East-facing Elevation (Fig. 4b)

Forms the main front face of the stables as presented to the east gate. It measures 31000mm long and comprises the crenelated facade of the central carriage house flanked by the gables of the south and north ranges. The spaces between the central facade have been filled in although much of this structure on the left of the central facade has collapsed. It is described from left to right (south to north) when viewed from the east.

The gable (EE1) of the south range is 7250mm long and partially survives to a height of 2400mm and is collapsed to near ground level for much of its length. The stub of a

Roman cement archivolt (EE2) indicating a former, now collapsed, blind arch was present.

The blinding wall between the south range and the central carriage house survives in part to 2750mm high and is 5800mm long. The build (EE3) is mortar bonded random rubble comprising basalt blocks. It contains the remains of a single door (D2). The remains of the wall abut the return of the south range (EE1) and the pier of the central facade (EE5).

The central facade (EE4-8) presents the focal point of the elevation and is described in full below in Section 4.3.

The blinding wall (EE9) blocking the former north entrance to the courtyard between the central facade and the north range mirrors EE3. It is mostly complete and measures 5900mm wide and 3500mm high. The main build (EE9) is mortar bonded random basalt rubble. It contains a single door (D13) which is framed by ashlar quoins. The top of the wall is crenelated. The wall abuts both the central facade pier (EE5) and the return of the north range (EE10).

The section of the east-facing elevation occupied by the north range measures 7250mm long and survives to 3600mm high. The elevation contains a blind central arch (EE11) measuring 2800mm wide and 2600mm high at its apex. The arch blinding comprises random rubble and pieces of brick and is set back 200mm from the wall face. It is unclear whether the arch is an original part of the build or has been cut later, but considering the formality of the rest of the facade, the absence of quoins framing the arch suggests it has been cut into the gable. The edge of the arch has surviving remnants of a Roman cement archivolt. The top of the arch fill also includes two upright sandstones which form the sides of a fireplace in the interior (FP3). The sills and lower quoins of two windows (W9 & W10) are visible at the top of the surviving wall, set on the former first floor level.

A roof scar (EE12) is visible at the left hand side of the elevation, above which is a remnant of a heightening of the elevation (EE13). The build of the elevation as it exists is visually messy so it seems likely that it would have been rendered or harled to present a tidy and formal appearance.

4.2.4 South-facing Elevation (Fig. 4c)

Faces open fields and measures 20000mm long. It comprises the gable of the west range and the side of the south range. The elevation of the west range is advanced by 200mm and measures 7200mm long and survives to a height of 2500mm. It is built of rough ashlar quoins which frame two entrances, each capped by a segmented arch.

The entrances measure 2200mm wide and 2250mm high at the apex. The surviving wall above the arch is built of random basalt rubble and is mortar bonded.

The elevation of the south range is 12800mm long and survives to a height of 1750mm. It contains doors D4 and D5 and windows W1 and W2.

4.2.5 *West-facing Elevation (Fig. 4d)*

The west-facing elevation (EW1) forms the back of the steading and the entire outside of the west range. It measures 32000mm long and survives up to 2500mm high. It contains three doors (D7-D9), two windows (W3 & W4) and five slit vents (V1-V5).

4.3 The Central Carriage House

This comprises the centre of the main exterior east-facing facade and fronts a sub-square building which occupies the east side of the courtyard.

4.3.1 *Central Facade: exterior east-facing elevation*

This forms the central and focal point of the east-facing elevation of the Stables Complex. It has an ornate pitched profile and it measures 4800mm wide and 6800 high at the apex and 3900mm high at the returns. The sides are formed by fine ashlar piers (EE4) supporting a segmented arch (EE5), above which is a basalt rubble built spandrel (EE6), framed by ashlar quoins. The spandrel is finished with an ornate crenelated pitched profile (EE7) and has decorative central blockwork (EE8) incorporating a circular oculus and a carved inverted ball finial device in relief. An open quatrefoil oculus is also set centrally in the spandrel directly above the apex of the segmented arch.

4.3.2 *Central Facade: interior west-facing elevation*

The build of the exterior as described above is reflected in the interior of the facade. A key difference is that the central pediment containing the inverted finial relief carving, fine ashlar stonework and decoration are absent, the spandrel build being random rubble and incorporating the two through oculi set within rougher hewn sandstone blocks.

4.3.3 *Other Exterior Elevations*

The south-, west- and north-facing elevations are built of basalt boulders in a random rattlebag build with large rough quoins at the returns.

The north and south-facing external elevations measure 5000m long and 2100mm high and abut the interior west-facing elevation of the blinding walls which block the former side entrances to the courtyard.

The south-facing elevation has a shallow pitched profile and measures 6100mm long and 3300mm at the apex.

4.3.4 *Interior: R1*

The interior of the Central Carriage House is designated R1 and is heavily overgrown with self seeding trees and nettles. No features were apparent, but it is notable that no blocked opening could be discerned in the rear, west wall of the Carriage House.

4.3.5 *Roof timbers*

A timber roof truss partially survives on the central carriage house. It is a simple design with top chords supported by a horizontal brace and is made from modern greenhouse timber.

4.4 **Interior: Courtyard, North, South and West Ranges**

4.4.1 *Interior Plan (Fig. 3a)*

The interior is divided into seven rooms (R1-R7) and a U-shaped courtyard by a series of internal walls. The U-shaped courtyard is bounded by the former exterior walls of the south, west and north ranges.

The floor surfaces are thickly overgrown with up to 1.5m high wild plants (nettle, dock, buttercup, thistle, etc) and occasional small self-seeding trees. R3 in particular is densely overgrown and no access would be possible without substantial clearance.

The interior walls are of uniform character, being mortar bonded and built of random coursed rubble. The bulk of the material is rough hewn basalt blocks and boulders, with occasional sandstone blocks randomly included. Variable surviving traces of limewash was present on the interior elevations. Individual features are listed and described below in Table 4.

The following descriptions will first outline the elevations surrounding the courtyard, then the internal character of the units, and finally describe the central carriage house.

4.4.2 *South Range: North-facing elevation.*

This elevation forms the side of the south range and bounds the south side of the courtyard. It measures 12650mm long and survives to 1800mm high for an extent of 2000mm at its intersection with the east elevation of the west range, into which the build is keyed. For the rest of its length it survives only to c.300mm above ground level and is heavily overgrown. The return at the east end is formed by ashlar quoins.

4.4.3 *West Range: East-facing elevation*

This elevation forms a side of the west range and bounds the west side of the courtyard. It measures 16600mm long and 2500mm high. The elevation contains three doors (D15-17) and four vents (V6-9).

4.4.4 *North Range: South-facing elevation*

This elevation forms a side of the north elevation and bounds the north side of the courtyard. It is 12200mm long and survives to a height of 1500mm but only for an extent of 3200mm from its intersection with the east-facing elevation of the west range, into which the build is keyed. It has collapsed or been demolished down to ground level for the rest of its length and is overgrown. Empty quoin sockets are visible in the return to the east gable of the north range.

4.4.5 *South Range*

R2 measures 12000mm by 600mm and is very heavily overgrown. No features were apparent.

4.4.6 *West Range*

R3 comprises the stable or carriage block accessed from the south side of the complex and measures 6000mm by 4300mm. It is heavily overgrown and no access was gained.

R4 measures 15000mm by 6000mm and was heavily overgrown. The interior north-facing elevation comprises an interior wall 2400mm high. It separates R4 from R3, and contains a doorway blocked with bricks (D19). The interior south-facing elevation survives as a stub of a dividing wall which abuts the main interior east-facing elevation of R4. It separates R4 from R5. R4 is accessed from the courtyard via doors D15 & D16.

R5 measures 6000mm by 5000mm. No features were noted.

R6 measures 6000mm by 4600mm and contains modern upstanding concrete livestock pens. It is linked to R7 by D18.

4.4.7 *North Range*

R7 measures 12000mm by 5800mm and contains several features on its interior west-facing elevation.

The interior west-facing elevation represents the interior of the east gable of the North Range. The wall build has partially surviving lime render finishing. Two fireplaces (FP1 & 2) occupy the ground level of the wall, and the line of the chimney from FP2 is traceable due to the dereliction. A third fireplace (FP3) is centrally situated at a height of 2m above ground level, indicating the prior existence of a loft with a level of comfort for the occupants.

5. DISCUSSION

5.1 The Stable Complex

According to the NTS little is known about the development of the estate landscape at the House of the Binns, or when the landscape park was laid out in the English style. Sir James Dalyell (1774-1841) appears to have been responsible for a reasonable amount of estate improvement. The architectural character of the stable complex would certainly place it within the late 18th century.

The east-facing elevation with its elaborate neo-classical facade including its flanking walls would have been proportionally well balanced with two blind arches set either side of the central arch and crenelated pediment. This design is repeated on the archway to the courtyard at the main House of the Binns and was created by William Burn as part of the house redesign in *c.* 1810 (D Rhodes pers. comm.).

5.2 Phasing (Fig. 3b)

Late 18th Century

The primary build is the U-shaped complex comprising the north, south and west ranges, which are contemporary in build and can be dated to the late 18th century. A secondary phase of the north range is its heightening which created a loft, likely to have been used as a domestic living space or workshop as a fireplace (FP3) was incorporated into the east gable. The date and sequence of this relative to other elements of the complex is difficult to read from the build or architecture. While the interior contains bricks within the heightening, these are as likely to be a later repair as part of the original build.

The main second phase of the complex is the building of the central coach house. Its first appearance is on the 1854 edition map. It is likely that the current structure comprises much of the original building: however, the relationships between the informal walls inside the courtyard and the formal exterior walls suggest that the building had a different earlier frontage than the current elaborate facade.

Early 19th Century

The current facade and the flanking walls blocking off the courtyard represent a main second phase of building. This indicates a shift in the function and a fundamental change in the appearance of the stables complex when approached from the east.

The construction of this phase effectively blocks access to the courtyard for carriages, although the arch of the central facade could accommodate them. However, there is no exit from the interior of the central carriage house to the courtyard, so it must be surmised that either there was access via an opening which has since been blocked and repaired in such a way to render it invisible in the wall fabric, or, more likely, that the carriage house was a self contained *cul de sac* space for a carriage and pedestrian access to the courtyard was through one of the doors (D2 & D13) in the blocking walls.

While no knowledge of the early appearance of the east-facing elevation exists, the central facade, the crenelated flanking walls and the blind arches within the gables of the north and south ranges would comprise an impressive and formal presentation frontage when approached from the east entrance gates.

Early-mid 20th Century

Relatively minor changes are observed during this phase. The roof present truss of the Central Carriage House dates to this period and is likely a replacement for the original. A door (D11) and window (W6) on the north-facing elevation are blocked and R6 is adapted for livestock use by the installation of concrete stalls.

Late 20th Century

The doorway (D19) between R3 and R4 is blocked with bricks.

5.3 General Condition Assessment

The condition of the Stable Complex is considered to be generally poor.

6. CONCLUSION AND RECOMMENDATIONS

The analytical Level 3 surveys carried out at the Stable complex has recorded the fabric detail and its formal layout.

No further survey work is required prior to future consolidation works proposed by the NTS.

A summary of the results of this project will be submitted to *Discovery and Excavation in Scotland 2013*.

7. REFERENCES

Bibliographic

English Heritage 2006 *Recording Historic Buildings - a descriptive specification*, 3rd edition. London.

Cartographic

Forrest, W 1818 *Linlithgow Shire*

Ordnance Survey First Edition 1856 Linlithgowshire Sheet II.13, 25” to the mile

Ordnance Survey Second Edition 1896 Linlithgowshire Sheet II.NW & SW, 25” to the mile

Ordnance Survey Third Edition 1904 Linlithgowshire Sheet IV, 1” to the mile

Roy, W 1747-1755 *Military Survey of Scotland.*

APPENDIX 1: Principal architectural features within the complex

| Feature No. | Location | Summary Description | Dimensions in mm (L x H) |
|-------------|----------|--|--------------------------|
| D1 | EE4-5 | Open doorway framed by finely dressed ashlar quoins and topped by a segmented arch. Forms main entrance to central carriage house. | 2900 x 3000 |
| D2 | EE3 | Open doorway. Right hand side formed by ashlar quoins. Left side is collapsed to ground level. Top/lintel absent. | 850 x N/A |
| D3 | ES3 | Open doorway. Framed by ashlar quoins with a raised surround and horizontal droving. Top/lintel absent. | 1000 x N/A |
| D4 | ES3 | Open doorway. Framed by ashlar quoins with a raised surround and horizontal droving. Top/lintel absent. | 1100 x N/A |
| D5 | ES1 | Arched stable entrance. Formed by ashlar quoins topped with a segmented arch. Decorated with raised surround and horizontal droving. | 2200 x 2350 |
| D6 | ES1 | Arched stable entrance. Formed by ashlar quoins topped with a segmented arch. Decorated with raised surround and horizontal droving. | 2200 x 2350 |
| D7 | EW1 | Open doorway. Framed by rough sandstone quoins and lintel. Decorated with a raised surround and coarse horizontal droving. | 1150 x 1250 |
| D8 | EW1 | Open doorway. Framed by rough sandstone quoins and lintel. Decorated with a raised surround and coarse horizontal droving. | 1050 x 1750 |
| D9 | EW1 | Open doorway. Framed by rough sandstone quoins and lintel. Decorated with a raised surround and coarse horizontal droving. | 1000 x 1250 |
| D10 | EN4 | Open doorway. Framed by ashlar quoins and lintel. Decorated with a raised surround and horizontal droving. | 1200 x 1850 |
| D11 | EN1 | Blocked doorway. Framed by rough sandstone quoins and lintel. Decorated with a raised surround and coarse horizontal droving. Blocked by mortar bonded sandstone randomly coursed. Possibly converted for use as a window before being wholly blocked. | 1100 x 1850 |
| D12 | EN1 | Open doorway. Framed by rough sandstone quoins and lintel. Decorated with a raised surround. | 900 x 1900 |
| D13 | EE9 | Open doorway. Framed by ashlar quoins and lintel. | 900 x 1900 |
| D14 | CY-R2 | Open doorway. East side formed by quoins of south range return. North side of doorway collapsed to ground level. | N/A |
| D15 | CY-R4 | Collapsed doorway, no structure remaining. | 1150 x N/A |
| D16 | CY-R4 | Collapsed doorway, no structure remaining. | 1050 x N/A |
| D17 | CY-R5 | Collapsed doorway, no structure remaining. | 700 x N/A |
| D18 | R6-R7 | Open doorway. North side of doorway is faced with smooth concrete. South side collapsed and top/lintel is absent. | 800 x N/A |
| D19 | R3-R4 | Blocked with brick. Top/lintel absent. | 1250 x N/A |
| W1 | ES3 | Open window. Framed by ashlar quoins and lintel with large orange sandstone sill and inset apron. Possibly a converted door as quoins are built from ground level. Decorated with raised surround and horizontal droving. | 850 x 1000 |
| W2 | ES3 | Partially surviving open window. Only the sill and lower quoins survive. Decorated with a raised surround and horizontal droving. | N/A |
| W3 | EW1 | Open window. Framed by rough sandstone quoins, lintel and sill decorated with a raised surround and coarse horizontal droving. | 700 x 1000 |

| Feature No. | Location | Summary Description | Dimensions in mm (L x H) |
|--------------------|-----------------|--|---------------------------------|
| W4 | EW1 | Open window. Framed by rough sandstone quoins, lintel and sill decorated with a raised surround and coarse horizontal droving. | 700 x 1000 |
| W5 | EN4 | Open window. Framed by rough ashlar quoins, lintel and sill and decorated with a raised surround and horizontal stugging on the quoins. | 750 x 1300 |
| W6 | EN1 | Blocked window. Framed by rough sandstone quoins, lintel and sill. Decorated with a raised surround. Blocked with random coursed mortar bonded sandstone blocks. | 750 x 1300 |
| W7 | EN1 | Open window. Framed by single sandstone side jambs, sill and lintel. Possibly slapped through the wall rather than being incorporated into the original build. | 750 x 1200 |
| W8 | EN1 | Open window. Framed by rough sandstone quoins, lintel and sill. Decorated with a raised surround. | 750 x 1200 |
| W9 | EE10 | First floor level open window framed by a sandstone sill and surviving lower rough ashlar quoins.. | 350 x N/A |
| W10 | EE10 | First floor level open window. Only the sandstone sill and a single ashlar quoin survive. | N/A |
| V1 | EW1 | Vertical slit vent. Framed by asymmetric rough quoins, splayed to the interior. | 100 x 500 |
| V2 | EW1 | Vertical slit vent. Framed by asymmetric rough quoins, splayed to the interior. Blocked by rubble. | 90 x 900 |
| V3 | EW1 | Vertical slit vent. Framed by long and short quoins with irregular decoration, possibly re-used stone. Splayed to the interior. | 90 x 900 |
| V4 | EW1 | Vertical slit vent. Framed by long and short quoins with irregular decoration, possibly re-used stone. Splayed to the interior | 90 x 900 |
| V5 | EW1 | Vertical slit vent. Framed by long and short quoins with irregular decoration, possibly re-used stone. Splayed to the interior. Blocked by rubble | 90 x 900 |
| V6 | ICYE | Vertical slit vent. Framed by asymmetric rough quoins and keyed into wall return of north range. Splayed to the interior of R5. | 90 x 900 |
| V7 | ICYE | Vertical slit vent. Framed by asymmetric rough quoins, splayed to the interior of R4. | 90 x 900 |
| V8 | ICYE | Vertical slit vent. Framed by asymmetric rough quoins, splayed to the interior. | 90 x 950 |
| V9 | ICYE | Vertical slit vent. Framed by asymmetric rough quoins and keyed into wall return of south range. Splayed to the interior. | 90 x 950 |
| V10 | IR7E | Square vent framed by rough quoins between two internal units (R6 & R7) | 330 x 330 |
| FP1 | IR7W | Ground floor fireplace built from vertical sandstone orthostats and a large sandstone lintel with a shallow rabbet carved along the outside face, possibly to accommodate a wall covering. | 900 x 950 |
| FP2 | IR71W | Ground floor fireplace built from vertical sandstone orthostats. The lintel is absent and the chimney is visible, slanting upwards towards the centre of the wall. | 900 x N/A |
| FP3 | IR71W | First floor fireplace built from vertical sandstone orthostats. The lintel is missing as is the wall above the top of the fireplace. | 900 x N/A |

APPENDIX 2: Photographic Register

| Photo No. | Subject | From | Drawing Ref. |
|-----------|---|------|----------------------|
| 1-18 | Exterior NFE (l-r) | | Architect's drawings |
| 19-54 | Exterior EFE (l-r) | | Architect's drawings |
| 55-57 | Exterior EFE details | | Architect's drawings |
| 58-89 | Exterior SFE | | Architect's drawings |
| 90-117 | Exterior WFE | | Architect's drawings |
| 118 | R1 Interior NFE | | |
| 119 | R1 Interior EFE | | |
| 120 | R1 Interior SFE | | |
| 121-126 | R1 Interior WFE and roof timber detail | | |
| 127 | R2 Interior general | NE | |
| 128 | R2 Interior NFE | | |
| 129 | R2 Interior NFE | | |
| 130 | R2 Interior NFE | | |
| 131 | R2 Interior WFE | | |
| 132 | R3 Interior general | W | |
| 133 | R3 Interior general | S | |
| 134 | R4 Interior NFE | | |
| 135-137 | R4 Interior EFE (l-r) | | |
| 138 | R4 Interior SFE | | |
| 139-141 | R4 Interior WFE (l-r) | | |
| 142 | R5 Interior NFE | | |
| 143 | R5 Interior EFE | | |
| 144 | R5 Interior SFE | | |
| 145-146 | R5 Interior WFE (l-r) | | |
| 147 | R6 Interior NFE | | |
| 148 | R6 Interior EFE | | |
| 149 | R6 Interior SFE | | |
| 150 | R6 Interior WFE | | |
| 151 | R7 Interior NFE | | |
| 152 | R7 Interior EFE | | |
| 153-157 | R7 Interior SFE (l-r) | | |
| 158-163 | R7 Interior WFE (l-r) | | |
| 164 | Courtyard Interior general | NE | |
| 165 | Courtyard Interior NFE | | |
| 166-167 | Courtyard Interior EFE (l-r) | | |
| 168 | Courtyard Interior SFE | | |
| 169-170 | Courtyard Interior, South side WFE (l-r) | | |
| 171 | Courtyard Interior, R1 Exterior detail | NW | |
| 172 | Courtyard Interior, R1 Exterior NFE | | |
| 173 | Courtyard Interior, R1 Exterior WFE | | |
| 174 | Courtyard Interior, R1 Exterior SFE | | |
| 175-177 | Courtyard Interior, South side WFE (l-r) | | |
| 178-179 | Detail: Iron door hinge, EFE | SE | |
| 180 | Detail: Door clasp, NFE | NE | |
| 181 | Detail: R1, Roof timbers. | E | |
| 182 | Detail: R1, Hinge hook | S | |
| 183 | Detail: abutment of R2 and courtyard, NFE | N | |
| 184 | Detail: Corbel, R1, EFE | E | |
| 185 | Detail: R1 exterior quoins | SE | |
| 186 | Detail: R1 exterior outshot | SE | |
| 187 | Detail: Exterior W3 | W | |
| 188 | Detail: Exterior V1 | W | |
| 189 | Detail: Exterior V2 | W | |
| 190 | Detail: Exterior D7 | W | |

| Photo No. | Subject | From | Drawing Ref. |
|------------------|---|-------------|---------------------|
| 191 | Detail: Exterior V3 | W | |
| 192 | Detail: Exterior D8 | W | |
| 193 | Detail: Exterior V4 | W | |
| 194 | Detail: Exterior D9 | W | |
| 195 | Detail: Exterior V5 | W | |
| 196 | Detail: Exterior W4 | W | |
| 197 | Detail: Exterior D10 | N | |
| 198 | Detail: Exterior W5 | N | |
| 199 | Detail: Exterior NFE Outshot quoin | N | |
| 200 | Detail: Exterior W6 | N | |
| 201 | Detail: Exterior D11 | N | |
| 202 | Detail: Exterior W7 | N | |
| 203 | Detail: Exterior D12 | N | |
| 204 | Detail: Exterior W8 | N | |
| 205 | Detail: Decorative arch, EFE | E | |
| 206 | Detail: Decorative arch, EFE | E | |
| 207 | Detail: Interior D13 | W | |
| 208 | Detail: Interior FP1 | W | |
| 209 | Detail: Interior FP3 | W | |
| 210 | Detail: Interior FP2 | W | |
| 211 | Detail: Interior FP2 & FP3 | W | |
| 212 | Detail: Wall stub and quoin sockets, R7 NFE | W | |
| 213 | Detail: Interior W7 | S | |
| 214 | Detail: Interior D11 | S | |
| 215 | Detail: Interior W5 | S | |
| 216 | Detail: Interior, concrete edge D18 | SW | |
| 217 | Detail: Interior V4 | E | |
| 218 | General view | NW | |
| 219 | General view | NE | |
| 220-227 | General view | E | |
| 228 | General view | S | |
| 229 | General view | SE | |
| 230-232 | General view | SW | |
| 233-234 | General view | N | |
| 235-238 | General view | NE | |
| 239-243 | General view from east gates | E | |

APPENDIX 3: Discovery and Excavation in Scotland

| | |
|---|---|
| LOCAL AUTHORITY: | West Lothian |
| PROJECT TITLE/SITE NAME: | The Stables Buildings, House of the Binns, Linlithgow, West Lothian |
| PROJECT CODE: | HOBF |
| PARISH: | Abercorn (West Lothian) |
| NAME OF CONTRIBUTOR: | M Cressey & S Mitchell |
| NAME OF ORGANISATION: | CFA Archaeology Ltd |
| TYPE(S) OF PROJECT: | Level 3 Standing building recording |
| NMRS NO(S): | N/A |
| SITE/MONUMENT TYPE(S): | Stables Complex |
| SIGNIFICANT FINDS: | N/A |
| NGR (2 letters, 6 figures) | NT 05029 78067 |
| START DATE (this season) | June 2013 |
| END DATE (this season) | June 2013 |
| PREVIOUS WORK (incl. DES ref.) | None |
| MAIN (NARRATIVE) DESCRIPTION: (May include information from other fields) | A Desk Based Assessment and Level 3 standing building survey were carried out on the Stables Complex on the House of the Binns Estate. The complex comprises three ranges in a U-shaped formation surrounding a courtyard and fronted by an ornate central facade facing towards the east gate of the estate. The build of the three ranges is mainly of random rubble using basalt with sandstone quoins at the returns which are noticeably of finer finish on the front, east face. The east face of the complex contains a central facade with a crenelated pitched profile and is decorated with two oculi and includes a segmented arch entrance into a central carriage house. The east-facing gables of the flanking ranges feature decorative blind arches. The interior of the complex is largely empty and heavily overgrown. The interior west-facing elevation of the north range features three in-situ fireplaces, one of which is situated on the first floor level indicating a living or working space within a loft. The overall condition of the bulk of the complex is poor. |
| PROPOSED FUTURE WORK: | None |
| CAPTION(S) FOR ILLUSTRS: | None |
| SPONSOR OR FUNDING BODY: | National Trust for Scotland |
| ADDRESS OF MAIN CONTRIBUTOR: | CFA Archaeology Ltd, Old Engine House, Eskmills Park, Musselburgh, EH21 7PQ. |
| EMAIL ADDRESS: | mressey@cfa-archaeology.co.uk |
| ARCHIVE LOCATION (intended/deposited) | Archive to be deposited in NMRS, Reports lodged with SMR and NMRS. |

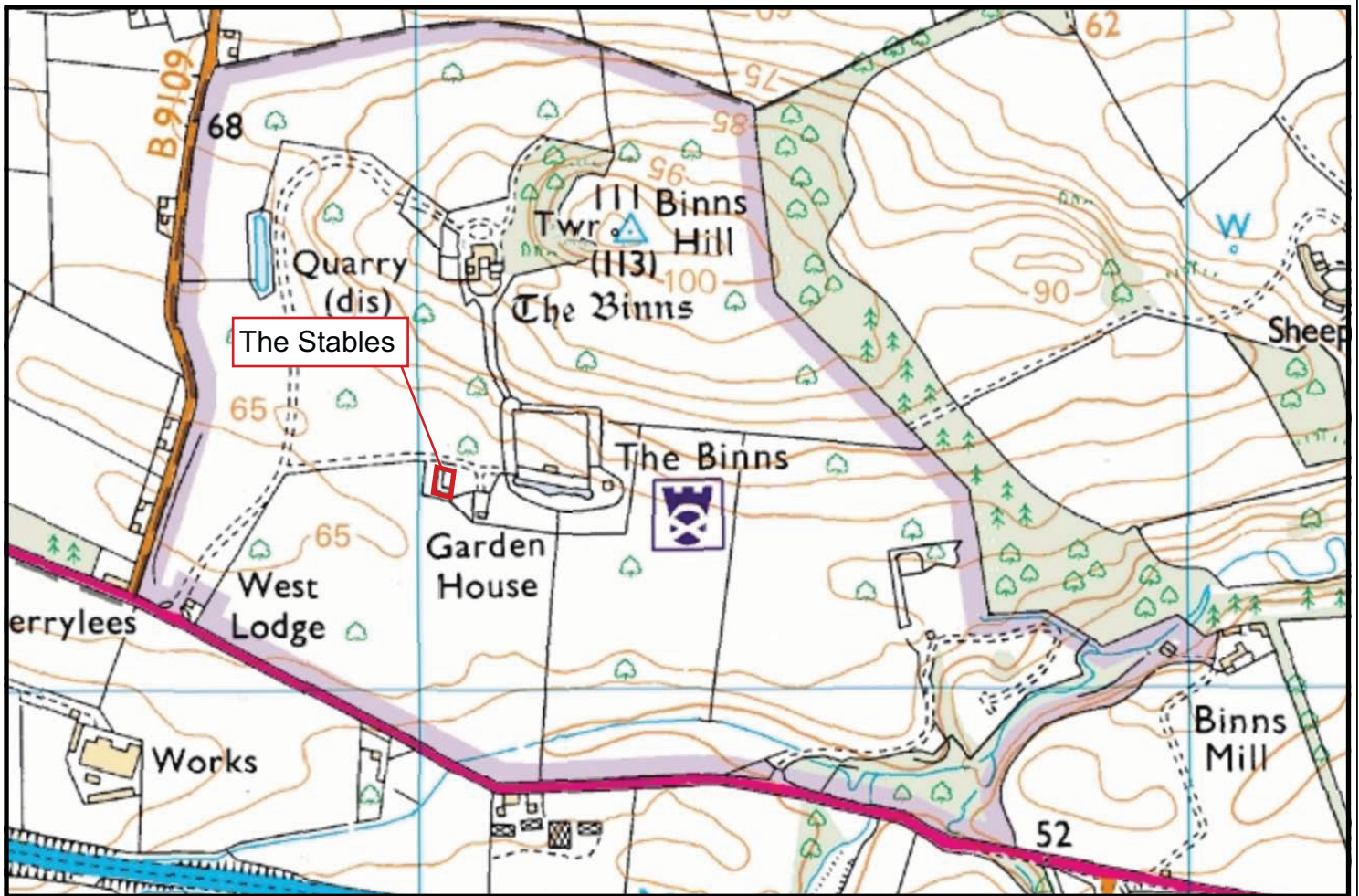

Key:

| | | | | | |
|----------|---|-----------|---|---------|-----------------------------|
| Fig. No: | 1 | Revision: | A | Client: | National Trust for Scotland |
| Title: | Site location | | | | |
| Project: | The Stables Buildings, House of The Binns, West Lothian | | | | |



CFA ARCHAEOLOGY LTD
The Old Engine House
Eskmills Park, Musselburgh
East Lothian, Eh21 7PQ
T: 0131 273 4380
F: 0131 273 4381
e: info@cfa-archaeology.co.uk
w: www.cfa-archaeology.co.uk

| | | |
|-----------|----------|------------|
| Drawn by: | Checked: | Report No: |
| TB | SM | 3037 |



Fig. 2a - Roy Military Survey of Scotland, 1747-1755



Fig. 2b - Forrest 1818

Key:

| | | |
|--|-----------------------|---|
| Fig. No: 2a-b | Revision: A | Client: National Trust for Scotland |
| Title: Map Regression | | |
| Project: The Stables Buildings, House of The Binns, West Lothian | | |



CFA ARCHAEOLOGY LTD
The Old Engine House
Eskmills Park, Musselburgh
East Lothian, EH21 7PQ
T: 0131 273 4380
F: 0131 273 4381
e: info@cfa-archaeology.co.uk
w: www.cfa-archaeology.co.uk

| | | |
|------------------------|-----------------------|---------------------------|
| Drawn by: TB | Checked: SM | Report No: 3037 |
|------------------------|-----------------------|---------------------------|

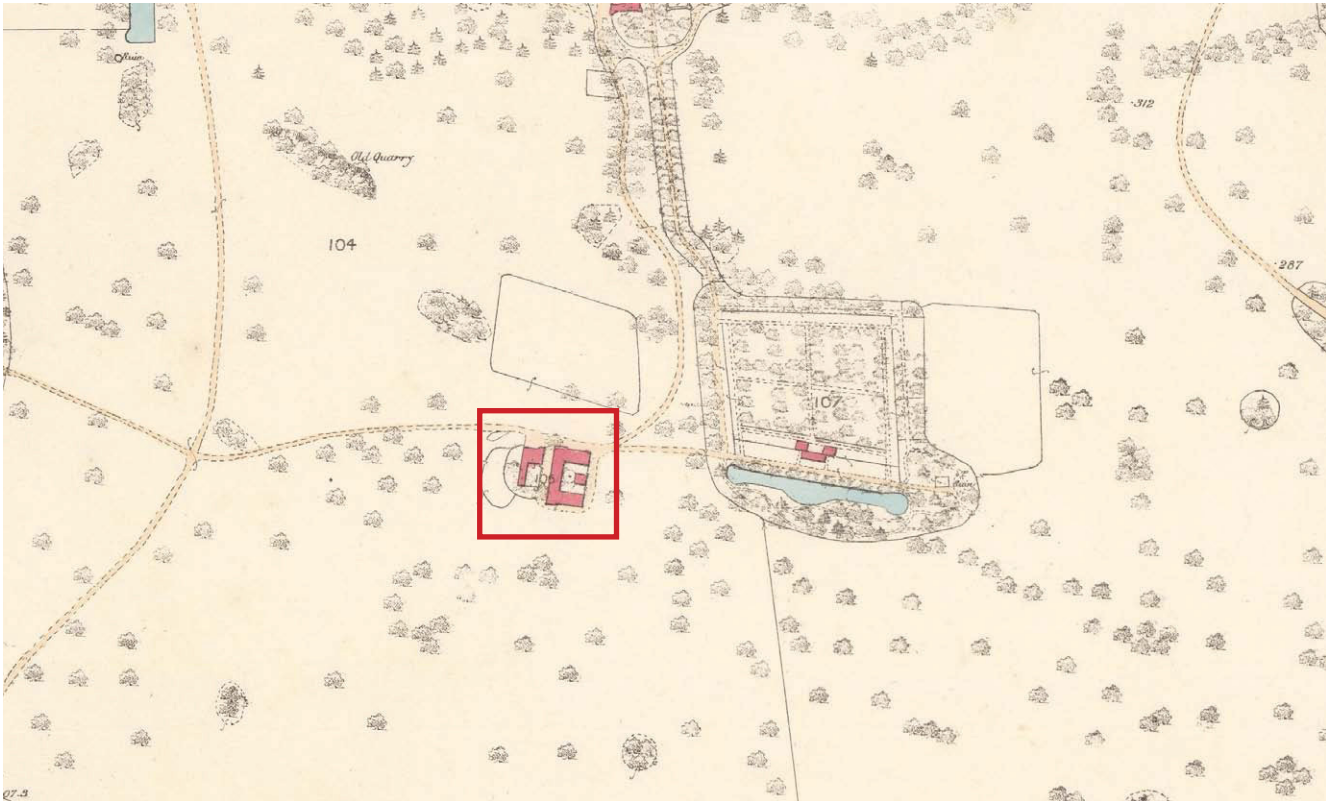

Fig. 2c - 25 inch to the mile, 1st edition OS Map, 1856



Fig. 2d - 25 inch to the mile, 2nd edition OS Map, 1896

Key:

| | | |
|--|-----------------------|---|
| Fig. No: 2c-d | Revision: A | Client: National Trust for Scotland |
| Title: Map Regression | | |
| Project: The Stables Buildings, House of the Binns, West Lothian | | |



CFA ARCHAEOLOGY LTD
The Old Engine House
Eskmills Park, Musselburgh
East Lothian, Eh21 7PQ
T: 0131 273 4380
F: 0131 273 4381
e: info@cfa-archaeology.co.uk
w: www.cfa-archaeology.co.uk

| | | |
|------------------------|-----------------------|---------------------------|
| Drawn by: TB | Checked: SM | Report No: 3037 |
|------------------------|-----------------------|---------------------------|



Fig. 2e - 1 inch to the mile, 3rd edition OS Map, 1904

Key:

| | | |
|--|-----------------------|---|
| Fig. No: 2e | Revision: A | Client: National Trust for Scotland |
| Title: Map Regression | | |
| Project: The Stables Buildings, House of The Binns, West Lothian | | |



CFA ARCHAEOLOGY LTD
The Old Engine House
Eskmills Park, Musselburgh
East Lothian, Eh21 7PQ
T: 0131 273 4380
F: 0131 273 4381
e: info@cfa-archaeology.co.uk
w: www.cfa-archaeology.co.uk

| | | |
|------------------------|-----------------------|---------------------------|
| Drawn by: TB | Checked: SM | Report No: 3037 |
|------------------------|-----------------------|---------------------------|



Key:

000



Photo locations

W0 Windows

D0 Doors

R0 Rooms

V0 Vents

fp Fire place



Fig. No: 3a Revision: A

Title: Floor plan with photograph location numbers

Project: The Stables Buildings, The House of Binns, West Lothian

Client: National Trust for Scotland

Scale at A3: 1:125

Drawn by: TB

Checked: SM

Report No: 3037



Reproduced with the permission of Ordnance Survey on behalf of The Controller of Her Majesty's Stationery Office, © Crown copyright. CFA Archaeology Ltd. Old Engine House, Eskmills Park, Musselburgh, EH21 7PO, AL100034785.

The copyright in this document (including its electronic form) shall remain vested in CFA Archaeology Ltd (CFA) but the Client shall have a licence to copy and use the document for the purpose for which it was provided. CFA shall not be liable for the use by any person of this document for any purpose other than that for which the same was provided by CFA. This document shall not be reproduced in whole or in part or relied upon by third parties for any use whatsoever without the express written authority of CFA.



Key:

-  Late 18th century
-  Early 19th century
-  Early 20th century
-  Late 20th century

CFA
ARCHAEOLOGY LTD

CFA ARCHAEOLOGY LTD
The Engine House
Esplanade, Musselburgh
East Lothian, EH21 7PQ
t 0131 273 4380
f 0131 273 4381
e info@cfaarchaeology.co.uk
www.cfaarchaeology.co.uk

Fig. No: 3b Revision: A

Title: Phased floor plan

Project:
**The Stables Buildings, The
House of Binns, West Lothian**

Client:
National Trust for Scotland

Scale at A3:
1:125

Drawn by: TB
Checked: SM
Report No: 3037

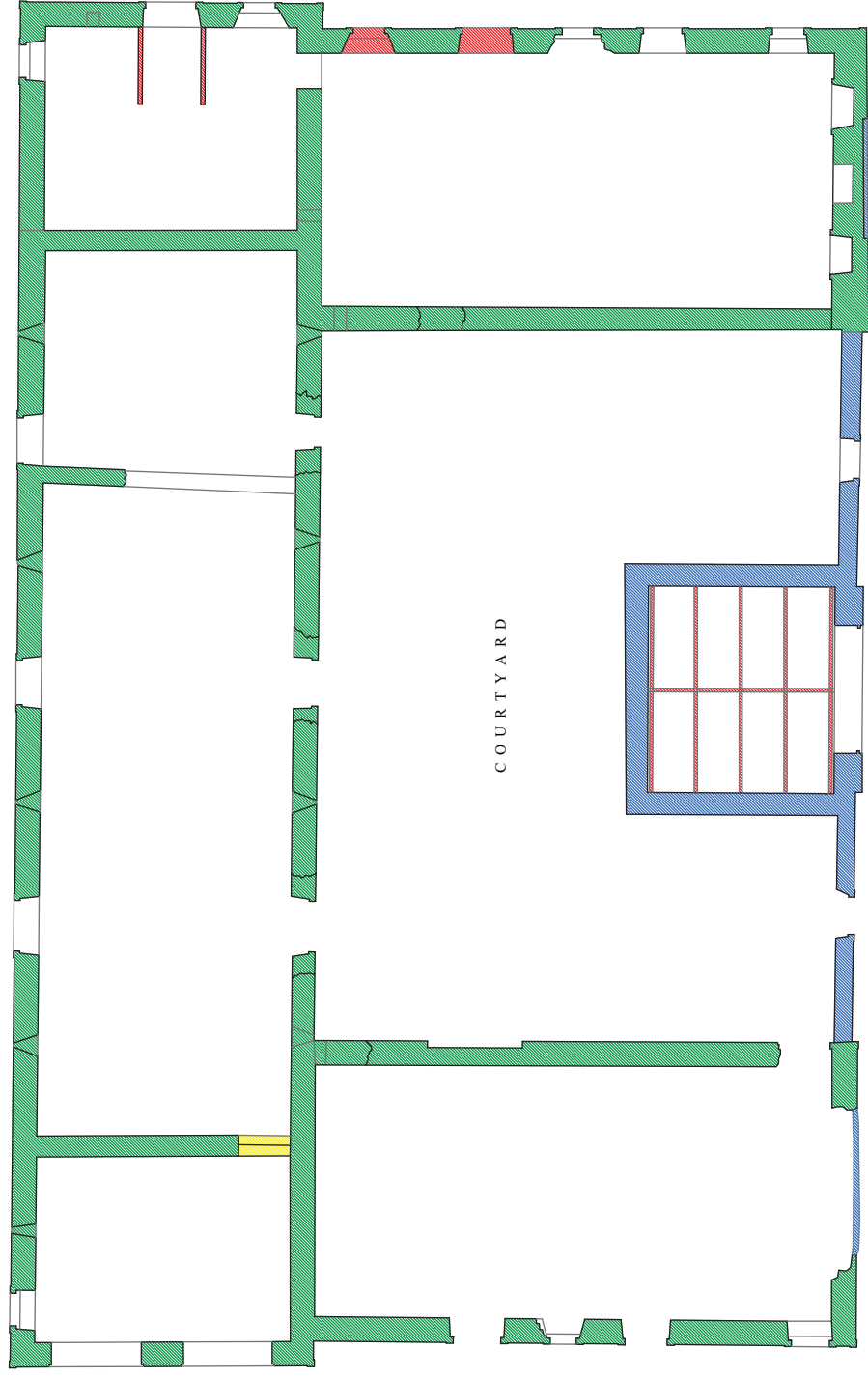



Key:

Blocked feature



CFA ARCHAEOLOGY LTD
The Old Engine House
Esplanade
Musselburgh
East Lothian, EH21 7PQ
t 0131 273 4380
f 0131 273 4381
e info@cfaarchaeology.co.uk
www.cfaarchaeology.co.uk

Fig. No: 4a-e

Revision: A

Title:
Building elevations

Project:
The Stables Buildings, The
House of Binns, West Lothian

Client:
National Trust for Scotland

Scale at A3:

1:125

Drawn by:

TB

Checked:

SM

Report No:

3037

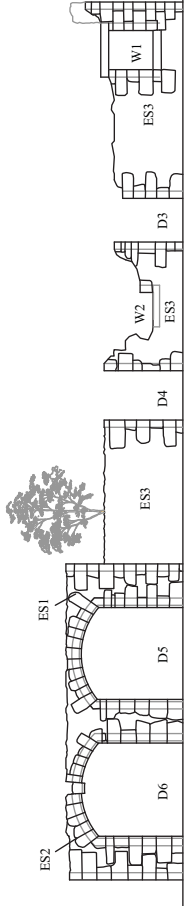

4c. - Exterior south-facing elevation

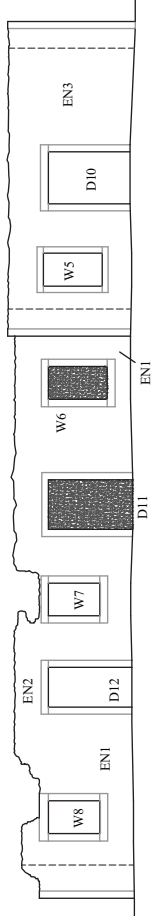

4a. - Exterior north-facing elevation

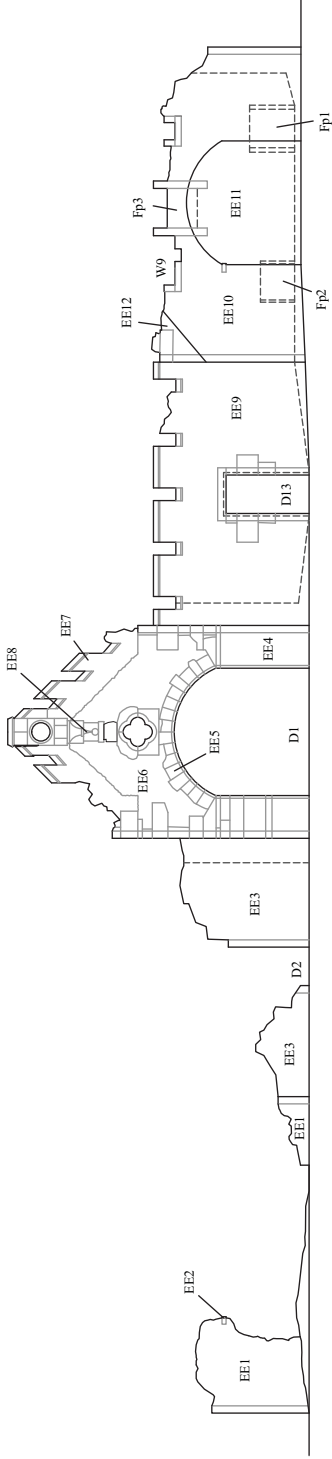

4b. - Exterior east-facing elevation

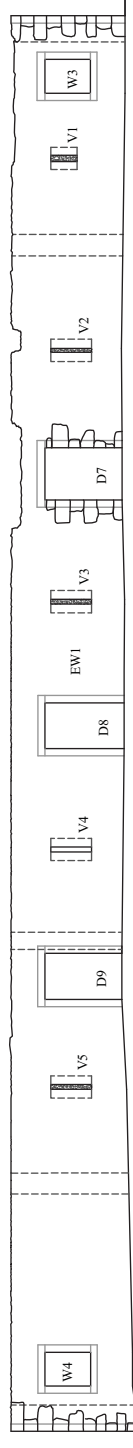

4d. - Exterior west-facing elevation

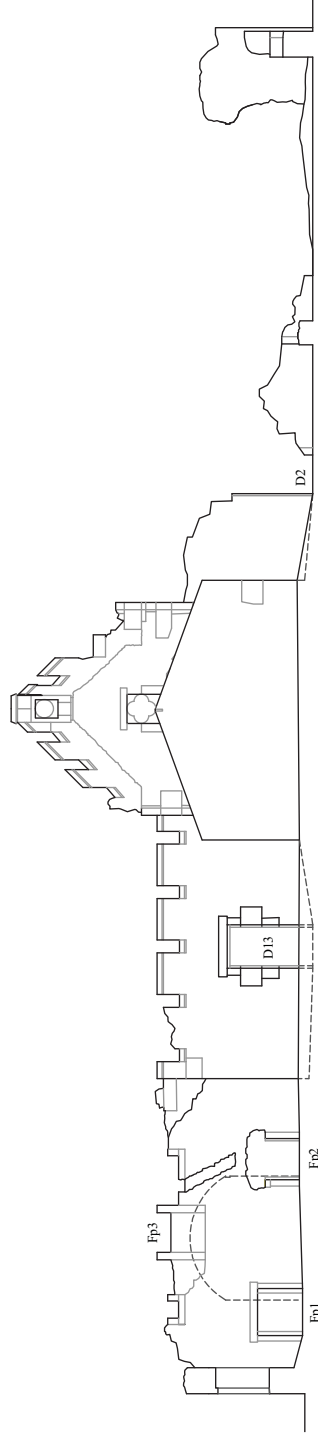

4e. - Interior west-facing elevation

0

10m



Fig. 5a - View from east gates



Fig. 5b - View from the north-east

| | | | | | |
|--|-----------------------|---------------------------|--|--|--|
| Fig No: 5a-b | | Revision: A | Project: The Stables Buildings, The House of Binns, West Lothian | | |
| Drawn by: TB | Checked: SM | Report No: 3037 | Client: National Trust for Scotland | | |
| <small>The copyright in this document (including its electronic form) shall remain vested in CFA Archaeology Ltd (CFA) but the Client shall have a licence to copy and use the document for the purpose for which it was provided. CFA shall not be liable for the use by any person of this document for any purpose other than that for which the same was provided by CFA. This document shall not be reproduced in whole or in part or relied upon by third parties for any use whatsoever without the express written authority of CFA.</small> | | | | | |

CFA ARCHAEOLOGY LTD
 The Old Engine House
 Eskmills Park, Musselburgh
 East Lothian, Eh21 7PQ
 T: 0131 273 4380
 F: 0131 273 4381
 e: info@cfa-archaeology.co.uk
 w: www.cfa-archaeology.co.uk



Fig. 5c - View from north-west



Fig. 5d - East facing elevation



| | | | |
|--|-----------------------|----------------------------|--|
| Fig No: 5c-d | | Revision: A | Project: The Stables Buildings, The House of Binns, West Lothian |
| Drawn by: TB | Checked: SM | Report No.: 3037 | Client: National Trust for Scotland |
| <p>The copyright in this document (including its electronic form) shall remain vested in CFA Archaeology Ltd (CFA) but the Client shall have a licence to copy and use the document for the purpose for which it was provided. CFA shall not be liable for the use by any person of this document for any purpose other than that for which the same was provided by CFA. This document shall not be reproduced in whole or in part or relied upon by third parties for any use whatsoever without the express written authority of CFA.</p> | | | |
| | | |  |
| | | |  |
| | | | <p>CFA ARCHAEOLOGY LTD The Old Engine House Eskmills Park, Musselburgh East Lothian, Eh21 7PQ</p> <p>T: 0131 273 4380 F: 0131 273 4381 e: info@cfa-archaeology.co.uk w: www.cfa-archaeology.co.uk</p> |



Fig. 5e - View from south-west



Fig. 5f - Detail of wall thickness and abutment between Courtyard and R2

| | | | |
|--|-----------------------|---------------------------|---|
| Fig No: 5e-f | | Revision: A | Project: The Stables Buildings, The House of Binns, West Lothian |
| Drawn by: TB | Checked: SM | Report No: 3037 | Client: National Trust for Scotland |
| <small>The copyright in this document (including its electronic form) shall remain vested in CFA Archaeology Ltd (CFA) but the Client shall have a licence to copy and use the document for the purpose for which it was provided. CFA shall not be liable for the use by any person of this document for any purpose other than that for which the same was provided by CFA. This document shall not be reproduced in whole or in part or relied upon by third parties for any use whatsoever without the express written authority of CFA.</small> | | |  <p>CFA ARCHAEOLOGY LTD</p> <p><small>CFA ARCHAEOLOGY LTD The Old Engine House Eskmills Park, Musselburgh East Lothian, Eh21 7PQ T: 0131 273 4380 F: 0131 273 4381 e: info@cfa-archaeology.co.uk w: www.cfa-archaeology.co.uk</small></p> |



Fig. 5g - Detail of surviving pilaster on EFE south range



Fig. 5h - Detail of outshot carriage entrance, SFE

| | | |
|------------------------|-----------------------|--|
| Fig No: 5g-h | Revision: A | Project: The Stables Buildings, The House of Binns, West Lothian |
| Drawn by: TB | Checked: SM | Report No.: 3037 |
| | | Client: National Trust for Scotland |



CFA
ARCHAEOLOGY LTD

CFA ARCHAEOLOGY LTD
The Old Engine House
Eskmills Park, Musselburgh
East Lothian, Eh21 7PQ

T: 0131 273 4380
F: 0131 273 4381
e: info@cfa-archaeology.co.uk
w: www.cfa-archaeology.co.uk

The copyright in this document (including its electronic form) shall remain vested in CFA Archaeology Ltd (CFA) but the Client shall have a licence to copy and use the document for the purpose for which it was provided. CFA shall not be liable for the use by any person of this document for any purpose other than that for which the same was provided by CFA. This document shall not be reproduced in whole or in part or relied upon by third parties for any use whatsoever without the express written authority of CFA.



Fig. 5i - Detail of W6



Fig. 5j - Detail of D12

| | | |
|------------------------|---------------------------|--|
| Fig No: 5i-j | Revision: A | Project: The Stables Buildings, The House of Binns, West Lothian |
| Drawn by: TB | Checked: SM | Client: National Trust for Scotland |
| | Report No: 3037 | |



CFA ARCHAEOLOGY LTD
 The Old Engine House
 Eskmills Park, Musselburgh
 East Lothian, Eh21 7PQ
 T: 0131 273 4380
 F: 0131 273 4381
 e: info@cfa-archaeology.co.uk
 w: www.cfa-archaeology.co.uk

The copyright in this document (including its electronic form) shall remain vested in CFA Archaeology Ltd (CFA) but the Client shall have a licence to copy and use the document for the purpose for which it was provided. CFA shall not be liable for the use by any person of this document for any purpose other than that for which the same was provided by CFA. This document shall not be reproduced in whole or in part or relied upon by third parties for any use whatsoever without the express written authority of CFA.



Fig. 5k - Detail of V5

| | | |
|------------------------|-----------------------|--|
| Fig No: 5k | Revision: A | Project: The Stables Buildings, The House of Binns, West Lothian |
| Drawn by: TB | Checked: SM | Report No.: 3037 |
| | | Client: National Trust for Scotland |



CFA ARCHAEOLOGY LTD
 The Old Engine House
 Eskmills Park, Musselburgh
 East Lothian, Eh21 7PQ

T: 0131 273 4380
 F: 0131 273 4381

e: info@cfa-archaeology.co.uk
 w: www.cfa-archaeology.co.uk

The copyright in this document (including its electronic form) shall remain vested in CFA Archaeology Ltd (CFA) but the Client shall have a licence to copy and use the document for the purpose for which it was provided. CFA shall not be liable for the use by any person of this document for any purpose other than that for which the same was provided by CFA. This document shall not be reproduced in whole or in part or relied upon by third parties for any use whatsoever without the express written authority of CFA.



Fig. 5l - Detail of FP1-3



Fig. 5m - View of courtyard from R7 towards R1 & R2

| | | | |
|------------------------|-----------------------|---------------------------|--|
| Fig No: 5l-m | | Revision: A | Project: The Stables Buildings, The House of Binns, West Lothian |
| Drawn by: TB | Checked: SM | Report No: 3037 | Client: National Trust for Scotland |



CFA ARCHAEOLOGY LTD
 The Old Engine House
 Eskmills Park, Musselburgh
 East Lothian, Eh21 7PQ
 T: 0131 273 4380
 F: 0131 273 4381
 e: info@cfa-archaeology.co.uk
 w: www.cfa-archaeology.co.uk

The copyright in this document (including its electronic form) shall remain vested in CFA Archaeology Ltd (CFA) but the Client shall have a licence to copy and use the document for the purpose for which it was provided. CFA shall not be liable for the use by any person of this document for any purpose other than that for which the same was provided by CFA. This document shall not be reproduced in whole or in part or relied upon by third parties for any use whatsoever without the express written authority of CFA.



HOBF_001.JPG



HOBF_002.JPG



HOBF_003.JPG



HOBF_004.JPG



HOBF_005.JPG



HOBF_006.JPG



HOBF_007.JPG



HOBF_008.JPG



HOBF_009.JPG



HOBF_010.JPG



HOBF_011.JPG



HOBF_012.JPG



HOBF_013.JPG



HOBF_014.JPG



HOBF_015.JPG



HOBF_016.JPG



HOBF_017.JPG



HOBF_018.JPG



HOBF_019.JPG



HOBF_020.JPG



HOBF_021.JPG



HOBF_022.JPG



HOBF_023.JPG



HOBF_024.JPG



HOBF_025.JPG



HOBF_026.JPG



HOBF_027.JPG



HOBF_028.JPG



HOBF_029.JPG



HOBF_030.JPG



HOBF_031.JPG



HOBF_032.JPG



HOBF_033.JPG



HOBF_034.JPG



HOBF_035.JPG



HOBF_036.JPG



HOBF_037.JPG



HOBF_038.JPG



HOBF_039.JPG



HOBF_040.JPG



HOBF_041.JPG



HOBF_042.JPG



HOBF_043.JPG



HOBF_044.JPG



HOBF_045.JPG



HOBF_046.JPG



HOBF_047.JPG



HOBF_048.JPG



HOBF_049.JPG



HOBF_050.JPG



HOBF_051.JPG



HOBF_052.JPG



HOBF_053.JPG



HOBF_054.JPG



HOBF_055.JPG



HOBF_056.JPG



HOBF_057.JPG



HOBF_058.JPG



HOBF_059.JPG



HOBF_060.JPG



HOBF_091.JPG



HOBF_092.JPG



HOBF_093.JPG



HOBF_094.JPG



HOBF_095.JPG



HOBF_096.JPG



HOBF_097.JPG



HOBF_098.JPG



HOBF_099.JPG



HOBF_100.JPG



HOBF_101.JPG



HOBF_102.JPG



HOBF_103.JPG



HOBF_104.JPG



HOBF_105.JPG



HOBF_106.JPG



HOBF_107.JPG



HOBF_108.JPG



HOBF_109.JPG



HOBF_110.JPG



HOBF_111.JPG



HOBF_112.JPG



HOBF_113.JPG



HOBF_114.JPG



HOBF_115.JPG



HOBF_116.JPG



HOBF_117.JPG



HOBF_118.JPG



HOBF_119.JPG



HOBF_120.JPG



HOBF_121.JPG



HOBF_122.JPG



HOBF_123.JPG



HOBF_124.JPG



HOBF_125.JPG



HOBF_126.JPG



HOBF_127.JPG



HOBF_128.JPG



HOBF_129.JPG



HOBF_130.JPG



HOBF_131.JPG



HOBF_132.JPG



HOBF_133.JPG



HOBF_134.JPG



HOBF_135.JPG



HOBF_136.JPG



HOBF_137.JPG



HOBF_138.JPG



HOBF_139.JPG



HOBF_140.JPG



HOBF_141.JPG



HOBF_142.JPG



HOBF_143.JPG



HOBF_144.JPG



HOBF_145.JPG



HOBF_146.JPG



HOBF_147.JPG



HOBF_148.JPG



HOBF_149.JPG



HOBF_150.JPG



HOBF_151.JPG



HOBF_152.JPG



HOBF_153.JPG



HOBF_154.JPG



HOBF_155.JPG



HOBF_156.JPG



HOBF_157.JPG



HOBF_158.JPG



HOBF_159.JPG



HOBF_160.JPG



HOBF_161.JPG



HOBF_162.JPG



HOBF_163.JPG



HOBF_164.JPG



HOBF_165.JPG



HOBF_166.JPG



HOBF_167.JPG



HOBF_168.JPG



HOBF_169.JPG



HOBF_170.JPG



HOBF_171.JPG



HOBF_172.JPG



HOBF_173.JPG



HOBF_174.JPG



HOBF_175.JPG



HOBF_176.JPG



HOBF_177.JPG



HOBF_178.JPG



HOBF_179.JPG

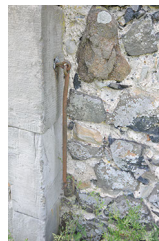

HOBF_180.JPG



HOBF_181.JPG



HOBF_182.JPG



HOBF_183.JPG



HOBF_184.JPG



HOBF_185.JPG



HOBF_186.JPG



HOBF_187.JPG



HOBF_188.JPG



HOBF_189.JPG



HOBF_190.JPG

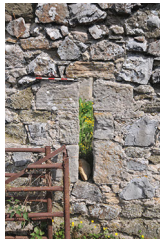

HOBF_191.JPG



HOBF_192.JPG



HOBF_193.JPG



HOBF_194.JPG



HOBF_195.JPG



HOBF_196.JPG



HOBF_197.JPG



HOBF_198.JPG



HOBF_199.JPG



HOBF_200.JPG



HOBF_201.JPG



HOBF_202.JPG



HOBF_203.JPG



HOBF_204.JPG



HOBF_205.JPG



HOBF_206.JPG



HOBF_207.JPG



HOBF_208.JPG



HOBF_209.JPG



HOBF_210.JPG



HOBF_211.JPG



HOBF_212.JPG



HOBF_213.JPG



HOBF_214.JPG



HOBF_215.JPG



HOBF_216.JPG

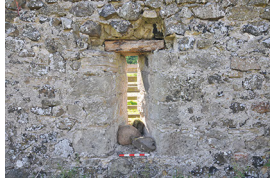

HOBF_217.JPG



HOBF_218.JPG



HOBF_219.JPG



HOBF_220.JPG



HOBF_221.JPG



HOBF_222.JPG



HOBF_223.JPG



HOBF_224.JPG



HOBF_225.JPG



HOBF_226.JPG



HOBF_227.JPG



HOBF_228.JPG



HOBF_229.JPG



HOBF_230.JPG



HOBF_231.JPG



HOBF_232.JPG



HOBF_233.JPG

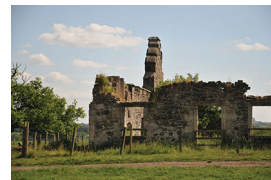

HOBF_234.JPG



HOBF_235.JPG



HOBF_236.JPG



HOBF_237.JPG



HOBF_238.JPG



HOBF_239.JPG



HOBF_240.JPG



HOBF_241.JPG



HOBF_242.JPG



HOBF_243.JPG