

CFA Archaeology Ltd

archaeological consultants

Advice on Archaeology & Planning

Environmental Impact Assessment

Interpretation, Design & Display

Finds/ Environmental Analysis

Field Evaluation & Excavation

Historic Building Recording

Site & Landscape Survey

Geophysical Survey

**Hattonmill Farm,
Frockheim,
Angus**

**Archaeological Strip and Map
Report No. 3278**

 0131 273 4380

 0131 273 4381

 info@cfa-archaeology.co.uk

 www.cfa-archaeology.co.uk

CFA ARCHAEOLOGY LTD

The Old Engine House
Eskmills Business Park
Musselburgh
East Lothian
EH21 7PQ

Tel: 0131 273 4380
Fax: 0131 273 4381
email: info@cfa-archaeology.co.uk
web: www.cfa-archaeology.co.uk

Author	Gary Savory MA
Illustrator	Tamlin Barton MA & Graeme Carruthers MA MCIfA
Editor	Tim Neighbour BSc FSA Scot MCIfA
Commissioned by	Geddes Group
Date issued	March 2015
Version	1
Oasis No.	Cfaarchaa1-207350
Grid Ref	NO 618 501, centred

This document has been prepared in accordance with CFA Archaeology Ltd standard operating procedures.

**Hattonmill Farm,
Frockheim,
Angus**

**Archaeological Strip and Map
Report No. 3278**

CONTENTS

1.	Introduction	3
2.	Working Methods	3
3.	Archaeological Results	4
4.	Finds	5
5.	Conclusions	6
6.	Reference	6

Appendices

1.	Summary of Excavated Features	7
2.	Context Register	9
3.	Drawings Register	13
4.	Summary of Finds	16
5.	Photographic Register	17
6.	Discovery and Excavation in Scotland Entry	19

Illustrations (bound at rear)

- Fig. 1 Location map and site plan
- Fig. 2 Detail of archaeological features of western section of area strip
- Fig. 3 Detail of archaeological features of middle section of area strip
- Fig. 4 Detail of archaeological features of eastern section of area strip
- Fig. 5 South-east-facing section of 2115
- Fig. 6 North-east-facing section of 2102
- Fig. 7 South-east-facing section of pits 2071 and 2073
- Fig. 8 East-south-east-facing section of 2069
- Fig. 9 West-facing section of 2077
- Fig. 10 West-facing section of 2128
- Fig. 11 South-south-east-facing of 2126
- Fig. 12 South-west-facing section of linear feature 2058

1 INTRODUCTION

1.1 General

This report presents the results of the first phase of an archaeological strip, map, record and excavation within the former scheduled area at Hattonmill Farm, Frockheim, Angus (NO 618 501, centred; Figs. 1-4). The work was commissioned by Geddes Group and undertaken by CFA Archaeology Ltd (CFA) during February and March 2015. An earlier trial trenching evaluation had been carried out by CFA in October 2014 (NMRS No: NO65SW 31, SMR No: NO65SW0031; Suddaby 2014).

A Written Scheme of Investigation (WSI) dated 27 January 2015 covering the programme of works was produced by CFA on behalf of Geddes Group and approved by the Aberdeenshire Council Archaeological Service (ACAS), who provide curatorial support to Angus Council.

1.2 Objectives

The objectives were:

- to establish the presence/absence, extent, condition, character, quality and date of any archaeological features or deposits within the proposed development area evaluation.
- To establish the vulnerability of any archaeological features the proposed development and to propose mitigation measures.

2. WORKING METHODS

2.1 General

CFA Archaeology Ltd follows the Chartered Institute for Archaeologists' Code of Conduct, Standards and Guidance for Archaeological Fieldwork. Recording of all elements followed established CFA methods.

2.2 Scope of works

It was agreed with the Aberdeenshire Council Archaeology Service (ACAS), who provide curatorial support to Angus Council, that it would be appropriate to carry out topsoil stripping under constant archaeological supervision of the former scheduled area, with any features that were revealed being mapped and recorded. Features that were revealed were to be excavated, where Geddes Group, as advised by CFA, considered it economically viable to do so. Those features that were not excavated were to be preserved in situ, fenced off within an appropriate buffer zone.

Stripping of the former scheduled area was to be conducted over several annual phases, so that just enough was cleared for each year's sand and gravel quarrying. In general each phase was to be the full extent, east to west, of the former Scheduled area and c.20m north to south.

2.3 Strip and map

Topsoil was removed by a tracked 360° mechanical excavator, equipped with a smooth-bladed ditching bucket under constant archaeological supervision. Any further excavation required to fulfil the objectives of the evaluation was carried out by hand. Feature locations were surveyed using industry standard electronic surveying equipment.

A total of 6300m² was stripped during this phase, which amounts to 32% of the former scheduled area.

3. ARCHAEOLOGICAL RESULTS

3.1 General

The following text provides descriptions of the archaeological features. Numbers in bold refer to contexts, a full list of which is presented as Appendix 2. A summary of all the excavated features is presented as Appendix 5.

Topsoil (**001**), which was 0.3m deep, overlay either subsoil (**002**) or natural sands and gravels (**003**). Much of the evaluated area appears dark on the aerial photographs and these dark areas coincided with the presence of the subsoil under the topsoil. This subsoil (**002**) was up to 0.9m deep in places, with a notably darker basal layer. Natural (**003**) consisted predominantly of sandy gravels, and there were also areas of sand and occasionally silty sand.

Overhead electricity cables near the western edge of the site resulted in a stand-off buffer zone being maintained.

3.2 Archaeological Features

Linear Features (Figs 5, 6, 7)

A curvilinear ditch (**2115**), aligned approximately east to west, measured 18m from east to west before turning north-south for 4.5m. Three sections placed transversely revealed it had an average width of 0.3m and depth of 0.2m (Fig. 3). It contained a single, dark brown silty sand fill (**2116**).

A second curvilinear ditch (**2102**) was identified which cut the north-east corner of ditch **2115**. The ditch measured 4.5m north-south before turning east-west for a further 8.5m. A section through the ditch revealed it to be 0.32m wide, surviving to a depth of 0.2m (Fig. 4). It contained a single, dark brown silty sand fill (**2103**).

Further to the east, a linear ditch (**2058**) was collinear with an elongated pit (**2084**).

Pits (Figs 8, 9, 10, 11, 12)

Pits were discovered in clusters; in pairs and in isolation. Six of the pits had fills that contained sherds of pottery (**2069, 2071, 2073, 2077, 2126** and **2128**):

An isolated cluster was formed of three pits (**2125, 2126** and **2128**). Pottery of early and late Neolithic date was found in one of the pits (**2126**). A second pit (**2028**) had a fill that contained pottery that could only be assigned a broad prehistoric date.

A cluster of ten pits (**2065, 2067, 2069, 2071, 2073, 2075, 2077, 2079, 2087** and **2091**) lay just to the east of one of the linear features (**2102**). Four of the pits had fills that contained pottery dating to the early Neolithic (**2069**), late Neolithic (**2073** and **2077**), and a sherd that could not be dated beyond a broad prehistoric date (**2071**). A line of pits (**2109, 2111** and **2113**) lay slightly to the west and a small, isolated pit (**2106**) lay between.

A cluster of five pits (**2040, 2042, 2044, 2046, 2048** and **2050**) formed a sub-circular arrangement.

Rig and furrow

The regular linear features seen on the aerial photographs were found during the stripping to be cultivation furrows, with a wavelength of between 9m and 11m and surviving to a depth of c.0.2m. Across much of the site, these furrows cut the subsoil and therefore no traces remained after the topsoil/subsoil had been removed. Where they cut the natural, their fills were removed to ensure no earlier features were concealed below them. No finds were recovered from the furrows.

4. FINDS (by Dr Melanie Johnson and Christina Hills)

Row Labels	No.	Wt (g)
Worked flint	1	3
Prehistoric Pottery	23	748
Post Medieval Pottery	1	46

Table 1- Summary of finds

A full list of the finds can be found in Appendix 4. A summary is presented in Table 1.

Prehistoric Pottery

Three body sherds from pits **2071** and **2128** have no diagnostic features and are unidentified. A rim sherd with an upright flat rim and elongated lug of an early Neolithic date was recovered from post-hole **2069**. Other pottery of Neolithic date was found in **2132**, a fill of pit **2126**. This consisted of two joining rims from an uncarinated bowl, two body sherds from an unidentified other vessel and one rim from a carinated bowl. A grooved ware vessel was found in pit **2126**, from **2134**, this had an upright flat topped rim with an external lip, a row of deep impression below the rim and multiple cordons across the body. A body sherd of grooved ware from

2078 had cordon and impressed fingernail decoration. One probable sherd of grooved ware was found in pit **2073** had cordon decoration.

Worked flint

A piece of flint recovered from topsoil (**001**) showed some evidence of working.

Post-medieval pottery

A sherd of post medieval pottery from **002** is a handle fragment of a redware vessel.

5. CONCLUSIONS

The first phase of works has identified a number of archaeological features including ditches and pits, some of which were in clusters. Some of the pits contained pottery of Neolithic date. The presence of ring-ditch structures (Suddaby 2014) to the north, within the area yet to be stripped, alongside pits which are likely to be of Neolithic pottery may indicate a multi-period use of the site.

Cultivation furrows were identified aligned north-north-east to south-south-west throughout the entire stripped area. Their wavelength is suggestive of a medieval date for these features.

Further phases of work are likely to demonstrate how the pits and ditches in this first phase area relate spatially and chronologically to the features, including ring-ditches and other features known from aerial photographs and, as yet, explored only by trial trenching evaluation (Suddaby 2014). In particular, it has to be suspected that the ditches and pits shown on Fig 3 will likely be revealed to form part of a prehistoric field system, perhaps related to the ring-ditch structures.

The project archive, comprising all CFA record sheets, maps and reports will be deposited with the National Monuments Record of Scotland (NMRS) and copies of reports will be lodged with the SMR.

A summary statement of the results of this evaluation will be submitted for publication in *Discovery and Excavation in Scotland* (Appendix 6) and an online OASIS entry submitted on completion of the project.

6. REFERENCE

Suddaby, I. 2014, *Hattonmill Farm, Frockheim, Angus. Archaeological Evaluation of Cropmarks*, CFA Archaeological Report No. 3210. Unpublished.

APPENDIX 1: Summary of Excavated Features

Feature No.	Description	Dimensions	Finds
2001	Sub-rectangular pit with one near vertical side and one gently sloping side and a concave base.	0.73m x 0.5m, 0.21m deep	
2003	Sub-oval pit with steep sloping sides and a flat base.	0.6m x 0.5m, 0.3m deep	
2006	Oval pit, aligned north-west to south-east, with one moderately sloping side and one near-vertical side and a irregular base	0.5m x 0.4m, 0.08m	
2008	Oval pit, aligned north-west to south-east, with near vertical sides and a concave base.	0.5m x 0.42m, 0.15m deep	
2010	Sub-circular pit with moderately sloping sides and a concave base.	c. 0.35m diam, 0.09m deep	
2012	Sub-circular pit with steeply sloping sides. Cuts by pit 2014.	0.2m x 0.12m, 0.07m deep	
2014	Oval pit, aligned north-east to south-west, with moderately sloping sides and a V-shaped base. Cuts pit 2012.	0.42m x 0.32m, 0.15m deep	
2016	Sub-circular pit with near vertical sides and flat base.	c. 0.2m diameter, 0.13m deep	
2018	Shallow, oval pit, aligned north-east to south-west, with gently sloping sides and a convex base.	0.2m x 0.16m, 0.05m deep	
2024	Shallow pit with very gently sloping sides and an irregular base.	0.35m x 0.3m, 0.04m deep	
2026	Shallow pit with very gently sloping sides and an irregular base.	0.35m x 0.25m, 0.03m deep	
2030	Sub-circular pit with near vertical sides and a concave base.	c. 0.21m diam, 0.19m deep	
2032	Sub-circular pit with gently sloping sides and an irregular base.	c. 0.63m diameter, 0.12m deep	
2034	Sub-circular pit with moderately sloping sides and a concave base	0.3m x 0.25m, 0.08m deep	
2036	Oval pit, aligned north-east to south-west, with gently sloping sides and an irregular base.	0.95m x 0.4m, 0.13m deep.	
2040	Sub-circular pit with near-vertical sides and flat base.	0.3m x 0.25m, 0.1m deep	
2042	Sub-rectangular pit, aligned north-west to south-east, with near-vertical sides and a flat base.	0.3m x 0.25m, 0.13m	
2044	Sub-circular depression with gently sloping sides and a concave base. Probably natural.	0.2m x 0.17m, 0.04m deep	
2046	Sub-circular pit with moderately sloping sides and a flat base	c.0.22m diam, 0.05m deep	
2048	Sub-circular pit with moderately sloping sides and a flat base.	c. 0.28m diam, 0.09m deep	
2050	Sub-circular pit with near-vertical sides and concave base.	c. 0.25m diam, 0.15m deep	
2052	Oval pit, aligned north-east to south-west, with one gently sloping side and one near-vertical side.	0.3m x 0.25m, 0.12m deep	
2056	The remains of what appears to have been an ovoid pit. This pit was cut by 2084. It has near-vertical sides and a flat base.	1.0m x 1.0m, 0.27m deep	
2058	Teardrop shaped pit with vertical sides and flat base.	9.5m MME to SSW, 1.4m wide (max), 0.18m deep	

Feature No.	Description	Dimensions	Finds
2061	Oval pit, aligned north-east to south-west, with steeply sloping sides and flat base.	1.2m x 0.72m, 0.12m deep	
2063	Small, sub-rectangular pit with near vertical sides and a flat base. Cut by 2094.	0.44m x 0.3m, 0.18m deep	
2065	Sub-circular pit	c. 0.25m diam, 0.03m deep	
2067	Sub-circular pit with gently sloping sides and a flat base.	0.72m x 0.6m, 0.14m deep	
2069	Circular pit with steeply sloping sides and a concave base.	c. 0.22m diam, 0.09m deep	Early Neolithic pottery
2071	Sub-circular pit with moderately sloping sides and a flat base. Cut by pit 2073.	0.5m x 0.46m, 0.16m deep	
2073	Irregular shaped pit with moderately sloping sides and an irregular base.	c. 0.9m NE-SW x 0.9m NW-SE, 0.4m deep	Poss. Grooved ware
2075	Sub-circular pit with moderately sloping sides and a concave base.	c. 0.28m diameter, 0.1m deep	
2077	Oval pit, aligned north-south, with moderately sloping sides and a concave base.	1.0m x 0.68m, 0.3m deep	Grooved ware sherd from 2078
2079	Sub-circular pit with very shallow sides and a concave base.	c. 0.52 diam, 0.08m deep.	
2081	Linear ditch aligned north-east to south-west. It intersects with pit 2091 but the fills were indistinguishable, so unable to ascertain phasing.	1.8m x 0.30m, 0.16m deep	
2084	Oval pit aligned north-south, with moderately sloping sides and a flat base.	1.3m x 1.0m, 0.3m	
2087	Oval pit aligned north to south. The pit has very gently sloping sided and an irregular base.	0.55m x 0.38m, 0.1m deep	
2089	Irregular shaped pit, was aligned east to west, with moderately sloping sides and a concave base. Truncated by The pit and animal burrowing on western side.	0.6m x 0.32m, 0.14m deep	
2091	Oval pit, aligned north-west to south-east, with gently sloping sides and a concave base. Intersects with ditch 2081 but fills indistinguishable so unable to ascertain phasing.	1.04m x 0.8m, 0.18m	
2094	Oval pit with near-vertical sides and a concave base.	0.52m x 0.42m, 0.38m deep	
2100	Sub-circular pit with shallow sloping sides and a flat base.	c.1.24m diam, 0.22m deep	
2102	Curvilinear ditch aligned north-east to south-west before turning north to south. Cuts ditch 2115.	16m x 0.62m (average), 0.4m deep.	
2106	Oval pit, aligned north to south, with near-vertical sides and a concave base.	0.26m x 0.21m, 0.13m deep	
2115	Linear ditch aligned mostly east to west. Cut by 2102	36m x 0.42m 0.18m deep	
2117	Circular pit with vertical sides and an irregular base.	c. 0.26m diam , 0.18m deep	
2119	Circular pit with vertical sides and a concave base.	c. 0.18m diam, 0.11m deep	
2121	Sub-rectangular pit, aligned north to south, with sloping sides and a concave base.	0.94m x 0.74m, 0.2m deep	
2123	Irregular shaped pit, aligned east to west, with gently sloping sides and an irregular base.	1.28m x 0.5m (max), 0.1m deep	

Feature No.	Description	Dimensions	Finds
2125	Circular pit with moderately sloping sides and a flat base.	c. 0.54m diam, 0.1m deep	
2126	Irregular shaped pit, aligned north-north-west to south-south-east, with steep sloping sides and a concave base.	1.1m x 1.1m, 0.34m deep	Neolithic pottery (2132). Grooved ware (2134)
2128	Circular pit with moderately sloping sides and concave base.	c. 0.68m diam, 0.23m deep	
2135	Oval pit, aligned north-west to south-east, with moderately sloping sides and an irregular base.	0.41m x 0.22m, 0.08m deep	
2137	Circular pit with moderately sloping sides and a concave base	c. 0.3m diam, 0.16m deep	
2139	Sub-circular pit with gently sloping sides and a concave base	0.25m x 0.2m, 0.06m deep	
2140	Shallow, irregular depression (probable stone hole) with gently sloping sides and an irregular base. Cut by pit 2141.	0.52m x 0.58m, 0.1m deep	
2141	Irregular shaped pit with near-vertical sides and a concave base. Cuts 2040.	0.8m x 0.7m, 0.2m deep.	
2143	Oval pit, aligned north-east to south-west, with moderately sloping sides and a flat base.	0.46m x 0.2m, 0.1m deep	
2146	Oval pit, aligned east to west, with moderately sloping sides and a flat base	0.38m x 0.22m, 0.11m deep	
2153	Not archaeological after excavation		
2154	Sub-rectangular pit, aligned north-north-east to south-south-west, with moderately sloping sides and an irregular base.	0.75m x 0.54m, 0.14m deep	
2156	Small, sub-circular pit with vertical sides and a concave base.	0.32m x 0.25m, 0.15m deep	
2157	Curvilinear ditch, aligned north-west to south-east, with near-vertical sides and a flat base.	1.9m x 0.3m, 0.1m deep	
2158	Sub-oval pit, aligned east to west, with moderately sloping sides and an irregular base.	0.9m x 0.6m, - 0.11m deep	

APPENDIX 2: Context Register

Context	Fill Of	Description
001		Topsoil
002		Subsoil
003		Natural sand and gravels
2001		Cut for sub-ovoid pit
2002	2001	Dark brown/black sandy silt with occasional sub 7cm stones
2003		Cut for sub-circular pit
2004	2003	Dark brown/grey silty sand basal
2005	2003	Dark brown/yellow silty sand with occasional sub 5cm stones
2006		Cut for sub-circular pit
2007	2006	Black silty sand with orange mottles
2008		Cut for sub-ovoid pit
2009	2008	Mid brown/orange silty sand
2010		Cut for ovoid pit
2011	2010	Mid brown/grey/orange sandy silt

Context	Fill Of	Description
2012		Cut for small sub-circular post-hole
2013	2012	Mid-dark grey/brown silty sand
2014		Cut for small sub-circular post-hole
2015	2014	Mid-dark grey/brown silty sand
2016		Cut for small sub-circular post-hole
2017	2016	Mid-dark grey/brown silty sand
2018		Cut for small sub-circular post-hole
2019	2018	Mid-dark grey/brown silty sand
2020		VOID
2021		VOID
2022		VOID
2023		VOID
2024		Cut for very small post-hole
2025	2024	Dark grey/brown silty sand
2026		Cut for sub-circular post-hole
2027	2026	Dark grey/brown silty sand
2028		VOID
2029		VOID
2030		Dark greyish brown silty sand
2031	2030	Dark brown silty sand
2032		Cut for circular pit
2033	2032	Mid brown/orange sandy silt
2034		Cut for sub-ovoid pit
2035	2034	Mid brown/orange sandy silt
2036		Sub-ovoid pit
2037	2036	Dark grey/brown silty sand
2038	2034	Dark grey/brown silty sand
2039	2038	Mid brown silty sand
2040		Cut for post-hole
2041	2040	Dark brown silty sand
2042		Cut for sub-circular post-hole
2043	2042	Dark brown silty sand
2044		Cut for sub-circular post-hole
2045	2044	Dark brown silty sand
2046		Cut for sub-circular post-hole
2047	2046	Dark brown silty sand
2048		Cut for sub-circular post-hole
2049	2048	Dark brown silty sand
2050		Cut for sub-circular post-hole
2051	2050	Dark brown silty sand
2052		Cut for sub-circular pit
2053	2052	Mid brown silty sand
2054		VOID

Context	Fill Of	Description
2055		VOID
2056		Cut for sub-rectangular pit
2057	2056	Dark brown sandy silt
2058		Cut of NNE-SSW running linear
2059	2058	Dark brown sandy silt
2060		Deposit of charcoal and dark sand
2061		Sub-rectangular pit
2062		Mid-brown sandy silt
2063		Sub-rectangular pit
2064	2063	Mid brown silty sand
2065		Cut for sub-circular pit
2066	2065	Mid-brown silty sand
2067		Cut for sub circular post-hole
2068	2067	Dark grey sandy silt
2069		Cut for sub-circular post-hole
2070	2069	Black/dark brown sandy silt
2071		Cut for sub-circular pit/post-hole
2072	2071	Mid-dark brown silty sand
2073		Cut for sub-rectangular pit
2074	2073	Dark brown sandy silt
2075		Cut for sub-circular pit/post-hole
2076	2075	Dark grey sandy silt
2077		Cut for sub-circular pit/post-hole
2078	2077	Dark grey sandy silt
2079		Cut for sub-circular pit/post-hole
2080	2079	Dark grey sandy silt
2081		Cut for curvilinear feature
2082	2081	Dark brown sandy silt
2083	2081	Light brown sand
2084		Cut for sub-circular pit
2085	2084	Mid brown silty sand
2086	2084	Mid brown very silty sand
2087		Cut for irregularly shaped pit
2088	2087	Mid grey sand
2089		Cut for sub-circular pit
2090	2089	Black/dark brown silty sand
2091		Cut for sub-circular pit
2092	2091	Black/brown dark grey silty sand
2093	2063	Mid brown sandy silt
2094		Sub-circular cut for post-hole
2095	2094	Mid-brown very silty sand
2096		Void
2097		Void

Context	Fill Of	Description
2098		Void
2099		Void
2100		Cut for large oval pit
2101	2100	Dark brown/black silty sand with charcoal and sub 10cm rocks
2102		Cut for linear ditch
2103	2102	Dark brown sandy silt
2104		Intercutting linear ditch
2105	2014	Dark brown silty sand
2106		Sub-circular cut for post-hole
2107	2106	Dark brown silty sand
2108	2106	Black/dark brown silty sand
2109		VOID
2110		VOID
2111		VOID
2112		VOID
2113		VOID
2114		VOID
2115		Cut for linear ditch
2116	2115	Dark brown silty sand fill
2117		Cut of circular pit
2118		Fill of circular pit
2119		Cut of possible post hole
2120		Fill of possible post hole
2121		Cut for sub-circular pit/possible stone-hole
2122	2121	Dark brown/faint orange silty sand with occasional sub 5cm rocks
2123		Cut for sub-ovoid pit
2124	2123	Dark brown/grey/faint orange silty sand
2125		Cut for sub-circular pit
2126		Cut for arrowhead shaped pit
2127	2125	Dark grey/brown silty sand with occasional charcoal and burnt bone
2128		Cut for egg-shaped pit
2129	2128	Dark grey/brown silty sand containing charcoal and pottery
2130	2128	Very shallow yellow-brown sand basal fill - possible eroded cut
2131	2126	Dark brown/grey gravelly sand
2132	2126	Black charcoal/silt layer containing pottery
2133	2126	Mid brown/orange sandy fill
2134	2126	Mid brown/bright orange sandy gravel - containing pottery
2135		Cut for small oval pit
2136	2135	Mid grey/brown sandy silt
2137		Cut for possible small pit
2138	2137/2139	Mid grey/brown sandy silt
2139		Cut for possible small pit
2140		Cut for possible triangular shaped pit

Context	Fill Of	Description
2141		Cut for egg-shaped pit
2142		VOID
2143		Cut for small oval pit
2144	2143	Dark orange/brown silty sand with charcoal flecks
2145	2143	Orange/brown silty sand/fine gravel
2146		Cut for oval pit
2147		Patch of charcoal/orange/brown silty sand adjacent to pit 2146
2148	2146	Orange/grey/brown silty sand
2149	2146	Mid orange/brown silty sand and gravel
2150	2140	Mid brown/orange sandy silt/gravel
2151	2141	Mid brown/grey sandy silt/gravel
2152	2141	Black/dark brown sandy silt with charcoal flecks
2153		Cut for pit - not of archaeological origin
2154		Cut for oval pit
2155	2154	Dark brown/faint orange sandy silt/gravel with charcoal flecks
2156		Cut for small pit - not of archaeological origin
2157		Cut for narrow linear ditch
2158		Cut for egg-shaped pit
2159	2156	mixed sand/gravel fill of small pit 2156
2160	2157	Dark brown silty sand and fine gravel
2161	2158	Dark brown/orange silty sand/gravel with black clumps of charcoal

APPENDIX 3: Drawings Register

Drawing Number	Sheet Number	Initials	Description/Contexts	Section/Plan	Scale
20	3	EM	NE-facing section of pit 2001	S	1:10
21	3	EM	Plan of pit 2001	P	1:10
22	3	EM	NE-facing section of pit 2003	S	01:10
23	3	EM	Plan of pit 2003	P	01:10
24	4A+B	GS	Plan of features in Eastern end of stripped area	P	01:50
25	5A+B	GS	Plan of features in mid-East part of stripped area	P	01:50
26	6	GS	SE-facing section of pit/post-hole 2010	S	01:10
27	6	GS	Plan of pit/post-hole 2010	P	01:10
28	6	GS	SW-facing section of intercutting pits 2012 and 2014	S	01:10
29	6	GS	Plan of intercutting pits 2012 and 2014	P	01:10
30	6	EM	SW facing section of post-hole 2016	S	01:10
31	6	EM	Plan of posthole 2016 post-section	P	01:10
32	6	EM	SW-facing section of post-hole/pit 2018	S	01:10
33	6	EM	Plan of post-hole/pit 2018 post-section	P	01:10
34	6	EM	S-facing section of pit 2024	S	01:10
35	6	EM	Plan of pit 2024 post-section	P	01:10

Drawing Number	Sheet Number	Initials	Description/Contexts	Section/Plan	Scale
36	6	EM	S-facing section of pit 2026	S	01:10
37	6	EM	Plan of pit 2026 post-section	P	01:10
38	6	EM	S-facing section of pit 2008	S	01:10
39	6	EM	Plan of pit 2008 post-section	P	01:10
40	6	EM	SE-facing section of pit 2006	S	01:10
41	6	EM	Plan of pit 2006 post-section	P	01:10
42	6	EM	SW-facing section of pit 2030	S	01:10
43	6	EM	Plan of pit 2030 post-section	P	01:10
44	6	EM	SSE-facing section of post-hole 2034	S	01:10
45	6	EM	Plan of post-hole 2034 post-section	P	01:10
46	6	EM	SE-facing section of pit 2036	S	01:10
47	6	EM	Plan of pit 2036 post-section	P	01:10
48	7	EM	SE-facing section post-hole 2044	S	01:10
49	7	EM	Plan of post-hole 2044 post-section	P	01:10
50	7	EM	SE-facing section of post-hole 2046	S	01:10
51	7	EM	Plan of post-hole 2046 post-section	P	01:10
52	7	EM	SE-facing section of post-hole 2048	S	01:10
53	7	EM	Plan of post-hole 2048 post-section	P	01:10
54	7	EM	N-facing section of post-hole 2050	S	01:10
55	7	EM	Plan of post-hole 2050 post-section	P	01:10
56	7	EM	NE-facing section of post-hole 2040	S	01:10
57	7	EM	Plan of post-hole 2040 post-section	P	01:10
58	7	EM	NE-facing section of post-hole 2042	S	01:10
59	7	EM	Plan of post-hole 2042 post-section	P	01:10
60	7	EM	SE-facing section of post-hole 2052	S	01:10
61	7	EM	plan of post-hole 2052 post-section	P	01:10
62	8	GS	SE-facing section of pits 2056 and 2083	S	01:10
63	8	GS	Plan of pits 2056 and 2083 post-section	P	01:10
64	8	GS	W-facing section of pit 2087	S	01:10
65	8	GS	Plan of pit 2087 post-section	P	01:10
66	8	GS	SSW-facing section of pit 2058	S	01:20
67	8	GS	Plan of pit 2058 post-section	P	01:20
68	8	GS	SW-facing section of pits 2063 and 2094	S	01:20
69	8	GS	Plan of pits 2063 and 2094 post-section	P	01:20
70	8	GS	SSW-facing section of pit 2067	S	01:20
71	8	GS	Plan of pit 2067 post-section	P	01:20
72	7	EM	ESE-facing section of post-hole 2069	S	01:20
73	7	EM	Plan of post-hole 2069	P	01:20
74	7	EM	ESE-facing section of pit 2065	S	01:20
75	7	EM	Plan of pit 2065 post-section	P	01:20
76	9	EM	SW-facing section of pit 2100	S	01:20
77	9	EM	Plan of pit 2100 post-section	P	01:20

Drawing Number	Sheet Number	Initials	Description/Contexts	Section/Plan	Scale
78	8	GS	SE-facing section of pits 2071 and 2073	S	01:20
79	8	GS	Plan of pits 2071 and 2073 post-section	P	01:20
80	8	GS	W-facing section of pit 2077	S	01:10
81	8	GS	Plan of pit 2077	P	01:10
82	10	GS	SSE-facing section of pit 2079	S	01:20
83	10	GS	Plan of pit 2079 post-section	P	01:20
84	10	EM	NNE-facing section of pit 2075	S	01:20
85	10	EM	Plan of pit 2075 post-section	P	01:20
86	10	EM	N-facing section of pit 2089	N	01:20
87	10	EM	Plan of pit 2089	P	01:20
88	9	GS	NE-facing section of pit 2091	S	01:20
89	9	GS	SW-facing section of linear 2081	S	01:10
90	9	GS	Plan of pit 2091 and linear 2081 post-sections	P	01:20
91	9	GS	E-facing section of ditch 2102	S	01:10
92	9	GS	N-facing section of post-hole 2106	S	01:10
93	9	GS	Plan of post-hole 2106 post-section	P	01:10
94	10	EM	N-facing section of intercutting ditches 2102 and 2115	S	01:10
95	10	EM	S-facing section of intercutting ditches 2102 and 2115	S	01:10
96	10	EM	Plan of intercutting ditches 2101 and 2115 post-section	P	01:10
97	9	GS	NE-facing section of pit 2061	S	01:20
98	9	GS	Plan of pit 2061 post-section	P	01:20
99	9	GS	SE-facing section of post-hole 2117	S	01:10
100	9	GS	Plan of post-hole 2117 post-section	P	01:10
101	10	EM	ENE-facing section of linear 2115 (Section 2)	S	01:10
102	10	EM	Plan of linear 2115 (Section 2) post-section	P	01:10
103	9	GS	SE facing section of post-hole 2119	S	01:10
104	9	GS	Plan of post-hole 2119 post-section	P	01:10
105	14A+B	GS/EM	General plan of features in central part of stripped area	P	0.111111
106	12A+B	GS/EM	General plan of features in western part of stripped area	P	02:40
107	10	EM	N-facing section of pit/post-hole 2121	S	01:10
108	10	EM	Plan of pit/post-hole 2121 post-section	P	01:10
109	10	EM	N-facing section of ovoid pit 2123	S	01:20
110	10	EM	Plan of pit 2123 post-section	P	01:20
111	9	IS	Plan of ditch 2115, post-section	P	01:20
112	9	IS	WNW-facing section of ditch 2115	S	01:10
113	9	IS	ESE-facing section of ditch 2115	S	01:10
114	9	IS	SW-facing section of pit 2125	S	01:20
115	9	IS	Plan of pit 2125 post-section	P	01:20
116	11	IS	W-facing section of pit 2128	S	01:10

Drawing Number	Sheet Number	Initials	Description/Contexts	Section/Plan	Scale
117	11	IS	Plan of pit 2128	P	01:20
118	10	EM	SSE-facing section of pit 2126	S	01:20
119	10	EM	Plan of pit 2126 post-section	P	01:20
120	11	IS	SW-facing section of pit 2135	S	01:10
121	11	IS	Plan of pit 2135 post-section	P	01:10
122	11	IS	W-facing section of pits 2137 and 2139	S	01:10
123	11	IS	Plan of pits 2137 and 2139 post-section	P	01:10
124	11	IS	NW-facing section of pit 2143	S	01:10
125	11	IS	Plan of pit 2143 post-section	P	01:10
126	11	IS	SSW-facing section of pit 2146	S	01:10
127	11	IS	Plan of pit 2146 post-section	P	01:10
128	10	EM	S-facing section of pit 2141	S	01:20
129	10	EM	SE-facing section showing pit 2141 cutting 2140	S	01:20
130	10	EM	Pits 2140 and 2141 post-ex plan	P	01:20
131	13	EM	ESE-facing section of pit 2154	S	01:10
132	13	EM	Plan of pit 2154 post-section	P	01:10
133	11	IS	W-facing section of pit 2153	S	01:20
134	11	IS	Plan of pit 2153 post-section	P	01:20
135	13	EM	SW-facing section of pit 2156	S	01:10
136	13	EM	Plan of pit 2156 post-section	P	01:10
137	11	IS	Plan of ditch 2157	P	01:20
138	11	IS	SSW-facing section of ditch 2157; N end	S	01:10
139	11	IS	SSW-facing section of ditch 2157; central section	S	01:10
140	11	IS	SSW-facing section of ditch 2157; S end	S	01:10
141	12	EM	S-facing section of pit 2158	S	01:10
142	12	EM	Plan of pit 2158 post-section	P	01:10

APPENDIX 4: Finds

Feature	Context	Find type	No.	Wt (g)	Notes	Spotdate
	001	Flint	1	3	Lithic	
	002	Post Medieval Pottery	1	46	Redware handle	Post medieval
2069	2070	Prehistoric Pottery	2	63	Upright flat rim with elongated lug	Early Neolithic
2071	2072	Prehistoric Pottery	2	59	Plain body sherds	Prehistoric
2073	2074	Prehistoric Pottery	1	16	Grooved ware, body sherd with cordon	3000-2500 BC
2077	2078	Prehistoric Pottery	8	147	Grooved ware, body sherd with cordon+impressed fingernail decoration	3000-2500 BC

2128	2129	Prehistoric Pottery	1	12	Plain body sherd	Prehistoric
2126	2132	Prehistoric Pottery	2	178	Uncarinated bowl (2 joining rims)	Early Neolithic
2126	2132	Prehistoric Pottery	2	24	Plain body sherds	Neolithic
2126	2132	Prehistoric Pottery	1	18	Carinated bowl	Neolithic
2126	2134	Prehistoric Pottery	4	231	Grooved ware, upright flat topped rim with external lip, row of deep impressions below the rim, multiple cordons across body	3000-2500 BC

APPENDIX 5: Photographic Register

Number	Description	From	Conditions
268	N-facing section of heavily burrowed pit 2089	N	Low sun
269	Post ex shot of 2091 and linear ditch 2081	NE	Low sun
270	Pre-ex shots of linear features 2102 and 2104	N	Low sun
271	Pre-ex shots of linear features 2102 and 2104	N	Low sun
272	Pre-ex shot of pit 2106	NE	Low sun
273	Pit 2077 general shot	ESE	Bright
274	SE-facing section of pit 2077	SE	Bright
275	Post-ex plan of pit 2077	SE	Bright
276	S-facing section of pit 2079	S	Bright
277	Post-ex plan of pit 2079	S	Bright
278	NE-facing section of pit 2091	E	Bright
279	W-facing section of linear 2081	W	Bright
280	NE-facing section of linear 2102	NE	Bright
281	Post-ex plan of linear 2102	SW	Bright
282	S-facing section of intercutting linears 2115 and 2102	S	Bright
283	N-facing section of intercutting linears 2115 and 2102	N	Bright
284	Post-ex shot of intercutting linears 2115 and 2102	S	Bright
285	ENE-facing section of linear 2115 (Section 2)	ENE	Bright
286	Post-ex plan linear 2115	ENE	Bright
287	NE-facing section of pit 2061	NE	Bright
288	Post-ex plan of pit 2061	NE	Bright
289	SE-facing section of linear 2115 (Section 3)	SE	Bright
290	Post-ex plan of linear 2115 (section 3)	SE	Bright
291	N-facing section of pit 2089	N	Bright
292	Post-ex plan of pit 2089	N	Bright
293-296	General views of stripped area as of 4/3/15	N	Overcast
297	Pre-ex shot of pit/post-hole 2121	N	Overcast
298	N-facing section of pit/post-hole 2121	N	Overcast
299	Pre-ex shot of ditch 2115 (section 4)	NE	Bright
300	Pre-ex shot of ovoid pit 2123	N	Bright

Number	Description	From	Conditions
301	N-facing section of ovoid pit 2123	N	Bright
302	General view of ditch 2115, section 4 post-ex	SE	Sun/shade
303	SE-facing section of ditch 2115, section 4	SE	Sun/shade
304	Pits 2125 and 2126 pre-ex	SW	Sun
305	Pit 2125 pre-ex	SSW	Sun
306	Pit 2126 pre-ex	SSW	Sun
307	Pit 2125 section	SW	Sun
308	Pit 2128 pre-ex	W	Overcast
309-310	SSE-facing section of pit 2126	SSE	Overcast
311	Pit 2128 section	W	Overcast
312	Pit 2128 post-ex	W	Overcast
313	Pit 2135 pre-ex	SW	Overcast
314	Pit 2135 section	SW	Overcast
315	Pits 2137 and 2139 pre-ex	WNW	Overcast
316	Working shot at pit 2126	NW	Overcast
317	Pit 2126 post-ex	SSE	Overcast
318	section of pits 2137 and 2139	WNW	Overcast
319	Pits 2140, 2141 and 2142 pre-ex	S	Overcast
320	Pit 2140 pre-ex	S	Overcast
321	Pit 2141 pre-ex	S	Overcast
322	Pit 2142 pre-ex	S	Overcast
323	Pit 2143 pre-ex	NW	Overcast
324	Pit 2143 section	NW	Overcast
325	Pit 2141 S-facing section	S	Overcast
326	Intercutting pits 2140 and 2141	SE	Overcast
327	Pit 2146 pre-ex with deposit 2147 on left	W	Overcast
328-329	SE-facing section showing 2141 cutting 2140	SE	Overcast
330	Pit 2146 section	SSW	Overcast
331	Pits 2140 and 2141 post-ex	SE	Overcast
332	Pit 2153 post-ex	W	Overcast
333	Pit 2154 pre-ex	ESE	Overcast
334	ESE-facing section of pit 2154	ESE	Overcast
335	Pit 2153 section	W	Overcast
336	Pre-ex shot of possible small pit 2156	SW	Overcast
337	Section of possible small pit 2156	SW	Overcast
338	Box section of unlikely feature 2153	W	Overcast
339	Curving ditch 2157 pre-ex	SSE	Overcast
340	Egg-shaped pit 2158 pre-ex	S	Overcast
341	S-facing section of egg-shaped pit 2158	S	Overcast
342-343	Ditch 2157 Northern section	SSW	Overcast
344	Ditch 2157 Central section	NNW	Overcast
345	Ditch 2157 Southern section	SSE	Overcast
346-349	Final shots of stripped area as of 6/3/15	Various	Overcast

APPENDIX 6: Discovery and Excavation in Scotland

LOCAL AUTHORITY:	Angus
PROJECT TITLE/SITE NAME:	Hattonmill Farm, Frockheim, Angus.
PROJECT CODE:	HARI2
PARISH:	Kinnell
NAME OF CONTRIBUTOR:	Gary Savory
NAME OF ORGANISATION:	CFA Archaeology Ltd
TYPE(S) OF PROJECT:	Strip, map and excavation
NMRS NO(S):	NO65SW 31
SITE/MONUMENT TYPE(S):	Pits, ditches
SIGNIFICANT FINDS:	Neolithic pottery
NGR (2 letters, 6 figures)	NO 618 501
START DATE (this season)	February 2015
END DATE (this season)	March 2015
PREVIOUS WORK (incl. DES ref.)	Yes cfaarchaa1-190290
MAIN (NARRATIVE) DESCRIPTION: (May include information from other fields)	An archaeological excavation identified a suite of pits, some of which contained Neolithic pottery, and two curvilinear ditches. Some of the pits formed discrete clusters, but no obvious patterns or structures could be discerned.
PROPOSED FUTURE WORK:	Yes
CAPTION(S) FOR ILLUSTRS:	None
SPONSOR OR FUNDING BODY:	Geddes Group
ADDRESS OF MAIN CONTRIBUTOR:	CFA Archaeology Ltd, Old Engine House, Eskmills Park, Musselburgh, EH21 7PQ.
EMAIL ADDRESS:	gsavory@cfa-archaeology.co.uk
ARCHIVE LOCATION (intended/deposited)	Archive to be deposited in NMRS, Reports lodged with SMR and NMRS.

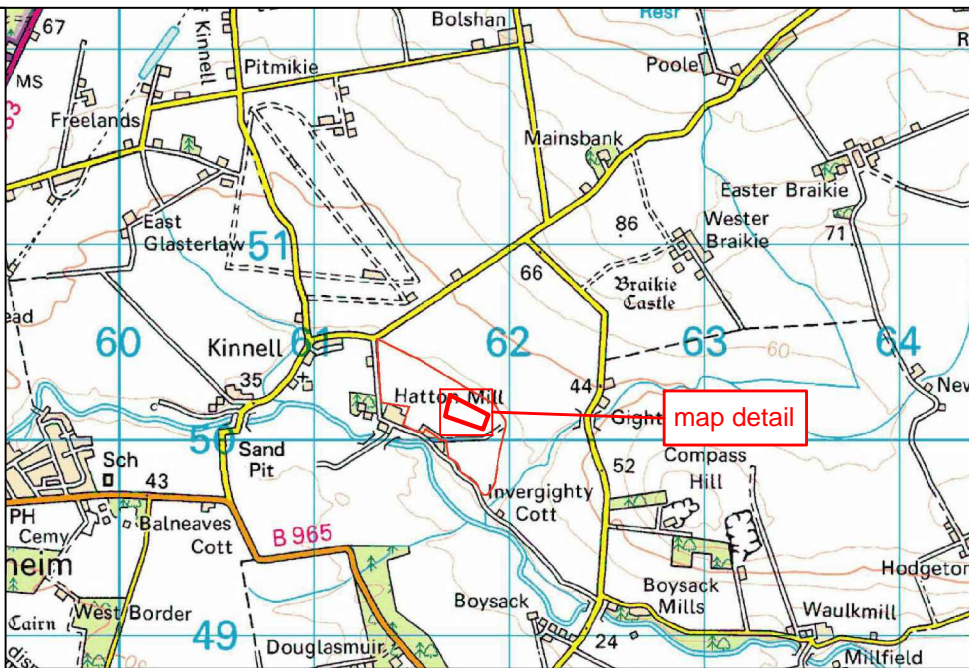
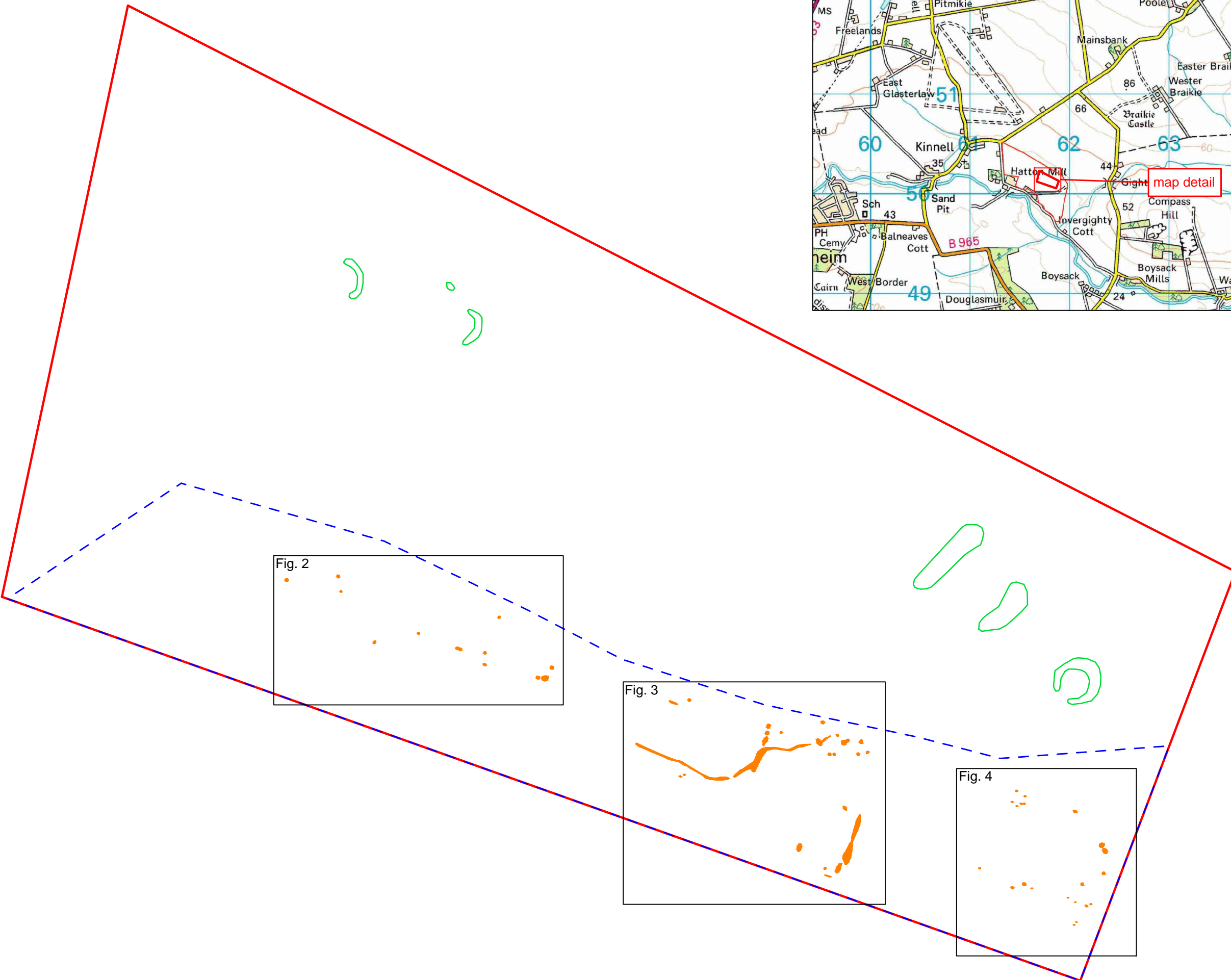

Key:

- Former Scheduled Area
- Strip and Record Area
- Features plotted from aerial photograph
- Archaeological features



CFA ARCHAEOLOGY LTD
 Old Engine House
 Eskmills Park
 Musselburgh
 East Lothian, EH21 7PQ
 T: 0131 273 4380
 F: 0131 273 4381
 info@cfa-archaeology.co.uk
 www.cfa-archaeology.co.uk

Fig. No: **1** Report No: **3278**

Title:
Location map and site plan

Project:
**Hattonmill Farm, Frockheim,
 Angus. Archaeological Strip
 and Map**

Client:
Geddes Group

Scale at A3:
1:700

Drawn by:	Checked:	Date:
SW	GS	27/03/2015

Reproduced with the permission of Ordnance Survey on behalf of The Controller of Her Majesty's Stationery Office, © Crown copyright. CFA Archaeology Ltd, Old Engine House, Eskmills Park, Musselburgh EH21 7PQ AL100034785

The copyright in this document (including its electronic form) shall remain vested in CFA Archaeology Ltd (CFA) but the Client shall have a licence to copy and use the document for the purpose for which it was provided. CFA shall not be liable for the use by any person of this document for any purpose other than that for which the same was provided by CFA. This document shall not be reproduced in whole or in part or relied upon by third parties for any use whatsoever without the express written authority of CFA.



Key:

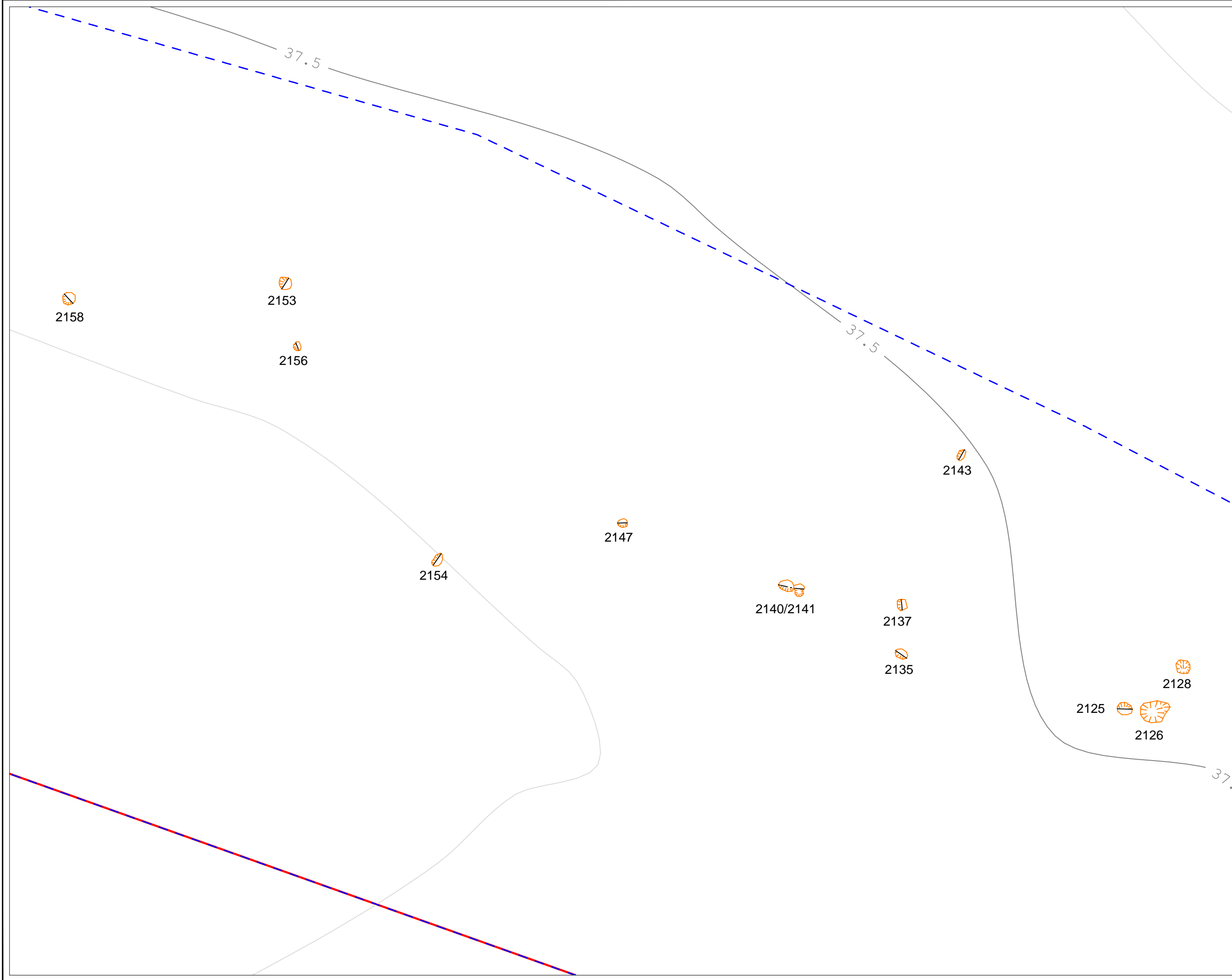

CFA ARCHAEOLOGY LTD
 Old Engine House
 Eskmills Park
 Musselburgh
 East Lothian, EH21 7PQ
 T: 0131 273 4380
 F: 0131 273 4381
 info@cfa-archaeology.co.uk
 www.cfa-archaeology.co.uk

Fig. No:	2	Report No:	3278
----------	---	------------	------

Title:
Detail of archaeological features of western section of area strip

Project:
Hattonmill Farm, Frockheim, Angus. Archaeological Strip and Map

Client:
Geddes Group

Scale at A3:
1:150

Drawn by:	Checked:	Date:
GC	SW	10/04/2015

Reproduced with the permission of Ordnance Survey on behalf of The Controller of Her Majesty's Stationery Office, © Crown copyright. CFA Archaeology Ltd, Old Engine House, Eskmills Park, Musselburgh EH21 7PQ AL100034785

The copyright in this document (including its electronic form) shall remain vested in CFA Archaeology Ltd (CFA) but the Client shall have a licence to copy and use the document for the purpose for which it was provided. CFA shall not be liable for the use by any person of this document for any purpose other than that for which the same was provided by CFA. This document shall not be reproduced in whole or in part or relied upon by third parties for any use whatsoever without the express written authority of CFA.



Key:

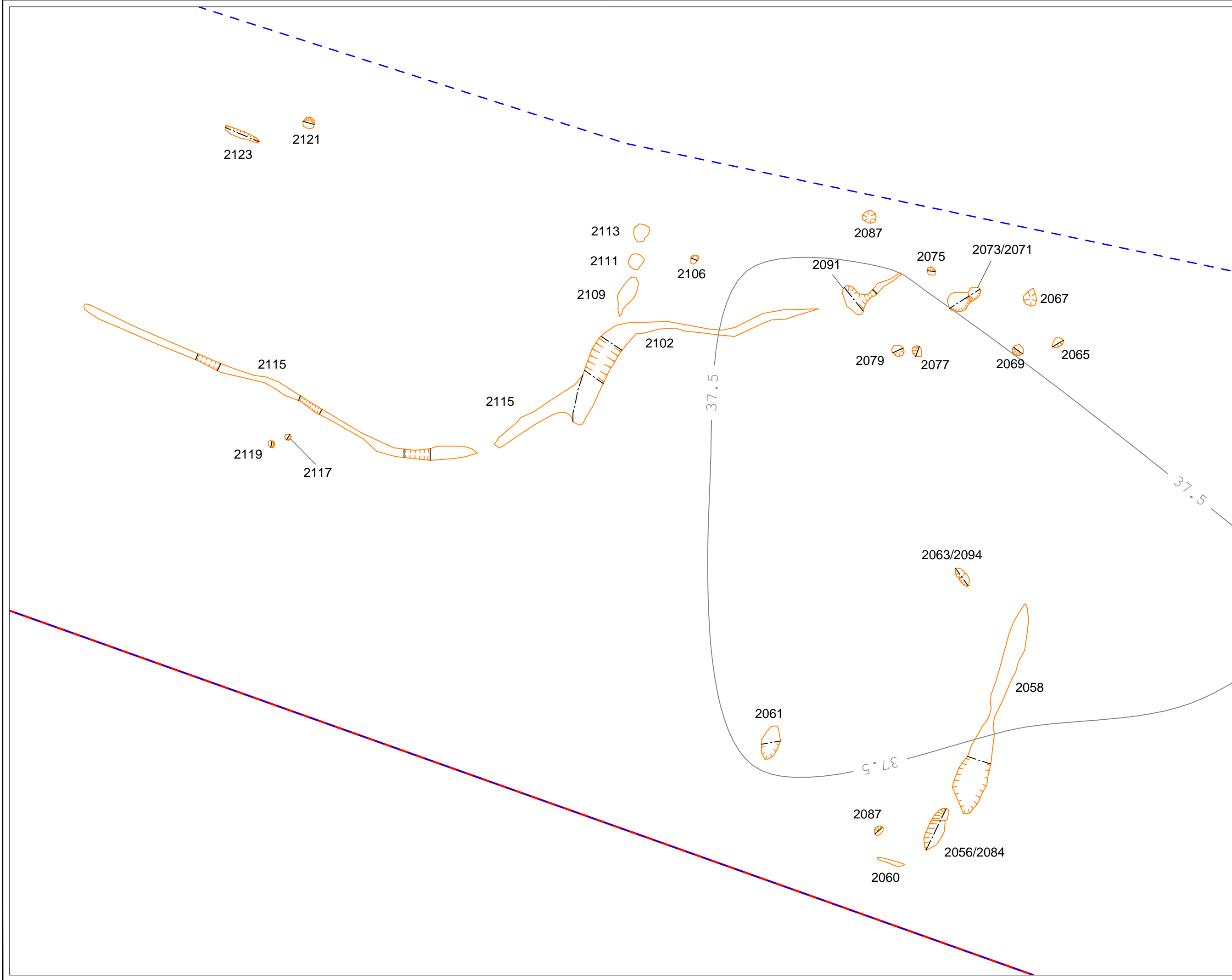

CFA ARCHAEOLOGY LTD
 Old Engine House
 Eskmills Park
 Musselburgh
 East Lothian, EH21 7PQ
 T: 0131 273 4380
 F: 0131 273 4381
 info@cfa-archaeology.co.uk
 www.cfa-archaeology.co.uk

Fig. No:	3	Report No:	3278
----------	----------	------------	-------------

Title:
Detail of archaeological features of middle section of area strip

Project:
Hattonmill Farm, Frockheim, Angus. Archaeological Strip and Map

Client:
Geddes Group

Scale at A3:
1:150

Drawn by:	Checked:	Date:
GC	SW	10/04/2015

Reproduced with the permission of Ordnance Survey on behalf of The Controller of Her Majesty's Stationery Office, © Crown copyright. CFA Archaeology Ltd, Old Engine House, Eskmills Park, Musselburgh EH21 7PQ AL100034785

The copyright in this document (including its electronic form) shall remain vested in CFA Archaeology Ltd (CFA) but the Client shall have a licence to copy and use the document for the purpose for which it was provided. CFA shall not be liable for the use by any person of this document for any purpose other than that for which the same was provided by CFA. This document shall not be reproduced in whole or in part or relied upon by third parties for any use whatsoever without the express written authority of CFA.

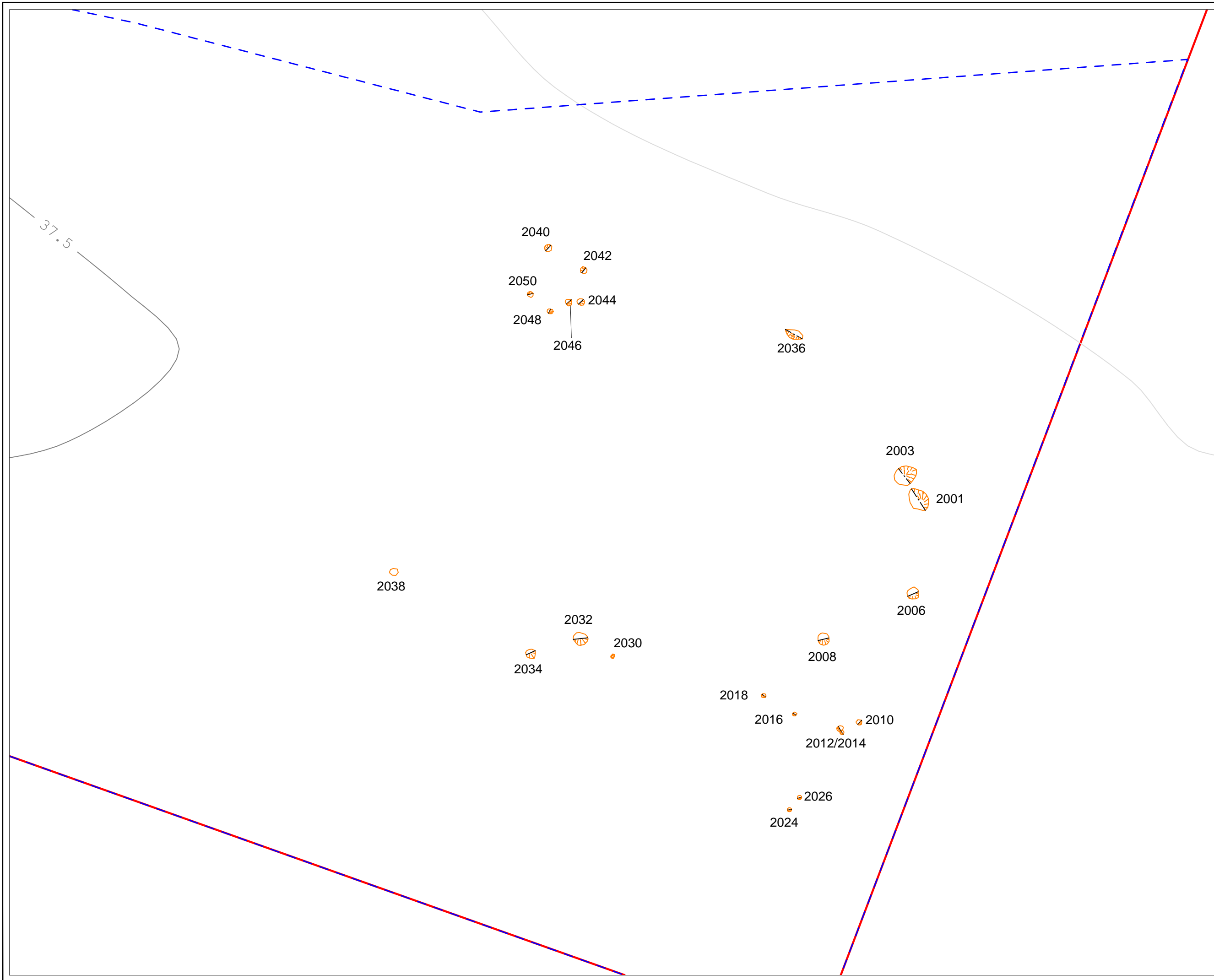

Key:



CFA ARCHAEOLOGY LTD
 Old Engine House
 Eskmills Park
 Musselburgh
 East Lothian, EH21 7PQ
 T: 0131 273 4380
 F: 0131 273 4381
 info@cfa-archaeology.co.uk
 www.cfa-archaeology.co.uk

Fig. No: 4 Report No: 3278

Title:
Detail of archaeological features of eastern section of area strip

Project:
Hattonmill Farm, Frockheim, Angus. Archaeological Strip and Map

Client:
Geddes Group

Scale at A3:
1:150

Drawn by:	Checked:	Date:
GC	SW	10/04/2015

Reproduced with the permission of Ordnance Survey on behalf of The Controller of Her Majesty's Stationery Office, © Crown copyright. CFA Archaeology Ltd, Old Engine House, Eskmills Park, Musselburgh EH21 7PQ AL100034785

The copyright in this document (including its electronic form) shall remain vested in CFA Archaeology Ltd (CFA) but the Client shall have a licence to copy and use the document for the purpose for which it was provided. CFA shall not be liable for the use by any person of this document for any purpose other than that for which the same was provided by CFA. This document shall not be reproduced in whole or in part or relied upon by third parties for any use whatsoever without the express written authority of CFA.



Fig. 5 - South-east-facing section of 2115



Fig. 6 - North-east-facing section of 2102



Fig. 7 - South-east-facing section of 2069



CFA ARCHAEOLOGY LTD
 Old Engine House
 Eskmills Park
 Musselburgh
 East Lothian, EH21 7PQ
 T: 0131 273 4380
 F: 0131 273 4381
 info@cfa-archaeology.co.uk
 www.cfa-archaeology.co.uk

Title:	Fig. 5 - 7	Report: 3278	Drawn: SW	CKD: GS	Date: 13/04/15
Client:	Geddes Group				
Project:	Hattonmill Farm, Frockheim, Angus, Archaeological Strip and Map				

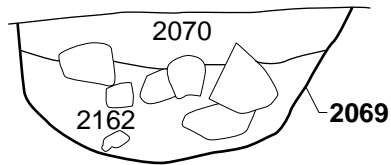

Fig. 8 - East-south-east-facing section of 2069

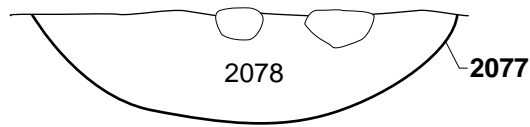

Fig. 9 - West-facing section of 2077



Scale @ 1:20



CFA ARCHAEOLOGY LTD
 Old Engine House
 Eskmills Park
 Musselburgh
 East Lothian, EH21 7PQ
 T: 0131 273 4380
 F: 0131 273 4381
 info@cfa-archaeology.co.uk
 www.cfa-archaeology.co.uk

Title:	Fig. 8 - 9	Report: 3278	Drawn: SW	CKD: GS	Date: 13/04/15
	Client: Geddes Group				
Project: Hattonmill Farm, Frockheim, Angus, Archaeological Strip and Map					



Fig. 10 - West-facing section of 2128



Fig. 11 - South-south-east-facing section of 2126



Fig. 12 - South-west-facing section of linear feature 2058



CFA ARCHAEOLOGY LTD
 Old Engine House
 Eskmills Park
 Musselburgh
 East Lothian, EH21 7PQ
 T: 0131 273 4380
 F: 0131 273 4381
 info@cfa-archaeology.co.uk
 www.cfa-archaeology.co.uk

Title:	Fig. 10 - 12	Report: 3278	Drawn: SW	CKD: GS	Date: 13/04/15
Client:	Geddes Group				
Project:	Hattonmill Farm, Frockheim, Angus, Archaeological Strip and Map				