

# CFA Archaeology Ltd

*archaeological consultants*

*Advice on Archaeology & Planning*

*Environmental Impact Assessment*

*Interpretation, Design & Display*

*Finds/ Environmental Analysis*

*Field Evaluation & Excavation*

*Historic Building Recording*

*Site & Landscape Survey*

*Geophysical Survey*

**Proposed Conservatory  
6 Grannus Mews, Inveresk  
Musselburgh**

**Archaeological Watching Brief**

**Report No. 3552**

 0131 273 4380

 0131 273 4381

 [info@cfa-archaeology.co.uk](mailto:info@cfa-archaeology.co.uk)

 [www.cfa-archaeology.co.uk](http://www.cfa-archaeology.co.uk)

## CFA ARCHAEOLOGY LTD

Old Engine House  
Eskmills Park  
Musselburgh  
East Lothian  
EH21 7PQ

Tel: 0131 273 4380  
Fax: 0131 273 4381  
email: [Edinburgh@cfa-archaeology.co.uk](mailto:Edinburgh@cfa-archaeology.co.uk)  
web: [www.cfa-archaeology.co.uk](http://www.cfa-archaeology.co.uk)

Author	Magnus Kirby MA FSA Scot ACIfA
Illustrator	Graeme Carruthers MA MIfA
Approver	Bruce Glendinning BSc PgDip MCIfA
Commissioned by	Mr Ian Orr
Date issued	May 2017
OASIS Reference	cfaarcha1-284440
Planning Ref. No.	16/01043/P
Version	1
Grid Ref	NT 3453 7201

This document has been prepared in accordance with CFA Archaeology Ltd standard operating procedures.

**Proposed Conservatory  
6 Grannus Mews, Inveresk  
Musselburgh**

**Archaeological Watching Brief**

**Report No. 3552**

## **CONTENTS**

1.	Introduction	3
2.	Working Methods	4
3.	Archaeological Results	4
4.	Conclusions	5

## **Appendices**

1.	Photograph Register	6
2.	Context Register	6
3.	Discovery and Excavation in Scotland Entry	7

## **Illustrations (bound at rear)**

Fig. 1 Location map and site plan showing foundation trenches monitored

Fig. 2 Pre-excavation shot of area

Fig. 3 Southernmost foundation trench excavated to concrete 003

Fig. 4 Westernmost foundation trench excavated to natural substratum

Fig. 5 Northernmost foundation trench excavated to natural substratum

## **1. INTRODUCTION**

### **1.1 General**

This report presents the results of an archaeological watching brief carried out by CFA Archaeology Ltd (CFA) in April 2017 for a proposed conservatory at 6 Grannus Mews, Inveresk, Musselburgh, East Lothian (Fig. 1) (NGR: NT 3453 7201). The work was commissioned by Mr Ian Orr.

A Written Scheme of Investigations (WSI) dated 10 April 2017 was produced by CFA for this programme of works. The WSI was designed to fulfil the terms of the Scheduled Monument Consent (SMC) and was agreed with Historic Environment Scotland (HES) in advance of the work taking place.

### **1.2 Background**

Planning permission (Ref. No.16/01043/P) was granted for the construction of a conservatory at 6 Grannus Mews, Inveresk within the area of the Scheduled Monument known as Inveresk, Roman civil settlement W of Inveresk Gate (Scheduled Monument Index No. 3293). Scheduled Monument Consent (Case ID 300019149) was granted by HES containing a condition that an archaeological watching brief was undertaken during all groundbreaking works

The Scheduled Monument was part of an extensive Roman civil settlement and survived as buried archaeological deposits and features. It was situated adjacent to Inveresk Roman fort (SAM No.3285), which dated to the Antonine period of Roman occupation (2<sup>nd</sup> century AD). This was a significant Roman settlement close to the eastern terminal of the Antonine Wall and was considered to be of National Importance.

The conservatory was situated to the rear of 6 Grannus Mews, which formed part of a modern gated development (built c.1999) located within the grounds of Inveresk Gate. Inveresk Gate is a Category C-Listed 18<sup>th</sup> century villa (LB No.10933), which was originally known as Rosebank. Prior to the construction of the conservatory the area largely consisted of the rear steps to the property along with a path constructed from concrete paving slabs (Fig. 2).

### **1.3 Objectives**

The objectives of the programme of archaeological works were:

- To conduct an appropriate programme of archaeological investigation (watching brief) to monitor groundbreaking works.
- To mitigate the effects of construction on any archaeological deposits or features identified during the watching brief by excavation and recording and to produce a report on them.

## **2. WORKING METHODS**

### **2.1 General**

CFA follows the Chartered Institute for Archaeologists' Code of Conduct, Standards and Guidelines as appropriate. Recording of all elements was carried out following established methods.

### **2.2 Watching Brief**

Strip foundations measuring 4.1m by 4m were excavated along the three external sides of the conservatory (Fig. 1). The foundation trenches had a width of c.0.75m and were excavated to the natural undisturbed subsoil. The ground-breaking works were undertaken using a micro digger. All ground-breaking works were carried out under constant archaeological supervision. Any further work required to fulfil the terms of the WSI were carried out by hand.

All excavation and on-site recording was carried out according to standard CFA procedures, principally by drawing, by photography and by completing standard CFA record forms.

## **3. ARCHAEOLOGICAL RESULTS**

Numbers in bold refer to contexts, a full list of which is contained in Appendix 1.

The deposits within the footprint of the conservatory consisted of 1m-1.1m of modern made-ground (**001**) overlying a natural undisturbed subsoil (**002**) consisting of reddish-orange sand (Figs. 4 and 5). At the base of the southernmost east to west aligned foundation trench there was a modern concrete surface (**003**) (Fig. 3) following the boundary line between 6 Grannus Mews and the adjoining 5 Grannus Mews. There were no features, deposits or artifacts of archaeological significance identified.

#### 4. CONCLUSION

A watching brief was carried out by CFA Archaeology Ltd within the Scheduled Area associated with the Inveresk Roman civil settlement during ground-works for a new conservatory at 6 Grannus Mews. The deposits within the footprint of the conservatory consisted entirely of made-ground suggesting that the area in which it was situated had been landscaped when the house was originally constructed. Natural sand was identified at a depth of c.1m, but there were no features, deposits or artifacts of archaeological significance identified.

CFA recommends that no further work is required in relation to this watching brief. However, it is understood that the final decision regarding mitigation measures lies with HES.

The project archive, comprising all CFA record sheets, maps and reports, will be deposited with Historic Environment Scotland (HES) and copies of reports will be lodged with East Lothian Council Sites and Monuments Record.

A summary statement will be submitted for publication in *Discovery and Excavation in Scotland* (Appendix 3) and will also be reported on through *OASIS Scotland*.

## APPENDIX 1: Photographic Register

Photo No.	Description	Taken From
1-2	Pre-excavation shots of development area	NW
3	General working shot	NW
4	Southernmost foundation trench	SW
5	Section of foundation trench showing made-ground deposits	S
6-18	General shots of foundation trenches	Various
19	General post-excavation shot of conservatory footprint	NW
20	Northernmost trench fully excavated	W

## APPENDIX 2: Context Register

Context no.	Fill of	Description
001	N/A	Modern made-ground: layers of hardcore and silty sandy made ground containing modern concrete slabs etc
002	N/A	Natural: reddish orange sand
003	N/A	Modern concrete surface or foundation

### APPENDIX 3: Discovery and Excavation in Scotland Entry

<b>LOCAL AUTHORITY:</b>	East Lothian
<b>PROJECT TITLE/SITE NAME:</b>	Proposed Conservatory, 6 Grannus Mews, Inveresk, Musselburgh
<b>PROJECT CODE:</b>	COGR
<b>PARISH:</b>	Inveresk
<b>NAME OF CONTRIBUTOR:</b>	Magnus Kirby
<b>NAME OF ORGANISATION:</b>	CFA Archaeology Ltd
<b>TYPE(S) OF PROJECT:</b>	Watching Brief
<b>NMRS NO(S):</b>	N/A
<b>SITE/MONUMENT TYPE(S):</b>	N/A
<b>SIGNIFICANT FINDS:</b>	N/A
<b>NGR (2 letters, 6 figures)</b>	NT 3453 7201
<b>START DATE (this season)</b>	April 2017
<b>END DATE (this season)</b>	April 2017
<b>PREVIOUS WORK (incl. DES ref.)</b>	None
<b>MAIN (NARRATIVE) DESCRIPTION:</b> (May include information from other fields)	A watching brief was carried out by CFA Archaeology Ltd within the Scheduled Area associated with the Inveresk Roman civil settlement during ground-works for a new conservatory at 6 Grannus Mews. The deposits within the footprint of the conservatory consisted entirely of made-ground suggesting that the area in which it was situated had been landscaped when the house was originally constructed. Natural sand was identified at a depth of c.1m, but there were no features, deposits or artifacts of archaeological significance identified.
<b>PROPOSED FUTURE WORK:</b>	None
<b>CAPTION(S) FOR ILLUSTRS:</b>	None
<b>SPONSOR OR FUNDING BODY:</b>	Mr and Mrs I. Orr
<b>ADDRESS OF MAIN CONTRIBUTOR:</b>	CFA Archaeology Ltd, Old Engine House, Eskmills Park, Musselburgh, EH21 7PQ.
<b>EMAIL ADDRESS:</b>	<a href="mailto:cfa@cfa-archaeology.co.uk">cfa@cfa-archaeology.co.uk</a>
<b>ARCHIVE LOCATION (intended/deposited)</b>	Archive to be deposited with HES, Reports lodged with SMR.



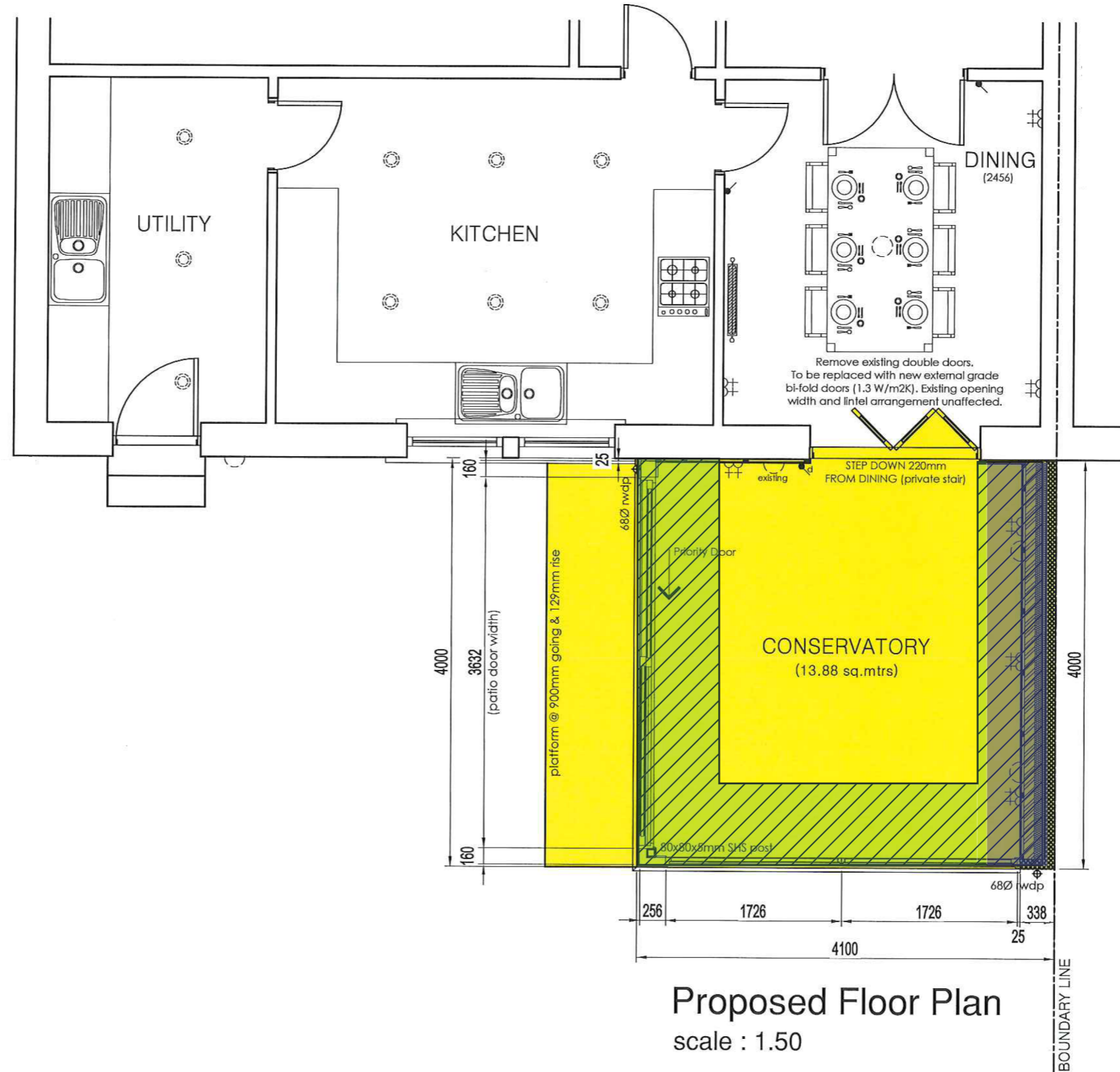
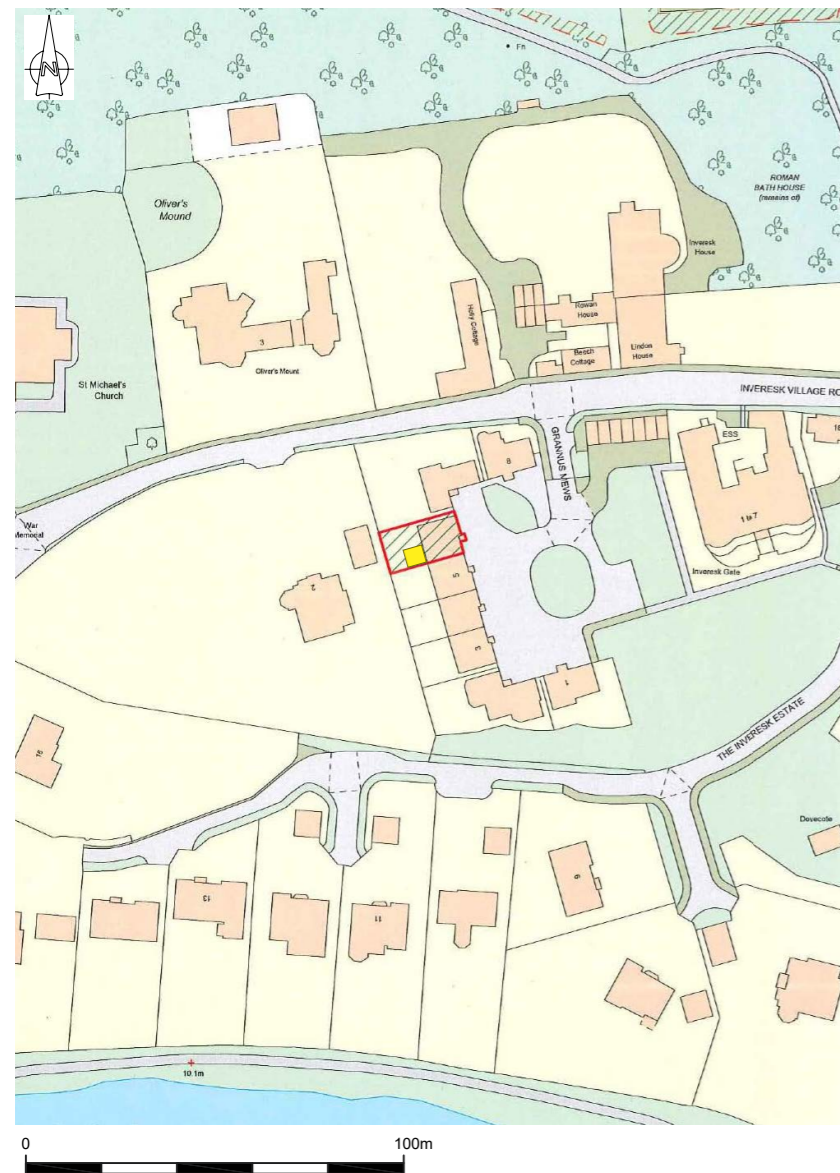

**Proposed Floor Plan**  
scale : 1.50



**Key:**

- Site Location
- Proposed Conservatory
- Area Monitored
- Concrete 003
- Natural 002

Reproduced with the permission of Ordnance Survey on behalf of The Controller of Her Majesty's Stationery Office, © Crown copyright. CFA Archaeology Ltd, Old Engine House, Eskmills Park, Musselburgh EH21 7PQ AL100034785

**CFA** ARCHAEOLOGY LTD  
 The Old Engine House  
 Eskmills Park  
 Musselburgh  
 East Lothian, EH21 7PQ  
 T: 0131 273 4380  
 F: 0131 273 4381  
 info@cfa-archaeology.co.uk  
 www.cfa-archaeology.co.uk

Title:  
**Location map and site plan showing foundation trenches monitored**

Project:  
**Proposed Conservatory, 6 Granus Mews, Inveresk, Musselburgh, East Lothian**

Client:  
**Mr. Ian Orr**

Scale at A3:  
**1:0000**

Drawn by: <b>SW</b>	Checked by: <b>BG</b>	Date: <b>08/05/17</b>
------------------------	--------------------------	--------------------------

Report No: <b>3552</b>	Fig. No: <b>1</b>
---------------------------	----------------------





Fig. 2 - Pre-excitation shot of area



Fig. 3 - Southernmost foundation trench excavated to concrete 003



Fig. 4 - Westernmost foundation trench excavated to natural substratum



Fig. 5 - Northernmost foundation trench excavated to natural substratum

Project:  
Proposed Conservatory, 6 Granus Mews, Inveresk, Musselburgh, East Lothian



Client:  
**Mr. Ian Orr**

Drawn by: <b>SW</b>	Checked: <b>xx</b>	Date: <b>08/05/17</b>
Report No: <b>3552</b>		Fig. No: <b>2 - 5</b>