



CFA ARCHAEOLOGY

Professional cultural heritage consultants - branches nationwide
enquiries@cfa-archaeology.co.uk



CAPABILITY
FLEXIBILITY
ASSURANCE

Land to the Rear of 10/10a Market Place, Egremont:

Archaeological Watching Brief
Report No. 3660

Author:
Gary Savory MA ACIfA



CFA ARCHAEOLOGY LTD

The Old Engine House
Eskmills Business Park
Musselburgh
East Lothian
EH21 7PQ

Tel: 0131 273 4380
Fax: 0131 273 4381
email: info@cfa-archaeology.co.uk
web: www.cfa-archaeology.co.uk

Author	Gary Savory MA ACIfA
Illustrator	Shelly Werner MA PhD MCIfA
Approver	Bruce Glendinning BSc PG Dip MCIfA
Commissioned by	Architects Plus (UK) Ltd on behalf of Merrett Commercial Ltd
Date issued	May 2018
Version	1
OASIS Reference	cfaarcha1-314256
Planning Application Nos.	4/17/2151
Grid Ref	NY 01122 10593

This document has been prepared in accordance with CFA Archaeology Ltd standard operating procedures.

**Land to the rear of 10/10a Market Place
Egremont, Cumbria**

Archaeological Watching Brief

Report No. 3660

CONTENTS

1.	Introduction	3
2.	Working Methods	4
3.	Archaeological Results	4
4.	Conclusion	5

Appendices

1.	Context Register	6
2.	Photographic Register	6
3.	Drawing Register	6
4.	Finds Register	6

List of Figures (Bound at Rear)

Fig 1 General Location map of the proposed development site

Fig 2 The proposed development site

Fig 3 North-facing section of soakaway

Fig 4 Example of the foundation trenches

Fig 5 Plan of the development area with identified features

Fig 6 Robber trench 004

Fig 7 North-north-west facing section of robber trench 004

1. INTRODUCTION

1.1 General

This report presents the results of an Archaeological Watching Brief undertaken by CFA Archaeology Ltd in March 2018 at Land to the rear of 10/10a Market Place, Egremont, Cumbria (NGR: NY 01122 10593) (Figs. 1 & 2). The work was commissioned by Architects Plus (UK) Ltd on behalf of Merrett Commercial Ltd.

A Written Scheme of Investigation (WSI) was prepared by CFA Archaeology Ltd and approved by Cumbrian County Council Historic Environment Service (CCCHES). CCCHES requested that an Archaeological Watching Brief should be carried out during groundbreaking activities required for the development of residential accommodation.

1.2 Background

Planning consent was been granted for the construction the construction of a terrace of 3 dwellings on land to the rear of 10/10a Market Place, Egremont. A condition for an archaeological watching brief was attached to the consent.

CCCHES indicated that their records showed that the site lay in an area of archaeological potential in the historic core of Egremont. Documentary evidence showed that the centre of the town was established from at least the end of the 12th century and that the market, on which the site was located, received its charter in 1267. The site of the 12th century predecessor of the existing parish church lay next to the site and the medieval castle was nearby. CCCHES therefore considered it likely that buried archaeological assets of local significance may be disturbed by the construction of the proposed development hence the condition on the consent.

The site was bounded to the east by Egremont Parish Church Hall, to the south by St. Mary and St. Michaels parish Church, and to the west by existing residential buildings looking onto Main Street (Fig. 2).

1.3 Objectives

The aims and objectives of the archaeological work were:

- To conduct an appropriate programme of archaeological investigation (watching brief) during all groundbreaking works to record any features or deposits of archaeological interest uncovered.
- To produce a report on the results and if necessary undertake post-excavation analysis and produce a publication report

2. WORKING METHODS

2.1 General

CFA follows the Chartered Institute for Archaeologists' Standards and Guidance and Code of Conduct as appropriate

2.2 Watching Brief

The watching brief was conducted during the excavation of a soakaway pit (approximately 3.2m x 2.1m) and the foundation trenches associated with the residential development. The overall development area measured 20m x 15m, where the buildings had a footprint of 14.9m x 9.5m. The remaining development features did not require excavation to be formed.

All excavation was conducted by a mechanical excavator under constant archaeological supervision. All discoveries, including soil profiles and subsoil characteristics, were recorded using standard CFA recording forms and digital photography.

3. ARCHAEOLOGICAL RESULTS

3.1 General

Context numbers are in bold and described in Appendix 1.

3.2 Watching Brief

Across the development site was approximately 0.4m of made-ground, which consisted of mixed dark brown sandy silt and gravel (**001**). The ground had been raised as a result of the construction of the pre-existing house and gardens situated to the west. Underlying the mixed deposit was approximately 0.5m of buried garden soils which consisted of dark brown sandy silt (**002**). Lying directly underneath the garden soil was reddish brown sandy gravel natural (**003**).

A soakaway which measured 3.2m x 2.1m, and 1.75m deep was excavated (Fig. 3). Foundation trenches were excavated around the perimeter and across the middle of the site. The trenches were approximately 0.7m wide were excavated to a depth of 0.8m, revealing the natural (Fig. 4 & 5).

A north-north-west by south-south-east aligned ditch that appeared to be a robber trench (**004**) where a former wall line had been removed was identified at the eastern edge of the development site (Fig. 6). As exposed it was 15m long and was approximately 0.5m wide. A section revealed that it was 0.15m deep. The fill (**005**) consisted of a mixture of mortar and sandstone fragments (Fig. 7). It had been cut through the garden soils (**002**). A small length of another robber trench (**006**), aligned east-north-east by west-south-west, was also identified. It measured 3m in length and 0.5m in width and survived to a depth of 0.15m. The trench petered out at its western end.

Otherwise, no other archaeologically significant features or deposits were identified.

3.3 Finds by Christina Hills

A small number of mixed finds were recovered on site and are detailed in appendix 4.

Animal bone

A small amount of unidentified animal bone was uncovered in deposit **002** and the fill of robber trench **004**.

Clay pipe

One clay pipe stem was found in deposit **002** and another in the fill of robber trench **004**. These are undiagnostic but probably post medieval in date.

Glass

All the glass recovered on site is modern bottle, including clear and light green fragments from deposit **002** and green and blue fragments, some of which have markings, from the fill of robber trench **004**.

Iron

Three pieces of iron were found in deposit **002** including a large rod and a nail, all of which are modern.

Pottery

Modern red and white earthenware was found in deposit **002** and the fill of robber trench **004**.

4. CONCLUSION

A watching brief was carried out during excavations of building footings, service trenches and a soakaway on land to the rear of 10/10a Market Place, Egremont. The remains of robber trenches for former walls were identified during the groundworks. The trenches were cut through the buried garden soil (**002**) and the walls were not considered to be of any great antiquity.

APPENDIX 1: CONTEXT REGISTER

Context no.	Post-hole	Fill of	Type	Description
001				Mixed topsoil and gravel (made ground)
002				Dark brown sandy silt (buried garden soils)
003				Reddish brown sandy gravel (natural)
004				Cut of robber trench
005		004		Fill of robber trench
006				Cut of robber trench
007		006		Fill of robber trench

APPENDIX 2: PHOTOGRAPHIC REGISTER

Shot No.	Summary description of subject	Facing
1	Pre-ex shot of the development area	NE
2	Representative section, soakaway	N
3	Representative section, soakaway	E
4	Robber trench [004], aligned NNW-SSE	SSE
5	Robber trench [004], aligned NNW-SSE	NNW
6	Robber trench [004], aligned NNW-SSE	NNW
7	ENE-WSW aligned robber trench [006]	WSW
8	NNW-facing section of robber trench [004]	SSE
9	NNW-facing section of robber trench [004]	SSE
10	Location of slot through robber trench [004]	SSE
11	Oblique view of one of the foundation trenches	SE
12	Oblique of one of the foundation trenches	ENE
13	Representative section of the foundation trenches	NNW

APPENDIX 3: DRAWING REGISTER

Dwg No.	Sheet No.	Scale	Plan / Section	Description/contexts
1	1	1:100	P	Plan of development area
2	1	1:10	S	NNW-facing section of robber trench 004
3	1	1:10	S	S-facing section of soakaway

APPENDIX 4: FINDS REGISTER

Context	Find type	No	Wt (g)	Notes	Spotdate
002	Pottery	2	172	Red earthenware, glazed	Modern
002	Pottery	17	304	White earthenware, glazed	Modern
002	Clay pipe	1	3	Stem	Post-med
002	Animal bone	6	56		
002	Glass	4	150	Light green, bottles	Modern
002	Glass	1	4	Clear. Bottle fragment	Modern
002	Iron	3	488	Nail, Large rod	Modern
005	Pottery	1	23	Red earthenware, glazed	Modern
005	Pottery	5	101	White earthenware, glazed	Modern
005	Clay pipe	1	1	Stem	Post-med
005	Animal bone	7	46		
005	Glass	2	35	Light green, bottle fragments.	Modern
005	Glass	1	36	Green bottle fragment	Modern

005	Glass	2	77	Blue bottle fragments	Modern
-----	-------	---	----	-----------------------	--------

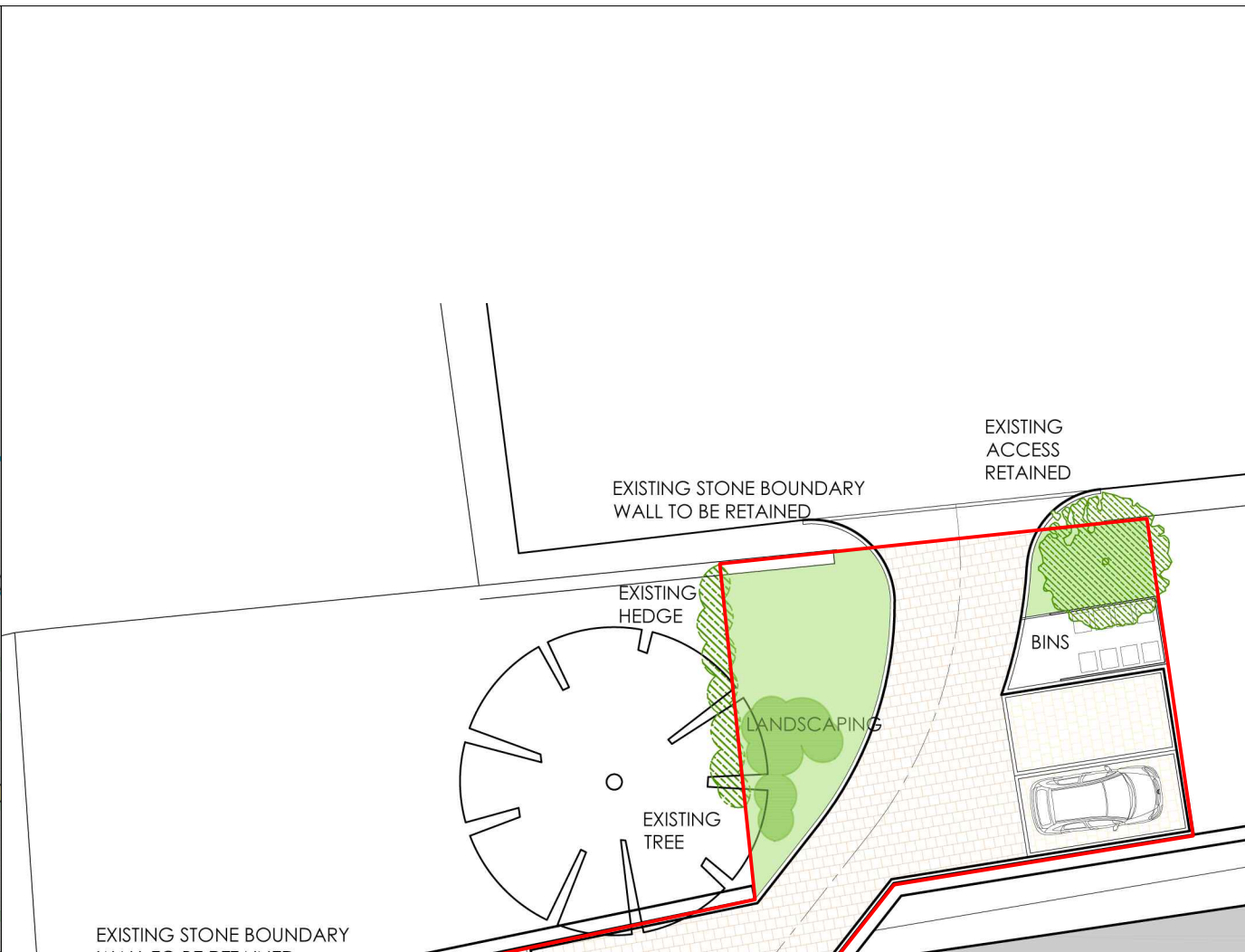

Key:

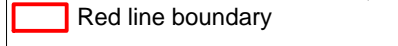

Red line boundary

Reproduced with the permission of Ordnance Survey on behalf of The Controller of Her Majesty's Stationery Office, © Crown copyright. CFA Archaeology Ltd, Old Engine House, Eskmills Park, Musselburgh EH21 7PQ AL100034785



Title:
General location map of proposed development site

Project:
Land to the rear of 10/10a Market Place, Egremont, Cumbria
Archaeological Watching Brief

Client:
Architects Plus (UK) Ltd

Scale at A3:
1:200

Drawn by: SW	Checked: GS	Date: 15/05/2018
-----------------	----------------	---------------------

Report No: 3660	Fig. No: 1
--------------------	---------------



Fig. 2 - The proposed development site



Fig. 3 - North-facing section of soakaway

Project:
 Land to the rear of 10/10a Market Place, Egremont, Cumbria
 Archaeological Watching Brief



CFA ARCHAEOLOGY LTD
 The Old Engine House
 Eskmills Park
 Musselburgh
 East Lothian, EH21 7PQ
 T: 0131 273 4380
 F: 0131 273 4381
 info@cfa-archaeology.co.uk
 www.cfa-archaeology.co.uk

Client:
Architects Plus (UK) Ltd

Drawn by: SW	Checked by: GS	Date: 15/05/18
Report No: 3660		Fig. No: 2 - 3



Fig. 4 - Example of the foundation trenches

Project:
 Land to the rear of 10/10a Market Place, Egremont, Cumbria
 Archaeological Watching Brief



Client:
 Architects Plus (UK) Ltd

Drawn by: SW	Checked: GS	Date: 15/05/18
Report No: 3660		Fig. No: 4

Key:

 Red line boundary

 Foundation Trench

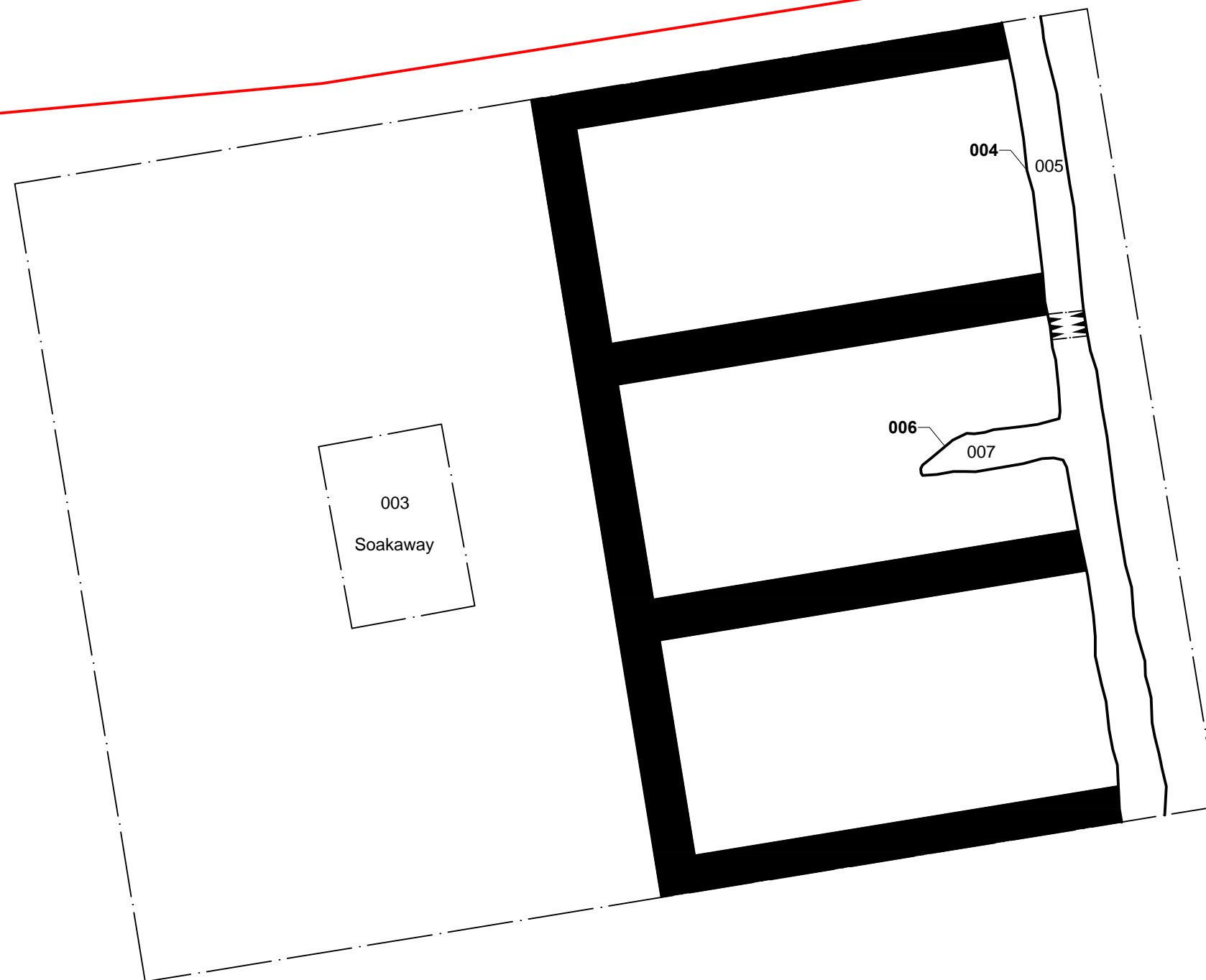

CFA
ARCHAEOLOGY LTD

CFA ARCHAEOLOGY LTD
The Old Engine House
Eskmills Park
Musselburgh
East Lothian, EH21 7PQ
T: 0131 273 4380
F: 0131 273 4381
info@cfa-archaeology.co.uk
www.cfa-archaeology.co.uk

Title:
Plan of development area with identified features

Project:
Land to the rear of 10/10a Market Place, Egremont, Cumbria Archaeological Watching Brief

Client:
Architects Plus (UK) Ltd

Scale at A3:
1:100

Drawn by: SW	Checked: GS	Date: 15/05/2018
------------------------	-----------------------	----------------------------

Report.No: 3660	Fig. No: 5
---------------------------	----------------------





Fig. 6 - Robber trench [004]



Fig. 7 - North-north-west-facing section of robber trench [004]

Project:
Land to the rear of 10/10a Market Place, Egremont, Cumbria
Archaeological Watching Brief



CFA ARCHAEOLOGY LTD
The Old Engine House
Eskmills Park
Musselburgh
East Lothian, EH21 7PQ
T: 0131 273 4380
F: 0131 273 4381
info@cfa-archaeology.co.uk
www.cfa-archaeology.co.uk

Client:
Architects Plus (UK) Ltd

Drawn by: SW	Checked: GS	Date: 15/05/18
Report No: 3660		Fig. No: 6 - 7



CFA ARCHAEOLOGY
www.cfa-archaeology.co.uk

HEAD OFFICE - Musselburgh

Old Engine House
Eskmills Park, Musselburgh
East Lothian, EH21 7PQ

t: +44 (0) 131 273 4380
e: enquiries@cfa-archaeology.co.uk

Leeds

Offices C1 & C2
Clayton Business Centre, Midland Road
Leeds, LS10 2RJ

t: +44 (0) 113 271 6060
e: yorkshire@cfa-archaeology.co.uk

Manchester

44G9, Europa Business Park
Bird Hall Lane, Cheadle Heath
Manchester, SK3 0XA

t: +44 (0) 161 428 8224
e: manchester@cfa-archaeology.co.uk

Milton Keynes

Town Hall
Creed Street, Wolverton
Milton Keynes, MK12 5LY

t: +44 (0) 1908 226 124
e: miltonkeynes@cfa-archaeology.co.uk

Carlisle

Warwick Mill Business Village
Warwick Bridge, Carlisle
Cumbria, CA4 8RR

t: +44 (0) 1228 564 531
e: cumbria@cfa-archaeology.co.uk

Sheffield

Office 5, Ecclesfield Business Centre
46 Stocks Hill, Ecclesfield
Sheffield, S35 9YT

t: +44 (0) 114 327 1108
e: sheffield@cfa-archaeology.co.uk

Leicester

Business Box
3 Oswin Road, Brailsford Industrial Estate
Leicester, LE3 1HR

t: +44 (0) 116 279 5156
e: leicestershire@cfa-archaeology.co.uk

Hertfordshire

Amwell House
9 Amwell Street, Hoddesdon
Hertfordshire, EN11 8TS

t: +44 (0) 845 017 9847
e: herts@cfa-archaeology.co.uk